

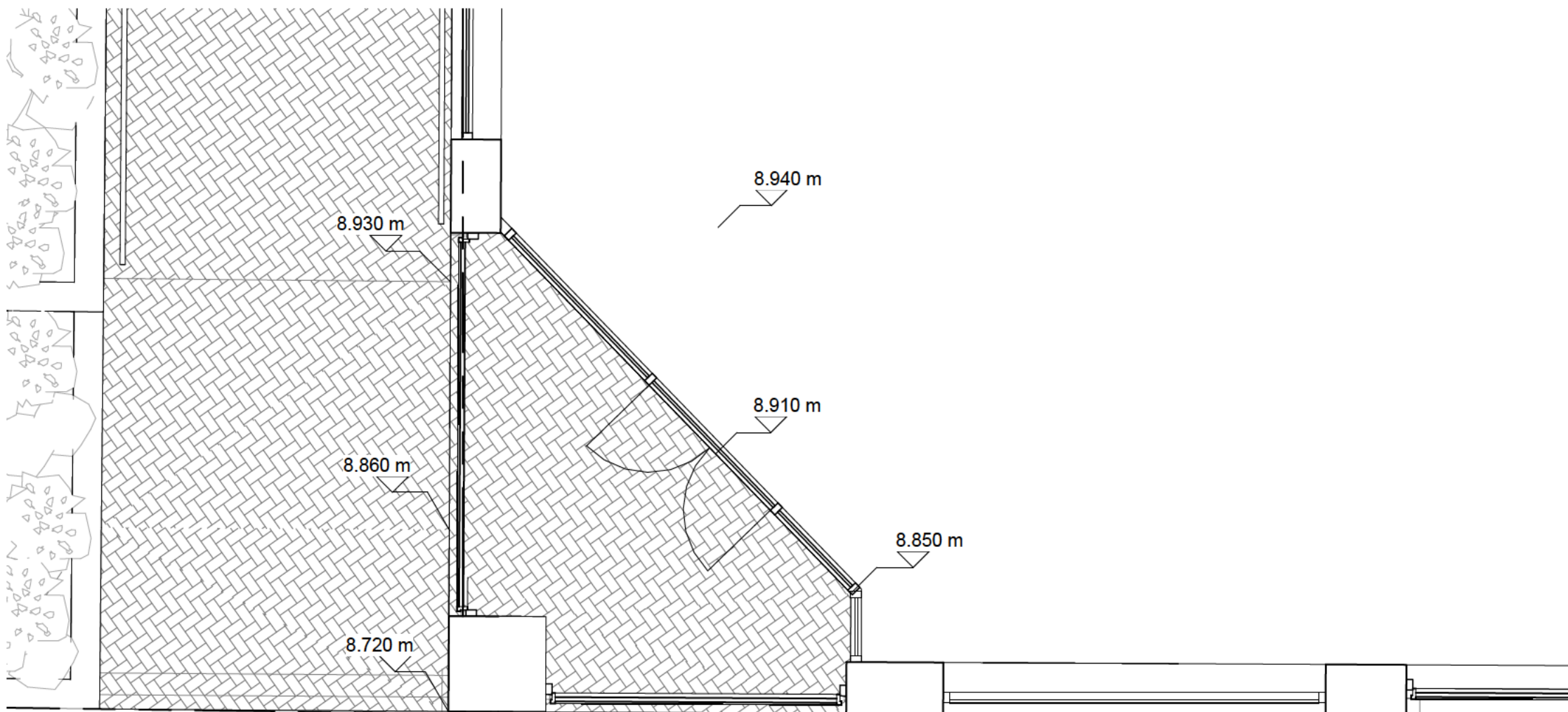

Existing East Elevation - The Landing
1 : 50



Existing GA Ground Floor Plan - The Landing
1 : 50

Note: All spot levels indicated are based on drawing 6766-1 Ground Floor (dated 30.06.2025) and drawing 6198-1a Redcliffe Quay Topographical Survey (Update) (dated 02.07.2025), both provided by Clifton Surveys Ltd.

Notes

Do not scale from this document, unless for the purposes of planning applications where a scale bar is provided. Refer to figured dimensions only. All dimensions to be verified on site prior to construction. Report all discrepancies or ambiguities to the Document Originator immediately. This document is to be read in conjunction with relevant documents, drawings and standards.

P02	20.11.25	Planning issue.	AC	RG
P01	11.07.25	First Issue	AC	RG

Rev	Date	Notes	Dm	Chk'd
-----	------	-------	----	-------

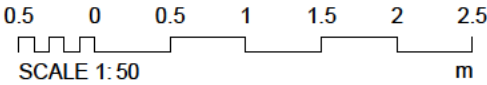

Document Originator

AWW

London - 106 Weston Street, SE1 3QB
Plymouth - East Quay House, PL4 0HX
Bristol - pivot + mark, 48 - 52 Baldwin Street, BS1 1QB

RIBA Chartered Practice

www.aww-uk.com

Client
Skelton Group

AWW Project Number
4817

Project Stage
Planning

Project Title
Redcliff Quay
Bristol

Title
The Landing Cafe - Existing Plan and East Elevation

Scale @ A2
1 : 50

Document Status
S4 - Suitable for Stage Approval

Project	Origin.	Volume	Level	Type	Role	Number	Rev
4817	AWW	ZZ	ZZ	DR	A	02213	P02