

1  
010 EXISTING GROUND FLOOR  
SCALE: 1 : 100

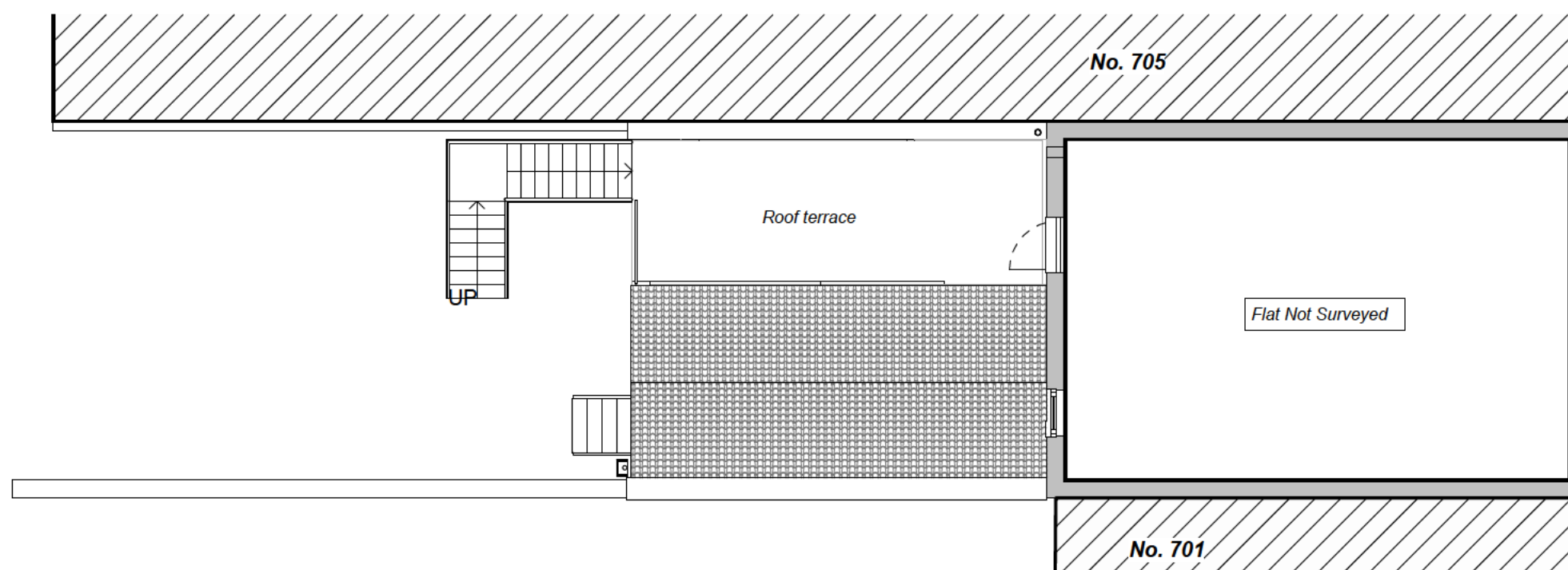

3  
010 EXISTING FIRST FLOOR  
SCALE: 1 : 100

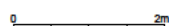

#### Notes:

Confirm all dimensions on site prior to any off site manufacturing.  
At construction phase do not scale from drawing, use figured dimensions only.  
Dimensions are in millimetres and to structure unless stated otherwise.  
Report any discrepancies, conflicts or errors to architect prior to proceeding.  
Refer to structural engineers design for all load bearing elements, bracing, movement joints and below ground drainage.  
Refer to mechanical and electrical engineers design for all building services.  
All works to comply with relevant British Standards and Building Regulations.  
This drawing and design is the property of 3bd LLP and is issued under license to the named recipient only. All copyright law protecting design, artistic & literary work contained within this drawing remains.

A Red line amended. 6-12-2024

Rev Description Date

**FOR PLANNING**

**3bd** LLP  
Architects

RIBA Chartered Practice © 2021  
15&17 Backfields Lane, Stokes Croft, Bristol. BS2 8QW  
www.3bdarchitects.com

Client  
**JESEY KAUR**

Project  
**703 Fishponds Road, Bristol,  
BS16 3UH**

Drawing Title  
**EXISTING FLOOR PLANS**

Drawing Number  
**672-PLA- 010**

Date  
MAR 2024

Scale  
1 : 100@ A3

Drawn  
TS

Rev.  
A

Chkd  
DF