

# Notice of variation and consolidation with introductory note

## The Environmental Permitting (England & Wales) Regulations 2016

---

Scott Bros. Limited

Billingham Reed Beds  
Norton Bottoms  
Portrack Roundabout  
Billingham  
TS18 2QF

### **Variation application number**

EPR/JP3336HA/V005

### **Permit number**

EPR/JP3336HA

# Billingham Reed Beds

## Permit number EPR/JP3336HA

### Introductory note

#### **This introductory note does not form a part of the notice**

Under the Environmental Permitting (England & Wales) Regulations 2016 (schedule 5, part 1, paragraph 19) a variation may comprise a consolidated permit reflecting the variations and a notice specifying the variations included in that consolidated permit.

Schedule 1 of the notice specifies the conditions that have been varied and schedule 2 comprises a consolidated permit which reflects the variations being made. Only the variations specified in schedule 1 are subject to a right of appeal.

#### **Changes introduced by this variation notice:**

This permit variation has been issued to implement the following guidance “Non-hazardous and inert waste: appropriate measures for permitted facilities” and to implement the relevant requirements Best Available Techniques (BAT) Conclusions set out in implementing decision (EU) 2018/1147 of 10 August 2018.

The Industrial Emissions Directive (IED) came into force on 7 January 2014 with the requirement to implement all relevant Best Available Techniques (BAT) Conclusions as described in the Commission Implementing Decision.

Article 21(3) of the IED requires the Environment Agency to review conditions in permits that it has issued and to ensure that the permit delivers compliance with relevant standards, within four years of the publication of updated decisions on Best Available Techniques (BAT) Conclusions. The BAT Conclusions for Waste Treatment (the BREF) was published on 17 August 2018 following a European Union wide review of BAT, implementing decision (EU) 2018/1147 of 10 August 2018.

The non-hazardous and inert waste: appropriate measures for permitted facilities guidance was published on the gov.uk website on 12 July 2021. This guidance sets out the standards that are relevant to regulated facilities with a permit to store, treat or transfer (or both) non-hazardous and inert wastes.

This variation has consolidated the original permit and subsequent variations.

#### **The main features of the permit are as follows:**

The permit allows for the disposal of non-hazardous waste into a system of soil-based reed beds. There are only two types of liquid waste streams that are accepted and treated at the reed bed site – leachate from landfills and gully/sweeper waste. While the gully/sweeper waste is pre-treated in a settling tank to remove suspended solids, the leachate waste is not pre-treated. All liquid waste is treated in the lined reed bed cells by microbiological activity which breaks down the organic matter.

Site activities are as follows:

- Section 5.4, Part A(1)(a)(i) - Disposal of non-hazardous waste with a capacity of more than 50 tonnes per day involving biological treatment.
- Section 5.4, Part A(1)(a)(ii) - Disposal of non-hazardous waste with a capacity of more than 50 tonnes per day involving physico-chemical treatment.
- Raw material handling and storage.

There is no storage of waste associated with the permitted activities other than that which forms an integral part of the settlement tank treatment activity.

The site is located off the A19 at Norton Bottoms, Billingham. The centre of the site is at National Grid Reference 446605, 520709. The site is located on Brownfield land situated within the former Imperial Chemical Industries (ICI) storage area. The nearest residential properties are approximately 750m to the

Northwest on Imperial Road. HMP Holme house is approximately 500m to the Southwest. The Teesmouth and Cleveland Coast SSSI and SPA is located approximately 300m to the east of the reed beds.

There are no channelled emissions to air from the site operations. There are currently no discharges or emissions to water or to sewer. However, a discharge point to Billingham Beck remains within the permit – this is linked to the pre-operational condition for future development, PO1 that requires the operator to assess the risk of any discharge and submit a written report of the risk assessment to the Environment Agency for approval prior to discharge of the treated waste streams to the receiving water body.

The schedules specify the changes made to the permit.

The status log of a permit sets out the permitting history, including any changes to the permit reference number.

Status log of the permit		
Description	Date	Comments
Application EPR/JP3336HA/A001	Duly made 02/03/2011	Application for reed bed treatment facility
Additional information received	26/04/2011	Response to parts – <ul style="list-style-type: none"> <li>Technically Competent Manager</li> <li>Operation of the pre-treatment settlement process</li> </ul> Installation of boreholes and groundwater sampling
Permit EPR/JP3336HA/A001 determined	28/07/2011	Permit issued to Scott Bros Limited
Variation Notice EPR/JP3336HA/V002	Issued 28/08/2013	Agency initiated variation to amend permit to reflect implementation of Industrial Emissions Directive.
Application EPR/JP3336HA/V003	Duly made 15/08/2016	Application to add EWC code 161002.
Variation determined EPR/JP3336HA	Issued 19/10/2016	Varied permit issued.
Application EPR/JP3336HA/V004	Duly made 25/11/2016	Application to relocate an emission point W1
Variation determined EPR/JP3336HA/V004 Permit JP3336HA (PAS billing number - ZP3932DH)	20/12/2016	Varied permit issued.
Environment Agency Non-hazardous Waste Sector Review Variation Number EPR/JP3336HA/V005 (variation and consolidation)	15/01/2024	Non-hazardous waste Sector Review - documents received in response to the Regulation 61 Notice dated 08/11/2021.
Regulation 61 notice – additional information request	12/05/2025	Documents Provided “TT-NB-Sch61Response 12.05.25” Questions 1, 2 & 5-14.
	19/05/2025	Documents provided: “TT-NB-Sch61Response 19.05.25”

Status log of the permit		
Description	Date	Comments
		Complete response including questions 2, 4, 15 & 16 <i>"Annex A - CAR JP3336HA-0555319"</i> <i>"Annex B - Reed Beds Waste Acceptance Procedures"</i> <i>"Annex C - Groundwater BH Installation"</i>
Variation determined EPR/JP3336HA	Issued 09/09/2025	Varied and consolidated permit issued in modern format.

End of introductory note

# Notice of variation and consolidation

## The Environmental Permitting (England and Wales) Regulations 2016

The Environment Agency in exercise of its powers under regulation 20 of the Environmental Permitting (England and Wales) Regulations 2016 varies

### Permit number

**EPR/JP3336HA/V005**

### Issued to

**Scott Bros. Limited** ("the operator")

whose registered office is

**Scott Business Park  
Haverton Hill Road  
Billingham  
TS23 1PY**

company registration number 06329873

to operate a regulated facility at

**Billingham Reed Beds  
Norton Bottoms  
Portrack Roundabout  
Billingham  
TS18 2QF**

to the extent set out in the schedules.

The notice shall take effect from 09/09/2025

Name	Date
<b>Peter Maksymiw</b>	<b>09/09/2025</b>

Authorised on behalf of the Environment Agency

## Schedule 1

The following conditions and tables have been added/varied/deleted as a result of the Environment Agency Initiated Variation:

Conditions	Amendment
Condition 1.4.1	Condition format updated to match the modern template.
Condition 1.4.2	Condition added in line with the modern template.
Condition 2.3.4	Condition 2.6.1 of the previous variation has been renumbered as condition 2.3.4 to reflect the layout of the modern template.
Condition 2.3.6	Condition added in line with the modern template.
Condition 2.5	Pre-operational condition has been added for the emission to water. The follow-on condition has been renumbered.
Condition 3.1.1	Condition 3.1.1 of the previous variation has been moved to become condition 3.1.2 and condition 3.1.2 to become condition 3.1.1 to reflect the layout of the modern template.
Condition 3.5.1	Condition updated to include the process monitoring table.
Conditions 3.6	Condition added in line with the modern template.
Condition 4.1.1	Condition format updated to match the modern template.
Condition 4.2.2	Condition format updated to match the modern template.
Condition 4.2.3	Condition format updated to match the modern template.
Condition 4.2.5	Condition added in line with the modern template.
Condition 4.3.1	Condition format updated to match the modern template.
Condition 4.3.3	Condition added in line with the modern template.
Condition 4.3.4	Condition format updated to match the modern template.
Table S1.1 as referenced in condition 2.1.1	Scheduled activities and limits updated to reflect the site situation.
Table S1.2 as referenced in condition 2.3.1	Operating techniques updated to include the response documents to the Regulation 61 notice.
Table S1.3 as referenced in condition 2.4	Improvement conditions added/updated in the permit.
Table S1.4 as referenced in condition 2.5.1	Pre-operational condition added for the emission to surface water.
Table S3.1 as referenced in condition 3.1.1	Emission limits updated with relevant BAT AELs.

Table S3.2 as referenced in condition 3.1.1	Emissions limit table removed from the permit as there are no permitted emissions to ground. This has been replaced with process monitoring of ground water.
Table S4.1 as referenced in condition 4.2.3	Reporting requirement have been updated to include process monitoring.
Table S4.3 as referenced in condition 4.2.2	Other performance parameters reporting added to the table.
Table S4.4 as referenced in condition 4.2.3	Reporting forms updated.
Schedule 5	Schedule format updated to match the modern template.
Schedule 6	Interpretations updated to match the modern template.

## **Schedule 2 – consolidated permit**

Consolidated permit issued as a separate document.

# Permit

## The Environmental Permitting (England and Wales) Regulations 2016

### Permit number

**EPR/JP3336HA**

This is the consolidated permit referred to in the variation and consolidation notice for application EPR/JP3336HA/V005 authorising,

**Scott Bros. Limited** ("the operator"),

whose registered office is

**Scott Business Park  
Haverton Hill Road  
Billingham  
England  
TS23 1PY**

company registration number 06329873

to operate an installation at

**Billingham Reed Beds  
Norton Bottoms  
Portrack Roundabout  
Billingham  
TS18 2QF**

to the extent authorised by and subject to the conditions of this permit.

Name	Date
Peter Maksymiw	09/09/2025

Authorised on behalf of the Environment Agency



# Conditions

## 1 Management

### 1.1 General management

- 1.1.1 The operator shall manage and operate the activities:
- (a) in accordance with a written management system that identifies and minimises risks of pollution, including those arising from operations, maintenance, accidents, incidents, non-conformances, closure and those drawn to the attention of the operator as a result of complaints; and
  - (b) using sufficient competent persons and resources.
- 1.1.2 Records demonstrating compliance with condition 1.1.1 shall be maintained.
- 1.1.3 Any person having duties that are or may be affected by the matters set out in this permit shall have convenient access to a copy of it kept at or near the place where those duties are carried out.
- 1.1.4 The operator shall comply with the requirements of an approved competence scheme.

### 1.2 Energy efficiency

- 1.2.1 The operator shall:
- (a) take appropriate measures to ensure that energy is used efficiently in the activities;
  - (b) review and record at least every four years whether there are suitable opportunities to improve the energy efficiency of the activities; and
  - (c) take any further appropriate measures identified by a review.

### 1.3 Efficient use of raw materials

- 1.3.1 The operator shall:
- (a) take appropriate measures to ensure that raw materials and water are used efficiently in the activities;
  - (b) maintain records of raw materials and water used in the activities;
  - (c) review and record at least every four years whether there are suitable alternative materials that could reduce environmental impact or opportunities to improve the efficiency of raw material and water use; and
  - (d) take any further appropriate measures identified by a review.

### 1.4 Avoidance, recovery and disposal of wastes produced by the activities

- 1.4.1 The operator shall take appropriate measures to ensure that:
- (a) the waste hierarchy referred to in Article 4 of the Waste Framework Directive is applied to the generation of waste by the activities; and
  - (b) any waste generated by the activities is treated in accordance with the waste hierarchy referred to in Article 4 of the Waste Framework Directive; and
  - (c) where disposal is necessary, this is undertaken in a manner which minimises its impact on the environment.

- 1.4.2 The operator shall review and record at least every four years whether changes to those measures should be made and take any further appropriate measures identified by a review.

## **2 Operations**

### **2.1 Permitted activities**

- 2.1.1 The operator is only authorised to carry out the activities specified in schedule 1 table S1.1 (the “activities”).

### **2.2 The site**

- 2.2.1 The activities shall not extend beyond the site, being the land shown edged in red on the site plan at schedule 7 to this permit.

### **2.3 Operating techniques**

- 2.3.1 The activities shall, subject to the conditions of this permit, be operated using the techniques and in the manner described in the documentation specified in schedule 1, table S1.2, unless otherwise agreed in writing by the Environment Agency.
- 2.3.2 If notified by the Environment Agency that the activities are giving rise to pollution, the operator shall submit to the Environment Agency for approval within the period specified, a revision of any plan or other documentation (“plan”) specified in schedule 1, table S1.2 or otherwise required under this permit which identifies and minimises the risks of pollution relevant to that plan, and shall implement the approved revised plan in place of the original from the date of approval, unless otherwise agreed in writing by the Environment Agency.
- 2.3.3 Any raw materials or fuels listed in schedule 2 table S2.1 shall conform to the specifications set out in that table.
- 2.3.4 Waste shall only be accepted if:
- (a) it is of a type and quantity listed in schedule 2 table S2.2 and
  - (b) it conforms to the description in the documentation supplied by the producer and holder.
- 2.3.5 The operator shall ensure that where waste produced by the activities is sent to a relevant waste operation, that operation is provided with the following information, prior to the receipt of the waste:
- (a) the nature of the process producing the waste;
  - (b) the composition of the waste;
  - (c) the handling requirements of the waste;
  - (d) the hazardous property associated with the waste, if applicable; and
  - (e) the waste code of the waste.
- 2.3.6 The operator shall ensure that where waste produced by the activities is sent to a landfill site, it meets the waste acceptance criteria for that landfill.

### **2.4 Improvement programme**

- 2.4.1 The operator shall complete the improvements specified in schedule 1 table S1.3 by the date specified in that table unless otherwise agreed in writing by the Environment Agency.

- 2.4.2 Except in the case of an improvement which consists only of a submission to the Environment Agency, the operator shall notify the Environment Agency within 14 days of completion of each improvement.

## **2.5 Pre-operational conditions**

- 2.5.1 The operations specified in schedule 1 table S1.4 shall not commence until the measures specified in that table have been completed.

## **2.6 Engineering**

- 2.6.1 No construction of infrastructure shall commence until the operator has submitted relevant construction proposals or a written request to use previous construction proposals to the Environment Agency and the Environment Agency has confirmed that it is satisfied with the construction proposals.
- 2.6.2 The construction of the infrastructure shall take place only in accordance with the approved construction proposals unless:
- (a) any change to the approved construction proposals would have no impact on the performance of any element of the design; or
  - (b) a change has otherwise been agreed in writing by the Environment Agency.
- 2.6.3 The operator shall submit a CQA Validation Report within four weeks of the completion of the construction of the relevant infrastructure or other time period agreed in writing with the Environment Agency.
- 2.6.4 Where pollution controls are immediately necessary to prevent an incident or accident, then conditions 2.6.1 do not apply and the relevant infrastructure may be constructed, provided that the construction proposals are submitted to the Environment Agency as soon as practicable.
- 2.6.5 For the purposes of conditions 2.6.1 the Environment Agency shall be deemed to be satisfied where it has not, within the period of four weeks from the date of receipt of the relevant construction proposals or CQA Validation Report, either:
- (a) confirmed whether or not it is satisfied; or
  - (b) informed the operator that it requires further information.

## **3 Emissions and monitoring**

### **3.1 Emissions to water, air or land**

- 3.1.1 There shall be no point source emissions to water, air or land except from the sources and emission points listed in schedule 3 table S3.1.
- 3.1.2 The limits given in schedule 3 shall not be exceeded.
- 3.1.3 Periodic monitoring shall be carried out at least once every 5 years for groundwater and 10 years for soil, unless such monitoring is based on a systematic appraisal of the risk of contamination.

### **3.2 Emissions of substances not controlled by emission limits**

- 3.2.1 Emissions of substances not controlled by emission limits (excluding odour) shall not cause pollution. The operator shall not be taken to have breached this condition if appropriate measures, including, but not limited to, those specified in any approved emissions management plan, have been taken to prevent or where that is not practicable, to minimise, those emissions.

3.2.2 The operator shall:

- (a) if notified by the Environment Agency that the activities are giving rise to pollution, submit to the Environment Agency for approval within the period specified, an emissions management plan which identifies and minimises the risks of pollution from emissions of substances not controlled by emission limits;
- (b) implement the approved emissions management plan, from the date of approval, unless otherwise agreed in writing by the Environment Agency.

3.2.3 All liquids in containers, whose emission to water or land could cause pollution, shall be provided with secondary containment, unless the operator has used other appropriate measures to prevent or where that is not practicable, to minimise, leakage and spillage from the primary container.

### **3.3 Odour**

3.3.1 Emissions from the activities shall be free from odour at levels likely to cause pollution outside the site, as perceived by an authorised officer of the Environment Agency, unless the operator has used appropriate measures, including, but not limited to, those specified in any approved odour management plan, to prevent or where that is not practicable to minimise the odour.

3.3.2 The operator shall:

- (a) if notified by the Environment Agency that the activities are giving rise to pollution outside the site due to odour, submit to the Environment Agency for approval within the period specified, an odour management plan which identifies and minimises the risks of pollution from odour;
- (b) implement the approved odour management plan, from the date of approval, unless otherwise agreed in writing by the Environment Agency.

### **3.4 Noise and vibration**

3.4.1 Emissions from the activities shall be free from noise and vibration at levels likely to cause pollution outside the site, as perceived by an authorised officer of the Environment Agency, unless the operator has used appropriate measures, including, but not limited to, those specified in any approved noise and vibration management plan to prevent or where that is not practicable to minimise the noise and vibration.

3.4.2 The operator shall:

- (a) if notified by the Environment Agency that the activities are giving rise to pollution outside the site due to noise and vibration, submit to the Environment Agency for approval within the period specified, a noise and vibration management plan which identifies and minimises the risks of pollution from noise and vibration;
- (b) implement the approved noise and vibration management plan, from the date of approval, unless otherwise agreed in writing by the Environment Agency.

### **3.5 Monitoring**

3.5.1 The operator shall, unless otherwise agreed in writing by the Environment Agency, undertake the monitoring specified in the following tables in schedule 3 to this permit:

- (a) point source emissions specified in tables S3.1;
- (b) process monitoring specified in table S3.2.

3.5.2 The operator shall maintain records of all monitoring required by this permit including records of the taking and analysis of samples, instrument measurements (periodic and continual), calibrations, examinations, tests and surveys and any assessment or evaluation made on the basis of such data.

- 3.5.3 Monitoring equipment, techniques, personnel and organisations employed for the emissions monitoring programme and the environmental or other monitoring specified in condition 3.5.1 shall have either MCERTS certification or MCERTS accreditation (as appropriate), where available, unless otherwise agreed in writing by the Environment Agency.
- 3.5.4 Permanent means of access shall be provided to enable sampling/monitoring to be carried out in relation to the emission points specified in schedule 3 tables S3.1 and S3.2 unless otherwise agreed in writing by the Environment Agency.

## **3.6 Pests**

- 3.6.1 The activities shall not give rise to the presence of pests which are likely to cause pollution, hazard or annoyance outside the boundary of the site. The operator shall not be taken to have breached this condition if appropriate measures, including, but not limited to, those specified in any approved pests management plan, have been taken to prevent or where that is not practicable, to minimise the presence of pests on the site.
- 3.6.2 The operator shall:
- (a) if notified by the Environment Agency, submit to the Environment Agency for approval within the period specified, a pests management plan which identifies and minimises risks of pollution from pests;
  - (b) implement the pests management plan, from the date of approval, unless otherwise agreed in writing by the Environment Agency.

# **4 Information**

## **4.1 Records**

- 4.1.1 All records required to be made by this permit shall:
- (a) be legible;
  - (b) be made as soon as reasonably practicable;
  - (c) if amended, be amended in such a way that the original and any subsequent amendments remain legible, or are capable of retrieval; and
  - (d) be retained, unless otherwise agreed in writing by the Environment Agency, for at least 6 years from the date when the records were made, or in the case of the following records until permit surrender:
    - (i) off-site environmental effects; and
    - (ii) matters which affect the condition of the land and groundwater.
- 4.1.2 The operator shall keep on site all records, plans and the management system required to be maintained by this permit, unless otherwise agreed in writing by the Environment Agency.

## **4.2 Reporting**

- 4.2.1 The operator shall send all reports and notifications required by the permit to the Environment Agency using the contact details supplied in writing by the Environment Agency.
- 4.2.2 A report or reports on the performance of the activities over the previous year shall be submitted to the Environment Agency by 31 January (or other date agreed in writing by the Environment Agency) each year. The report(s) shall include as a minimum:

- (a) a review of the results of the monitoring and assessment carried out in accordance with the permit including an interpretive review of that data;
  - (b) the annual production/treatment data set out in schedule 4 table S4.2; and
  - (c) the performance parameters set out in schedule 4 table S4.3 using the forms specified in table S4.4 of that schedule.
- 4.2.3 Within 28 days of the end of the reporting period the operator shall, unless otherwise agreed in writing by the Environment Agency, submit reports of the monitoring and assessment carried out in accordance with the conditions of this permit, as follows:
- (a) in respect of the parameters and emission points specified in schedule 4 table S4.1;
  - (b) for the reporting periods specified in schedule 4 table S4.1 and using the forms specified in schedule 4 table S4.4; and
  - (c) giving the information from such results and assessments as may be required by the forms specified in those tables.
- 4.2.4 The operator shall, unless notice under this condition has been served within the preceding four years, submit to the Environment Agency, within six months of receipt of a written notice, a report assessing whether there are other appropriate measures that could be taken to prevent, or where that is not practicable, to minimise pollution.
- 4.2.5 Within 1 month of the end of each quarter, the operator shall submit to the Environment Agency using the form made available for the purpose, the information specified on the form relating to the site and the waste accepted and removed from it during the previous quarter.

## 4.3 Notifications

- 4.3.1 In the event:
- (a) that the operation of the activities gives rise to an incident or accident which significantly affects or may significantly affect the environment, the operator must immediately—
    - (i) inform the Environment Agency,
    - (ii) take the measures necessary to limit the environmental consequences of such an incident or accident, and
    - (iii) take the measures necessary to prevent further possible incidents or accidents;
  - (b) of a breach of any permit condition the operator must immediately—
    - (i) inform the Environment Agency, and
    - (ii) take the measures necessary to ensure that compliance is restored within the shortest possible time;
  - (c) of a breach of permit condition which poses an immediate danger to human health or threatens to cause an immediate significant adverse effect on the environment, the operator must immediately suspend the operation of the activities or the relevant part of it until compliance with the permit conditions has been restored.
- 4.3.2 Any information provided under condition 4.3.1 shall be confirmed by sending the information listed in schedule 5 to this permit within the time period specified in that schedule.
- 4.3.3 Where the Environment Agency has requested in writing that it shall be notified when the operator is to undertake monitoring and/or spot sampling, the operator shall inform the Environment Agency when the relevant monitoring and/or spot sampling is to take place. The operator shall provide this information to the Environment Agency at least 14 days before the date the monitoring is to be undertaken.

- 4.3.4 The Environment Agency shall be notified within 14 days of the occurrence of the following matters, except where such disclosure is prohibited by Stock Exchange rules:

Where the operator is a registered company:

- (a) any change in the operator's trading name, registered name or registered office address; and
- (b) any steps taken with a view to the operator going into administration, entering into a company voluntary arrangement or being wound up.

Where the operator is a corporate body other than a registered company:

- (a) any change in the operator's name or address; and
- (b) any steps taken with a view to the dissolution of the operator.

In any other case:

- (a) the death of any of the named operators (where the operator consists of more than one named individual);
- (b) any change in the operator's name(s) or address(es); and
- (c) any steps taken with a view to the operator, or any one of them, going into bankruptcy, entering into a composition or arrangement with creditors, or, in the case of them being in a partnership, dissolving the partnership.

- 4.3.5 Where the operator proposes to make a change in the nature or functioning, or an extension of the activities, which may have consequences for the environment and the change is not otherwise the subject of an application for approval under the Regulations or this permit:

- (a) the Environment Agency shall be notified at least 14 days before making the change; and
- (b) the notification shall contain a description of the proposed change in operation.

- 4.3.6 The Environment Agency shall be given at least 14 days' notice before implementation of any part of the site closure plan.

## **4.4 Interpretation**

- 4.4.1 In this permit the expressions listed in schedule 6 shall have the meaning given in that schedule.

- 4.4.2 In this permit references to reports and notifications mean written reports and notifications, except where reference is made to notification being made "immediately", in which case it may be provided by telephone.

# Schedule 1 – Operations

Table S1.1 activities			
Activity reference	Activity listed in Schedule 1 of the EP Regulations	Description of specified activity and WFD Annex I and II operations	Limits of specified activity and waste types
AR1	Section 5.4, Part A(1)(a)(i) Disposal of non-hazardous waste with a capacity of more than 50 tonnes per day involving biological treatment.	Biological treatment of waste via soil-based reed bed systems. D8 - Biological treatment resulting in final compounds or mixtures which are discarded by any of the operations numbered D1 to D12.	Biological treatment of non-hazardous leachate and gully sucking/road sweeper waste through individual reed beds 1-7. From receipt of non-hazardous liquid waste to biological treatment within the reed beds. There shall be no channelled emissions to air or sewer from this activity. There shall be no discharge to surface water, prior to the completion of PO1. Gully sucking/road sweeper waste shall be pre-treated prior to discharge into the reed bed system. Waste types suitable for acceptance are limited to those specified in Table S2.2.
AR2	Section 5.4, Part A(1)(a)(ii) Disposal of non-hazardous waste with a capacity of more than 50 tonnes per day involving physico-chemical treatment.	Physico-chemical treatment of waste via settlement. D9 - Physico-chemical treatment resulting in final compounds or mixtures which are discarded by any of the operations numbered D1 to D12	From acceptance of non-hazardous gully sucking/sweeper waste with high solids content to treatment in a settlement tank to transfer into the reed bed system for further treatment and disposal. There shall be no channelled emissions to air or sewer from this activity. There shall be no discharge to surface water, prior to the completion of PO1 Waste types suitable for acceptance are limited to those specified in Table S2.2.
<b>Directly Associated Activity</b>			
AR3	N/A	Raw material handling and storage. From receipt of gas oil and storage to point of use.	Raw material handling and storage. From receipt of gas oil and storage to point of use.



Table S1.2 Operating techniques		
Description	Parts	Date Received
Application	Parts – <ul style="list-style-type: none"> <li>• Non technical summary</li> <li>• Operational techniques</li> <li>• Raw materials, waste, water and energy efficiency</li> <li>• Risk assessment, including H1</li> <li>• Monitoring</li> <li>• Emissions</li> <li>• Accident management plan</li> </ul>	02/03/2011
Additional information received	Response to parts – <ol style="list-style-type: none"> <li>1. Technically Competent Manager</li> <li>2. Operation of pre-treatment settlement process</li> <li>3. Installation of boreholes and groundwater sampling</li> </ol>	26/04/2011
Pre-operational measure 1	The written operating procedures for pre acceptance of waste to site and on site acceptance of waste that will form part of the management system	Response received 06/03/2012
Pre-operational measure 2	The written confirmation of the disposal route of the sludge produced from the physical settlement process and the associated operating procedures	Response received 06/03/2012
Pre-operational measure 3	A plan for undertaking sampling and analysis of the reed bed soils to establish baseline soil conditions	Response received 10/10/2011
Pre-operational measure 4	A groundwater monitoring plan	Response received 12/03/2012
Application variation EPR/JP3336HA/V004	Application forms C2 and C3 and referenced supporting information	Duly made as of 25/11/2016
Response to regulation 61 notice EPR/JP3336HA/V005	Documents Titled: <i>"Response to Regulation 61 Notice EPRJP3336HAA001"</i> Pages: <ul style="list-style-type: none"> <li>• 1-5 Regulation 61 Notice response</li> <li>• 15-18 Annex 2 BAT Conclusions</li> <li>• 19-20 Annex 3 Appropriate Measures</li> </ul>	Response received 15/01/2024
Response to regulation 61 notice EPR/JP3336HA/V005 - Additional information received in response to the Request for Further Information (RFI) dated 31/03/25	Documents Titled: <i>"TT-NB-Sch61Response 19.05.25"</i> Responses to questions: <ul style="list-style-type: none"> <li>• 1 and 6 - emissions and monitoring</li> <li>• 2 and 4 - Waste acceptance and delivery</li> <li>• 12 – sludge management</li> <li>• 13 and 14 – water management</li> <li>• 15 and 16 – groundwater monitoring</li> </ul> Annex B: <ul style="list-style-type: none"> <li>• Settlement tank sludge removal process</li> <li>• Waste acceptance procedure</li> </ul> Annex C: <ul style="list-style-type: none"> <li>• Groundwater BH installation</li> </ul>	Response received 19/05/2025

Table S1.3 Improvement programme requirements		
Reference	Requirement	Date
IC1	<p>The operator shall submit to the Environment Agency for assessment and approval an updated waste acceptance procedure and a procedure for representative sampling and testing of the soil/silt media within the reed beds.</p> <p>The updated waste acceptance and soil/silt procedures shall include methodology for sampling and testing all possible contaminants in the incoming waste streams (full suite) and in the soil/silt media that support the reed beds. The contaminants sampled in the soil/silt must be the same as those in the incoming waste.</p>	09/12/2025
IC2	<p>Following the completion of IC1, the operator shall submit a report to the Environment Agency for assessment and approval. The report shall contain:</p> <ul style="list-style-type: none"> <li>• Details of the sampling and testing results conducted in line with the approved procedures submitted under IC1. A minimum of 12 samples shall be submitted for each of the incoming waste streams (landfill leachate and gully sweepings) and for the soil/silt media.</li> <li>• Evidence to show that the reed bed treatment technique is effective in treating all contaminants identified in the incoming waste streams and to demonstrate that the identified contaminants are not bioaccumulating in the soil/silt media.</li> <li>• Evidence to show that the reedbed and any other treatment method you are using are designed to meet the requirements of BAT 20 of the Waste Treatment BAT Conclusions.</li> </ul> <p>Where it cannot be demonstrated that the reed beds can successfully treat any of the identified contaminants contained within the waste streams, the operator shall include in the report, a proposal for improvements to be implemented to ensure that waste is treated effectively.</p> <p>The Operator shall implement any improvements in accordance with the timescale agreed with the Environment Agency and where necessary, shall cease further acceptance of waste until the proposed improvements are implemented.</p>	15 months from the commencement date of IC2
IC3	<p>The operator shall undertake an inspection of the groundwater condition and a review of all primary and secondary containment systems and site surfacing to ensure that they are fit for purpose and shall submit a report of the review/inspection to the Environment Agency for approval.</p> <p>The review shall ascertain the state, design and construction of all relevant impermeable surfaces and sealed drainage systems on site, including the reedbeds liners to confirm that they are in line with, or equivalent to the standards specified in CIRIA Report C736. The review shall include:</p> <ul style="list-style-type: none"> <li>a) assessment and inspection of all primary and secondary containment against the standards set out in CIRIA C736. The assessment must be undertaken by a suitably qualified and experienced engineer and shall provide information on the condition of the reed beds and other infrastructure that is used in storing, treating, and/or handling waste at the site.</li> </ul>	09/03/2026

Table S1.3 Improvement programme requirements		
Reference	Requirement	Date
	<p>b) groundwater monitoring of borehole samples to establish that there are no impacts on groundwater as a result of the activities authorised in the permit.</p> <p>Where it is identified that impermeable surfaces, sealed drainage systems and liners underneath the reedbeds are not fit for purpose, the operator shall submit detailed improvement programme to bring the containment systems up to the required standards in CIRIA 736 or an equivalent alternative, to ensure all polluting materials are contained.</p> <p>Where it is not possible to identify improvement programmes to mitigate any identified risk at the site, the operator shall cease to accept waste at the site within 1 month of the deadline specified in this improvement condition.</p>	
IC4	<p>Following the completion IC3 and where improvement programmes have been agreed, the operator shall implement any identified improvement measures by the deadline specified in this improvement condition unless otherwise agreed in writing with the Environment Agency.</p> <p>The improvements may include, but are not limited to, the installation of impermeable surface, sealed drainage and containment systems.</p>	12 months from the commencement date of IC4
IC5	<p>Following the completion of IC3, the operator shall submit for approval and implementation a methodology and frequency for the on-going continued monitoring of ground water boreholes.</p> <p>Reporting shall be completed in line with table S4.1 following the completion of this improvement condition.</p>	3 months from the commencement date of IC5
IC6	<p>The operator shall submit a report for approval, an updated scheme of maintenance for the reedbed systems. The maintenance scheme shall include but not be limited to:</p> <ul style="list-style-type: none"> <li>• A weeding and harvesting schedule</li> <li>• Replanting schedule</li> <li>• De-silting schedule</li> </ul> <p>All measures shall be implemented as agreed in writing with the Environment Agency.</p>	09/12/2025

Table S1.4 Pre-operational measures for future development		
Reference	Operation	Pre-operational measures
PO1	Emissions to water via emission point W1	<p>Prior to the commencement of discharge from W1, the operator shall submit a written report to the Environment Agency for approval. The report must contain:</p> <ul style="list-style-type: none"> <li>• A H1 risk assessment demonstrating the levels of contaminants contained within the discharge and their impact upon the receiving waters.</li> <li>• Modelling where the H1 does not screen out the contaminants.</li> </ul>

Table S1.4 Pre-operational measures for future development		
Reference	Operation	Pre-operational measures
		<p>Where the results of H1 risk assessment and/or modelling shows that the emission limits in Table S3.1 are not likely to be achieved, the report must include proposals of further improvements to the treatment methods which shall be implemented to ensure that the emission meets the relevant limits.</p> <p>The operator must implement any proposals identified within the report and shall not commence discharging until it is demonstrated that all contaminants are below the emission limits in Table S3.1.</p>

## Schedule 2 – Waste types, raw materials and fuels

Table S2.1 Raw materials and fuels	
Raw materials and fuel description	Specification
Gas oil	Less than 0.1% sulphur

Table S2.2 Permitted waste types and quantities for treatment under AR1 and AR2 activities	
<b>Maximum quantity</b>	10,000m <sup>3</sup> per year of gully suckings 40,000m <sup>3</sup> per year of landfill leachate
<b>Waste code</b>	<b>Description</b>
<b>16</b>	<b>Wastes not otherwise specified in the list</b>
<b>16 10</b>	<b>aqueous liquid wastes destined for off-site treatment</b>
16 10 02	aqueous liquid wastes other than those mentioned in 16 10 01 restricted to run-off water from the adjacent composting process.
<b>19</b>	<b>Wastes from waste management facilities, off-site waste water treatment plants and the preparation of water intended for human consumption and water for industrial use</b>
<b>19 07</b>	<b>landfill leachate</b>
19 07 03	landfill leachate other than those mentioned in 19 07 02
<b>20</b>	<b>Municipal wastes (household waste and similar commercial, industrial and institutional wastes) including separately collected fractions</b>
<b>20 03</b>	<b>other municipal wastes</b>
20 03 03	street-cleaning residues

## Schedule 3 – Emissions and monitoring

Table S3.1 Point Source emissions to water (other than sewer) and land – emission limits and monitoring requirements						
Emission point ref. & location	Parameter	Source	Limit (incl. unit)	Reference Period	Monitoring frequency (6) (7)	Monitoring standard or method
W1 – Installation boundary and general site layout	Arsenic <sup>(4)</sup>	Effluent Treatment Plant – Final effluent discharge pit	0.1 mg/l	Spot	Daily	Various EN standards available (e.g. EN ISO 11885, EN ISO 17294-2, EN ISO 15586)
	Barium		0.14mg/l	Spot	Monthly	BS EN ISO 11885, SCA blue book 163. Or otherwise agreed with the Environment Agency
	Cadmium and its compounds expressed as cadmium (Total Cd) <sup>(4)</sup>		0.0006 mg/l	Spot	Daily	Various EN standards available (e.g. EN ISO 11885, EN ISO 17294-2, EN ISO 15586)
	Chromium <sup>(4)</sup>		0.01mg/l	Spot	Daily	Various EN standards available (e.g. EN ISO 11885, EN ISO 17294-2, EN ISO 15586)
	Cobalt		0.4 mg/l	Spot	Monthly	BS EN ISO 11885, SCA blue book 163. Or otherwise agreed with the Environment Agency
	Copper <sup>(4)</sup>		0.5 mg/l	Spot	Daily	Various EN standards available (e.g. EN ISO 11885, EN ISO 17294-2, EN ISO 15586)
	Lead <sup>(4)</sup>		0.14mg/l	Spot	Daily	Various EN standards available (e.g. EN ISO 11885, EN ISO 17294-2, EN ISO 15586)
	Mercury and its compounds expressed as mercury (Total Hg) <sup>(4)</sup>		0.0002m g/l	Spot	Daily	Various EN standards available (i.e. EN ISO 17852, EN ISO 12846)
	Nickel <sup>(4)</sup>		0.04mg/l	Spot	Daily	Various EN standards available (e.g. EN ISO 11885, EN ISO 17294-2, EN ISO 15586)
	Zinc <sup>(4)</sup>		0.4mg/l	Spot	Daily	Various EN standards available (e.g. EN ISO 11885, EN ISO 17294-2, EN ISO 15586)

Table S3.1 Point Source emissions to water (other than sewer) and land – emission limits and monitoring requirements						
Emission point ref. & location	Parameter	Source	Limit (incl. unit)	Reference Period	Monitoring frequency (6) (7)	Monitoring standard or method
	Manganese <sup>(4)</sup>		-	Spot	Daily	Various EN standards available (e.g. EN ISO 11885, EN ISO 17294-2, EN ISO 15586)
	Hexavalent chromium (Cr(VI)) <sup>(4)</sup>		-	Spot	Daily	Various EN standards available (i.e. EN ISO 10304-3, EN ISO 23913)
	Ammonia (Ammoniacal Nitrogen)		4mg/l	Spot	Monthly	BS EN ISO 11732, SCA blue book 48, BS 6068-2.11:1984 ISO 7150-1. Or otherwise agreed with the Environment Agency
	BOD		20mg/l	Spot	Monthly	BS EN 1899-1, BS EN 1899-2, SCA blue book 130. Or otherwise agreed with the Environment Agency
	Total suspended solids		50mg/l	Spot	Daily	EN 872
	Total Organic Carbon (TOC)		40mg/l	Spot	Daily	EN 1484
	Nitrate		10mg/l	Spot	Monthly	BS EN ISO 10304-1. Or otherwise agreed with the Environment Agency
	pH		6-9	Spot	Monthly	BS6068-2.50, ISO 10523. Or otherwise agreed with the Environment Agency
	Fats, oils and grease		No significant trace present	Spot	Daily when discharging	As agreed with the Environment Agency
	Suite of organic contaminants (TPH, PAH PCB pesticides)		-	Spot	Quarterly	As agreed with the Environment Agency
	Total daily volume of discharge		200m <sup>3</sup> /day	24 hour total	Continuous	MCERTS self monitoring of effluent flow scheme

Table S3.1 Point Source emissions to water (other than sewer) and land – emission limits and monitoring requirements						
Emission point ref. & location	Parameter	Source	Limit (incl. unit)	Reference Period	Monitoring frequency <sup>(6) (7)</sup>	Monitoring standard or method
	Total nitrogen (Total N)		60 mg/l <sup>(1) (2) (3)</sup>	Spot	Daily	EN 12260, EN ISO 11905-1
	Total phosphorus (Total P)		3 mg/l <sup>(5)</sup>	Spot	Daily	Various EN standards available (i.e. EN ISO 15681-1 and -2, EN ISO 6878, EN ISO 11885)
	Hydrocarbon oil index (HOI)		10 mg/l	Spot	Daily	EN ISO 9377-2
	Phenol index		0.3 mg/l	Spot	Daily	EN ISO 14402
	Free cyanide <sup>(4)</sup>		0.1 mg/l	Spot	Daily	Various EN standards available (i.e. EN ISO 14403-1 and -2)
	Adsorbable organically bound halogens (AOX) <sup>(4)</sup>		1 mg/l	Spot	Daily	EN ISO 9562
	PFOA <sup>(4)</sup>		-	Spot	6 monthly	-
	PFOS <sup>(4)</sup>		-	Spot	6 monthly	-
	Benzene, toluene, ethylbenzene, xylene (BTEX) <sup>(4)</sup>		-	Spot	Monthly	EN ISO 15680
<p>(1) The BAT-AEL may not apply when the temperature of the waste water is low (e.g. below 12 °C).</p> <p>(2) The BAT-AEL may not apply in the case of high chloride concentrations (e.g. above 10 g/l in the waste input).</p> <p>(3) The BAT-AEL only applies when biological treatment of waste water is used.</p> <p>(4) The monitoring only applies when the substance concerned is identified as relevant in the waste water inventory mentioned in BAT 3.</p> <p>(5) The BAT-AEL may not apply to plants treating drilling muds/cuttings.</p> <p>(6) Monitoring frequencies may be reduced if the emission levels are proven to be sufficiently stable.</p> <p>(7) In the case of batch discharge less frequent than the minimum monitoring frequency, monitoring is carried out once per batch.</p>						

Table S3.2 Process monitoring requirements				
Emission point reference or source or description of point of measurement	Parameter	Monitoring frequency	Monitoring standard or method	Other specifications
Groundwater monitoring	As agreed under IC5	As agreed under IC5	As agreed under IC5	As agreed under IC5



## Schedule 4 – Reporting

Parameters, for which reports shall be made, in accordance with conditions of this permit, are listed below.

<b>Table S4.1 Reporting of monitoring data</b>		
<b>Parameter</b>	<b>Reporting period</b>	<b>Period ends</b>
Point source emission to water As specified by schedule 3, table S3.1	Every 6 months	1 January, 1 July
Process monitoring of groundwater As specified by schedule 3, table S3.2	Annually	1 January

<b>Table S4.2: Annual production/treatment</b>	
<b>Parameter</b>	<b>Units</b>
Total sludge produced	Annually
Leachate waste stream	Annually
Gully sucking/street sweeper waste stream	Annually

<b>Table S4.3 Performance parameters</b>		
<b>Parameter</b>	<b>Frequency of assessment</b>	<b>Units</b>
Water usage	Annually	m <sup>3</sup>
Energy usage	Annually	MWh
Other performance parameters (Raw Material usage)	Annually	tonnes per production unit

<b>Table S4.4 Reporting forms</b>		
<b>Parameter</b>	<b>Reporting form</b>	<b>Form version number and date</b>
Point source emissions to water (other than sewer)	Emissions to Water Reporting Form, or other form as agreed in writing by the Environment Agency	Version 1, 08/03/2021
Process monitoring	Process Monitoring Form, or other form as agreed in writing by the Environment Agency	Version 1, 08/03/2021
Water usage	Water Usage Reporting Form, or other form as agreed in writing by the Environment Agency	Version 1, 08/03/2021
Energy usage	Energy Usage Reporting Form, or other form as agreed in writing by the Environment Agency	Version 1, 08/03/2021
Other performance parameters	Other Performance Parameters Reporting Form, or other form as agreed in writing by the Environment Agency	Version 1, 08/03/2021
Waste returns	E-waste return form	-

## Schedule 5 – Notification

These pages outline the information that the operator must provide.

Units of measurement used in information supplied under Part A and B requirements shall be appropriate to the circumstances of the emission. Where appropriate, a comparison should be made of actual emissions and authorised emission limits.

If any information is considered commercially confidential, it should be separated from non-confidential information, supplied on a separate sheet and accompanied by an application for commercial confidentiality under the provisions of the EP Regulations.

### Part A

Permit Number	
Name of operator	
Location of Facility	
Time and date of the detection	

<b>(a) Notification requirements for any malfunction, breakdown or failure of equipment or techniques, accident, or emission of a substance not controlled by an emission limit which has caused, is causing or may cause significant pollution</b>	
<b>To be notified within 24 hours of detection</b>	
Date and time of the event	
Reference or description of the location of the event	
Description of where any release into the environment took place	
Substances(s) potentially released	
Best estimate of the quantity or rate of release of substances	
Measures taken, or intended to be taken, to stop any emission	
Description of the failure or accident.	

<b>(b) Notification requirements for the breach of a limit</b>	
<b>To be notified within 24 hours of detection unless otherwise specified below</b>	
Emission point reference/ source	
Parameter(s)	
Limit	
Measured value and uncertainty	
Date and time of monitoring	

<b>(b) Notification requirements for the breach of a limit</b>	
<b>To be notified within 24 hours of detection unless otherwise specified below</b>	
Measures taken, or intended to be taken, to stop the emission	

<b>Time periods for notification following detection of a breach of a limit</b>	
<b>Parameter</b>	<b>Notification period</b>

<b>(c) Notification requirements for the breach of permit conditions not related to limits</b>	
<b>To be notified within 24 hours of detection</b>	
Condition breached	
Date, time and duration of breach	
Details of the permit breach i.e. what happened including impacts observed.	
Measures taken, or intended to be taken, to restore permit compliance.	

<b>(d) Notification requirements for the detection of any significant adverse environmental effect</b>	
<b>To be notified within 24 hours of detection</b>	
Description of where the effect on the environment was detected	
Substances(s) detected	
Concentrations of substances detected	
Date of monitoring/sampling	

## Part B – to be submitted as soon as practicable

Any more accurate information on the matters for notification under Part A.	
Measures taken, or intended to be taken, to prevent a recurrence of the incident	
Measures taken, or intended to be taken, to rectify, limit or prevent any pollution of the environment which has been or may be caused by the emission	
The dates of any unauthorised emissions from the facility in the preceding 24 months.	

Name*	
Post	
Signature	
Date	

\* authorised to sign on behalf of the operator

## Schedule 6 – Interpretation

“accident” means an accident that may result in pollution.

“application” means the application for this permit, together with any additional information supplied by the operator as part of the application and any response to a notice served under Schedule 5 to the EP Regulations.

“authorised officer” means any person authorised by the Environment Agency under section 108(1) of The Environment Act 1995 to exercise, in accordance with the terms of any such authorisation, any power specified in section 108(4) of that Act.

“disposal” means any of the operations provided for in Annex I to the Waste Framework Directive.

“emissions to land” includes emissions to groundwater.

“EP Regulations” means The Environmental Permitting (England and Wales) Regulations SI 2016 No.1154 and words and expressions used in this permit which are also used in the Regulations have the same meanings as in those Regulations.

“emissions of substances not controlled by emission limits” means emissions of substances to air, water or land from the activities, either from the emission points specified in schedule 3 or from other localised or diffuse sources, which are not controlled by an emission or background concentration limit.

“groundwater” means all water, which is below the surface of the ground in the saturation zone and in direct contact with the ground or subsoil.

“Industrial Emissions Directive” means DIRECTIVE 2010/75/EU OF THE EUROPEAN PARLIAMENT AND OF THE COUNCIL of 24 November 2010 on industrial emissions, as read in accordance with Schedule 1A to the Environmental Permitting (England and Wales) Regulations 2016.

“List of Wastes” means the list of wastes established by Commission Decision 2000/532/EC replacing Decision 94/3/EC establishing a list of wastes pursuant to Article 1(a) of Council Directive 75/442/EEC on waste and Council Decision 94/904/EC establishing a list of hazardous waste pursuant to Article 1(4) of Council Directive 91/689/EEC on hazardous waste.

“MCERTS” means the Environment Agency’s Monitoring Certification Scheme.

Pests” means Birds, Vermin and Insects.

“quarter” means a calendar year quarter commencing on 1 January, 1 April, 1 July or 1 October.

“Waste code” means the six digit code referable to a type of waste in accordance with the List of Wastes and in relation to hazardous waste, includes the asterisk.

“Waste Framework Directive” or “WFD” means Waste Framework Directive 2008/98/EC of the European Parliament and of the Council on waste, as read in accordance with Schedule 1A to the Environmental Permitting (England and Wales) Regulations 2016.

Where a minimum limit is set for any emission parameter, for example pH, reference to exceeding the limit shall mean that the parameter shall not be less than that limit.

Unless otherwise stated, any references in this permit to concentrations of substances in emissions into air means:

- in relation to emissions from combustion processes, the concentration in dry air at a temperature of 273K, at a pressure of 101.3 kPa and with an oxygen content of 3% dry for liquid and gaseous fuels other than gas engines or gas turbines, 6% dry for solid fuels; and/or
- in relation to emissions from gas engines or gas turbines, the concentration in dry air at a temperature of 273K, at a pressure of 101.3 kPa and with an oxygen content of 15% dry for liquid and gaseous fuels ; and/or

in relation to emissions from non-combustion sources, the concentration at a temperature of 273K and at a pressure of 101.3 kPa, with no correction for water vapour content “year” means calendar year ending 31 December.

“year” means calendar year ending 31 December.

## Schedule 7 – Site plan

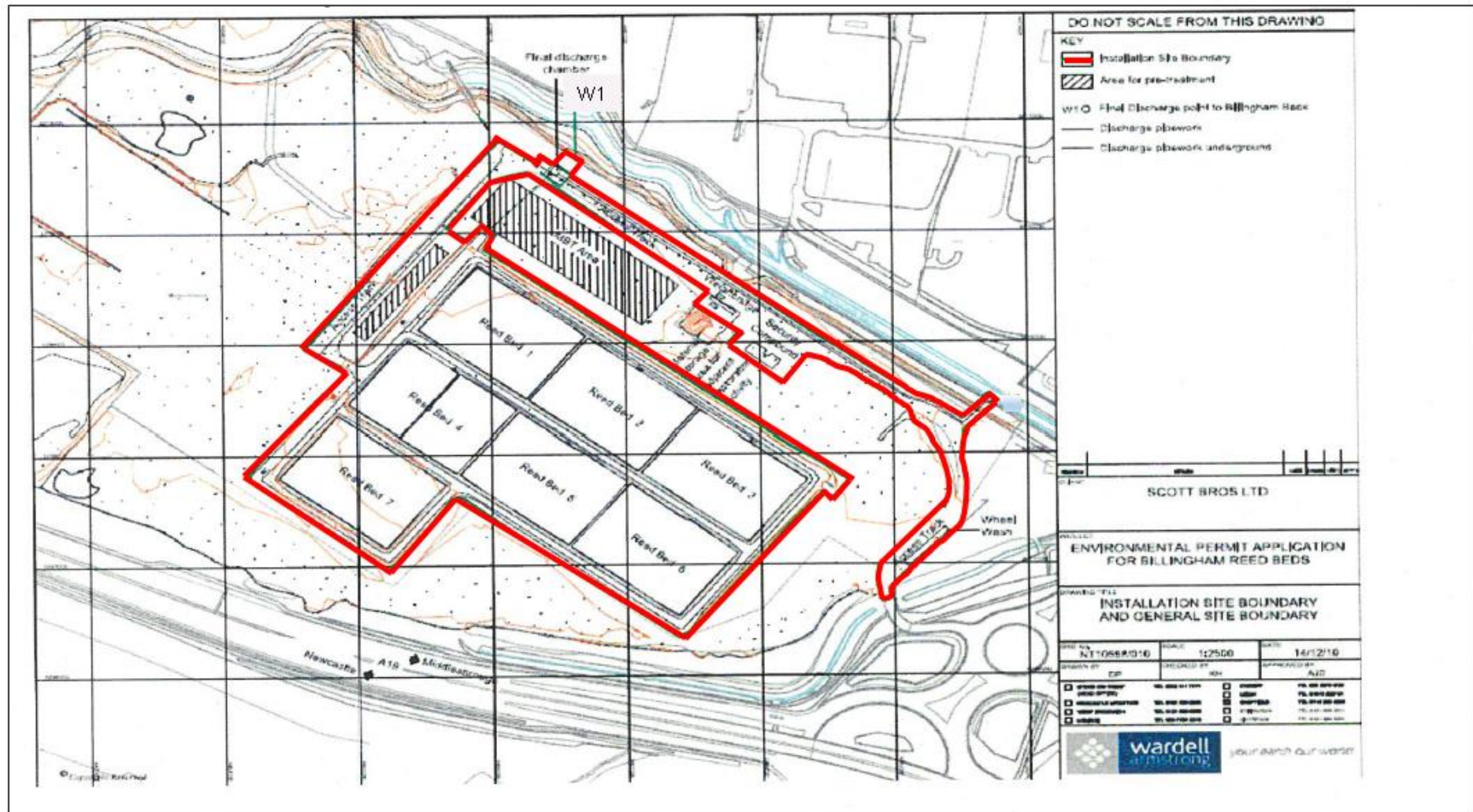

END OF PERMIT

Permit number  
EPR/AB1234CDJP3336HA