

## Waste Management Statement to support Sui Generis Apartments 11-13 Whiteladies Road, Bristol, BS8 1PB

21st July 2025

This Waste Management Statement has been based on the Bristol City Council's guide *Waste and Recycling Storage and Collection Facilities* (updated March 2022).

The proposed development is for Sui Generis apartments for students. All flats are generous in size have their own cooking facilities.

### The number of apartments to the development

The development will be for student apartments (planning class Sui Generis) and will provide 20 apartments; 18 x 1 bedrooms apartments / studios and 2 x 2 bedroom apartments.

### The size of the refuse and recycling bins

As there are over 15 apartments it is proposed there will be a communal store with the larger containers.

The container sizes will be in accordance with Table 4 of the BCC guidance document;

- 1100 litres - 1250w x 980d x 1470h
- 360 litres - 680w x 880d x 1100h
- 240 litres - 580w x 730d x 1060h
- 140 litres - 480w x 560 d x 1060h

### The number / mix of refuse and recycling bins

The waste and recycling requirements is based on the number of apartments.

Below is a table which outlines the required number of containers;

No. of bed spaces	22					
Material	Collection frequency	Container size used	Litres required per flat	Litres required	Number of bins	Bins rounded up
Plastic / cans	1	360	25	550	1.53	2
Glass	1	240	3	132	0.55	1
Paper	1	240	1	22	0.09	1
Card	1	1100	16	352	0.32	1
Food	1	140	2	44	0.32	1
Refuse	0.5	1100	39	858	0.78	1

### How will refuse and recycling be stored

Due to the sensitive nature of the Conservation Area all waste will be stored at the rear of the site in a dedicated refuse store. The plan for the bin store arrangement is contained in Appendix A. The waste store will be enclosed by a 1.8m slatted timber fence.

### How refuse and recycling is moved for collection day

The refuse and recycling bins will be moved to the holding area adjacent to the pavement on the days for collection by a member of staff. This is where existing waste for the offices is currently collected from (fig 1). Once the waste has been collected the bins will be returned promptly to the refuse store.

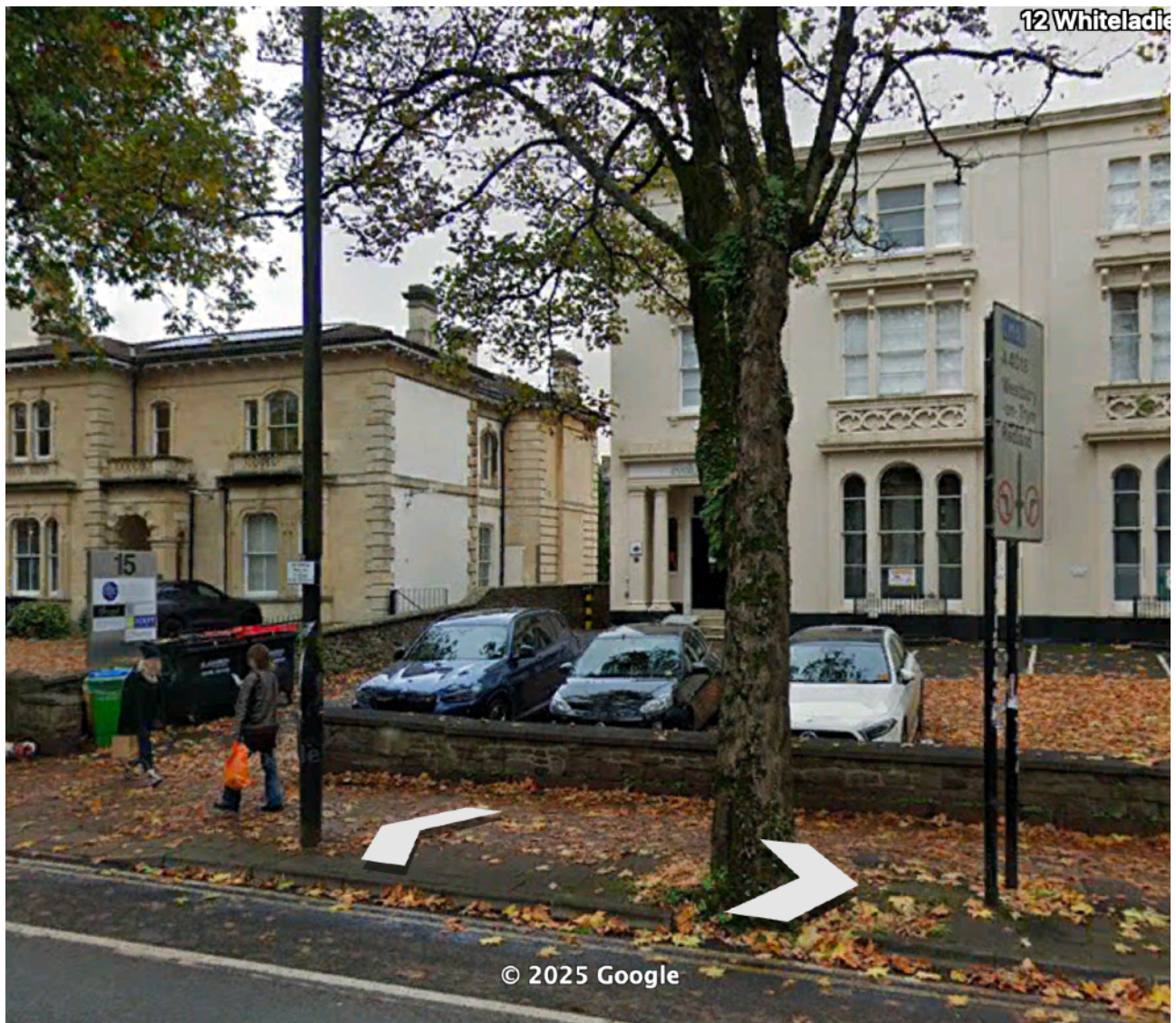
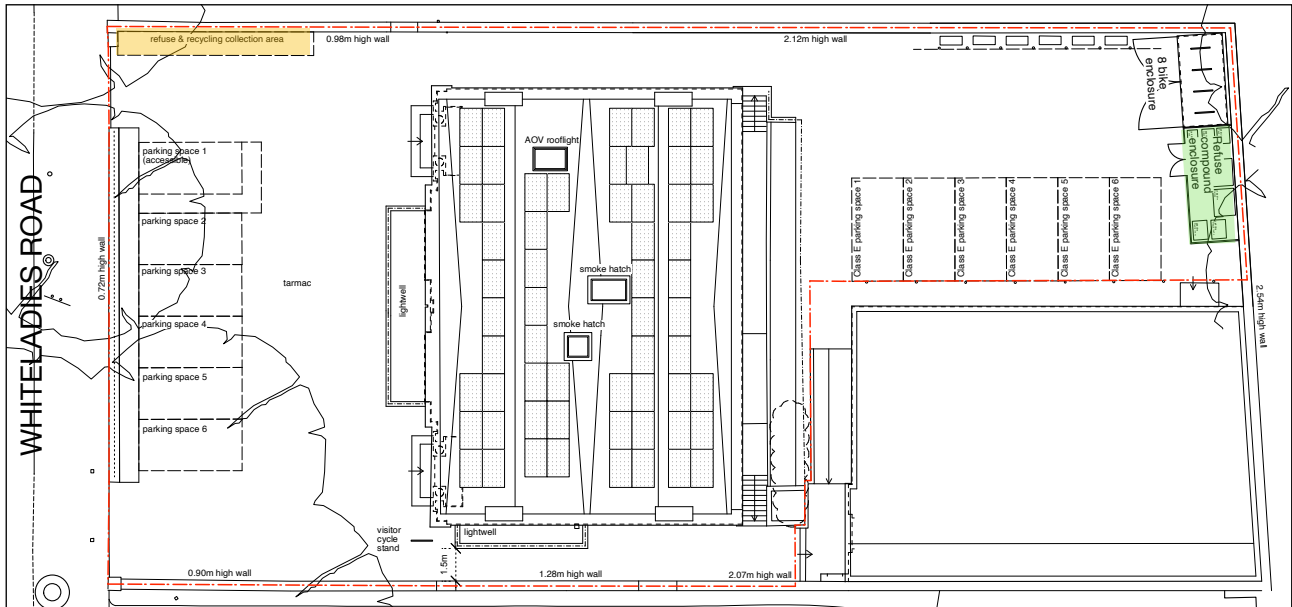

Figure 1: Existing waste collection day holding store to the front left of no. 11 (Google Earth)

# Appendix A

## Site wide waste storage plan

Below is the proposed site wide waste store plan with the refuse and recycling store indicated in green and the collection day holding point indicated in yellow. The collection point is as existing.



## Refuse & Recycling Centre

Below is a plan of the refuse and recycling area. This will be fenced off from the rear garden and will include the following;

- 1 no. 1100 litre bin for refuse
- 1 no. 1100 litre bin for cardboard
- 2 no. 360 litre bin for plastic and cans
- 1 no. 240 litre bin for glass
- 1 no. 240 litre bin for paper
- 1 no. 140 litre bin for food waste

