

Notice of part surrender, variation and consolidation with introductory note

The Environmental Permitting (England & Wales) Regulations 2016

University of Leeds
Spenneth Farm
Spenneth Common Lane
Tadcaster
Leeds
LS24 9NS

Part surrender application number

EPR/NP3132RD/S004

Variation and consolidation application number

EPR/NP3132RD/V003

Permit number

EPR/NP3132RD

Spenn Farm

Permit number EPR/NP3132RD

Introductory note

This introductory note does not form a part of the notice.

The following notice gives notice of the surrender in part and variation of an environmental permit.

The schedules specify the changes made to the permit as a result of the surrender in part, variation and consolidation.

Under the Environmental Permitting (England & Wales) Regulations 2016 (schedule 5, part 1, paragraph 19) a variation may comprise a consolidated permit reflecting the variations and a notice specifying the variations included in that consolidated permit.

Schedule 1 of the notice specifies the conditions that have been varied and schedule 2 comprises a consolidated permit which reflects the variations being made. All the conditions of the permit have been varied and are subject to the right of appeal. In addition, part of the installation has been surrendered, and this is reflected in the amended installation boundary as shown on the site plan in Schedule 7.

This part surrender and variation authorises the following changes:

- Installation boundary is amended on the site plan in schedule 7 to add an area of land to the north of the existing boundary, for a new slurry draw off point.
- Installation boundary is amended on the site plan in schedule 7 to remove areas of land not associated with the permitted activity, including removal of House 10, which were previously included in error.
- Addition of a bunded fuel tank to enable vehicles and equipment to be refuelled without leaving the biosecurity perimeter of the pig unit.

There will be no change to pig places or operating techniques as a result of this application.

Slurry will be transported to the area through an underground pipe; there will be no change to slurry management except for the change of location for the slurry draw off point. The area to be added consists of a pipe with lockable valve for slurry draw off (another lockable valve is present on the pipe, close to the slurry tanks), a below ground slurry reception pit/catch pit, and a concrete area large enough for a slurry tanker, constructed so that any spillage would drain back to the catch pit.

We consider that in reaching our decision to vary the permit we have taken into account all relevant considerations and legal requirements. We are satisfied that the permit will ensure that a high level of protection is provided for the environment and human health and that the activities will not give rise to any significant pollution of the environment or harm to human health.

The rest of the installation is unchanged and is operated as follows:

Spenn Farm is located approximately two kilometres south of Bramham, Tadcaster and it is centred on National Grid Reference SE 43266 40837. The unit is managed by the Estates Department of the University of Leeds. It uses a 3-week batch system which results in an estimated 92% annual occupation of the total pig places.

The indoor unit houses the following pigs on solid floor systems with straw and natural ventilation (house 1):

- 418 dry sows and served gilts;
- 39 maiden gilts; and
- 3 boars.

Passages in house 1 will be scraped at least twice per week and solid manure will be kept in a covered store on site prior to export.

The following pigs will be housed on fully slatted floors ('FSF') with frequent slurry removal:

- 140 farrowers;
- 2,340 weaners (7kg - 30kg) from the indoor breeding stock;
- 640 weaners (7kg - 15kg) from the outdoor breeding stock; and
- 3,120 production pigs (> 30kg).

House number 8 (which holds up to 640 weaners) has low velocity roof ventilation; the remaining houses using FSF are ventilated by high-speed roof fans. Ventilation fans on houses 6 and 7 have an efflux velocity of 7 m/s and the fans on houses 2, 3, 4 and 5 have an efflux velocity of 10 m/s.

The maximum depth of slurry in the FSF systems will be 800mm; slurry will be removed at least every 12 weeks (6 weeks in houses 2 and 8). The operator will use manure collection in water (listed technique in BAT Conclusion 30(a)(13)) to further reduce ammonia levels. Slurry is emptied when the pens are de-stocked, and the final wash water is then retained in the slurry channels.

Spennymoor Farm has three covered slurry tanks which provide in excess of 6 months' storage capacity.

Wash water and contaminated drainage from the tracks used to move pigs between houses is channelled to the slurry tanks. Uncontaminated surface water and roof water from the livestock housing is emitted to one of two soakaways.

Dry feed is stored in hoppers; there is no milling or mixing on site. The pigs' diet contains reduced levels of crude protein to minimise emissions. Feed trials will be undertaken at the site. The installation includes an ancillary house (number 11) which can be used for trial purposes (other than for farrowers). House 11 has solid floors and natural ventilation.

When identified, carcasses are moved into a sealed container and then removed from the site (usually within 24 hours).

A standby diesel generator with associated fuel storage is within the installation boundary. This is used for both the installation and non-permitted activities.

There are three Sites of Special Scientific Interest within 5 kilometres of the installation. There are also two Local Wildlife Sites and two Ancient Woodlands within 2 kilometres of the installation. An assessment of the impact of emissions was carried out previously and the installation is considered to have no adverse effect on the nature conservation sites.

We have reviewed the permit for this installation against the revised BAT Conclusions in the Intensive Farming BAT conclusions document dated February 2017. The permit conditions and schedules ensure the compliance of this installation with this BAT conclusions document.

This permit implements the requirements of the European Union Directive on Industrial Emissions.

The schedules specify the changes made to the permit.

The status log of a permit sets out the permitting history, including any changes to the permit reference number.

Status log of the permit		
Description	Date	Comments
Application EPR/NP3132RD/A001	Duly made 11/09/2019	Application for an intensive farming pig installation permit.
Response to Schedule 5 Notice dated 18/11/19 and subsequent requests for information	10/12/2019	Response confirming drainage measures and control of the facility.
	24/01/2020	Confirmation that the site will implement BAT and receipt of updated site plans and odour, noise and bioaerosol management plans.

Status log of the permit		
Description	Date	Comments
Permit determined EPR/NP3132RD	31/03/2020	Permit issued to University of Leeds.
Application EPR/NP3132RD/V002 (variation and consolidation)	Received 13/02/2025	Application to amend the installation boundary to include a new slurry draw off point and add a bunded fuel tank.
Application returned	03/03/2025	Not duly made.
Application EPR/NP3132RD/V003 (variation and consolidation)	Duly made 07/05/2025	Application to amend the installation boundary to include a new slurry draw off point and add a bunded fuel tank.
Part surrender application EPR/NP3132RD/S004	Duly made 22/05/2025	Application to remove areas of land not associated with the permitted activity.
Additional information received	11/06/2025	Revised site plan.
	24/06/2025	Confirmation regarding registered address.
Variation and part surrender determined	01/07/2025	Part surrender complete. Varied and consolidated permit issued in modern condition format.

End of introductory note

Notice of part surrender, variation and consolidation

The Environmental Permitting (England and Wales) Regulations 2016

The Environment Agency in exercise of its powers under regulation 20 and 25 of the Environmental Permitting (England and Wales) Regulations 2016 accepts the surrender in part, varies and consolidates

Permit number

EPR/NP3132RD

Issued to

University of Leeds ("the operator")

whose registered office is

11.72 E C Stoner Building

Leeds

LS2 9JT

company registration number **RC000658**

to operate an installation at

Spen Farm

Spen Common Lane

Tadcaster

Leeds

LS24 9NS

to the extent set out in the schedules.

The notice shall take effect from 01/07/2025

Name	Date
Stacey Tapsell	01/07/2025

Authorised on behalf of the Environment Agency

Schedule 1

All conditions have been varied and an area of land surrendered by the consolidated permit EPR/NP3132RD as a result of the application made by the operator.

Schedule 2 – consolidated permit

Consolidated permit issued as a separate document.

Permit

The Environmental Permitting (England and Wales) Regulations 2016

Permit number

EPR/NP3132RD

This is the consolidated permit referred to in the partial surrender, variation and consolidation notice for applications EPR/NP3132RD/V003 and EPR/NP3132RD/V004 authorising,

University of Leeds (“the operator”),

whose registered office is

11.72 E C Stoner Building

Leeds

LS2 9JT

company registration number RC000658

to operate an installation at

Spennard Farm

Spennard Common Lane

Tadcaster

Leeds

LS24 9NS

to the extent authorised by and subject to the conditions of this permit.

Name	Date
Stacey Tapsell	01/07/2025

Authorised on behalf of the Environment Agency

Conditions

1 Management

1.1 General management

- 1.1.1 The operator shall manage and operate the activities:
- (a) in accordance with a written management system that identifies and minimises risks of pollution, so far as is reasonably practicable, including those risks arising from operations, maintenance, accidents, incidents, non-conformances, closure and those drawn to the attention of the operator as a result of complaints; and
 - (b) using sufficient competent persons and resources.
- 1.1.2 Records demonstrating compliance with condition 1.1.1 shall be maintained.
- 1.1.3 Any person having duties that are or may be affected by the matters set out in this permit shall have convenient access to a copy of the permit.

1.2 Energy efficiency

- 1.2.1 The operator shall:
- (a) take appropriate measures to ensure that energy is used efficiently in the activities; and
 - (b) maintain records of fuel and energy consumption used in the activities.

1.3 Efficient use of raw materials

- 1.3.1 The operator shall:
- (a) take appropriate measures to ensure that raw materials and water are used efficiently in the activities; and
 - (b) maintain records of raw materials and water used in the activities.

1.4 Avoidance, recovery and disposal of wastes produced by the activities

- 1.4.1 The operator shall take appropriate measures to ensure that the waste hierarchy referred to in Article 4 of the Waste Framework Directive is applied to the generation of waste by the activities and that;
- (a) any waste generated by the activities is treated in accordance with the waste hierarchy referred to in Article 4 of the Waste Framework Directive; and
 - (b) where disposal is necessary, this is undertaken in a manner which minimises its impact on the environment.

2 Operations

2.1 Permitted activities

- 2.1.1 The only activities authorised by the permit are the activities specified in schedule 1 table S1.1 (the “activities”).

2.2 The site

- 2.2.1 The activities shall not extend beyond the site, being the land shown edged in green on the site plan at schedule 7 to this permit.

2.3 Operating techniques

- 2.3.1 The activities shall, subject to the conditions of this permit, be operated using the techniques and in the manner described in the documentation specified in schedule 1, table S1.2, unless otherwise agreed in writing by the Environment Agency.
- 2.3.2 If notified by the Environment Agency that the activities are giving rise to pollution, the operator shall submit to the Environment Agency for approval within the period specified, a revision of any plan or other documentation ("plan") specified in schedule 1, table S1.2 or otherwise required under this permit which identifies and minimises the risks of pollution relevant to that plan, and shall implement the approved revised plan in place of the original from the date of approval, unless otherwise agreed in writing by the Environment Agency.
- 2.3.3 The operator shall maintain and implement a system to record the number of animal places and animal movements.
- 2.3.4 The operator shall ensure that a diet formulation and nutritional strategy is used to reduce the total nitrogen and total phosphorus excreted.
- 2.3.5 The operator shall take appropriate measures in disposal or recovery of solid manure or slurry to prevent, or where this is not practicable, to minimise pollution.
- 2.3.6 Any raw materials or fuels listed in schedule 2 table S2.1 shall conform to the specifications set out in that table.
- 2.3.7 The operator shall ensure that where waste produced by the activities is sent to a relevant waste operation, that operation is provided with the following information, prior to the receipt of the waste:
- (a) the nature of the process producing the waste;
 - (b) the composition of the waste;
 - (c) the handling requirements of the waste;
 - (d) the hazardous property associated with the waste, if applicable; and
 - (e) the waste code of the waste.

3 Emissions and monitoring

3.1 Emissions to water, air or land

- 3.1.1 There shall be no point source emissions to water, air or land except from the sources and emission points specified in tables S3.1 and S3.2.
- 3.1.2 The limits given in schedule 3 shall not be exceeded.
- 3.1.3 Periodic monitoring shall be carried out at least once every 5 years for groundwater and 10 years for soil, unless such monitoring is based on a systematic appraisal of the risk of contamination.

3.2 Emissions of substances not controlled by emission limits

- 3.2.1 Emissions of substances not controlled by emission limits shall not cause pollution. The operator shall not be taken to have breached this condition if appropriate measures, including, but not limited to, those specified in any approved emissions management plan, have been taken to prevent or where that is not practicable, to minimise, those emissions.

3.2.2 The operator shall:

- (a) if notified by the Environment Agency that the activities are giving rise to pollution, submit to the Environment Agency for approval within the period specified, an emissions management plan which identifies and minimises the risks of pollution from emissions of substances not controlled by emission limits; and
- (b) implement the approved emissions management plan, from the date of approval, unless otherwise agreed in writing by the Environment Agency.

3.2.3 All liquids in containers, whose emission to water or land could cause pollution, shall be provided with secondary containment, unless the operator has used other appropriate measures to prevent or where that is not practicable, to minimise, leakage and spillage from the primary container.

3.3 Odour

3.3.1 Emissions from the activities shall be free from odour at levels likely to cause pollution outside the site, as perceived by an authorised officer of the Environment Agency, unless the operator has used appropriate measures, including, but not limited to, those specified in any approved odour management plan, to prevent or where that is not practicable to minimise the odour.

3.4 Noise and vibration

3.4.1 Emissions from the activities shall be free from noise and vibration at levels likely to cause pollution outside the site, as perceived by an authorised officer of the Environment Agency, unless the operator has used appropriate measures, including, but not limited to, those specified in any approved noise and vibration management plan to prevent or where that is not practicable to minimise the noise and vibration.

3.5 Monitoring

3.5.1 The operator shall, unless otherwise agreed in writing by the Environment Agency, undertake the monitoring specified in the following tables in schedule 3 to this permit:

- (a) point source emissions specified in tables S3.1 and S3.2; and
- (b) process monitoring specified in table S3.3.

3.5.2 The operator shall maintain records of all monitoring required by this permit including records of the taking and analysis of samples, instrument measurements (periodic and continual), calibrations, examinations, tests and surveys and any assessment or evaluation made on the basis of such data.

3.5.3 Monitoring equipment, techniques, personnel and organisations employed for the emissions monitoring programme and the environmental or other monitoring specified in condition 3.5.1 shall have either MCERTS certification or MCERTS accreditation (as appropriate), where available, unless otherwise agreed in writing by the Environment Agency.

3.6 Pests

3.6.1 The activities shall not give rise to the presence of pests which are likely to cause pollution, hazard or annoyance outside the boundary of the site. The operator shall not be taken to have breached this condition if appropriate measures, including, but not limited to, those specified in any approved pests management plan, have been taken to prevent or where that is not practicable, to minimise the presence of pests on the site.

3.6.2 The operator shall:

- (a) if notified by the Environment Agency, submit to the Environment Agency for approval within the period specified, a pests management plan which identifies and minimises risks of pollution, hazard or annoyance from pests; and

- (b) implement the pests management plan, from the date of approval, unless otherwise agreed in writing by the Environment Agency.

4 Information

4.1 Records

- 4.1.1 All records required to be made by schedules 3, 4 and 5 to this permit shall:
 - (a) be legible;
 - (b) be made as soon as reasonably practicable;
 - (c) if amended, be amended in such a way that the original and any subsequent amendments remain legible, or are capable of retrieval; and
 - (d) be retained, unless otherwise agreed in writing by the Environment Agency, for at least 6 years from the date when the records were made, or in the case of the following records until permit surrender:
 - (i) off-site environmental effects; and
 - (ii) matters which affect the condition of the land and groundwater.
- 4.1.2 The operator shall maintain convenient access, in either electronic or hard copy, to the records, plans and management system required to be maintained by this permit.

4.2 Reporting

- 4.2.1 The operator shall send all reports and notifications required by the permit to the Environment Agency using the contact details supplied in writing by the Environment Agency.
- 4.2.2 For the following activities referenced in schedule 1, table S1.1 a report or reports on the performance of the activities over the previous year shall be submitted to the Environment Agency by 31 January (or other date agreed in writing by the Environment Agency) each year. The report(s) shall include as a minimum:
 - (a) a review of the results of the monitoring and assessment carried out in accordance with the permit including an interpretive review of that data.
- 4.2.3 Within 28 days of the end of the reporting period the operator shall, unless otherwise agreed in writing by the Environment Agency, submit reports of the monitoring and assessment carried out in accordance with the conditions of this permit, as follows:
 - (a) in respect of the parameters and emission points specified in schedule 4 table S4.1;
 - (b) for the reporting periods specified in schedule 4 table S4.1 and using the forms specified in schedule 4 table S4.2; and
 - (c) giving the information from such results and assessments as may be required by the forms specified in those tables.
- 4.2.4 The operator shall, unless notice under this condition has been served within the preceding four years, submit to the Environment Agency, within six months of receipt of a written notice, a report assessing whether there are other appropriate measures that could be taken to prevent, or where that is not practicable, to minimise pollution.

4.3 Notifications

- 4.3.1 In the event:
 - (a) that the operation of the activities gives rise to an incident or accident which significantly affects or may significantly affect the environment, the operator must immediately:-

- (i) inform the Environment Agency,
 - (ii) take the measures necessary to limit the environmental consequences of such an incident or accident, and
 - (iii) take the measures necessary to prevent further possible incidents or accidents; and
- (b) of a breach of any permit condition the operator must immediately:-
- (i) inform the Environment Agency, and
 - (ii) take the measures necessary to ensure that compliance is restored within the shortest possible time;
- (c) of a breach of permit condition which poses an immediate danger to human health or threatens to cause an immediate significant adverse effect on the environment, the operator must immediately suspend the operation of the activities or the relevant part of it until compliance with the permit conditions has been restored.

4.3.2 Any information provided under condition 4.3.1 shall be confirmed by sending the information listed in schedule 5 to this permit within the time period specified in that schedule.

4.3.3 Where the Environment Agency has requested in writing that it shall be notified when the operator is to undertake monitoring and/or spot sampling, the operator shall inform the Environment Agency when the relevant monitoring and/or spot sampling is to take place. The operator shall provide this information to the Environment Agency at least 14 days before the date the monitoring is to be undertaken.

4.3.4 The Environment Agency shall be notified within 14 days of the occurrence of the following matters, except where such disclosure is prohibited by Stock Exchange rules:

Where the operator is a registered company:

- (a) any change in the operator's trading name, registered name or registered office address; and
- (b) any steps taken with a view to the operator going into administration, entering into a company voluntary arrangement or being wound up.

Where the operator is a corporate body other than a registered company:

- (c) any change in the operator's name or address; and
- (d) any steps taken with a view to the dissolution of the operator.

In any other case:

- (e) the death of any of the named operators (where the operator consists of more than one named individual);
- (f) any change in the operator's name(s) or address(es); and
- (g) any steps taken with a view to the operator, or any one of them, going into bankruptcy, entering into a composition or arrangement with creditors, or, in the case of them being in a partnership, dissolving the partnership.

4.3.5 Where the operator proposes to make a change in the nature or functioning, or an extension of the activities, which may have consequences for the environment and the change is not otherwise the subject of an application for approval under the Regulations or this permit:

- (a) the Environment Agency shall be notified at least 14 days before making the change; and
- (b) the notification shall contain a description of the proposed change in operation.

4.3.6 The Environment Agency shall be given at least 14 days' notice before implementation of any part of the site closure plan.

4.4 Interpretation

- 4.4.1 In this permit the expressions listed in schedule 6 shall have the meaning given in that schedule.
- 4.4.2 In this permit references to reports and notifications mean written reports and notifications, except where reference is made to notification being made “immediately”, in which case it may be provided by telephone.

Schedule 1 – Operations

Table S1.1 Activities		
Activity listed in Schedule 1 of the EP Regulations	Description of specified activity	Limits of specified activity
Section 6.9 A(1)(a)(ii) Rearing of pigs intensively in an installation with more than 2,000 places for production pigs (over 30 kg)	Rearing of pigs intensively in an installation with a capacity for 3,162 production pig (over 30 kg) places, including 3 boars.	Keeping of production pigs and not served gilts (over 30 kg), including from receipt of raw materials and fuels on to the site to pigs and associated wastes being removed from site.
Directly Associated Activity	Description of specified activity	Limits of specified activity
Keeping sows (below the threshold)	Rearing of breeding stock in an installation with a capacity for 558 sow places.	Keeping of sows and served gilts for production of piglets, from receipt of raw materials and fuels on to the site to removal of sows and associated wastes from site.
Rearing of pigs (up to 30 kg)	Rearing of 2,980 pigs to 30 kg.	From weaning of pigs and receipt of raw materials and fuels on to the site up to pigs reaching 30 kg and removal of pigs and associated wastes from site.

Table S1.2 Operating techniques		
Description	Parts	Date received
Application EPR/NP3132RD/A001	Responses to sections 8a, 8g, 8h and 8i of the Part B3.5 application form and section 6 of the supporting documentation ('Technical standards').	28/08/2019
	Email regarding emission factors and document titled 'Housing and drainage review'.	10/09/2019
	Email responses to requests for further information regarding the housing systems on site.	11/09/2019
Response to Schedule 5 Notice dated 18/11/19 and subsequent request on 24/12/19 for further information	<ul style="list-style-type: none"> Confirmation of meeting BAT Conclusions. Layout, drainage and emission point site plans (Site Plans B and C). Odour, noise and dust and bioaerosol management plans. 	24/01/2020
Application EPR/NP3132RD/V003 (variation and consolidation)	Responses to Part C3.5 of the application form and referenced supporting documentation, including: <ul style="list-style-type: none"> Revised Site Plan A (site layout plan). 	Duly made 07/05/2025
Part surrender application EPR/NP3132RD/V004	Response to Part E2 of the application form and referenced supporting documentation, including: <ul style="list-style-type: none"> Site condition report Site plan showing areas of land to be removed. 	Duly made 22/05/2025
Response to request for information dated 06/06/2025	Response providing a revised site plan.	11/06/2025

Schedule 2 – Waste types, raw materials and fuels

Table S2.1 Raw materials and fuels	
Raw materials and fuel description	Specification
---	---

Schedule 3 – Emissions and monitoring

Table S3.1 Point source emissions to air – emission limits and monitoring requirements						
Emission point ref. & location	Source	Parameter	Limit (incl. unit)	Reference period	Monitoring frequency	Monitoring standard or method
High velocity roof fan outlets on houses 2, 3, 4, 5, 6, 7 and 11, as shown on Site plan C in application EPR/NP3132RD/A001 received 24/01/2020	Houses 2, 3, 4, 5, 6, 7 and 11	---	---	---	---	---
Side fan outlets on house 8, as shown on Site plan C in application EPR/NP3132RD/A001 received 24/01/2020	House 8	---	---	---	---	---
Natural ventilation on house 1, as shown on Site plan C in application EPR/NP3132RD/A001 received 24/01/2020	House 1	---	---	---	---	---
Exhaust from standby generator, as shown on Site plan C in application EPR/NP3132RD/A001 received 24/01/2020	Standby generator	---	---	---	---	---
Vent from two diesel tanks, as shown on Site plan C in application EPR/NP3132RD/A001 received 24/01/2020	Diesel tanks	---	---	---	---	---

Table S3.2 Point Source emissions to water (other than sewer) and land – emission limits and monitoring requirements						
Emission point ref. & location	Source	Parameter	Limit (incl. unit)	Reference period	Monitoring frequency	Monitoring standard or method
Outlet to soakaways as indicated on Site Plan B in application EPR/NP3132RD/A001 received 24/01/2020	Roof water and uncontaminated water draining from the yard areas (excluding all times yards are contaminated e.g. catching, mucking out or washing)	---	---	---	---	---

Table S3.3 Process monitoring requirements				
Emission point reference or source or description of point of measurement	Parameter	Limit (incl. unit)	Monitoring frequency	Monitoring standard or method
Weaners (rearing of pigs up to 30 kg) in houses 3 and 8, as	Kg N excreted/ animal place/ year	4.0 kg N/animal place/year	Annually	Using a mass balance of nitrogen based on the feed intake, dietary content of crude protein and animal performance or

Table S3.3 Process monitoring requirements				
Emission point reference or source or description of point of measurement	Parameter	Limit (incl. unit)	Monitoring frequency	Monitoring standard or method
shown on the site plan in Schedule 7				Estimation by using manure analysis for total nitrogen content
	Kg P ₂ O ₅ excreted/ animal place/ year	2.2 kg P ₂ O ₅ /animal place/year	Annually	Using a mass balance of phosphorus based on the feed intake, dietary content of crude protein, total phosphorus and animal performance or Estimation by using manure analysis for total phosphorus content
Weaners (rearing of pigs up to 30 kg) on fully slatted floors, in houses 3 and 8, as shown on the site plan in Schedule 7 (FSF)	Kg NH ₃ /animal place/year	0.53 kg NH ₃ /animal place/year	Annually	Estimation using emission factors
Fattening pigs (production pigs over 30 kg, including maiden gilts) in houses 1, 4, 5, 6 and 7, as shown on the site plan in Schedule 7	Kg N excreted/ animal place/ year	13.0 kg N/animal place/year	Annually	Using a mass balance of nitrogen based on the feed intake, dietary content of crude protein and animal performance; or Estimation by using manure analysis for total nitrogen content.
	Kg P ₂ O ₅ excreted/ animal place/ year	5.4kg P ₂ O ₅ /animal place/year	Annually	Using a mass balance of phosphorus based on the feed intake, dietary content of crude protein, total phosphorus and animal performance; or Estimation by using manure analysis for total phosphorus content.
Fattening pigs (production pigs over 30 kg) on fully slatted floors in houses 4, 5, 6 and 7, as shown on the site plan in Schedule 7	Kg NH ₃ /animal place/year	2.6 kg NH ₃ /animal place/year	Annually	Estimation using emission factors
Fattening pigs (production pigs over 30 kg, on solid floors in house 1, as shown on the site plan in Schedule 7	Kg NH ₃ /animal place/year	5.65 kg NH ₃ /animal place/year	Annually	Estimation using emission factors
Farrowing sows in house 2 (including suckling piglets) as	Kg N excreted/ animal place/ year	30.0 kg N/animal place/year	Annually	Using a mass balance of nitrogen based on the feed intake, dietary content of crude protein, and animal performance; or

Table S3.3 Process monitoring requirements				
Emission point reference or source or description of point of measurement	Parameter	Limit (incl. unit)	Monitoring frequency	Monitoring standard or method
shown on the site plan in Schedule 7				Estimation by using manure analysis for total nitrogen content.
	Kg P ₂ O ₅ excreted/ animal place/ year	15 kg P ₂ O ₅ /animal place/year	Annually	Using a mass balance of phosphorus based on the feed intake, dietary content of crude protein, total phosphorus and animal performance; or Estimation by using manure analysis for total phosphorus content.
Farrowing sows on fully slatted floors, in house 2 (including suckling piglets), as shown on the site plan in Schedule 7	Kg NH ₃ /animal place/year	5.6 kg NH ₃ /animal place/year	Annually	Estimation using emission factors
Mating and gestating sows (dry sows and served gilts) in house 1, as shown on the site plan in Schedule 7	Kg N excreted/ animal place/ year	30.0 kg N/animal place/year	Annually	Using a mass balance of nitrogen based on the feed intake, dietary content of crude protein, and animal performance; or Estimation by using manure analysis for total nitrogen content.
	Kg P ₂ O ₅ excreted/ animal place/ year	15 kg P ₂ O ₅ /animal place/year	Annually	Using a mass balance of phosphorus based on the feed intake, dietary content of crude protein, total phosphorus and animal performance; or Estimation by using manure analysis for total phosphorus content.
Mating and gestating sows (dry sows and served gilts) on solid floors in house 1, as shown on the site plan in Schedule 7	Kg NH ₃ /animal place/year	5.2 kg NH ₃ /animal place/year	Annually	Estimation using emission factors
Boars	Ammonia	n/a	Annually	Estimation using emission factors
Livestock houses 1 – 8, as shown on the site plan in Schedule 7	Dust	N/A	Annually	Estimation using emission factors

Schedule 4 – Reporting

Parameters, for which reports shall be made, in accordance with conditions of this permit, are listed below.

Table S4.1 Reporting of monitoring data			
Parameter	Emission or monitoring point/reference	Reporting period	Period begins
Process monitoring Parameters as required by condition 3.5.1	---	Every 12 months	1 January

Table S4.2 Reporting forms		
Media/parameter	Reporting format	Date of form
Kg NH ₃ /animal place/year	Form Process Monitoring 1 or other form as agreed in writing by the Environment Agency	31/03/2020
Kg N excreted/animal place/year		
Kg P ₂ O ₅ excreted/animal place/year		
Dust atmospheric mass emission		

Schedule 5 – Notification

These pages outline the information that the operator must provide.

Units of measurement used in information supplied under Part A and B requirements shall be appropriate to the circumstances of the emission. Where appropriate, a comparison should be made of actual emissions and authorised emission limits.

If any information is considered commercially confidential, it should be separated from non-confidential information, supplied on a separate sheet and accompanied by an application for commercial confidentiality under the provisions of the EP Regulations.

Part A

Permit number	
Name of operator	
Location of facility	
Time and date of the detection	

(a) Notification requirements for any malfunction, breakdown or failure of equipment or techniques, accident, or emission of a substance not controlled by an emission limit which has caused, is causing or may cause significant pollution	
To be notified within 24 hours of detection	
Date and time of the event	
Reference or description of the location of the event	
Description of where any release into the environment took place	
Substances(s) potentially released	
Best estimate of the quantity or rate of release of substances	
Measures taken, or intended to be taken, to stop any emission	
Description of the failure or accident.	

(b) Notification requirements for the breach of a limit	
To be notified within 24 hours of detection	
Emission point reference/ source	
Parameter(s)	
Limit	
Measured value and uncertainty	
Date and time of monitoring	
Measures taken, or intended to be taken, to stop the emission	

Time periods for notification following detection of a breach of a limit	
Parameter	Notification period

(c) Notification requirements for the breach of permit conditions not related to limits	
To be notified within 24 hours of detection	
Condition breached	
Date, time and duration of breach	
Details of the permit breach i.e. what happened including impacts observed.	
Measures taken, or intended to be taken, to restore permit compliance.	

(d) Notification requirements for the detection of any significant adverse environmental effect	
To be notified within 24 hours of detection	
Description of where the effect on the environment was detected	
Substances(s) detected	
Concentrations of substances detected	
Date of monitoring/sampling	

Part B – to be submitted as soon as practicable

Any more accurate information on the matters for notification under Part A.	
Measures taken, or intended to be taken, to prevent a recurrence of the incident	
Measures taken, or intended to be taken, to rectify, limit or prevent any pollution of the environment which has been or may be caused by the emission	
The dates of any unauthorised emissions from the facility in the preceding 24 months.	
Name*	
Post	
Signature	
Date	

* authorised to sign on behalf of the operator

Schedule 6 – Interpretation

“accident” means an accident that may result in pollution.

“application” means the application for this permit, together with any additional information supplied by the operator as part of the application and any response to a notice served under Schedule 5 to the EP Regulations.

“authorised officer” means any person authorised by the Environment Agency under section 108(1) of The Environment Act 1995 to exercise, in accordance with the terms of any such authorisation, any power specified in section 108(4) of that Act.

“building” means a construction that has the objective of providing sheltering cover and minimising emissions of noise, particulate matter, odour and litter.

“emissions to land” includes emissions to groundwater.

“emissions of substances not controlled by emission limits” means emissions of substances to air, water or land from the activities, either from the emission points specified in schedule 3 or from other localised or diffuse sources, which are not controlled by an emission limit.

“EP Regulations” means The Environmental Permitting (England and Wales) Regulations SI 2016 No.1154 and words and expressions used in this permit which are also used in the Regulations have the same meanings as in those Regulations.

“Existing housing” means housing that is not defined as new housing.

“groundwater” means all water, which is below the surface of the ground in the saturation zone and in direct contact with the ground or subsoil.

“Hazardous property” has the meaning in Annex III of the Waste Framework Directive.

“Industrial Emissions Directive” means DIRECTIVE 2010/75/EU OF THE EUROPEAN PARLIAMENT AND OF THE COUNCIL of 24 November 2010 on industrial emissions, as read in accordance with Schedule 1A to the Environmental Permitting (England and Wales) Regulations 2016.

“List of Wastes” means the list of wastes established by Commission Decision 2000/532/EC replacing Decision 94/3/EC establishing a list of wastes pursuant to Article 1(a) of Council Directive 75/442/EEC on waste and Council Decision 94/904/EC establishing a list of hazardous waste pursuant to Article 1(4) of Council Directive 91/689/EEC on hazardous waste, as amended from time to time.

“Manure and slurry” have the following meaning:

- Manures may be either slurries or solid manures.
- Slurries consist of excreta produced by livestock whilst in a yard or building mixed with rainwater and wash water and, in some cases, waste bedding and feed. Slurries can be pumped or discharged by gravity.
- Slurry includes duck effluent, seepage from manure and wash water.
- Solid manures include farmyard manure (FYM) and comprise material from straw-based housing systems, excreta with lots of straw/sawdust/woodchips in it, or solids from mechanical separators.
- Most poultry systems produce solid manure (litter).
- Solid manure can generally be stacked.

“New housing” means housing first permitted at the installation following the publication of the intensive rearing of poultry or pigs (IRPP) best available techniques (BAT) conclusions document dated 21/02/17, or a complete replacement of existing housing after 21/02/17.

“MCERTS” means the Environment Agency’s Monitoring Certification Scheme.

“pests” means Birds, Vermin and Insects.

“Waste code” means the six digit code referable to a type of waste in accordance with the List of Wastes and in relation to hazardous waste, includes the asterisk

“Waste Framework Directive” or “WFD” means Waste Framework Directive 2008/98/EC of the European Parliament and of the Council on waste.

“year” means calendar year ending 31 December.

Schedule 7 – Site plan

Site plan - showing installation boundary as referred to in condition 2.2.1.



Crown Copyright and Database Rights 2025 OS AC0000807064.

Site layout plan

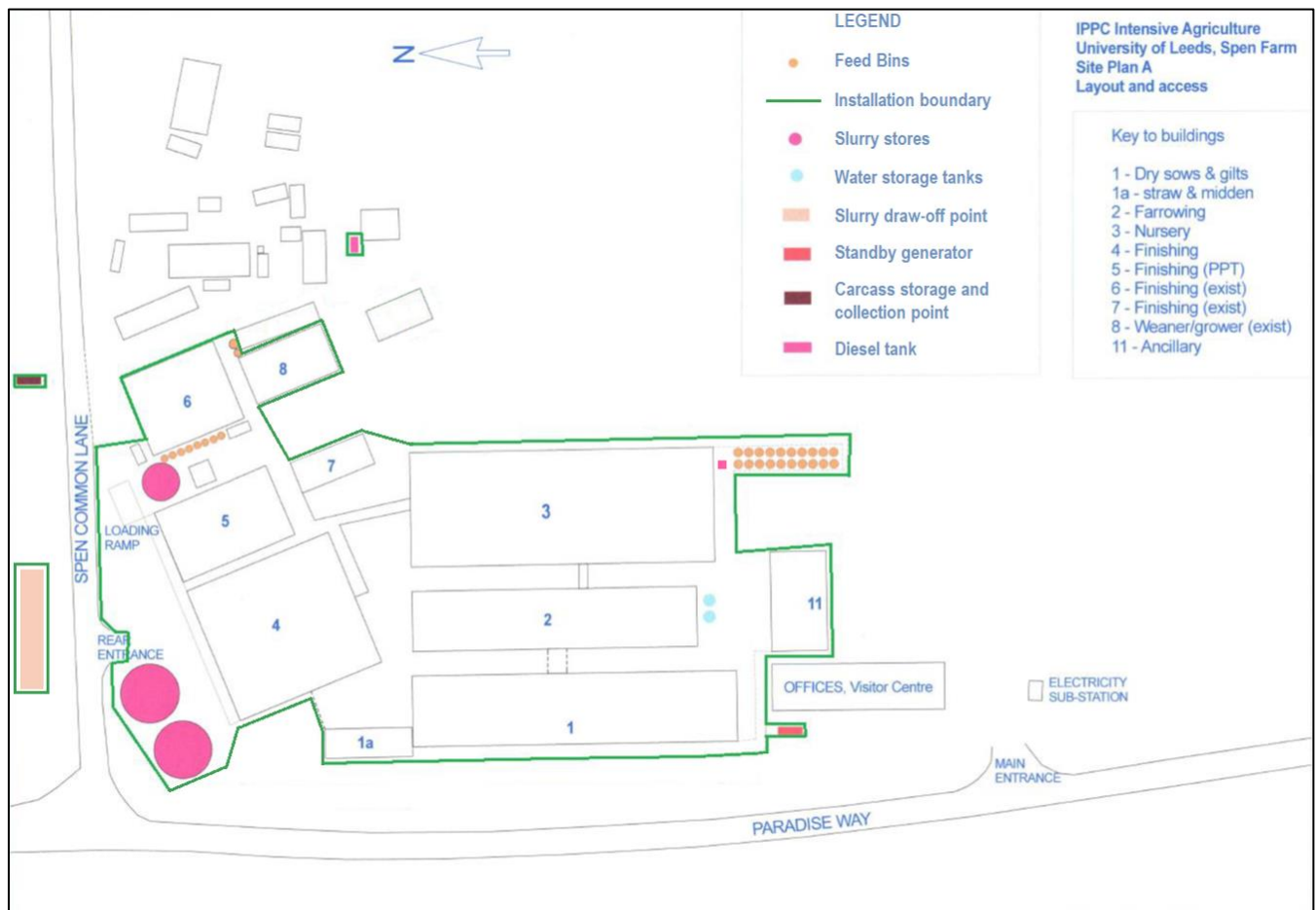

END OF PERMIT