



UNIVERSAL DESTINATIONS & EXPERIENCES UK PROJECT

Former Kempston Hardwick Brickworks and adjoining land, Bedford Parameter Plan - Active Travel Plan

Report reference: 1.12.0

Revision number: 00

Date: June 2025



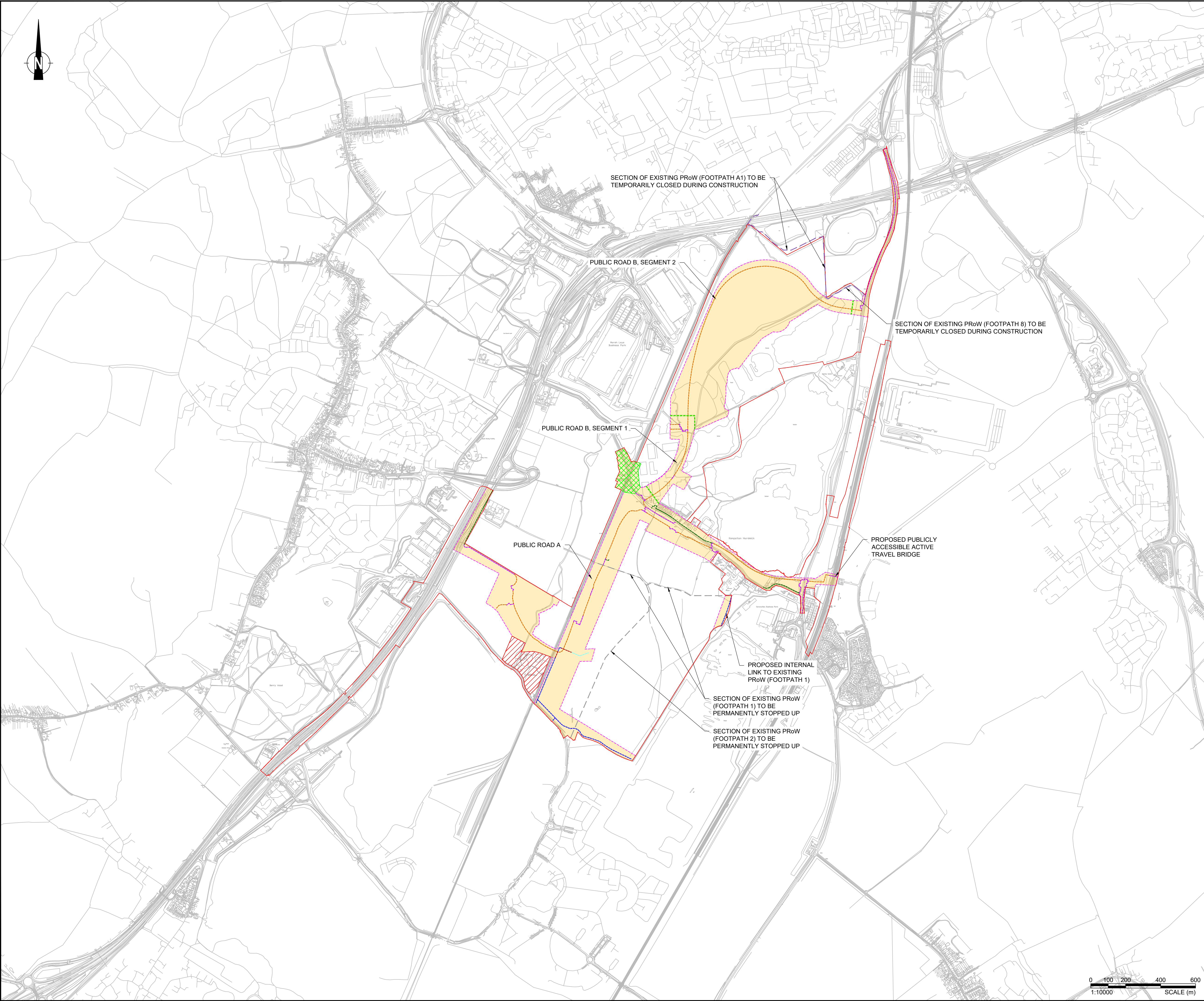

- LEGEND**
- SITE BOUNDARY
 - EXCLUDED FROM SITE BOUNDARY
 - PROPOSED ACTIVE TRAVEL LIMIT OF DEVIATION
 - MANOR ROAD LEVEL CROSSING PROPOSALS
 - EXISTING ROUTE FOR PEDESTRIANS (FOOTWAY)
 - PROPOSED SHARED ROUTE FOR PEDESTRIANS AND CYCLISTS (FOOTWAY / CYCLEWAY) TO BE OFFERED UP FOR ADOPTION TO BEDFORD BOROUGH COUNCIL
 - PROPOSED ROUTE FOR PEDESTRIANS (FOOTWAY) TO BE OFFERED UP FOR ADOPTION TO BEDFORD BOROUGH COUNCIL
 - PROPOSED SEGREGATED ROUTE FOR PEDESTRIANS AND CYCLISTS ADJACENT TO ADOPTED ROADWAY TO BE OFFERED UP FOR ADOPTION TO BEDFORD BOROUGH COUNCIL
 - PROPOSED SHARED ROUTE FOR PEDESTRIANS AND CYCLISTS (FOOTWAY / CYCLEWAY) TO REMAIN IN PRIVATE CONTROL
 - PROPOSED SHARED ROUTE FOR PEDESTRIANS AND CYCLISTS (FOOTWAY / CYCLEWAY) UNDERPASS TO REMAIN IN PRIVATE CONTROL
 - PROPOSED ROUTE FOR PEDESTRIANS (FOOTWAY) TO REMAIN IN PRIVATE CONTROL
 - EXISTING PUBLIC RIGHT OF WAY (PrOw) TO BE PERMANENTLY STOPPED UP
 - EXISTING PUBLIC RIGHT OF WAY (PrOw) TO BE TEMPORARILY CLOSED DURING CONSTRUCTION
 - PUBLIC ROAD B SPLIT LINE

00	FIRST ISSUE	MY	LB	MS	26.06.25
Rev	Details	Drawn	Checked	Auth	Date
Site Address: FORMER KEMPSTON HARDWICK BRICKWORKS AND ADJOINING LAND, BEDFORD					
Project Name: UNIVERSAL DESTINATIONS & EXPERIENCES UK PROJECT					
Drawing Title: PARAMETER PLAN ACTIVE TRAVEL PLAN					
Scale	1:10000	Designed	CR	Drawn	CR
		Checked	LB	Authorised	MIS
Original Size	A1	Date	26.06.25	Date	26.06.25
		Date	26.06.25	Date	26.06.25
Drawing Reference:					Project Ref. No. P320
1.12.0					Revision 00