

Responsibility is not accepted for errors made by others scaling from this drawing. All construction information should be taken from figured dimensions only.

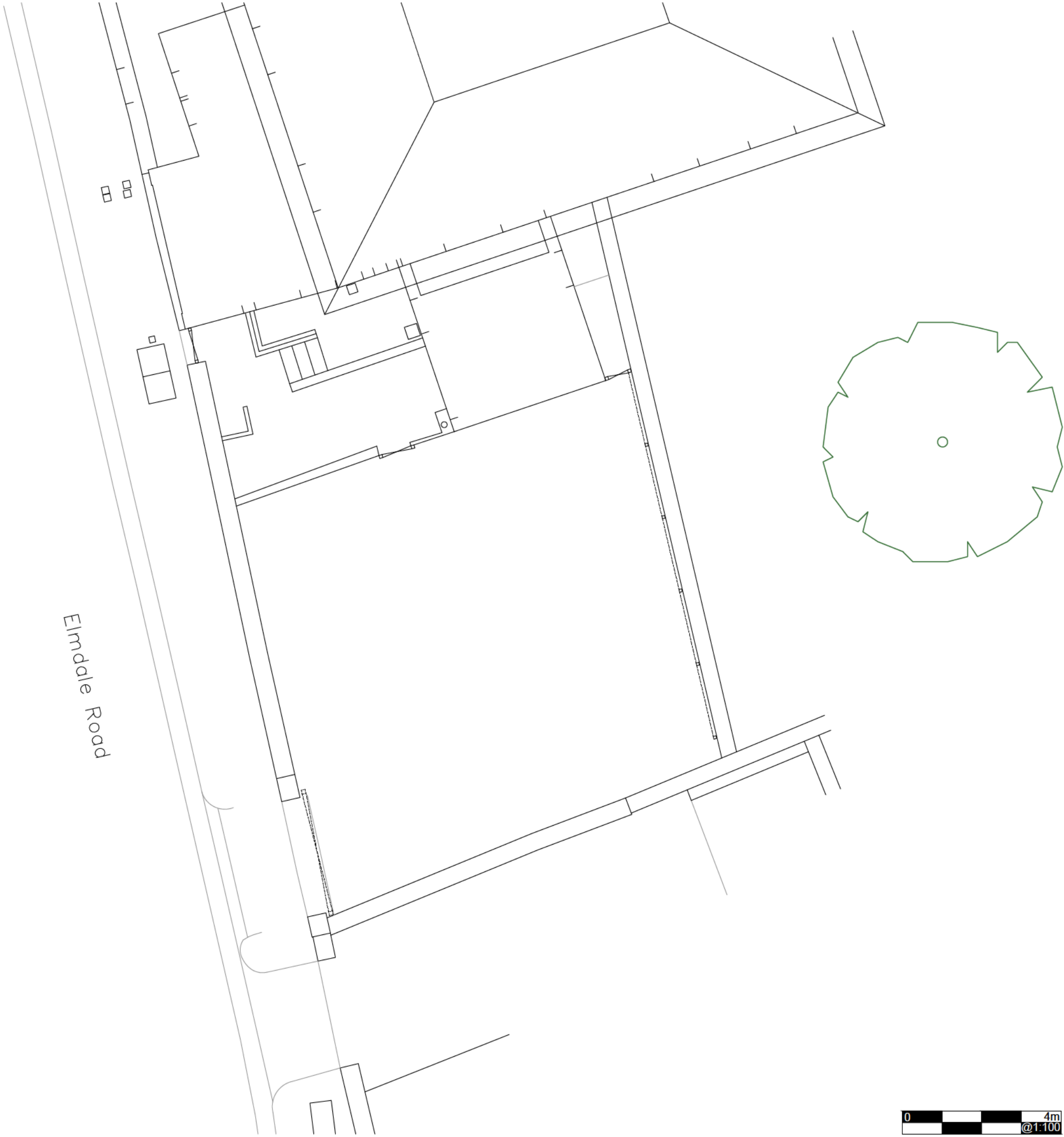

REV	Note	Date
-----	------	------



105 WEST ARCHITECTS Ltd
107 Lower Redland Road, Redland,
Bristol. BS6 6SW
T: 0117 3737596
E: info@105west.co.uk
Web site: www.105west.co.uk

Project	Rear 6 Tyndalls Park Road
---------	---------------------------

Drawing Title	Existing Site Plan
---------------	--------------------

Drawing No.	1749(L)11
-------------	-----------

Scale @A3	drawn by	Date	Rev
-----------	----------	------	-----

1:100	LH	26/03/24	-
-------	----	----------	---