

© Crown copyright and Landmark Information Group Limited 2015. All Rights Reserved.



A Member of the RSK Group plc

## Somerset

Published 1921 - 1932

Source map scale - 1:10,560

The historical maps shown were reproduced from maps predominantly held at the scale adopted for England, Wales and Scotland in the 1840's. In 1854 the 1:2,500 scale was adopted for mapping urban areas; these maps were used to update the 1:10,560 maps. The published date given therefore is often some years later than the surveyed date. Before 1938, all OS maps were based on the Cassini Projection, with independent surveys of a single county or group of counties, giving rise to significant inaccuracies in outlying areas. In the late 1940's, a Provisional Edition was produced, which updated the 1:10,560 mapping from a number of sources. The maps appear unfinished - with all military camps and other strategic sites removed. These maps were initially overprinted with the National Grid. In 1970, the first 1:10,000 maps were produced using the Transverse Mercator Projection. The revision process continued until recently, with new editions appearing every 10 years or so for urban areas.

### Map Name(s) and Date(s)

006NE 1921 1:10,560	007NW 1932 1:10,560
006SE 1921 1:10,560	007SW 1932 1:10,560

### Historical Map - Slice A

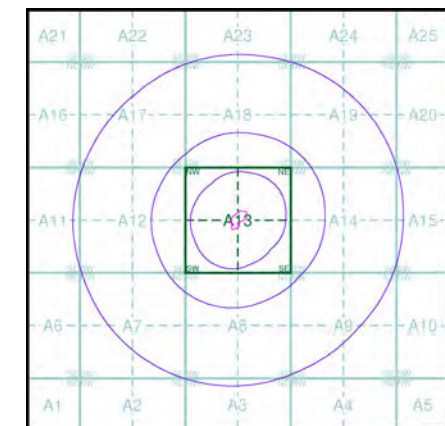

### Order Details

Order Number: 132920054\_1\_1  
 Customer Ref: 732959  
 National Grid Reference: 362560, 170010  
 Slice: A  
 Site Area (Ha): 0.69  
 Search Buffer (m): 1000

### Site Details

Ground Floor, 515-517, Stockwood Road, Brislington,  
 BRISTOL, BS4 5LR



Tel: 0844 844 9952  
 Fax: 0844 844 9951  
 Web: www.envirocheck.co.uk

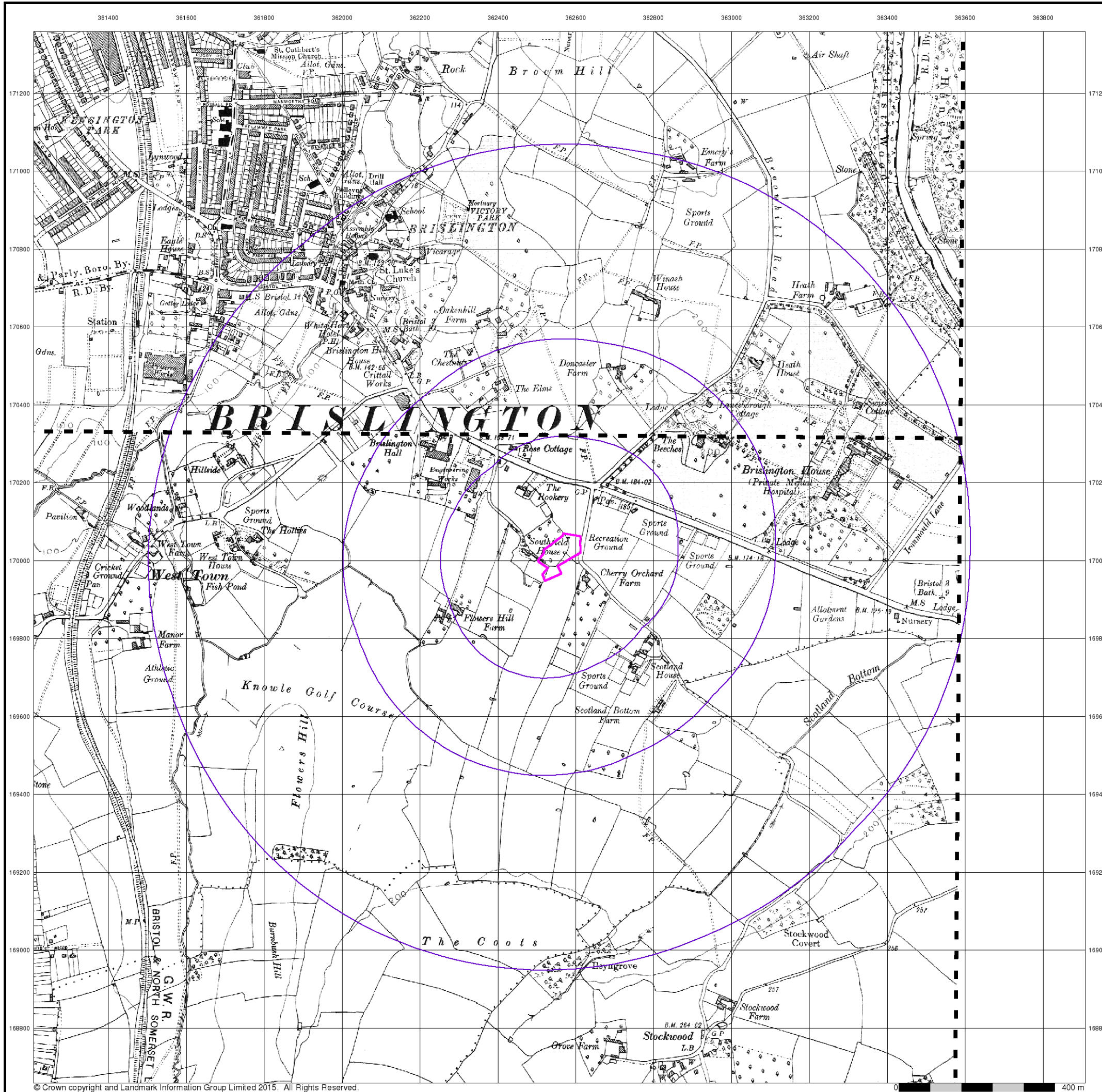

**STRUCTURAL SOILS LTD**

A Member of the RSK Group plc

**Somerset**

**Published 1932 - 1933**

**Source map scale - 1:10,560**

The historical maps shown were reproduced from maps predominantly held at the scale adopted for England, Wales and Scotland in the 1840's. In 1854 the 1:2,500 scale was adopted for mapping urban areas; these maps were used to update the 1:10,560 maps. The published date given therefore is often some years later than the surveyed date. Before 1938, all OS maps were based on the Cassini Projection, with independent surveys of a single county or group of counties, giving rise to significant inaccuracies in outlying areas. In the late 1940's, a Provisional Edition was produced, which updated the 1:10,560 mapping from a number of sources. The maps appear unfinished - with all military camps and other strategic sites removed. These maps were initially overlaid with the National Grid. In 1970, the first 1:10,000 maps were produced using the Transverse Mercator Projection. The revision process continued until recently, with new editions appearing every 10 years or so for urban areas.

**Map Name(s) and Date(s)**

006NE	1933	1:10,560
006SE	1932	1:10,560

**Historical Map - Slice A**

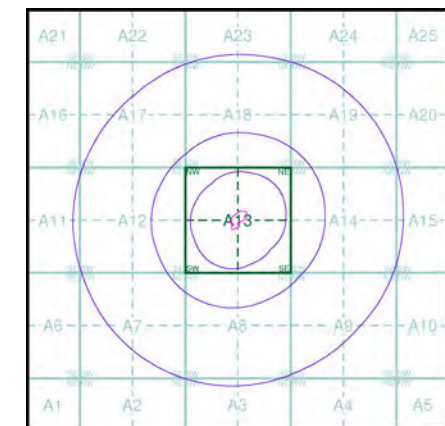

**Order Details**

Order Number: 132920054\_1\_1  
 Customer Ref: 732959  
 National Grid Reference: 362560, 170010  
 Slice: A  
 Site Area (Ha): 0.69  
 Search Buffer (m): 1000

**Site Details**

Ground Floor, 515-517, Stockwood Road, Brislington, BRISTOL, BS4 5LR



Tel: 0844 844 9952  
 Fax: 0844 844 9951  
 Web: www.envirocheck.co.uk

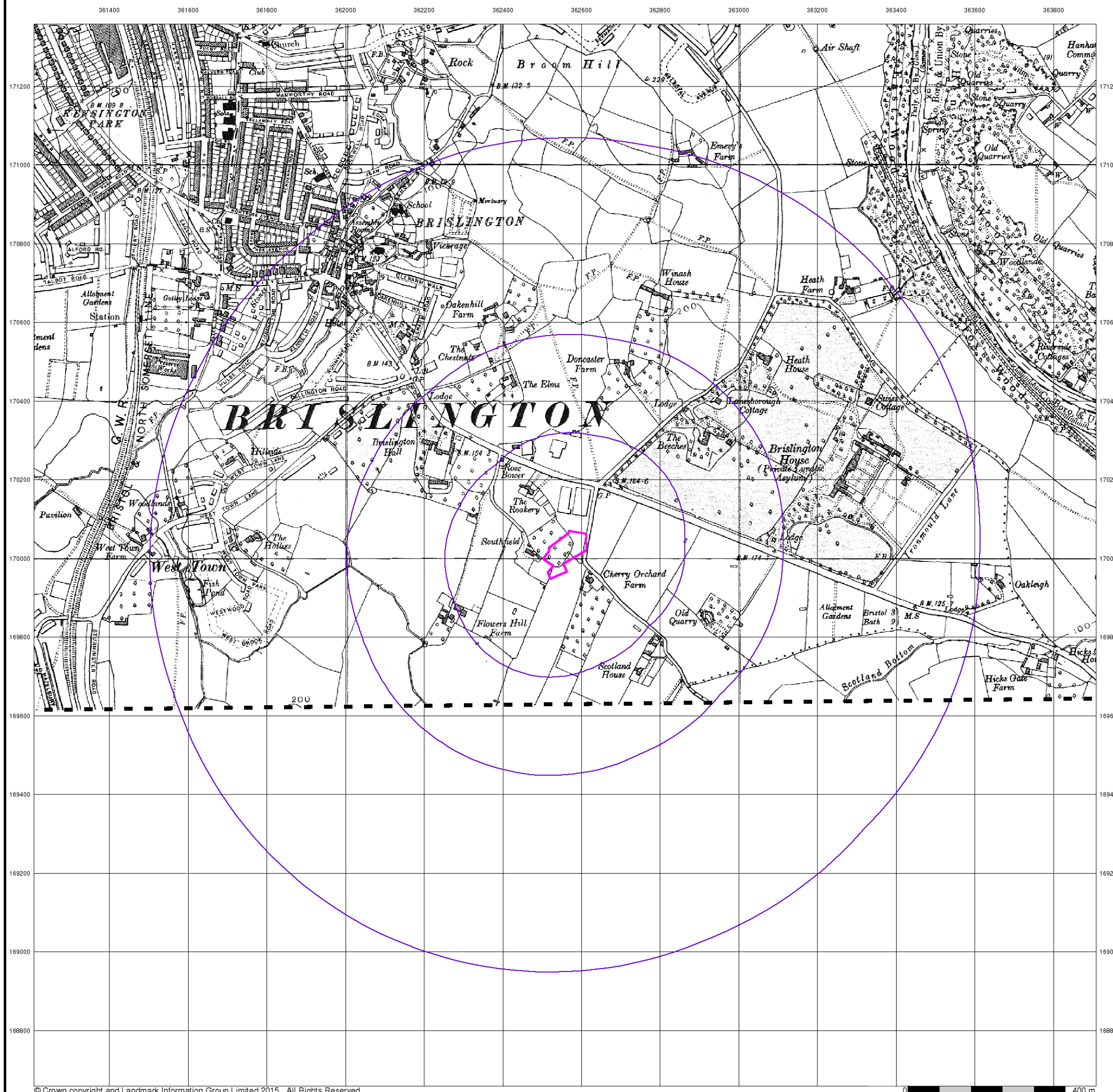

© Crown copyright and Landmark Information Group Limited 2015. All Rights Reserved.



**STRUCTURAL SOILS LTD**

A Member of the RSK Group plc

**Gloucestershire**

**Published 1938**

**Source map scale - 1:10,560**

The historical maps shown were reproduced from maps predominantly held at the scale adopted for England, Wales and Scotland in the 1840's. In 1854 the 1:2,500 scale was adopted for mapping urban areas; these maps were used to update the 1:10,560 maps. The published date given therefore is often some years later than the surveyed date. Before 1938, all OS maps were based on the Cassini Projection, with independent surveys of a single county or group of counties, giving rise to significant inaccuracies in outlying areas. In the late 1940's, a Provisional Edition was produced, which updated the 1:10,560 mapping from a number of sources. The maps appear unfinished - with all military camps and other strategic sites removed. These maps were initially overprinted with the National Grid. In 1970, the first 1:10,000 maps were produced using the Transverse Mercator Projection. The revision process continued until recently, with new editions appearing every 10 years or so for urban areas.

**Map Name(s) and Date(s)**

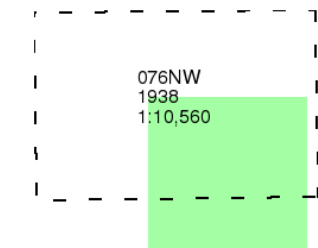

**Historical Map - Slice A**

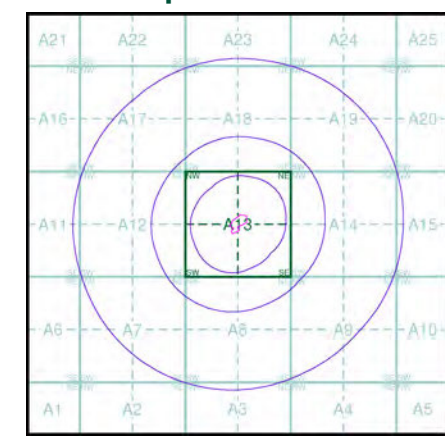

**Order Details**

Order Number: 132920054\_1\_1  
 Customer Ref: 732959  
 National Grid Reference: 362560, 170010  
 Slice: A  
 Site Area (Ha): 0.69  
 Search Buffer (m): 1000

**Site Details**

Ground Floor, 515-517, Stockwood Road, Brislington, BRISTOL, BS4 5LR



Tel: 0844 844 9952  
 Fax: 0844 844 9951  
 Web: www.envirocheck.co.uk



© Crown copyright and Landmark Information Group Limited 2015. All Rights Reserved.



**STRUCTURAL SOILS LTD**

A Member of the RSK Group plc

**Somerset**

**Published 1938**

**Source map scale - 1:10,560**

The historical maps shown were reproduced from maps predominantly held at the scale adopted for England, Wales and Scotland in the 1840's. In 1854 the 1:2,500 scale was adopted for mapping urban areas; these maps were used to update the 1:10,560 maps. The published date given therefore is often some years later than the surveyed date. Before 1938, all OS maps were based on the Cassini Projection, with independent surveys of a single county or group of counties, giving rise to significant inaccuracies in outlying areas. In the late 1940's, a Provisional Edition was produced, which updated the 1:10,560 mapping from a number of sources. The maps appear unfinished - with all military camps and other strategic sites removed. These maps were initially overprinted with the National Grid. In 1970, the first 1:10,000 maps were produced using the Transverse Mercator Projection. The revision process continued until recently, with new editions appearing every 10 years or so for urban areas.

**Map Name(s) and Date(s)**

006NE 1938 1:10,560	007NW 1938 1:10,560
006SE 1938 1:10,560	007SW 1938 1:10,560

**Historical Map - Slice A**

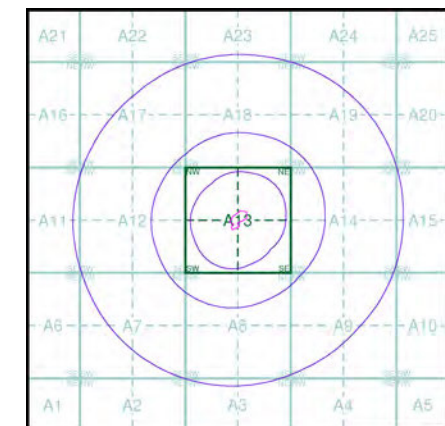

**Order Details**

Order Number: 132920054\_1\_1  
 Customer Ref: 732959  
 National Grid Reference: 362560, 170010  
 Slice: A  
 Site Area (Ha): 0.69  
 Search Buffer (m): 1000

**Site Details**

Ground Floor, 515-517, Stockwood Road, Brislington,  
 BRISTOL, BS4 5LR



Tel: 0844 844 9952  
 Fax: 0844 844 9951  
 Web: www.envirocheck.co.uk

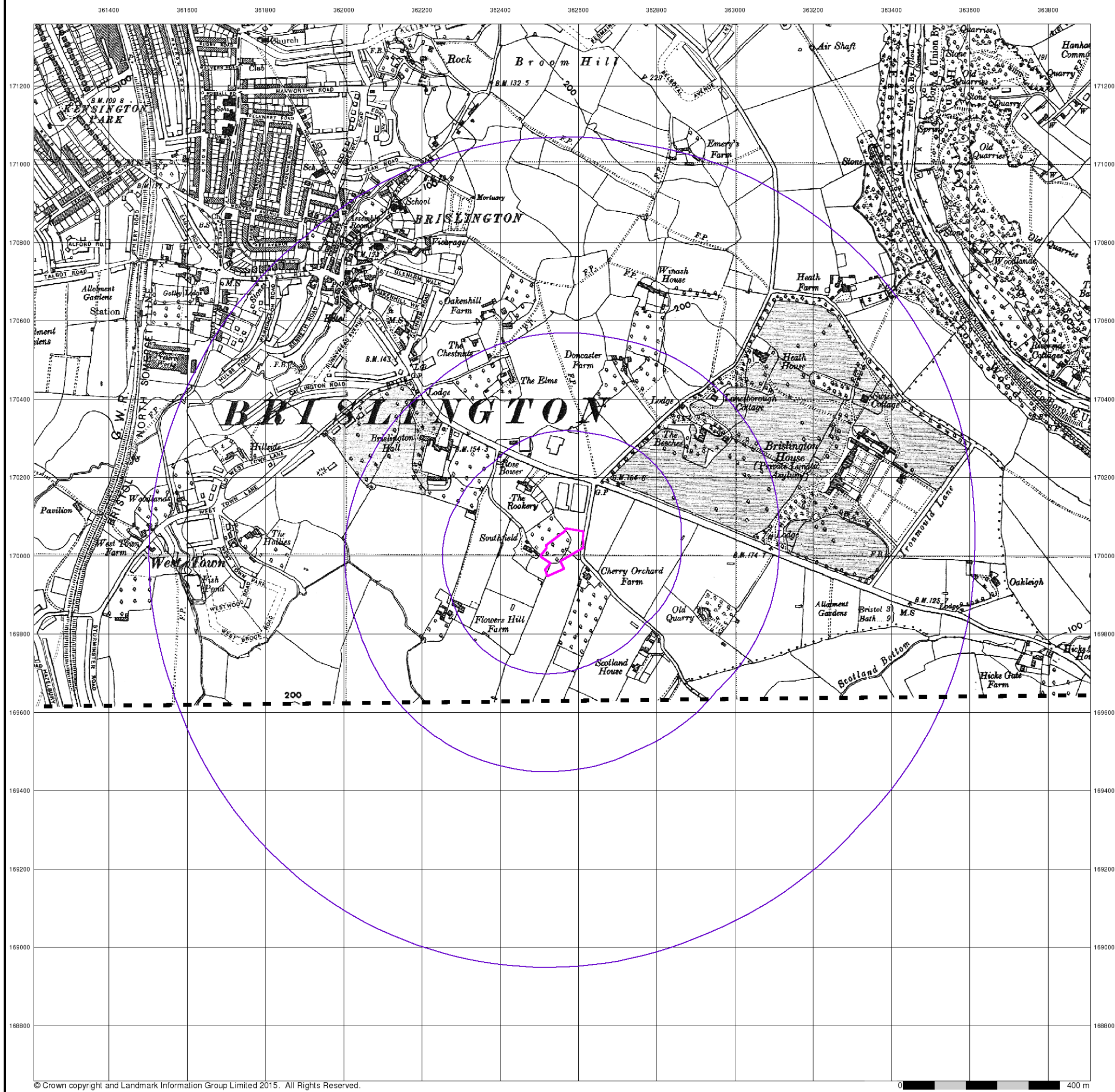

© Crown copyright and Landmark Information Group Limited 2015. All Rights Reserved.



**STRUCTURAL SOILS LTD**

A Member of the RSK Group plc

**Gloucestershire**

**Published 1938**

**Source map scale - 1:10,560**

The historical maps shown were reproduced from maps predominantly held at the scale adopted for England, Wales and Scotland in the 1840's. In 1854 the 1:2,500 scale was adopted for mapping urban areas; these maps were used to update the 1:10,560 maps. The published date given therefore is often some years later than the surveyed date. Before 1938, all OS maps were based on the Cassini Projection, with independent surveys of a single county or group of counties, giving rise to significant inaccuracies in outlying areas. In the late 1940's, a Provisional Edition was produced, which updated the 1:10,560 mapping from a number of sources. The maps appear unfinished - with all military camps and other strategic sites removed. These maps were initially overprinted with the National Grid. In 1970, the first 1:10,000 maps were produced using the Transverse Mercator Projection. The revision process continued until recently, with new editions appearing every 10 years or so for urban areas.

**Map Name(s) and Date(s)**

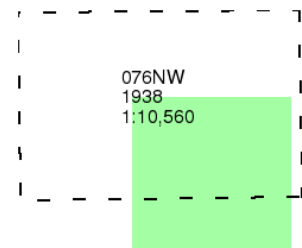

**Historical Map - Slice A**

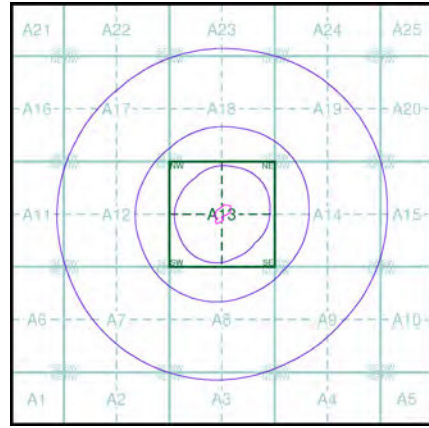

**Order Details**

Order Number: 132920054\_1\_1  
 Customer Ref: 732959  
 National Grid Reference: 362560, 170010  
 Slice: A  
 Site Area (Ha): 0.69  
 Search Buffer (m): 1000

**Site Details**

Ground Floor, 515-517, Stockwood Road, Brislington, BRISTOL, BS4 5LR



Tel: 0844 844 9952  
 Fax: 0844 844 9951  
 Web: www.envirocheck.co.uk



© Crown copyright and Landmark Information Group Limited 2015. All Rights Reserved.



A Member of the RSK Group plc

**Somerset**

**Published 1938**

**Source map scale - 1:10,560**

The historical maps shown were reproduced from maps predominantly held at the scale adopted for England, Wales and Scotland in the 1840's. In 1854 the 1:2,500 scale was adopted for mapping urban areas; these maps were used to update the 1:10,560 maps. The published date given therefore is often some years later than the surveyed date. Before 1938, all OS maps were based on the Cassini Projection, with independent surveys of a single county or group of counties, giving rise to significant inaccuracies in outlying areas. In the late 1940's, a Provisional Edition was produced, which updated the 1:10,560 mapping from a number of sources. The maps appear unfinished - with all military camps and other strategic sites removed. These maps were initially overprinted with the National Grid. In 1970, the first 1:10,000 maps were produced using the Transverse Mercator Projection. The revision process continued until recently, with new editions appearing every 10 years or so for urban areas.

**Map Name(s) and Date(s)**

006NE 1938 1:10,560	007NW 1938 1:10,560
006SE 1938 1:10,560	007SW 1938 1:10,560

**Historical Map - Slice A**

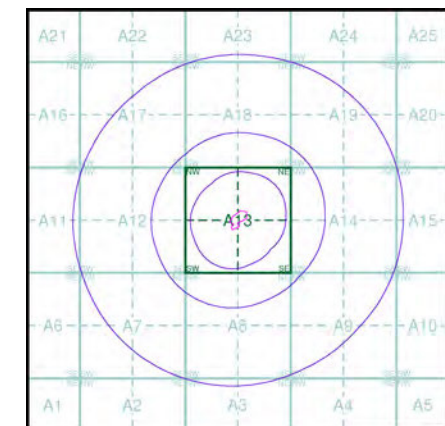

**Order Details**

Order Number: 132920054\_1\_1  
 Customer Ref: 732959  
 National Grid Reference: 362560, 170010  
 Slice: A  
 Site Area (Ha): 0.69  
 Search Buffer (m): 1000

**Site Details**

Ground Floor, 515-517, Stockwood Road, Brislington,  
 BRISTOL, BS4 5LR



Tel: 0844 844 9952  
 Fax: 0844 844 9951  
 Web: www.envirocheck.co.uk

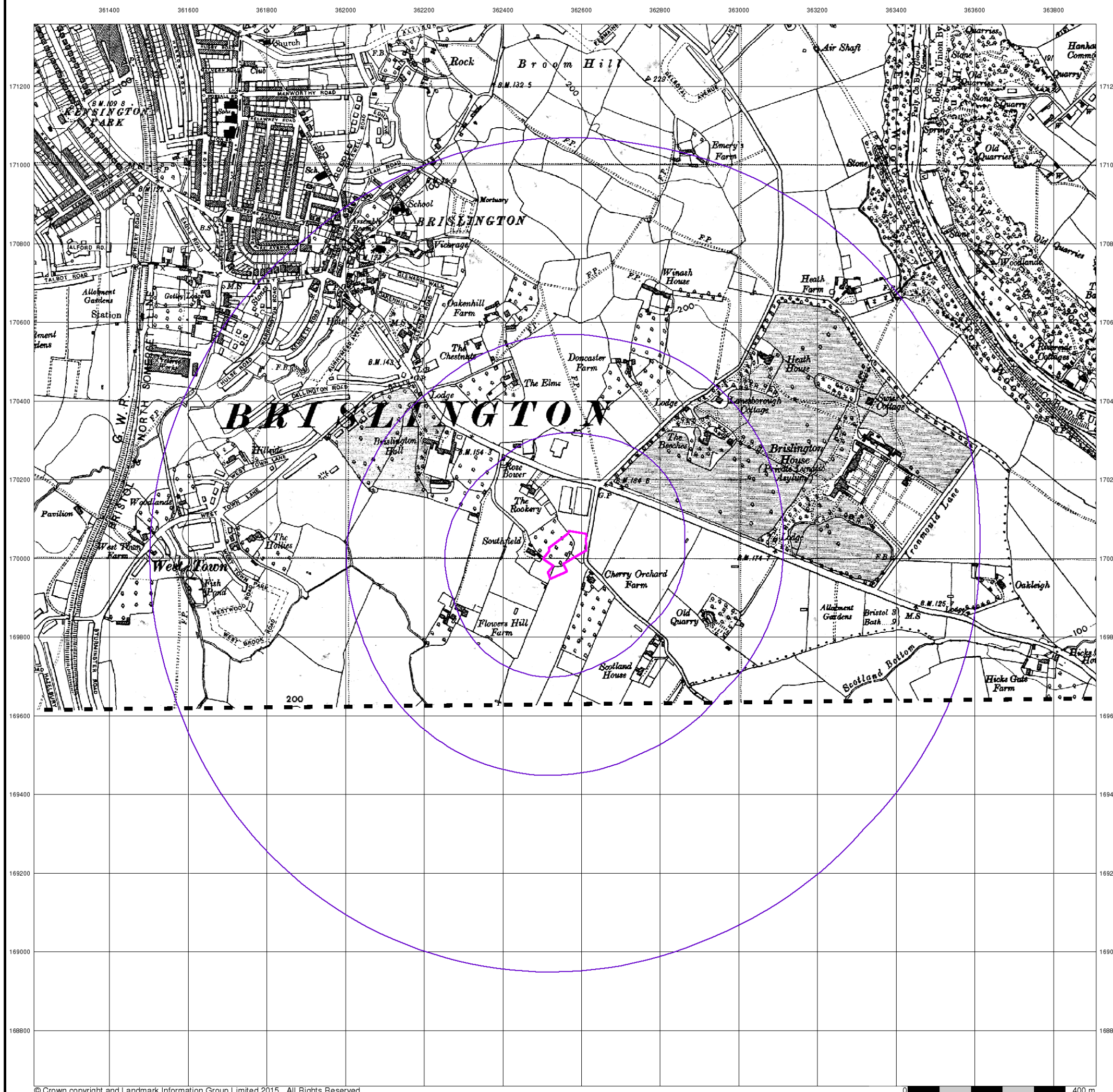

© Crown copyright and Landmark Information Group Limited 2015. All Rights Reserved.



**STRUCTURAL SOILS LTD**

A Member of the RSK Group plc

**Gloucestershire**

**Published 1946**

**Source map scale - 1:10,560**

The historical maps shown were reproduced from maps predominantly held at the scale adopted for England, Wales and Scotland in the 1840's. In 1854 the 1:2,500 scale was adopted for mapping urban areas; these maps were used to update the 1:10,560 maps. The published date given therefore is often some years later than the surveyed date. Before 1938, all OS maps were based on the Cassini Projection, with independent surveys of a single county or group of counties, giving rise to significant inaccuracies in outlying areas. In the late 1940's, a Provisional Edition was produced, which updated the 1:10,560 mapping from a number of sources. The maps appear unfinished - with all military camps and other strategic sites removed. These maps were initially overprinted with the National Grid. In 1970, the first 1:10,000 maps were produced using the Transverse Mercator Projection. The revision process continued until recently, with new editions appearing every 10 years or so for urban areas.

**Map Name(s) and Date(s)**

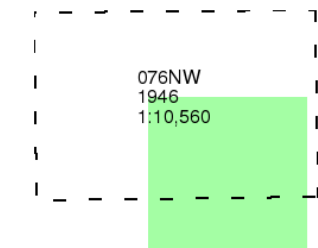

**Historical Map - Slice A**

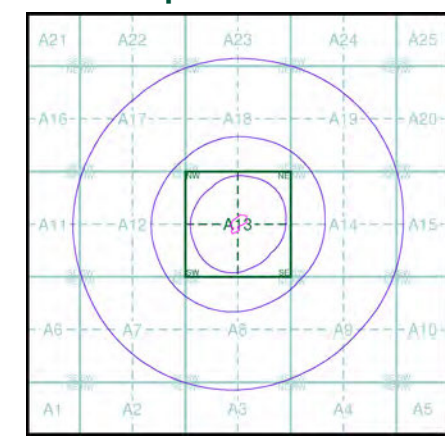

**Order Details**

Order Number: 132920054\_1\_1  
 Customer Ref: 732959  
 National Grid Reference: 362560, 170010  
 Slice: A  
 Site Area (Ha): 0.69  
 Search Buffer (m): 1000

**Site Details**

Ground Floor, 515-517, Stockwood Road, Brislington, BRISTOL, BS4 5LR



Tel: 0844 844 9952  
 Fax: 0844 844 9951  
 Web: www.envirocheck.co.uk

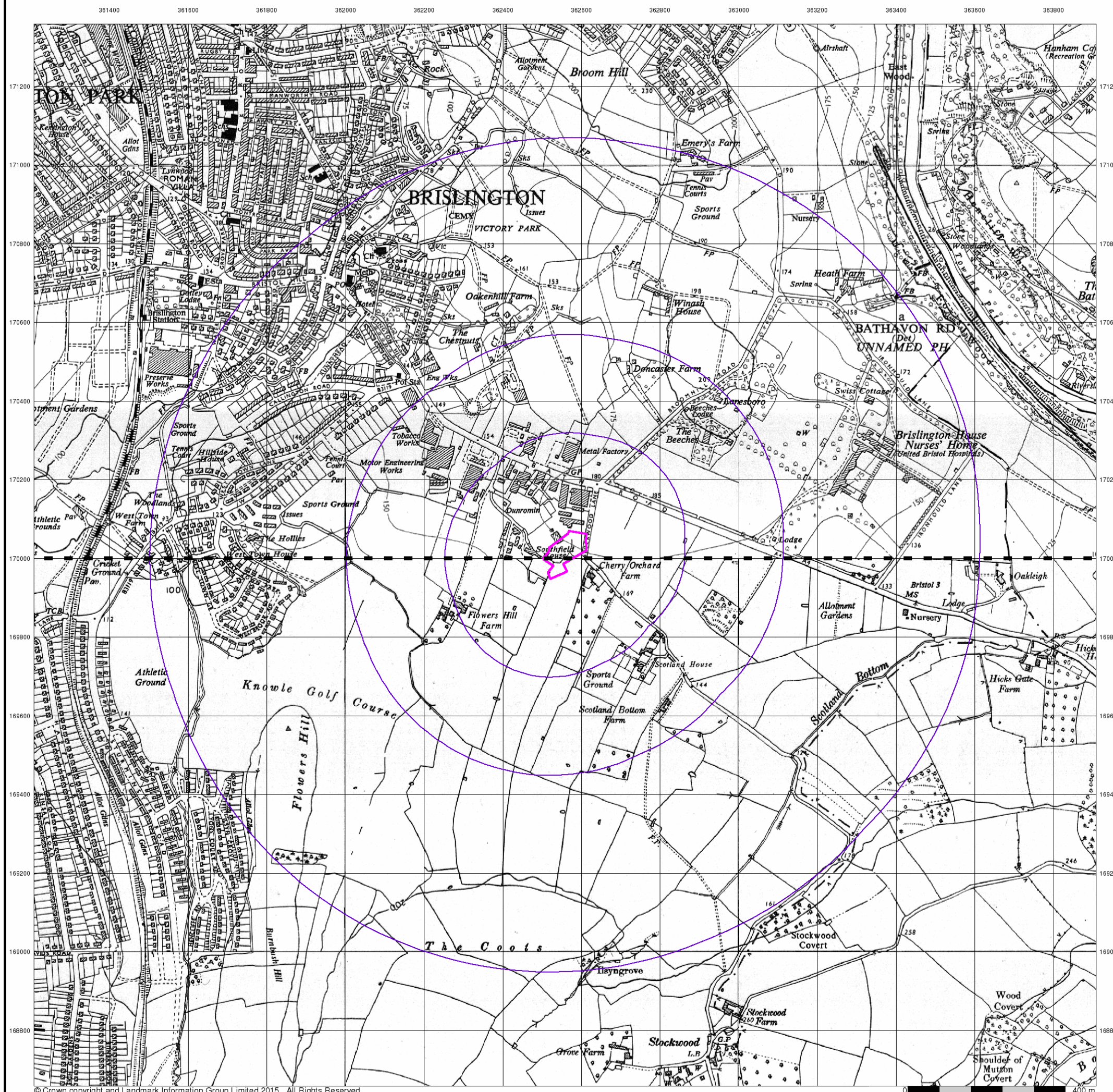

© Crown copyright and Landmark Information Group Limited 2015. All Rights Reserved.



A Member of the RSK Group plc

## Ordnance Survey Plan

Published 1955

Source map scale - 1:10,000

The historical maps shown were reproduced from maps predominantly held at the scale adopted for England, Wales and Scotland in the 1840's. In 1854 the 1:2,500 scale was adopted for mapping urban areas; these maps were used to update the 1:10,560 maps. The published date given therefore is often some years later than the surveyed date. Before 1938, all OS maps were based on the Cassini Projection, with independent surveys of a single county or group of counties, giving rise to significant inaccuracies in outlying areas. In the late 1940's, a Provisional Edition was produced, which updated the 1:10,560 mapping from a number of sources. The maps appear unfinished - with all military camps and other strategic sites removed. These maps were initially overprinted with the National Grid. In 1970, the first 1:10,000 maps were produced using the Transverse Mercator Projection. The revision process continued until recently, with new editions appearing every 10 years or so for urban areas.

### Map Name(s) and Date(s)

ST67SW	1955
1:10,560	
ST66NW	1955
1:10,560	

### Historical Map - Slice A

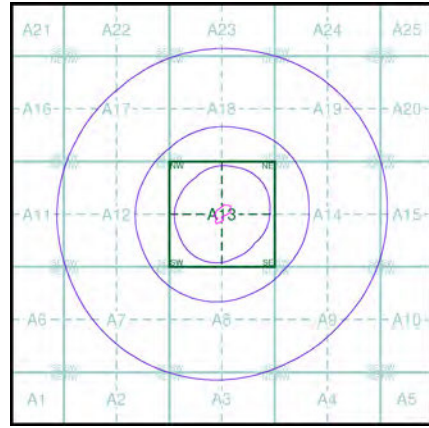

### Order Details

Order Number: 132920054\_1\_1  
 Customer Ref: 732959  
 National Grid Reference: 362560, 170010  
 Slice: A  
 Site Area (Ha): 0.69  
 Search Buffer (m): 1000

### Site Details

Ground Floor, 515-517, Stockwood Road, Brislington, BRISTOL, BS4 5LR



Tel: 0844 844 9952  
 Fax: 0844 844 9951  
 Web: www.envirocheck.co.uk



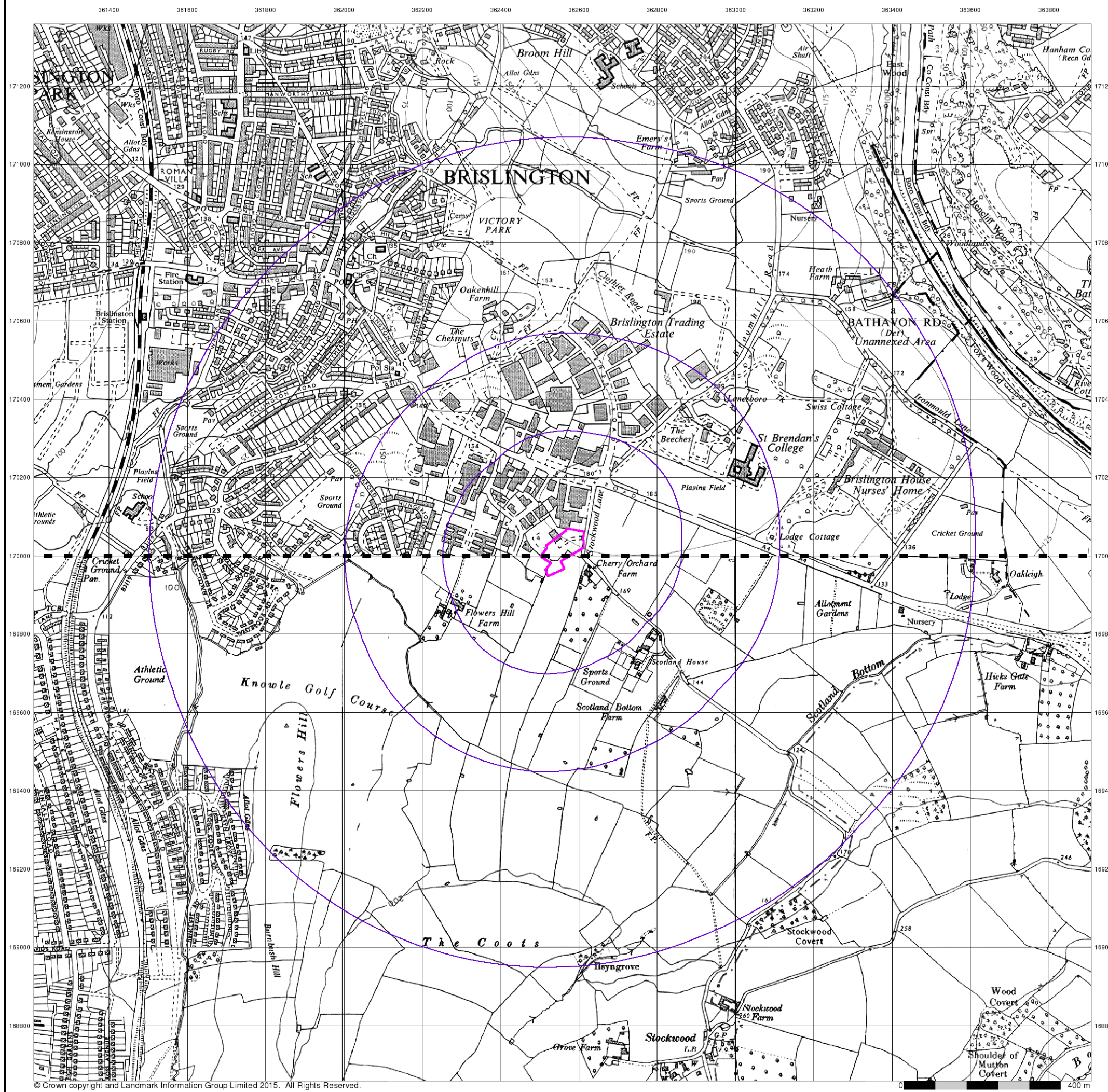

© Crown copyright and Landmark Information Group Limited 2015. All Rights Reserved.



**STRUCTURAL SOILS LTD**

A Member of the **RSK** Group plc

### Ordnance Survey Plan

Published 1965 - 1967

Source map scale - 1:10,000

The historical maps shown were reproduced from maps predominantly held at the scale adopted for England, Wales and Scotland in the 1840's. In 1854 the 1:2,500 scale was adopted for mapping urban areas; these maps were used to update the 1:10,560 maps. The published date given therefore is often some years later than the surveyed date. Before 1938, all OS maps were based on the Cassini Projection, with independent surveys of a single county or group of counties, giving rise to significant inaccuracies in outlying areas. In the late 1940's, a Provisional Edition was produced, which updated the 1:10,560 mapping from a number of sources. The maps appear unfinished - with all military camps and other strategic sites removed. These maps were initially overprinted with the National Grid. In 1970, the first 1:10,000 maps were produced using the Transverse Mercator Projection. The revision process continued until recently, with new editions appearing every 10 years or so for urban areas.

### Map Name(s) and Date(s)

ST67SW	1965
1:10,560	
ST66NW	1967
1:10,560	

### Historical Map - Slice A

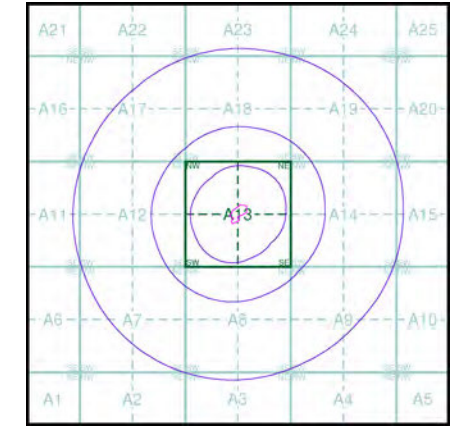

### Order Details

Order Number: 132920054\_1\_1  
 Customer Ref: 732959  
 National Grid Reference: 362560, 170010  
 Slice: A  
 Site Area (Ha): 0.69  
 Search Buffer (m): 1000

### Site Details

Ground Floor, 515-517, Stockwood Road, Brislington, BRISTOL, BS4 5LR



Tel: 0844 844 9952  
 Fax: 0844 844 9951  
 Web: www.envirocheck.co.uk