

# Notice of variation and consolidation with introductory note

The Environmental Permitting (England & Wales) Regulations 2016

---

Pork Farms Limited

Queens Drive Baked Products  
Dunsil Drive  
Queens Drive Industrial Estate  
Nottingham  
Nottinghamshire  
NG2 1LU

**Variation application number**

EPR/SP3336UV/V002

**Permit number**

EPR/SP3336UV

# Queens Drive Baked Products

## Permit number EPR/SP3336UV

### Introductory note

#### **This introductory note does not form a part of the notice**

Under the Environmental Permitting (England & Wales) Regulations 2016 (schedule 5, part 1, paragraph 19) a variation may comprise a consolidated permit reflecting the variations and a notice specifying the variations included in that consolidated permit.

Schedule 1 of the notice specifies the conditions that have been varied and schedule 2 comprises a consolidated permit which reflects the variations being made. All the conditions of the permit have been varied and are subject to the right of appeal.

This consolidated permit has been issued following a full review against the best available techniques (BAT) conclusions for the Food, Drink and Milk Industries published on 4<sup>th</sup> December 2019 in the official journal of the European Union.

We have implemented the requirements of the Medium Combustion Plant directive, and incorporated post-dated requirements for 2030.

The schedules specify the changes made to the permit.

Queens Drive Baked Products, operated by Pork Farms Limited is located at Queens Drive Industrial Estate located near central Nottingham at national grid reference SK 56400 37940. The surrounding area consists of an industrial estate with the river Leen to the immediate north. The A453 is located 75m to the east of the site, with the closest residential receptors located beyond the A453 approximately 140m northeast of the site boundary with other industrial premises to the south and west of the site. The river Trent is located within approximately 50m to the East of the installation. The site covers an area of approximately 7.8 acres and consists of buildings containing factory facilities, product storage areas and offices. There is also a small brook (Tottle Brook) that runs alongside the factory. The site was constructed in 1971 on a brownfield site which was formally Clifton Colliery.

The installation produces a range of pork pies from a variety of raw materials and ingredients using a number of processing techniques including meat preparation, cooking and chilling before packaging (primary and secondary) and palletisation for dispatch. Throughput is approximately 15,500 tonnes per annum of all products with significant variations in daily production in accordance with changing seasonal demands. Average output is normally 40 tonnes per day with peaks in excess of 75 tonnes per day. Raw materials are stored in a wide range of different containers on-site ranging from silos, for some dry ingredients, through to drums and IBCs as appropriate. Chilled storage areas are available for some raw materials as necessary. Following meat preparation where a "meat fill" is produced, product is then prepared by filling of the meat fill directly into pastry on a filling line. Pastry mix is prepared on-site as required. The product from the production line is then cooked in ovens before being chilled and wrapped prior to storage and dispatch off-site.

The Operator's new registered Company House address has been included in this permit review.

The Environmental Permit is for the following scheduled activity:

*Section 6.8 Part A(1)(d)(i): Treating and processing material intended for the production of food products from animal raw materials (other than milk only) at plant with a finished product production capacity of more than 75 tonnes per day.*

The main potential for environmental impact is associated with the discharges to sewer. Process effluent is discharged untreated at two points into the local sewer under existing Trade Discharge Consents. Treatment is carried out by Severn Trent Water Ltd at Stoke Bardolph Sewage Treatment Works.

There is no discharge to controlled waters (including groundwater) except for uncontaminated surface water run-off from the site which is routed from two discharge points via oil interceptors, into the local Tottle Brook.

The key emission source points arise from two natural gas fired boilers which each have an input of 1.8 MWth. The ovens are fired on natural gas with the products of combustion being released directly to atmosphere from a number of point sources. No abatement equipment is installed on these release points or the emission points from the two site boiler systems which are used to generate hot water and steam for processing. All systems are run on natural gas and are maintained on a regular basis to maintain combustion efficiency. Total thermal input for the site is estimated as 7 MWTh for all combustion units on site.

General waste is disposed of via incineration to produce energy following compaction. Paper and board are segregated and sent for recycling, while food wastes are sent to anaerobic digestion.

There are no statutory or non-statutory sites that could be affected by the installation, including any special areas of conservation (SACs), special protection areas (SPAs), or RAMSAR areas within 10km of the installation, or sites of special scientific interest (SSSIs), ancient woodlands within 2km of the installation. The Operator is signed up to the Climate Change Levy Agreement.

The site has an internal Environmental Management System (EMS) in place which is structured to meet BAT.

The status log of a permit sets out the permitting history, including any changes to the permit reference number.

| <b>Status log of the permit</b>                                |                                                         |                                                                                                                                                                                                                                                                                                                                                        |
|----------------------------------------------------------------|---------------------------------------------------------|--------------------------------------------------------------------------------------------------------------------------------------------------------------------------------------------------------------------------------------------------------------------------------------------------------------------------------------------------------|
| <b>Description</b>                                             | <b>Date</b>                                             | <b>Comments</b>                                                                                                                                                                                                                                                                                                                                        |
| Application received<br>EPR/ZP3532PN/A001                      | Received<br>02/09/2005                                  | Application received for the production of pork-based products.                                                                                                                                                                                                                                                                                        |
| Additional information received                                | Received<br>06/05/2005                                  | --                                                                                                                                                                                                                                                                                                                                                     |
| Permit determined                                              | 11/07/2005                                              | Permit issued to F.W.Farnsworth Limited.                                                                                                                                                                                                                                                                                                               |
| Transfer Application<br>SP3336UV/T001                          | Received<br>28/06/2007                                  | Transfer application received to transfer the permit from F.W.Farnsworth Limited to Pork Farms Limited.                                                                                                                                                                                                                                                |
| Transfer determined                                            | 19/09/2007                                              | Permit transferred to Pork Farms Limited.                                                                                                                                                                                                                                                                                                              |
| Application<br>EPR/SP3336UV/V002 (variation and consolidation) | Regulation 61<br>Notice response received<br>03/03/2023 | Environment Agency initiated variation and consolidation following the Food, Drink & Milk Industries sector permit review.                                                                                                                                                                                                                             |
| Response to request for information dated 28/10/2024           | Received<br>11/11/2024                                  | Information requested in relation to Reg.61 response tool concerning BATc 3, 6, 7, 9, 11, 12, 15, and non-narrative BAT in relation to production/capacity threshold, H1 assessment, soil & groundwater risk assessment (baseline report), relevant hazardous substances, climate change adaption plan, containment, regulated activity and site plan. |
| Response to request for information dated 13/11/2024           | Received<br>19/11/2024                                  | Information requested in relation to Reg.61 response tool concerning BATc 29 EPL's.                                                                                                                                                                                                                                                                    |
| Variation determined and consolidation issued<br>EPR/SP3336UV  | 06/12/2024                                              | Varied and consolidated permit issued in modern format.                                                                                                                                                                                                                                                                                                |

End of introductory note

# Notice of variation and consolidation

## The Environmental Permitting (England and Wales) Regulations 2016

The Environment Agency in exercise of its powers under regulation 20 of the Environmental Permitting (England and Wales) Regulations 2016 varies

### Permit number

EPR/SP3336UV

### Issued to

**Pork Farms Limited** (“the Operator”)

whose registered office is

**Tottle Bakery**

**Queens Drive**

**Nottingham**

**NG2 1LU**

company registration number 5998346

to operate a regulated facility at

**Queens Drive Baked Products**

**Dunsil Drive**

**Queens Drive Industrial Estate**

**Nottingham**

**Nottinghamshire**

**NG2 1LU**

to the extent set out in the schedules.

The notice shall take effect from 06/12/2024

| Name          | Date       |
|---------------|------------|
| Denise Horton | 06/12/2024 |

Authorised on behalf of the Environment Agency

## **Schedule 1**

All conditions have been varied by the consolidated permit as a result of an Environment Agency initiated variation.

## **Schedule 2 – consolidated permit**

Consolidated permit issued as a separate document.

# Permit

## The Environmental Permitting (England and Wales) Regulations 2016

### Permit number

**EPR/SP3336UV**

This is the consolidated permit referred to in the variation and consolidation notice for application EPR/SP3336UV/V002 authorising,

**Pork Farms Limited** (“the Operator”),

whose registered office is

**Tottle Bakery**

**Queens Drive**

**Nottingham**

**NG2 1LU**

company registration number 5998346

to operate an installation at

**Queens Drive Baked Products**

**Dunsil Drive**

**Queens Drive Industrial Estate**

**Nottingham**

**Nottinghamshire**

**NG2 1LU**

to the extent authorised by and subject to the conditions of this permit.

| Name          | Date       |
|---------------|------------|
| Denise Horton | 06/12/2024 |

Authorised on behalf of the Environment Agency

# Conditions

## 1 Management

### 1.1 General management

1.1.1 The Operator shall manage and operate the activities:

- (a) in accordance with a written management system that identifies and minimises risks of pollution, including those arising from operations, maintenance, accidents, incidents, non-conformances, closure and those drawn to the attention of the Operator as a result of complaints; and
- (b) using sufficient competent persons and resources.

1.1.2 Records demonstrating compliance with condition 1.1.1 shall be maintained.

1.1.3 Any person having duties that are or may be affected by the matters set out in this permit shall have convenient access to a copy of it kept at or near the place where those duties are carried out.

### 1.2 Energy efficiency

1.2.1 The Operator shall:

- (a) take appropriate measures to ensure that energy is used efficiently in the activities;
- (b) review and record at least every four years whether there are suitable opportunities to improve the energy efficiency of the activities; and
- (c) take any further appropriate measures identified by a review.

### 1.3 Efficient use of raw materials

1.3.1 The Operator shall:

- (a) take appropriate measures to ensure that raw materials and water are used efficiently in the activities;
- (b) maintain records of raw materials and water used in the activities;
- (c) review and record at least every four years whether there are suitable alternative materials that could reduce environmental impact or opportunities to improve the efficiency of raw material and water use; and
- (d) take any further appropriate measures identified by a review.

### 1.4 Avoidance, recovery and disposal of wastes produced by the activities

1.4.1 The Operator shall take appropriate measures to ensure that:

- (a) the waste hierarchy referred to in Article 4 of the Waste Framework Directive is applied to the generation of waste by the activities; and
- (b) any waste generated by the activities is treated in accordance with the waste hierarchy referred to in Article 4 of the Waste Framework Directive; and
- (c) where disposal is necessary, this is undertaken in a manner which minimises its impact on the environment.

1.4.2 The Operator shall review and record at least every four years whether changes to those measures should be made and take any further appropriate measures identified by a review.

## **2 Operations**

### **2.1 Permitted activities**

2.1.1 The Operator is only authorised to carry out the activities specified in schedule 1 table S1.1 (the “activities”).

### **2.2 The site**

2.2.1 The activities shall not extend beyond the site, being the land shown edged in green on the site plan at schedule 7 to this permit.

### **2.3 Operating techniques**

2.3.1 The activities shall, subject to the conditions of this permit, be operated using the techniques and in the manner described in the documentation specified in schedule 1, table S1.2, unless otherwise agreed in writing by the Environment Agency.

2.3.2 If notified by the Environment Agency that the activities are giving rise to pollution, the Operator shall submit to the Environment Agency for approval within the period specified, a revision of any plan or other documentation (“plan”) specified in schedule 1, table S1.2 or otherwise required under this permit which identifies and minimises the risks of pollution relevant to that plan, and shall implement the approved revised plan in place of the original from the date of approval, unless otherwise agreed in writing by the Environment Agency.

2.3.3 Any raw materials or fuels listed in schedule 2 table S2.1 shall conform to the specifications set out in that table.

2.3.4 The Operator shall ensure that where waste produced by the activities is sent to a relevant waste operation, that operation is provided with the following information, prior to the receipt of the waste:

- (a) the nature of the process producing the waste;
- (b) the composition of the waste;
- (c) the handling requirements of the waste;
- (d) the hazardous property associated with the waste, if applicable; and
- (e) the waste code of the waste.

2.3.5 The Operator shall ensure that where waste produced by the activities is sent to a landfill site, it meets the waste acceptance criteria for that landfill.

### **2.4 Improvement programme**

2.4.1 The Operator shall complete the improvements specified in schedule 1 table S1.3 by the date specified in that table unless otherwise agreed in writing by the Environment Agency.

2.4.2 Except in the case of an improvement which consists only of a submission to the Environment Agency, the Operator shall notify the Environment Agency within 14 days of completion of each improvement.

## **3 Emissions and monitoring**

### **3.1 Emissions to water, air or land**

3.1.1 There shall be no point source emissions to water, air or land except from the sources and emission points listed in schedule 3 tables S3.1, S3.2 and S3.3.



- 3.1.2 The limits given in schedule 3 shall not be exceeded.
- 3.1.3 Periodic monitoring shall be carried out at least once every 5 years for groundwater and 10 years for soil, unless such monitoring is based on a systematic appraisal of the risk of contamination.
- 3.1.4 For the following activities referenced in schedule 1, table S1.1 (AR2 boiler plant 1 – A30 and 2 - A31) the first monitoring measurements shall be carried out within four months of 01/01/2030 or of the date when the MCP is first put into operation, whichever is later.

## **3.2 Emissions of substances not controlled by emission limits**

- 3.2.1 Emissions of substances not controlled by emission limits (excluding odour) shall not cause pollution. The Operator shall not be taken to have breached this condition if appropriate measures, including, but not limited to, those specified in any approved emissions management plan, have been taken to prevent or where that is not practicable, to minimise, those emissions.
- 3.2.2 The Operator shall:
- (a) if notified by the Environment Agency that the activities are giving rise to pollution, submit to the Environment Agency for approval within the period specified, an emissions management plan which identifies and minimises the risks of pollution from emissions of substances not controlled by emission limits;
  - (b) implement the approved emissions management plan, from the date of approval, unless otherwise agreed in writing by the Environment Agency.
- 3.2.3 All liquids in containers, whose emission to water or land could cause pollution, shall be provided with secondary containment, unless the Operator has used other appropriate measures to prevent or where that is not practicable, to minimise, leakage and spillage from the primary container.

## **3.3 Odour**

- 3.3.1 Emissions from the activities shall be free from odour at levels likely to cause pollution outside the site, as perceived by an authorised officer of the Environment Agency, unless the Operator has used appropriate measures, including, but not limited to, those specified in any approved odour management plan, to prevent or where that is not practicable to minimise the odour.
- 3.3.2 The Operator shall:
- (a) if notified by the Environment Agency that the activities are giving rise to pollution outside the site due to odour, submit to the Environment Agency for approval within the period specified, an odour management plan which identifies and minimises the risks of pollution from odour;
  - (b) implement the approved odour management plan, from the date of approval, unless otherwise agreed in writing by the Environment Agency.

## **3.4 Noise and vibration**

- 3.4.1 Emissions from the activities shall be free from noise and vibration at levels likely to cause pollution outside the site, as perceived by an authorised officer of the Environment Agency, unless the Operator has used appropriate measures, including, but not limited to, those specified in any approved noise and vibration management plan to prevent or where that is not practicable to minimise the noise and vibration.
- 3.4.2 The Operator shall:
- (a) if notified by the Environment Agency that the activities are giving rise to pollution outside the site due to noise and vibration, submit to the Environment Agency for approval within the period specified, a noise and vibration management plan which identifies and minimises the risks of pollution from noise and vibration;

- (b) implement the approved noise and vibration management plan, from the date of approval, unless otherwise agreed in writing by the Environment Agency.

## **3.5 Monitoring**

- 3.5.1 The Operator shall, unless otherwise agreed in writing by the Environment Agency, undertake the monitoring specified in the following tables in schedule 3 to this permit:
  - (a) point source emissions specified in tables S3.1, S3.2 and S3.3.
- 3.5.2 The Operator shall maintain records of all monitoring required by this permit including records of the taking and analysis of samples, instrument measurements (periodic and continual), calibrations, examinations, tests and surveys and any assessment or evaluation made on the basis of such data.
- 3.5.3 Monitoring equipment, techniques, personnel and organisations employed for the emissions monitoring programme and the environmental or other monitoring specified in condition 3.5.1 shall have either MCERTS certification or MCERTS accreditation (as appropriate), where available, unless otherwise agreed in writing by the Environment Agency.
- 3.5.4 Permanent means of access shall be provided to enable sampling/monitoring to be carried out in relation to the emission points specified in schedule 3 tables S3.1, S3.2 and S3.3 unless otherwise agreed in writing by the Environment Agency.

## **3.6 Pests**

- 3.6.1 The activities shall not give rise to the presence of pests which are likely to cause pollution, hazard or annoyance outside the boundary of the site. The Operator shall not be taken to have breached this condition if appropriate measures, including, but not limited to, those specified in any approved pests management plan, have been taken to prevent or where that is not practicable, to minimise the presence of pests on the site.
- 3.6.2 The Operator shall:
  - (a) if notified by the Environment Agency, submit to the Environment Agency for approval within the period specified, a pests management plan which identifies and minimises risks of pollution from pests;
  - (b) implement the pests management plan, from the date of approval, unless otherwise agreed in writing by the Environment Agency.

## **4 Information**

### **4.1 Records**

- 4.1.1 All records required to be made by this permit shall:
  - (a) be legible;
  - (b) be made as soon as reasonably practicable;
  - (c) if amended, be amended in such a way that the original and any subsequent amendments remain legible, or are capable of retrieval; and
  - (d) be retained, unless otherwise agreed in writing by the Environment Agency, for at least 6 years from the date when the records were made, or in the case of the following records until permit surrender:
    - (i) off-site environmental effects; and
    - (ii) matters which affect the condition of the land and groundwater.

4.1.2 The Operator shall keep on site all records, plans and the management system required to be maintained by this permit, unless otherwise agreed in writing by the Environment Agency.

## 4.2 Reporting

4.2.1 The Operator shall send all reports and notifications required by the permit to the Environment Agency using the contact details supplied in writing by the Environment Agency.

4.2.2 A report or reports on the performance of the activities over the previous year shall be submitted to the Environment Agency by 31 January (or other date agreed in writing by the Environment Agency) each year. The report(s) shall include as a minimum:

- (a) a review of the results of the monitoring and assessment carried out in accordance with the permit including an interpretive review of that data;
- (b) the annual production/treatment data set out in schedule 4 table S4.2; and
- (c) the performance parameters set out in schedule 4 table S4.3 using the forms specified in table S4.4 of that schedule.

4.2.3 Within 28 days of the end of the reporting period the Operator shall, unless otherwise agreed in writing by the Environment Agency, submit reports of the monitoring and assessment carried out in accordance with the conditions of this permit, as follows:

- (a) in respect of the parameters and emission points specified in schedule 4 table S4.1;
- (b) for the reporting periods specified in schedule 4 table S4.1 and using the forms specified in schedule 4 table S4.4; and
- (c) giving the information from such results and assessments as may be required by the forms specified in those tables.

4.2.4 The Operator shall, unless notice under this condition has been served within the preceding four years, submit to the Environment Agency, within six months of receipt of a written notice, a report assessing whether there are other appropriate measures that could be taken to prevent, or where that is not practicable, to minimise pollution.

## 4.3 Notifications

4.3.1 In the event:

- (a) that the operation of the activities gives rise to an incident or accident which significantly affects or may significantly affect the environment, the Operator must immediately—
  - (i) inform the Environment Agency,
  - (ii) take the measures necessary to limit the environmental consequences of such an incident or accident, and
  - (iii) take the measures necessary to prevent further possible incidents or accidents;
- (b) of a breach of any permit condition the Operator must immediately—
  - (i) inform the Environment Agency, and
  - (ii) take the measures necessary to ensure that compliance is restored within the shortest possible time;
- (c) of a breach of permit condition which poses an immediate danger to human health or threatens to cause an immediate significant adverse effect on the environment, the Operator must immediately suspend the operation of the activities or the relevant part of it until compliance with the permit conditions has been restored.

- 4.3.2 Any information provided under condition 4.3.1 shall be confirmed by sending the information listed in schedule 5 to this permit within the time period specified in that schedule.
- 4.3.3 Where the Environment Agency has requested in writing that it shall be notified when the Operator is to undertake monitoring and/or spot sampling, the Operator shall inform the Environment Agency when the relevant monitoring and/or spot sampling is to take place. The Operator shall provide this information to the Environment Agency at least 14 days before the date the monitoring is to be undertaken.
- 4.3.4 The Environment Agency shall be notified within 14 days of the occurrence of the following matters, except where such disclosure is prohibited by Stock Exchange rules:
- Where the Operator is a registered company:
- (a) any change in the Operator's trading name, registered name or registered office address; and
  - (b) any steps taken with a view to the Operator going into administration, entering into a company voluntary arrangement or being wound up.
- Where the Operator is a corporate body other than a registered company:
- (a) any change in the Operator's name or address; and
  - (b) any steps taken with a view to the dissolution of the Operator.
- In any other case:
- (a) the death of any of the named Operators (where the Operator consists of more than one named individual);
  - (b) any change in the Operator's name(s) or address(es); and
  - (c) any steps taken with a view to the Operator, or any one of them, going into bankruptcy, entering into a composition or arrangement with creditors, or, in the case of them being in a partnership, dissolving the partnership.
- 4.3.5 Where the Operator proposes to make a change in the nature or functioning, or an extension of the activities, which may have consequences for the environment and the change is not otherwise the subject of an application for approval under the Regulations or this permit:
- (a) the Environment Agency shall be notified at least 14 days before making the change; and
  - (b) the notification shall contain a description of the proposed change in operation.
- 4.3.6 The Environment Agency shall be given at least 14 days' notice before implementation of any part of the site closure plan.
- 4.3.7 Where the Operator has entered into a climate change agreement with the Government, the Environment Agency shall be notified within one month of:
- (a) a decision by the Secretary of State not to re-certify the agreement;
  - (b) a decision by either the Operator or the Secretary of State to terminate the agreement; and
  - (c) any subsequent decision by the Secretary of State to re-certify such an agreement.

## **4.4 Interpretation**

- 4.4.1 In this permit the expressions listed in schedule 6 shall have the meaning given in that schedule.
- 4.4.2 In this permit references to reports and notifications mean written reports and notifications, except where reference is made to notification being made "immediately", in which case it may be provided by telephone.

# Schedule 1 – Operations

| <b>Table S1.1 activities</b>        |                                                            |                                                                                                                                                                                                                                                                                                                                                                                 |                                                                                                                                                                                                                                                                    |
|-------------------------------------|------------------------------------------------------------|---------------------------------------------------------------------------------------------------------------------------------------------------------------------------------------------------------------------------------------------------------------------------------------------------------------------------------------------------------------------------------|--------------------------------------------------------------------------------------------------------------------------------------------------------------------------------------------------------------------------------------------------------------------|
| <b>Activity reference</b>           | <b>Activity listed in Schedule 1 of the EP Regulations</b> | <b>Description of specified activity</b>                                                                                                                                                                                                                                                                                                                                        | <b>Limits of specified activity</b>                                                                                                                                                                                                                                |
| AR1                                 | Section 6.8 Part A1 (d) (i)                                | Treatment and processing, other than exclusively packaging, of the following raw materials, whether previously processed or unprocessed, intended for the production of food or feed (where the weight of the finished product excludes packaging) only animal raw materials (other than milk only) with a finished product production capacity greater than 75 tonnes per day. | From receipt of raw materials such as meat and pastry goods delivered to the site to production of finished product including storage and dispatch off-site of savoury and ready to eat food products.<br><br>Production capacity is limited to 85 tonnes per day. |
| <b>Directly Associated Activity</b> |                                                            |                                                                                                                                                                                                                                                                                                                                                                                 |                                                                                                                                                                                                                                                                    |
| AR2                                 | Steam supply                                               | Medium Combustion plants: 2 x 1.8 MWth natural gas fired boilers (A30 & A31)                                                                                                                                                                                                                                                                                                    | From receipt of fuel to release of products of combustion to air.                                                                                                                                                                                                  |
| AR3                                 | Operations of ovens                                        | x15 baking turnover products oven (A1-A15), x14 baking pork pies oven (A16-A29)                                                                                                                                                                                                                                                                                                 | From receipt of fuel to release of products of combustion to air.                                                                                                                                                                                                  |
| AR4                                 | Raw material storage and handling                          | Storage and handling of raw materials at the installation                                                                                                                                                                                                                                                                                                                       | From receipt of raw materials to dispatch of final product.                                                                                                                                                                                                        |
| AR5                                 | Use of refrigerants                                        | Use of refrigerants in cooling, chilling and/or freezing systems at the installation.                                                                                                                                                                                                                                                                                           | From receipt of raw materials to dispatch of final product.                                                                                                                                                                                                        |
| AR6                                 | Storage and use of chemicals and oils                      | Storage and use of chemicals and oils at the installation.                                                                                                                                                                                                                                                                                                                      | From receipt of chemicals and oils to disposal of wastes arising.                                                                                                                                                                                                  |
| AR7                                 | Waste storage and handling                                 | Storage and handling of waste materials                                                                                                                                                                                                                                                                                                                                         | From generation of waste to storage pending removal for disposal or recovery.                                                                                                                                                                                      |
| AR8                                 | Surface water drainage.                                    | Collection of uncontaminated site surface waters.                                                                                                                                                                                                                                                                                                                               | Handling and storage of site drainage until discharge to the site surface water system.                                                                                                                                                                            |

| <b>Table S1.2 Operating techniques</b>                                        |                                                                                                                                                                                                                                                                                                                                                          |                      |
|-------------------------------------------------------------------------------|----------------------------------------------------------------------------------------------------------------------------------------------------------------------------------------------------------------------------------------------------------------------------------------------------------------------------------------------------------|----------------------|
| <b>Description</b>                                                            | <b>Parts</b>                                                                                                                                                                                                                                                                                                                                             | <b>Date Received</b> |
| Application<br>ZP3532PN/A001                                                  | The response to questions 2.1 and 2.2 given in sections B2.1 to B2.2 of the application template form PPC1, pages 11 to 39.                                                                                                                                                                                                                              | 02/09/2004           |
| Regulation 61 (1) Notice<br>– Responses to questions dated 03/08/2022         | All parts                                                                                                                                                                                                                                                                                                                                                | 03/03/2023           |
| Regulation 61(1) Notice<br>– request for further information dated 28/10/2024 | Information requested in relation to Reg.61 response tool concerning BATc 3, 6, 7, 9, 11, 12, 15, and non-narrative BAT in relation to production/capacity threshold, H1 assessment, soil & groundwater risk assessment (baseline report), relevant hazardous substances, climate change adaptation plan, containment, regulated activity and site plan. | 11/11/2024           |
| Regulation 61(1) Notice<br>– request for further information dated 13/11/2024 | Information requested in relation to Reg.61 response tool concerning BATc 29 EPL's.                                                                                                                                                                                                                                                                      | 19/11/2024           |

| <b>Table S1.3 Improvement programme requirements</b> |                                                                                                                                                                                                                                                                                                                                                                                                                                                                                                                                                                                                                                                                                                         |                                                                                                        |
|------------------------------------------------------|---------------------------------------------------------------------------------------------------------------------------------------------------------------------------------------------------------------------------------------------------------------------------------------------------------------------------------------------------------------------------------------------------------------------------------------------------------------------------------------------------------------------------------------------------------------------------------------------------------------------------------------------------------------------------------------------------------|--------------------------------------------------------------------------------------------------------|
| <b>Reference</b>                                     | <b>Requirement</b>                                                                                                                                                                                                                                                                                                                                                                                                                                                                                                                                                                                                                                                                                      | <b>Date</b>                                                                                            |
| IC8                                                  | The operator shall confirm, achievement of the 'Narrative' BAT conclusions as identified in the Food, Drink and Milk Bref published on 4 December 2019 where BAT is currently not demonstrated or achieved with respect to BATc 3, 11 and 12.<br><br>Refer to BAT Conclusions for a full description of the BAT requirement.                                                                                                                                                                                                                                                                                                                                                                            | 3 months from date of permit issue or as agreed in writing by the Environment Agency<br><br>06/03/2025 |
| IC9                                                  | The operator shall submit, for approval by the Environment Agency, a report demonstrating achievement of the 'Narrative' BAT conclusions as identified in the Food, Drink and Milk Bref published on 4 December 2019 where BAT is currently not demonstrated or achieved. The report shall include, but not be limited to, the following: <ul style="list-style-type: none"> <li>• Methodology applied for achieving BAT</li> <li>• Demonstrating that BAT has been achieved.</li> </ul><br>The report shall address the BAT Conclusions for Food, Drink and Milk Industries with respect to BATc 6a energy efficiency plan.<br>Refer to BAT Conclusions for a full description of the BAT requirement. | 3 months from date of permit issue or as agreed in writing by the Environment Agency<br><br>06/03/2025 |
| IC10                                                 | The operator shall use refrigerants without ozone depletion potential and with a low global warming potential (GWP) in accordance with BAT 9 from the Food, Drink and Milk Industries BATCs.<br><br>To demonstrate compliance against BAT 9, the operator shall produce a plan for the onsite refrigerant system(s) at the installation. The plan is to be assessed by the Environment Agency and shall be incorporated within the existing environmental management system.                                                                                                                                                                                                                            | 3 months from date of permit issue or as agreed in writing by the Environment Agency<br><br>06/03/2025 |

| <b>Table S1.3 Improvement programme requirements</b> |                                                                                                                                                                                                                                                                                                                                                                                                                                                                                                                                                                                                                                                                                                                                                                                    |                                                                                                             |
|------------------------------------------------------|------------------------------------------------------------------------------------------------------------------------------------------------------------------------------------------------------------------------------------------------------------------------------------------------------------------------------------------------------------------------------------------------------------------------------------------------------------------------------------------------------------------------------------------------------------------------------------------------------------------------------------------------------------------------------------------------------------------------------------------------------------------------------------|-------------------------------------------------------------------------------------------------------------|
| <b>Reference</b>                                     | <b>Requirement</b>                                                                                                                                                                                                                                                                                                                                                                                                                                                                                                                                                                                                                                                                                                                                                                 | <b>Date</b>                                                                                                 |
|                                                      | <p>The plan should include, but not be limited to, the following:</p> <ul style="list-style-type: none"> <li>Where practicable, retro filling systems containing high GWP refrigerants e.g. R-404A with lower GWP alternatives as soon as possible.</li> </ul> <p>An action log with timescales, for replacement of end-of-life equipment using refrigerants with the lowest practicable GWP.</p>                                                                                                                                                                                                                                                                                                                                                                                  |                                                                                                             |
| IC11                                                 | <p>The Operator shall submit a written report to the Environment Agency for technical assessment and approval on the feasibility of installing effluent treatment and include a review of treatment options available along with their associated benefits. Justification is required where no on-site treatment is provided, taking into account the nature of the wastewater and any subsequent off-site treatment. In addition the report needs to consider the appropriate on-site monitoring of the effluent stream prior to disposal. (BAT 3, 4 and 12 Best Available Techniques Reference Document and BAT Conclusions document for the food, drink and milk industry dated December 2019).</p>                                                                             | <p>12 months from date of permit issue or as agreed in writing by the Environment Agency<br/>06/12/2025</p> |
| IC12                                                 | <p>The Operator shall undertake a survey of the waste water buffer storage at the site and review measures against relevant standard including:</p> <p>The operator shall submit a written report that meets the Narrative BAT requirements for the BAT Conclusions for Food, Drink and Milk Industries with respect to BAT 11, to the Environment Agency for approval, outlining the results of the survey and the review of feasibility of options and provide details of:</p> <ul style="list-style-type: none"> <li>current containment measures</li> <li>improvements proposed</li> <li>time scale for implementation of improvements.</li> </ul> <p>The operator shall implement the proposed improvements in line with the timescales agreed by the Environment Agency.</p> | <p>12 months from date of permit issue or as agreed in writing by the Environment Agency<br/>06/12/2025</p> |
| IC13                                                 | <p>The operator shall review and update the H1 risk assessment at the capacity levels stated within table S1.1 of this permit. The H1 shall be submitted to the Environment Agency for review.</p>                                                                                                                                                                                                                                                                                                                                                                                                                                                                                                                                                                                 | <p>12 months from date of permit issue or as agreed in writing by the Environment Agency<br/>06/12/2025</p> |
| IC14                                                 | <p>The Operator shall produce a Site Condition Report (SCR) in line with our H5 Guidance. The report shall contain the information necessary to determine the state of soil and groundwater, and ensure this is maintained throughout the life of the permit by using the results to better inform the SPMP. The report shall be submitted to the Environment Agency for review.</p>                                                                                                                                                                                                                                                                                                                                                                                               | <p>12 months from date of permit issue or as agreed in writing by the Environment Agency<br/>06/12/2025</p> |
| IC15                                                 | <p>The operator shall submit to the Environment Agency for approval a risk assessment considering the possibility of soil and groundwater</p>                                                                                                                                                                                                                                                                                                                                                                                                                                                                                                                                                                                                                                      | <p>12 months from date of permit</p>                                                                        |

| <b>Table S1.3 Improvement programme requirements</b> |                                                                                                                                                                                                                                                                                                                                                                                                                                                                                                                                                                                                                                                                                                                                                                                                                                                                                                                                                                                                                                                                                                                                                                                                                |                                                                                                                |
|------------------------------------------------------|----------------------------------------------------------------------------------------------------------------------------------------------------------------------------------------------------------------------------------------------------------------------------------------------------------------------------------------------------------------------------------------------------------------------------------------------------------------------------------------------------------------------------------------------------------------------------------------------------------------------------------------------------------------------------------------------------------------------------------------------------------------------------------------------------------------------------------------------------------------------------------------------------------------------------------------------------------------------------------------------------------------------------------------------------------------------------------------------------------------------------------------------------------------------------------------------------------------|----------------------------------------------------------------------------------------------------------------|
| <b>Reference</b>                                     | <b>Requirement</b>                                                                                                                                                                                                                                                                                                                                                                                                                                                                                                                                                                                                                                                                                                                                                                                                                                                                                                                                                                                                                                                                                                                                                                                             | <b>Date</b>                                                                                                    |
|                                                      | <p>contamination at the installation where the activity involves the use, production or release of a hazardous substances (as defined in Article 3 of Regulation (EC) No. 1272/2008 on classification, labelling and packaging of substances and mixtures).</p> <p>A stage 1-3 assessment should be completed (as detailed within the EC Commission Guidance 2014/C 136/-3) as follows;</p> <p>Stage 1 – Identify hazardous substance(s) used / stored on site.</p> <p>Stage 2 – Identify if the hazardous substance(s) are capable of causing pollution. If they are capable of causing pollution, they are then termed Relevant Hazardous Substances (RHS).</p> <p>Stage 3 – Identify if pollution prevention measures &amp; drains are fit for purpose in areas where hazardous substances are used / stored.</p> <p>If the outcomes of Stage 3 identifies that pollution of soil / ground water to be possible. The operator shall produce and submit a monitoring plan to the Environment Agency for approval detailing how the substance(s) will be monitored to demonstrate no pollution. The operator shall commence monitoring of the RHS within a timescale as agreed by the Environment Agency.</p> | <p>issue or as agreed in writing by the Environment Agency</p> <p>06/12/2025</p>                               |
| IC16                                                 | <p>The operator shall produce a climate change adaptation plan, which will form part of the EMS.</p> <p>The plan shall include, but not be limited to:</p> <ul style="list-style-type: none"> <li>• Details of how the installation has or could be affected by severe weather;</li> <li>• The scale of the impact of severe weather on the operations within the installation;</li> <li>• An action plan and timetable for any improvements to be made to minimise the impact of severe weather at the installation.</li> </ul> <p>The Operator shall implement any necessary improvements to a timetable agreed in writing with the Environment Agency.</p>                                                                                                                                                                                                                                                                                                                                                                                                                                                                                                                                                  | <p>12 months from date of permit issue or as agreed in writing by the Environment Agency</p> <p>06/12/2025</p> |
| IC17                                                 | <p>The Operator shall undertake a survey of the primary, secondary and tertiary containment at the site and review measures against relevant standard including:</p> <ul style="list-style-type: none"> <li>• CIRIA Containment systems for the prevention of pollution (C736) – Secondary, tertiary and other measures for industrial and commercial premises,</li> <li>• EEMUA 159 - Above ground flat bottomed storage tanks</li> </ul> <p>The operator shall submit a written report to the Environment Agency approval which outlines the results of the survey and the review of standard and provide details of</p> <ul style="list-style-type: none"> <li>• current containment measures</li> <li>• any deficiencies identified in comparison to relevant standards,</li> <li>• improvements proposed</li> <li>• time scale for implementation of improvements.</li> </ul> <p>The operator shall implement the proposed improvements in line with the timescales agreed by the Environment Agency.</p>                                                                                                                                                                                                 | <p>12 months from date of permit issue or as agreed in writing by the Environment Agency</p> <p>06/12/2025</p> |



## Schedule 2 – Waste types, raw materials and fuels

| Table S2.1 Raw materials and fuels |               |
|------------------------------------|---------------|
| Raw materials and fuel description | Specification |
| --                                 | --            |

## Schedule 3 – Emissions and monitoring

| Table S3.1 Point source emissions to air – emission limits and monitoring requirements |                                          |                   |                        |                  |                      |                               |
|----------------------------------------------------------------------------------------|------------------------------------------|-------------------|------------------------|------------------|----------------------|-------------------------------|
| Emission point ref. & location on site plan ZP3532 PN DOC 5A in Schedule 7             | Source                                   | Parameter         | Limit (including unit) | Reference period | Monitoring frequency | Monitoring standard or method |
| A1                                                                                     | PL2 Oven - Baking turnover products oven | No parameters set | No limit set           | --               | --                   | --                            |
| A2                                                                                     | PL2 Oven - Baking turnover products oven | No parameters set | No limit set           | --               | --                   | --                            |
| A3                                                                                     | PL2 Oven - Baking turnover products oven | No parameters set | No limit set           | --               | --                   | --                            |
| A4                                                                                     | PL2 Oven - Baking turnover products oven | No parameters set | No limit set           | --               | --                   | --                            |
| A5                                                                                     | PL2 Oven - Baking turnover products oven | No parameters set | No limit set           | --               | --                   | --                            |
| A6                                                                                     | PL2 Oven - Baking turnover products oven | No parameters set | No limit set           | --               | --                   | --                            |
| A7                                                                                     | PL2 Oven - Baking turnover products oven | No parameters set | No limit set           | --               | --                   | --                            |
| A8                                                                                     | PL1 Oven - Baking turnover products oven | No parameters set | No limit set           | --               | --                   | --                            |
| A9                                                                                     | PL1 Oven - Baking turnover products oven | No parameters set | No limit set           | --               | --                   | --                            |

| <b>Table S3.1 Point source emissions to air – emission limits and monitoring requirements</b> |                                          |                   |                               |                         |                             |                                      |
|-----------------------------------------------------------------------------------------------|------------------------------------------|-------------------|-------------------------------|-------------------------|-----------------------------|--------------------------------------|
| <b>Emission point ref. &amp; location on site plan ZP3532 PN DOC 5A in Schedule 7</b>         | <b>Source</b>                            | <b>Parameter</b>  | <b>Limit (including unit)</b> | <b>Reference period</b> | <b>Monitoring frequency</b> | <b>Monitoring standard or method</b> |
| A10                                                                                           | PL1 Oven - Baking turnover products oven | No parameters set | No limit set                  | --                      | --                          | --                                   |
| A11                                                                                           | PL1 Oven - Baking turnover products oven | No parameters set | No limit set                  | --                      | --                          | --                                   |
| A12                                                                                           | PL1 Oven - Baking turnover products oven | No parameters set | No limit set                  | --                      | --                          | --                                   |
| A13                                                                                           | PL1 Oven - Baking turnover products oven | No parameters set | No limit set                  | --                      | --                          | --                                   |
| A14                                                                                           | PL1 Oven - Baking turnover products oven | No parameters set | No limit set                  | --                      | --                          | --                                   |
| A15                                                                                           | PL1 Oven - Baking turnover products oven | No parameters set | No limit set                  | --                      | --                          | --                                   |
| A16                                                                                           | 5/11 OZ Oven - Baking pork pies oven     | No parameters set | No limit set                  | --                      | --                          | --                                   |
| A17                                                                                           | 5/11 OZ Oven - Baking pork pies oven     | No parameters set | No limit set                  | --                      | --                          | --                                   |
| A18                                                                                           | 5/11 OZ Oven - Baking pork pies oven     | No parameters set | No limit set                  | --                      | --                          | --                                   |
| A19                                                                                           | 5/11 OZ Oven - Baking pork pies oven     | No parameters set | No limit set                  | --                      | --                          | --                                   |

| Table S3.1 Point source emissions to air – emission limits and monitoring requirements |                                                                                |                                                                           |                        |                  |                      |                               |
|----------------------------------------------------------------------------------------|--------------------------------------------------------------------------------|---------------------------------------------------------------------------|------------------------|------------------|----------------------|-------------------------------|
| Emission point ref. & location on site plan ZP3532 PN DOC 5A in Schedule 7             | Source                                                                         | Parameter                                                                 | Limit (including unit) | Reference period | Monitoring frequency | Monitoring standard or method |
| A20                                                                                    | Snack Oven - Baking pork pies oven                                             | No parameters set                                                         | No limit set           | --               | --                   | --                            |
| A21                                                                                    | Snack Oven - Baking pork pies oven                                             | No parameters set                                                         | No limit set           | --               | --                   | --                            |
| A22                                                                                    | Snack Oven - Baking pork pies oven                                             | No parameters set                                                         | No limit set           | --               | --                   | --                            |
| A23                                                                                    | Snack Oven - Baking pork pies oven                                             | No parameters set                                                         | No limit set           | --               | --                   | --                            |
| A24                                                                                    | Snack Oven - Baking pork pies oven                                             | No parameters set                                                         | No limit set           | --               | --                   | --                            |
| A25                                                                                    | Snack Oven - Baking pork pies oven                                             | No parameters set                                                         | No limit set           | --               | --                   | --                            |
| A26                                                                                    | Rack Oven - Baking pork pies oven                                              | No parameters set                                                         | No limit set           | --               | --                   | --                            |
| A27                                                                                    | Rack Oven - Baking pork pies oven                                              | No parameters set                                                         | No limit set           | --               | --                   | --                            |
| A28                                                                                    | Rack Oven - Baking pork pies oven                                              | No parameters set                                                         | No limit set           | --               | --                   | --                            |
| A29                                                                                    | Rack Oven - Baking pork pies oven                                              | No parameters set                                                         | No limit set           | --               | --                   | --                            |
| A30                                                                                    | Boiler plant 1<br>1.8 MWth natural gas fired boiler<br><small>[Note 1]</small> | Oxides of Nitrogen (NO and NO <sub>2</sub> expressed as NO <sub>x</sub> ) | 250 mg/m <sup>3</sup>  | Periodic         | Every three years    | BS EN 14792                   |
|                                                                                        |                                                                                | Carbon monoxide                                                           | No Limit               | Periodic         | Every three years    | MCERTS                        |

| <b>Table S3.1 Point source emissions to air – emission limits and monitoring requirements</b>                                                                        |                                                                 |                                                                           |                               |                         |                             |                                      |
|----------------------------------------------------------------------------------------------------------------------------------------------------------------------|-----------------------------------------------------------------|---------------------------------------------------------------------------|-------------------------------|-------------------------|-----------------------------|--------------------------------------|
| <b>Emission point ref. &amp; location on site plan ZP3532 PN DOC 5A in Schedule 7</b>                                                                                | <b>Source</b>                                                   | <b>Parameter</b>                                                          | <b>Limit (including unit)</b> | <b>Reference period</b> | <b>Monitoring frequency</b> | <b>Monitoring standard or method</b> |
|                                                                                                                                                                      |                                                                 |                                                                           |                               |                         |                             | BS EN15058                           |
| A31                                                                                                                                                                  | Boiler plant 2<br>1.8 MWth natural gas fired boiler<br>[Note 1] | Oxides of Nitrogen (NO and NO <sub>2</sub> expressed as NO <sub>x</sub> ) | 250 mg/m <sup>3</sup>         | Periodic                | Every three years           | BS EN 14792                          |
|                                                                                                                                                                      |                                                                 | Carbon monoxide                                                           | No Limit                      | Periodic                | Every three years           | MCERTS<br>BS EN15058                 |
| Note 1: The emission monitoring and limits requirements apply from 1 January 2030, unless otherwise advised by the Environment Agency and if the boiler is replaced. |                                                                 |                                                                           |                               |                         |                             |                                      |

| <b>Table S3.2 Point Source emissions to water (other than sewer) and land – emission limits and monitoring requirements</b> |                               |                  |                           |                         |                             |                                      |
|-----------------------------------------------------------------------------------------------------------------------------|-------------------------------|------------------|---------------------------|-------------------------|-----------------------------|--------------------------------------|
| <b>Emission point ref. &amp; location on Site Plan in Schedule 7</b>                                                        | <b>Source</b>                 | <b>Parameter</b> | <b>Limit (incl. unit)</b> | <b>Reference Period</b> | <b>Monitoring frequency</b> | <b>Monitoring standard or method</b> |
| W1 emission to Tottle Brook                                                                                                 | Uncontaminated surface runoff | No parameter set | No limit set              | --                      | --                          | --                                   |
| W2 emission to Tottle Brook                                                                                                 | Uncontaminated surface runoff | No parameter set | No limit set              | --                      | --                          | --                                   |

**Table S3.3 Point source emissions to sewer, effluent treatment plant or other transfers off-site– emission limits and monitoring requirements**

| <b>Emission point ref. &amp; location on Site Plan in Schedule 7</b> | <b>Source</b>                       | <b>Parameter</b>  | <b>Limit (incl. Unit)</b> | <b>Reference period</b> | <b>Monitoring frequency</b> | <b>Monitoring standard or method</b> |
|----------------------------------------------------------------------|-------------------------------------|-------------------|---------------------------|-------------------------|-----------------------------|--------------------------------------|
| S1 emission to Severn Trent Water Sewage Treatment Works             | Trade effluent from meat processing | No parameters Set | No limit set              | --                      | --                          | --                                   |

## Schedule 4 – Reporting

Parameters, for which reports shall be made, in accordance with conditions of this permit, are listed below.

| <b>Table S4.1 Reporting of monitoring data</b>                             |                                               |                                                                                                                                   |                                                                       |
|----------------------------------------------------------------------------|-----------------------------------------------|-----------------------------------------------------------------------------------------------------------------------------------|-----------------------------------------------------------------------|
| <b>Parameter</b>                                                           | <b>Emission or monitoring point/reference</b> | <b>Reporting period</b>                                                                                                           | <b>Period begins</b>                                                  |
| Point source emissions to air<br>Parameters as required by condition 3.5.1 | A30 & A31                                     | First monitoring undertaken in accordance with Condition 3.1.4 to be reported within 3 months, and then every 3 years thereafter. | From first monitoring requirements in accordance with Condition 3.1.4 |

| <b>Table S4.2: Annual production/treatment</b> |              |
|------------------------------------------------|--------------|
| <b>Parameter</b>                               | <b>Units</b> |
| Total product produced.                        | tonnes       |

| <b>Table S4.3 Performance parameters</b> |                                |                   |
|------------------------------------------|--------------------------------|-------------------|
| <b>Parameter</b>                         | <b>Frequency of assessment</b> | <b>Units</b>      |
| Water usage                              | Annually                       | m <sup>3</sup>    |
| Energy usage                             | Annually                       | MWh               |
| Waste                                    | Annually                       | Tonnes            |
| COD loss efficiency                      | Annually*                      | COD te/te product |
| Food waste                               | Annually                       | Tonnes            |

\*COD loss efficiency to be calculated on a weekly frequency, reported annually. Or equivalent calculation as agreed in writing by the Environment Agency.

| <b>Table S4.4 Reporting forms</b> |                                                                                                           |                                     |
|-----------------------------------|-----------------------------------------------------------------------------------------------------------|-------------------------------------|
| <b>Parameter</b>                  | <b>Reporting form</b>                                                                                     | <b>Form version number and date</b> |
| Point source emissions to air     | Emissions to Air Reporting Form, or other form as agreed in writing by the Environment Agency             | Version 1, 08/03/2021               |
| Water usage                       | Water Usage Reporting Form, or other form as agreed in writing by the Environment Agency                  | Version 1, 08/03/2021               |
| Energy usage                      | Energy Usage Reporting Form, or other form as agreed in writing by the Environment Agency                 | Version 1, 08/03/2021               |
| Food Waste                        | Food waste Reporting Form, or other form as agreed in writing by the Environment Agency                   | Version 1<br>06/02/2023             |
| Other performance parameters      | Other Performance Parameters Reporting Form, or other form as agreed in writing by the Environment Agency | Version 1, 08/03/2021               |

# Schedule 5 – Notification

These pages outline the information that the Operator must provide.

Units of measurement used in information supplied under Part A and B requirements shall be appropriate to the circumstances of the emission. Where appropriate, a comparison should be made of actual emissions and authorised emission limits.

If any information is considered commercially confidential, it should be separated from non-confidential information, supplied on a separate sheet and accompanied by an application for commercial confidentiality under the provisions of the EP Regulations.

## Part A

|                                |  |
|--------------------------------|--|
| Permit Number                  |  |
| Name of Operator               |  |
| Location of Facility           |  |
| Time and date of the detection |  |

|                                                                                                                                                                                                                                                     |  |
|-----------------------------------------------------------------------------------------------------------------------------------------------------------------------------------------------------------------------------------------------------|--|
| <b>(a) Notification requirements for any malfunction, breakdown or failure of equipment or techniques, accident, or emission of a substance not controlled by an emission limit which has caused, is causing or may cause significant pollution</b> |  |
| <b>To be notified within 24 hours of detection</b>                                                                                                                                                                                                  |  |
| Date and time of the event                                                                                                                                                                                                                          |  |
| Reference or description of the location of the event                                                                                                                                                                                               |  |
| Description of where any release into the environment took place                                                                                                                                                                                    |  |
| Substances(s) potentially released                                                                                                                                                                                                                  |  |
| Best estimate of the quantity or rate of release of substances                                                                                                                                                                                      |  |
| Measures taken, or intended to be taken, to stop any emission                                                                                                                                                                                       |  |
| Description of the failure or accident.                                                                                                                                                                                                             |  |

|                                                                                     |  |
|-------------------------------------------------------------------------------------|--|
| <b>(b) Notification requirements for the breach of a limit</b>                      |  |
| <b>To be notified within 24 hours of detection unless otherwise specified below</b> |  |
| Emission point reference/ source                                                    |  |
| Parameter(s)                                                                        |  |
| Limit                                                                               |  |
| Measured value and uncertainty                                                      |  |
| Date and time of monitoring                                                         |  |



|                                                                                     |  |
|-------------------------------------------------------------------------------------|--|
| <b>(b) Notification requirements for the breach of a limit</b>                      |  |
| <b>To be notified within 24 hours of detection unless otherwise specified below</b> |  |
| Measures taken, or intended to be taken, to stop the emission                       |  |

|                                                                                 |                            |
|---------------------------------------------------------------------------------|----------------------------|
| <b>Time periods for notification following detection of a breach of a limit</b> |                            |
| <b>Parameter</b>                                                                | <b>Notification period</b> |
|                                                                                 |                            |
|                                                                                 |                            |
|                                                                                 |                            |

|                                                                                                |  |
|------------------------------------------------------------------------------------------------|--|
| <b>(c) Notification requirements for the breach of permit conditions not related to limits</b> |  |
| <b>To be notified within 24 hours of detection</b>                                             |  |
| Condition breached                                                                             |  |
| Date, time and duration of breach                                                              |  |
| Details of the permit breach i.e. what happened including impacts observed.                    |  |
| Measures taken, or intended to be taken, to restore permit compliance.                         |  |

|                                                                                                        |  |
|--------------------------------------------------------------------------------------------------------|--|
| <b>(d) Notification requirements for the detection of any significant adverse environmental effect</b> |  |
| <b>To be notified within 24 hours of detection</b>                                                     |  |
| Description of where the effect on the environment was detected                                        |  |
| Substances(s) detected                                                                                 |  |
| Concentrations of substances detected                                                                  |  |
| Date of monitoring/sampling                                                                            |  |

**Part B – to be submitted as soon as practicable**

|                                                                                  |  |
|----------------------------------------------------------------------------------|--|
| Any more accurate information on the matters for notification under Part A.      |  |
| Measures taken, or intended to be taken, to prevent a recurrence of the incident |  |

|                                                                                                                                                        |  |
|--------------------------------------------------------------------------------------------------------------------------------------------------------|--|
| Measures taken, or intended to be taken, to rectify, limit or prevent any pollution of the environment which has been or may be caused by the emission |  |
| The dates of any unauthorised emissions from the facility in the preceding 24 months.                                                                  |  |

|           |  |
|-----------|--|
| Name*     |  |
| Post      |  |
| Signature |  |
| Date      |  |

\* authorised to sign on behalf of the Operator

## Schedule 6 – Interpretation

“accident” means an accident that may result in pollution.

“application” means the application for this permit, together with any additional information supplied by the Operator as part of the application and any response to a notice served under Schedule 5 to the EP Regulations.

“authorised officer” means any person authorised by the Environment Agency under section 108(1) of The Environment Act 1995 to exercise, in accordance with the terms of any such authorisation, any power specified in section 108(4) of that Act.

“EP Regulations” means The Environmental Permitting (England and Wales) Regulations SI 2016 No.1154 and words and expressions used in this permit which are also used in the Regulations have the same meanings as in those Regulations.

“emissions of substances not controlled by emission limits” means emissions of substances to air, water or land from the activities, either from the emission points specified in schedule 3 or from other localised or diffuse sources, which are not controlled by an emission limit.

“Food waste” reporting: Reporting of food waste to use a methodology such as the global Food Loss and Waste Accounting and Reporting Standard (FLW standard) , WRAP’s Target Measure Act initiative or similar.

“groundwater” means all water, which is below the surface of the ground in the saturation zone and in direct contact with the ground or subsoil.

“Industrial Emissions Directive” means DIRECTIVE 2010/75/EU OF THE EUROPEAN PARLIAMENT AND OF THE COUNCIL of 24 November 2010 on industrial emissions, as read in accordance with Schedule 1A to the Environmental Permitting (England and Wales) Regulations 2016.

“MCERTS” means the Environment Agency’s Monitoring Certification Scheme.

“Medium Combustion Plant” or “MCP” means a combustion plant with a rated thermal input equal to or greater than 1 MW but less than 50 MW. An “existing medium combustion plant” is combustion plant operating before 20 December 2018.

“Medium Combustion Plant Directive” or “MCPD” means Directive 2015/2193/EU of the European Parliament and of the Council on the limitation of emissions of certain pollutants into the air from medium combustion plants, as read in accordance with Schedule 1A to the Environmental Permitting (England and Wales) Regulations 2016.

“Pests” means Birds, Vermin and Insects.

Where a minimum limit is set for any emission parameter, for example pH, reference to exceeding the limit shall mean that the parameter shall not be less than that limit.

Unless otherwise stated, any references in this permit to concentrations of substances in emissions into air means:

- in relation to emissions from combustion processes, the concentration in dry air at a temperature of 273K, at a pressure of 101.3 kPa and with an oxygen content of 3% dry for liquid and gaseous fuels, 6% dry for solid fuels; and/or
- in relation to emissions from non-combustion sources, the concentration at a temperature of 273K and at a pressure of 101.3 kPa, with no correction for water vapour content

“year” means calendar year ending 31 December.

# Schedule 7 – Site plan

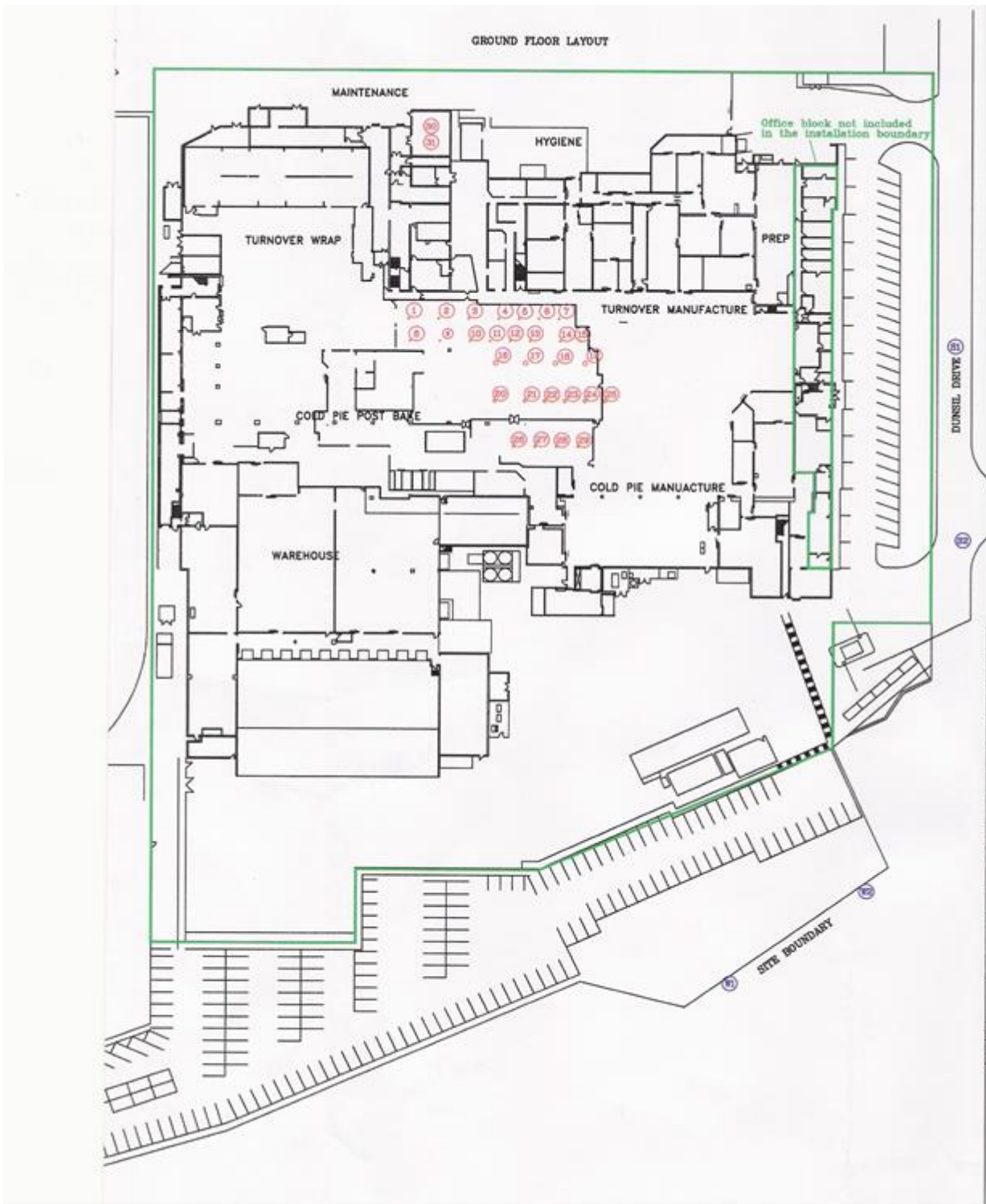

END OF PERMIT

