

Notice of variation and consolidation with introductory note

The Environmental Permitting (England & Wales) Regulations 2016

KSD Recycled Aggregates Limited

Dunton Recycling Centre
Lichfield Road
Near Curdworth
Sutton Coldfield
B76 0BB

Variation application number

EPR/GB3635RB/V004

Permit number

EPR/GB3635RB

Dunton Recycling Centre

Permit number EPR/GB3635RB

Introductory note

This introductory note does not form a part of the notice

Under the Environmental Permitting (England & Wales) Regulations 2016 (schedule 5, part 1, paragraph 19) a variation may comprise a consolidated permit reflecting the variations and a notice specifying the variations included in that consolidated permit.

Schedule 1 of the notice specifies the conditions that have been varied and schedule 2 comprises a consolidated permit which reflects the variations being made. Only the variations specified in schedule 1 are subject to a right of appeal.

Changes introduced by this variation notice:

This variation has been issued to update the permit following a statutory review of the permits in the industry sector for treatment of incinerator bottom ash.

The Industrial Emissions Directive (IED) came into force on 7th January 2014 with the requirement to implement all relevant Best Available Techniques (BAT) conclusions as described in the Commission Implementing Decision. The BAT conclusions for incineration were published on 03 December 2019 in the Official Journal of the European Union (L323) following a European Union wide review of BAT, implementing decision 2017/2117/EU of 21 November 2017.

The main features of the permit are as follows.

The Dunton Recycling Centre site (centred at SK 58049 28617) is located within an industrial area that also includes nearby residential properties. The site is located just off Junction 9 of the M42 off the A446 Lichfield Road, on the outskirts of Birmingham. The nearest local sensitive receptor is Dunton Hall, which is on the north-eastern boundary of the site. HS2 runs behind the north-west to east boundary of the site. The A446 trunk road runs along the southern boundary; Kingsbury Road to the west and the fields to the east. There are no watercourses near the site.

The environmental permit allows the operation of an Incinerator Bottom Ash recovery facility and a household, commercial and industrial waste transfer station.

The main installation is for the treatment of non-hazardous Incinerator Bottom Ash (IBA) by washing in a closed loop wet process to produce an Incinerator Bottom Ash Aggregate (IBAA), including metal extraction and separation of ferrous and non-ferrous metal. The installation facility is permitted to accept up to 100,000 tonnes of IBA per year and to carry out the following activities:

- S5.4 A(1) (b) (iii) - Recovery or a mix of recovery and disposal of non-hazardous waste with a capacity exceeding 75 tonnes per day involving treatment of slags and ashes.
- Storage of waste prior to treatment.
- Storage of wastes recovered from the IBA treatment processes.
- Collection and storage of process water in a storage tank.
- Collection and storage of site surface water via a sump in a storage tank.
- Storage of raw materials including fuel and lubrication oils.

Unprocessed IBA received at the site is stored outside up to 4 weeks in separate bays and batches under a traffic light system. Red bays are for IBA that has come in from a specific EfW plant. The incoming IBA batch is held pending the outcome of the test results to ascertain whether the waste is hazardous or non-hazardous. If the results show that the waste is non-hazardous, the bays are signed off as green and are ready to be processed on site. If the test results come back as hazardous, the batch is signed off as brown

pending its removal from site to an authorised landfill. The accepted IBA stockpile is processed through a washing plant. The IBA is fed into a rinser, and the wet process separates the fines (less than or equal to 4mm size fraction) from the aggregate to produce IBAA. The material goes through metal separation processes and then the IBAA is screened to fractions and stockpiled for reuse in the construction industry.

IBA pending processing is stored on an impermeable surface. The surface water runoff from the IBA storage area is captured in a separate drain, which runs to a water storage tank housed within the IBA plant. A French drain runs under the plant from the manhole within IBA storage area to a sump located within the IBA plant. Water from the sump is then pumped into a steel storage tank that sits on an impermeable concrete pad and has a capacity to hold 40,000 litres of water. The IBA treatment process is a closed loop system. Water generated from the process is collected and re-used in the washing process.

In addition to the IBA treatment activities, the site is also permitted to undertake physical treatment of up to 400,000 tonnes per year of non-hazardous waste. The treatment operations consist of sorting, separation, screening, crushing, washing and blending of waste to produce soil, soil substitutes and secondary aggregates for re-use in the construction industry in accordance with the WRAP Quality Protocol. Surface water runoff from the soil/aggregates production area is captured in a concrete wall lagoon and reused in the process.

All activities are carried out in the open. There are no channelled emissions to air or discharges from the site to sewer or controlled waters.

The status log of the permit sets out the permitting history, including any changes to the permit reference number.

Status log of permit		
Description	Date	Comments
Application received	Duly made 21/05/12	Application for use of waste materials for the production of aggregates.
Additional information received	16/05/12	Site condition report, site management plan and planning permission
Permit determined EAWML 104171	10/08/12	Original permit issued to KSD Recycled Aggregates Limited.
Application EPR/GB3635RB/V002 (variation and consolidation)	Duly made 23/03/15	Application to vary and update the permit to IED conditions
Variation determined	23/12/15	Varied and consolidated permit issued in modern condition format.
Application EPR/GB3635RB/V003 (variation and consolidation with EPR/GB3633RY)	Duly made 15/04/19	Application to vary and update the permit to modern conditions.
Variation determined	10/07/19	Varied and consolidated permit issued in modern condition format.
Environment Agency Non-hazardous Waste Sector Review Variation number EPR/GB3635RB/V004 (variation and consolidation)	19/07/23	Regulation 61 Notice requiring information for Statutory review of the permit against Waste Incineration BAT Conclusions published 12 December 2019 - documents received in response to the Regulation 61 Notice dated 14/04/2023, including documents titled 'BATC Return Spreadsheet, IBA Process Flow Chart & Plant List and Site Plan 2018.
Regulation 61 notice – response to Request for Further	07/05/24	Email containing response to questions 1 – 11 of the RFI, including the documents titled Site Plan

Status log of permit		
Description	Date	Comments
Information (RFI) dated 23/04/2024		Dunton, EMS Dunton 2024, Dunton Dust Management Plan.
	28/06/24	Email and the Site Layout Plan, drawing number LD162/DN/005, dated June 2024.
Additional information	04/09/24	Email received in response to the draft permit providing details about the waste operation activities, EWC codes, storage capacity of the IBAA and IBAA/other aggregates
Variation issued EPR/GB3635RB	20/11/24	Varied and consolidated permit issued.

End of introductory note

Notice of variation and consolidation

The Environmental Permitting (England and Wales) Regulations 2016

The Environment Agency in exercise of its powers under regulation 20 of the Environmental Permitting (England and Wales) Regulations 2016 varies

Permit number

EPR/GB3635RB

Issued to

KSD Recycled Aggregates Limited (“the operator”)

whose registered office is

**16 Binley Road
Gosford Green
Coventry
CV3 1HZ**

company registration number **04142553**

to operate regulated facilities at

**Dunton Recycling Centre
Lichfield Road
Near Curdworth
Sutton Coldfield
B76 0BB**

to the extent set out in the schedules.

The notice shall take effect from 20/11/2024.

Name	Date
Peter Maksymiw	20/11/2024

Authorised on behalf of the Environment Agency

Schedule 1

The following conditions and tables have been added/varied/deleted as a result of the Environment Agency Initiated Variation:

- Conditions 2.3.1 and 2.3.2 have been added because they are relevant installation conditions. The follow-on condition has been renumbered.
- Condition 2.3.5 of the previous variation has been deleted because the site is not accepting hazardous waste.
- Conditions 2.4.1 and 2.4.2 have been added to implement the improvement programmes associated with this variation.
- Condition 3.5.1 (a) of the previous variation has been deleted because there is no point source emission to surface water and/or sewer. Conditions 3.5.1 (a) and (b) have been added to implement the process and ambient air monitoring requirements introduced by this variation.
- Conditions 3.5.4 has been amended to replace the point source emission to sewer with the process monitoring table as Table S3.1 and add Table S3.2 for ambient air monitoring.
- Conditions 3.6.1 and 3.6.2 have been deleted because the operator is not storing combustible waste.
- Conditions 4.2.2 (b) and (c) have been amended to refer to the appropriate tables.
- Condition 4.2.3 has been added because it is a relevant installation condition. The follow-on conditions have been renumbered.
- Table S1.1 as referenced in Condition 2.1.1 has been amended to clearly define the activities that are undertaken at the site, to apply relevant restrictions to them and to add activity AR3.
- Table S1.2 as referenced in Conditions 2.3.1 and 2.3.2 has been added to incorporate operating technique documents submitted in response to the Regulation 61 Notice.
- Table S1.3 as referenced in Condition 2.4.1 has been added to implement the improvement conditions IC1 – IC7.
- Table S3.1 of the previous variation has been deleted because there is no point source emission to surface water and/or sewer.
- Table S3.1 as referenced in Conditions 3.5.1 (a) and 3.5.4 has been added for process monitoring of moisture content.
- Table S3.2 as referenced in Conditions 3.5.1 (b) and 3.5.4 has been added for ambient air monitoring of dust emissions.
- Table S4.1 as referenced in Conditions 4.2.3 (b) and (c) has been added to implement reporting of process and ambient air monitoring. The follow-on tables have been renumbered.
- Table S4.4 as referenced in Conditions 4.2.2 (c) and 4.2.3 (b) has been amended to include relevant forms.
- Schedule 6 as referenced in condition 4.4.1 has been amended by adding additional interpretations that are relevant to the changes made as a result of this variation and by updating/deleting some of the existing interpretations.

Schedule 2 – consolidated permit

Consolidated permit issued as a separate document.

Permit

The Environmental Permitting (England and Wales) Regulations 2016

Permit number

EPR/GB3635RB

This is the consolidated permit referred to in the variation and consolidation notice for application EPR/GB3635RB/V004 authorising,

KSD Recycled Aggregates Limited (“the operator”)

whose registered office is

**16 Binley Road
Gosford Green
Coventry
CV3 1HZ**

company registration number **04142553**

to operate an installation and waste operations at

**Dunton Recycling Centre
Lichfield Road
Near Curdworth
Sutton Coldfield
B76 0BB**

to the extent authorised by and subject to the conditions of this permit.

Name	Date
Peter Maksymiw	20/11/2024

Authorised on behalf of the Environment Agency

Conditions

1 Management

1.1 General management

- 1.1.1 The operator shall manage and operate the activities:
- (a) in accordance with a written management system that identifies and minimises risks of pollution, including those arising from operations, maintenance, accidents, incidents, non-conformances, closure and those drawn to the attention of the operator as a result of complaints; and
 - (b) using sufficient competent persons and resources.
- 1.1.2 Records demonstrating compliance with condition 1.1.1 shall be maintained.
- 1.1.3 Any person having duties that are or may be affected by the matters set out in this permit shall have convenient access to a copy of it kept at or near the place where those duties are carried out.
- 1.1.4 The operator shall comply with the requirements of an approved competence scheme.

1.2 Energy efficiency

- 1.2.1 For the following activities referenced in schedule 1, table S1.1 (AR1 to AR6), the operator shall:
- (a) take appropriate measures to ensure that energy is used efficiently in the activities;
 - (b) review and record at least every four years whether there are suitable opportunities to improve the energy efficiency of the activities; and
 - (c) take any further appropriate measures identified by a review.

1.3 Efficient use of raw materials

- 1.3.1 For the following activities referenced in schedule 1, table S1.1 (AR1 to AR6), the operator shall:
- (a) take appropriate measures to ensure that raw materials and water are used efficiently in the activities;
 - (b) maintain records of raw materials and water used in the activities;
 - (c) review and record at least every four years whether there are suitable alternative materials that could reduce environmental impact or opportunities to improve the efficiency of raw material and water use; and
 - (d) take any further appropriate measures identified by a review.

1.4 Avoidance, recovery and disposal of wastes produced by the activities

- 1.4.1 The operator shall take appropriate measures to ensure that:
- (a) the waste hierarchy referred to in Article 4 of the Waste Framework Directive is applied to the generation of waste by the activities; and
 - (b) any waste generated by the activities is treated in accordance with the waste hierarchy referred to in Article 4 of the Waste Framework Directive; and

(c) where disposal is necessary, this is undertaken in a manner which minimises its impact on the environment.

1.4.2 The operator shall review and record at least every four years whether changes to those measures should be made and take any further appropriate measures identified by a review.

2 Operations

2.1 Permitted activities

2.1.1 The operator is only authorised to carry out the activities specified in schedule 1 table S1.1 (the "activities").

2.1.2 For the following activities referenced in schedule 1, table S1.1 (AR1 to AR6), waste authorised by this permit shall be clearly distinguished from any other waste on the site.

2.2 The site

2.2.1 The activities shall not extend beyond the site, being the land shown edged in green on the site plan at schedule 7 to this permit.

2.3 Operating techniques

2.3.1 The activities shall, subject to the conditions of this permit, be operated using the techniques and in the manner described in the documentation specified in schedule 1, table S1.2, unless otherwise agreed in writing by the Environment Agency.

2.3.2 If notified by the Environment Agency that the activities are giving rise to pollution, the operator shall submit to the Environment Agency for approval within the period specified, a revision of any plan or other documentation ("plan") specified in schedule 1, table S1.2 or otherwise required under this permit which identifies and minimises the risks of pollution relevant to that plan, and shall implement the approved revised plan in place of the original from the date of approval, unless otherwise agreed in writing by the Environment Agency.

2.3.3 Any raw materials or fuels listed in schedule 2 table S2.1 shall conform to the specifications set out in that table.

2.3.4 Waste shall only be accepted if:

- (a) it is of a type and quantity listed in schedule 2 tables S2.2 and S2.3; and
- (b) it conforms to the description in the documentation supplied by the producer and holder.

2.3.5 The operator shall ensure that where waste produced by the activities is sent to a relevant waste operation, that operation is provided with the following information, prior to the receipt of the waste:

- (a) the nature of the process producing the waste;
- (b) the composition of the waste;
- (c) the handling requirements of the waste;
- (d) the hazardous property associated with the waste, if applicable; and
- (e) the waste code of the waste.

2.3.6 The operator shall ensure that where waste produced by the activities is sent to a landfill site, it meets the waste acceptance criteria for that landfill.

2.4 Improvement programme

- 2.4.1 The operator shall complete the improvements specified in schedule 1 table S1.3 by the date specified in that table unless otherwise agreed in writing by the Environment Agency.
- 2.4.2 Except in the case of an improvement which consists only of a submission to the Environment Agency, the operator shall notify the Environment Agency within 14 days of completion of each improvement.

3 Emissions and monitoring

3.1 Emissions to water, air or land

- 3.1.1 There shall be no point source emissions to water, air or land except from the sources and emission points listed in schedule 3 tables S3.1.
- 3.1.2 The limits given in schedule 3 shall not be exceeded.
- 3.1.3 Periodic monitoring shall be carried out at least once every 5 years for groundwater and 10 years for soil, unless such monitoring is based on a systematic appraisal of the risk of contamination.

3.2 Emissions of substances not controlled by emission limits

- 3.2.1 Emissions of substances not controlled by emission limits (excluding odour) shall not cause pollution. The operator shall not be taken to have breached this condition if appropriate measures, including, but not limited to, those specified in any approved emissions management plan, have been taken to prevent or where that is not practicable, to minimise, those emissions.
- 3.2.2 The operator shall:
- (a) if notified by the Environment Agency that the activities are giving rise to pollution, submit to the Environment Agency for approval within the period specified, an emissions management plan which identifies and minimises the risks of pollution from emissions of substances not controlled by emission limits;
 - (b) implement the approved emissions management plan, from the date of approval, unless otherwise agreed in writing by the Environment Agency.
- 3.2.3 All liquids in containers, whose emission to water or land could cause pollution, shall be provided with secondary containment, unless the operator has used other appropriate measures to prevent or where that is not practicable, to minimise, leakage and spillage from the primary container.

3.3 Odour

- 3.3.1 Emissions from the activities shall be free from odour at levels likely to cause pollution outside the site, as perceived by an authorised officer of the Environment Agency, unless the operator has used appropriate measures, including, but not limited to, those specified in any approved odour management plan, to prevent or where that is not practicable to minimise the odour.
- 3.3.2 The operator shall:
- (a) if notified by the Environment Agency that the activities are giving rise to pollution outside the site due to odour, submit to the Environment Agency for approval within the period specified, an odour management plan which identifies and minimises the risks of pollution from odour;
 - (b) implement the approved odour management plan, from the date of approval, unless otherwise agreed in writing by the Environment Agency.

3.4 Noise and vibration

- 3.4.1 Emissions from the activities shall be free from noise and vibration at levels likely to cause pollution outside the site, as perceived by an authorised officer of the Environment Agency, unless the operator has used appropriate measures, including, but not limited to, those specified in any approved noise and vibration management plan to prevent or where that is not practicable to minimise the noise and vibration.
- 3.4.2 The operator shall:
- (a) if notified by the Environment Agency that the activities are giving rise to pollution outside the site due to noise and vibration, submit to the Environment Agency for approval within the period specified, a noise and vibration management plan which identifies and minimises the risks of pollution from noise and vibration;
 - (b) implement the approved noise and vibration management plan, from the date of approval, unless otherwise agreed in writing by the Environment Agency.

3.5 Monitoring

- 3.5.1 The operator shall, unless otherwise agreed in writing by the Environment Agency, undertake the monitoring specified in the following tables in schedule 3 to this permit:
- (a) process monitoring specified in table S3.1; and
 - (b) ambient air monitoring specified in table S3.2.
- 3.5.2 The operator shall maintain records of all monitoring required by this permit including records of the taking and analysis of samples, instrument measurements (periodic and continual), calibrations, examinations, tests and surveys and any assessment or evaluation made on the basis of such data.
- 3.5.3 Monitoring equipment, techniques, personnel and organisations employed for the emissions monitoring programme and the environmental or other monitoring specified in condition 3.5.1 shall have either MCERTS certification or MCERTS accreditation (as appropriate), where available, unless otherwise agreed in writing by the Environment Agency.
- 3.5.4 Permanent means of access shall be provided to enable sampling/monitoring to be carried out in relation to the emission points specified in schedule 3 tables S3.1 and S3.2 unless otherwise agreed in writing by the Environment Agency.

4 Information

4.1 Records

- 4.1.1 All records required to be made by this permit shall:
- (a) be legible;
 - (b) be made as soon as reasonably practicable;
 - (c) if amended, be amended in such a way that the original and any subsequent amendments remain legible, or are capable of retrieval; and
 - (d) be retained, unless otherwise agreed in writing by the Environment Agency, for at least 6 years from the date when the records were made, or in the case of the following records until permit surrender:
 - (i) off-site environmental effects; and

- (ii) matters which affect the condition of the land and groundwater.

4.1.2 The operator shall keep on site all records, plans and the management system required to be maintained by this permit, unless otherwise agreed in writing by the Environment Agency.

4.2 Reporting

4.2.1 The operator shall send all reports and notifications required by the permit to the Environment Agency using the contact details supplied in writing by the Environment Agency.

4.2.2 For the following activities referenced in schedule 1, table S1.1 (AR1 to AR6), a report or reports on the performance of the activities over the previous year shall be submitted to the Environment Agency by 31 January (or other date agreed in writing by the Environment Agency) each year. The report(s) shall include as a minimum:

- (a) a review of the results of the monitoring and assessment carried out in accordance with the permit including an interpretive review of that data;
- (b) the annual production/treatment data set out in schedule 4 table S4.2; and
- (c) the performance parameters set out in schedule 4 table S4.3 using the forms specified in table S4.4 of that schedule.

4.2.3 Within 28 days of the end of the reporting period the operator shall, unless otherwise agreed in writing by the Environment Agency, submit reports of the monitoring and assessment carried out in accordance with the conditions of this permit, as follows:

- (a) in respect of the parameters and emission points specified in schedule 4 table S4.1;
- (b) for the reporting periods specified in schedule 4 table S4.1 and using the forms specified in schedule 4 table S4.4; and
- (c) giving the information from such results and assessments as may be required by the forms specified in those tables.

4.2.4 The operator shall, unless notice under this condition has been served within the preceding four years, submit to the Environment Agency, within six months of receipt of a written notice, a report assessing whether there are other appropriate measures that could be taken to prevent, or where that is not practicable, to minimise pollution.

4.2.5 Within 1 month of the end of each quarter, the operator shall submit to the Environment Agency using the form made available for the purpose, the information specified on the form relating to the site and the waste accepted and removed from it during the previous quarter.

4.3 Notifications

4.3.1 In the event:

- (a) that the operation of the activities gives rise to an incident or accident which significantly affects or may significantly affect the environment, the operator must immediately—
 - (i) inform the Environment Agency,
 - (ii) take the measures necessary to limit the environmental consequences of such an incident or accident, and
 - (iii) take the measures necessary to prevent further possible incidents or accidents;
- (b) of a breach of any permit condition the operator must immediately—
 - (i) inform the Environment Agency, and

(ii) take the measures necessary to ensure that compliance is restored within the shortest possible time;

(c) of a breach of permit condition which poses an immediate danger to human health or threatens to cause an immediate significant adverse effect on the environment, the operator must immediately suspend the operation of the activities or the relevant part of it until compliance with the permit conditions has been restored.

4.3.2 Any information provided under condition 4.3.1 shall be confirmed by sending the information listed in schedule 5 to this permit within the time period specified in that schedule.

4.3.3 Where the Environment Agency has requested in writing that it shall be notified when the operator is to undertake monitoring and/or spot sampling, the operator shall inform the Environment Agency when the relevant monitoring and/or spot sampling is to take place. The operator shall provide this information to the Environment Agency at least 14 days before the date the monitoring is to be undertaken.

4.3.4 The Environment Agency shall be notified within 14 days of the occurrence of the following matters, except where such disclosure is prohibited by Stock Exchange rules:

Where the operator is a registered company:

- (a) any change in the operator's trading name, registered name or registered office address; and
- (b) any steps taken with a view to the operator going into administration, entering into a company voluntary arrangement or being wound up.

Where the operator is a corporate body other than a registered company:

- (a) any change in the operator's name or address; and
- (b) any steps taken with a view to the dissolution of the operator.

In any other case:

- (a) the death of any of the named operators (where the operator consists of more than one named individual);
- (b) any change in the operator's name(s) or address(es); and
- (c) any steps taken with a view to the operator, or any one of them, going into bankruptcy, entering into a composition or arrangement with creditors, or, in the case of them being in a partnership, dissolving the partnership.

4.3.5 Where the operator proposes to make a change in the nature or functioning, or an extension of the activities, which may have consequences for the environment and the change is not otherwise the subject of an application for approval under the Regulations or this permit:

- (a) the Environment Agency shall be notified at least 14 days before making the change; and
- (b) the notification shall contain a description of the proposed change in operation.

4.3.6 The Environment Agency shall be given at least 14 days' notice before implementation of any part of the site closure plan.

4.4 Interpretation

4.4.1 In this permit the expressions listed in schedule 6 shall have the meaning given in that schedule.

4.4.2 In this permit references to reports and notifications mean written reports and notifications, except where reference is made to notification being made "immediately" in which case it may be provided by telephone.

Schedule 1 – Operations

Table S1.1 activities			
Activity reference	Activity listed in Schedule 1 of the EP Regulations	Description of specified activity and WFD Annex I and II operations	Limits of specified activity and waste types
AR1	S5.4 A(1) (b) (iii) Recovery or a mix of recovery and disposal of non-hazardous waste with a capacity exceeding 75 tonnes per day involving treatment of slags and ashes.	R4: Recycling/reclamation of metals and metal compounds. R5: Recycling/reclamation of other inorganic materials.	From receipt of permitted incinerator bottom ash (IBA) waste through to treatment and recovery of incinerator bottom ash aggregate (IBAA). Treatment consisting only of screening, separation and washing of IBA for recovery as IBAA. Treatment of IBA shall be on an impermeable surface with sealed drainage. There shall be no channelled emissions to air, surface water and/or sewer from this activity. Waste types as specified in Table S2.2.
Directly Associated Activity			
AR2	N/A	Storage of waste IBA prior to treatment R13: Storage of waste pending the operations numbered R1, R4 and R5 (excluding temporary storage, pending collection, on the site where it is produced).	From receipt of waste to transfer to the treatment processes. Storage of IBA shall be on impermeable surface with sealed drainage system. Waste stored under this activity shall not exceed 40,000 tonnes at any one time. There shall be no channelled emissions to air, surface water and/or sewer from this activity. No waste shall be stored for more than 12 months. Waste types as specified in Table S2.2.
AR3	N/A	Storage of recovered incinerator bottom ash aggregate (IBAA) and residual waste after treatment processes R13: Storage of waste pending the operations numbered R1, R4 and R5	From recovery of waste to despatch off-site for use. Storage of IBAA, ferrous and non-ferrous metals, and residual waste shall be on impermeable surface with sealed drainage system.

Table S1.1 activities			
Activity reference	Activity listed in Schedule 1 of the EP Regulations	Description of specified activity and WFD Annex I and II operations	Limits of specified activity and waste types
		(excluding temporary storage, pending collection, on the site where it is produced)	Waste stored under this activity shall not exceed 25,000 tonnes at any one time. Waste stored under this activity and activity AR7, shall not exceed 75,000 tonnes in total at any one time. There shall be no channelled emissions to air, surface water and/or sewer from this activity. No waste shall be stored for more than 12 months.
AR4	N/A	Process water collection and storage Collection and storage of process water in a storage tank.	From the collection of process water to re-use within the facility or despatch off site for recovery or disposal. There shall be no discharge of site effluent to surface water and/or sewer.
AR5	Surface water collection and storage	Collection and storage of site surface water via a sump in a storage tank.	From the collection of site surface water to re-use within the facility or despatch off site for recovery or disposal. There shall be no discharge of site effluent to surface water and/or sewer.
AR6	Raw material storage	Storage of raw materials including fuel and oil.	From the receipt of raw materials to despatch for use within the facility.
Activity reference	Description of activities for waste operations		Limits of activities
AR7	R3: Recycling/reclamation of organic substances which are not used as solvents R5: Recycling/reclamation of other inorganic compounds R13: Storage of waste pending any of the operations numbered R1 to R12 (excluding temporary storage, pending collection, on the site where it is produced)		Treatment of non-hazardous wastes consisting only of sorting, separation, screening, crushing, blending and washing of waste for recovery as a soil, soil substitute or aggregate. Treatment and storage of waste shall be on an impermeable surface with sealed drainage. Waste stored under this activity and activity AR3, shall not exceed 75,000 tonnes in total at any one time. Waste types as specified in Table S2.3

Table S1.2 - Operating techniques		
Description	Parts	Date Received
Application (EAWML 104171)	Supporting information provided with the submitted application.	05/2012
Response to regulation 61 notice EPR/GB3635RB/V004	Documents titled ' <i>BATC Return Spreadsheet</i> ', ' <i>IBA Process Flow Chart & Plant List</i> ' and ' <i>Site Plan 2018</i> '.	19/07/2023
Response to regulation 61 notice EPR/GB3635RB/V004 - Additional information received in response to the RFI dated 23/04/2024	Email containing response to questions 1 – 11 of the RFI, including the documents titled 'Site Plan Dunton' and EMS Dunton 2024.	07/05/2024
	Site Layout Plan, drawing number LD162/DN/005, dated June 2024.	28/06/2024
Additional information	Email providing details about the waste operation activities, EWC codes, storage capacity of the IBAA and IBAA/other aggregates	04/09/2024

Table S1.3 Improvement programme requirements		
Reference	Requirement	Date
IC1	<p>The operator shall submit an updated Dust Management Plan (DMP) to the Environment Agency for approval.</p> <p>The revised DMP shall include an assessment of the risk of dust pollution associated with the permitted site operations including a review of the:</p> <ul style="list-style-type: none"> loading, unloading and material handling procedures especially those that are used in transferring waste at the site. waste storage and treatment procedures for the site, including those associated with the waste operation activities. inspection and maintenance procedures for dust control measures, including information on the frequency of dust monitoring for fugitive emissions. <p>The plan shall take into account the appropriate measures for dust control specified in the <u>Non-hazardous and inert waste: appropriate measures for permitted facilities</u> guidance and <u>Control and monitor emissions for your environmental permit</u>.</p> <p>Once the DMP is approved by the Environment Agency, the operator shall carry out site operations in accordance with the approved DMP, and any subsequent revisions agreed in writing by the Environment Agency.</p>	20/02/25
IC2	<p>The operator shall carry out a detailed review of the existing waste treatment, storage and handling areas and equipment at the site to ensure that they are in accordance with the requirements specified in the <u>Non-hazardous and inert waste: appropriate measures for permitted facilities</u> guidance and BAT 24 of the <u>Waste Incineration BAT Conclusions</u>.</p> <p>Following the review, the operator shall submit a written report to the Environment Agency for approval outlining the results of the review and</p>	20/05/25

Table S1.3 Improvement programme requirements		
Reference	Requirement	Date
	<p>measures and procedures that are in place to prevent and/or reduce fugitive emissions of dust, odour and noise.</p> <p>The report shall include recommendations for improvements and installation of new infrastructure, including timescales for implementation of the identified improvements.</p>	
IC3	<p>Following the completion of IC2, the operator shall implement any improvements by the deadline specified in this improvement condition unless otherwise agreed in writing with the Environment Agency. The improvements may include, but are not limited to:</p> <ul style="list-style-type: none"> • installation of a new building or enclosure around the treatment operations currently taking place outside of the building; • installation of fast acting doors that default to closed position to prevent and/or reduce fugitive emissions of dust, odour and noise. 	20/11/26
IC4	<p>The operator shall undertake a review of the areas of the site that are currently covered by an impermeable surface and sealed drainage systems. The review shall ascertain their state and determine if the design and construction of the impermeable surface and sealed drainage systems are in line with or equivalent to the standards required in CIRIA Report C736.</p> <p>The report of the review shall be certified by a suitably qualified engineer and submitted to the Environment Agency for approval together with details of any improvements.</p>	20/02/25
IC5	<p>Following the completion IC4, the operator shall implement the improvement measures by the deadline specified in this improvement condition unless otherwise agreed in writing with the Environment Agency. The improvements may include, but are not limited to, the installation of a new impermeable surface, sealed drainage and containment systems.</p>	20/11/26
IC6	<p>The operator shall submit to the Environment Agency for approval, an infrastructure improvement plan to cover any area where the waste operation activities are being undertaken with an impermeable surface, sealed drainage and containment systems.</p> <p>The plan shall contain detailed information on the design and construction specifications of the impermeable surface, sealed drainage and containment systems. It shall take into account the appropriate measures specified in <u>Non-hazardous and inert waste: appropriate measures for permitted facilities guidance</u>, <u>Control and monitor emissions for your environmental permit guidance</u> and CIRIA Report C736.</p> <p>The plan must contain timescales for implementation of the individual measures and a provision for the construction to be certified by a suitably qualified engineer.</p>	20/05/25
IC7	<p>Following the completion IC6, the operator shall implement the improvement measures by the deadline specified in this improvement condition unless otherwise agreed in writing with the Environment Agency. The improvements may include, but are not limited to, the installation of impermeable surface, sealed drainage and containment systems.</p>	20/11/26

Schedule 2 – Waste types, raw materials and fuels

Table S2.1 Raw materials and fuels	
Raw materials and fuel description	Specification
Fuel oil	Sulphur content not exceeding 0.1% by mass.

Table S2.2 Permitted waste types and quantities for storage and treatment for the incinerator bottom ash treatment facility (AR1 and AR2)	
Maximum quantity	The total quantity of waste accepted at the site for activities AR1 and AR2 shall be less than 100,000 tonnes a year.
Exclusions	Wastes having any of the following characteristics shall not be accepted: <ul style="list-style-type: none"> Wastes in liquid form
Waste code	Description
19	WASTES FROM WASTE MANAGEMENT FACILITIES, OFF-SITE WASTE WATER TREATMENT PLANTS AND THE PREPARATION OF WATER INTENDED FOR HUMAN CONSUMPTION AND WATER FOR INDUSTRIAL USE
19 01	Wastes from incineration or pyrolysis of waste
19 01 12	Bottom ash and slag other than those mentioned in 19 01 11

Table S2.3 Permitted waste types and quantities for soil and aggregate treatment facility (AR7)	
Maximum quantity	The total quantity of waste accepted at the site under activity AR7 shall be less than 400,000 tonnes a year.
Exclusions	Wastes having any of the following characteristics shall not be accepted: <ul style="list-style-type: none"> Consisting solely or mainly of dust, powders or loose fibres Wastes that are in the form which is either sludge or liquid
Waste code	Description
01	WASTES RESULTING FROM EXPLORATION, MINING, QUARRYING, AND PHYSICAL AND CHEMICAL TREATMENT OF MINERALS
01 01	Wastes from mineral excavation
01 01 02	Wastes from mineral non-metalliferous excavation
01 04	Wastes from physical and chemical processing of non-metalliferous minerals
01 04 08	Waste gravel and crushed rocks other than those mentioned in 01 04 07
01 04 09	Waste sand and clays
10	WASTES FROM THERMAL PROCESSES
10 11	Wastes from manufacture of glass and glass products
10 11 12	Waste glass other than those mentioned in 10 11 11
10 12	Wastes from manufacture of ceramic goods, bricks, tiles and construction products
10 12 08	Waste ceramics, bricks, tiles and construction products (after thermal processing)

Table S2.3 Permitted waste types and quantities for soil and aggregate treatment facility (AR7)	
Maximum quantity	The total quantity of waste accepted at the site under activity AR7 shall be less than 400,000 tonnes a year.
Exclusions	Wastes having any of the following characteristics shall not be accepted: <ul style="list-style-type: none"> • Consisting solely or mainly of dust, powders or loose fibres • Wastes that are in the form which is either sludge or liquid
Waste code	Description
10 13	Wastes from manufacture of cement, lime and plaster and articles and products made from them
10 13 14	Wastes concrete only
15	WASTE PACKAGING; ABSORBENTS, WIPING CLOTHS, FILTER MATERIALS AND PROTECTIVE CLOTHING NOT OTHERWISE SPECIFIED
15 01	Packaging (including separately collected municipal packaging waste)
15 01 07	Glass packaging
17	CONSTRUCTION AND DEMOLITION WASTES (INCLUDING EXCAVATED SOIL FROM CONTAMINATED SITES)
17 01	Concrete, bricks, tiles and ceramics
17 01 01	Concrete
17 01 02	Bricks
17 01 03	Tiles and ceramics
17 01 07	Mixtures of concrete, bricks, tiles and ceramics other than those mentioned in 17 01 06
17 02	Wood, glass and plastic
17 02 02	Glass
17 03	Bituminous mixtures, coal tar and tarred products
17 03 02	Bituminous mixtures other than those mentioned in 17 03 01
17 05	Soil (including excavated soil from contaminated sites), stones and dredging spoil
17 05 04	Soil and stones other than those mentioned in 17 05 03
17 05 06	Dredging spoil other than those mentioned in 17 05 05
17 05 08	Track ballast other than those mentioned in 17 05 07
17 08	Gypsum-based construction material
17 08 02	Gypsum-based construction materials other than those mentioned in 17 08 01
17 09	Other construction and demolition wastes
17 09 04	Mixed construction and demolition wastes other than those mentioned in 17 09 01, 17 09 02 and 17 09 03
19	WASTES FROM WASTE MANAGEMENT FACILITIES, OFF-SITE WASTE WATER TREATMENT PLANTS AND THE PREPARATION OF WATER INTENDED FOR HUMAN CONSUMPTION AND WATER FOR INDUSTRIAL USE
19 08	Wastes from waste water treatment plants not otherwise specified
19 08 02	Waste from desanding
19 12	Wastes from the mechanical treatment of waste (for example sorting, crushing, compacting, pelletising) not otherwise specified

Table S2.3 Permitted waste types and quantities for soil and aggregate treatment facility (AR7)	
Maximum quantity	The total quantity of waste accepted at the site under activity AR7 shall be less than 400,000 tonnes a year.
Exclusions	Wastes having any of the following characteristics shall not be accepted: <ul style="list-style-type: none"> • Consisting solely or mainly of dust, powders or loose fibres • Wastes that are in the form which is either sludge or liquid
Waste code	Description
19 12 05	Glass
19 12 09	Minerals (for example sand, stones)
19 12 12	Other wastes (including mixtures of materials) from mechanical treatment of wastes other than those mentioned in 19 12 11
19 13	Wastes from soil and groundwater remediation
19 13 02	Solid wastes from soil remediation other than those mentioned in 19 13 01
20	MUNICIPAL WASTES (HOUSEHOLD WASTE AND SIMILAR COMMERCIAL, INDUSTRIAL AND INSTITUTIONAL WASTES) INCLUDING SEPARATELY COLLECTED FRACTIONS
20 01	Separately collected fractions (except 15 01)
20 01 02	Glass
20 02	Garden and park wastes (including cemetery waste)
20 02 02	Soil and stones
20 03	Other municipal wastes
20 03 03	Street-cleaning residues

Schedule 3 – Emissions and monitoring

Emission point reference or source or description of point of measurement	Parameter	Monitoring frequency	Monitoring standard or method	Other specifications
At the IBA waste stockpiles shown and other locations agreed in accordance with the approved Dust Management Plan required under IC1	Moisture content	As agreed under the dust emissions management plan and the updated version required under IC1	As agreed under the dust emissions management plan and the updated version required under IC1	--

Emission point reference or source or description of point of measurement	Parameter	Monitoring frequency	Monitoring standard or method	Other specifications
At the locations agreed in accordance with the approved Dust Management Plan required under IC1	Dust	Daily	M17 guidance	Use directional and real-time dust gauges. Contents of deposit gauge to be measured/analysed in line with the Dust Management Plan and the replacement version required under IC1. Trigger level of 75µg/m ³ and action level 25µg/m ³ (specified in the Dust Management Plan and the replacement version required under IC1).
	Visual dust checks	Daily		

Schedule 4 – Reporting

Parameters, for which reports shall be made, in accordance with conditions of this permit, are listed below.

Table S4.1 Reporting of monitoring data			
Parameter	Emission or monitoring point/reference	Reporting period	Period begins
Process monitoring Parameters as required by condition 3.5.	At the IBA waste stockpiles shown and other locations agreed in accordance with the approved Dust Management Plan required under IC1	Every 6 months	1 January, 1 July
Ambient air monitoring Parameters as required by condition 3.5.	At the locations agreed in accordance with the approved Dust Management Plan required under IC1	Every 6 months	1 January, 1 July

Table S4.2 Annual production/treatment	
Parameter	Units
Incinerator bottom ash processed	tonnes
Incinerator bottom ash imported	tonnes
Ferrous metals recovered	tonnes
Non-ferrous metals recovered	tonnes
Incinerator bottom ash aggregate recovered	tonnes
Process water tankered off-site	tonnes

Table S4.3 Performance parameters		
Parameter	Frequency of assessment	Units
Water usage	Annually	m ³ per tonne of processed ash
Energy usage	Annually	MWh per processed ash
Total raw material used	Annually	tonnes

Table S4.4 Reporting forms		
Media/parameter	Reporting format	Date of form
Process monitoring	Process Monitoring Form, or other form as agreed in writing by the Environment Agency	Version 1, 08/03/2021
Ambient air monitoring	Ambient Air Monitoring Form, or other form as agreed in writing by the Environment Agency	Version 1, 08/03/2021
Water usage	Form water usage 1 or other form as agreed in writing by the Environment Agency	Version 1, 08/03/2021

Table S4.4 Reporting forms		
Media/parameter	Reporting format	Date of form
Energy usage	Form energy 1 or other form as agreed in writing by the Environment Agency	Version 1, 08/03/2021
Other performance indicators	Form performance 1 or other form as agreed in writing by the Environment Agency	Version 1, 08/03/2021
Waste returns	E-waste return form	

Schedule 5 – Notification

These pages outline the information that the operator must provide.

Units of measurement used in information supplied under Part A and B requirements shall be appropriate to the circumstances of the emission. Where appropriate, a comparison should be made of actual emissions and authorised emission limits.

If any information is considered commercially confidential, it should be separated from non-confidential information, supplied on a separate sheet and accompanied by an application for commercial confidentiality under the provisions of the EP Regulations.

Part A

Permit Number	
Name of operator	
Location of Facility	
Time and date of the detection	

(a) Notification requirements for any malfunction, breakdown or failure of equipment or techniques, accident, or emission of a substance not controlled by an emission limit which has caused, is causing or may cause significant pollution	
To be notified within 24 hours of detection	
Date and time of the event	
Reference or description of the location of the event	
Description of where any release into the environment took place	
Substances(s) potentially released	
Best estimate of the quantity or rate of release of substances	
Measures taken, or intended to be taken, to stop any emission	
Description of the failure or accident.	

(b) Notification requirements for the breach of a limit	
To be notified within 24 hours of detection unless otherwise specified below	
Emission point reference/ source	
Parameter(s)	
Limit	
Measured value and uncertainty	
Date and time of monitoring	

(b) Notification requirements for the breach of a limit	
To be notified within 24 hours of detection unless otherwise specified below	
Measures taken, or intended to be taken, to stop the emission	

Time periods for notification following detection of a breach of a limit	
Parameter	Notification period

(c) Notification requirements for the breach of permit conditions not related to limits	
To be notified within 24 hours of detection	
Condition breached	
Date, time and duration of breach	
Details of the permit breach i.e. what happened including impacts observed.	
Measures taken, or intended to be taken, to restore permit compliance.	

(d) Notification requirements for the detection of any significant adverse environmental effect	
To be notified within 24 hours of detection	
Description of where the effect on the environment was detected	
Substances(s) detected	
Concentrations of substances detected	
Date of monitoring/sampling	

Part B – to be submitted as soon as practicable

Any more accurate information on the matters for notification under Part A.	
Measures taken, or intended to be taken, to prevent a recurrence of the incident	

Measures taken, or intended to be taken, to rectify, limit or prevent any pollution of the environment which has been or may be caused by the emission	
The dates of any unauthorised emissions from the facility in the preceding 24 months.	

Name*	
Post	
Signature	
Date	

* authorised to sign on behalf of the operator

Schedule 6 – Interpretation

“accident” means an accident that may result in pollution.

“application” means the application for this permit, together with any additional information supplied by the operator as part of the application and any response to a notice served under Schedule 5 to the EP Regulations.

“authorised officer” means any person authorised by the Environment Agency under section 108(1) of The Environment Act 1995 to exercise, in accordance with the terms of any such authorisation, any power specified in section 108(4) of that Act.

“bottom ash” means ash falling through the grate transported by the grate.

“building” means a construction that has the objective of providing sheltering cover and minimising emissions of noise, particulate matter, odour and litter.

“disposal” means any of the operations provided for in Annex I to Directive 2008/98/EC of the European Parliament and of the Council on waste.

“emissions to land” includes emissions to groundwater.

“EP Regulations” means The Environmental Permitting (England and Wales) Regulations SI 2016 No.1154 and words and expressions used in this permit which are also used in the Regulations have the same meanings as in those Regulations.

“emissions of substances not controlled by emission limits” means emissions of substances to air, water or land from the activities, either from the emission points specified in schedule 3 or from other localised or diffuse sources, which are not controlled by an emission limit.

“groundwater” means all water, which is below the surface of the ground in the saturation zone and in direct contact with the ground or subsoil.

“Industrial Emissions Directive” means DIRECTIVE 2010/75/EU OF THE EUROPEAN PARLIAMENT AND OF THE COUNCIL of 24 November 2010 on industrial emissions, as read in accordance with Schedule 1A to the Environmental Permitting (England and Wales) Regulations 2016.

“List of Wastes” means the list of wastes established by Commission Decision 2000/532/EC replacing Decision 94/3/EC establishing a list of wastes pursuant to Article 1(a) of Council Directive 75/442/EEC on waste and Council Decision 94/904/EC establishing a list of hazardous waste pursuant to Article 1(4) of Council Directive 91/689/EEC on hazardous waste.

“MCERTS” means the Environment Agency’s Monitoring Certification Scheme.

“quarter” means a calendar year quarter commencing on 1 January, 1 April, 1 July or 1 October.

“recovery” means any of the operations provided for in Annex II to the Waste Framework Directive.

“sealed drainage system” in relation to an impermeable surface, means a drainage system with impermeable components which does not leak and which will ensure that:

- no liquids will run off the surface otherwise than via the system.
- all liquids entering the system are collected in a sealed sump, except where liquids may be lawfully discharged to foul sewer.

“separation” means separating wastes into different material types, components and grades.

“sorting” means sorting that may be undertaken by hand or machinery. Sorting enables materials to be processed and recycled appropriately. It may involve separation of different waste types or the separation of different metal types including different ferrous metals, non-ferrous metals and non-metallic materials (e.g. paper and plastic). The sorted metals are graded by visual inspection, supplemented by chemical and other laboratory tests. The physical sorting may be assisted by conveyors and electromagnets.

“Waste code” means the six-digit code referable to a type of waste in accordance with the List of Wastes and in relation to hazardous waste, includes the asterisk.

“Waste Framework Directive” or “WFD” means Waste Framework Directive 2008/98/EC of the European Parliament and of the Council on waste, as read in accordance with Schedule 1A to the Environmental Permitting (England and Wales) Regulations 2016.

“year” means calendar year ending 31 December.

Where a minimum limit is set for any emission parameter, for example pH, reference to exceeding the limit shall mean that the parameter shall not be less than that limit.

Unless otherwise stated, any references in this permit to concentrations of substances in emissions into air means:

- in relation to emissions from combustion processes, the concentration in dry air at a temperature of 273K, at a pressure of 101.3 kPa and with an oxygen content of 3% dry for liquid and gaseous fuels, 6% dry for solid fuels; and/or
- in relation to emissions from non-combustion sources, the concentration at a temperature of 273K and at a pressure of 101.3 kPa, with no correction for water vapour content.

Schedule 7 – Site plan

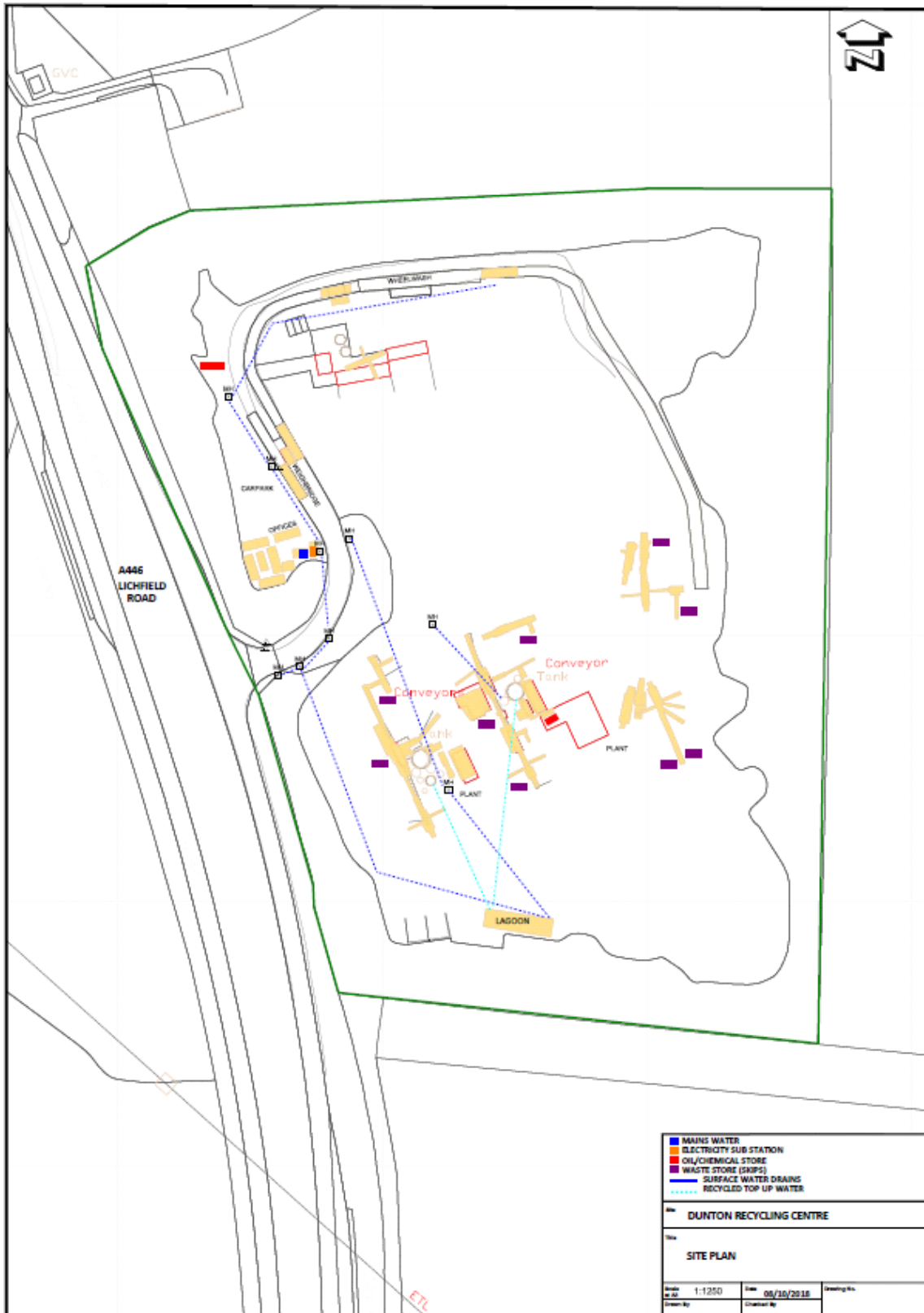

END OF PERMIT

Permit number
EPR/GB3635RB

Reporting Forms

Process Monitoring Form

Permit Number: **EPR/GB3635RB**

Operator: **KSD Recycled Aggregates Limited**

Facility: **Dunton Recycling Centre**

Process Monitoring Form: **version 1, 08/03/2021**

Reporting of process monitoring for the period from *[DD/MM/YY]* to *[DD/MM/YY]*

Monitoring point description or source	Parameter	Reference period	Test method ¹	Result ²	Sample dates and times ³	Uncertainty ⁴
<i>[e.g. Condenser V 2345]</i>	<i>[e.g. cooling water outlet temperature]</i>	<i>[e.g. instantaneous]</i>	<i>[if applicable]</i>	<i>[State result]</i>	<i>[State relevant dates and time periods]</i>	<i>[if applicable]</i>

Operator's comments

Signed: *[Name]*

Date: *[DD/MM/YY]*

(Authorised to sign as representative of the operator)

Guidance for use: Use this form to report your monitoring results.

Example text is shown in bracketed grey italics. Replace the example text by entering your own site specific information. Complete columns 1 to 5 using the information from schedule 3 of your permit. Complete columns 6 to 8 with your monitoring data. Add additional rows as necessary.

- ¹ Where an internationally recognised standard test method is used, give the reference number. Where another method that has been formally agreed with the Environment Agency, give the appropriate identifier. In other cases state the principal technique, for example gas chromatography.
- ² Give the result as the maximum value (or the minimum value in the case of a limit that is expressed as a minimum) obtained during the reporting period, expressed in the same terms as the emission limit value. Where the emission limit value is expressed as a range, give the result as the 'minimum to maximum' of the measured values.
- ³ For non-continuous measurements give the date and time of the sample that produced the result. For continuous measurements give the percentage of the process operating time covered by the result.
- ⁴ Complete if the uncertainty associated with the result is not a 95% confidence interval. Leave blank for 95% confidence intervals.

Signed: *[Name]*

Date: *[DD/MM/YY]*

(Authorised to sign as representative of the operator)

Guidance for use: Use this form to report your monitoring results.

Example text is shown in bracketed grey italics. Replace the example text by entering your own site specific information. Complete columns 1 to 5 using the information from schedule 3 of your permit. Complete columns 6 to 8 with your monitoring data. Add additional rows as necessary.

- ¹ Where an internationally recognised standard test method is used, give the reference number. Where another method that has been formally agreed with the Environment Agency, give the appropriate identifier. In other cases state the principal technique, for example gas chromatography.
- ² Give the result as the maximum value (or the minimum value in the case of a limit that is expressed as a minimum) obtained during the reporting period, expressed in the same terms as the emission limit value. Where the emission limit value is expressed as a range, give the result as the 'minimum to maximum' of the measured values.
- ³ For non-continuous measurements give the date and time of the sample that produced the result. For continuous measurements give the percentage of the process operating time covered by the result.
- ⁴ Complete if the uncertainty associated with the result is not a 95% confidence interval. Leave blank for 95% confidence intervals.

Water Usage Reporting Form

Permit Number: EPR/GB3635RB

Operator: KSD Recycled Aggregates Limited

Facility: Dunton Recycling Centre

Water Usage Reporting Form: version 1, 08/03/2021

Reporting of water usage for the year [YYYY]

Water source	Water usage (m ³)	Specific water usage (m ³ /unit) ²
Mains water	<i>[insert annual usage in m³ where mains water is used]</i>	<i>[insert annual usage in m³/unit where mains water is used]</i>
Site borehole	<i>[insert annual usage in m³ where water is used from a site borehole]</i>	<i>[insert annual usage in m³/unit where water is used from a site borehole]</i>
River abstraction	<i>[insert annual usage in m³ where abstracted river water is used]</i>	<i>[insert annual usage in m³/unit where abstracted river water is used]</i>
Other – <i>[specify other water source where applicable. Add extra rows where needed]</i>	<i>[insert annual usage in m³ where applicable]</i>	<i>[insert annual usage in m³/unit where applicable]</i>
Total water usage	<i>[insert total annual water usage in m³]</i>	<i>[insert total annual water usage in m³/unit]</i>

Operator's comments

Signed: *[Name]*

Date: *[DD/MM/YY]*

(Authorised to sign as representative of the operator)

Guidance for use: Use this form to report your annual water usage.

Example text is shown in bracketed grey italics. Replace the example text by entering your own site specific information. Add additional rows as necessary.

Energy Usage Reporting Form

Permit Number: EPR/GB3635RB

Operator: KSD Recycled Aggregates Limited

Facility: Dunton Recycling Centre

Energy Usage Reporting Form: version 1, 08/03/2021

Reporting of energy usage for the year [YYYY]

Energy source	Energy consumption / production (MWh)	Specific energy consumption (MWh/unit) ²
Electricity imported as delivered - source [specify source, e.g. supplied from the national grid]	<i>[insert annual consumption in MWh where electricity is imported]</i>	<i>[insert annual consumption in MWh/unit where electricity is imported]</i>
Electricity imported as primary energy 1 – conversion factor of [specify conversion factor used to convert electricity delivered to primary energy]	<i>[insert annual consumption in MWh where electricity is imported]</i>	<i>[insert annual consumption in MWh/unit where electricity is imported]</i>
Natural gas	<i>[insert annual consumption in MWh where natural gas is used]</i>	<i>[insert annual consumption in MWh/unit where natural gas is used]</i>
Gas oil – conversion factor of [specify conversion factor used to convert tonnes to MWh]	<i>[insert annual consumption in MWh where gas oil is used]</i>	<i>[insert annual consumption in MWh/unit where gas oil is used]</i>
Imported heat	<i>[insert annual consumption in MWh where heat is imported]</i>	<i>[insert annual consumption in MWh/unit where heat is imported]</i>
Other – <i>[specify other energy source and conversion factors where applicable, e.g. renewable fuel. Add extra rows where needed]</i>	<i>[insert annual consumption in MWh where applicable]</i>	<i>[insert annual consumption in MWh/unit where applicable]</i>
Electricity exported	<i>[insert annual production in MWh where electricity is exported]</i>	Not applicable
Heat exported	<i>[insert annual production in MWh where heat is exported]</i>	Not applicable

Operator's comments

Signed: *[Name]*

Date: *[DD/MM/YY]*

(Authorised to sign as representative of the operator)

Guidance for use: Use this form to report your annual energy usage.

Example text is shown in bracketed grey italics. Replace the example text by entering your own site specific information. Add additional rows as necessary.

- ¹ Multiply delivered electricity by 2.4 to convert to primary energy where the electricity is supplied from the national grid. If the electricity is supplied from another source, specify the conversion factor used. Add additional rows as needed if electricity is imported from multiple sources.
- ² Divide energy consumption by an appropriate unit of raw material processed or waste output.

Other Performance Parameters Reporting Form

Permit Number: **EPR/GB3635RB**

Operator: **KSD Recycled Aggregates Limited**

Facility: **Dunton Recycling Centre**

Other Performance Parameters Reporting Form: **version 1, 08/03/2021**

Reporting of other performance parameters for the period from *[DD/MM/YY]* to *[DD/MM/YY]*

Parameter	Units
<i>[e.g. Total raw material usage]</i>	<i>[e.g. tonnes per production unit]</i>

Operator's comments

Signed: *[Name]*

Date: *[DD/MM/YY]*

(Authorised to sign as representative of the operator)

Guidance for use: Use this form to report the performance parameters (other than water and energy) required by your permit. Example text is shown in bracketed grey italics. Replace the example text by entering your own site specific information. The parameters to report and units to be used can be found in the 'Performance parameters' table in schedule 4 of your permit. Add additional rows as necessary.