

KEY

- Ownership Boundary
- Application Boundary  
9806.74 sqm / 105559.79 sqft / 2.42 acres
- Tree Root Protection Area

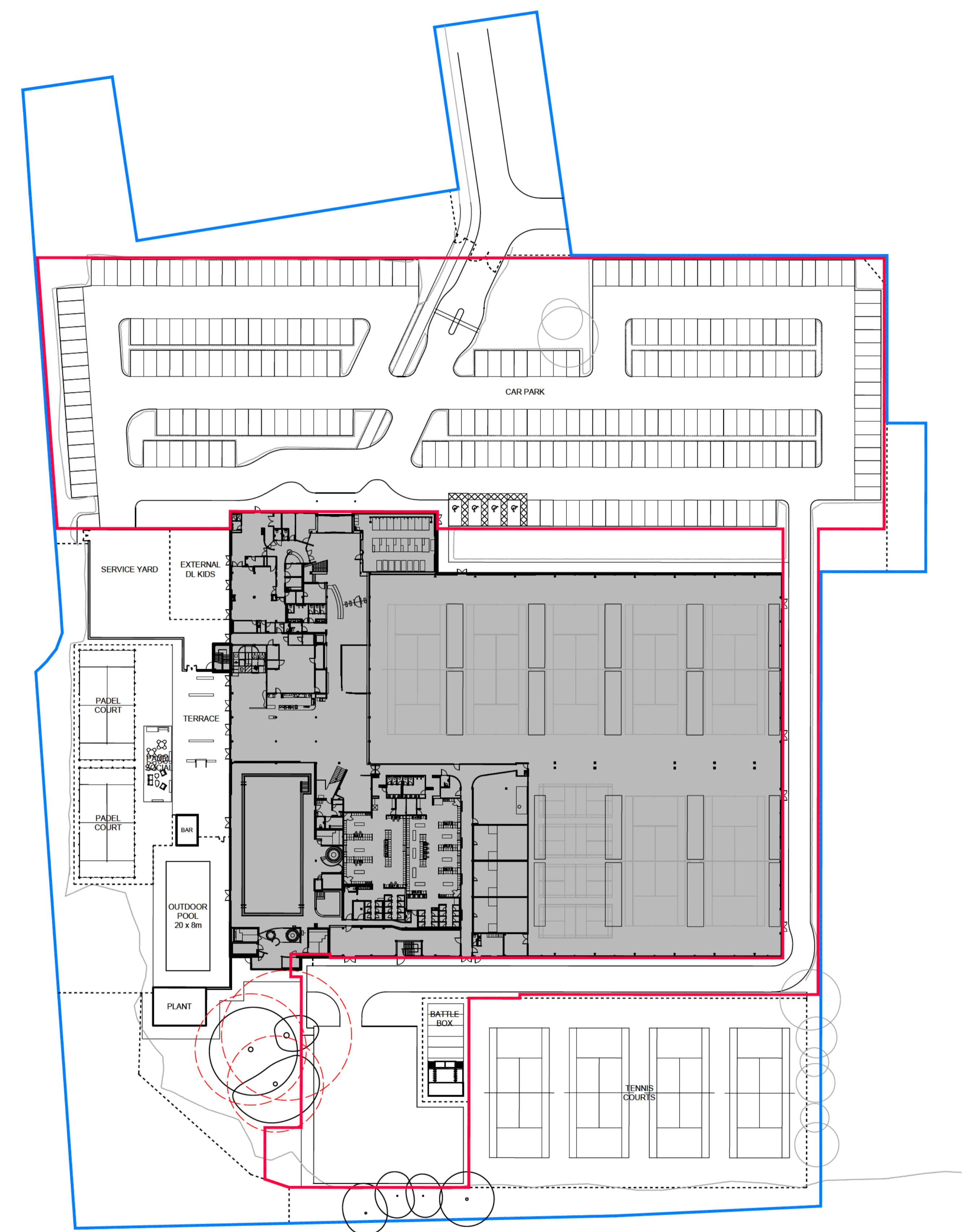

REVISION: P06	BY: HP	CHECKED: MB	DATE: 09/10/2024
Planning issue			
REVISION: P05	BY: HP	CHECKED: MB	DATE: 31/07/2024
Applications boundary line amended.			
REVISION: P04	BY: HP	CHECKED: MB	DATE: 05/03/2024
Applications boundary line amended to suit spa layout.			
REVISION: P03	BY: EQ	CHECKED: MB	DATE: 06/09/2023
Car park note omitted.			
REVISION: P02	BY: EQ	CHECKED: MB	DATE: 01/08/2023
Scale amended. Ownership and application boundary lines made solid.			
REVISION: P01	BY: EQ	CHECKED: MB	DATE: 27/07/2023
Planning issue			

STATUS **S4a | FOR PLANNING**



PROJECT **BRISTOL WESTBURY  
SPA EXTENSION & SPA GARDEN**

TITLE **EXISTING SITE PLAN**

**Hadfield Cawkwell Davidson**  
Broomgrove Lodge, 13 Broomgrove Rd, Sheffield, S10 2LZ T 0114 266 8181

NO. PROJECT NO 2022-319	SCALE 1:500 @ A1	REV. <b>P06</b>
PROJECT NO 2022-319	ORIGINATOR HCD	VOLUME A0
LEVEL 00	TYPE DR	ROLE - NUMBER A-PL-002

S:\Architecture\2022-319\Drawings\DR - Plans\Bristol\Planning\A1-002 Existing Plan.dwg | ©HCD