

**KEY**

- Ownership Boundary
- Application Boundary  
9806.74 sqm / 105559.79 sqft / 2.42 acres
- Tree Root Protection Area
- Denotes proposed new parking bay (12no.)

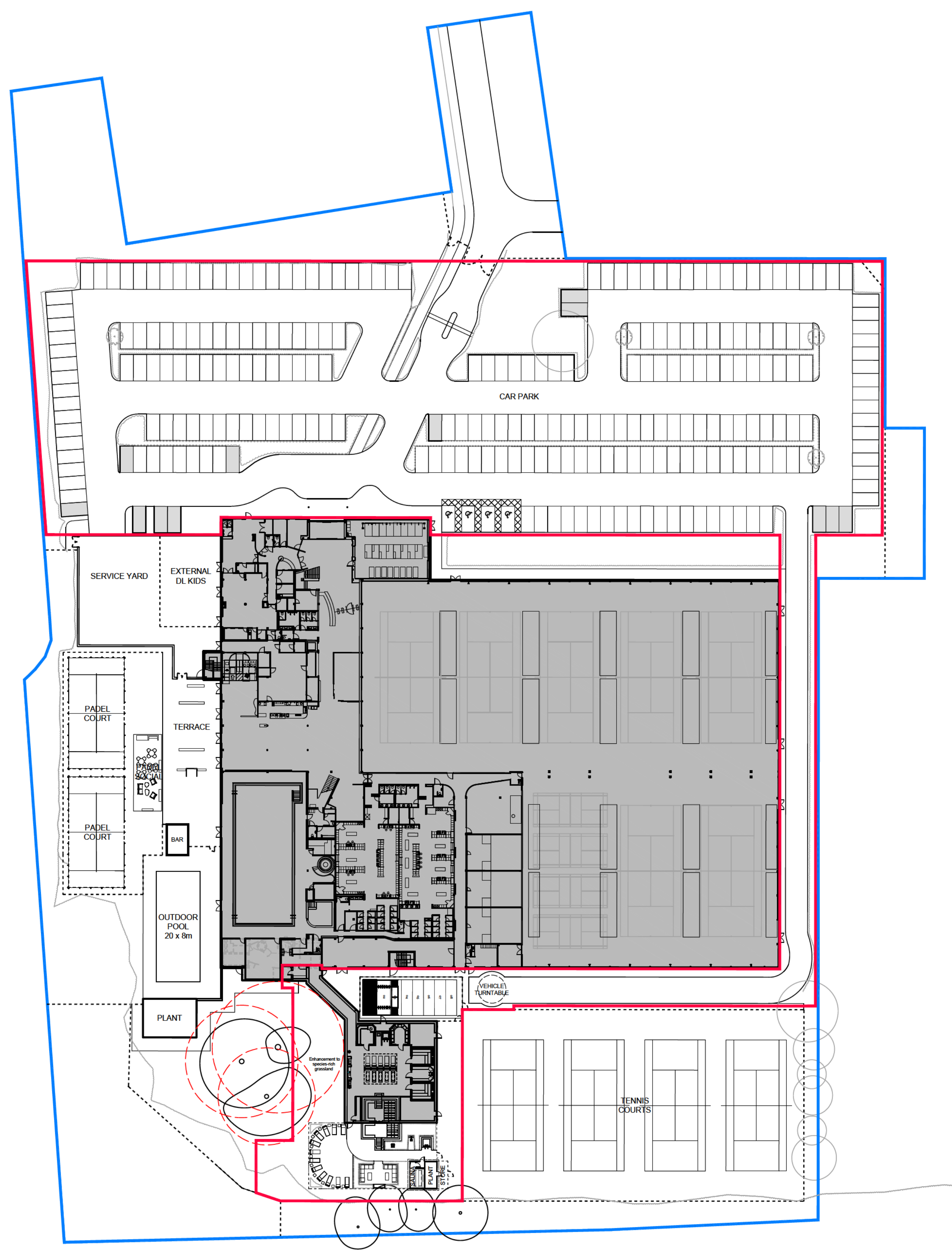

REVISION: P07	BY: HP	CHECKED: MB	DATE: 09/10/2024
Spa extension & garden layout amended.			
REVISION: P06	BY: HP	CHECKED: MB	DATE: 21/08/2024
Car park amended. Grassland note added. 4 new trees added.			
REVISION: P05	BY: HP	CHECKED: MB	DATE: 31/07/2024
Applications boundary line amended.			
REVISION: P04	BY: HP	CHECKED: MB	DATE: 28/06/2024
Additional parking bays added. Service vehicle turntable added.			
REVISION: P03	BY: HP	CHECKED: MB	DATE: 05/03/2024
Spa garden layout and application boundary line amended.			
REVISION: P02	BY: EQ	CHECKED: MB	DATE: 01/08/2023
Scale amended. Ownership and application boundary lines made solid.			
REVISION: P01	BY: EQ	CHECKED: MB	DATE: 27/07/2023
Planning issue.			

**S4a | FOR PLANNING**



**BRISTOL WESTBURY  
SPA EXTENSION & SPA GARDEN**

**PROPOSED SITE PLAN**

**Hadfield Cawkwell Davidson**  
Broomgrove Lodge, 13 Broomgrove Rd, Sheffield, S10 2LZ T 0114 266 818

HCD PROJECT NO: 2022-319	SCALE: 1:500 @ A1	REV: <b>P07</b>
PROJECT NO: 2022-319	ORIGINATOR: HCD	VOLUME: A0
LEVEL: 00	TYPE: DR	ROLE - NUMBER: <b>A-PL-003</b>

S:\Architect\2022-319\Drawings\DR - Plans\Arch\Planning\A-PL-003 Proposed Plan.dwg | © HCD