

- ① EXISTING CONSERVATORY TO BE DEMOLISHED.
- ② EXISTING OFF STREET PARKING.

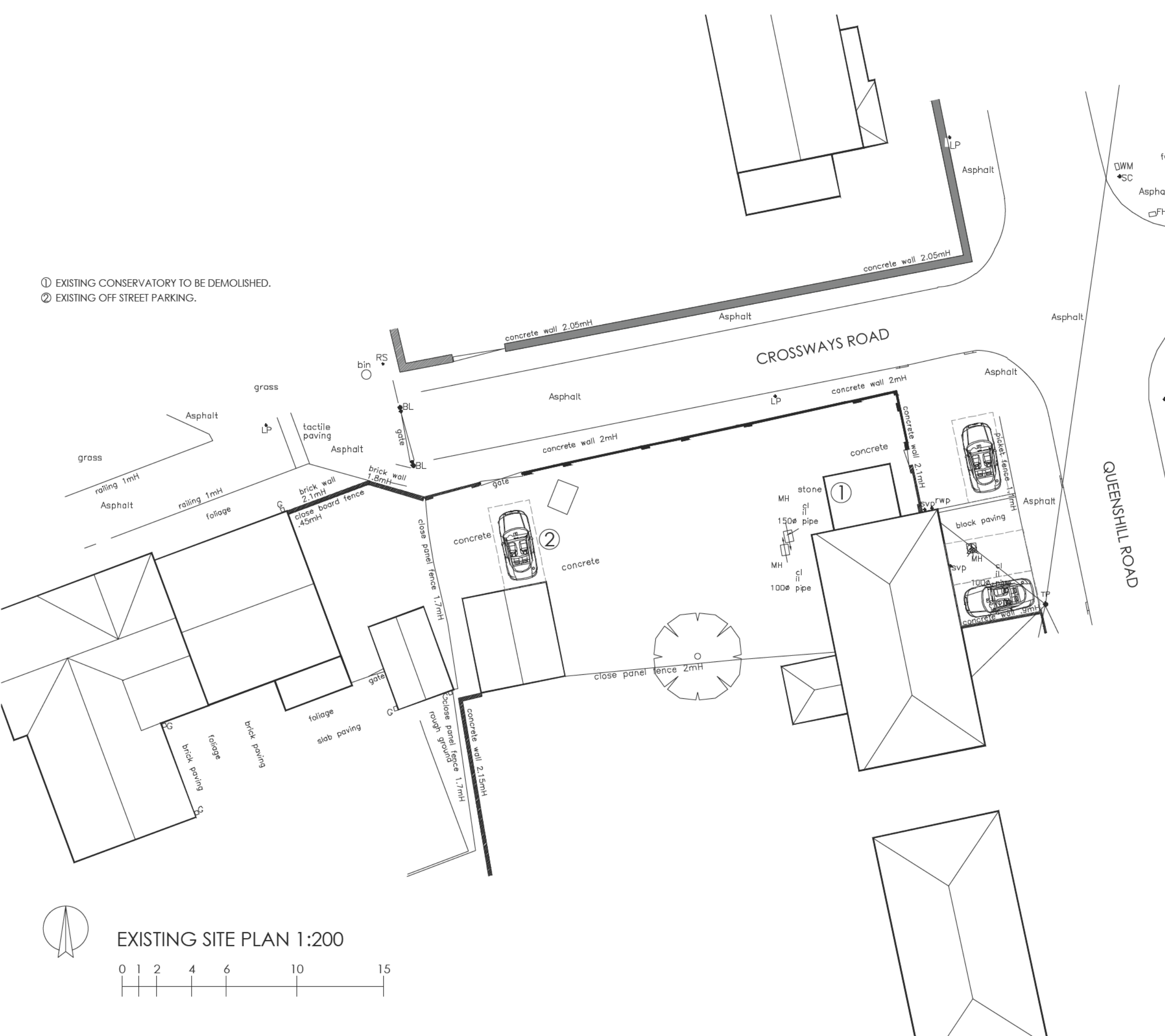

Notes:
 The owner, should they need to do so under the requirements of the Party Wall Act 1996, has a duty to serve a Party Structure Notice on any adjoining owner if building work on, to or near an existing Party Wall involves any of the following:

- Support of beam
- Insertion of DPC through wall
- Raising a wall or cutting off projections
- Demolition and rebuilding
- Underpinning
- Insertion of lead flashings
- Excavations within 3 metres of an existing structure where the new foundations will go deeper than adjoining foundations, or within 6 metres of an existing structure where the new foundations are within a 45 degree line of the adjoining foundations. A Party Wall Agreement is to be in place prior to start of works on site.

Rv. Date. Note.

MD METCALFE
 DESIGN

Project Description:
 Proposal of 1 New Dwelling to Land Adjacent to 87
 Queenshill Road

Project Address:
 87 Queenshill Road, Knowle, Bristol, BS4 2XQ

Drawing Title:
 Existing Site Plan

| | |
|--|---------------------------|
| Client: Paul Rhodes | Drawing No. 24149-PL04 |
| Drawing Issue: Planning Application | Revision: - |
| Scale: 1:200 @ A3 | Date: 23.09.24 |
| | Drawn by: KM |