



Notice of variation and consolidation with introductory note

The Environmental Permitting (England & Wales) Regulations 2016

Cranswick Convenience Foods Limited
Sutton Fields Convenience Food Production
68 - 72 Helsinki Road
Sutton Fields Industrial Estate
Kingston upon Hull
HU7 0YW

Variation application number

EPR/KP3733AN/V006

Permit number

EPR/KP3733AN

Sutton Fields Convenience Food Production

Permit number EPR/KP3733AN

Introductory note

This introductory note does not form a part of the notice

Under the Environmental Permitting (England & Wales) Regulations 2016 (schedule 5, part 1, paragraph 19) a variation may comprise a consolidated permit reflecting the variations and a notice specifying the variations included in that consolidated permit.

Schedule 1 of the notice specifies the conditions that have been varied and schedule 2 comprises a consolidated permit which reflects the variations being made. All the conditions of the permit have been varied and are subject to the right of appeal.

This consolidated permit has been issued following a full review against the best available techniques (BAT) conclusions for the Food, Drink and Milk Industries published on 4th December 2019 in the official journal of the European Union.

We have implemented the requirements of the Medium Combustion Plant directive, and incorporated post-dated requirements for 2030.

The schedules specify the changes made to the permit.

The main features of the permit are as follows.

The Sutton Fields Convenience Food Production site is located within the Sutton Fields Industrial Estate approximately 3.5km north of Kingston Upon Hull, at national grid reference TA 09649 32335. The surrounding area consists of other industrial activity. The site undertakes food manufacturing producing packaged meat products for human consumption.

The Environmental Permit is for the following scheduled activity:

Section 6.8 A(1)(d)(iii)(aa) - Treatment and processing, other than exclusively packaging, of the following raw materials, whether previously processed or unprocessed, intended for the production of food or feed (where the weight of the finished product excludes packaging) - animal and vegetable raw materials (other than milk only), both in combined and separate products, with a finished product production capacity in tonnes per day greater than - 75 if A is equal to 10 or more, where 'A' is the portion of animal material in percent of weight of the finished product production capacity.

The installation has a maximum theoretical production capacity to produce 260 tonnes of finished product per day.

The main operations on site are the receipt of raw fresh and frozen meat (such as pork, beef and chicken), processing by mincing, slicing, mixing and blending with other ingredients (such as coatings, marinades, herbs and spices), and cooking (by hot oil/steam oven, grilling, frying, and/or smoking), to produce packaged meat products for human consumption. Raw materials are brought onto site and unloaded into a refrigerated goods area where they are checked for quality, temperature, and quantity. The raw materials are then stored in chilled storage prior to being processed.

Cooking takes place on-site in steam ovens, frying lines, and two smoke chambers. The food processing machinery used includes blenders, tumblers, mincers, conveyors, cookers, slicers and packing machines. Once cooked, in order to extend the shelf life, meat products are packed into modified atmosphere packaging. Despatch of the finished product is undertaken from the despatch area using refrigerated transport to various regional distribution centres.

The key emission source points arise from steam/hot water boilers and heaters, thermal oil heater, ovens, fryers, and two smoke chambers. Cooking is undertaken using steam ovens/grills (1.4MWth), hot oil heated fryers (three x 0.605MWth), a hot oil/steam oven (0.9MWth), all fired on natural gas, in addition to the two

smoke chambers. Heat, hot water and steam used in the process are also generated by one 1.3 MWth, one 1.4 MWth, and one x 3.6 MWth boilers. This is in addition to three x 0.250 MWth hot water heaters, and one x 2.9 MWth thermal oil heating plant, all fired on natural gas.

The site is based on hard standing with an enclosed drainage system that runs to an interceptor before discharge to sewer. Frequent cleaning of the process machinery and building fabric is undertaken using food grade chemicals.

Water is used to clean down the facility and the resulting effluent runs to an enclosed drainage system, which has catch pots to capture any solids not removed by the dry-cleaning processes. Effluent produced during the process mainly comes from the wash down and cleaning of processing areas, this results in only light meat contamination. All uncontaminated roof-water and surface water run-off discharges to three foul sewer points. Effluent is discharged to sewer in accordance with the terms of a trade effluent discharge consent with Yorkshire Water.

The site has an Environmental Management System (EMS) which is externally accredited to the ISO14001 standard

The status log of a permit sets out the permitting history, including any changes to the permit reference number.

Status log of the permit		
Description	Date	Comments
Application received EPR/KP3733AN/A001	Duly made 23/03/2015	Application received for a food, drink and milk Installation for the production of meat-based products such as beef, pork and poultry.
Additional Information	22/04/2015	Confirmation of boiler/heater sizes.
Permit determined EPR/KP3733AN	11/06/2015	Permit issued to Cranswick Convenience Foods Limited.
Application EPR/KP3733AN/V002 Notified of change of Registered office	13/08/2019	Registered office changed to Crane Court, Hesslewood Office Park, Ferriby Road, Hessle, HU13 0PA.
Variation issued EPR/KP3733AN	29/08/2019	Varied permit issued to Cranswick Convenience Foods Limited.
Application EPR/KP3733AN/V003 (variation and consolidation)	Duly made 20/07/2020	Application to vary and consolidate (not modernised).
Additional information	27/07/2020	Site condition report.
	04/08/2020	Combustion plant information.
	17/08/2020	Combustion plant information.
Variation determined EPR/KP3733AN	23/09/2020	Varied permit issued.
Application for a variation EPR/KP3733AN/V004	Duly made 03/11/2021	Application for a variation to add a new chicken process line, combustion plant, refrigeration plant and other associated changes to on-site infrastructure.
Variation determined EPR/KP3733AN	11/01/2022	Varied and consolidated permit issued.
Application EPR/KP3733AN/V006 (variation and consolidation)	Regulation 61 Notice response received 01/12/2022	Environment Agency initiated variation and consolidation following the Food, Drink & Milk Industries sector permit review.

Status log of the permit		
Description	Date	Comments
Application Variation EPR/KP3733AN/V005 incorrectly logged on Environment Agency internal systems	30/05/2023	Incorrect logging – no changes to the permit.
Application EPR/KP3733AN/V007 (variation and consolidation)	Duly made 10/04/2024	Application to vary and update the permit to modern conditions.
Variation determined and consolidation issued EPR/KP3733AN	14/05/2024	Varied and consolidated permit issued in modern format.
Application EPR/KP3733AN/V006 (variation and consolidation) Response to request for information dated 27/06/2024	Received 10/07/2024	Information requested in relation to Reg.61 response tool concerning BATc 3, 5, 11, 12, 29, medium combustion plant, and site emission source points to air plan.
Additional information	Received 23/07/2024	Information regarding a temporary replacement of existing medium combustion plant (1.3 MWth boiler A4) that was beyond economical repair during this application's determination, that was replaced by a third-party leased (1.4 MWth) new boiler.
Variation determined and consolidation issued EPR/KP3733AN	04/09/2024	Varied and consolidated permit issued in modern format.

End of introductory note

Notice of variation and consolidation

The Environmental Permitting (England and Wales) Regulations 2016

The Environment Agency in exercise of its powers under regulation 20 of the Environmental Permitting (England and Wales) Regulations 2016 varies

Permit number

EPR/KP3733AN

Issued to

Cranswick Convenience Foods Limited (“the Operator”)

whose registered office is

**Crane Court
Hesslewood Office Park
Ferriby Road
Hessle
HU13 0PA**

company registration number 02239912

to operate a regulated facility at

**Sutton Fields Convenience Food Production
68 - 72 Helsinki Road
Sutton Fields Industrial Estate
Kingston upon Hull
HU7 0YW**

to the extent set out in the schedules.

The notice shall take effect from 04/09/2024.

Name	Date
Sandra Cavill	04/09/2024

Authorised on behalf of the Environment Agency

Schedule 1

All conditions have been varied by the consolidated permit as a result of an Environment Agency initiated variation.

Schedule 2 – consolidated permit

Consolidated permit issued as a separate document.

Permit

The Environmental Permitting (England and Wales) Regulations 2016

Permit number

EPR/KP3733AN

This is the consolidated permit referred to in the variation and consolidation notice for application EPR/KP3733AN/V006 authorising,

Cranswick Convenience Foods Limited (“the Operator”),

whose registered office is

**Crane Court
Hesslewood Office Park
Ferryby Road
Hessle
HU13 0PA**

company registration number 02239912

to operate an installation at

**Sutton Fields Convenience Food Production
68 - 72 Helsinki Road
Sutton Fields Industrial Estate
Kingston upon Hull
HU7 0YW**

to the extent authorised by and subject to the conditions of this permit.

Name	Date
Sandra Cavill	04/09/2024

Authorised on behalf of the Environment Agency

Conditions

1 Management

1.1 General management

1.1.1 The Operator shall manage and operate the activities:

- (a) in accordance with a written management system that identifies and minimises risks of pollution, including those arising from operations, maintenance, accidents, incidents, non-conformances, closure and those drawn to the attention of the Operator as a result of complaints; and
- (b) using sufficient competent persons and resources.

1.1.2 Records demonstrating compliance with condition 1.1.1 shall be maintained.

1.1.3 Any person having duties that are or may be affected by the matters set out in this permit shall have convenient access to a copy of it kept at or near the place where those duties are carried out.

1.2 Energy efficiency

1.2.1 The Operator shall:

- (a) take appropriate measures to ensure that energy is used efficiently in the activities;
- (b) review and record at least every four years whether there are suitable opportunities to improve the energy efficiency of the activities; and
- (c) take any further appropriate measures identified by a review.

1.3 Efficient use of raw materials

1.3.1 The Operator shall:

- (a) take appropriate measures to ensure that raw materials and water are used efficiently in the activities;
- (b) maintain records of raw materials and water used in the activities;
- (c) review and record at least every four years whether there are suitable alternative materials that could reduce environmental impact or opportunities to improve the efficiency of raw material and water use; and
- (d) take any further appropriate measures identified by a review.

1.4 Avoidance, recovery and disposal of wastes produced by the activities

1.4.1 The Operator shall take appropriate measures to ensure that:

- (a) the waste hierarchy referred to in Article 4 of the Waste Framework Directive is applied to the generation of waste by the activities; and
- (b) any waste generated by the activities is treated in accordance with the waste hierarchy referred to in Article 4 of the Waste Framework Directive; and
- (c) where disposal is necessary, this is undertaken in a manner which minimises its impact on the environment.

1.4.2 The Operator shall review and record at least every four years whether changes to those measures should be made and take any further appropriate measures identified by a review.

2 Operations

2.1 Permitted activities

2.1.1 The Operator is only authorised to carry out the activities specified in schedule 1 table S1.1 (the “activities”).

2.2 The site

2.2.1 The activities shall not extend beyond the site, being the land shown edged in green on the site plan at schedule 7 to this permit.

2.3 Operating techniques

2.3.1 The activities shall, subject to the conditions of this permit, be operated using the techniques and in the manner described in the documentation specified in schedule 1, table S1.2, unless otherwise agreed in writing by the Environment Agency.

2.3.2 If notified by the Environment Agency that the activities are giving rise to pollution, the Operator shall submit to the Environment Agency for approval within the period specified, a revision of any plan or other documentation (“plan”) specified in schedule 1, table S1.2 or otherwise required under this permit which identifies and minimises the risks of pollution relevant to that plan, and shall implement the approved revised plan in place of the original from the date of approval, unless otherwise agreed in writing by the Environment Agency.

2.3.3 Any raw materials or fuels listed in schedule 2 table S2.1 shall conform to the specifications set out in that table.

2.3.4 The Operator shall ensure that where waste produced by the activities is sent to a relevant waste operation, that operation is provided with the following information, prior to the receipt of the waste:

- (a) the nature of the process producing the waste;
- (b) the composition of the waste;
- (c) the handling requirements of the waste;
- (d) the hazardous property associated with the waste, if applicable; and
- (e) the waste code of the waste.

2.3.5 The Operator shall ensure that where waste produced by the activities is sent to a landfill site, it meets the waste acceptance criteria for that landfill.

2.4 Improvement programme

2.4.1 The Operator shall complete the improvements specified in schedule 1 table S1.3 by the date specified in that table unless otherwise agreed in writing by the Environment Agency.

2.4.2 Except in the case of an improvement which consists only of a submission to the Environment Agency, the Operator shall notify the Environment Agency within 14 days of completion of each improvement.

3 Emissions and monitoring

3.1 Emissions to water, air or land

3.1.1 There shall be no point source emissions to water, air or land except from the sources and emission points listed in schedule 3 tables S3.1 and S3.2.

- 3.1.2 The limits given in schedule 3 shall not be exceeded.
- 3.1.3 Periodic monitoring shall be carried out at least once every 5 years for groundwater and 10 years for soil, unless such monitoring is based on a systematic appraisal of the risk of contamination.
- 3.1.4 For the following activities referenced in schedule 1, table S1.1 (AR2) the first monitoring measurements shall be carried out within four months of 01/01/2030 for boiler A3 and within four months of the issue date of the permit for boiler A4; or of the date when the MCP(s) is first put into operation, whichever is later. For the following activities referenced in schedule 1, table S1.1 (AR2) the monitoring measurements has been retained for boiler A7 and A8.

3.2 Emissions of substances not controlled by emission limits

- 3.2.1 Emissions of substances not controlled by emission limits (excluding odour) shall not cause pollution. The Operator shall not be taken to have breached this condition if appropriate measures, including, but not limited to, those specified in any approved emissions management plan, have been taken to prevent or where that is not practicable, to minimise, those emissions.
- 3.2.2 The Operator shall:
- (a) if notified by the Environment Agency that the activities are giving rise to pollution, submit to the Environment Agency for approval within the period specified, an emissions management plan which identifies and minimises the risks of pollution from emissions of substances not controlled by emission limits;
 - (b) implement the approved emissions management plan, from the date of approval, unless otherwise agreed in writing by the Environment Agency.
- 3.2.3 All liquids in containers, whose emission to water or land could cause pollution, shall be provided with secondary containment, unless the Operator has used other appropriate measures to prevent or where that is not practicable, to minimise, leakage and spillage from the primary container.

3.3 Odour

- 3.3.1 Emissions from the activities shall be free from odour at levels likely to cause pollution outside the site, as perceived by an authorised officer of the Environment Agency, unless the Operator has used appropriate measures, including, but not limited to, those specified in any approved odour management plan, to prevent or where that is not practicable to minimise the odour.
- 3.3.2 The Operator shall:
- (a) if notified by the Environment Agency that the activities are giving rise to pollution outside the site due to odour, submit to the Environment Agency for approval within the period specified, an odour management plan which identifies and minimises the risks of pollution from odour;
 - (b) implement the approved odour management plan, from the date of approval, unless otherwise agreed in writing by the Environment Agency.

3.4 Noise and vibration

- 3.4.1 Emissions from the activities shall be free from noise and vibration at levels likely to cause pollution outside the site, as perceived by an authorised officer of the Environment Agency, unless the Operator has used appropriate measures, including, but not limited to, those specified in any approved noise and vibration management plan to prevent or where that is not practicable to minimise the noise and vibration.
- 3.4.2 The Operator shall:
- (a) if notified by the Environment Agency that the activities are giving rise to pollution outside the site due to noise and vibration, submit to the Environment Agency for approval within the period

specified, a noise and vibration management plan which identifies and minimises the risks of pollution from noise and vibration;

- (b) implement the approved noise and vibration management plan, from the date of approval, unless otherwise agreed in writing by the Environment Agency.

3.5 Monitoring

- 3.5.1 The Operator shall, unless otherwise agreed in writing by the Environment Agency, undertake the monitoring specified in the following tables in schedule 3 to this permit:
 - (a) point source emissions specified in tables S3.1 and S3.2;
- 3.5.2 The Operator shall maintain records of all monitoring required by this permit including records of the taking and analysis of samples, instrument measurements (periodic and continual), calibrations, examinations, tests and surveys and any assessment or evaluation made on the basis of such data.
- 3.5.3 Monitoring equipment, techniques, personnel and organisations employed for the emissions monitoring programme and the environmental or other monitoring specified in condition 3.5.1 shall have either MCERTS certification or MCERTS accreditation (as appropriate), where available, unless otherwise agreed in writing by the Environment Agency.
- 3.5.4 Permanent means of access shall be provided to enable sampling/monitoring to be carried out in relation to the emission points specified in schedule 3 tables S3.1 and S3.2 unless otherwise agreed in writing by the Environment Agency.

3.6 Pests

- 3.6.1 The activities shall not give rise to the presence of pests which are likely to cause pollution, hazard or annoyance outside the boundary of the site. The Operator shall not be taken to have breached this condition if appropriate measures, including, but not limited to, those specified in any approved pests management plan, have been taken to prevent or where that is not practicable, to minimise the presence of pests on the site.
- 3.6.2 The Operator shall:
 - (a) if notified by the Environment Agency, submit to the Environment Agency for approval within the period specified, a pests management plan which identifies and minimises risks of pollution from pests;
 - (b) implement the pests management plan, from the date of approval, unless otherwise agreed in writing by the Environment Agency.

4 Information

4.1 Records

- 4.1.1 All records required to be made by this permit shall:
 - (a) be legible;
 - (b) be made as soon as reasonably practicable;
 - (c) if amended, be amended in such a way that the original and any subsequent amendments remain legible, or are capable of retrieval; and
 - (d) be retained, unless otherwise agreed in writing by the Environment Agency, for at least 6 years from the date when the records were made, or in the case of the following records until permit surrender:
 - (i) off-site environmental effects; and

- (ii) matters which affect the condition of the land and groundwater.

4.1.2 The Operator shall keep on site all records, plans and the management system required to be maintained by this permit, unless otherwise agreed in writing by the Environment Agency.

4.2 Reporting

4.2.1 The Operator shall send all reports and notifications required by the permit to the Environment Agency using the contact details supplied in writing by the Environment Agency.

4.2.2 A report or reports on the performance of the activities over the previous year shall be submitted to the Environment Agency by 31 January (or other date agreed in writing by the Environment Agency) each year. The report(s) shall include as a minimum:

- (a) a review of the results of the monitoring and assessment carried out in accordance with the permit including an interpretive review of that data;
- (b) the annual production/treatment data set out in schedule 4 table S4.2; and
- (c) the performance parameters set out in schedule 4 table S4.3 using the forms specified in table S4.4 of that schedule.

4.2.3 Within 28 days of the end of the reporting period the Operator shall, unless otherwise agreed in writing by the Environment Agency, submit reports of the monitoring and assessment carried out in accordance with the conditions of this permit, as follows:

- (a) in respect of the parameters and emission points specified in schedule 4 table S4.1;
- (b) for the reporting periods specified in schedule 4 table S4.1 and using the forms specified in schedule 4 table S4.4; and
- (c) giving the information from such results and assessments as may be required by the forms specified in those tables.

4.2.4 The Operator shall, unless notice under this condition has been served within the preceding four years, submit to the Environment Agency, within six months of receipt of a written notice, a report assessing whether there are other appropriate measures that could be taken to prevent, or where that is not practicable, to minimise pollution.

4.3 Notifications

4.3.1 In the event:

- (a) that the operation of the activities gives rise to an incident or accident which significantly affects or may significantly affect the environment, the Operator must immediately—
 - (i) inform the Environment Agency,
 - (ii) take the measures necessary to limit the environmental consequences of such an incident or accident, and
 - (iii) take the measures necessary to prevent further possible incidents or accidents;
- (b) of a breach of any permit condition the Operator must immediately—
 - (i) inform the Environment Agency, and
 - (ii) take the measures necessary to ensure that compliance is restored within the shortest possible time;
- (c) of a breach of permit condition which poses an immediate danger to human health or threatens to cause an immediate significant adverse effect on the environment, the Operator must immediately suspend the operation of the activities or the relevant part of it until compliance with the permit conditions has been restored.

- 4.3.2 Any information provided under condition 4.3.1 shall be confirmed by sending the information listed in schedule 5 to this permit within the time period specified in that schedule.
- 4.3.3 Where the Environment Agency has requested in writing that it shall be notified when the Operator is to undertake monitoring and/or spot sampling, the Operator shall inform the Environment Agency when the relevant monitoring and/or spot sampling is to take place. The Operator shall provide this information to the Environment Agency at least 14 days before the date the monitoring is to be undertaken.
- 4.3.4 The Environment Agency shall be notified within 14 days of the occurrence of the following matters, except where such disclosure is prohibited by Stock Exchange rules:
- Where the Operator is a registered company:
- (a) any change in the Operator's trading name, registered name or registered office address; and
 - (b) any steps taken with a view to the Operator going into administration, entering into a company voluntary arrangement or being wound up.
- Where the Operator is a corporate body other than a registered company:
- (a) any change in the Operator's name or address; and
 - (b) any steps taken with a view to the dissolution of the Operator.
- In any other case:
- (a) the death of any of the named Operators (where the Operator consists of more than one named individual);
 - (b) any change in the Operator's name(s) or address(es); and
 - (c) any steps taken with a view to the Operator, or any one of them, going into bankruptcy, entering into a composition or arrangement with creditors, or, in the case of them being in a partnership, dissolving the partnership.
- 4.3.5 Where the Operator proposes to make a change in the nature or functioning, or an extension of the activities, which may have consequences for the environment and the change is not otherwise the subject of an application for approval under the Regulations or this permit:
- (a) the Environment Agency shall be notified at least 14 days before making the change; and
 - (b) the notification shall contain a description of the proposed change in operation.
- 4.3.6 The Environment Agency shall be given at least 14 days' notice before implementation of any part of the site closure plan.
- 4.3.7 Where the Operator has entered into a climate change agreement with the Government, the Environment Agency shall be notified within one month of:
- (a) a decision by the Secretary of State not to re-certify the agreement;
 - (b) a decision by either the Operator or the Secretary of State to terminate the agreement; and
 - (c) any subsequent decision by the Secretary of State to re-certify such an agreement.

4.4 Interpretation

- 4.4.1 In this permit the expressions listed in schedule 6 shall have the meaning given in that schedule.
- 4.4.2 In this permit references to reports and notifications mean written reports and notifications, except where reference is made to notification being made "immediately", in which case it may be provided by telephone.

Schedule 1 – Operations

Table S1.1 activities			
Activity reference	Activity listed in Schedule 1 of the EP Regulations	Description of specified activity	Limits of specified activity
AR1	Section 6.8 Part A1 (d) (iii) (aa)	Treatment and processing, other than exclusively packaging, of the following raw materials, whether previously processed or unprocessed, intended for the production of food or feed (where the weight of the finished product excludes packaging) - animal and vegetable raw materials (other than milk only), both in combined and separate products, with a finished product production capacity in tonnes per day greater than - 75 if A is equal to 10 or more, where 'A' is the portion of animal material in percent of weight of the finished product production capacity.	From receipt of raw materials to production of finished meat product including storage and dispatch offsite. Production capacity is limited to 260 tonnes per day.
Directly Associated Activity			
AR2	Steam, heat, hot water and electrical power supply	1 x 1.3 MWth steam/hot water boiler (A3), 1 x 1.4 MWth steam/hot water boiler (A4), and 1 x 3.6 steam/hot water (A7) MWth natural gas fired boilers. 3 x 0.250 MWth hot water heaters (A5). 1 x 2.9 MWth natural gas fired thermal oil heating plant (A8).	From receipt of fuel to release of products of combustion to air.
AR3	Operation of ovens	3 x 0.605 MWth hot oil heated fryers (A6), 1 x hot oil/steam oven, steam ovens/grills 1.4 MWth (aggregated) (A9 – A17), all natural gas fired.	From receipt of fuel to release of products of combustion to air.
AR4	Operation of meat smoker chambers	2 x meat smoker chambers (A26a and A26b).	From receipt of fuel to release of products of combustion to air.
AR5	Raw material storage and handling	Storage and handling of raw materials at the installation	From receipt of raw materials to dispatch of final product.
AR6	Use of refrigerants	Use of refrigerants in cooling, chilling and/or freezing systems at the installation.	From receipt of raw materials to dispatch of final product.

Table S1.1 activities			
Activity reference	Activity listed in Schedule 1 of the EP Regulations	Description of specified activity	Limits of specified activity
AR7	Storage and use of chemicals and oils	Storage and use of chemicals and oils at the installation.	From receipt of chemicals and oils to disposal of wastes arising.
AR8	Waste storage and handling	Storage and handling of waste materials	From generation of waste to storage pending removal for disposal or recovery.

Table S1.2 Operating techniques		
Description	Parts	Date Received
Application EPR/KP3733AN/A001	Part B2 and B3 of the application and supporting documents. Additional information received regarding environmental risk assessment, baseline data, emission points to sewer and air (Emails dated 10/02/2015).	Duly Made 23/03/2015
EPR/KP3733AN/A001 Additional information	Additional information received by email regarding boiler/heater sizes.	22/04/2015
Application EPR/KP3733AN/V003	Sutton Fields BAT statement, BAT/SF – July 2020 Version 1	17/07/2020
Application EPR/KP3733AN/V004	All sections and supporting information of Section C2 and C3 including Environmental Risk Assessment, Operating Techniques, Energy Efficiency, Energy Use, and Waste Avoidance.	Duly made 03/11/2021
Application EPR/KP3733AN/V007	Part C2 and C3 of the application and supporting documents including Environment Risk Assessment, Operating Techniques, Energy Efficiency, Use of Raw Materials, and Waste Avoidance.	Duly made 10/04/2024
Regulation 61 (1) Notice – Responses to questions dated 01/08/2022	All parts	Received 01/12/2022
Regulation 61(1) Notice – request for further information dated 27/06/2024	Information requested in relation to Reg.61 response tool concerning BATc 3, 5, 11, 12, 29, medium combustion plant, and site emission source points to air plan.	Received 10/07/2024
Additional information	Information regarding a temporary replacement of existing medium combustion plant (1.3 MWth boiler A4) that was beyond economical repair during this application's determination, that was replaced by a third-party leased (1.4 MWth) new boiler.	Received 23/07/2024

Table S1.3 Improvement programme requirements		
Reference	Requirement	Date
IC8	<p>The Operator shall submit, for approval by the Environment Agency, a report demonstrating achievement of the 'Narrative' BAT conclusions as identified in the Food, Drink and Milk Bref published on 4 December 2019 where BAT is currently not demonstrated or achieved. The report shall include, but not be limited to, the following:</p> <ul style="list-style-type: none"> • Methodology applied for achieving BAT • Demonstrating that BAT has been achieved. <p>The report shall address the BAT Conclusions for Food, Drink and Milk Industries with respect to BATc 5.</p> <p>Refer to BAT Conclusions for a full description of the BAT requirement.</p>	<p>3 months from date of issue or as agreed in writing by the Environment Agency 04/12/2024</p>
IC9	<p>The operator shall confirm, achievement of the 'Narrative' BAT conclusions as identified in the Food, Drink and Milk Bref published on 4 December 2019 where BAT is currently not demonstrated or achieved with respect to BATc 11 and 12.</p> <p>Refer to BAT Conclusions for a full description of the BAT requirement.</p>	<p>3 months from date of issue or as agreed in writing by the Environment Agency 04/12/2024</p>
IC10	<p>The Operator shall undertake a survey of the waste water buffer storage at the site and review measures against relevant standard including:</p> <p>The operator shall submit a written report that meets the Narrative BAT requirements for the BAT Conclusions for Food, Drink and Milk Industries with respect to BAT 11, to the Environment Agency for approval, outlining the results of the survey and the review of feasibility of options and provide details of:</p> <ul style="list-style-type: none"> • current containment measures • improvements proposed • time scale for implementation of improvements. <p>The operator shall implement the proposed improvements in line with the timescales agreed by the Environment Agency.</p>	<p>12 months from permit issue or as agreed in writing by the Environment Agency 04/09/2025</p>
IC11	<p>The Operator shall submit a written report to the Environment Agency for technical assessment and approval on the feasibility of installing effluent treatment and include a review of treatment options available along with their associated benefits. Justification is required where no on-site treatment is provided, taking into account the nature of the wastewater and any subsequent off-site treatment. In addition the report needs to consider the appropriate on-site monitoring of the effluent stream prior to disposal. (BAT 3, 4 and 12 Best Available Techniques Reference Document and BAT Conclusions document for the food, drink and milk industry dated December 2019).</p>	<p>12 months from permit issue or as agreed in writing by the Environment Agency 04/09/2025</p>

Schedule 2 – Waste types, raw materials and fuels

Table S2.1 Raw materials and fuels	
Raw materials and fuel description	Specification
--	--

Schedule 3 – Emissions and monitoring

Table S3.1 Point source emissions to air – emission limits and monitoring requirements						
Emission point ref. & location on site plan in Schedule 7	Source	Parameter	Limit (including unit)	Reference period	Monitoring frequency	Monitoring standard or method
A3	Gas Boiler Stack (1.3 MWth) ^[Note 1]	Oxides of Nitrogen (NO and NO ₂ expressed as NO ₂)	250 mg/m ³	Periodic	Every three years	MCERTS BS EN14792
		Carbon monoxide	No Limit	Periodic	Every three years	MCERTS BS EN15058
A4	Gas Boiler Stack (1.4 MWth) ^[Note 2]	Oxides of Nitrogen (NO and NO ₂ expressed as NO ₂)	100 mg/m ³	Periodic	Every three years	MCERTS BS EN14792
		Carbon monoxide	No Limit	Periodic	Every three years	MCERTS BS EN15058
A5	Water heaters 3 x 0.25MWth	No parameters set	No limit set	--	--	--
A6	Oven outlet	No parameters set	No limit set	--	--	--
A7	Boiler 3.6 MWth natural gas fired boiler	Oxides of Nitrogen (NO and NO ₂ expressed as NO ₂)	100 mg/m ³	Periodic	Every three years	MCERTS BS EN14792
		Carbon monoxide	No Limit	Periodic	Every three years	MCERTS BS EN15058
A8	Boiler 2.9 MWth natural gas fired thermal oil heater	Oxides of Nitrogen (NO and NO ₂ expressed as NO ₂)	100 mg/m ³	Periodic	Every three years	MCERTS BS EN14792
		Carbon monoxide	No Limit	Periodic	Every three years	MCERTS BS EN15058

Table S3.1 Point source emissions to air – emission limits and monitoring requirements						
Emission point ref. & location on site plan in Schedule 7	Source	Parameter	Limit (including unit)	Reference period	Monitoring frequency	Monitoring standard or method
A9 – A14	Fryer vents	No parameters set	No limit set	--	--	--
A15 – A17	Oven vents	No parameters set	No limit set	--	--	--
A18 – A25	Relief vents, safety vents and local exhaust ventilation	No parameters set	No limit set	--	--	--
A26	Smoke chamber (A26 a)	Total Volatile Organic Compounds (TVOC)	50mg/m ³ [Note 3]	Average	Annually	BS EN12619
		Oxides of Nitrogen (NO and NO ₂ expressed as NO _x) [Note 4]	No limit	Periodic	Annually	BS EN14792
		Carbon monoxide [Note 4]	No limit	Periodic	Annually	BS EN15058
	Smoke chamber (A26 b)	Total Volatile Organic Compounds (TVOC)	50mg/m ³ [Note 3]	Average	Annually	BS EN12619
		Oxides of Nitrogen (NO and NO ₂ expressed as NO _x) [Note 4]	No limit	Periodic	Annually	BS EN14792
		Carbon monoxide [Note 4]	No limit	Periodic	Annually	BS EN15058

Note 1: The emission monitoring and limits requirements apply from 1 January 2030, unless otherwise advised by the Environment Agency and if the boiler is replaced.

Note 2: The emission monitoring and limits requirements apply from date of permit issue, unless otherwise advised by the Environment Agency and if the boiler is replaced.

Note 3: The BAT-AEL does not apply when the TVOC emission load is below 500g/h.

Note 4: The monitoring only applies when a thermal oxidiser is used.

Table S3.2 Point source emissions to sewer, effluent treatment plant or other transfers off-site–emission limits and monitoring requirements						
Emission point ref. & location	Source	Parameter	Limit (incl. Unit)	Reference period	Monitoring frequency	Monitoring standard or method
S1 – West discharge [S1 on site plan in schedule 7] emission to Yorkshire Water foul sewer.	Process effluent and site drainage	No parameters set	No limit set	--	--	--
S2 – East discharge [S2 on site plan in schedule 7] emission to Yorkshire Water foul sewer.	Process effluent and site drainage	No parameters set	No limit set	--	--	--
S3 Aquarius discharge [S3 on site plan in schedule 7] emission to Yorkshire Water foul sewer.	Process effluent and site drainage	No parameters set	No limit set	--	--	--

Schedule 4 – Reporting

Parameters, for which reports shall be made, in accordance with conditions of this permit, are listed below.

Parameter	Emission or monitoring point/reference	Reporting period	Period begins
Point source emissions to air	A26a & A26b	Every 12 months	1 January
Parameters as required by condition 3.5.1	A3, A4, A7 & A8	First monitoring undertaken in accordance with Condition 3.1.4 to be reported within 3 months, and then every 3 years thereafter	From first monitoring requirements in accordance with Condition 3.1.4

Parameter	Units
Total product produced.	tonnes

Parameter	Frequency of assessment	Units
Water usage	Annually	m ³
Energy usage	Annually	MWh
Waste	Annually	tonnes
COD loss efficiency	Annually*	COD te/te product
Food waste	Annually	Tonnes

*COD loss efficiency to be calculated on a weekly frequency, reported annually

Parameter	Reporting form	Form version number and date
Point source emissions to air	Emissions to Air Reporting Form, or other form as agreed in writing by the Environment Agency	Version 1, 08/03/2021
Water usage	Water Usage Reporting Form, or other form as agreed in writing by the Environment Agency	Version 1, 08/03/2021
Energy usage	Energy Usage Reporting Form, or other form as agreed in writing by the Environment Agency	Version 1, 08/03/2021
Food Waste	Food waste Reporting Form, or other form as agreed in writing by the Environment Agency	Version 1 06/02/2023
Other performance parameters	Other Performance Parameters Reporting Form, or other form as agreed in writing by the Environment Agency	Version 1, 08/03/2021

Schedule 5 – Notification

These pages outline the information that the Operator must provide.

Units of measurement used in information supplied under Part A and B requirements shall be appropriate to the circumstances of the emission. Where appropriate, a comparison should be made of actual emissions and authorised emission limits.

If any information is considered commercially confidential, it should be separated from non-confidential information, supplied on a separate sheet and accompanied by an application for commercial confidentiality under the provisions of the EP Regulations.

Part A

Permit Number	
Name of Operator	
Location of Facility	
Time and date of the detection	

(a) Notification requirements for any malfunction, breakdown or failure of equipment or techniques, accident, or emission of a substance not controlled by an emission limit which has caused, is causing or may cause significant pollution	
To be notified within 24 hours of detection	
Date and time of the event	
Reference or description of the location of the event	
Description of where any release into the environment took place	
Substances(s) potentially released	
Best estimate of the quantity or rate of release of substances	
Measures taken, or intended to be taken, to stop any emission	
Description of the failure or accident.	

(b) Notification requirements for the breach of a limit	
To be notified within 24 hours of detection unless otherwise specified below	
Emission point reference/ source	
Parameter(s)	
Limit	
Measured value and uncertainty	
Date and time of monitoring	

(b) Notification requirements for the breach of a limit	
To be notified within 24 hours of detection unless otherwise specified below	
Measures taken, or intended to be taken, to stop the emission	

Time periods for notification following detection of a breach of a limit	
Parameter	Notification period

(c) Notification requirements for the breach of permit conditions not related to limits	
To be notified within 24 hours of detection	
Condition breached	
Date, time and duration of breach	
Details of the permit breach i.e. what happened including impacts observed.	
Measures taken, or intended to be taken, to restore permit compliance.	

(d) Notification requirements for the detection of any significant adverse environmental effect	
To be notified within 24 hours of detection	
Description of where the effect on the environment was detected	
Substances(s) detected	
Concentrations of substances detected	
Date of monitoring/sampling	

Part B – to be submitted as soon as practicable

Any more accurate information on the matters for notification under Part A.	
Measures taken, or intended to be taken, to prevent a recurrence of the incident	
Measures taken, or intended to be taken, to rectify, limit or prevent any pollution of the environment which has been or may be caused by the emission	

OFFICIAL

The dates of any unauthorised emissions from the facility in the preceding 24 months.	
---	--

Name*	
Post	
Signature	
Date	

* authorised to sign on behalf of the Operator

Schedule 6 – Interpretation

“accident” means an accident that may result in pollution.

“application” means the application for this permit, together with any additional information supplied by the Operator as part of the application and any response to a notice served under Schedule 5 to the EP Regulations.

“authorised officer” means any person authorised by the Environment Agency under section 108(1) of The Environment Act 1995 to exercise, in accordance with the terms of any such authorisation, any power specified in section 108(4) of that Act.

“average over the sampling period” means the average value of three consecutive measurements of at least 30 minutes each, unless otherwise stated, as defined in the General Considerations section of the Food, Drink & Milk Industries BAT Conclusions.

“EP Regulations” means The Environmental Permitting (England and Wales) Regulations SI 2016 No.1154 and words and expressions used in this permit which are also used in the Regulations have the same meanings as in those Regulations.

“emissions of substances not controlled by emission limits” means emissions of substances to air, water or land from the activities, either from the emission points specified in schedule 3 or from other localised or diffuse sources, which are not controlled by an emission limit.

“Food waste” reporting: Reporting of food waste to use a methodology such as the global Food Loss and Waste Accounting and Reporting Standard (FLW standard) , WRAP’s Target Measure Act initiative or similar.

“groundwater” means all water, which is below the surface of the ground in the saturation zone and in direct contact with the ground or subsoil.

“Industrial Emissions Directive” means DIRECTIVE 2010/75/EU OF THE EUROPEAN PARLIAMENT AND OF THE COUNCIL of 24 November 2010 on industrial emissions, as read in accordance with Schedule 1A to the Environmental Permitting (England and Wales) Regulations 2016.

“MCERTS” means the Environment Agency’s Monitoring Certification Scheme.

“Medium Combustion Plant” or “MCP” means a combustion plant with a rated thermal input equal to or greater than 1 MW but less than 50 MW. An “existing medium combustion plant” is combustion plant operating before 20 December 2018.

“Medium Combustion Plant Directive” or “MCPD” means Directive 2015/2193/EU of the European Parliament and of the Council on the limitation of emissions of certain pollutants into the air from medium combustion plants, as read in accordance with Schedule 1A to the Environmental Permitting (England and Wales) Regulations 2016.

“Pests” means Birds, Vermin and Insects.

Where a minimum limit is set for any emission parameter, for example pH, reference to exceeding the limit shall mean that the parameter shall not be less than that limit.

Unless otherwise stated, any references in this permit to concentrations of substances in emissions into air means:

- in relation to emissions from combustion processes, the concentration in dry air at a temperature of 273K, at a pressure of 101.3 kPa and with an oxygen content of 3% dry for liquid and gaseous fuels, 6% dry for solid fuels; and/or
- in relation to emissions from gas engines or gas turbines, the concentration in dry air at a temperature of 273K, at a pressure of 101.3 kPa and with an oxygen content of 15% dry for liquid and gaseous fuels ; and/or

- in relation to emissions from non-combustion sources, the concentration at a temperature of 273K and at a pressure of 101.3 kPa, with no correction for water vapour content

“year” means calendar year ending 31 December.

Schedule 7 – Site plan



©Crown Copyright. All rights reserved. Environment Agency, 100024198, 2024.

Emissions source points plan 1 of 2:



Emissions source points plan 2 of 2:

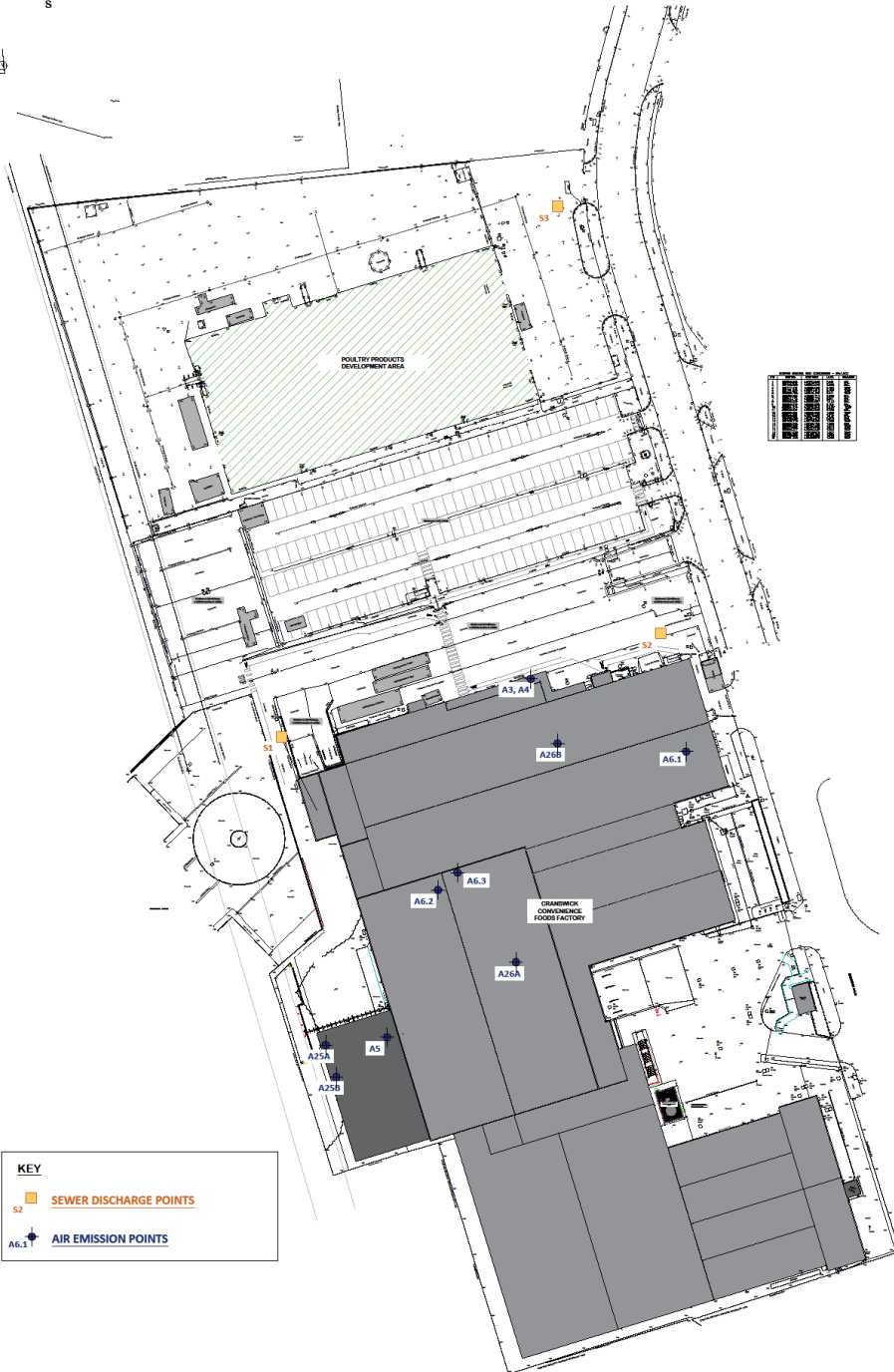

KEY	
	SEWER DISCHARGE POINTS
	AIR EMISSION POINTS

NEW EXTRACT & FLUE EMISSIONS POINTS	
A25A	VENTILATION OUTLET
A25B	PRV OUTLET
A26A	SMOKER EXHAUST VENT
A26B	SMOKER EXHAUST VENT

Notes:
 This document is the property of David Trundley Design Services Ltd and may not be removed, loaned or copied in part or in whole without written permission © 2020.
 All dimensions are in millimetres unless stated otherwise. It is recommended that information is not scaled off this drawing.
 This drawing should be read in conjunction with all other relevant information, specifications & schedules.
 If this drawing is received electronically it is the recipient's responsibility to print the document at the correct scale.
 All dimensions to be checked on site prior to commencing work and any discrepancies to be advised immediately.
CONSTRUCTION (Design & Management) REGULATIONS 2015: David Trundley Design Services Ltd are employed as 'Designer' and will provide information to those responsible for the 'Principal Designer' and to the client.
 David Trundley Design Services Ltd are responsible for the 'Architectural' design of the elements included on this drawing only.
 Architectural design has been carried out with due consideration for the safety during construction, occupation and maintenance of the finished structure.
 The works contain no extraordinary hazards or risks that are not present during routine construction operations that would not normally be apparent to a competent contractor.
 This information should be included as part of commencement of the Health and safety file for the project.

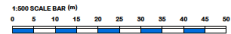

1	06.07.2024	ADA AND ABE AIR EMISSION POINTS ADDED
2	16.08.2024	AS-BUILT CONNECTION LIMITED
3	06.09	Final Issue for Construction

PERMIT

trundley DESIGN SERVICES
 www.trundley.com

Salisbury Street
 Helmsley Road
 Hull, HU7 0YW
 Tel: 01482 617700
 Fax: 01482 617214
 Email: enquiries@trundley.com

CRANSWICK CONVENIENCE FOODS
 HELSINKI ROAD
 HULL
 HU7 0YW

PROPOSED PRODUCTION FACILITY ALTERATIONS

Issued For:
POST DEVELOPMENT EMISSION POINT PLAN
 SF ORIGINAL

Scale:	Date:	Drawn:
1:500 @ A1	MAY 2023	IPGT

Drawing Number: **22-L26-IP03B**

Checked by: _____ Date: _____

If this drawing is unsigned in the check box then the drawing is an unauthorised issue and should not be used for any purposes

END OF PERMIT

OFFICIAL

OFFICIAL