

- KEY:**
- Existing
  - Proposed
  - Demolished

**Notes:**

Confirm all dimensions on site prior to any off site manufacturing.  
 At construction phase do not scale from drawing, use figured dimensions only.  
 Dimensions are in millimetres and to structure unless stated otherwise.  
 Report any discrepancies, conflicts or errors to architect prior to proceeding.  
 Refer to structural engineers design for all load bearing elements, bracing, movement joints and below ground drainage.  
 Refer to mechanical and electrical engineers design for all building services.  
 All works to comply with relevant British Standards and Building Regulations.  
 This drawing and design is the property of 3bd LLP and is issued under license to the named recipient only. All copyright law protecting design, artistic & literary work contained within this drawing remains.

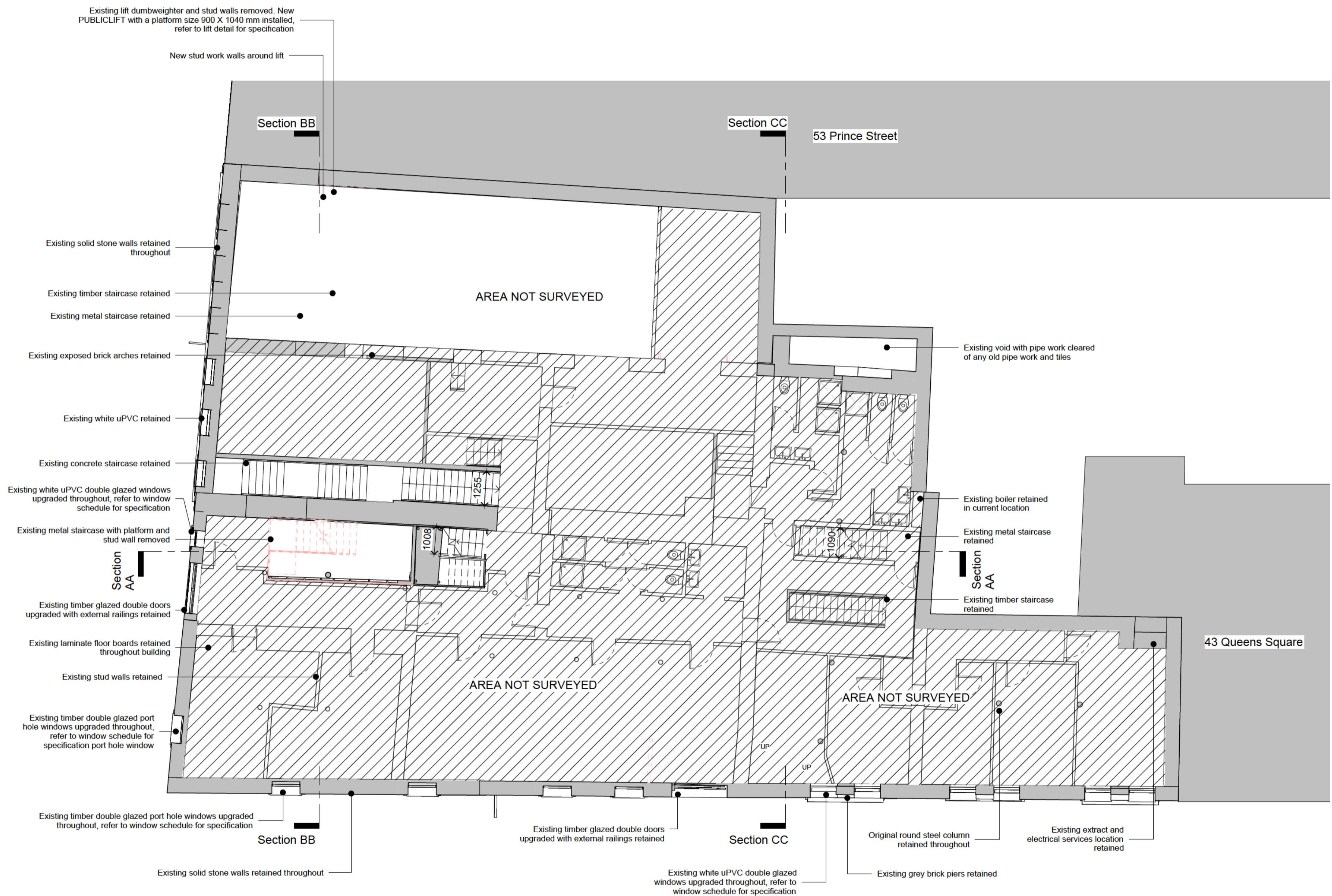

B	Updated to comments	04/03/24
A	Issued to the client	31/01/24
Rev	Description	Date

**FOR PLANNING**

**3bd** LLP  
 Architects  
 RIBA Chartered Practice © 2021  
 15&17 Backfields Lane, Stokes Croft, Bristol, BS2 8QW  
 T 01173 707 380 e:partners@3bdarchitects.com

Client Vijay Patel	
Project 57 Prince Street, Bristol BS1 4QH	
Drawing Title PROPOSED SECOND FLOOR PLAN	
Drawing Number 388-PLA- 112	Rev. B
Date Jan '24	Scale 1:100@ A2
Drawn JB	Chkd SR

