

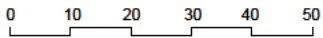

LOCATION PLAN
1 : 1250

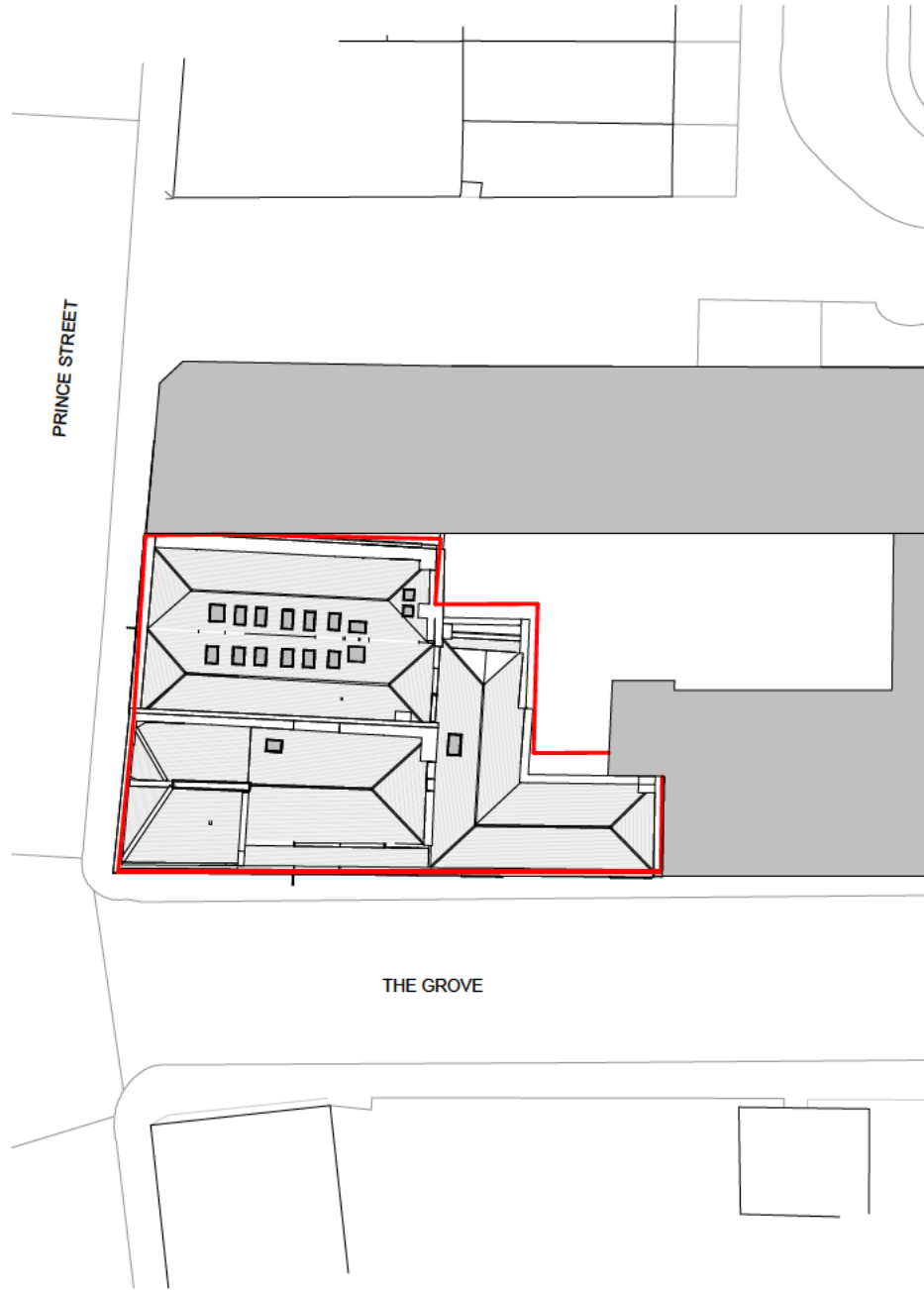

Mapping contents © Crown copyright and database rights 2023
Ordnance Survey 100035207



SITE PLAN
1 : 500

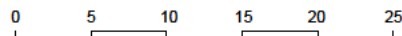

Notes:

Confirm all dimensions on site prior to any off site manufacturing. Dimensions are in millimetres and to structure unless stated otherwise.
Report all discrepancies, conflicts or errors to architect prior to proceeding.
Refer to structural engineers design for all load bearing elements, bracing, movement joints and below ground drainage.
Refer to mechanical and electrical engineers design for all building services.
All works to comply with relevant British Standards and Building Regulations.
This drawing and design is the property of 3bd LLP and is issued under license to the named recipient only. All copyright law protecting design, artistic & literary work contained within this drawing remains.

B	Issued to the client	31/01/24
A	Issued to fire consultant	23/01/24
Rev.	Description	Date

FOR PLANNING

3bd LLP
Architects

RIBA Chartered Practice © 2023

15&17 Backfields Lane, Stokes Croft, Bristol BS2 8QW

t 01173 707 380

Client

Vijay Patel

Project

57 Prince Street, Bristol BS1
4QH

Drawing Title

EXISTING SITE LOCATION
PLAN

Drawing Number

388-PLA- 001

Rev.

B

Date

Jan '24

Scale

As indicated @ A4

Drawn

JB

Chkd

SR