

Proposed Ground Floor Plan

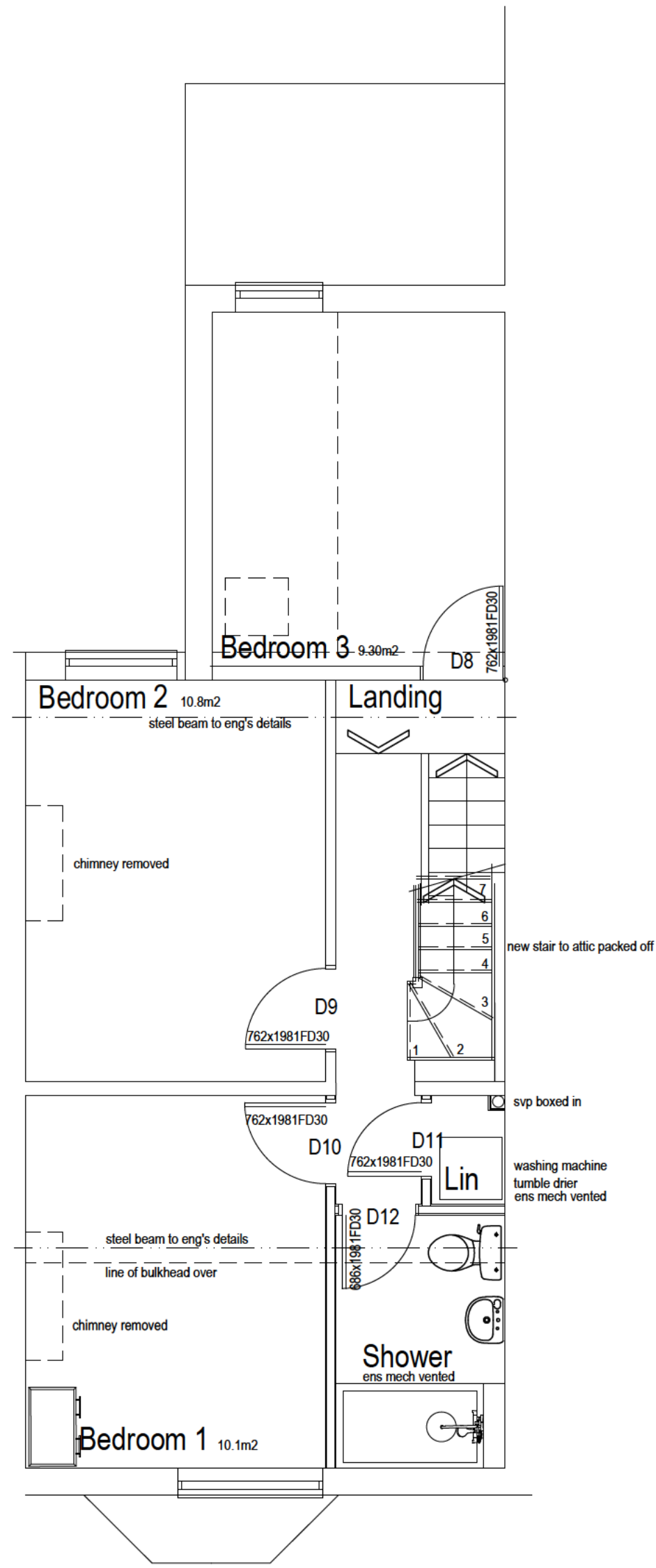

Proposed First Floor Plan

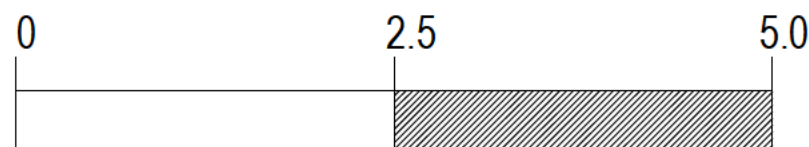

Rev:	Date:	Note

Proposed Alterations and extension to
**85 Ruby Street Bedminster
 Bristol**

Proposed Floor Plans

Date:
 Oct 2022

Scale:
 1:50 @ A3

DWG No:
3538/10

David Cahill

Design Consultants Ltd
 Unit 2 Office 4 Tower Lane Business Park
 Warmley Bristol BS30 8XT

Tel: [REDACTED]