

EARTH ENVIRONMENTAL  
& GEOTECHNICAL

## Coal Mining Risk Assessment

20 Conway Road

Brislington

Bristol

BS4 3RF

Report Ref: B648/24

February 2024

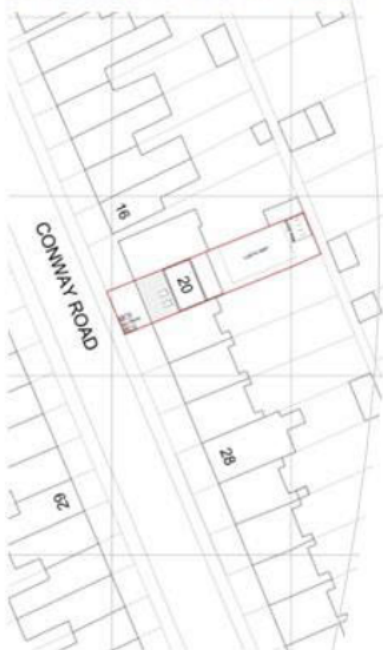

Earth Environmental & Geotechnical (Southern) Ltd  
3 Tollbridge Studios  
Toll Bridge Road  
Bath  
BA1 7DE

Tel : 01225 858823

Email [southwest@earthenvironmental.co.uk](mailto:southwest@earthenvironmental.co.uk)



**COAL MINING RISK ASSESSMENT**

**20 CONWAY ROAD**

**BRISLINGTON**

**BRISTOL**

**BS4 3RF**

**FOR**

**INNOVA PROPERTY**

Earth Environmental & Geotechnical (Southern) Ltd  
3 Tollbridge Studios  
Toll Bridge Road  
Bath  
BA1 7DE  
Tel 01225 858823

**Report No. B3648/24**

**FEBRUARY 2024**

<b>Report Title:</b>	<b>20 Conway Road, Brislington, Bristol, BS4 3RF Coal Mining Risk Assessment</b>
<b>Report Reference:</b>	<b>B3648/24</b>
<b>Client:</b>	<b>Innova Property</b>
<b>Issue Date:</b>	<b>29<sup>th</sup> February 2024</b>
<b>Drafted By:</b>	<b>C.Montgomery</b>
<b>Reviewed By:</b>	<b>S.Leat</b>
<b>Authorised By:</b>	<b>S.Leat</b>

This document has been prepared for the titled project (or named part thereof) and should not be relied upon or used for any other project without an independent check being carried out as to its suitability and prior written authorisation being obtained from Earth Environmental & Geotechnical. Earth Environmental & Geotechnical accepts no responsibility or liability for the consequences of the use of this document, wholly or in part, for any other purpose than that for which it was commissioned. Any persons so using or relying upon this document for such other purpose do so at their own risk.

This report was prepared for the sole use of the Client and shall not be relied upon or transferred to any other party without the express written authorisation of Earth Environmental & Geotechnical. It may contain material subject to copyright or obtained subject to license; unauthorised copying of this report will be in breach of copyright/license.

The findings and opinions provided in this document are given in good faith and are subject to the limitations imposed by employing site assessment methods and techniques, appropriate to the time of investigation and within the limitations and constraints defined within this document. The findings and opinions are relevant to the dates when the assessment was undertaken but should not necessarily be relied upon to represent conditions at a substantially later date.

The findings and opinions conveyed in this report are based on information obtained from a variety of sources as detailed and which Earth Environmental & Geotechnical assumes to be reliable but have not been independently confirmed. Therefore, Earth Environmental & Geotechnical cannot and does not guarantee the authenticity or reliability of third party information it has relied upon.

Where opinions expressed in this report are based on current available guidelines and legislation, no liability can be accepted by Earth Environmental & Geotechnical for the effects of any future changes to such guidelines and legislation.

The limitations of liability of Earth Environmental & Geotechnical for the contents of this document have been agreed with the Client, as set out in the terms and conditions of offer and related contract documentation.

## CONTENTS

<b>1.0</b>	<b>INTRODUCTION.....</b>	<b>1</b>
	Appointment .....	1
	Proposed Development.....	1
	Objective .....	1
	Sources of Information .....	2
<b>2.0</b>	<b>SITE LOCATION AND DESCRIPTION.....</b>	<b>3</b>
<b>3.0</b>	<b>ASSESSMENT OF DATA.....</b>	<b>4</b>
	Geological Information .....	4
	Coal Authority Records .....	5
<b>4.0</b>	<b>COAL MINING RISK ASSESSMENT .....</b>	<b>7</b>
	Scope of Coal Mining Risk Assessment.....	7
	Data Limitations.....	7
	Coal Mining Risks.....	7
	Summary of Risk.....	7
	Proposed Mitigation Strategy .....	8

## APPENDICES

Appendix 1	Coal Authority Mining Report
Appendix 2	Report Limitations

## FIGURES

Figure 1	Proposed Development Details
Figure 2	Site Location Plan
Figure 3	Aerial Photograph Showing Site and Surrounding Area
Figure 4	Geological Map Extract
Figure 5	Site Location and Development High Risk (Hatched) Area

## TABLES

Table 1	Summary of Potential Risks Associated with Coal Mining Legacy
---------	---

## 1.0 INTRODUCTION

### Appointment

- 1.1 Earth Environmental & Geotechnical (Southern) Ltd was instructed by Innova Property (the 'Client'), to undertake a Coal Mining Risk Assessment for a proposed development in Bristol.
- 1.2 A Coal Mining Risk Assessment is required to support a planning application and to assist with the site design process.

### Proposed Development

- 1.3 It is understood the site will be redeveloped for residential purposes.
- 1.4 Details of the proposed development are shown in Figure 1 below.

**Figure 1 – Proposed Development Details**



### Objective

- 1.5 The purpose of the Coal Mining Risk Assessment is to collate available geological, mining and historical data in order to assess the potential for the site to be affected by underground mining. This report has been drafted in accordance with the Coal Authority Coal Mining Risk Assessment Template, January 2011.

## Sources of Information

1.6 The Coal Mining Risk Assessment comprises of a review of the following information sources:

- Online British Geological Survey maps and data.
- Coal Authority Report reference 51003408153001 dated 28<sup>th</sup> February 2024.
- Coal Authority Interactive Map Viewer.
- British Geological Survey online borehole records.
- Google Earth imagery.
- Site Investigations in Areas of Mining Subsidence, FG Bell, 1975.
- The threat of abandoned mines on the stability of urban areas, Barry Clarke, IAEG2006 Paper Number 379, The Geological Society of London, 2006.
- Construction over abandoned mineworkings, CIRIA Special Publication 32, 2002.
- Abandoned Mineworkings, CIRIA 758.

## 2.0 SITE LOCATION AND DESCRIPTION

2.1 The site is located at No. 20 Conway Road in Brislington, Bristol at National Grid Reference 361491 171696 with a nearest postcode of BS4 3RF. The site and surrounding area are shown in Figure 2 below.

Figure 2 – Site Location Plan



2.2 The site is located in a residential area and is currently occupied by the existing property (No. 20) and associated garden. The site and surrounding area are shown in the aerial photograph (Figure 3) below.

Figure 3 – Aerial Photograph Showing Site and Surrounding Area





### 3.0 ASSESSMENT OF DATA

#### Geological Information

- 3.1 The geology of the site has been determined from acquisition of geological maps for the area and examination of Coal Authority records.
- 3.2 The British Geological Survey (BGS) indicates the site is directly underlain by the Redcliffe Sandstone Member of Triassic Age, lying unconformably over Coal Measures strata of Carboniferous Age.
- 3.3 The Redcliffe Sandstone is described as distinctive fine to medium grained, deep red, calcareous and ferruginous sandstone. Commonly decalcified at shallow depths below the surface, giving rise to an uncemented sand.

Figure 4 – Geological Map Extract

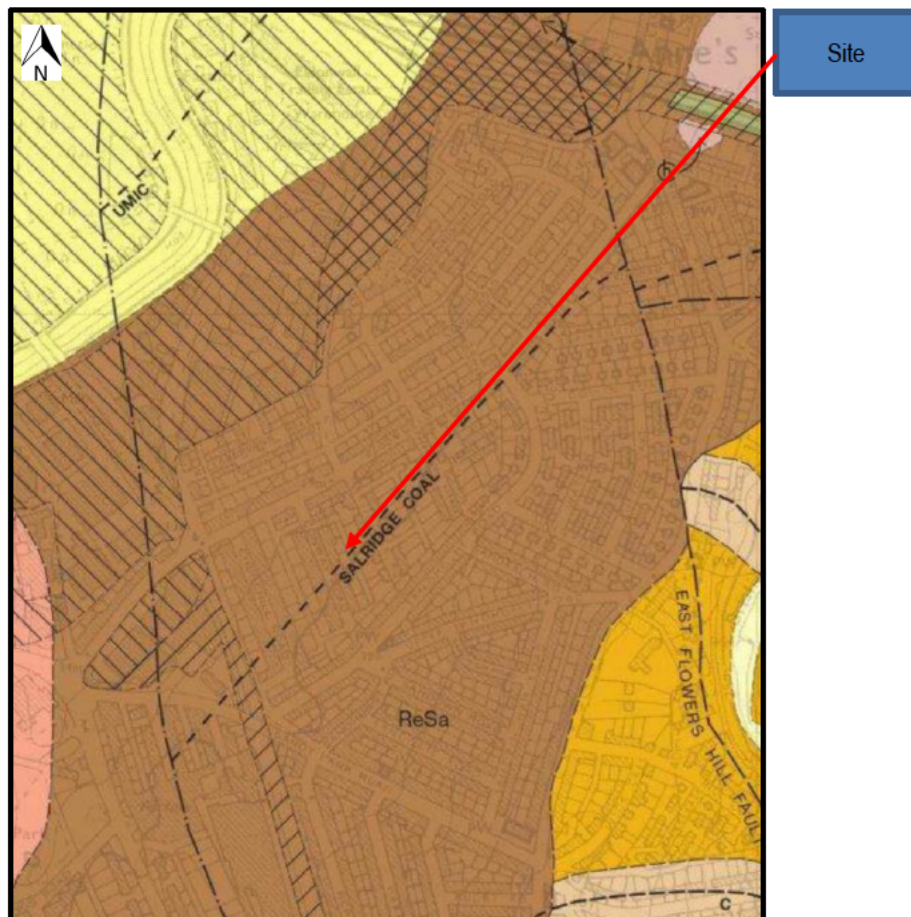

- 3.4 The Salridge Coal seam is shown beneath the site outcropping on the surface of the Coal Measures strata, at depth beneath the Redcliffe Sandstone.



- 3.5 The geological succession indicates the Redcliffe Sandstone can be up to 30m in thickness overlying the Coal Measures strata. The Salridge Seam to be located at the base of the Farringdon and Barren Red Formation of the Coal Measures.
- 3.6 An historical BGS borehole is located 200m to the east-northeast of the site (BGS ref. ST67SW282), which encountered the following ground conditions:
- 0.0 - 3.0mbgl: Made Ground.
  - 3.0 - 3.2mbgl: CLAY.
  - 3.2 - 6.55mbgl: silty clayey SAND.
  - 6.55 - 14.3mbgl: SANDSTONE.
  - 14.3 - 15.2mbgl: CONGLOMERATE.
  - 15.2 - 16.2mbgl: SILTSTONE.
  - 16.2 - 16.5mbgl: SANDSTONE.
- 3.7 The closest available BGS borehole record to the east of the site is located approximately 400m away (reference ST67SW390) and encountered 30m thickness of 'sand, sandstone and pennant grit'.
- 3.8 There are no geological faults or other linear features located on or close to the site.

#### Coal Authority Records

- 3.9 A Coal Authority Mining Report has been acquired for the site and is included in Appendix 1.
- 3.10 There are no recorded underground shallow depth workings beneath the site.
- 3.11 The Coal Authority Report indicates there are probable unrecorded workings at shallow depth beneath the site.
- 3.12 Examination of the Coal Authority online interactive map viewer indicates the site is located within a Development High Risk Area (DHRA) associated with unrecorded shallow workings, as shown in Figure 5 below.

**Figure 5 – Site Location and Development High Risk (Hatched) Area**

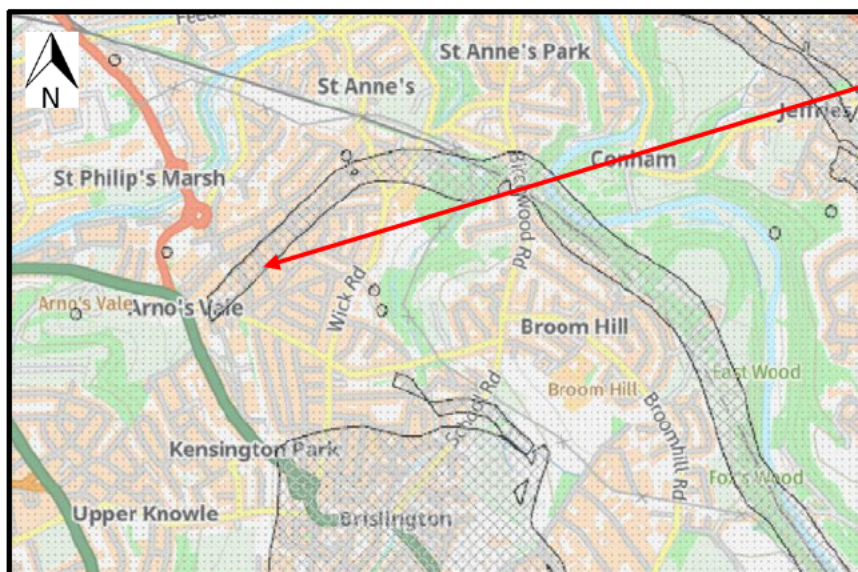

- 3.13 From Figure 5 it appears the DHRA zone coincides with the Salridge Seam which outcrops on the surface of the Coal Measures strata, at depth beneath the Redcliffe Sandstone.
- 3.14 There are no recorded mine entries on or close to the site.
- 3.15 There are no outcrops of coal at surface, geological faults, fissures or breaklines on or close to the site.
- 3.16 There are no opencast mines or Coal Authority managed tips within 500m of the site.
- 3.17 There are no records of remediated sites or coal mining subsidence within 50m of the site.
- 3.18 The Coal Authority has no record of mine gas emissions or mine water treatment schemes on or within 500m of the site.
- 3.19 There are no records of future planned underground mining on or close to the site.

## 4.0 COAL MINING RISK ASSESSMENT

### Scope of Coal Mining Risk Assessment

- 4.1 The objective of the coal mining risk assessment is to provide a desk-based assessment of available geological and mining information relating to the assessment site (and wider area) and to use this information to identify risks present to the proposed development.
- 4.2 As part of the risk assessment, potential mitigation measures (if required) should be considered, including any necessary remedial works.
- 4.3 The outcome of the risk assessment should demonstrate to the Local Authority that the proposed development is or can be made safe (and stable) to meet the requirements of the National Planning Policy Framework (NPPF).

### Data Limitations

- 4.4 It should be appreciated that it did not become a legal requirement to deposit coal mining abandonment plans until the 1870's and that this requirement was not rigorously enforced for some time after. Many shallow coal seams were worked prior to the introduction of first edition Ordnance Survey Maps and information on these workings is often not available. Therefore, if coal seams were accessible, they could have been worked by formal or informal means.
- 4.5 If unrecorded workings are present, then unrecorded mine entries may also be present.

### Coal Mining Risks

- 4.6 The risks associated with coal mining are as follows:
- Collapse of relict workings beneath buildings causing damage to the building fabric and infrastructure.
  - Migration of mine gases from old mine works and mine entries resulting in build-up of flammable and asphyxiating gases in confined areas.
  - Consolidation of relict workings and overlying strata causing structural defects in building fabric and infrastructure.
  - Failure of mine entries causing loss of ground beneath building and external areas.
  - Spontaneous combustion of old mineworkings.

### Summary of Risk

- 4.7 The site is not underlain by recorded shallow depth workings.
- 4.8 The site is located in a development high risk area, which would appear to be associated with a coal seam outcropping on the surface of the coal measures strata beneath the site, at depth beneath overlying Redcliffe Sandstone.
- 4.9 The risk to surface development from these potential workings is dependent on the depth to workings, size (thickness of workings) and thickness of competent rock cover above the workings. Normally, if there is a thickness of 10 times the thickness of workings of competent bedrock above the workings, then the perceived risk is low. Based on the closest available borehole records there would seem to

be a minimum thickness of between 16m and 30m of sand/sandstone in the area of the site, before any coal measures strata could be present. This information indicates there is likely to be sufficient bedrock cover above the workings for the site to be low risk in relation to these workings.

- 4.10 Table 1 below summarises the potential risks associated with coal mining legacy for the proposed development site, identified from the above sources of information.

**Table 1 – Summary of Potential Risks Associated with Coal Mining Legacy**

Coal Mining Issue	Yes	No	Risk Assessment
Underground coal mining (recorded at shallow depths)		N	Low
Underground coal mining (probable at shallow depths)	Y		Low
Coal Outcrops		N	Low
Mine entries (shafts and adits)		N	Low
Coal mining geology (fissures)		N	Low
Record of past mine gas emissions		N	Low
Recorded coal mining surface hazard		N	Low
Surface mining (opencast workings)		N	Low

#### **Proposed Mitigation Strategy**

- 4.11 Based on the above findings, further mitigation measures are not required.

## **APPENDIX 1**

# **COAL AUTHORITY MINING REPORT**





The Coal  
Authority

# Consultants Coal Mining Report

20 Conway Road  
Brislington  
Bristol  
Bristol City  
BS4 3RF

Date of enquiry: 28 February 2024  
Date enquiry received: 28 February 2024  
Issue date: 28 February 2024

Our reference: 51003408153001  
Your reference: B3648

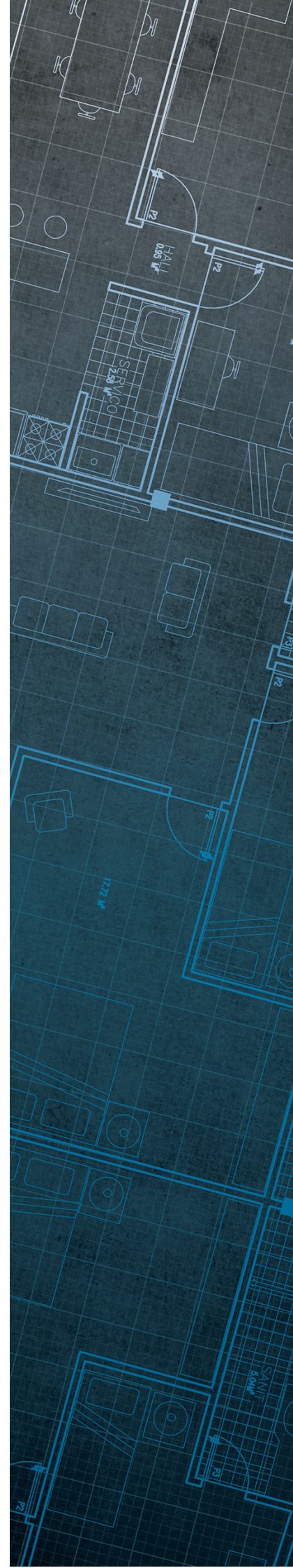



# Consultants

# Coal Mining Report

This report is based on and limited to the records held by the Coal Authority at the time the report was produced.

## Client name



## Enquiry address

20 Conway Road  
Brislington  
Bristol  
Bristol City  
BS4 3RF

## How to contact us

0345 762 6848 (UK)  
+44 (0)1623 637 000 (International)

200 Lichfield Lane  
Mansfield  
Nottinghamshire  
NG18 4RG



 @coalauthority

 /company/the-coal-authority

 /thecoalauthority

 /thecoalauthority

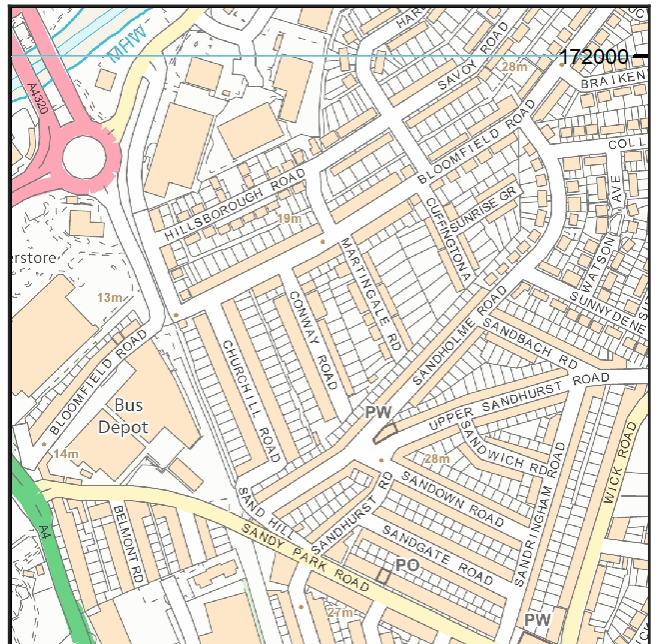

Approximate position of property



Reproduced by permission of Ordnance Survey on behalf of HMSO. © Crown copyright and database right 2018. All rights reserved.

Ordnance Survey Licence number: 100020315

# Section 1 – Mining activity and geology

## **Past underground mining**

No past mining recorded.

## **Probable unrecorded shallow workings**

Yes.

## **Spine roadways at shallow depth**

No spine roadway recorded at shallow depth.

## **Mine entries**

None recorded within 100 metres of the enquiry boundary.

## **Abandoned mine plan catalogue numbers**

None available.

## **Outcrops**

No outcrops recorded.

## **Geological faults, fissures and breaklines**

No faults, fissures or breaklines recorded.

## **Opencast mines**

None recorded within 500 metres of the enquiry boundary.

## **Coal Authority managed tips**

None recorded within 500 metres of the enquiry boundary.

## Section 2 – Investigative or remedial activity

Please refer to the 'Summary of findings' map (on separate sheet) for details of any activity within the area of the site boundary.

### Site investigations

None recorded within 50 metres of the enquiry boundary.

### Remediated sites

None recorded within 50 metres of the enquiry boundary.

### Coal mining subsidence

The Coal Authority has not received a damage notice or claim for the subject property, or any property within 50 metres of the enquiry boundary, since 31 October 1994.

There is no current Stop Notice delaying the start of remedial works or repairs to the property.

The Coal Authority is not aware of any request having been made to carry out preventive works before coal is worked under section 33 of the Coal Mining Subsidence Act 1991.

### Mine gas

None recorded within 500 metres of the enquiry boundary.

### Mine water treatment schemes

None recorded within 500 metres of the enquiry boundary.

## Section 3 – Licensing and future mining activity

### Future underground mining

None recorded.

### Coal mining licensing

None recorded within 200 metres of the enquiry boundary.

### Court orders

None recorded.

### Section 46 notices

No notices have been given, under section 46 of the Coal Mining Subsidence Act 1991, stating that the land is at risk of subsidence.

### Withdrawal of support notices

The property is not in an area where a notice to withdraw support has been given.

The property is not in an area where a notice has been given under section 41 of the Coal Industry Act 1994, cancelling the entitlement to withdraw support.

### Payments to owners of former copyhold land

The property is not in an area where a relevant notice has been published under the Coal Industry Act 1975/Coal Industry Act 1994.

## Section 4 – Further information

Based on the responses in this report, no further information has been highlighted.

### Future development

If development proposals are being considered, technical advice relating to both the investigation of coal and former coal mines and their treatment should be obtained before beginning work on site. All proposals should apply specialist engineering practice required for former mining areas. No development should be undertaken that intersects, disturbs or interferes with any coal or coal mines without first obtaining the permission of the Coal Authority.

**MINE GAS:** Please note, if there are no recorded instances of mine gas within 500m of the enquiry boundary, this does not mean that mine gas is not present within the vicinity. The Coal Authority Mine Gas data is limited to only those sites where a Mine Gas incident has been recorded. Developers should be aware that the investigation of coal seams, mine workings or mine entries may have the potential to generate and/or displace underground gases. Associated risks both to the development site and any neighbouring land or properties should be fully considered when undertaking any ground works. The need for effective measures to prevent gases migrating onto any land or into any properties, either during investigation or remediation work, or after development must also be assessed and properly addressed. In these instances, the Coal Authority recommends that a more detailed Gas Risk Assessment is undertaken by a competent assessor.

## Section 5 – Data definitions

The datasets used in this report have limitations and assumptions within their results. For more guidance on the data and the results specific to the enquiry boundary, please **call us on 0345 762 6848** or **email us at [groundstability@coal.gov.uk](mailto:groundstability@coal.gov.uk)**.

### Past underground coal mining

Details of all recorded underground mining relative to the enquiry boundary. Only past underground workings where the enquiry boundary is within 0.7 times the depth of the workings (zone of likely physical influence) allowing for seam inclination, will be included.

### Probable unrecorded shallow workings

Areas where the Coal Authority believes there to be unrecorded coal workings that exist at or close to the surface (less than 30 metres deep).

### Spine roadways at shallow depth

Connecting roadways either, working to working, or, surface to working, both in-seam and cross measures that exist at or close to the surface (less than 30 metres deep), either within or within 10 metres of the enquiry boundary.

### Mine entries

Details of any shaft or adit either within, or within 100 metres of the enquiry boundary including approximate location, brief treatment details where known, the mineral worked from the mine entry and conveyance details where the mine entry has previously been sold by the Authority or its predecessors British Coal or the National Coal Board.

### Abandoned mine plan catalogue numbers

Plan numbers extracted from the abandoned mines catalogue containing details of coal and other mineral abandonment plans deposited via the Mines Inspectorate in accordance with the Coal Mines Regulation Act and Metalliferous Mines Regulation Act 1872. A maximum of 9 plan extents that intersect with the enquiry boundary will be included. This does not infer that the workings and/or mine entries shown on the abandonment plan will be relevant to the site/property boundary.

### Outcrops

Details of seam outcrops will be included where the enquiry boundary intersects with a conjectured or actual seam outcrop location (derived by either the British Geological Survey or the Coal Authority) or intersects with a defined 50 metres buffer on the coal (dip) side of the outcrop. An indication of whether the Coal Authority believes the seam to be of sufficient thickness and/or quality to have been worked will also be included.

### Geological faults, fissures and breaklines

Geological disturbances or fractures in the bedrock. Surface fault lines (British Geological Survey derived data) and fissures and breaklines (Coal Authority derived data) intersecting with the enquiry boundary will be included. In some circumstances faults, fissures or breaklines have been known to contribute to surface subsidence damage as a consequence of underground coal mining.



### **Opencast mines**

Opencast coal sites from which coal has been removed in the past by opencast (surface) methods and where the enquiry boundary is within 500 metres of either the licence area, site boundary, excavation area (high wall) or coaling area.

### **Coal Authority managed tips**

Locations of disused colliery tip sites owned and managed by the Coal Authority, located within 500 metres of the enquiry boundary.

### **Site investigations**

Details of site investigations within 50 metres of the enquiry boundary where the Coal Authority has received information relating to coal mining risk investigation and/or remediation by third parties.

### **Remediated sites**

Sites where the Coal Authority has undertaken remedial works either within or within 50 metres of the enquiry boundary following report of a hazard relating to coal mining under the Coal Authority's Emergency Surface Hazard Call Out procedures.

### **Coal mining subsidence**

Details of alleged coal mining subsidence claims made since 31 October 1994 either within or within 50 metres of the enquiry boundary. Where the claim relates to the enquiry boundary confirmation of whether the claim was accepted, rejected or whether liability is still being determined will be given. Where the claim has been discharged, whether this was by repair, payment of compensation or a combination of both, the value of the claim, where known, will also be given.

Details of any current 'Stop Notice' deferring remedial works or repairs affecting the property/site, and if so the date of the notice.

Details of any request made to execute preventative works before coal is worked under section 33 of the Coal Mining Subsidence Act 1991. If yes, whether any person withheld consent or failed to comply with any request to execute preventative works.

### **Mine gas**

Reports of alleged mine gas emissions received by the Coal Authority, either within or within 500 metres of the enquiry boundary that subsequently required investigation and action by the Coal Authority to mitigate the effects of the mine gas emission. Please note, if there are no recorded instances of mine gas reported, this does not mean that mine gas is not present within the vicinity. The Coal Authority Mine Gas data is limited to only those sites where a Mine Gas incident has been recorded.

### **Mine water treatment schemes**

Locations where the Coal Authority has constructed or operates assets that remove pollutants from mine water prior to the treated mine water being discharged into the receiving water body.

These schemes are part of the UK's strategy to meet the requirements of the Water Framework Directive. Schemes fall into 2 basic categories: Remedial – mitigating the impact of existing pollution or Preventative – preventing a future pollution incident.

Mine water treatment schemes generally consist of one or more primary settlement lagoons and one or more reed beds for secondary treatment. A small number are more specialised process treatment plants.

### **Future underground mining**

Details of all planned underground mining relative to the enquiry boundary. Only those future workings where the enquiry boundary is within 0.7 times the depth of the workings (zone of likely physical influence) allowing for seam inclination will be included.

### **Coal mining licensing**

Details of all licenses issued by the Coal Authority either within or within 200 metres of the enquiry boundary in relation to the under taking of surface coal mining, underground coal mining or underground coal gasification.

### **Court orders**

Orders in respect of the working of coal under the Mines (Working Facilities and Support) Acts of 1923 and 1966 or any statutory modification or amendment thereof.

### **Section 46 notices**

Notice of proposals relating to underground coal mining operations that have been given under section 46 of the Coal Mining Subsidence Act 1991.

### **Withdrawal of support notices**

Published notices of entitlement to withdraw support and the date of the notice. Details of any revocation notice withdrawing the entitlement to withdraw support given under Section 41 of the Coal Industry Act 1994.

### **Payment to owners of former copyhold land**

Relevant notices which may affect the property and any subsequent notice of retained interests in coal and coal mines, acceptance or rejection notices and whether any compensation has been paid to a claimant.



The map highlights any specific surface or subsurface features within or near to the boundary of the site.

**Key**

Approximate position of the enquiry boundary shown 

---

**How to contact us**  
0345 762 6848 (UK)  
+44 (0)1623 637 000 (International)

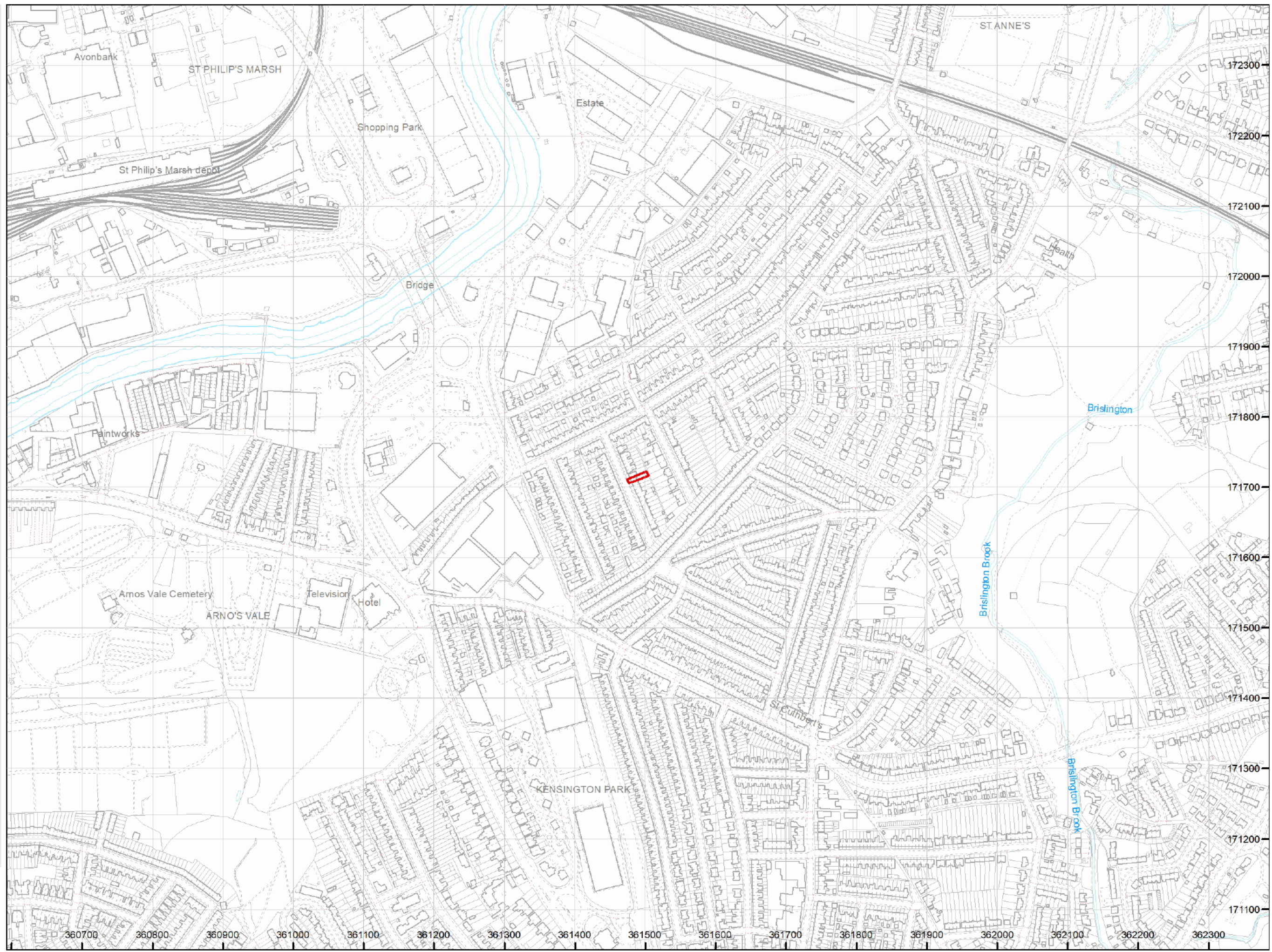



## **APPENDIX 2**

### **REPORT LIMITATIONS**

## **REPORT LIMITATIONS**

This contract was completed by Earth Environmental & Geotechnical Ltd on the basis of a defined programme and scope of works and terms and conditions agreed with the client. This report was compiled with all reasonable skill, and care, bearing in mind the project objectives, the agreed scope of works, the prevailing site conditions, the budget and staff resources allocated to the project.

Other than that, expressly contained in the above paragraph, Earth Environmental & Geotechnical Ltd provides no other representation or warranty whether express or implied, is made in relation to the services. Unless otherwise agreed this report has been prepared exclusively for the use and reliance of the client in accordance with generally accepted consulting practices and for the intended purposes as stated in the agreement under which this work was completed. This report may not be relied upon, or transferred to, by any other party without the written agreement of a Director of Earth Environmental & Geotechnical Ltd.

If a third party relies on this report, it does so wholly at its own and sole risk and Earth Environmental & Geotechnical Ltd disclaims any liability to such parties.

It is Earth Environmental & Geotechnical Ltd understanding that this report is to be used for the purpose described in the introduction to the report. That purpose was an important factor in determining the scope and level of the services. Should the purpose for which the report is used, or the proposed use of the site change, this report will no longer be valid and any further use of, or reliance upon the report in those circumstances by the client without Earth Environmental & Geotechnical Ltd review and advice shall be at the client's sole and own risk.

The report was written in 2024 and should be read in light of any subsequent changes in legislation, statutory requirements and industry best practices. Ground conditions can also change over time and further investigations, or assessment should be made if there is any significant delay in acting on the findings of this report. The passage of time may result in changes in site conditions, regulatory or other legal provisions, technology or economic conditions which could render the report inaccurate or unreliable. The information and conclusions contained in this report should not be relied upon in the future without the written advice of Earth Environmental & Geotechnical Ltd. In the absence of such written advice of Earth Environmental & Geotechnical Ltd, reliance on the report in the future shall be at the client's own and sole risk. Should Earth Environmental & Geotechnical Ltd be requested to review the report in the future, Earth Environmental & Geotechnical Ltd shall be entitled to additional payment at the then existing rate or such other terms as may be agreed between Earth Environmental & Geotechnical Ltd and the client.

The observations and conclusions described in this report are based solely upon the services that were provided pursuant to the agreement between the client and Earth Environmental & Geotechnical Ltd. Earth Environmental & Geotechnical Ltd has not performed any observations, investigations, studies or testing not specifically set out or mentioned within this report.

Earth Environmental & Geotechnical Ltd is not liable for the existence of any condition, the discovery of which would require performance of services not otherwise contained in the services. For the avoidance of doubt, unless otherwise expressly referred to in the introduction to this report, Earth Environmental & Geotechnical Ltd did not seek to evaluate the presence on or off the site of electromagnetic fields, lead paint, radon gas or other radioactive materials.

The services are based upon Earth Environmental & Geotechnical Ltd observations of existing physical conditions at the site gained from a walkover survey of the site together with Earth Environmental & Geotechnical Ltd interpretation of information including documentation, obtained from third parties and from the client on the history and usage of the site. The findings and recommendations contained in this report are based in part upon information provided by third parties, and whilst Earth Environmental & Geotechnical Ltd have no reason to doubt the accuracy and that it has been provided in full from those it was requested from, the items relied on have not been verified.

No responsibility can be accepted for errors within third party items presented in this report. Further Earth Environmental & Geotechnical Ltd was not authorised and did not attempt to independently verify the accuracy or completeness of information, documentation or materials received from the client or third parties, including laboratories and information services, during the performance of the services. Earth Environmental & Geotechnical Ltd is not liable for any inaccurate information, misrepresentation of data or conclusions, the discovery of which inaccuracies required the doing of any act including the gathering of any information which was not reasonably available to Earth Environmental & Geotechnical Ltd and including the doing of any independent investigation of the information provided to Earth Environmental & Geotechnical Ltd save as otherwise provided in the terms of the contract between the client and Earth Environmental & Geotechnical Ltd.

Where field investigations have been carried out these have been restricted to a level of detail required to achieve the stated objectives of the work. Ground conditions can also be variable and as investigation excavations only allow examination of the ground at discrete locations. The potential exists for ground conditions to be encountered which are different to those considered in this report. The extent of the limited area depends on the soil and groundwater conditions, together with the position of any current structures and underground facilities and natural and other activities on site. In addition, chemical analysis was carried out for a limited number of parameters [as stipulated in the contract between the client and Earth Environmental & Geotechnical Ltd] based on an understanding of the available operational and historical information, and it should not be inferred that other chemical species are not present.

The groundwater conditions entered on the exploratory hole records are those observed at the time of investigation. The normal speed of investigation usually does not permit the recording of an equilibrium water level for any one water strike. Moreover, groundwater levels are subject to seasonal variation or changes in local drainage conditions and higher groundwater levels may occur at other times of the year than were recorded during this investigation.

Any site drawing(s) provided in this report is (are) not meant to be an accurate base plan but is (are) used to present the general relative locations of features on, and surrounding, the site.