

HIGH SPEED RAIL (LONDON – WEST MIDLANDS) ACT 2017

HIGH SPEED RAIL (LONDON – WEST MIDLANDS) GENERAL VESTING DECLARATION No. 645

This **GENERAL VESTING DECLARATION** is executed on 9th November 2021 by the Secretary of State for Transport ("the Authority").

WHEREAS:

- (1) On 23 February 2017 the High Speed Rail (London – West Midlands) Act 2017 ("the High Speed Rail Act") received Royal Assent authorising the Authority to acquire the land specified in the Schedule hereto.
- (2) Section 4(1) of the High Speed Rail Act authorises the Authority to acquire compulsorily so much of the land within the limits of the High Speed Rail Act as may be required for Phase One purposes¹.
- (3) Section 4(4) of the High Speed Rail Act provides that the Compulsory Purchase (Vesting Declarations) Act 1981 ("the 1981 Act") applies as if the High Speed Rail Act were a compulsory purchase order and paragraph 3² of Schedule 6 to the High Speed Rail Act provides that the 1981 Act shall have effect subject to the modifications specified in that paragraph.
- (4) Notice pursuant to section 3A³ of the 1981 Act was first published on 18 October 2021. That notice included the particulars specified in section 3A(3) of the 1981 Act.

NOW THIS DEED WITNESSETH that, in exercise of the powers conferred on it by section 4 of the 1981 Act, the Authority hereby declares:-

1. The land described in the Schedule hereto (being part of the land authorised to be acquired by the High Speed Rail Act) and more particularly delineated and shown coloured pink on the plan annexed hereto, together with the right to enter upon and take possession of the land, shall vest in the Authority as from the end of the period of 4 months from the date on which the service of notices required by section 6⁴ of the 1981 Act is completed.

For the purposes of Section 2(2) of the 1981 Act, the specified period in relation to the land comprised in this declaration is one year and one day.

1 Phase One Purposes has meaning given by section 67 of the High Speed Rail Act

2 Paragraph 3 as substituted by section 11 of, and paragraph 6 of Schedule 14 to, the High Speed Rail Act.

3 Section 3A of the 1981 Act as inserted by paragraph 3(a) of Schedule 6 to the High Speed Rail Act as substituted by section 11 of, and paragraphs 6 and 7 of Schedule 14 to, that Act.

4 Section 6 as modified by paragraph 3(c) of Schedule 6 to the High Speed Rail Act, as substituted by section 11 of, and paragraph 6 of Schedule 14 to, that Act

SCHEDULE

West Northamptonshire

(1) Plot No.	(2) Description
66464	All interests in 754.9 square metres, or thereabouts, of public road, verges and footway (Northampton Road)
66469	All interests in 14.5 square metres, or thereabouts, of woodland and verge (2 Versions Bungalow)
66474	All interests in 22254.1 square metres, or thereabouts, of public road, roundabout, verges, woodland, drain, access tracks and access splays (A43)
66480	All interests in 17845.9 square metres, or thereabouts, of agricultural land, access track and hedgerow (Iletts Farm)
66481	All interests in 9018.6 square metres, or thereabouts, of agricultural land (Iletts Farm)
66482	All interests in 1655.5 square metres, or thereabouts, of agricultural land (Iletts Farm)
66484	All interests in 13229.8 square metres, or thereabouts, of agricultural land, public footpath (BD2), access track, drain and hedgerow (Manor Farm)
66485	All interests in 56922.6 square metres, or thereabouts, of public road, verges, access splays, woodland and public footpath (BD4) (A43)
66486	All interests in 5943.5 square metres, or thereabouts, of agricultural land (Iletts Farm)
66487	All interests in 1282.8 square metres, or thereabouts, of public road, verges and hedgerow (Radstone Road)
66491	All interests in 5.3 square metres, or thereabouts, of agricultural land (Radstone House Farm)
66522	All interests in 5936.9 square metres, or thereabouts, of agricultural land and hedgerow (Halse Grange Farm)
66523	All interests in 70519.6 square metres, or thereabouts, of agricultural land, public bridleway (AN37), public footpath (AN22), hedgerows and woodland (Halse Grange Farm)
66525	All interests in 4831.8 square metres, or thereabouts, of agricultural land and woodland (Halse Grange Farm)
66527	All interests in 60091.7 square metres, or thereabouts, of agricultural land, hedgerows, access track carrying public bridleway (AN37) and woodland (Halse Copse Farm)
70009	All interests in 48.1 square metres, or thereabouts, of access track (Iletts Farm)
70010	All interests in 6631.1 square metres, or thereabouts, of agricultural land and woodland (Iletts Farm)
70734	All interests in 3012.5 square metres, or thereabouts, of agricultural land, hedgerow, woodland and public bridleway (BD7) (Iletts Farm)

IN WITNESS WHEREOF the Secretary of State for Transport has hereunto set its corporate seal on the day in the year first written above.

The **CORPORATE SEAL** of the SECRETARY OF STATE FOR TRANSPORT hereunto affixed to this deed is authenticated by



Authorised Signatory

Dated : 9th November 2021



SEAL REF
DFT GP / 0802

SEAL REF
DTT GP

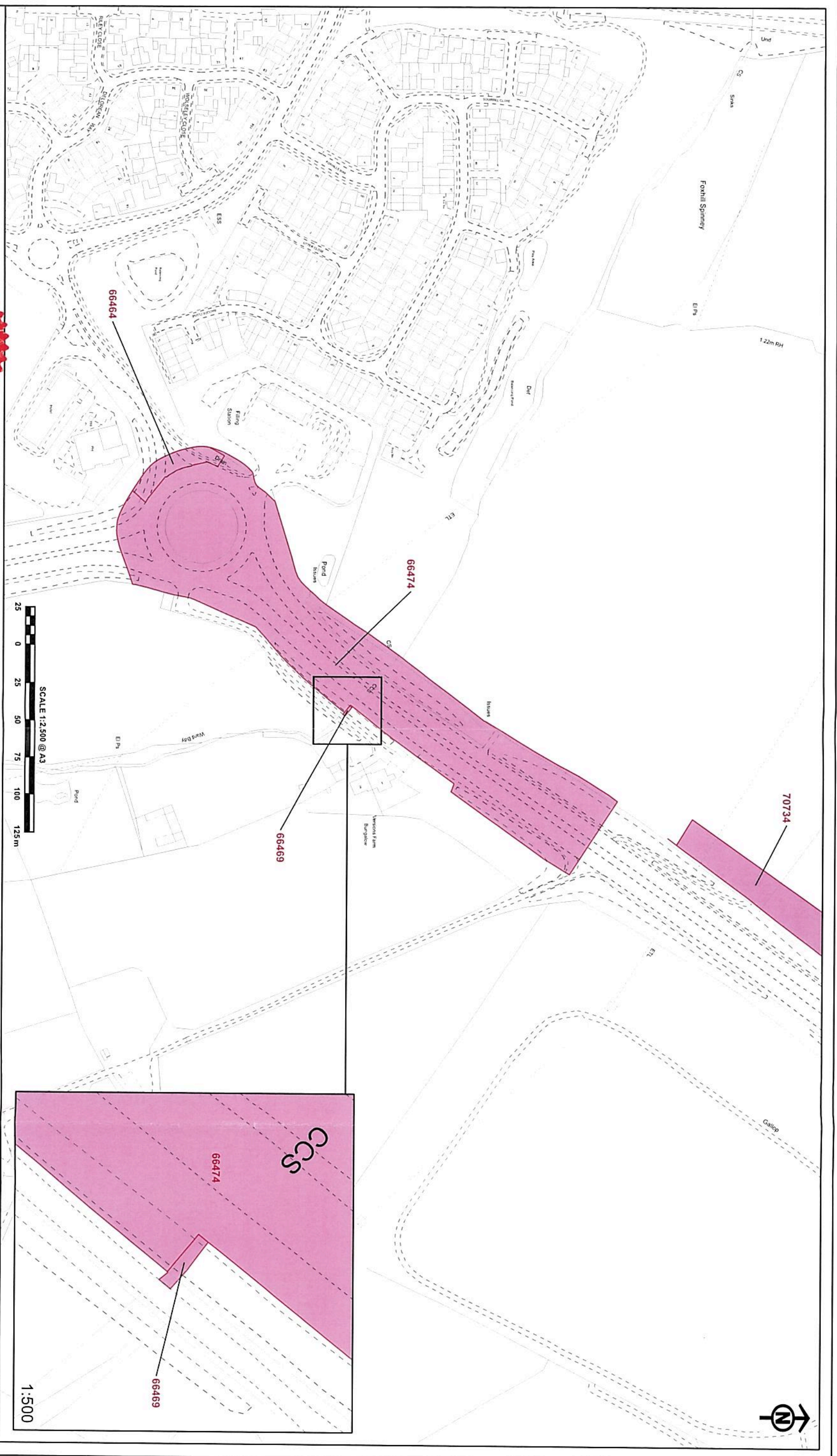

The CORPORATE SEAL of the
SECRETARY OF STATE
hereunto affixed to this deed
is authenticated by

Authorised by the Secretary of State for Transport
Dated 9th November 2021

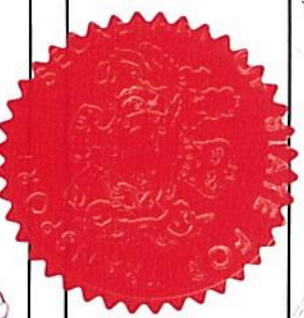

0802



SCALE 1:2,500 @ A3

1:500

© Crown copyright and database rights 2021 Ordnance Survey. Licence Number: 100049188
© Crown copyright and database rights 2021 Ordnance Survey. Licence Number: 100049188
This document is a reproduction of the original document and is not a substitute for the original document.

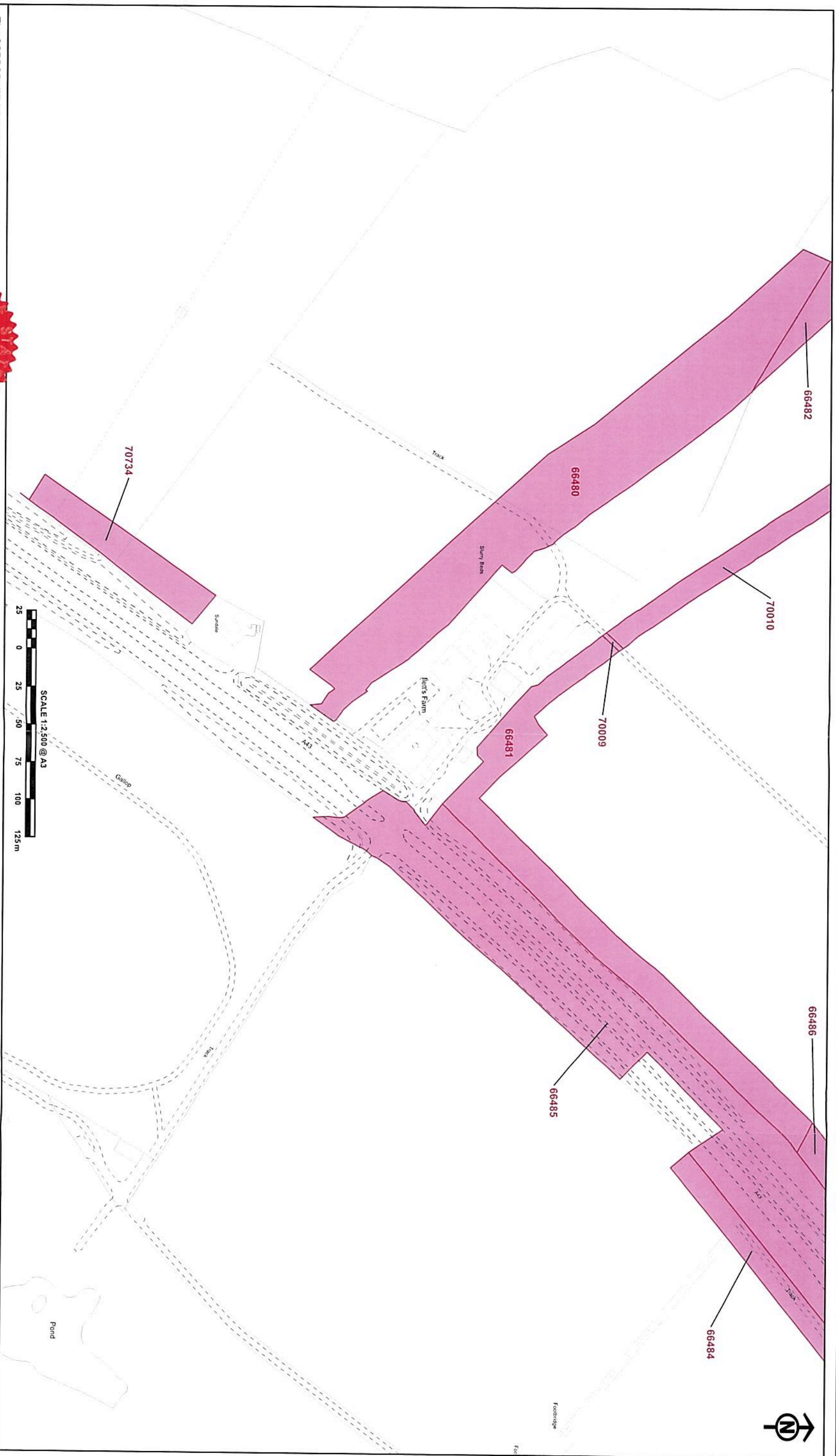

The CORPORATE SEAL of the
SECRETARY OF STATE
hereunto affixed to this deed,
is authenticated by

Authorised by the Secretary of State for Transport
Dated 9th November 2021

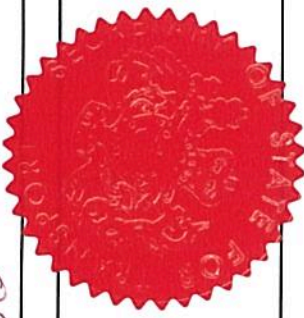

0802



The CORPORATE SEAL of the
SECRETARY OF STATE
hereunto affixed to this deed
is authentically

Authorised by the Secretary of State for Transport

Dated 9th November 2011



0802

© Crown copyright and database right 2011 Ordnance Survey (License Number 10004116)
reproduced with the permission of the Controller of Her Majesty's Stationery Office
under the Open Government Licence v1.0

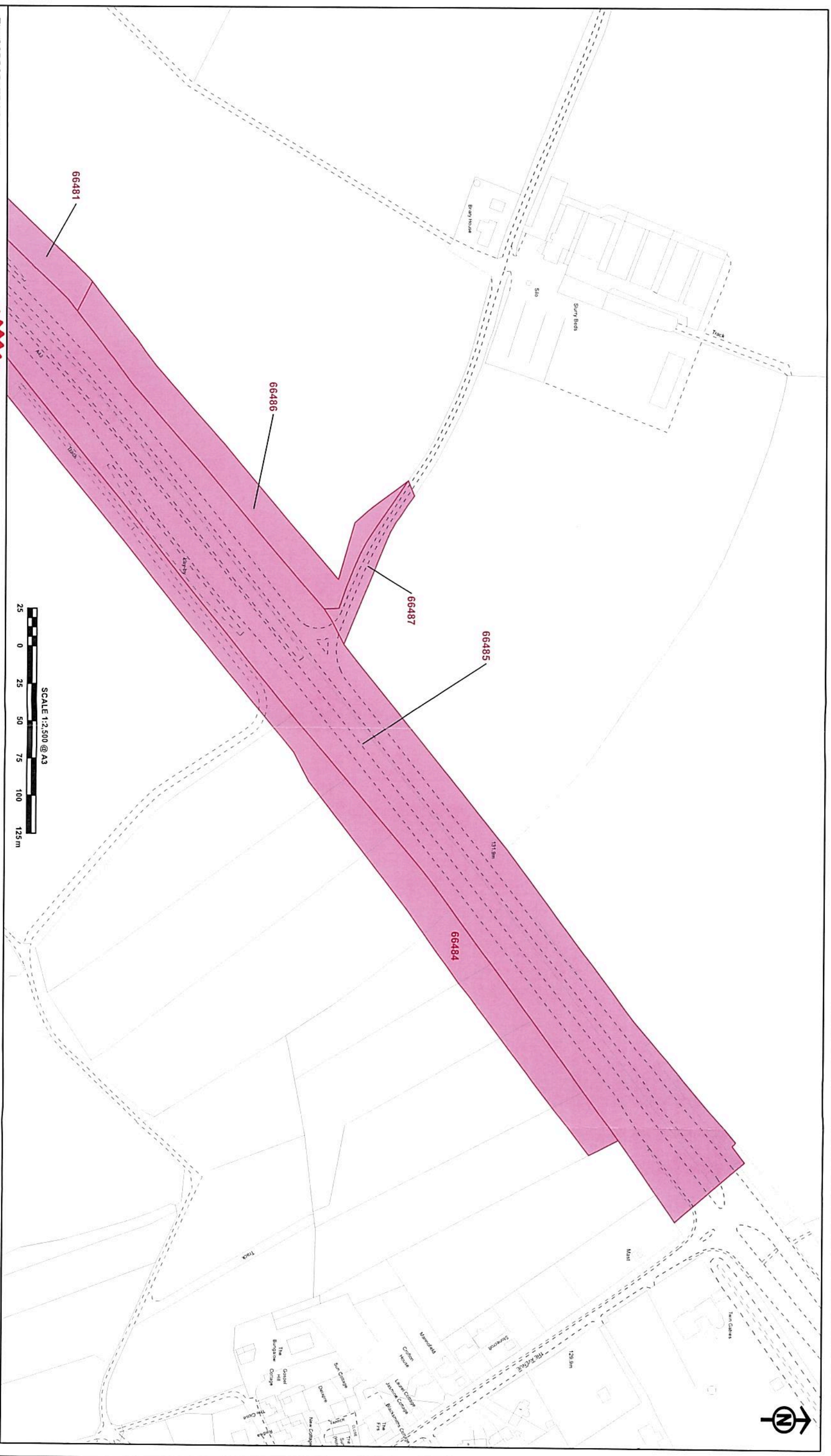

The CORPORATE SEAL of the
SECRETARY OF STATE
hereunto affixed for this deed
is authenticated by

Authorised by the Secretary of State for Transport

Dated 9th November 2021



0802

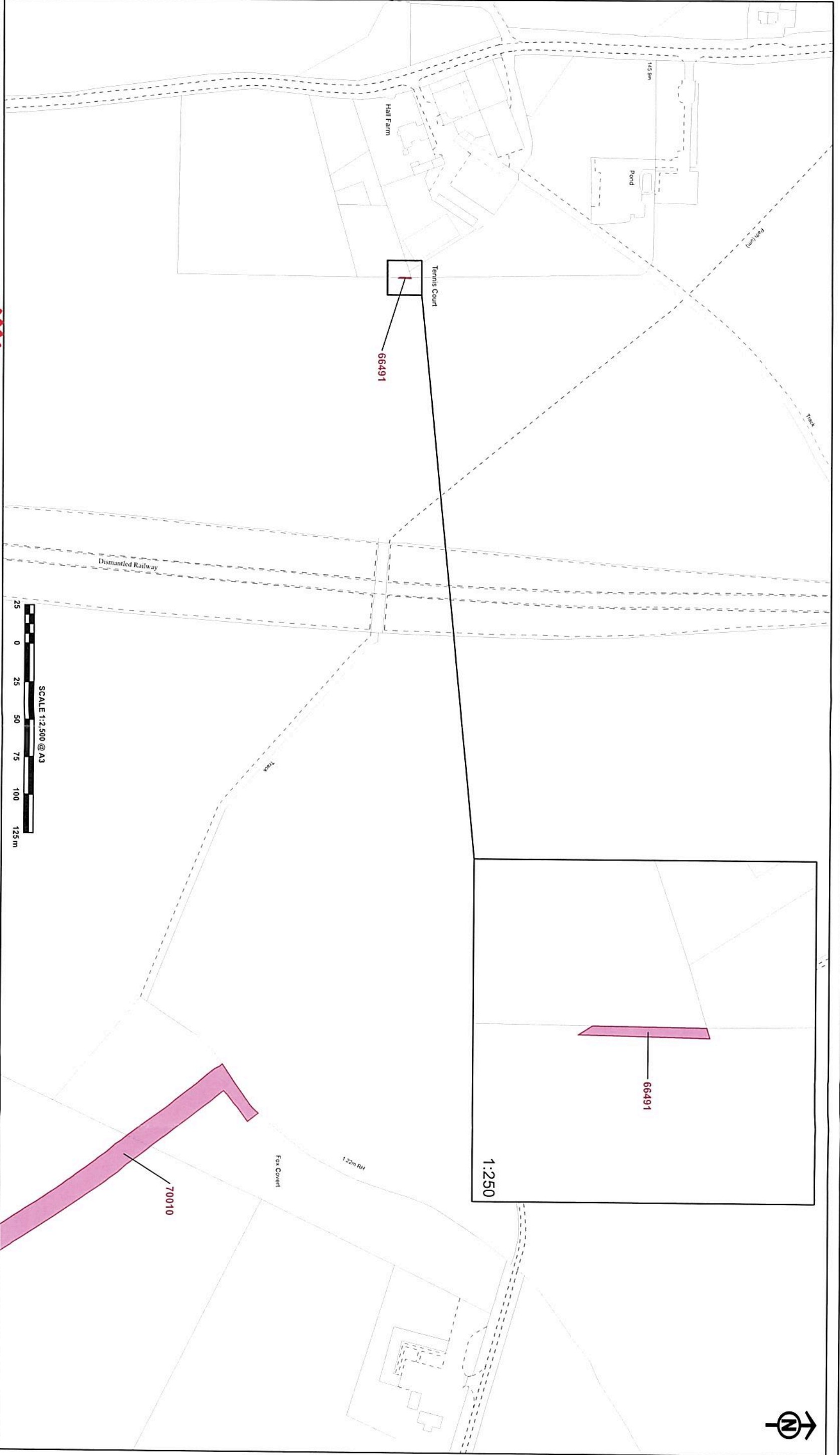

The CORPORATE SEAL of the
SECRETARY OF STATE
hereunto affixed
is authenticated by

Authorised by the Secretary of State for Transport
Dated 9th November 2021



0802



The CORPORATE SEAL of the
SECRETARY OF STATE
hereunto affixed to this deed
is authenticated by

.....
Authorised by the Secretary of State for Transport

Dated 9th November 2021

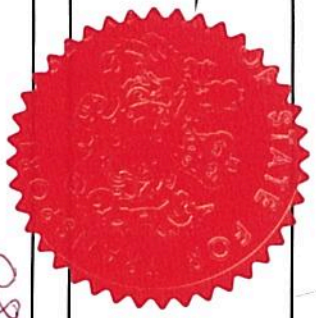

0802

© Crown copyright and database right 2021. Ordnance Survey Licence Number 100049196.
© Crown copyright material reproduced with the permission of Land Registry under
Licence Number SPS/100049196/2021 and the permission of the Ordnance Survey under
Licence Number SPS/100049196/2021.

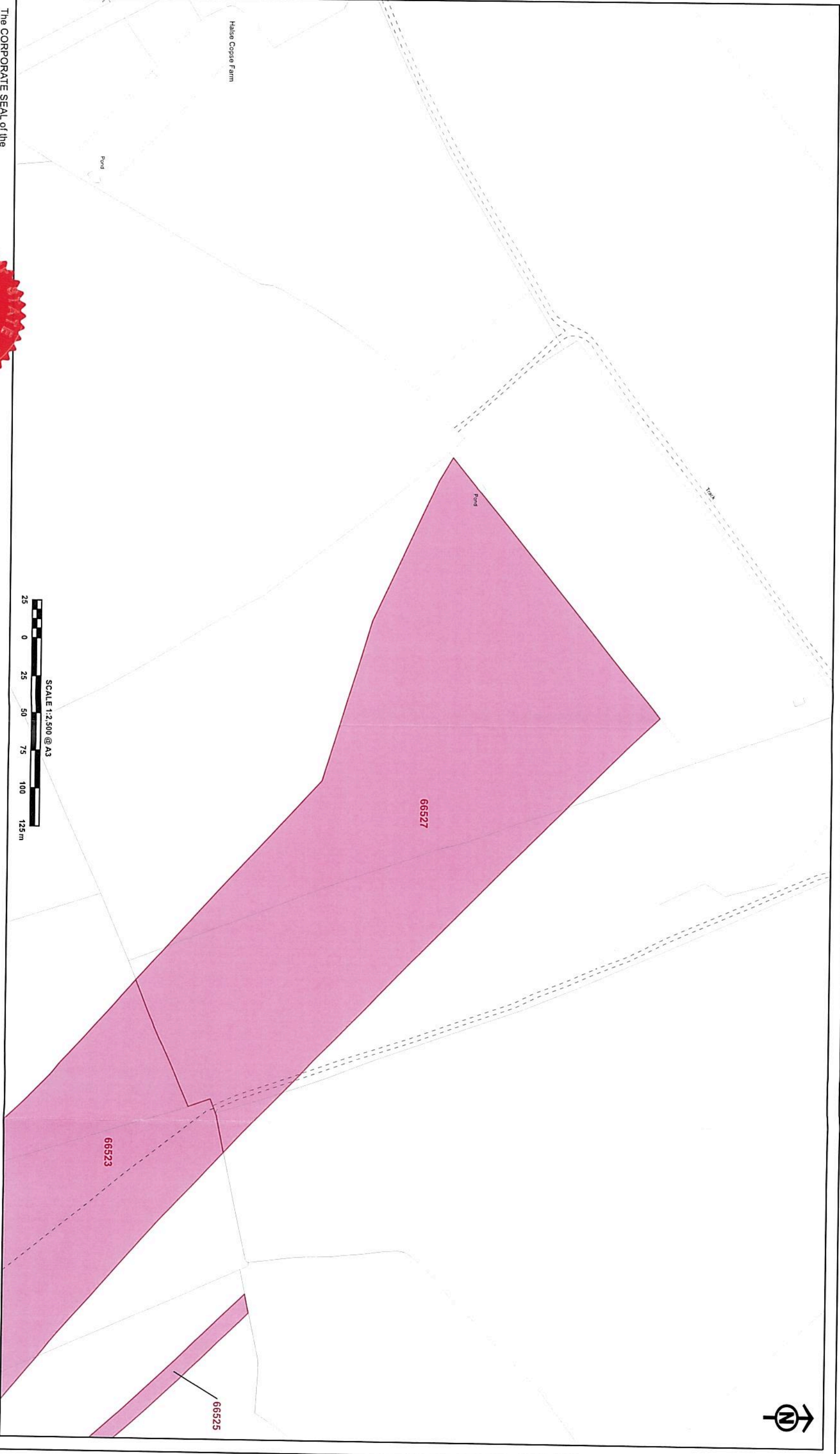

The CORPORATE SEAL of the
SECRETARY OF STATE
hereunto affixed to this deed
is authenticated by

Authorised by the Secretary of State for Transport

Dated 9th November 2021

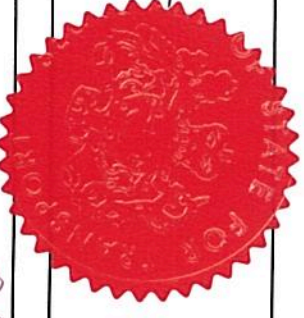

0802