

HIGH SPEED RAIL (LONDON – WEST MIDLANDS) ACT 2017

HIGH SPEED RAIL (LONDON – WEST MIDLANDS) GENERAL VESTING DECLARATION No. 857

This **GENERAL VESTING DECLARATION** is executed on
by the Secretary of State for Transport (“the Authority”).

18 JANUARY 2022

WHEREAS:

- (1) On 23 February 2017 the High Speed Rail (London – West Midlands) Act 2017 (“the High Speed Rail Act”) received Royal Assent authorising the Authority to acquire the land specified in the Schedule hereto.
- (2) Section 4(1) of the High Speed Rail Act authorises the Authority to acquire compulsorily so much of the land within the limits of the High Speed Rail Act as may be required for Phase One purposes¹.
- (3) Section 8 of the High Speed Rail Act provides that the power under section 4(1) in relation to land may be exercised in relation to the subsoil or under-surface of the land only.
- (4) Section 4(4) of the High Speed Rail Act provides that the Compulsory Purchase (Vesting Declarations) Act 1981 (“the 1981 Act”) applies as if the High Speed Rail Act were a compulsory purchase order and paragraph 3² of Schedule 6 to the High Speed Rail Act provides that the 1981 Act shall have effect subject to the modifications specified in that paragraph.
- (5) Notice pursuant to section 3A³ of the 1981 Act was first published on 05 January 2022. That notice included the particulars specified in section 3A(3) of the 1981 Act.

NOW THIS DEED WITNESSETH that, in exercise of the powers conferred on it by section 4 of the 1981 Act, the Authority hereby declares:-

1. The land described in the Schedule hereto (being part of the land authorised to be acquired by the High Speed Rail Act) and more particularly delineated and shown coloured yellow on the plan annexed hereto, together with the right to enter upon and take possession of the land, shall vest in the Authority as from the end of the period of 3 months from the date on which the service of notices required by section 6⁴ of the 1981 Act is completed.
2. For the purposes of Section 2(2) of the 1981 Act, the specified period in relation to the land comprised in this declaration is one year and one day.

1 Phase One Purposes has meaning given by section 67 of the High Speed Rail Act

2 Paragraph 3 as substituted by section 11 of, and paragraph 6 of Schedule 14 to, the High Speed Rail Act.

3 Section 3A of the 1981 Act as inserted by paragraph 3(a) of Schedule 6 to the High Speed Rail Act as substituted by section 11 of, and paragraphs 6 and 7 of Schedule 14 to, that Act.

4 Section 6 as modified by paragraph 3(c) of Schedule 6 to the High Speed Rail Act, as substituted by section 11 of, and paragraph 6 of Schedule 14 to, that Act

SCHEDULE

London Borough of Hillingdon

| (1) Plot No. | (2) Description |
|---------------------|--|
| 04450 | All that stratum of subsoil that lies beneath 2599.16 square metres, or thereabouts, of land and recreation ground (south of Rabournmead Drive), the upper extremity of which is 28.4 metres above Ordnance Survey Datum and the lower extremity of which is 5.9 metres above Ordnance Survey Datum. |

London Borough of Ealing

| (1) Plot No. | (2) Description |
|---------------------|---|
| 04451 | All that stratum of subsoil that lies beneath 1867.90 square metres, or thereabouts, of accessway and playground (south of Wilsmere Drive), the upper extremity of which is 27.5 metres above Ordnance Survey Datum and the lower extremity of which is 5.1 metres above Ordnance Survey Datum. |
| 04459 | All that stratum of subsoil that lies beneath 328.94 square metres, or thereabouts, of railway (Acton-Northolt Line) and bridge carrying public highway (Eastcote Lane) over, works and land, the upper extremity of which is 24.4 metres above Ordnance Survey Datum and the lower extremity of which is 2.7 metres above Ordnance Survey Datum, excluding any interest held by Network Rail Infrastructure Limited. |

IN WITNESS WHEREOF the Secretary of State for Transport has hereunto set its corporate seal on the day in the year first written above.

The **CORPORATE SEAL** of the SECRETARY OF STATE FOR TRANSPORT hereunto affixed to this deed is authenticated by



Authorised Signatory



Dated : 18 JANUARY 2022

SEAL REF
DFT GP / 1053

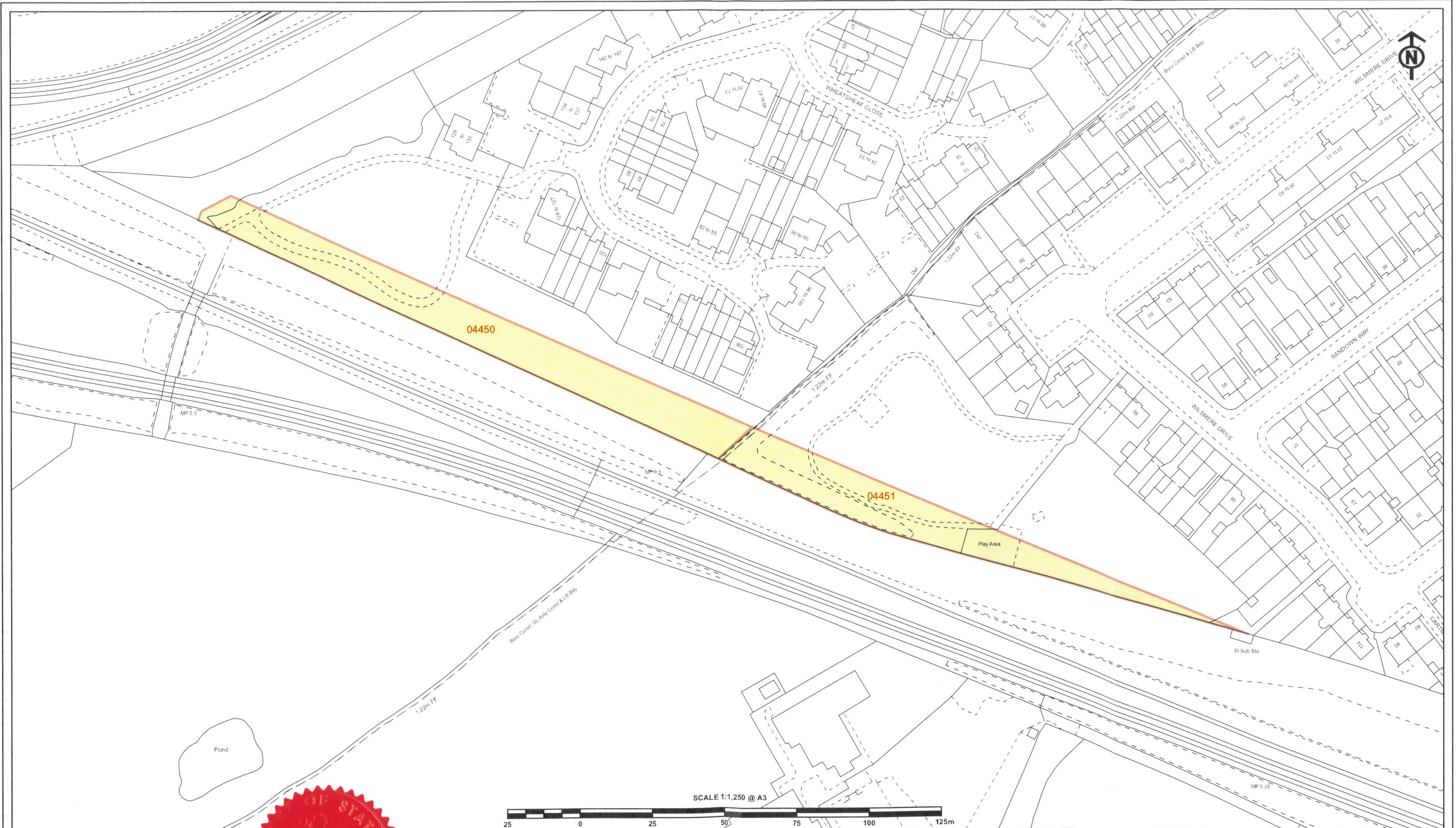

The CORPORATE SEAL of the
SECRETARY OF STATE
hereunto affixed to this deed
is authenticated by

Authorised by the Secretary of State for Transport

Dated: 18 JANUARY 2022

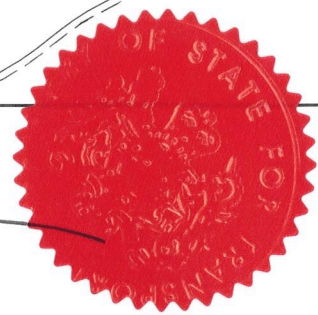

SEAL REF
DIT GP / 1053

CENTRE POINT: 512,211, 184,953

© Crown copyright and database rights 2021. Ordnance Survey Licence Number 100049190.
© Crown copyright material is reproduced with the permission of Land Registry under
delegated authority from the Controller of HMSO and © Crown Copyright Ordnance Survey.

HIGH SPEED RAIL (LONDON – WEST MIDLANDS) ACT 2017 GENERAL VESTING DECLARATION No. 857 SHEET 2 of 2

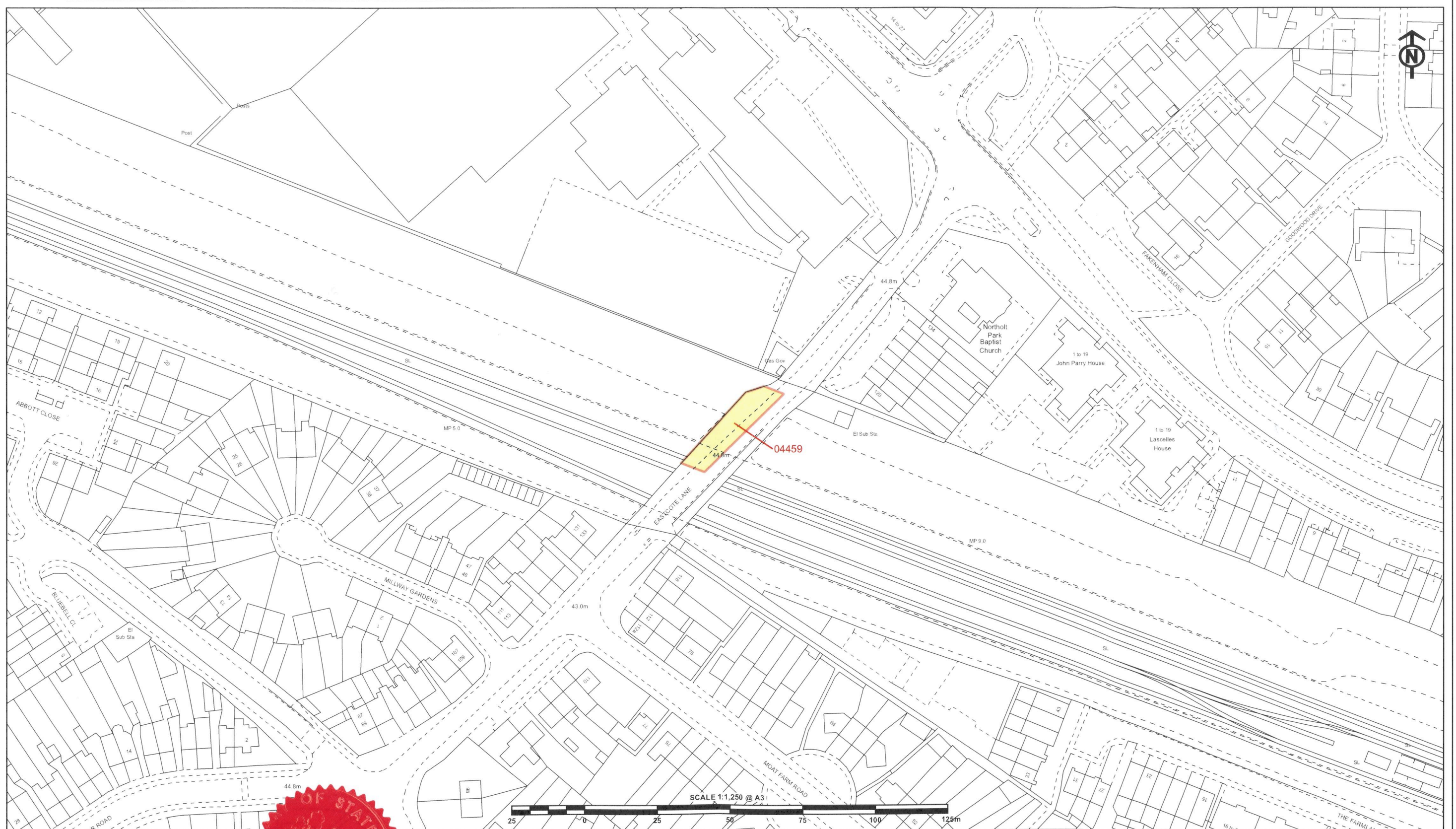

The CORPORATE SEAL of the
SECRETARY OF STATE
hereunto affixed to this deed
is authenticated by

Authorised by the Secretary of State for Transport

Dated: 18 JANUARY 2022



SEAL REF
DfT GP / 1053

CENTRE POINT: 512,858, 184,684