

## HIGH SPEED RAIL (LONDON – WEST MIDLANDS) ACT 2017

### HIGH SPEED RAIL (LONDON – WEST MIDLANDS) GENERAL VESTING DECLARATION No. 754

This **GENERAL VESTING DECLARATION** is executed on 25 JANUARY 2022  
by the Secretary of State for Transport (“the Authority”).

#### WHEREAS:

- (1) On 23 February 2017 the High Speed Rail (London – West Midlands) Act 2017 (“the High Speed Rail Act”) received Royal Assent authorising the Authority to acquire the land specified in the Schedule hereto.
- (2) Section 4(1) of the High Speed Rail Act authorises the Authority to acquire compulsorily so much of the land within the limits of the High Speed Rail Act as may be required for Phase One purposes<sup>1</sup>.
- (3) Section 8 of the High Speed Rail Act provides that the power under section 4(1) in relation to land may be exercised in relation to the subsoil or under-surface of the land only.
- (4) Section 4(4) of the High Speed Rail Act provides that the Compulsory Purchase (Vesting Declarations) Act 1981 (“the 1981 Act”) applies as if the High Speed Rail Act were a compulsory purchase order and paragraph 3<sup>2</sup> of Schedule 6 to the High Speed Rail Act provides that the 1981 Act shall have effect subject to the modifications specified in that paragraph.
- (5) Notice pursuant to section 3A<sup>3</sup> of the 1981 Act was first published on 21 October 2021. That notice included the particulars specified in section 3A(3) of the 1981 Act.

**NOW THIS DEED WITNESSETH** that, in exercise of the powers conferred on it by section 4 of the 1981 Act, the Authority hereby declares:-

1. The land described in the Schedule hereto (being part of the land authorised to be acquired by the High Speed Rail Act) and more particularly delineated and shown coloured yellow on the plan annexed hereto, together with the right to enter upon and take possession of the land, shall vest in the Authority as from the end of the period of 3 months from the date on which the service of notices required by section 6<sup>4</sup> of the 1981 Act is completed.
2. For the purposes of Section 2(2) of the 1981 Act, the specified period in relation to the land comprised in this declaration is one year and one day.

---

1 Phase One Purposes has meaning given by section 67 of the High Speed Rail Act

2 Paragraph 3 as substituted by section 11 of, and paragraph 6 of Schedule 14 to, the High Speed Rail Act.

3 Section 3A of the 1981 Act as inserted by paragraph 3(a) of Schedule 6 to the High Speed Rail Act as substituted by section 11 of, and paragraphs 6 and 7 of Schedule 14 to, that Act.

4 Section 6 as modified by paragraph 3(c) of Schedule 6 to the High Speed Rail Act, as substituted by section 11 of, and paragraph 6 of Schedule 14 to, that Act

## SCHEDULE

London Borough of Hillingdon

(1) Plot No.	(2) Description
06064	All that stratum of subsoil that lies beneath 2248.18 square metres, or thereabouts, of railway works (Chiltern Main Line) and land, the upper extremity of which is 28.4 metres above Ordnance Survey Datum and the lower extremity of which is 7.7 metres above Ordnance Survey Datum, excluding any interests held by the Secretary of State for Transport.
06081	All that stratum of subsoil that lies beneath 9633.30 square metres, or thereabouts, of railway works, land, woodland (Chiltern Main line) and river (Yeading Brook), bed and banks thereof, the upper extremity of which is 26.8 metres above Ordnance Survey Datum and the lower extremity of which is 8.4 metres above Ordnance Survey Datum, excluding any interests held by the Secretary of State for Transport.
06092	All that stratum of subsoil that lies beneath 84.70 square metres, or thereabouts, of land and access road to Clifford Industrial Estate (west of Long Drive), the upper extremity of which is 28.4 metres above Ordnance Survey Datum and the lower extremity of which is 8.7 metres above Ordnance Survey Datum, excluding any interests held by the Secretary of State for Transport.
06093	All that stratum of subsoil that lies beneath 200.40 square metres, or thereabouts, of land and premises (1 Long Drive), the upper extremity of which is 28.4 metres above Ordnance Survey Datum and the lower extremity of which is 8.8 metres above Ordnance Survey Datum, excluding any interests held by the Secretary of State for Transport.
06096	All that stratum of subsoil that lies beneath 19.65 square metres, or thereabouts, of public road and footways (Long Drive) and bridge carrying railway (Chiltern Main Line) over, works and land, the upper extremity of which is 28.2 metres above Ordnance Survey Datum and the lower extremity of which is 8.8 metres above Ordnance Survey Datum, excluding any interests held by the Secretary of State for Transport.
06097	All that stratum of subsoil that lies beneath 18.01 square metres, or thereabouts, of bridge carrying railway (Chiltern Main line), works and land over public road, footway and central reservation (West End Road), the upper extremity of which is 27.3 metres above Ordnance Survey Datum and the lower extremity of which is 9.7 metres above Ordnance Survey Datum, excluding any interests held by the Secretary of State for Transport.
06098	All that stratum of subsoil that lies beneath 635.17 square metres, or thereabouts, of public road, footway and central reservation (West End Road), the upper extremity of which is 27.2 metres above Ordnance Survey Datum and the lower extremity of which is 9.7 metres above Ordnance Survey Datum, excluding any interests held by the Secretary of State for Transport.
06100	All that stratum of subsoil that lies beneath 20.95 square metres, or thereabouts, of bridge carrying railway (Chiltern Main line), works and land over public road, footways and central reservation (Bridgewater Road), the upper extremity of which is 28.0 metres above Ordnance Survey Datum and the lower extremity of which is 8.4 metres above Ordnance Survey Datum, excluding any interests held by the Secretary of State for Transport.
06101	All that stratum of subsoil that lies beneath 194.11 square metres, or thereabouts, of public road, verge and footway (Bridgewater Road), the upper extremity of which is 28.0 metres above Ordnance Survey Datum and the lower extremity of which is 8.4 metres above Ordnance Survey Datum,

	excluding any interests held by the Secretary of State for Transport.
30275	All that stratum of subsoil that lies beneath 4453.60 square metres, or thereabouts, of land, workshop and premises (Clifford Industrial Estate) and railway works (Chiltern Main Line) and land, the upper extremity of which is 28.4 metres above Ordnance Survey Datum and the lower extremity of which is 7.7 metres above Ordnance Survey Datum, excluding any interests held by the Secretary of State for Transport.

**IN WITNESS WHEREOF** the Secretary of State for Transport has hereunto set its corporate seal on the day in the year first written above.

The **CORPORATE SEAL** of the SECRETARY OF STATE FOR TRANSPORT hereunto affixed to this deed is authenticated by



Authorised Signatory

Dated: 25 JANUARY 2022



SEAL REF  
DFT GP / 0936



## HIGH SPEED RAIL (LONDON – WEST MIDLANDS) ACT 2017 GENERAL VESTING DECLARATION No. 754 SHEET 1 of 3

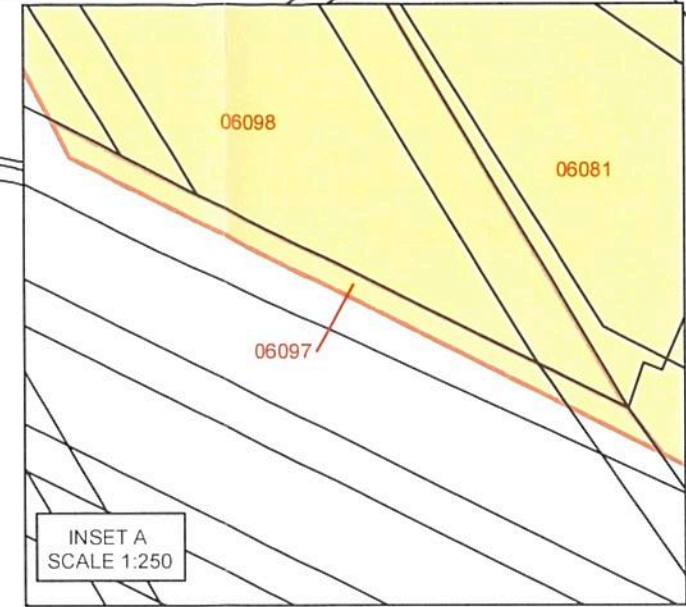

The CORPORATE SEAL of the  
SECRETARY OF STATE  
hereunto affixed to this deed  
is authenticated by

Authorised by the Secretary of State for Transport

Dated 25 JANUARY 2022



0936

CENTRE POINT: 510,336, 185,861







## HIGH SPEED RAIL (LONDON – WEST MIDLANDS) ACT 2017 GENERAL VESTING DECLARATION No. 754 SHEET 2 of 3

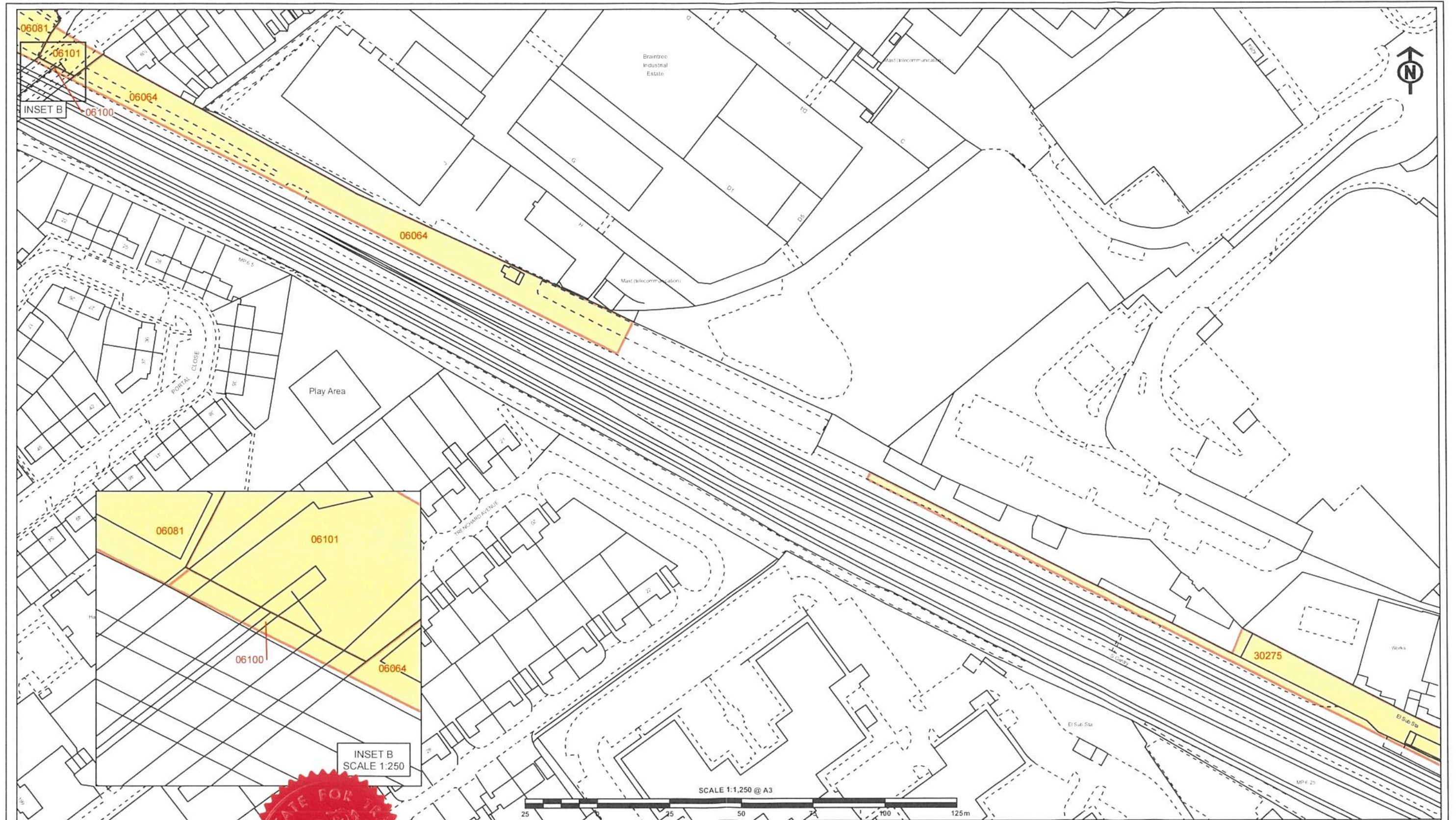

The CORPORATE SEAL of the  
SECRETARY OF STATE  
hereunto affixed to this deed  
is authenticated by

Authorised by the Secretary of State for Transport

Dated 25 JANUARY 2022



CENTRE POINT: 510,756, 185,627







## HIGH SPEED RAIL (LONDON – WEST MIDLANDS) ACT 2017 GENERAL VESTING DECLARATION No. 754 SHEET 3 of 3

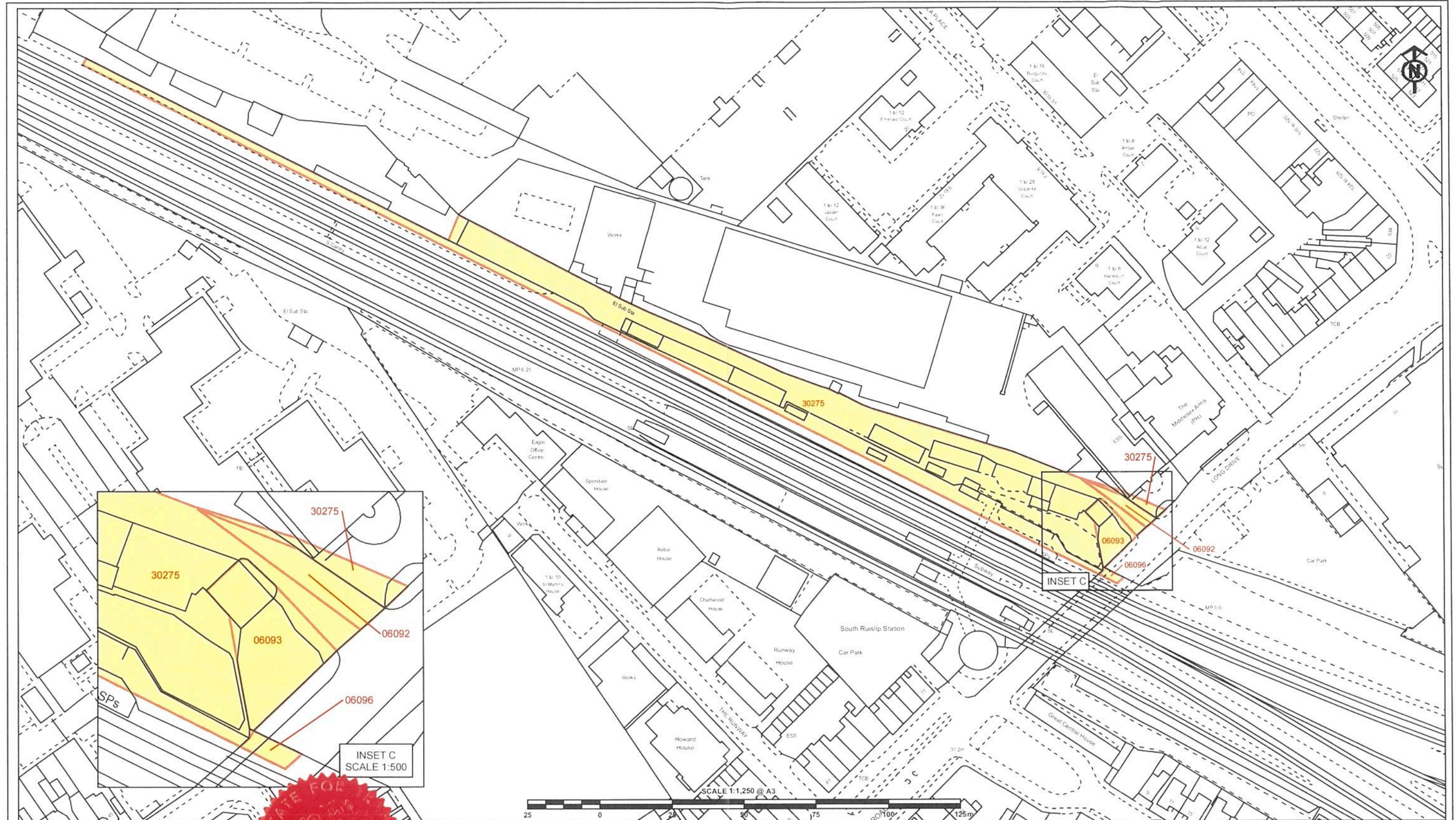

The CORPORATE SEAL of the  
SECRETARY OF STATE  
hereunto affixed to this deed  
is authenticated by

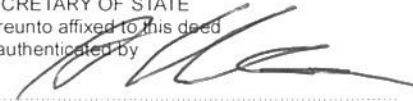

Authorised by the Secretary of State for Transport  
Dated 25 JANUARY 2022



CENTRE POINT: 511,028, 185,483