

## HIGH SPEED RAIL (LONDON – WEST MIDLANDS) ACT 2017

### HIGH SPEED RAIL (LONDON – WEST MIDLANDS) GENERAL VESTING DECLARATION No. 797

This **GENERAL VESTING DECLARATION** is executed on 13 DECEMBER 2021  
by the Secretary of State for Transport ("the Authority").

#### WHEREAS:

- (1) On 23 February 2017 the High Speed Rail (London – West Midlands) Act 2017 ("the High Speed Rail Act") received Royal Assent authorising the Authority to acquire the land specified in the Schedule hereto.
- (2) Section 4(1) of the High Speed Rail Act authorises the Authority to acquire compulsorily so much of the land within the limits of the High Speed Rail Act as may be required for Phase One purposes<sup>1</sup>.
- (3) Section 4(4) of the High Speed Rail Act provides that the Compulsory Purchase (Vesting Declarations) Act 1981 ("the 1981 Act") applies as if the High Speed Rail Act were a compulsory purchase order and paragraph 3<sup>2</sup> of Schedule 6 to the High Speed Rail Act provides that the 1981 Act shall have effect subject to the modifications specified in that paragraph.
- (4) Notice pursuant to section 3A<sup>3</sup> of the 1981 Act was first published on 25 November 2021. That notice included the particulars specified in section 3A(3) of the 1981 Act.

**NOW THIS DEED WITNESSETH** that, in exercise of the powers conferred on it by section 4 of the 1981 Act, the Authority hereby declares:-

1. The land described in the Schedule hereto (being part of the land authorised to be acquired by the High Speed Rail Act) and more particularly delineated and shown coloured pink on the plan annexed hereto, together with the right to enter upon and take possession of the land, shall vest in the Authority as from the end of the period of 4 months from the date on which the service of notices required by section 6<sup>4</sup> of the 1981 Act is completed.

For the purposes of Section 2(2) of the 1981 Act, the specified period in relation to the land comprised in this declaration is one year and one day.

---

1 Phase One Purposes has meaning given by section 67 of the High Speed Rail Act

2 Paragraph 3 as substituted by section 11 of, and paragraph 6 of Schedule 14 to, the High Speed Rail Act.

3 Section 3A of the 1981 Act as inserted by paragraph 3(a) of Schedule 6 to the High Speed Rail Act as substituted by section 11 of, and paragraphs 6 and 7 of Schedule 14 to, that Act.

4 Section 6 as modified by paragraph 3(c) of Schedule 6 to the High Speed Rail Act, as substituted by section 11 of, and paragraph 6 of Schedule 14 to, that Act

## SCHEDULE

### Buckinghamshire

(1) Plot No.	(2) Description
66233	All interests in 35322.9 square metres, or thereabouts, of agricultural land, woodland, hedgerows, pond, drain, access track, disused railway and public footpath (BHA/4/2) (Barton Hill Farm)
66234	All interests in 34425.5 square metres, or thereabouts, of agricultural land, woodland, drain and hedgerows (Chetwode)
66235	All interests in 12.9 square metres, or thereabouts, of woodland and drain (Newton Purcell)
66236	All interests in 17.3 square metres, or thereabouts, of woodland and drain (Newton Purcell)
66237	All interests in 34.0 square metres, or thereabouts, of woodland (Newton Purcell)
66238	All interests in 809.1 square metres, or thereabouts, of woodland (Newton Purcell)
66240	All interests in 16619.3 square metres, or thereabouts, of agricultural land, woodland, hedgerows and public footpath (BHA/2/2) (Barton Hartshorn)
70480	All interests in 3165.4 square metres, or thereabouts, of agricultural land and hedgerows (Barton Hill Farm)
70481	All interests in 1448.0 square metres, or thereabouts, of access track and public footpath (BHA/4/2) (Barton Hill Farm)

### District of Cherwell

(1) Plot No.	(2) Description
66241	All interests in 24232.1 square metres, or thereabouts, of agricultural land, hedgerows and public footpaths (308/2/10 and 308/3/20) (Newton Purcell)
66244	All interests in 271.5 square metres, or thereabouts, of agricultural land (Newton Purcell)
66245	All interests in 39.7 square metres, or thereabouts, of grassland (Newton Purcell)
66247	All interests in 6573.0 square metres, or thereabouts, of agricultural land and hedgerow (Moat Farm)
66248	All interests in 1.7 square metres, or thereabouts, of agricultural land (Moat Farm)
66249	All interests in 9743.9 square metres, or thereabouts, of agricultural land, woodland, drain and hedgerows (Barleyfields Farm)
66250	All interests in 8546.9 square metres, or thereabouts, of grassland, verges and public road (A4421) (Newton Purcell)
66251	All interests in 1364.9 square metres, or thereabouts, of agricultural land and woodland (Newton Purcell)
66252	All interests in 4699.5 square metres, or thereabouts, of agricultural land, hedgerows, drain and outbuilding (Newton Purcell)

66253	All interests in 27235.8 square metres, or thereabouts, of agricultural land and hedgerows (Newton Purcell)
66254	All interests in 982.6 square metres, or thereabouts, of agricultural land, drain and woodland (Newton Purcell)
66255	All interests in 36.3 square metres, or thereabouts, of verge and woodland (Newton Purcell)
66256	All interests in 47.0 square metres, or thereabouts, of woodland and verge (Buckingham Road)
66257	All interests in 225.3 square metres, or thereabouts, of woodland (Buckingham Road)
66259	All interests in 1572.8 square metres, or thereabouts, of woodland (Buckingham Road)
66261	All interests in 210.0 square metres, or thereabouts, of public road, verge and access splay (Buckingham Road)
66262	All interests in 31792.2 square metres, or thereabouts, of agricultural land, drain and hedgerows (Barley Fields Farm)
66263	All interests in 1177.8 square metres, or thereabouts, of garden (Barley Fields Cottage)
66264	All interests in 168.7 square metres, or thereabouts, of drain (Barleyfields Barn Farm)
66265	All interests in 4284.6 square metres, or thereabouts, of public road and verges (A4421)
66266	All interests in 335.4 square metres, or thereabouts, of agricultural land (Barley Fields Farm)
66267	All interests in 63.1 square metres, or thereabouts, of agricultural land (Barley Fields Farm)
66268	All interests in 19818.8 square metres, or thereabouts, of agricultural land, hedgerow and drain (Barley Field Farm)
66269	All interests in 698.3 square metres, or thereabouts, of agricultural land and hedgerow (Barley Fields Farm)
66270	All interests in 26053.3 square metres, or thereabouts, of agricultural land, hedgerow and drain (Barleyfields Barn Farm)
66273	All interests in 629.7 square metres, or thereabouts, of agricultural land and hedgerows (Barley Fields Farm)
66275	All interests in 1420.1 square metres, or thereabouts, of agricultural land (Boundary Farm)
66276	All interests in 6478.8 square metres, or thereabouts, of agricultural land (Shelswell Park)
66277	All interests in 7276.2 square metres, or thereabouts, of agricultural land (Shelswell Park)
66283	All interests in 1716.8 square metres, or thereabouts, of woodland and public bridleway (213/7/20) (Shelswell Park)
66284	All interests in 30.6 square metres, or thereabouts, of woodland and public bridleway (213/7/20) (Shelswell Park)
66285	All interests in 18.8 square metres, or thereabouts, of woodland and public bridleway (213/7/20) (Shelswell Park)
66286	All interests in 602.9 square metres, or thereabouts, of woodland and public bridleway (213/7/20) (Shelswell Park)
66287	All interests in 25876.8 square metres, or thereabouts, of woodland, access tracks, dismantled railway and public bridleways (213/7/20 and 213/4/10) (Shelswell Park)
66292	All interests in 2831.6 square metres, or thereabouts, of woodland (Banbury Road)
66293	All interests in 9191.6 square metres, or thereabouts, of public road, verges and woodland (A421) excluding the interests held by the Secretary of State

	for Transport
66297	All interests in 379.9 square metres, or thereabouts, of woodland (Shelswell Park)
71734	All interests in 19229.3 square metres, or thereabouts, of agricultural land, hedgerow and drain (Barley Fields Farm)

**IN WITNESS WHEREOF** the Secretary of State for Transport has hereunto set its corporate seal on the day in the year first written above.

The **CORPORATE SEAL** of the SECRETARY OF STATE FOR TRANSPORT hereunto affixed to this deed is authenticated by



.....

Authorised Signatory

Dated: 13 DECEMBER 2021



SEAL REF:  
DfT GP / 0958



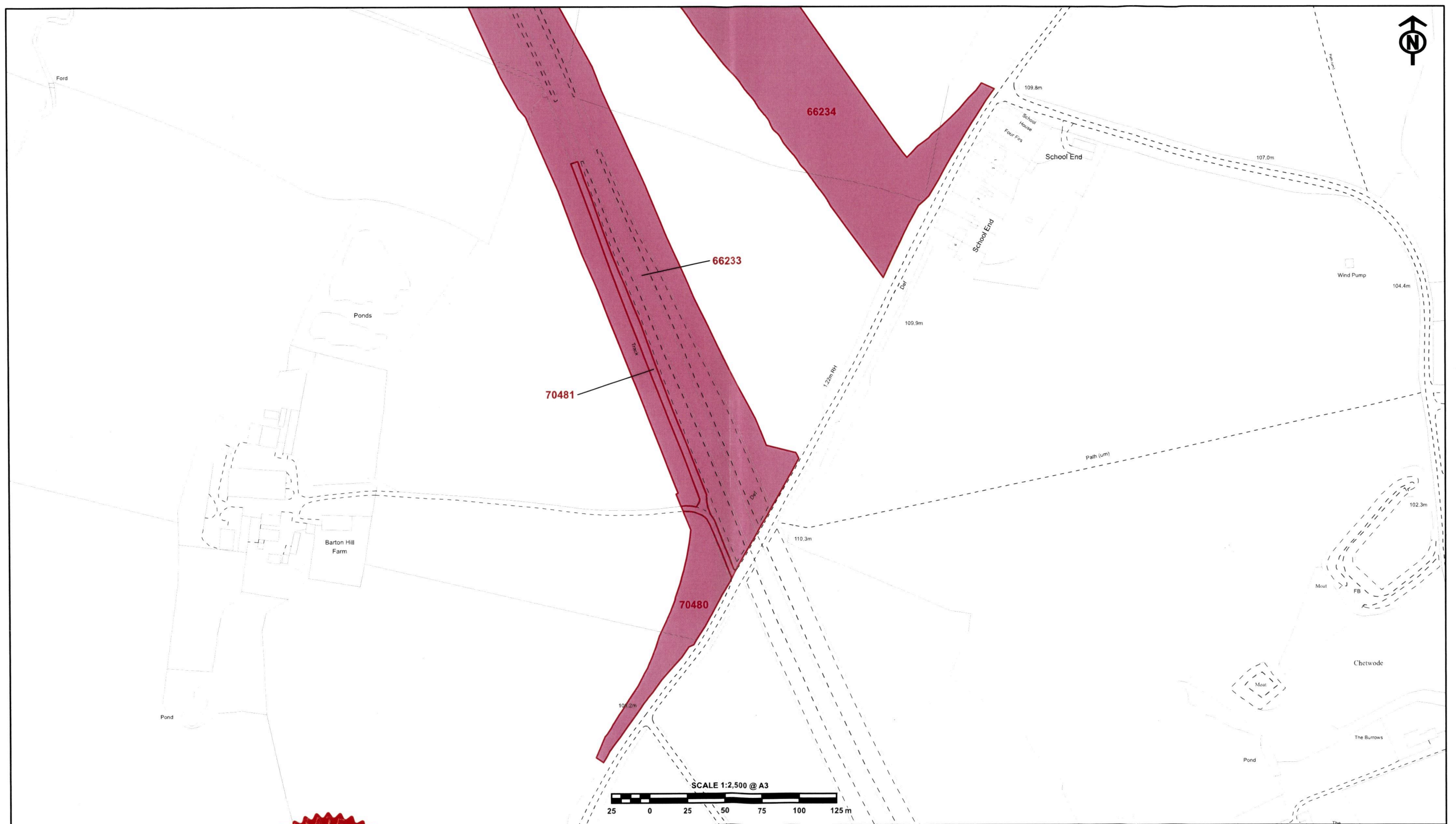

CENTRE POINT: 463,518, 229,843

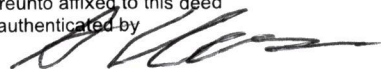
The CORPORATE SEAL of the  
SECRETARY OF STATE  
hereunto affixed to this deed  
is authenticated by  
  
Authorised by the Secretary of State for Transport  
Dated 13 DECEMBER 2021



0958







The CORPORATE SEAL of the  
SECRETARY OF STATE  
hereunto affixed to this deed  
is authenticated by  
  
.....  
Authorised by the Secretary of State for Transport  
Dated 13 DECEMBER 2011



0958

CENTRE POINT: 463,304, 230,289



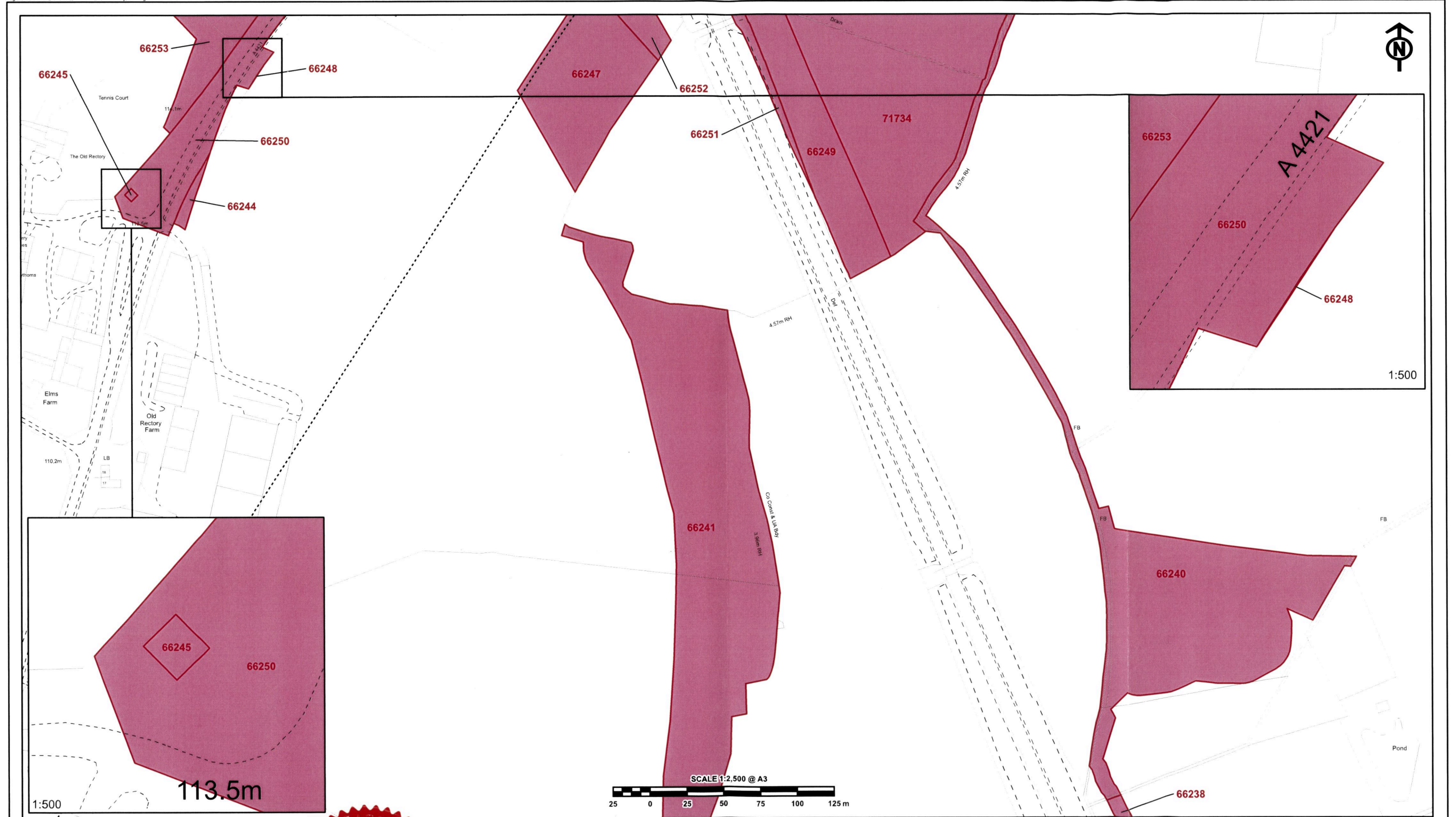

The CORPORATE SEAL of the  
SECRETARY OF STATE  
hereunto affixed to this deed  
is authenticated by  
*[Signature]*  
Authorised by the Secretary of State for Transport  
Dated 13 DECEMBER 2021



0958

CENTRE POINT: 463,007, 230,759



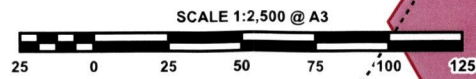
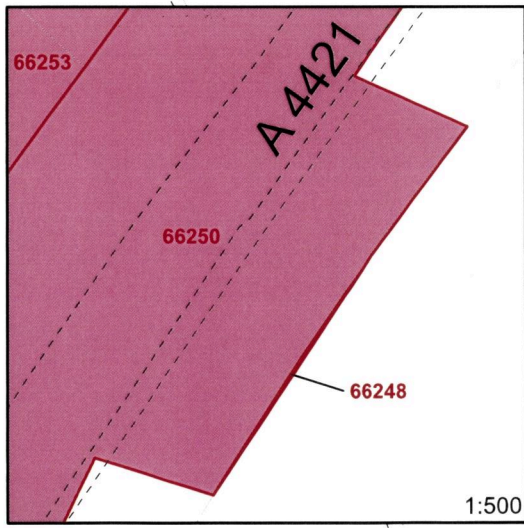
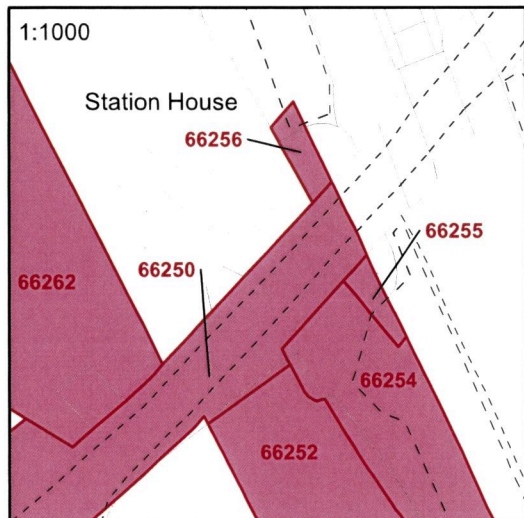

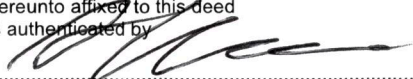
The CORPORATE SEAL of the  
SECRETARY OF STATE  
hereunto affixed to this deed  
is authenticated by  
  
Authorised by the Secretary of State for Transport  
Dated 13 DECEMBER 2021





CENTRE POINT: 462,893, 231,213

© Crown copyright and database rights 2021. Ordnance Survey Licence Number 100049199.  
© Crown copyright material is reproduced with the permission of Land Registry under  
delegated authority from the Controller of HMSO and © Crown Copyright Ordnance Survey.

0958

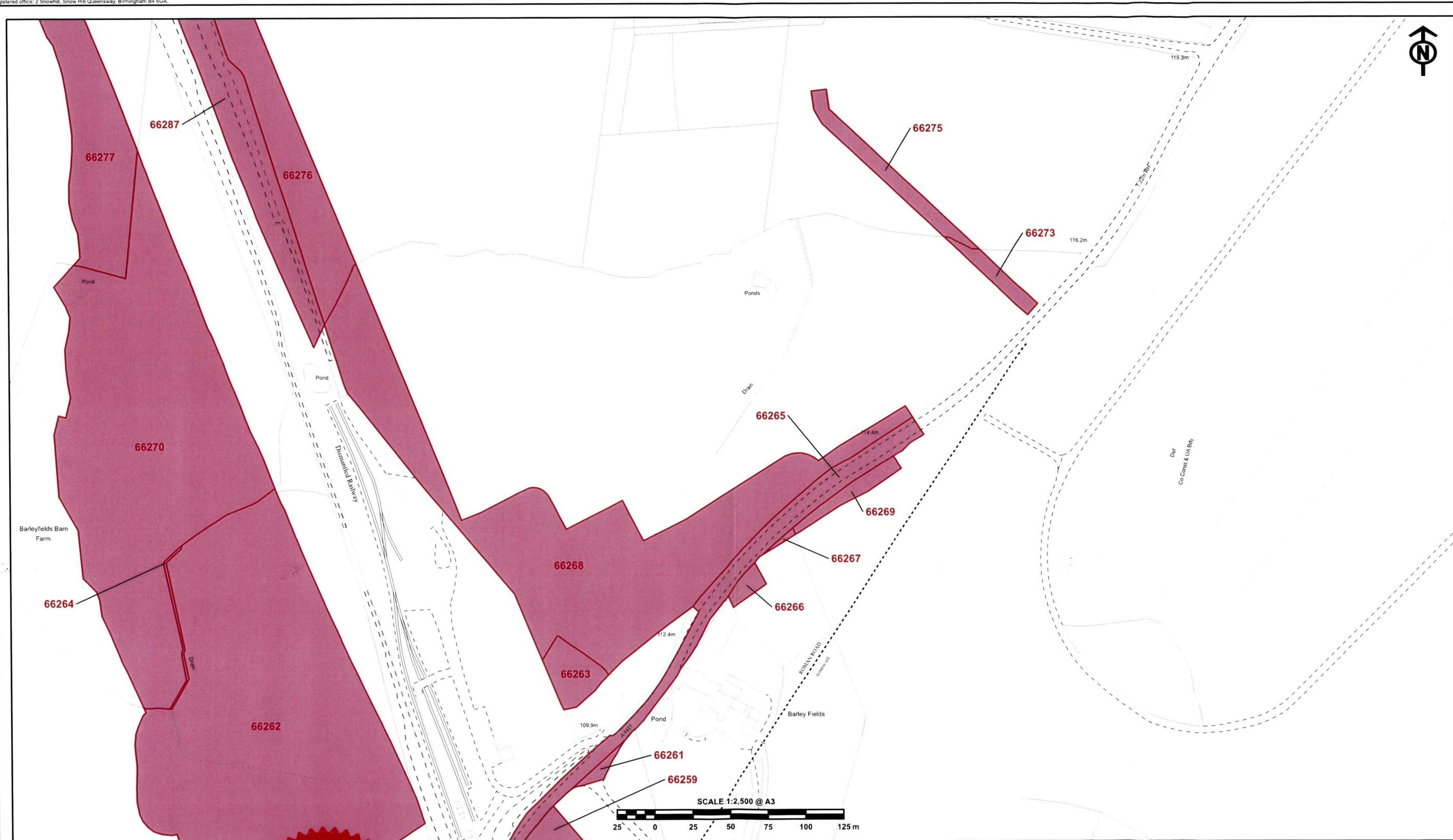



The CORPORATE SEAL of the  
SECRETARY OF STATE  
hereunto affixed to this deed  
is authenticated by  
  
Authorised by the Secretary of State for Transport

Dated 13 DECEMBER 2021

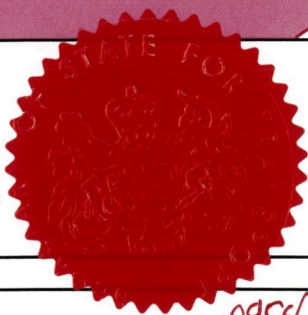

0958

CENTRE POINT: 463,080, 231,534





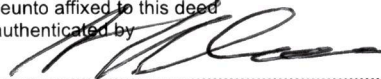

The CORPORATE SEAL of the  
SECRETARY OF STATE  
hereunto affixed to this deed  
is authenticated by  
  
Authorised by the Secretary of State for Transport  
Dated 13 DECEMBER 2020



CENTRE POINT: 462,556, 231,849



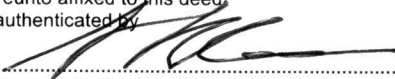

The CORPORATE SEAL of the  
SECRETARY OF STATE  
hereunto affixed to this deed  
is authenticated by  
  
Authorised by the Secretary of State for Transport  
Dated 13 DECEMBER 2021

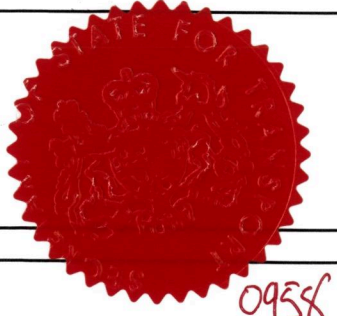

0958

CENTRE POINT: 462,446, 232,227



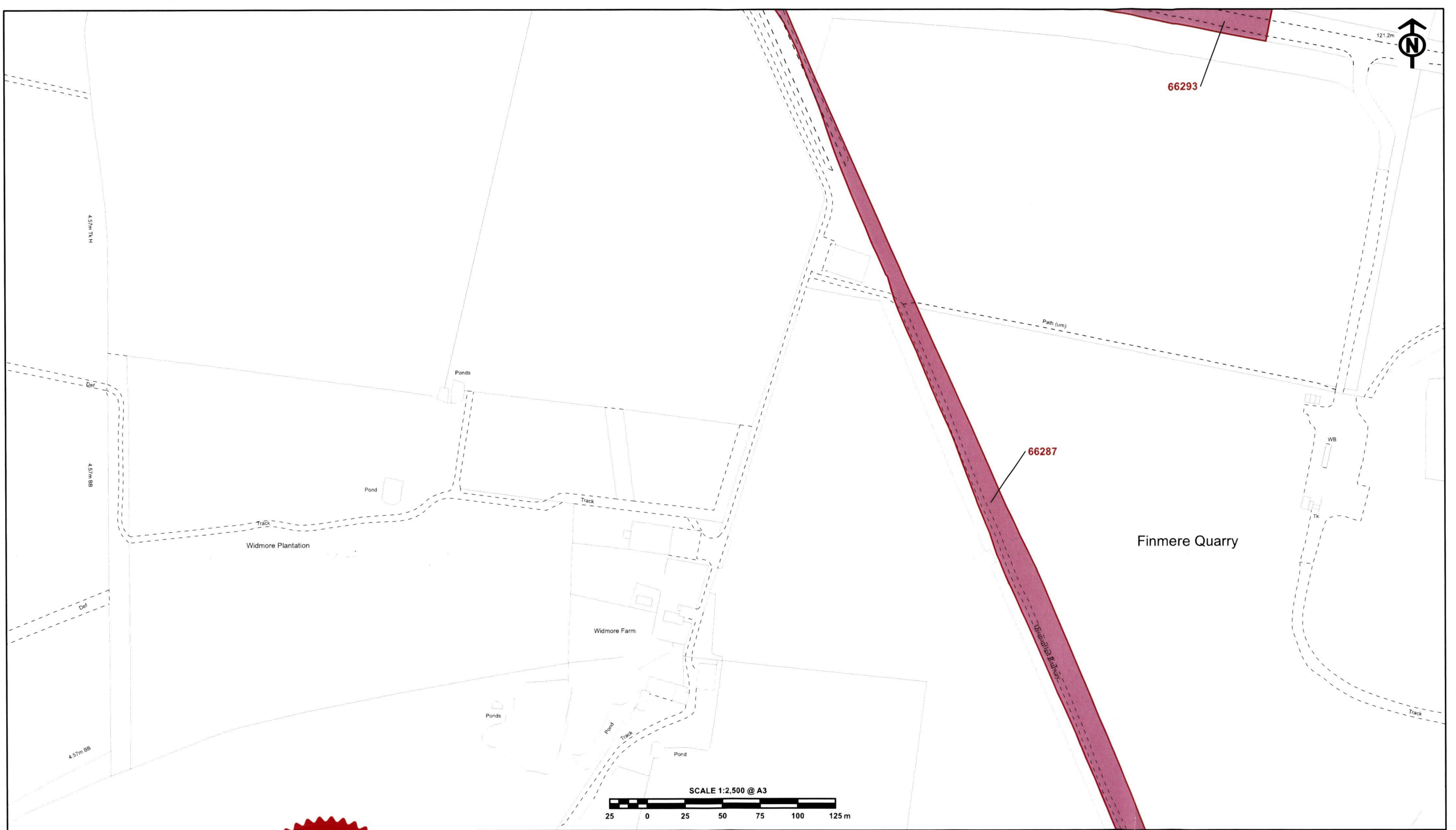

The CORPORATE SEAL of the  
SECRETARY OF STATE  
hereunto affixed to this deed  
is authenticated by

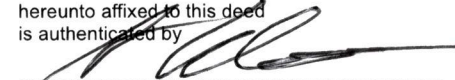
  
Authorised by the Secretary of State for Transport

Dated 13 DECEMBER 2021



0958

CENTRE POINT: 462,217, 232,650



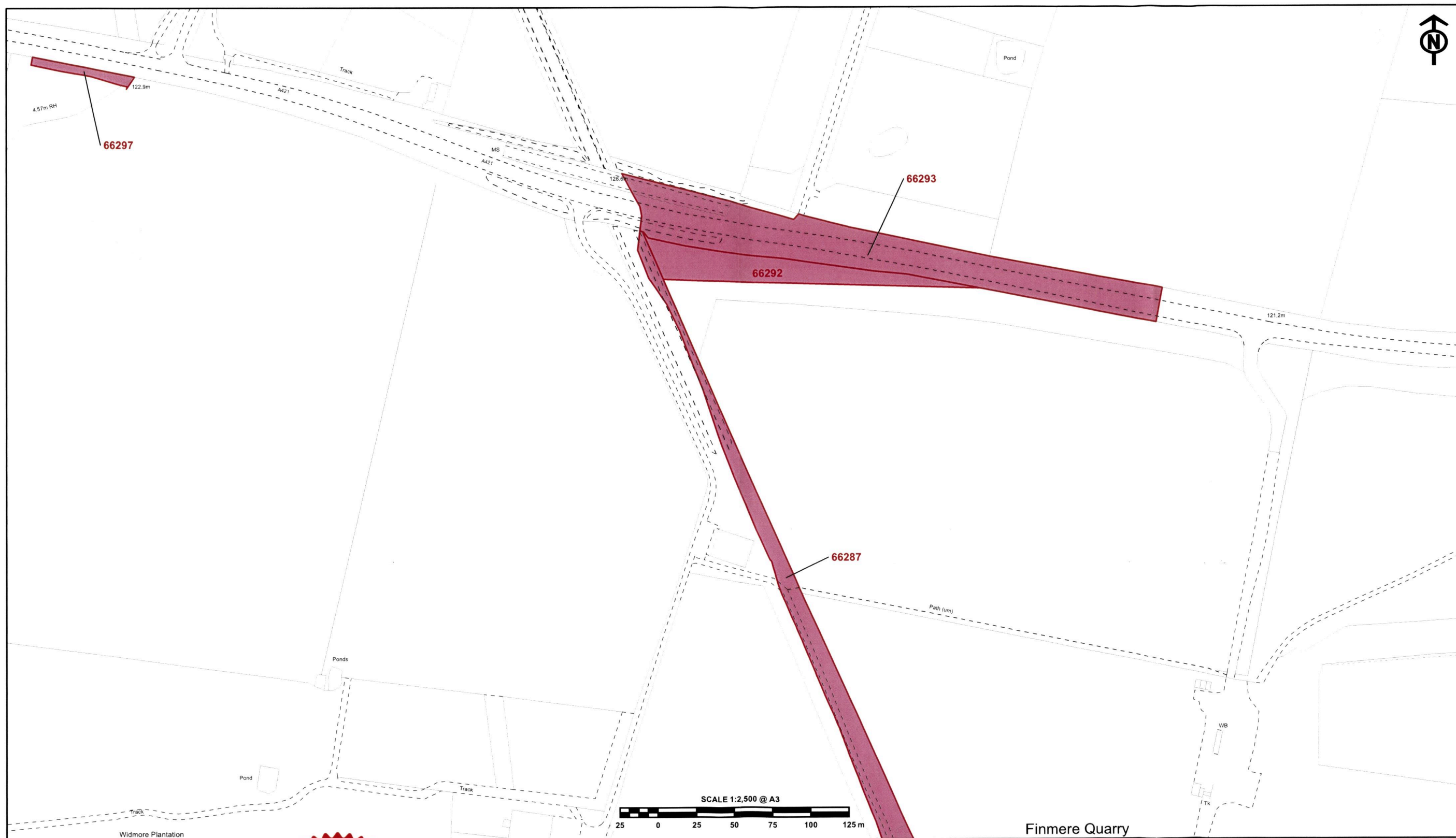

The CORPORATE SEAL of the  
SECRETARY OF STATE  
hereunto affixed to this deed  
is authenticated by  
  
Authorised by the Secretary of State for Transport  
Dated 13 DECEMBER 2021



0958

CENTRE POINT: 462,303, 232,835

