

HIGH SPEED RAIL (LONDON – WEST MIDLANDS) ACT 2017

HIGH SPEED RAIL (LONDON – WEST MIDLANDS) GENERAL VESTING DECLARATION No. 918

This **GENERAL VESTING DECLARATION** is executed on 8th February 2022
by the Secretary of State for Transport ("the Authority").

WHEREAS:

- (1) On 23 February 2017 the High Speed Rail (London – West Midlands) Act 2017 ("the High Speed Rail Act") received Royal Assent authorising the Authority to acquire the land specified in the Schedule hereto.
- (2) Section 4(1) of the High Speed Rail Act authorises the Authority to acquire compulsorily so much of the land within the limits of the High Speed Rail Act as may be required for Phase One purposes¹.
- (3) Section 4(4) of the High Speed Rail Act provides that the Compulsory Purchase (Vesting Declarations) Act 1981 ("the 1981 Act") applies as if the High Speed Rail Act were a compulsory purchase order and paragraph 3² of Schedule 6 to the High Speed Rail Act provides that the 1981 Act shall have effect subject to the modifications specified in that paragraph.
- (4) Notice pursuant to section 3A³ of the 1981 Act was first published on 07 January 2022. That notice included the particulars specified in section 3A(3) of the 1981 Act.

NOW THIS DEED WITNESSETH that, in exercise of the powers conferred on it by section 4 of the 1981 Act, the Authority hereby declares:-

1. The land described in the Schedule hereto (being part of the land authorised to be acquired by the High Speed Rail Act) and more particularly delineated and shown coloured pink on the plan annexed hereto, together with the right to enter upon and take possession of the land, shall vest in the Authority as from the end of the period of 3 months from the date on which the service of notices required by section 6⁴ of the 1981 Act is completed.

For the purposes of Section 2(2) of the 1981 Act, the specified period in relation to the land comprised in this declaration is one year and one day.

1 Phase One Purposes has meaning given by section 67 of the High Speed Rail Act

2 Paragraph 3 as substituted by section 11 of, and paragraph 6 of Schedule 14 to, the High Speed Rail Act.

3 Section 3A of the 1981 Act as inserted by paragraph 3(a) of Schedule 6 to the High Speed Rail Act as substituted by section 11 of, and paragraphs 6 and 7 of Schedule 14 to, that Act.

4 Section 6 as modified by paragraph 3(c) of Schedule 6 to the High Speed Rail Act, as substituted by section 11 of, and paragraph 6 of Schedule 14 to, that Act

SCHEDULE

Buckinghamshire

(1) Plot No.	(2) Description
65300	All interests in 89736.0 square metres, or thereabouts, of agricultural land, grassland, hedgerow, ponds, drains and public footpaths (SMA/5/1, SMA/5A/1 and SMA/5/2) (Risborough Road)
65301	All interests in 7726.5 square metres, or thereabouts, of public road, access splay and verge (Risborough Road North Lee)
65302	All interests in 10945.6 square metres, or thereabouts, of agricultural land (Risborough Road)
65312	All interests in 5691.9 square metres, or thereabouts, of agricultural land (Risborough Road)
65313	All interests in 68129.3 square metres, or thereabouts, of agricultural land and public footpaths (ELL/1/1, ELL/2/1 and ELL/8/1) (Marsh Lane)
65317	All interests in 2121.7 square metres, or thereabouts, of public road, verges and woodland (Risborough Road)
65318	All interests in 10209.7 square metres, or thereabouts, of access track, access splay and verges (Risborough Road)
65321	All interests in 1880.6 square metres, or thereabouts, of agricultural land and woodland (Marsh Lane)
65322	All interests in 4281.1 square metres, or thereabouts, of agricultural land, pylon and overhead electricity cables and public footpath (GLK/31/1) (Marsh Lane)
65323	All interests in 312.6 square metres, or thereabouts, of agricultural land (Risborough Road)
65325	All interests in 175.4 square metres, or thereabouts, of public road and verges (Old Risborough Road)
65326	All interests in 927.2 square metres, or thereabouts, of public road, verges, footway and woodland (Risborough Road)
65330	All interests in 1188.8 square metres, or thereabouts, of agricultural land and woodland (Old Risborough Road)
65333	All interests in 555.7 square metres, or thereabouts, of public road and verge (Old Risborough Road)
65339	All interests in 130.0 square metres, or thereabouts, of outbuilding, agricultural land and access track (Old Risborough Road)
65344	All interests in 5610.4 square metres, or thereabouts, of agricultural land and woodland (Marsh Lane)
65345	All interests in 2608.2 square metres, or thereabouts, of agricultural land (Marsh Lane)
65347	All interests in 7497.0 square metres, or thereabouts, of agricultural land and public footpath (SMA/9/1) (Marsh Lane)
65352	All interests in 28370.0 square metres, or thereabouts, of agricultural land, hedgerow and public footpaths (ELL/1/1 and SMA/9/1) (Marsh Lane)
65354	All interests in 359.8 square metres, or thereabouts, of woodland and public footpath (SMA/15A/2) (Brook Farm)
65355	All interests in 9841.4 square metres, or thereabouts, of agricultural land and public footpaths (GLK/31/1 and SBH/29/1) (Standalls Farm)
65356	All interests in 11416.1 square metres, or thereabouts, of agricultural land and public footpath (SMA/9/1) (Standalls Farm)

65357	All interests in 2668.9 square metres, or thereabouts, of public road, verges and woodland (Marsh Lane)
65358	All interests in 7441.3 square metres, or thereabouts, of agricultural land and public footpaths (SMA/9/1 and SMA/15A/2) (Marsh Lane)
65359	All interests in 11453.8 square metres, or thereabouts, of agricultural land (Marsh Lane)
65361	All interests in 1913.6 square metres, or thereabouts, of public road, verges and woodland (Marsh Lane)
65362	All interests in 88.7 square metres, or thereabouts, of river, bed and banks thereof (Stoke Brook) and bridge carrying public footpath (SMA/9/1) (Marsh Lane)
65365	All interests in 2535.7 square metres, or thereabouts, of agricultural land and public footpaths (SMA/9/2, SMA/10/1, SMA/15/1 and SMA/15A/1) (Marsh Lane)
65366	All interests in 90062.0 square metres, or thereabouts, of agricultural land, hedgerows, access track and public footpath (SMA/11/2) (Moat Farm)
65368	All interests in 154.4 square metres, or thereabouts, of public road and verge (Marsh Lane)
65370	All interests in 65979.8 square metres, or thereabouts, of agricultural land, hedgerow and public footpath (SMA/11/2) (Marsh Lane)
65372	All interests in 35737.7 square metres, or thereabouts, of railway, works and land (Little Kimble and Aylesbury Line) and river, bed and banks thereof (Stoke Brook) (Marsh Lane)
65378	All interests in 12479.8 square metres, or thereabouts, of agricultural land and public footpath (SMA/16/2) (Stoke Farm)
69342	All interests in 1330.9 square metres, or thereabouts, of railway, works and land (Princes Risborough and Aylesbury Line) (Marsh Lane)
71201	All interests in 220.3 square metres, or thereabouts, of river, bed and bank thereof (Stoke Brook)
71353	All interests in 20889.8 square metres, or thereabouts, of agricultural land, public footpaths (SMA/18/1 and SMA/16/3) and river, bed and banks thereof (Stoke Brook) (Lower Road)
71354	All interests in 1681.0 square metres, or thereabouts, of agricultural land and public footpath (SMA/16/3) (Lower Road)
71796	All interests in 1079.3 square metres, or thereabouts, of agricultural land and woodland (Marsh Lane)

IN WITNESS WHEREOF the Secretary of State for Transport has hereunto set its corporate seal on the day in the year first written above.

The **CORPORATE SEAL** of the SECRETARY OF STATE FOR TRANSPORT hereunto affixed to this deed is authenticated by

Nsu WNA
.....

Authorised Signatory

Dated : 8th February 2022



SEAL REF
DfT GP / 1159

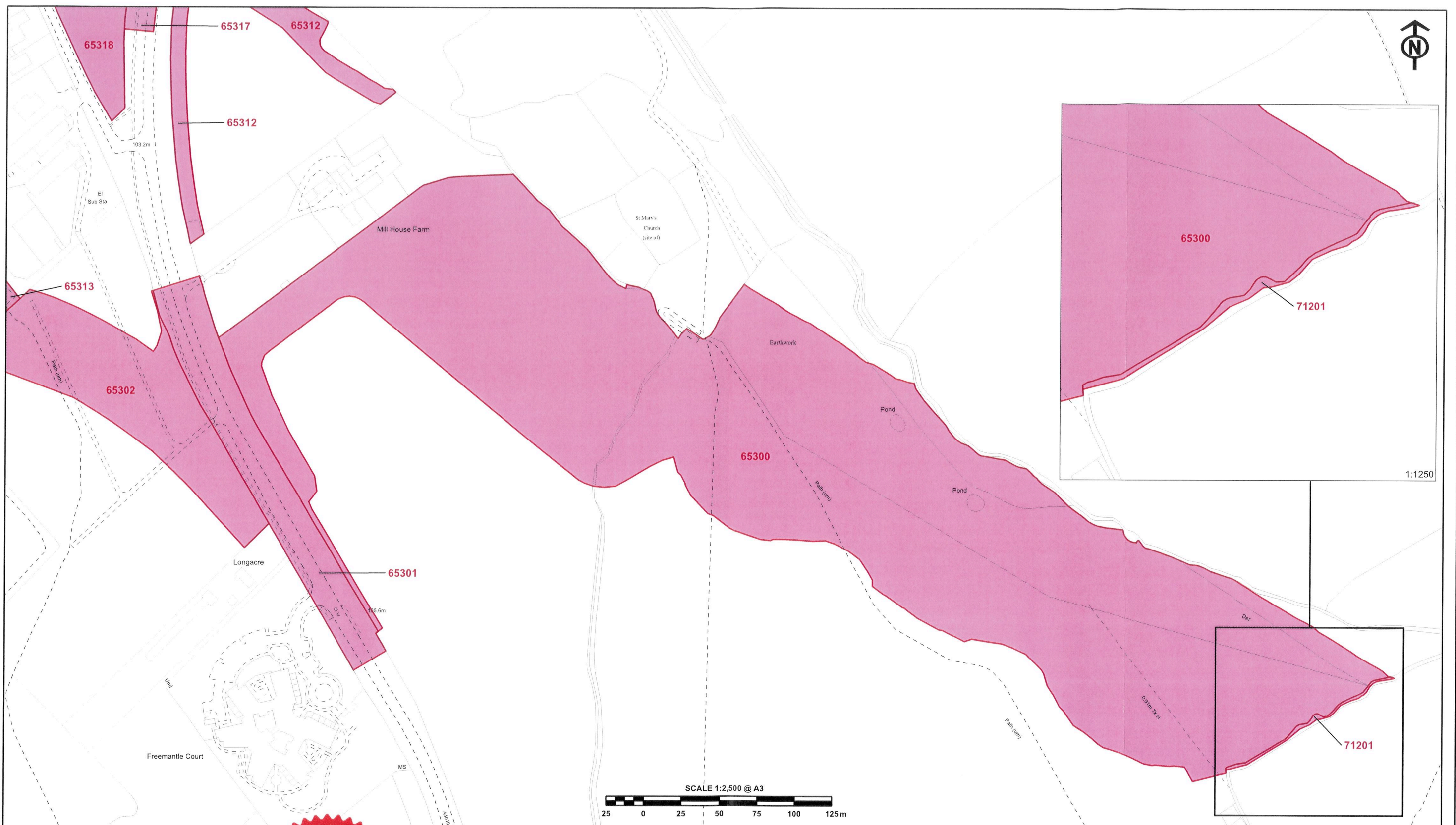

The CORPORATE SEAL of the
SECRETARY OF STATE
hereunto affixed to this deed
is authenticated by
Nat WMA
Authorised by the Secretary of State for Transport
Dated 8th February 2022

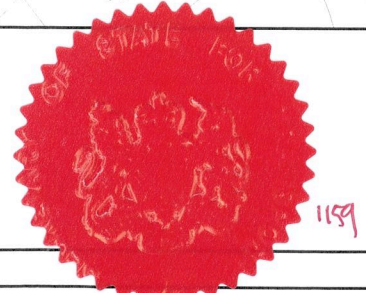

CENTRE POINT: 483,873, 209,284

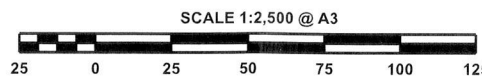

The CORPORATE SEAL of the
SECRETARY OF STATE
hereunto affixed to this deed
is authenticated by
[Signature]
Authorised by the Secretary of State for Transport
Dated 8th February 2022



CENTRE POINT: 483,253, 209,547

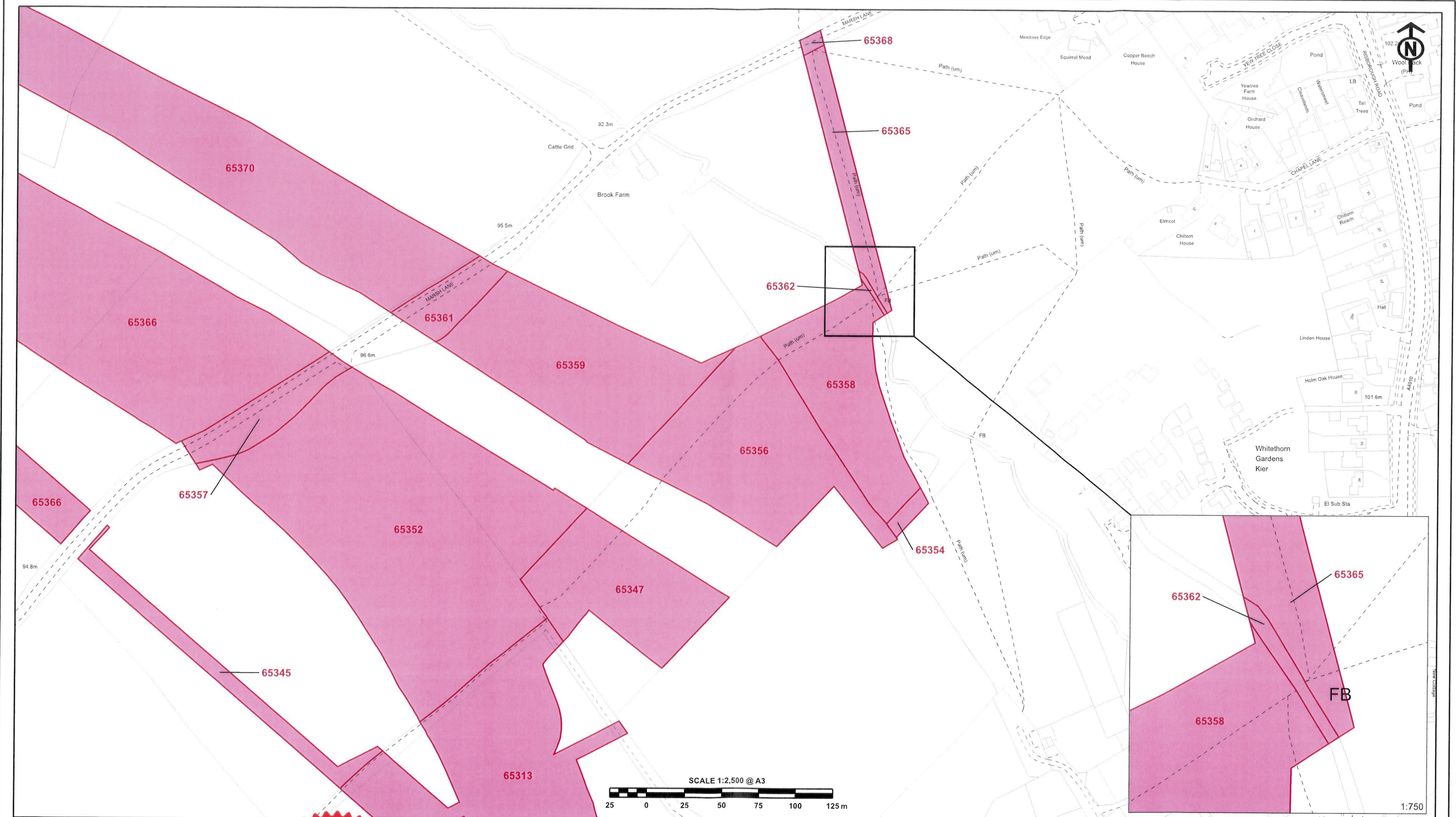

The CORPORATE SEAL of the
SECRETARY OF STATE
hereunto affixed to this deed
is authenticated by
Nan Lunt
Authorised by the Secretary of State for Transport
Dated 8th February 2022

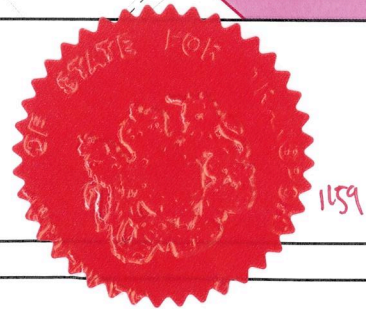

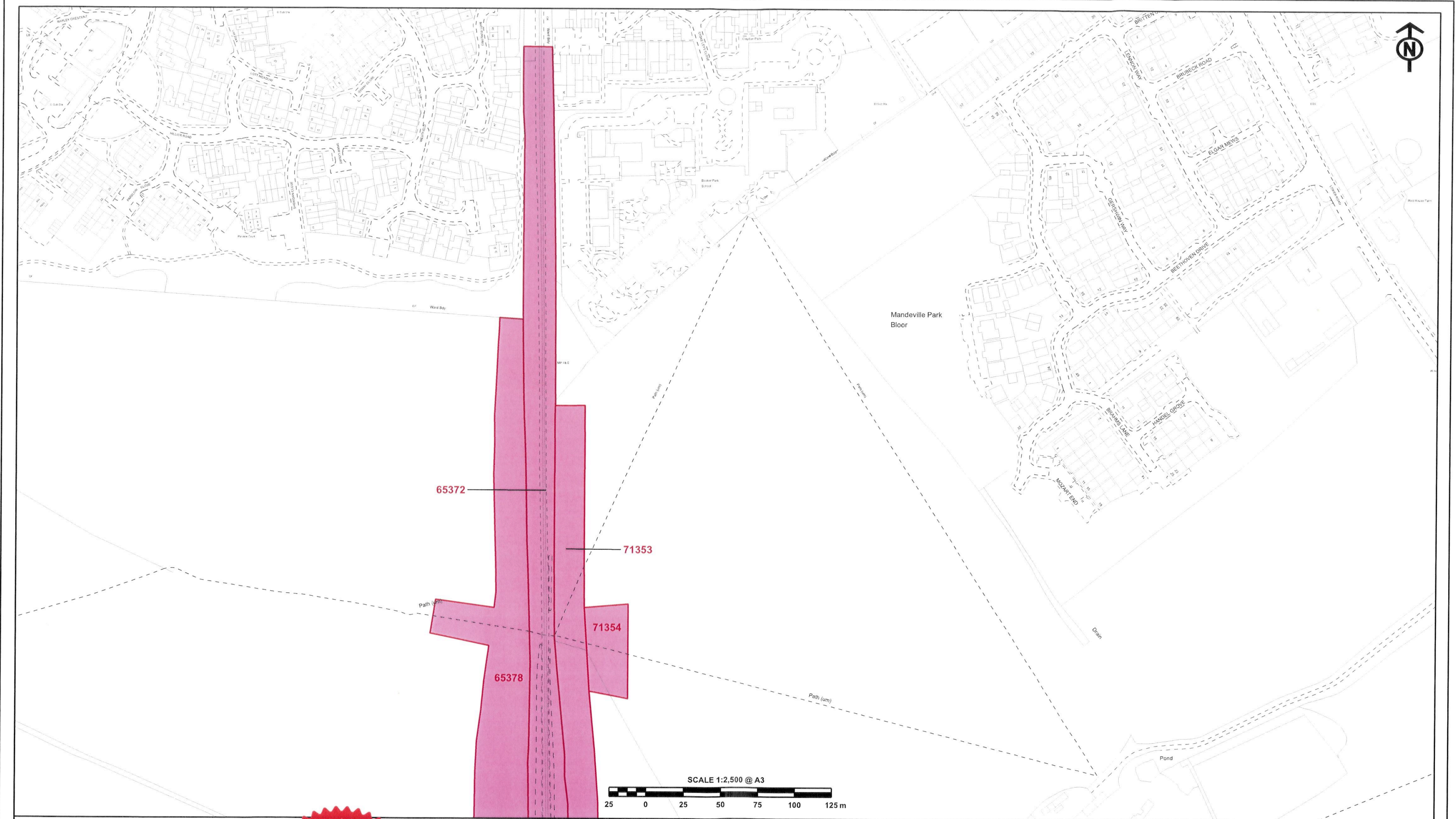

The CORPORATE SEAL of the
SECRETARY OF STATE
hereunto affixed to this deed
is authenticated by
Niall Wint
Authorised by the Secretary of State for Transport
Dated 8th February 2022

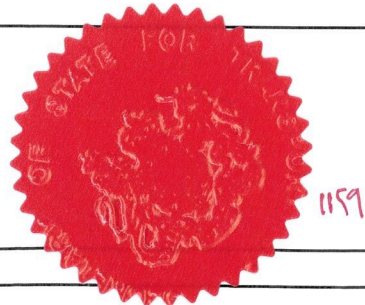

CENTRE POINT: 482,284, 211,102

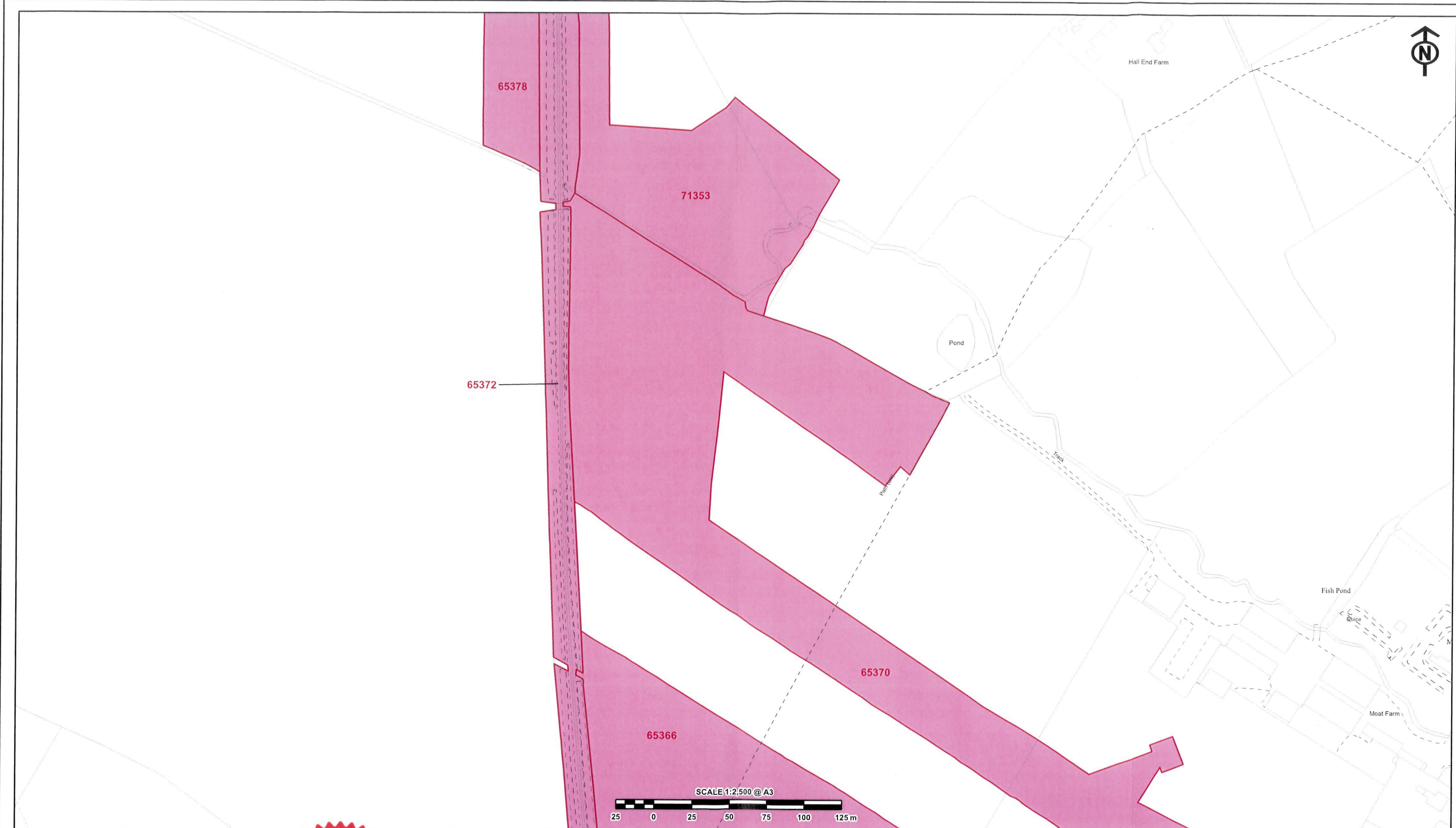

The CORPORATE SEAL of the
SECRETARY OF STATE
hereunto affixed to this deed
is authenticated by
Neil Lamb
Authorised by the Secretary of State for Transport
Dated 8th February 2022

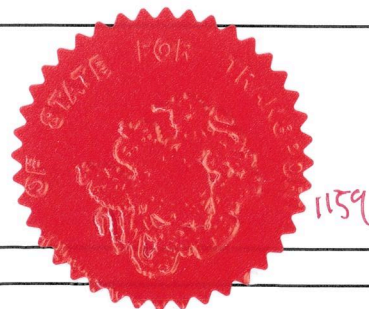

CENTRE POINT: 482,284, 210,574

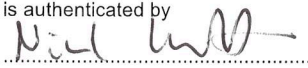

The CORPORATE SEAL of the
 SECRETARY OF STATE
 hereunto affixed to this deed
 is authenticated by

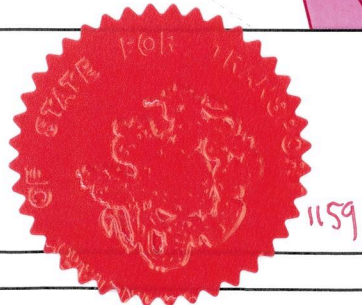
 Authorised by the Secretary of State for Transport
 Dated 8th February 2022

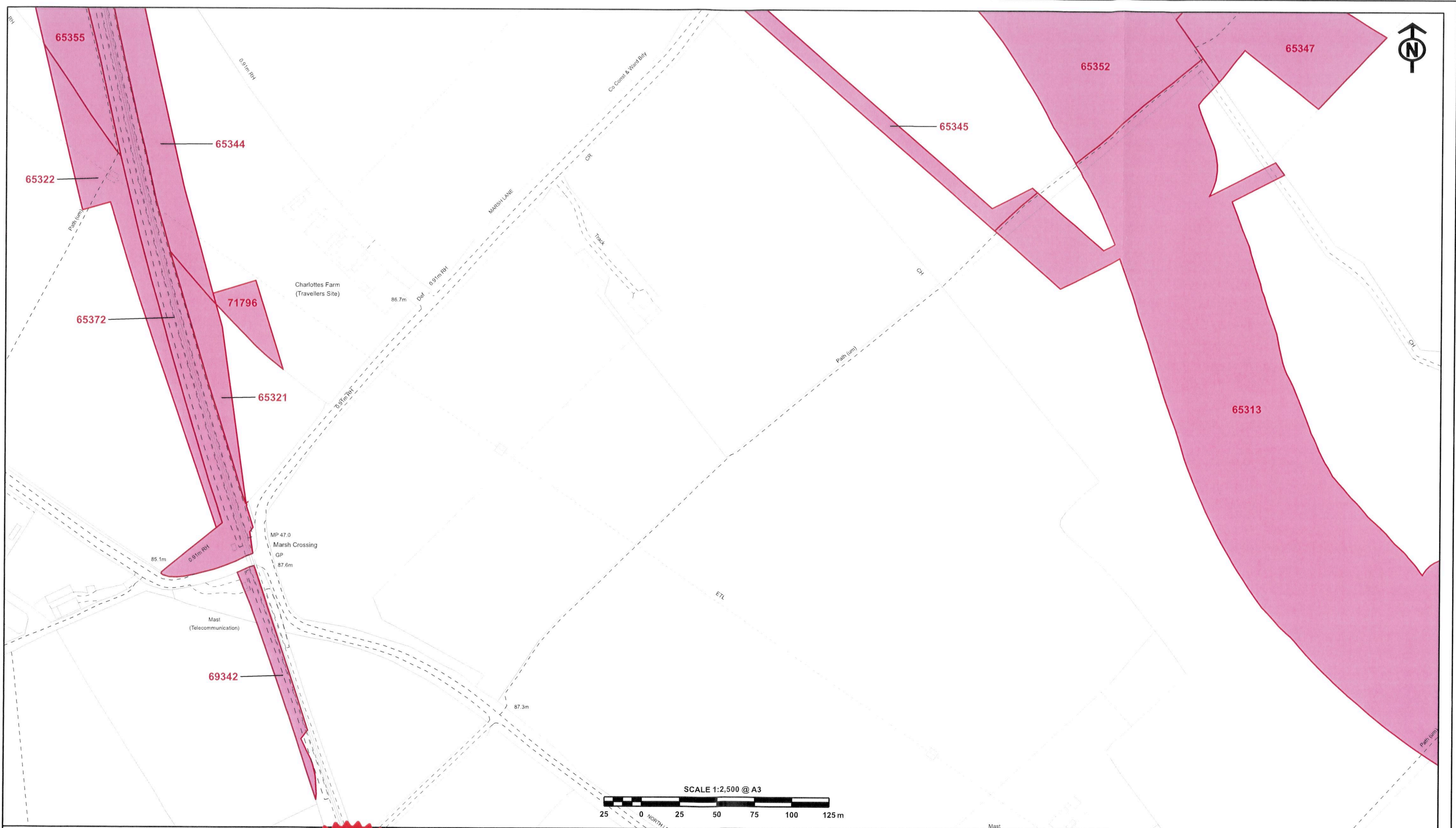

CENTRE POINT: 482,438, 210,102



The CORPORATE SEAL of the
SECRETARY OF STATE
hereunto affixed to this deed
is authenticated by

[Signature]

Authorised by the Secretary of State for Transport

Dated 8th February 2022

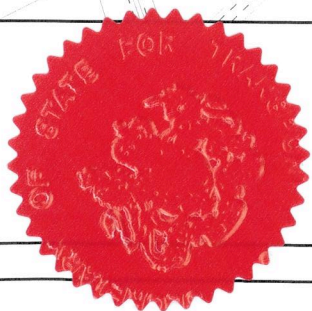

1159

CENTRE POINT: 482,659, 209,633

