

HIGH SPEED RAIL (LONDON – WEST MIDLANDS) ACT 2017

HIGH SPEED RAIL (LONDON – WEST MIDLANDS) GENERAL VESTING DECLARATION No. 787

This **GENERAL VESTING DECLARATION** is executed on 17 JANUARY 2022
by the Secretary of State for Transport (“the Authority”).

WHEREAS:

- (1) On 23 February 2017 the High Speed Rail (London – West Midlands) Act 2017 (“the High Speed Rail Act”) received Royal Assent authorising the Authority to acquire the land specified in the Schedule hereto.
- (2) Section 4(1) of the High Speed Rail Act authorises the Authority to acquire compulsorily so much of the land within the limits of the High Speed Rail Act as may be required for Phase One purposes¹.
- (3) Section 4(4) of the High Speed Rail Act provides that the Compulsory Purchase (Vesting Declarations) Act 1981 (“the 1981 Act”) applies as if the High Speed Rail Act were a compulsory purchase order and paragraph 3² of Schedule 6 to the High Speed Rail Act provides that the 1981 Act shall have effect subject to the modifications specified in that paragraph.
- (4) Notice pursuant to section 3A³ of the 1981 Act was first published on 19 November 2021. That notice included the particulars specified in section 3A(3) of the 1981 Act.

NOW THIS DEED WITNESSETH that, in exercise of the powers conferred on it by section 4 of the 1981 Act, the Authority hereby declares:-

1. The land described in the Schedule hereto (being part of the land authorised to be acquired by the High Speed Rail Act) and more particularly delineated and shown coloured pink on the plan annexed hereto, together with the right to enter upon and take possession of the land, shall vest in the Authority as from the end of the period of 4 months from the date on which the service of notices required by section 6⁴ of the 1981 Act is completed.

For the purposes of Section 2(2) of the 1981 Act, the specified period in relation to the land comprised in this declaration is one year and one day.

1 Phase One Purposes has meaning given by section 67 of the High Speed Rail Act

2 Paragraph 3 as substituted by section 11 of, and paragraph 6 of Schedule 14 to, the High Speed Rail Act.

3 Section 3A of the 1981 Act as inserted by paragraph 3(a) of Schedule 6 to the High Speed Rail Act as substituted by section 11 of, and paragraphs 6 and 7 of Schedule 14 to, that Act.

4 Section 6 as modified by paragraph 3(c) of Schedule 6 to the High Speed Rail Act, as substituted by section 11 of, and paragraph 6 of Schedule 14 to, that Act

SCHEDULE

Buckinghamshire

(1) Plot No.	(2) Description
49612	All interests in 7426.3 square metres, or thereabouts, of agricultural land, hedgerow, drain, hardstanding and river, bed and banks thereof (unnamed river) (Station Road)
63985	All interests in 34038.2 square metres, or thereabouts, of agricultural land and hedgerow (Quainton Road)
63986	All interests in 24081.7 square metres, or thereabouts, of agricultural land, hedgerow, hardstanding, access track and public footpath (QUA/30/1) (Station Road)
63989	All interests in 12105.3 square metres, or thereabouts, of agricultural land and hedgerow (Upper South Farm)
65716	All interests in 176.0 square metres, or thereabouts, of agricultural land (Upper Cranwell Farm)
65718	All interests in 41831.0 square metres, or thereabouts, of agricultural land, hedgerow, drain, pond, public footpaths (WAD/6/4 and WAD/7A/5) and public bridleways (WAD/8/3 and FMA/1/1) (Upper Cranwell Farm)
65719	All interests in 41717.0 square metres, or thereabouts, of agricultural land, hedgerow, ponds and public footpath (WAD/6/4) (Upper Cranwell Farm)
65721	All interests in 9273.2 square metres, or thereabouts, of agricultural land (Upper Cranwell Farm)
65723	All interests in 352.9 square metres, or thereabouts, of access track and verges (Cranwell Farm)
65724	All interests in 24786.5 square metres, or thereabouts, of agricultural land (Upper Cranwell Farm)
65728	All interests in 73.4 square metres, or thereabouts, of access track and verges (Cranwell Farm)
65730	All interests in 5684.0 square metres, or thereabouts, of agricultural land (Cranwell Farm)
65733	All interests in 3856.8 square metres, or thereabouts, of public road, footways and verges (Brackley Road, A41)
65734	All interests in 426.4 square metres, or thereabouts, of agricultural land (Cranwell Farm)
65735	All interests in 5949.4 square metres, or thereabouts, of public road and verges (Brackley Road, A41)
65736	All interests in 2561.0 square metres, or thereabouts, of public road and verges (Brackley Road, A41)
65737	All interests in 2816.0 square metres, or thereabouts, of public road and verges (Brackley Road, A41)
65738	All interests in 1806.1 square metres, or thereabouts, of verges (Brackley Road, A41)
65739	All interests in 96112.9 square metres, or thereabouts, of agricultural land (Lower Blackgrove Farm)
65740	All interests in 1531.9 square metres, or thereabouts, of access track and verge (Lower Blackgrove Farm)
65741	All interests in 69807.5 square metres, or thereabouts, of agricultural land and hedgerow (Lower Blackgrove Farm)
65746	All interests in 53433.9 square metres, or thereabouts, of agricultural land

	and hedgerow (Lower Blackgrove Farm)
65747	All interests in 2497.6 square metres, or thereabouts, of verge (Brackley Road, A41)
65748	All interests in 8357.4 square metres, or thereabouts, of public road and verges (Brackley Road, A41)
65749	All interests in 460.8 square metres, or thereabouts, of woodland (Brackley Road, A41)
65750	All interests in 18379.2 square metres, or thereabouts, of agricultural land (Waddesdon Estate)
65752	All interests in 696.5 square metres, or thereabouts, of agricultural land and public footpath (WAD/5/1) (Briar Hill Farm)
65755	All interests in 190.3 square metres, or thereabouts, of public road and verges (Blackgrove Road)
65756	All interests in 83411.2 square metres, or thereabouts, of agricultural land, hedgerows, ponds and public footpath (WAD/5/1) (Blackgrove Road)
65757	All interests in 20046.2 square metres, or thereabouts, of agricultural land and public footpath (WAD/5/2) (Waddesdon Estate)
65758	All interests in 4139.1 square metres, or thereabouts, of agricultural land and public footpath (WAD/5/1) (Blackgrove Road)
65759	All interests in 3467.3 square metres, or thereabouts, of agricultural land and hedgerow (Blackgrove Road)
65760	All interests in 9630.0 square metres, or thereabouts, of public road and verges (Blackgrove Road)
65761	All interests in 6344.7 square metres, or thereabouts, of agricultural land and pond (Blackgrove Road)
65762	All interests in 294.3 square metres, or thereabouts, of agricultural land (Waddesdon Estate)
65763	All interests in 1901.2 square metres, or thereabouts, of agricultural land, hedgerow and public footpath (WAD/3/4) (Glebe Farm)
65764	All interests in 1019.6 square metres, or thereabouts, of agricultural land (Lower Blackgrove Farm)
65765	All interests in 438.2 square metres, or thereabouts, of agricultural land (Glebe Farm)
65766	All interests in 31882.8 square metres, or thereabouts, of agricultural land, hedgerow and public footpath (WAD/4/2) (Glebe Farm)
65768	All interests in 60590.3 square metres, or thereabouts, of agricultural land and hedgerow (Glebe Farm)
65769	All interests in 166.6 square metres, or thereabouts, of access track and verges (Glebe Farm)
65778	All interests in 4622.9 square metres, or thereabouts, of hardstanding, hedgerows, grassland and access track (Waddesdon Sewage Treatment Works)
65784	All interests in 5174.6 square metres, or thereabouts, of agricultural land and hedgerow (Glebe Farm)
65787	All interests in 1020.6 square metres, or thereabouts, of woodland and access splay (Station Road)
65788	All interests in 1308.8 square metres, or thereabouts, of public road and verges (Quainton Road)
65789	All interests in 27612.9 square metres, or thereabouts, of agricultural land, hedgerows, construction site and river, bed and banks thereof (Unnamed river) (Station Road)
65790	All interests in 663.8 square metres, or thereabouts, of railway, works and land (Great Central Railway)
65793	All interests in 323.5 square metres, or thereabouts, of public road and verges (Quainton Road)

65794	All interests in 76.0 square metres, or thereabouts, of hardstanding (Station Road)
65796	All interests in 39385.6 square metres, or thereabouts, of agricultural land, access track, hedgerows and construction site (Station Road)
65800	All interests in 18956.5 square metres, or thereabouts, of agricultural land and hedgerows (Station Road)
65801	All interests in 8801.7 square metres, or thereabouts, of public road and verges (Station Road)
65808	All interests in 7.7 square metres, or thereabouts, of verge (Station Road)
65809	All interests in 15.6 square metres, or thereabouts, of access splay and verge (Quainton Road Station)
65810	All interests in 198.1 square metres, or thereabouts, of access track and verge (Buffer Depot)
65811	All interests in 176.2 square metres, or thereabouts, of woodland, hardstanding and access splay (Station Road)
65812	All interests in 219.1 square metres, or thereabouts, of public road and verges (Station Road)
65813	All interests in 6984.3 square metres, or thereabouts, of agricultural land, hardstanding, hedgerow and access track (Quainton Road Station)
65815	All interests in 337.3 square metres, or thereabouts, of public road and verges (Station Road)
65816	All interests in 106.5 square metres, or thereabouts, of hedgerow (Quainton Road Station)
65817	All interests in 738.4 square metres, or thereabouts, of access track and hedgerow (Down Yard)
65819	All interests in 501.7 square metres, or thereabouts, of hedgerow (Station Road)
65821	All interests in 13670.7 square metres, or thereabouts, of agricultural land, hedgerows, drain and access track (Quainton Road Station)
69206	All interests in 1798.0 square metres, or thereabouts, of access track and public footpath (WAD/4A/1) (Glebe Farm)
69207	All interests in 87669.1 square metres, or thereabouts, of agricultural land, hedgerows, access track and public footpaths (WAD/3/4 and WAD/4A/1) (Glebe Farm)
70070	All interests in 352.8 square metres, or thereabouts, of access track (Glebe Farm)
70071	All interests in 356.6 square metres, or thereabouts, of access track carrying public footpath (WAD/4/2) (Glebe Farm)
70072	All interests in 36471.0 square metres, or thereabouts, of agricultural land, hedgerows and public footpath (WAD/4A/1) (Glebe Farm)
70073	All interests in 27228.3 square metres, or thereabouts, of agricultural land, hedgerows, woodland and ponds (Glebe Farm)
70075	All interests in 54436.6 square metres, or thereabouts, of agricultural land, hedgerows, access track and public footpath (WAD/3/4) (Glebe Farm)
70076	All interests in 550.5 square metres, or thereabouts, of access track (Glebe Farm)
70077	All interests in 193.7 square metres, or thereabouts, of access track (Glebe Farm)
71733	All interests in 274.7 square metres, or thereabouts, of agricultural land and hedgerows (Fleet Marston)

IN WITNESS WHEREOF the Secretary of State for Transport has hereunto set its corporate seal on the day in the year first written above.

The **CORPORATE SEAL** of the SECRETARY OF STATE FOR TRANSPORT hereunto affixed to this deed is authenticated by



Authorized Signatory

Dated: 17 JANUARY 2022



SEAL REF
DfT GP 10949

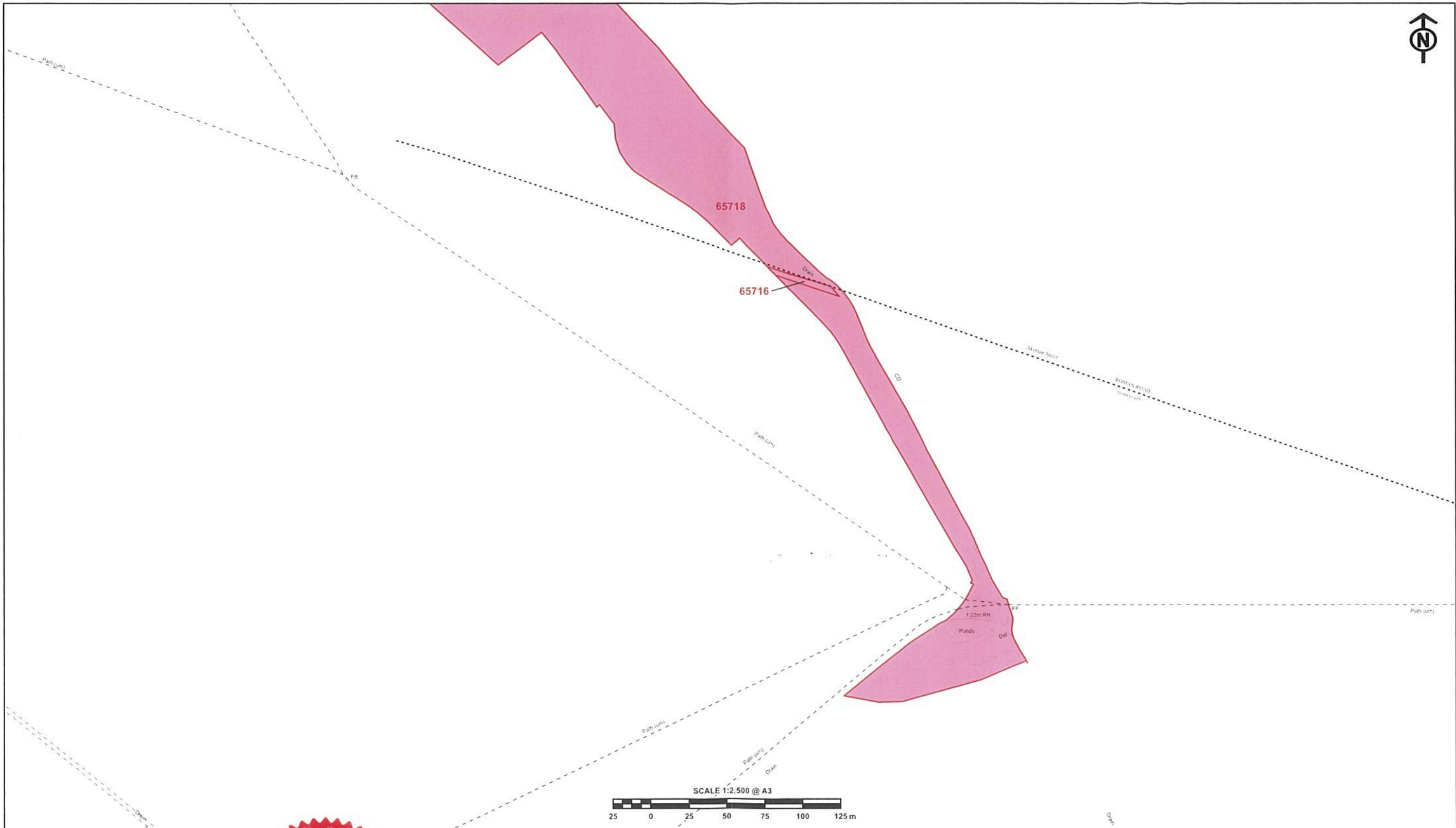

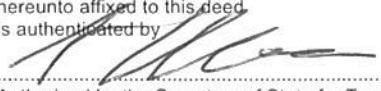
The CORPORATE SEAL of the
SECRETARY OF STATE
hereunto affixed to this deed
is authenticated by

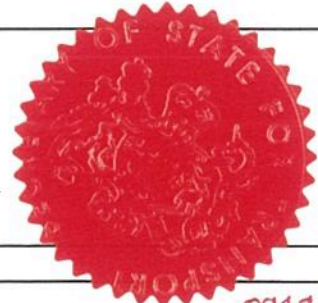
Authorised by the Secretary of State for Transport
Dated 17 JANUARY 2022



0919

CENTRE POINT: 477,163, 215,698

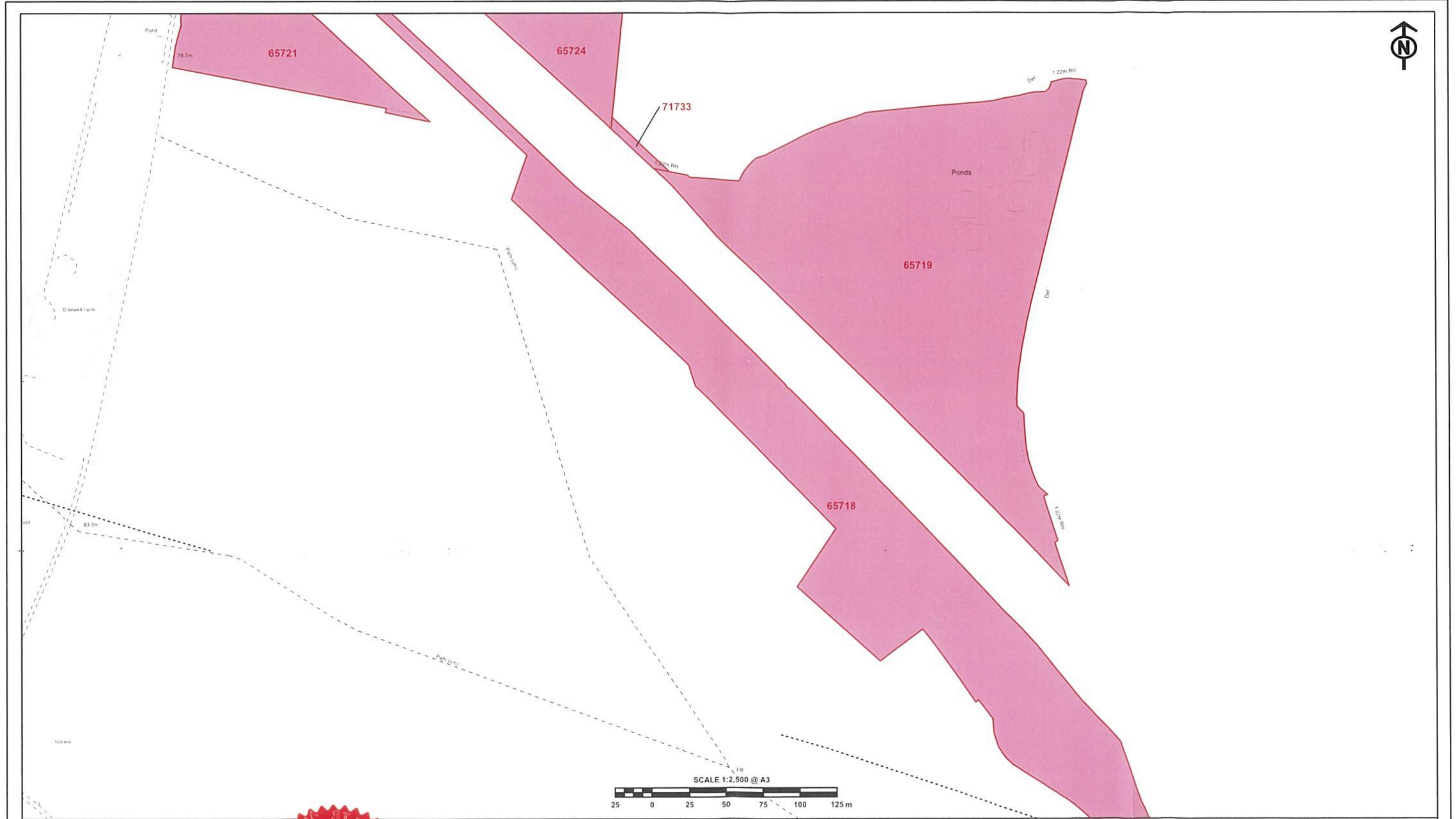
© Crown copyright and database rights 2021. Ordnance Survey Licence Number 100041795.
© Crown copyright material is reproduced with the permission of Land Registry under
delegated authority from the Controller of HMSO and © Crown Copyright Ordnance Survey.



The CORPORATE SEAL of the
SECRETARY OF STATE
hereunto affixed to this deed
is authenticated by

[Signature]
Authorised by the Secretary of State for Transport

Dated 17 JANUARY 2022



0949

CENTRE POINT: 476,909, 216,096

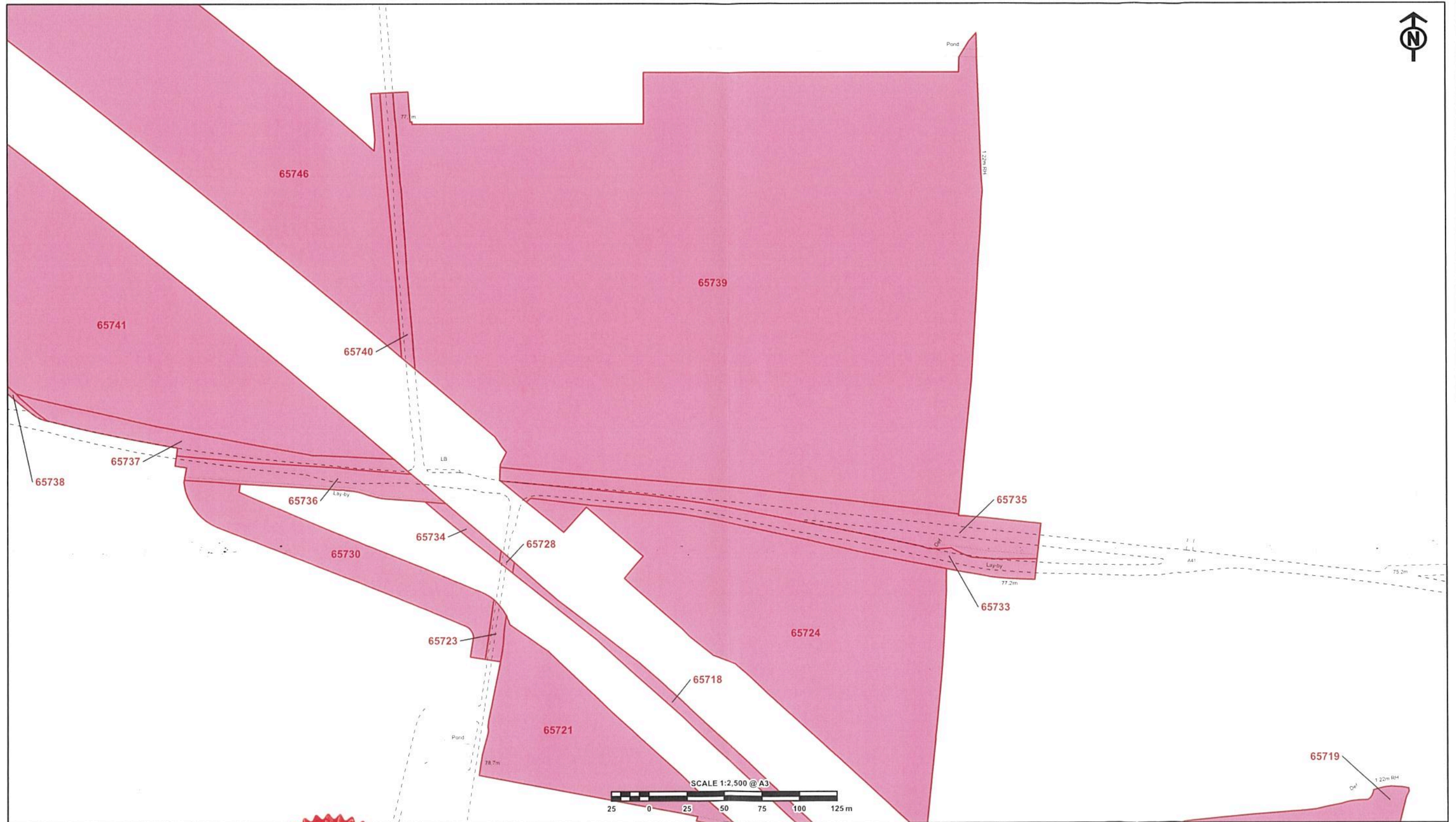

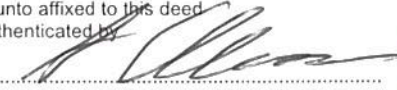
The CORPORATE SEAL of the
SECRETARY OF STATE
hereunto affixed to this deed
is authenticated by

Authorised by the Secretary of State for Transport
Dated 17 JANUARY 2022



0949

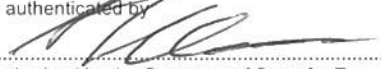

The CORPORATE SEAL of the
SECRETARY OF STATE
hereunto affixed to this deed
is authenticated by

Authorised by the Secretary of State for Transport
Dated 17 JANUARY 2022

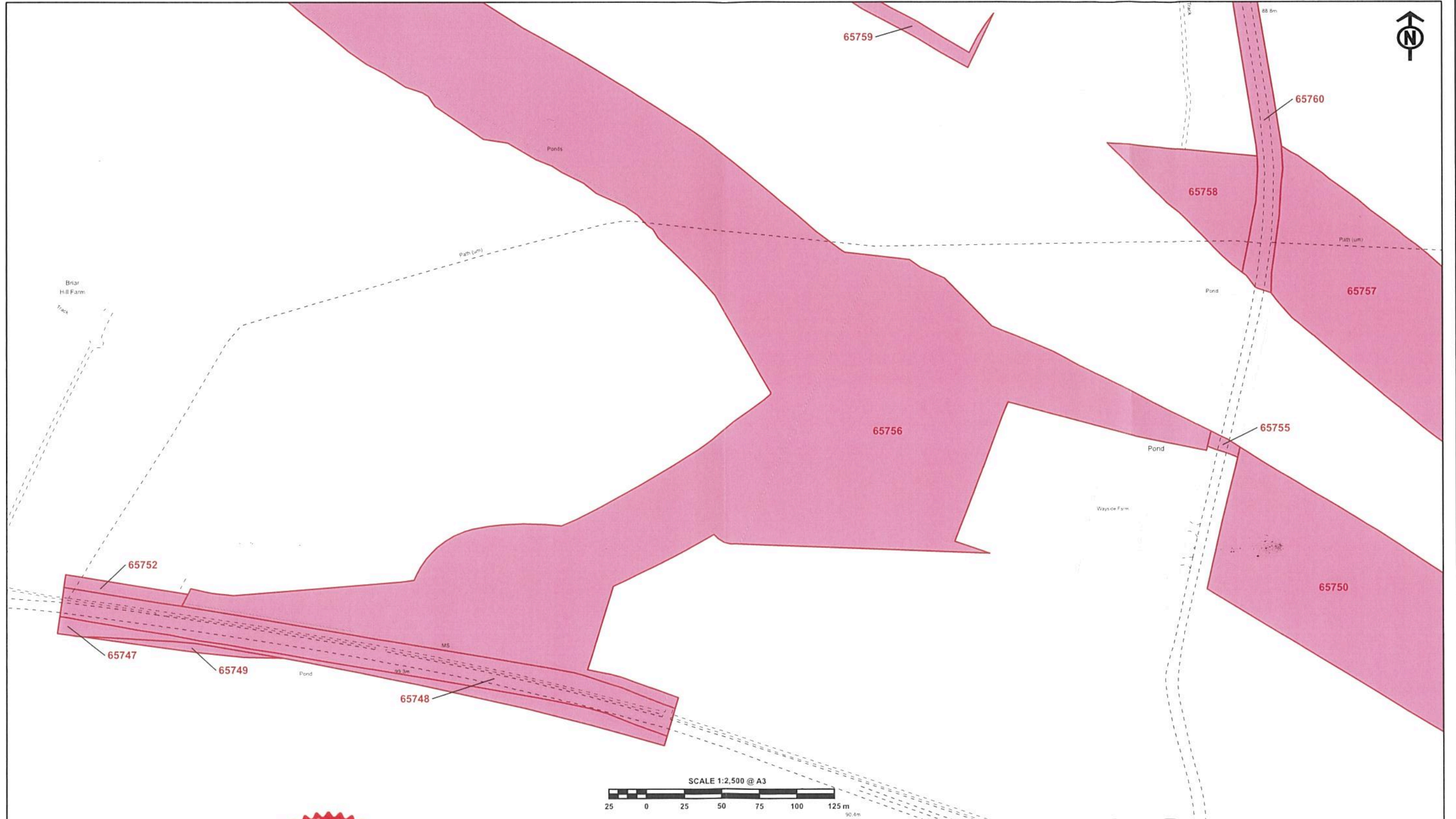

0949



CENTRE POINT: 475,494, 217,039

The CORPORATE SEAL of the
SECRETARY OF STATE
hereunto affixed to this deed
is authenticated by

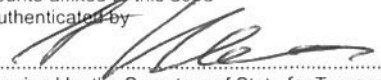

Authorized by the Secretary of State for Transport

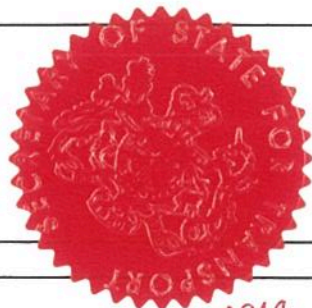
Dated 17 JANUARY 2022.

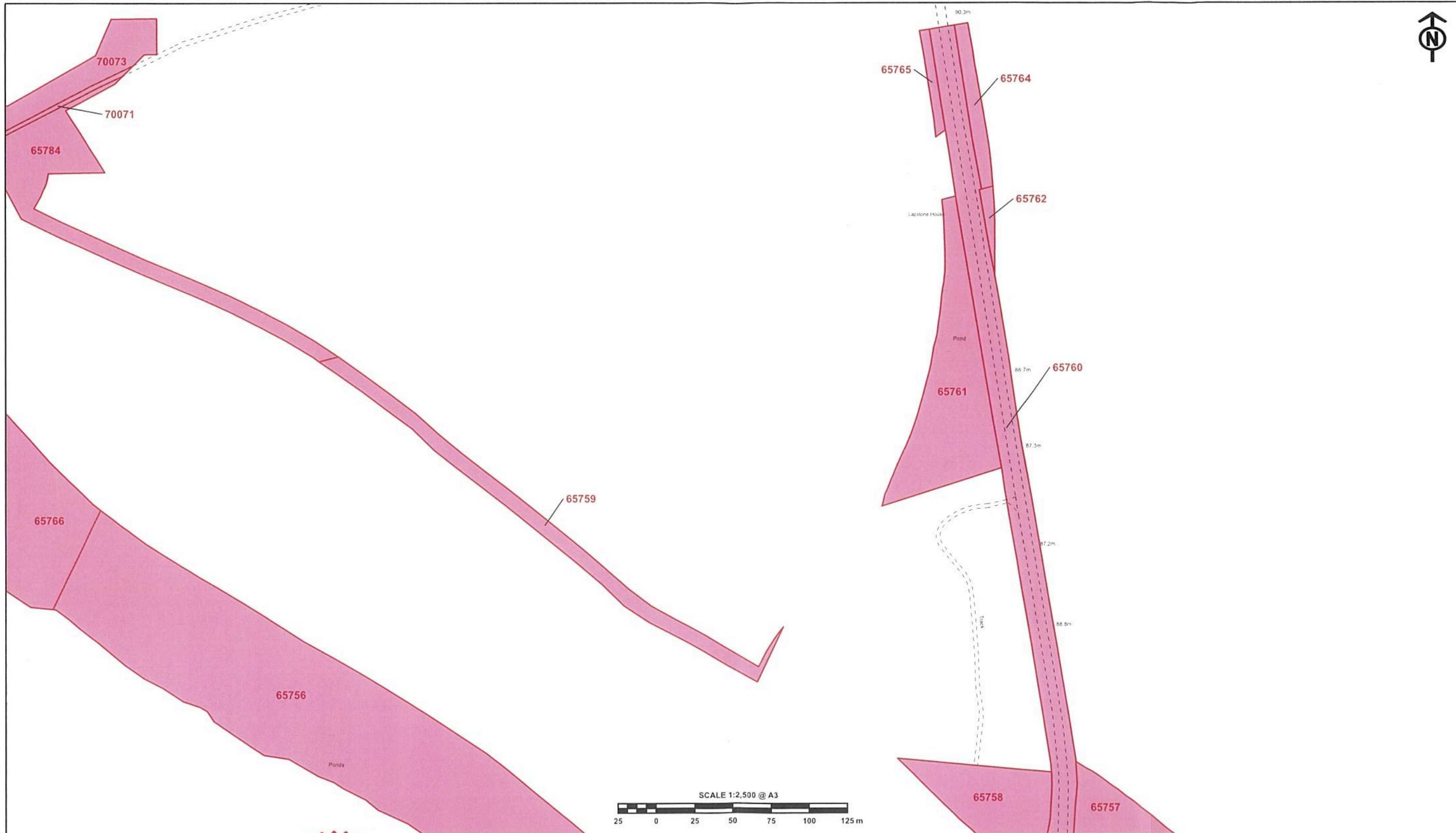

0949

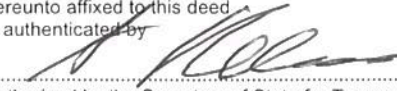

The CORPORATE SEAL of the
SECRETARY OF STATE
hereunto affixed to this deed
is authenticated by

Authorised by the Secretary of State for Transport
Dated 17 JANUARY 2022

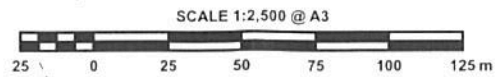

0949

CENTRE POINT: 475,643, 217,440

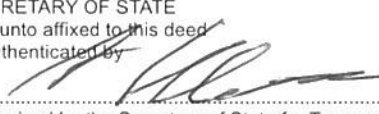

CENTRE POINT: 474,805, 217,720

The CORPORATE SEAL of the
SECRETARY OF STATE
hereunto affixed to this deed
is authenticated by

Authorized by the Secretary of State for Transport
Dated 17 JANUARY 2022.



0949



CENTRE POINT: 474,989, 218,160

The CORPORATE SEAL of the
SECRETARY OF STATE
hereunto affixed to this deed
is authenticated by

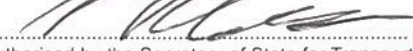

Authorised by the Secretary of State for Transport

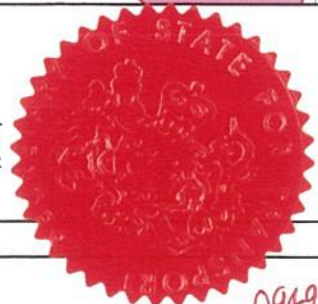
Dated 17 JANUARY 2022



0949



The CORPORATE SEAL of the
SECRETARY OF STATE
hereunto affixed to this deed
is authenticated by

Authorised by the Secretary of State for Transport
Dated 17 JANUARY 2022.



0949

CENTRE POINT: 474,285, 218,152

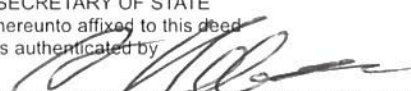

CENTRE POINT: 473,862, 218,431

The CORPORATE SEAL of the
SECRETARY OF STATE
hereunto affixed to this deed
is authenticated by

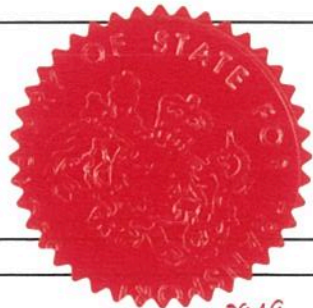
Authorised by the Secretary of State for Transport
Dated 17 JANUARY 2022

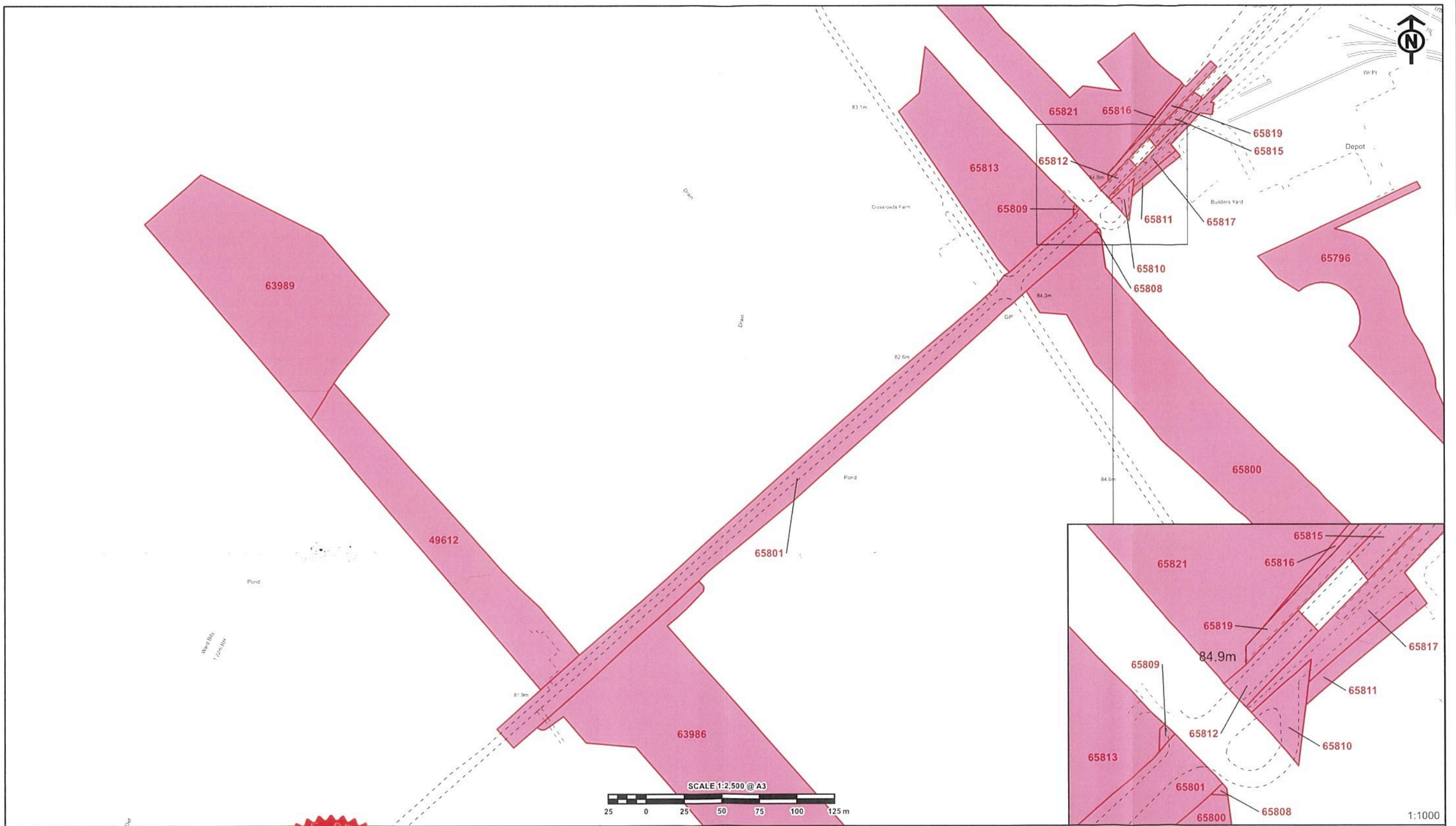

0949



The CORPORATE SEAL of the
SECRETARY OF STATE
hereunto affixed to this deed
is authenticated by

Authorised by the Secretary of State for Transport
Dated 17 JANUARY 2022



0949

CENTRE POINT: 473,357, 218,714

© Crown copyright and database rights 2021. Ordnance Survey Licence Number: 100049133
© Crown copyright material is reproduced with the permission of Land Registry under
delegated authority from the Controller of HMSO and is Crown Copyright Ordnance Survey

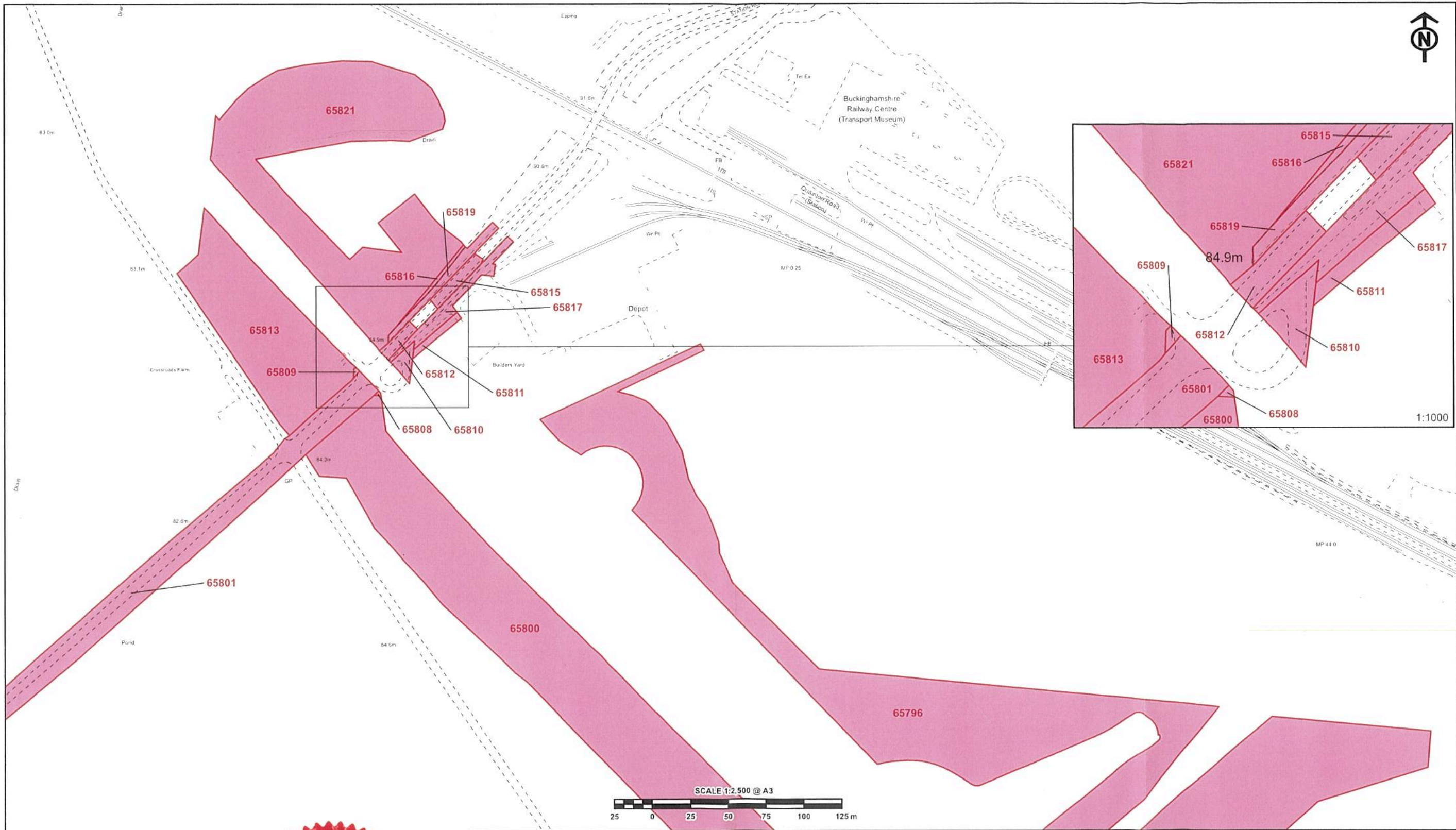

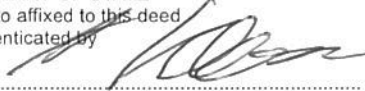
The CORPORATE SEAL of the
SECRETARY OF STATE
hereunto affixed to this deed
is authenticated by

Authorised by the Secretary of State for Transport
Dated 17 JANUARY 2022



8999