

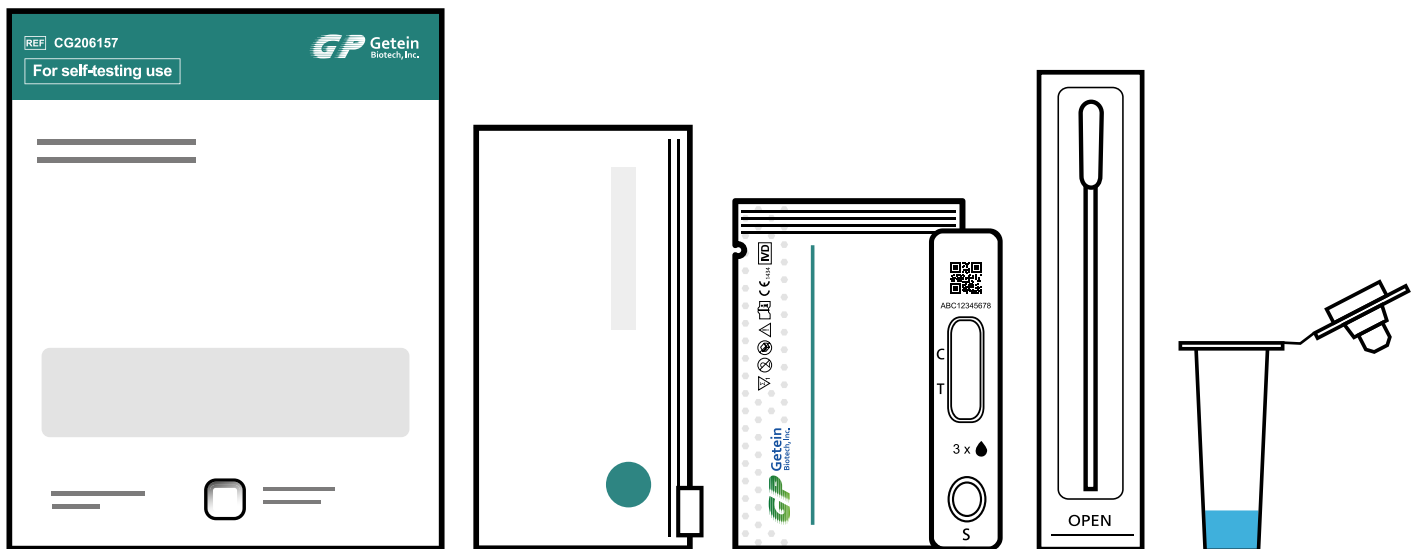

# Your step-by-step guide to Getein Biotech COVID-19 Self Testing



It is important that you read all of this leaflet before you start.

Alternative language versions including Welsh and video demonstrations are on [gov.uk/covid19-self-test-help](https://www.gov.uk/covid19-self-test-help)

# Using this guide

Using this guide	2
Testing for COVID-19	3
About the test	5
What is in your test kit	6
Getting ready to do your test	7
Testing a child or someone else	12
Swabbing your nose	15
After swabbing your nose	17
Using your test cassette	19
Getting your test results	21
Throwing away your used test kit	23

# Testing for COVID-19

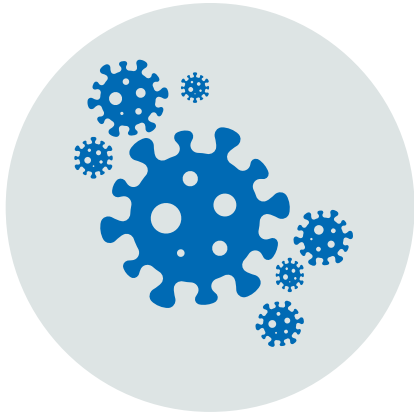

COVID-19 is an illness that has spread around the world.



Some people can feel very ill when they have COVID-19.

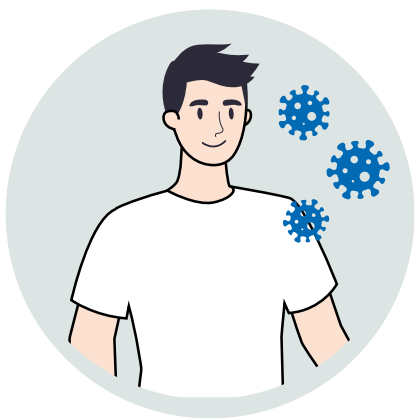

Other people might not feel ill at all.

You can do this test even if you do not feel ill.

You can do the test and check the results yourself.



It will take about 15 minutes to do the test.

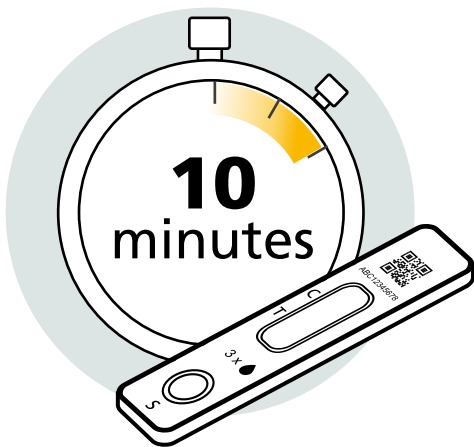

Then you wait for 10 minutes to get your results.

### Important

Only use one test kit at a time.

Do not mix parts from different test kits.

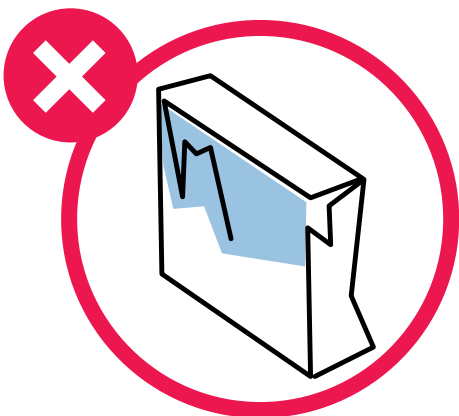

Do not use a test if anything is torn or broken or missing.

# About the test

The test is nothing to worry about. It will be quick and it will not hurt.



You will take the sample from your nose using the swab.

You will use the same swab for both of your nostrils.



If your nostril is pierced you must take your jewellery out before doing the test.



You can watch a video on how to do a swab test:

[gov.uk/covid19-self-test-help](https://www.gov.uk/covid19-self-test-help)

# What is in your test kit

There are 7 test kit packets in the box.

The box has a small hole in the top. You can put the plastic tube here when you do the test.

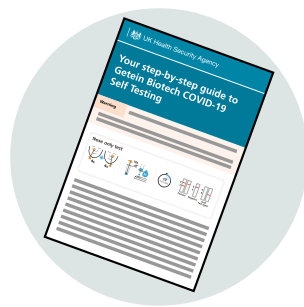

Each box has an instruction leaflet

In each packet there is:

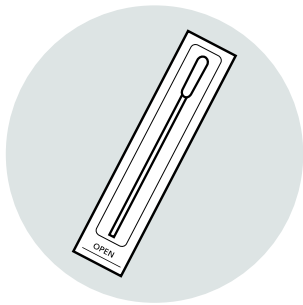

A swab in a packet. The swab is a stick with a bud at the end.



A plastic tube with a lid. It will have some liquid in.

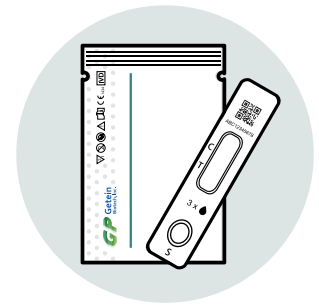

A plastic test cassette in a white packet.



A small plastic bag. This is for the used parts from your test when you have finished.

# Getting ready to do your test



Clear, clean and dry a flat surface such as a table.

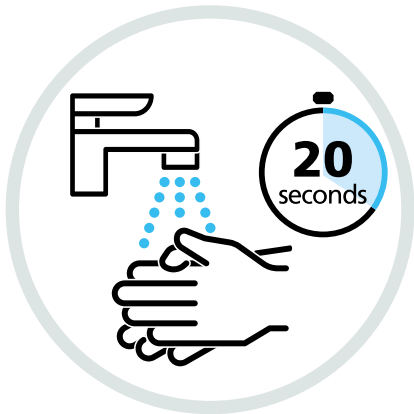

Now wash your hands with soap and water or use hand sanitiser

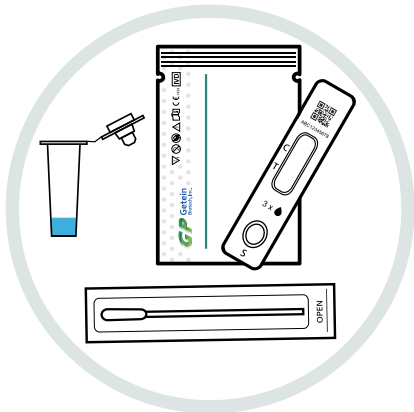

Take one test kit packet out of the box.

Open the packet. Put the test parts on the clean surface.



You will need the test kit box. You can stand the tube in the small hole in the top when you do the test.

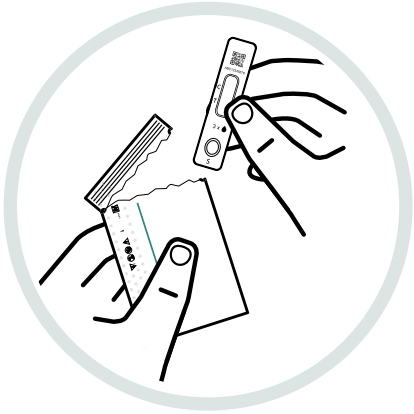

Open the test cassette packet and take out the test cassette.

Put it on your clean, flat and level surface.



### Important

Once you open the cassette, you need to start the test within 60 minutes.

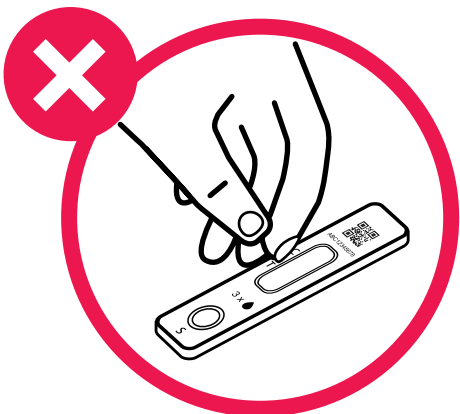

### Important

Do not move the cassette during the test.



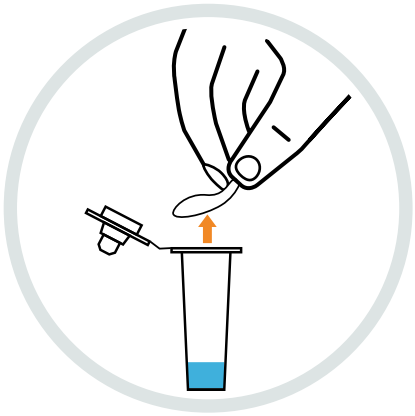

Carefully hold the plastic tube.  
Keep it away from your face.  
Gently pull the seal off the top.

### Important

Do not try to pull the seal off with your teeth.

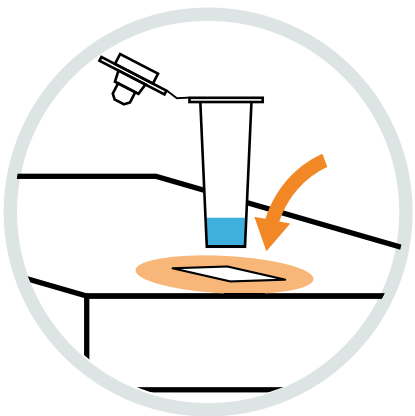

Place the tube in the hole in the test kit box.

Make sure none of the liquid spills.

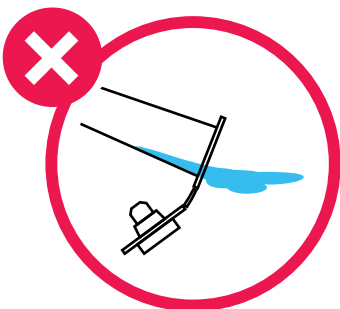

### Warning

If any of the liquid from the tube gets on your skin or in your eyes or mouth, rinse with lots of water.

If it starts to feel sore, contact your doctor.



Blow your nose into a tissue.

Throw the tissue away in a bin.

If you are testing a child or someone else. Help them to blow their nose.

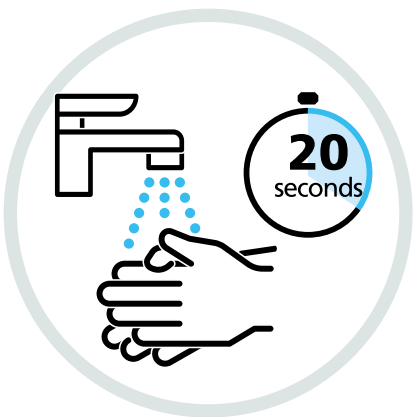

Wash your hands again with soap and warm water or hand sanitiser for 20 seconds.

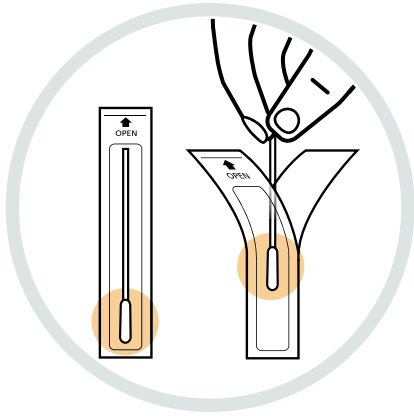

Open the swab packet at the stick end and carefully take out the swab.

Make sure you hold it at the stick end.

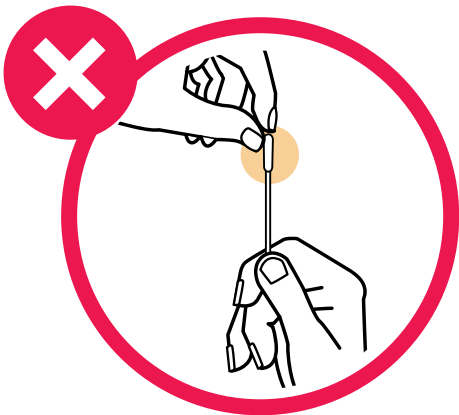

Do not touch the soft end of the swab with your fingers.

If the swab touches anything it could spoil your results.

# Testing a child or someone else

Children under 12 should be tested by an adult.



## Warning

Do not do a test on a child or someone else if you are not sure how to do it.



You can watch a demonstration video at: [gov.uk/covid19-self-test-help](https://www.gov.uk/covid19-self-test-help)

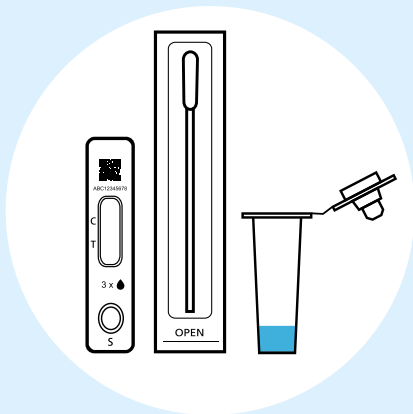

Show the test kit to the child or person you are testing.

Tell them what you are going to do.

It is helpful for a small child to sit on someone's lap.



If the child or person you are testing is hurting, stop the test.

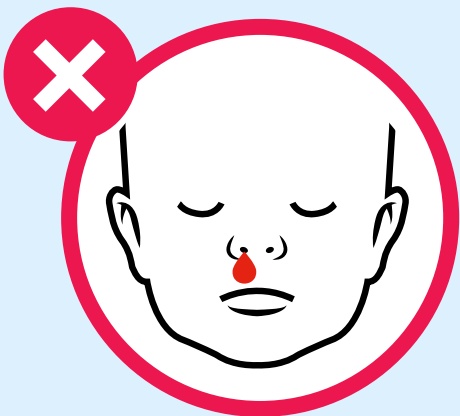

If the child or person you are testing has a nose bleed, stop the test.

Wait at least 24 hours before doing a new test.

If their nose does not stop bleeding, contact a doctor.



Place the soft end of the swab about 1.5cm into the first nostril.



You do not need to push it very far. Stop when you feel it touch the inside of the nose.

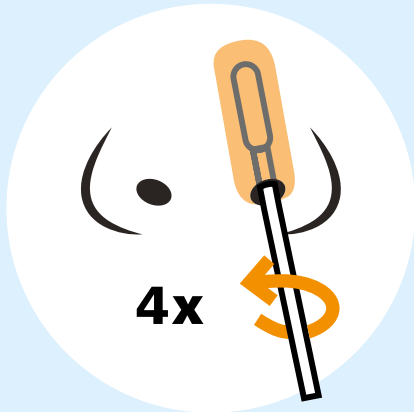

Gently turn the swab round 4 times in the nostril.

Slowly take the swab out of the nostril.

**Swab both nostrils**

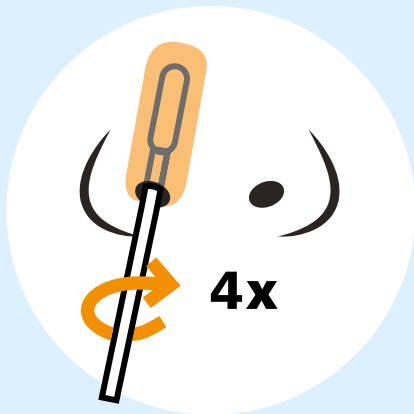

Place the soft end of the same swab into their other nostril. Gently turn it around 4 times.

Slowly take the swab out of that nostril.

# Swabbing your nose

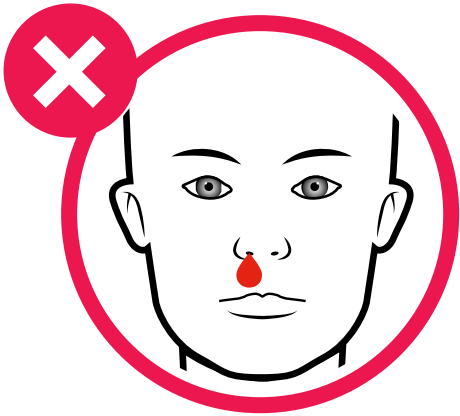

If you have a nose bleed, stop the test.

Wait at least 24 hours before doing a new test.

If your nose does not stop bleeding, contact your doctor.



Place the soft end of the swab about 1.5cm into your first nostril.

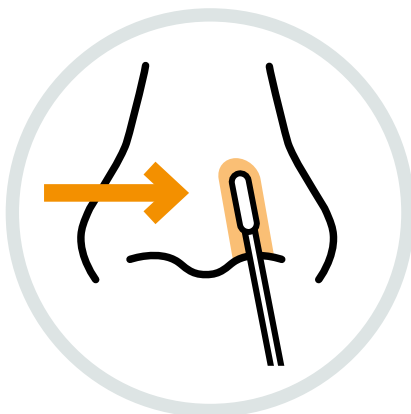

You do not need to push it very far. Stop when you feel it touch the inside of your nose.

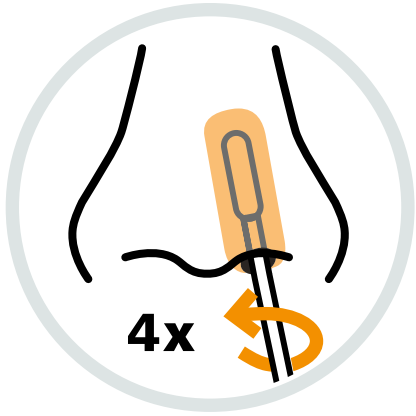

Gently turn the swab round 4 times in your nostril.

Slowly take the swab out of your nostril.

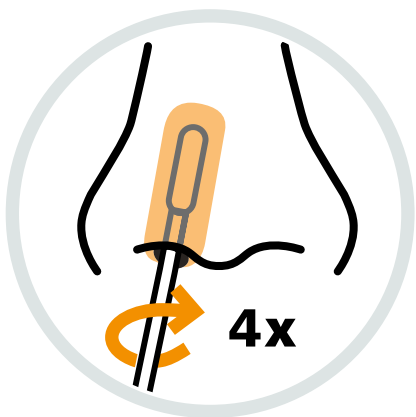

Place the soft end of the same swab into your other nostril. Gently turn it around 4 times.

Slowly take the swab out of that nostril.



# After swabbing your nose

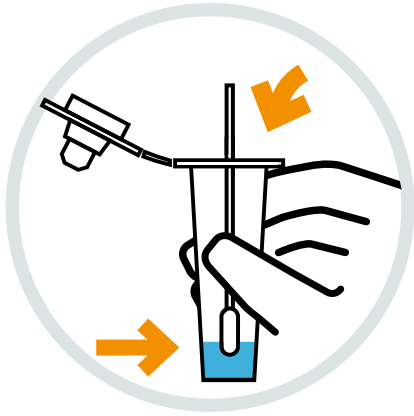

Put the swab into the plastic tube. The soft end should go in the liquid.

Be careful not to spill any liquid from the tube.

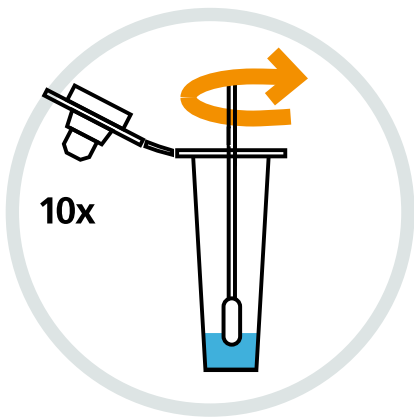

Stir the liquid round with the swab 10 times

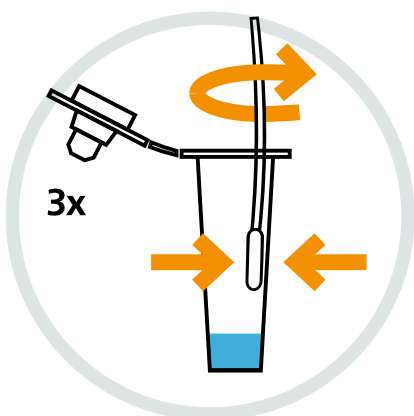

Squeeze the soft end of the swab against the side of the tube 3 times.

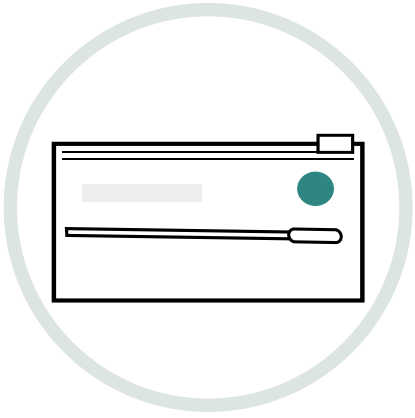

You do not need the swab again.  
Put it in the small plastic bag.



Push the top onto the plastic  
tube.  
Make sure it is on tightly so that  
no liquid can spill.

# Using your test cassette

The test cassette looks like this picture:

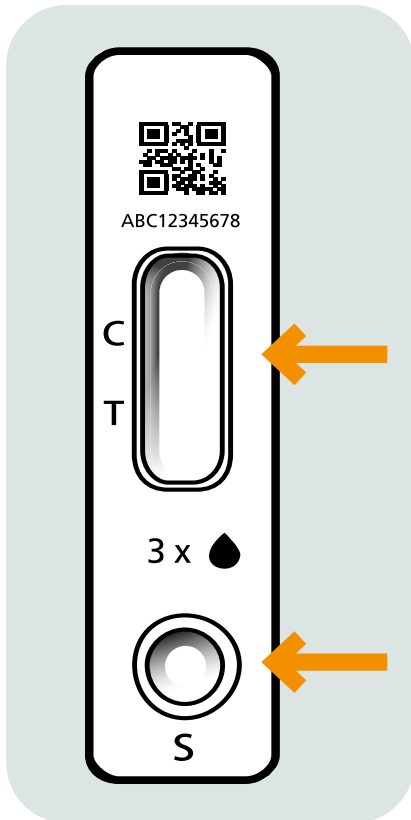

This part will tell you the results. It has the letters C and T next to it.

The small round hole is where you put your sample. It has the letter S next to it.

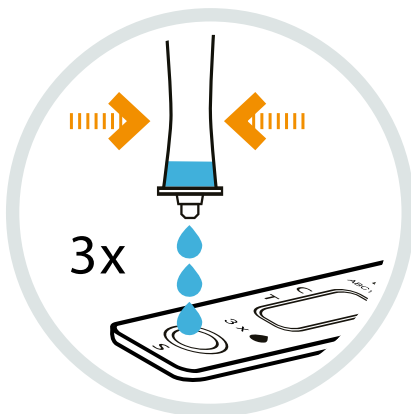

Slowly squeeze three drops of liquid from the plastic tube into the hole next to the letter S.

Make sure that you drop liquid and not an air bubble.

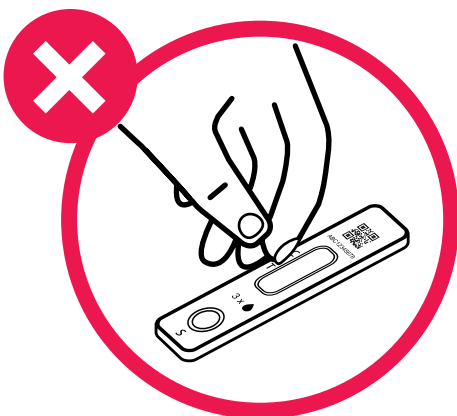

## Important

Do not move the cassette during the test.



You need to wait 10 minutes before you can read your result.

Set a timer or use a watch or clock.



### Important

You can read the result after 10 to 20 minutes.



Do not read it after 20 minutes, as the result may be wrong.

# Getting your test results

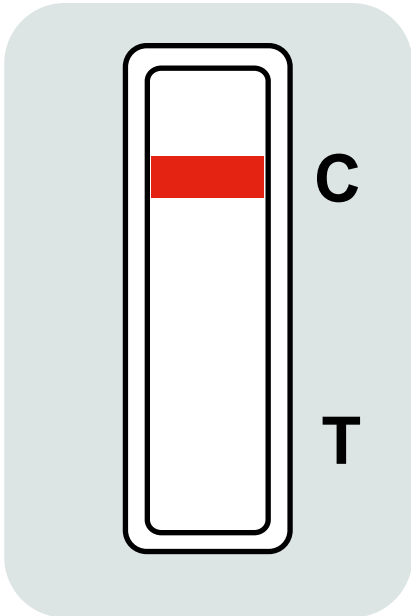

## If you test negative

Your test should show a line next to the letter C. This shows that your test is working.

If there is just one line next to the letter C, this means your test is negative.

You probably do not have COVID-19.

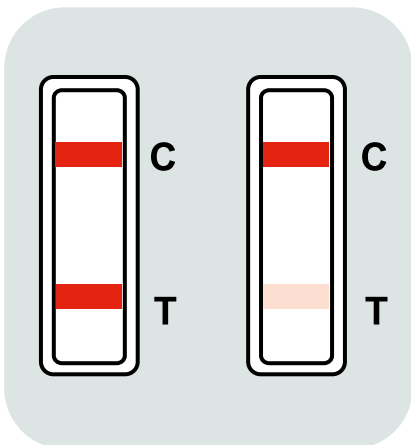

## If you test positive

If there are 2 lines, it shows the test is positive.

One line is next to the letter C and the other line is next to the letter T.

Even if the lines are not very clear, you probably have COVID-19.



If you test positive, you should stay at home if you can, so you don't spread the virus.

For more advice go to [nhs.uk/stay-at-home](https://www.nhs.uk/stay-at-home)

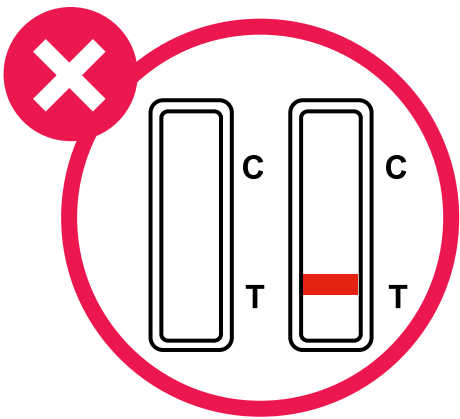

### Void result

If there are no lines or just one line by the letter T, the test did not work.

If this happens, do the test again.

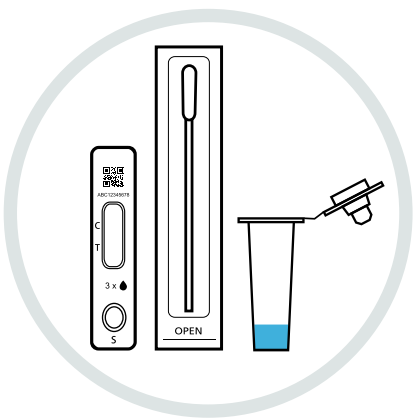

Use a new test. Do not reuse any parts from your first test.

# Throwing away your used test kit



Put all the used parts from your test kit into the plastic bag.

Put the bag into your rubbish bin.

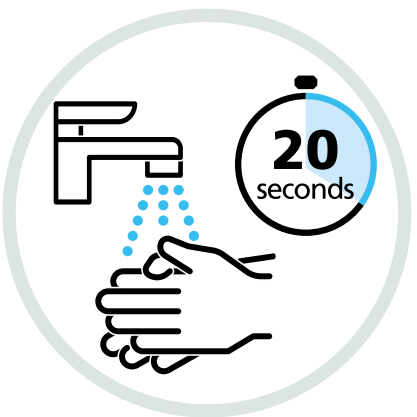

Wash your hands with soap and water or use hand sanitiser.

**You have now finished taking your test.**



For more information about COVID-19 go to:

[gov.uk/covid19-self-test-help](https://gov.uk/covid19-self-test-help)



















These instructions relate to Getein Biotech One Step Test for Sars-Cov-2 Antigen (Colloidal Gold) CG206157.

This guide explains how to test yourself or another person for COVID-19, and report the results to the NHS.

### Give feedback about your test or report harm

If you are harmed by a device or have feedback about your test kit, reporting it could help others. Go to: [gov.uk/covid-19-test-feedback](https://www.gov.uk/covid-19-test-feedback).

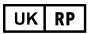
### Symbols used

	Store within 4°C – 30°C		Sterilized using ethylene oxide		Manufacturer
	Lot number		Use-by date		In vitro diagnostic medical device
	Keep away from sunlight		Date of manufacture		Do not re-use
	Keep dry		Consult instructions for use		Caution
	Contains sufficient for 7 tests		Do not use if package is damaged		Recyclable
	CE mark		UK responsible person		Authorized representative in the European Community

 Getein Biotech  
 Add: No.9 Bofu Road, Luhe District, Nanjing, 211505, China  
 Tel: +86-25-68568508 E-mail: tech@getein.com.cn Website: www.getein.com



 CMC Medical Devices & Drugs S.L  
 Add: C/ Horacio Lengo Nº 18,  
 CP 29006, Málaga, Spain  
 Tel: +34951214054

 CMC Medical Devices Ltd.  
 Add: Office 32 19-21 Crawford Street,  
 London, United Kingdom  
 Email: info@cmcmedicaldevices.com

 EC Certificate No. 1434-IVDD-447/2021

#### Swab manufacturer

 **Jiangsu Hanheng Medical Technology Co.,Ltd**  
 16-B4,#1 North Qingyang Road, Tianning District, 213017, Changzhou, Jiangsu, China

or

 **Jiangsu Changfeng Medical Industry Co., Ltd.**  
 Touqiao Town, Guangling District Yangzhou 225109 Jiangsu P.R. China

   
 Llins Service & Consulting GmbH  
 Obere Seegasse 34/2,69124 Heidelberg Germany

   
 Luxus Lebenswelt GmbH  
 Kochstr.1, 47877, Willich, Germany

Created Jan 2024 to support Getein Biotech guidance of Nov 2023

All of the information and images in this document are correct as of 5/1/2024.  
 This instruction booklet only refers to Getein Biotech product code: CG206157

TC2669 EASY READ