

1:200

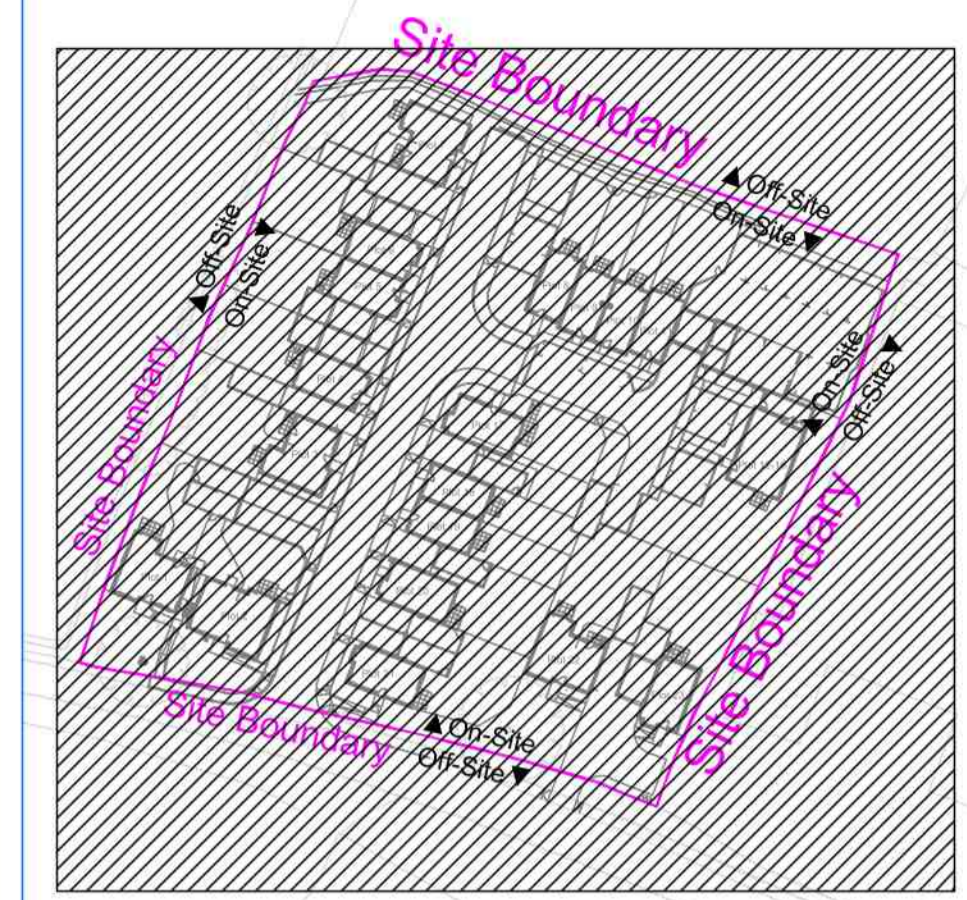

Key Plan



Hatched Zone Represents Area Covered by this Drawing

Site Address: Stickling Green Road, Clavering, Saffron Walden CB11 4WA

1	Mains cable and additional jointing information added	30/03/16	CH
REV	AMENDMENT	DATE	BY
 The Utility Connection Company			
Client: Weston Homes Project: Stickling Green Road Title: ESP As Laid Plan			
Planning Engineer: Teodorico Izzi Contact No: 08452 577 105		Project Manager: Brad Hogan Contact No: 07814 516 036	
Drawn By: CH Checked By: MG Date: 23.03.15	Scale: As Shown Sheet No: 1/1 Original Size: A1		
Drawing No: UKP3004 - DWG901			Rev: 1
Drawing Status: For Information Only			

ESP As Laid Plan