

Permit with introductory note

The Environmental Permitting (England & Wales) Regulations 2016

Centrica Business Solutions UK Limited

Pincroft CHP
Pincroft Dyeing and Printing Co Limited,
Market Street,
Adlington,
Chorley,
PR7 4HU

Permit number

EPR/RP3842YJ

Pincroft CHP

Permit number EPR/RP3842YJ

Introductory note

This introductory note does not form a part of the permit

The main features of the permit are as follows.

This permit enables the operation of a 3.05 MWth input Combined Heat and Power (CHP) plant used to supply electrical power and heat in the form of low temperature hot water and steam to the Pincroft Dyeing & Printing Co Ltd site. The CHP plant is operated by Centrica Business Solutions UK Limited as a directly associated activity to the Schedule 1 Section 6.4 Part A(1) (b) activity carried out on the Pincroft site under permit EPR/BL8651IX. The CHP plant is a Medium Combustion Plant under the Medium Combustion Plant Directive 2015 and is powered by natural gas.

The site on which the CHP is located is in Adlington near Chorley. The national grid reference is SD 6032812690. The site is immediately surrounded by industrial units and warehouses to the north-east, with residential properties situated to the south-west. There are 6 local wildlife sites and one ancient woodland within the 2km screening distance. The site is also located within Flood Zone 3.

Point source emissions from the operation of the plant mainly concern releases of nitrogen oxides (NOx) and carbon monoxide (CO) to air. The cogeneration, CHP plant, utilises lean burn technology to minimise air emissions. In addition, heat recovery systems power the unfired waste heat boiler producing steam and enable the production of low temperature hot water. Uncontaminated surface water and small quantities of boiler blowdown are transferred off-site to the Pincroft Dyeing and Printing Co Ltd site where they are treated in the effluent treatment plant before release to sewer under a trade effluent discharge consent.

Lubricating oil required for the operation of the CHP is contained within a sealed storage tank with an integral bund designed to hold 110% of the tank capacity. Waste oil is stored within a similarly banded tank and sent off site for further recovery. Management of the site is carried out under a certified environmental management system.

The status log of the permit sets out the permitting history, including any changes to the permit reference number.

Status log of the permit		
Description	Date	Comments
Application EPR/RP3842YJ/A001	Duly made 05/12/2022	Application for combined heat and power plant
Additional information received	05/07/2023	Schedule 5 response including revised air dispersion modelling, drainage and site plans.
Permit determined EPR/RP3842YJ	18/09/2023	Permit issued to Centrica Business Solutions UK Limited.

Other Part A installation permits relating to this installation		
Operator	Permit number	Date of issue
Pincroft Dyeing and Printing Co. Ltd.	EPR/BL8651IX	14/03/2014

End of introductory note

Permit

The Environmental Permitting (England and Wales) Regulations 2016

Permit number

EPR/RP3842YJ

The Environment Agency hereby authorises, under regulation 13 of the Environmental Permitting (England and Wales) Regulations 2016

Centrica Business Solutions UK Limited (“the operator”),

whose registered office is

**Millstream,
Maidenhead Road,
Windsor,
Berkshire,
SL4 5GD**

company registration number 01874716

to operate part of an installation at

**Pincroft CHP
Pincroft Dyeing and Printing Co Limited,
Market Street,
Adlington,
Chorley,
PR7 4HU**

to the extent authorised by and subject to the conditions of this permit.

Name	Date
Peter Maksymiw	18/09/2023

Authorised on behalf of the Environment Agency

Conditions

1 Management

1.1 General management

1.1.1 The operator shall manage and operate the activities:

- (a) in accordance with a written management system that identifies and minimises risks of pollution, including those arising from operations, maintenance, accidents, incidents, non-conformances, closure and those drawn to the attention of the operator as a result of complaints; and
- (b) using sufficient competent persons and resources.

1.1.2 Records demonstrating compliance with condition 1.1.1 shall be maintained.

1.1.3 Any person having duties that are or may be affected by the matters set out in this permit shall have convenient access to a copy of it kept at or near the place where those duties are carried out.

1.2 Energy efficiency

1.2.1 The operator shall:

- (a) take appropriate measures to ensure that energy is used efficiently in the activities;
- (b) review and record at least every four years whether there are suitable opportunities to improve the energy efficiency of the activities; and
- (c) take any further appropriate measures identified by a review.

1.3 Efficient use of raw materials

1.3.1 The operator shall:

- (a) take appropriate measures to ensure that raw materials and water are used efficiently in the activities;
- (b) maintain records of raw materials and water used in the activities;
- (c) review and record at least every four years whether there are suitable alternative materials that could reduce environmental impact or opportunities to improve the efficiency of raw material and water use; and
- (d) take any further appropriate measures identified by a review.

1.4 Avoidance, recovery and disposal of wastes produced by the activities

1.4.1 The operator shall take appropriate measures to ensure that:

- (a) the waste hierarchy referred to in Article 4 of the Waste Framework Directive is applied to the generation of waste by the activities; and
- (b) any waste generated by the activities is treated in accordance with the waste hierarchy referred to in Article 4 of the Waste Framework Directive; and
- (c) where disposal is necessary, this is undertaken in a manner which minimises its impact on the environment.

- 1.4.2 The operator shall review and record at least every four years whether changes to those measures should be made and take any further appropriate measures identified by a review.

1.5 Multiple operator installations

- 1.5.1 Where the operator notifies the Environment Agency under condition 4.3.1 (a) or 4.3.1 (c), the operator shall also notify without delay the other operator(s) of the installation of the same information.

2 Operations

2.1 Permitted activities

- 2.1.1 The operator is only authorised to carry out the activities specified in schedule 1 table S1.1 (the “activities”).

2.2 The site

- 2.2.1 The activities shall not extend beyond the site, being the land shown edged in red on the site plan at schedule 7 to this permit, which is within the area edged in blue on the site plan that represents the extent of the installation covered by this permit and that of the other operator of the installation.

2.3 Operating techniques

- 2.3.1 The activities shall, subject to the conditions of this permit, be operated using the techniques and in the manner described in the documentation specified in schedule 1, table S1.2, unless otherwise agreed in writing by the Environment Agency.
- 2.3.2 If notified by the Environment Agency that the activities are giving rise to pollution, the operator shall submit to the Environment Agency for approval within the period specified, a revision of any plan or other documentation (“plan”) specified in schedule 1, table S1.2 or otherwise required under this permit which identifies and minimises the risks of pollution relevant to that plan, and shall implement the approved revised plan in place of the original from the date of approval, unless otherwise agreed in writing by the Environment Agency.
- 2.3.3 Any raw materials or fuels listed in schedule 2 table S2.1 shall conform to the specifications set out in that table.

3 Emissions and monitoring

3.1 Emissions to water, air or land

- 3.1.1 There shall be no point source emissions to water, air or land except from the sources and emission points listed in schedule 3 tables S3.1 and S3.2.
- 3.1.2 The limits given in schedule 3 shall not be exceeded.
- 3.1.3 Periodic monitoring shall be carried out at least once every 5 years for groundwater and 10 years for soil, unless such monitoring is based on a systematic appraisal of the risk of contamination.
- 3.1.4 The first monitoring measurements shall be carried out within four months of the issue date of the permit or of the date when the MCP is first put into operation, whichever is later.

3.2 Emissions of substances not controlled by emission limits

3.2.1 Emissions of substances not controlled by emission limits (excluding odour) shall not cause pollution. The operator shall not be taken to have breached this condition if appropriate measures, including, but not limited to, those specified in any approved emissions management plan, have been taken to prevent or where that is not practicable, to minimise, those emissions.

3.2.2 The operator shall:

- (a) if notified by the Environment Agency that the activities are giving rise to pollution, submit to the Environment Agency for approval within the period specified, an emissions management plan which identifies and minimises the risks of pollution from emissions of substances not controlled by emission limits;
- (b) implement the approved emissions management plan, from the date of approval, unless otherwise agreed in writing by the Environment Agency.

3.2.3 All liquids in containers, whose emission to water or land could cause pollution, shall be provided with secondary containment, unless the operator has used other appropriate measures to prevent or where that is not practicable, to minimise, leakage and spillage from the primary container.

3.3 Odour

3.3.1 Emissions from the activities shall be free from odour at levels likely to cause pollution outside the site, as perceived by an authorised officer of the Environment Agency, unless the operator has used appropriate measures, including, but not limited to, those specified in any approved odour management plan, to prevent or where that is not practicable to minimise the odour.

3.3.2 The operator shall:

- (a) if notified by the Environment Agency that the activities are giving rise to pollution outside the site due to odour, submit to the Environment Agency for approval within the period specified, an odour management plan which identifies and minimises the risks of pollution from odour;
- (b) implement the approved odour management plan, from the date of approval, unless otherwise agreed in writing by the Environment Agency.

3.4 Noise and vibration

3.4.1 Emissions from the activities shall be free from noise and vibration at levels likely to cause pollution outside the site, as perceived by an authorised officer of the Environment Agency, unless the operator has used appropriate measures, including, but not limited to, those specified in any approved noise and vibration management plan to prevent or where that is not practicable to minimise the noise and vibration.

3.4.2 The operator shall:

- (a) if notified by the Environment Agency that the activities are giving rise to pollution outside the site due to noise and vibration, submit to the Environment Agency for approval within the period specified, a noise and vibration management plan which identifies and minimises the risks of pollution from noise and vibration;
- (b) implement the approved noise and vibration management plan, from the date of approval, unless otherwise agreed in writing by the Environment Agency

3.5 Monitoring

- 3.5.1 The operator shall, unless otherwise agreed in writing by the Environment Agency, undertake the monitoring specified in the following tables in schedule 3 to this permit:
- (a) point source emissions specified in tables S3.1 and S3.2.
- 3.5.2 The operator shall maintain records of all monitoring required by this permit including records of the taking and analysis of samples, instrument measurements (periodic and continual), calibrations, examinations, tests and surveys and any assessment or evaluation made on the basis of such data.

4 Information

4.1 Records

- 4.1.1 All records required to be made by this permit shall:
- (a) be legible;
 - (b) be made as soon as reasonably practicable;
 - (c) if amended, be amended in such a way that the original and any subsequent amendments remain legible, or are capable of retrieval; and
 - (d) be retained, unless otherwise agreed in writing by the Environment Agency, for at least 6 years from the date when the records were made, or in the case of the following records until permit surrender:
 - (i) off-site environmental effects; and
 - (ii) matters which affect the condition of the land and groundwater.
- 4.1.2 The operator shall keep on site all records, plans and the management system required to be maintained by this permit, unless otherwise agreed in writing by the Environment Agency.

4.2 Reporting

- 4.2.1 The operator shall send all reports and notifications required by the permit to the Environment Agency using the contact details supplied in writing by the Environment Agency.
- 4.2.2 A report or reports on the performance of the activities over the previous year shall be submitted to the Environment Agency by 31 January (or other date agreed in writing by the Environment Agency) each year. The report(s) shall include as a minimum:
- (a) a review of the results of the monitoring and assessment carried out in accordance with the permit including an interpretive review of that data;
 - (b) the annual production/treatment data set out in schedule 4 table S4.2; and
 - (c) the performance parameters set out in schedule 4 table S4.3 using the forms specified in table S4.4 of that schedule.

- 4.2.3 Within 28 days of the end of the reporting period the operator shall, unless otherwise agreed in writing by the Environment Agency, submit reports of the monitoring and assessment carried out in accordance with the conditions of this permit, as follows:
- (a) in respect of the parameters and emission points specified in schedule 4 table S4.1;
 - (b) for the reporting periods specified in schedule 4 table S4.1 and using the forms specified in schedule 4 table S4.4; and
 - (c) giving the information from such results and assessments as may be required by the forms specified in those tables.
- 4.2.4 The operator shall, unless notice under this condition has been served within the preceding four years, submit to the Environment Agency, within six months of receipt of a written notice, a report assessing whether there are other appropriate measures that could be taken to prevent, or where that is not practicable, to minimise pollution.

4.3 Notifications

- 4.3.1 In the event:
- (a) that the operation of the activities gives rise to an incident or accident which significantly affects or may significantly affect the environment, the operator must immediately—
 - (i) inform the Environment Agency,
 - (ii) take the measures necessary to limit the environmental consequences of such an incident or accident, and
 - (iii) take the measures necessary to prevent further possible incidents or accidents;
 - (b) of a breach of any permit condition the operator must immediately—
 - (i) inform the Environment Agency, and
 - (ii) take the measures necessary to ensure that compliance is restored within the shortest possible time;
 - (c) of a breach of permit condition which poses an immediate danger to human health or threatens to cause an immediate significant adverse effect on the environment, the operator must immediately suspend the operation of the activities or the relevant part of it until compliance with the permit conditions has been restored.
- 4.3.2 Any information provided under condition 4.3.1 shall be confirmed by sending the information listed in schedule 5 to this permit within the time period specified in that schedule.
- 4.3.3 Where the Environment Agency has requested in writing that it shall be notified when the operator is to undertake monitoring and/or spot sampling, the operator shall inform the Environment Agency when the relevant monitoring and/or spot sampling is to take place. The operator shall provide this information to the Environment Agency at least 14 days before the date the monitoring is to be undertaken.
- 4.3.4 The Environment Agency shall be notified within 14 days of the occurrence of the following matters, except where such disclosure is prohibited by Stock Exchange rules:
- Where the operator is a registered company:
- (a) any change in the operator's trading name, registered name or registered office address; and
 - (b) any steps taken with a view to the operator going into administration, entering into a company voluntary arrangement or being wound up

Where the operator is a corporate body other than a registered company:

- (a) any change in the operator's name or address; and
- (b) any steps taken with a view to the dissolution of the operator.

In any other case:

- (a) the death of any of the named operators (where the operator consists of more than one named individual);
- (b) any change in the operator's name(s) or address(es); and
any steps taken with a view to the operator, or any one of them, going into bankruptcy, entering into a composition or arrangement with creditors, or, in the case of them being in a partnership, dissolving the partnership.

4.3.5 Where the operator proposes to make a change in the nature or functioning, or an extension of the activities, which may have consequences for the environment and the change is not otherwise the subject of an application for approval under the Regulations or this permit:

- (a) the Environment Agency shall be notified at least 14 days before making the change; and
- (b) the notification shall contain a description of the proposed change in operation.

4.3.6 The Environment Agency shall be given at least 14 days' notice before implementation of any part of the site closure plan.

4.4 Interpretation

4.4.1 In this permit the expressions listed in schedule 6 shall have the meaning given in that schedule.

4.4.2 In this permit references to reports and notifications mean written reports and notifications, except where reference is made to notification being made "without delay", in which case it may be provided by telephone.

Schedule 1 – Operations

Table S1.1 activities			
Activity reference	Activity listed in Schedule 1 of the EP Regulations	Description of specified activity	Limits of specified activity
Directly Associated Activity			
AR1	-	Schedule 25A – Medium Combustion Plant Operation of plant to provide both heat in the form of steam and power.	1 X 3.05 MWth Combined Heat and Power Plant (CHP) fuelled by natural gas. Includes storage and use of lubricants as required for the maintenance and routine operation of the CHP.

Table S1.2 Operating techniques		
Description	Parts	Date Received
Application	Sections 2, 3, 4.8 and 6 of the application document titled ' <i>Application for an Environmental Permit...</i> ' (05/12/2022) detailing site management, management of operations, monitoring, and compliance with technical standards.	Duly Made 19/12/2022
Response to Schedule 5 Notice dated 21/04/2023	Drainage plans ' <i>CHP drainage</i> ' (18/02/2020) and ' <i>Environment ACAD 2000-Pincroft sheet(2)</i> ' (05/07/2023).	05/07/2023

Schedule 2 – Waste types, raw materials and fuels

Table S2.1 Raw materials and fuels	
Raw materials and fuel description	Specification
--	--

Schedule 3 – Emissions and monitoring

Table S3.1 Point source emissions to air – emission limits and monitoring requirements						
Emission point ref. & location	Source	Parameter	Limit (including unit)	Reference period	Monitoring frequency	Monitoring standard or method
A1 [Point A1 on site plan in Schedule 7]	CHP plant	Oxides of Nitrogen (NO and NO ₂ expressed as NO ₂)	95 mg/m ³	In line with web guide: Monitoring stack emissions: low risk MCPs and specified generators Published 16 February 2021	Every 3 years from date of acceptance of first monitoring measurements under condition 3.1.4	In line with web guide: Monitoring stack emissions: low risk MCPs and specified generators Published 16 February 2021
		Carbon Monoxide	No limit set	In line with web guide: Monitoring stack emissions: low risk MCPs and specified generators Published 16 February 2021	Every 3 years from date of acceptance of first monitoring measurements under condition 3.1.4	In line with web guide: Monitoring stack emissions: low risk MCPs and specified generators Published 16 February 2021

Table S3.2 Point source emissions to sewer, effluent treatment plant or other transfers off-site– emission limits and monitoring requirements						
Emission point ref. & location	Source	Parameter	Limit (incl. Unit)	Reference period	Monitoring frequency	Monitoring standard or method
S1 emission to United Utilities Water plc via effluent drains and effluent treatment plant on the Pincroft Dyeing and Printing Co Ltd site (EPR/BL8651IX)	Uncontaminated surface water and boiler blowdown	--	--	--	--	--

Schedule 4 – Reporting

Parameters, for which reports shall be made, in accordance with conditions of this permit, are listed below.

Table S4.1 Reporting of monitoring data			
Parameter	Emission or monitoring point/reference	Reporting period	Period begins
Emissions to air Parameters as required by condition 3.5.1.	A1	Every 3 years	1 January

Table S4.2 Performance parameters		
Parameter	Frequency of assessment	Units
Water usage	Annually	m ³

Table S4.3 Reporting forms		
Parameter	Reporting form	Form version number and date
Point source emissions to air	Emissions to Air Reporting Form, or other form as agreed in writing by the Environment Agency	Version 1, 08/03/2021
Water usage	Water Usage Reporting Form, or other form as agreed in writing by the Environment Agency	Version 1, 08/03/2021

Schedule 5 – Notification

These pages outline the information that the operator must provide.

Units of measurement used in information supplied under Part A and B requirements shall be appropriate to the circumstances of the emission. Where appropriate, a comparison should be made of actual emissions and authorised emission limits.

If any information is considered commercially confidential, it should be separated from non-confidential information, supplied on a separate sheet and accompanied by an application for commercial confidentiality under the provisions of the EP Regulations.

Part A

Permit Number	
Name of operator	
Location of Facility	
Time and date of the detection	

(a) Notification requirements for any malfunction, breakdown or failure of equipment or techniques, accident, or emission of a substance not controlled by an emission limit which has caused, is causing or may cause significant pollution	
To be notified within 24 hours of detection	
Date and time of the event	
Reference or description of the location of the event	
Description of where any release into the environment took place	
Substances(s) potentially released	
Best estimate of the quantity or rate of release of substances	
Measures taken, or intended to be taken, to stop any emission	
Description of the failure or accident.	

(b) Notification requirements for the breach of a limit	
To be notified within 24 hours of detection unless otherwise specified below	
Emission point reference/ source	
Parameter(s)	
Limit	
Measured value and uncertainty	
Date and time of monitoring	

(b) Notification requirements for the breach of a limit	
To be notified within 24 hours of detection unless otherwise specified below	
Measures taken, or intended to be taken, to stop the emission	

Time periods for notification following detection of a breach of a limit	
Parameter	Notification period

(c) Notification requirements for the breach of permit conditions not related to limits	
To be notified within 24 hours of detection	
Condition breached	
Date, time and duration of breach	
Details of the permit breach i.e. what happened including impacts observed.	
Measures taken, or intended to be taken, to restore permit compliance.	

(d) Notification requirements for the detection of any significant adverse environmental effect	
To be notified within 24 hours of detection	
Description of where the effect on the environment was detected	
Substances(s) detected	
Concentrations of substances detected	
Date of monitoring/sampling	

Part B – to be submitted as soon as practicable

Any more accurate information on the matters for notification under Part A.	
Measures taken, or intended to be taken, to prevent a recurrence of the incident	

Measures taken, or intended to be taken, to rectify, limit or prevent any pollution of the environment which has been or may be caused by the emission	
The dates of any unauthorised emissions from the facility in the preceding 24 months.	

Name*	
Post	
Signature	
Date	

* authorised to sign on behalf of the operator

Schedule 6 – Interpretation

“accident” means an accident that may result in pollution.

“application” means the application for this permit, together with any additional information supplied by the operator as part of the application and any response to a notice served under Schedule 5 to the EP Regulations.

“authorised officer” means any person authorised by the Environment Agency under section 108(1) of The Environment Act 1995 to exercise, in accordance with the terms of any such authorisation, any power specified in section 108(4) of that Act.

“background concentration” means such concentration of that substance as is present in:

- for emissions to surface water, the surface water quality up-gradient of the site; or
- for emissions to sewer, the surface water quality up-gradient of the sewage treatment works discharge.

“emissions to land” includes emissions to groundwater.

“EP Regulations” means The Environmental Permitting (England and Wales) Regulations SI 2016 No.1154 and words and expressions used in this permit which are also used in the Regulations have the same meanings as in those Regulations.

“emissions of substances not controlled by emission limits” means emissions of substances to air, water or land from the activities, either from the emission points specified in schedule 3 or from other localised or diffuse sources, which are not controlled by an emission or background concentration limit.

“groundwater” means all water, which is below the surface of the ground in the saturation zone and in direct contact with the ground or subsoil.

“Industrial Emissions Directive” means DIRECTIVE 2010/75/EU OF THE EUROPEAN PARLIAMENT AND OF THE COUNCIL of 24 November 2010 on industrial emissions, as read in accordance with Schedule 1A to the Environmental Permitting (England and Wales) Regulations 2016.

“MCERTS” means the Environment Agency’s Monitoring Certification Scheme.

“Medium Combustion Plant” or “MCP” means a combustion plant with a rated thermal input equal to or greater than 1 MW but less than 50 MW.

“Medium Combustion Plant Directive” or “MCPD” means Directive 2015/2193/EU of the European Parliament and of the Council on the limitation of emissions of certain pollutants into the air from medium combustion plants, as read in accordance with Schedule 1A to the Environmental Permitting (England and Wales) Regulations 2016.

Where a minimum limit is set for any emission parameter, for example pH, reference to exceeding the limit shall mean that the parameter shall not be less than that limit.

Unless otherwise stated, any references in this permit to concentrations of substances in emissions into air means:

- in relation to emissions from combustion processes, the concentration in dry air at a temperature of 273K, at a pressure of 101.3 kPa and with an oxygen content of 3% dry for liquid and gaseous fuels other than gas engines or gas turbines, 6% dry for solid fuels; and/or
- in relation to emissions from gas engines or gas turbines, the concentration in dry air at a temperature of 273K, at a pressure of 101.3 kPa and with an oxygen content of 15% dry for liquid and gaseous fuels ; and/or

in relation to emissions from non-combustion sources, the concentration at a temperature of 273K and at a pressure of 101.3 kPa, with no correction for water vapour content “year” means calendar year ending 31 December.

Schedule 7 – Site plan

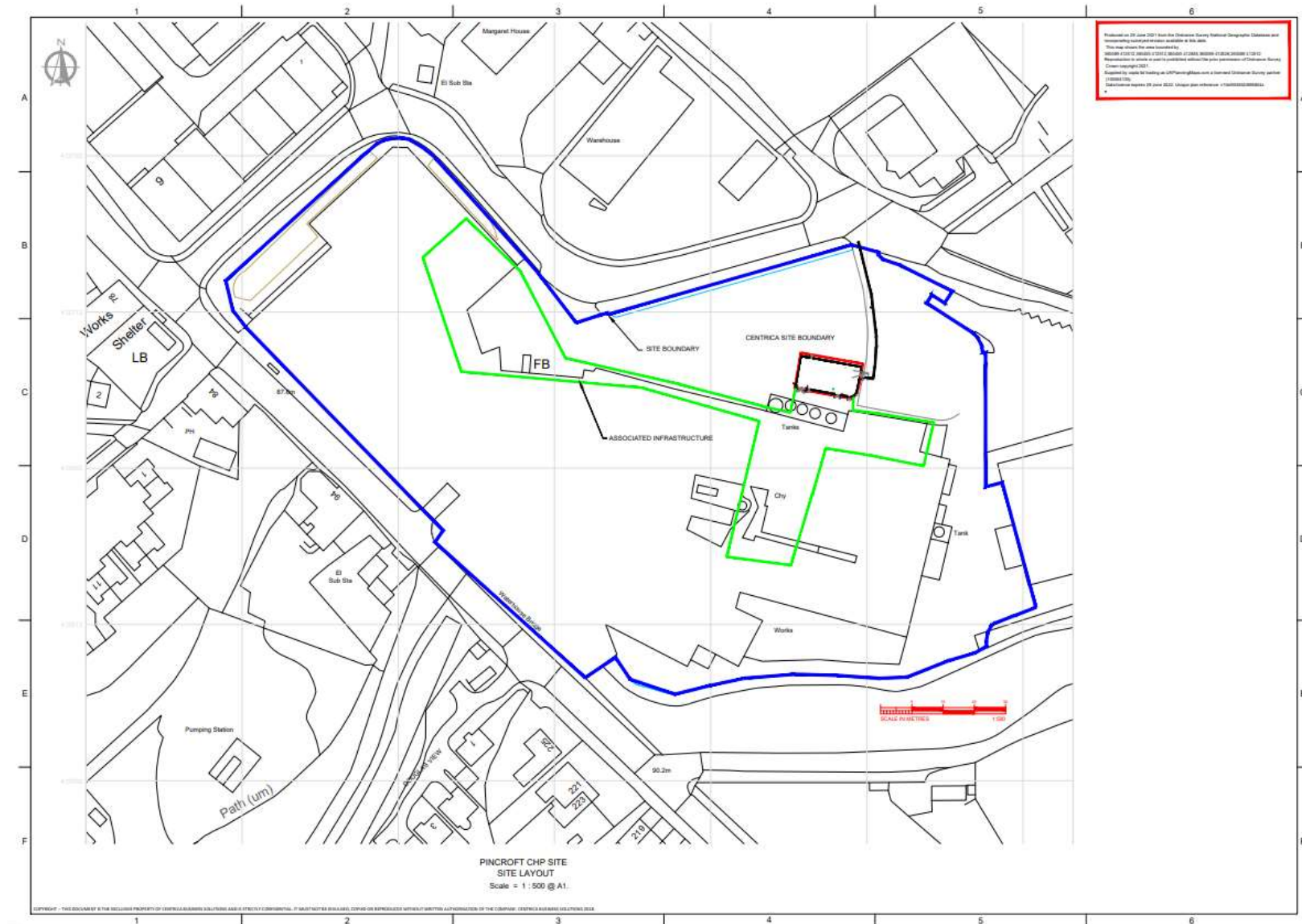

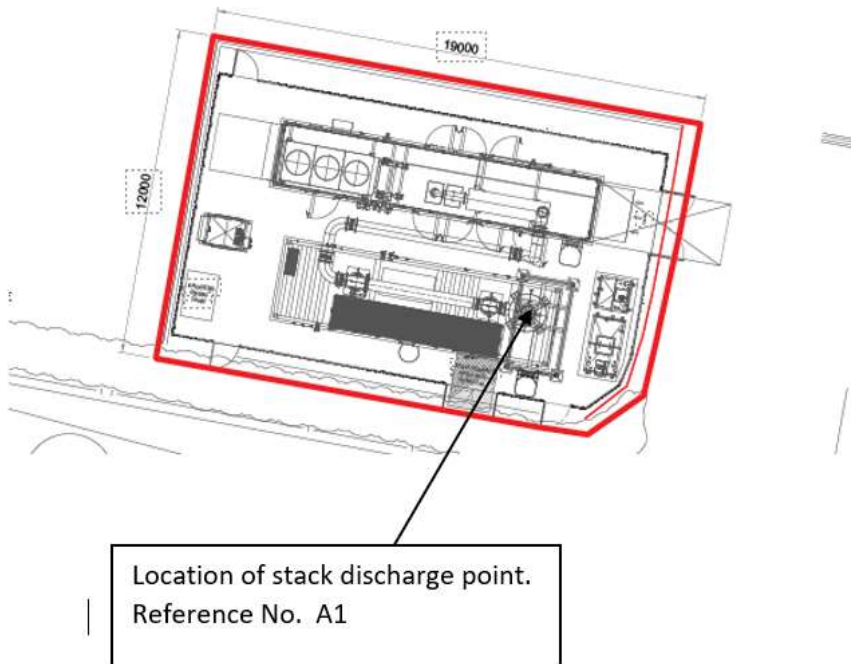

“©Crown Copyright. All rights reserved. Environment Agency, 100024198, 2023.”

END OF PERMIT

Reporting Forms

Emissions to Air Reporting Form

Permit number: *[EPR/AB1234CB]*

Operator: *[A Company Name Limited]*

Facility name: *[Unit A, Anytown]*

Emissions to Air Reporting Form: version 1, 08/03/2021

Reporting of emissions to air for the period from *[DD/MM/YY]* to *[DD/MM/YY]*

Emission point	Substance / parameter	Emission Limit Value	Reference period	Test method ¹	Result ²	Sample dates and times ³	Uncertainty ⁴
<i>[e.g. A1]</i>	<i>[e.g. Oxides of nitrogen (NO and NO₂ expressed as NO₂)]</i>	<i>[e.g. 200 mg/m³]</i>	<i>[e.g. daily average]</i>	<i>[e.g. BS EN 14181]</i>	<i>[State result]</i>	<i>[State relevant dates and time periods]</i>	<i>[State uncertainty if not 95% confidence interval]</i>

Signed: *[Name]*

Date: *[DD/MM/YY]*

(Authorised to sign as representative of the operator)

Guidance for use: Use this form to report your monitoring results.

Example text is shown in bracketed grey italics. Replace the example text by entering your own site specific information. Complete columns 1 to 5 using the information from schedule 3 of your permit. Complete columns 6 to 8 with your monitoring data. Add additional rows as necessary.

- ¹ Where an internationally recognised standard test method is used, give the reference number. Where another method that has been formally agreed with the Environment Agency, give the appropriate identifier. In other cases state the principal technique, for example gas chromatography.
- ² Give the result as the maximum value (or the minimum value in the case of a limit that is expressed as a minimum) obtained during the reporting period, expressed in the same terms as the emission limit value. Where the emission limit value is expressed as a range, give the result as the 'minimum to maximum' of the measured values.
- ³ For non-continuous measurements give the date and time of the sample that produced the result. For continuous measurements give the percentage of the process operating time covered by the result.
- ⁴ Complete if the uncertainty associated with the result is not a 95% confidence interval. Leave blank for 95% confidence intervals.

Water Usage Reporting Form

Permit number: [EPR/AB1234CB]

Operator: [A Company Name Limited]

Facility name: [Unit A, Anytown]

Water Usage Reporting Form: version 1, 08/03/2021

Reporting of water usage for the year [YYYY]

Water source	Water usage (m ³)	Specific water usage (m ³ /unit) ²
Mains water	<i>[insert annual usage in m³ where mains water is used]</i>	<i>[insert annual usage in m³/unit where mains water is used]</i>
Site borehole	<i>[insert annual usage in m³ where water is used from a site borehole]</i>	<i>[insert annual usage in m³/unit where water is used from a site borehole]</i>
River abstraction	<i>[insert annual usage in m³ where abstracted river water is used]</i>	<i>[insert annual usage in m³/unit where abstracted river water is used]</i>
Other – <i>[specify other water source where applicable. Add extra rows where needed]</i>	<i>[insert annual usage in m³ where applicable]</i>	<i>[insert annual usage in m³/unit where applicable]</i>
Total water usage	<i>[insert total annual water usage in m³]</i>	<i>[insert total annual water usage in m³/unit]</i>

Operator's comments

Signed: *[Name]*

Date: *[DD/MM/YY]*

(Authorised to sign as representative of the operator)

Guidance for use: Use this form to report your annual water usage.

Example text is shown in bracketed grey italics. Replace the example text by entering your own site specific information. Add additional rows as necessary.