

Plan
Scale 1:5,000 @ A1

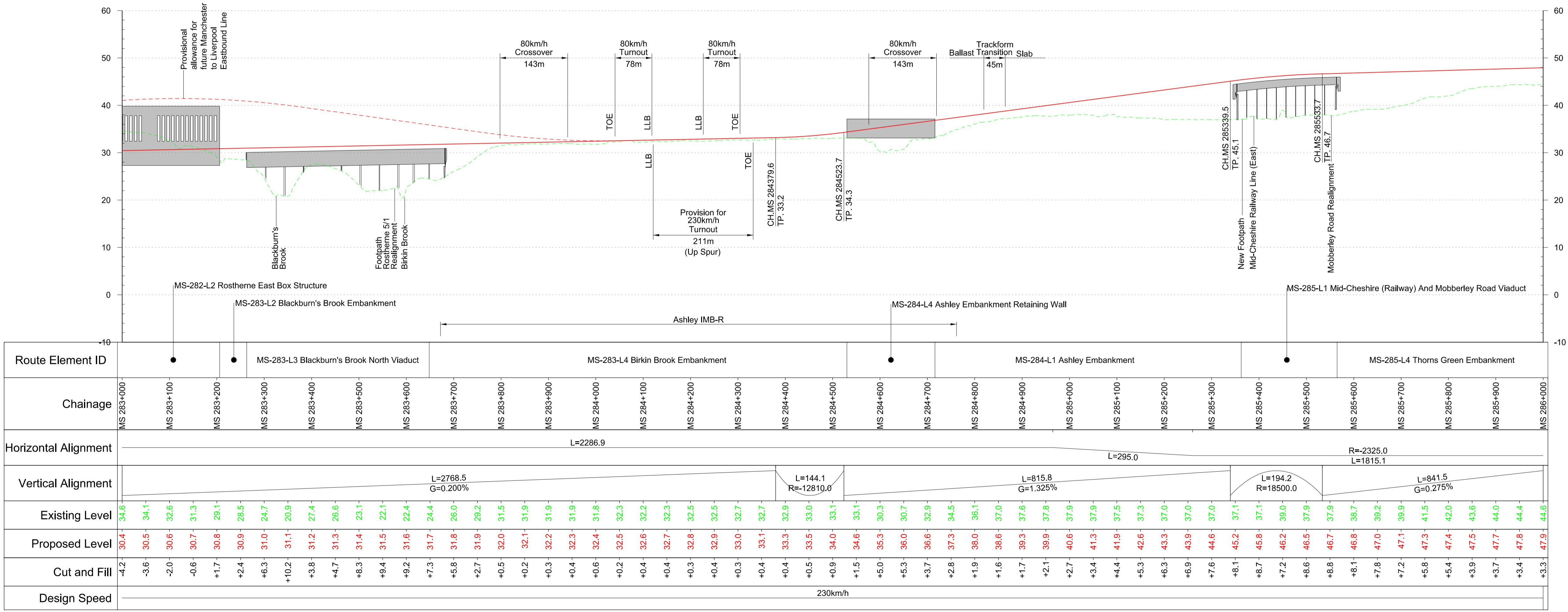

Profile
Scale H:1:5,000 V:1:500 @ A1

Fit for Acceptance

This document is issued for the party which commissioned it and for specific purposes connected with the captioned project only. It should not be relied upon by any other party or used for any other purpose. We accept no responsibility for the consequences of this document being relied upon by any other party, or being used for any other purpose, or containing any error or omission which is due to an error or omission in data supplied to us by other parties.

Rev	Description	Drawn	Checked	Con App	HS2 App
P02	AP2 Second Issue	MWI	TSH	GHU	
		18/01/2023	18/12/2023	18/12/2023	
P01	AP2 First Issue	MWI	TSH	GHU	
		23/09/2022	23/09/2022	23/09/2022	

HS2 accepts no responsibility for any circumstances which arise from the reproduction of this document after alteration, amendment or abbreviation or if it is issued in part or issued incompletely in any way.

© Crown Copyright and database right 2022. All rights reserved. Ordnance Survey Licence number 100049190

© Crown Copyright material is reproduced with the permission of Land Registry under delegated authority from the Controller of HMSO.

This material was last updated on 2022 and may not be copied, distributed, sold or published without the formal permission of Land Registry. Only an official copy of a title plan or register obtained from the Land Registry may be used for legal or other official purposes.

Scale with caution as distortion can occur.

Legends/Notes:

- Depot, station, headhouse, shaft or portal building
- Tunnel portal
- Railway system site
- Ecological mitigation pond
- Balancing pond
- Pumping station
- Replacement floodplain storage area
- Woodland habitat creation
- Wetland habitat creation
- Grassland habitat creation
- Landscape mitigation planting (scrub / woodland)
- Balancing pond
- Local places
- Public realm
- Engineering earthworks
- Landscape earthworks
- Rail alignment formation
- Returned to suitable development use
- County boundary
- Borough / District boundary
- Major contour
- Community area boundary
- Existing watercourse
- Watercourse diversions
- New Ditches
- Hedgehog
- Major utility works
- Noise fence barrier
- Car Park
- Existing public right of way
- New, diverted or realigned public right of way
- Public right of way closure
- Tunnels external extent
- HS2 access
- Realigned highway
- Light Rail Transit
- Rail alignment

HS2

Registered in England
Registration No. 06791686
Registered office:
2 Snow Hill, Queensway,
Birmingham, B4 6GA

Creator/Originator
MW JV (Mott MacDonald and WSP Joint Venture)

Zone
M3 Wide – Hulse Heath to Manchester

Design Stage
Hybrid Bill - Interim Preliminary Design AP2

Drawing Title
M3 Hulse Heath to Manchester Piccadilly Station
Plan & Profile Sheet 3 of 10
Chainage 283+000 to 286+000

Project/Contract
2DE01 Hybrid Bill Additional Provision 2 AP2

Discipline/Function
Civil

Drawn CCL	Checked TSH	Approved GHU
Date 21/09/2022	Scale AS SHOWN	Size A1
Drawing No. 2PT27-MWJ-CV-DPP-M003-320053	Rev. P02	