

- KEY**
- Site Boundary (14.07 Ha)
 - Location of existing drain to be retained (Position to be confirmed)
 - Location of affordable plot (tenure blind)

Moors Field, Little Dunmow
Testing Layout Schedule

House Type	Code	Dwelling Type	Square Footage	No. Units	No. Storeys	Total Spft	Mix %
OPEN MARKET							
2 BED HOUSES	16	1B2P					22
1BB	1BB	1B2P	645	2	1	1290	2.1
2BB	2BB	2B2P	797	3	1	2391	3.1
VType	VYN	2B4P	757	3	2	12112	16.7
3 BED HOUSES	35	3B2P					36
Character	GIA	3B2P (Det)	949	12	2	11308	15.2
Program	FRD	3B2P (Det)	1000	7	2	7000	7.3
Goodness	GOD2	3B2P (Det - Corner)	1098	3	2	17426	18.7
4 BED HOUSES	34	4B2P					30
Perthurst	PEN	4B2P (Det - Corner)	1256	8	2	10048	8.3
Waltham (Detached)	WOB	4B2P (Det)	1240	18	2	19840	16.7
Goodwood	GOD	4B2P (Det)	1391	5	2	8955	5.2
Winstor	WIN	4B2P (Det)	1442	3	2	4258	3.1
Charwell - MA3	CHR	4B2P (Det)	1564	4	2	6256	4.2
5 BED HOUSES	0	5B2P (Det)					4
Kingston	KIN	5B2P (Det)	1787	4	2	7148	4.2
TOTAL				94	60%	104132	100.0
AFFORDABLE							
1 BED HOUSES	20	1B2P					31.3
1BF	1BF	1B2P	560	12	1	6720	15.8
2BF	2BF	2B4P	753	4	1	3012	6.3
1BB - MA3	1BB	1B2P	703	2	1	1406	3.1
2BB - MA3	2BB	2B2P	787	2	1	1574	3.1
2 BED HOUSES	18	2B4P					28.1
Hertford	HER	2B4P	858	18	2	15444	28.1
3 BED HOUSES	28	3B2P					34.4
Parham	PAR	3B2P	1010	22	2.5	22220	34.4
4 BED HOUSES	4	4B2P					6.3
Bethley	BLE	4B2P	1343	4	2.5	5372	6.3
AFFORDABLE TOTAL				64	60%	85748	100.0
GRAND TOTAL				140		189880	100
NET DEVELOPABLE AREA				4.73 Ha		11.80 Acres	
COVERAGE				13719 sq/ha			
DENSITY				34 DPH			

REV	DATE	DESCRIPTION	REVISED BY	APPROVED BY
G	13.07.23	Minor amendments to layout in line with consultant information	RW	AG
F	12.07.23	Updating mix/layout to local authority request (Replace 2x 1BB with 2x 2BB)	RW	AG
E	10.07.23	Minor amendments to developed layout & inclusion of engineers info	RW	AG
D	20.06.23	Minor tweaks to layout as client discussion and addition of schedule	RW	AG
C	20.06.23	Plot subbing to increase coverage	RW	AG
B	20.06.23	Amendments/updates to layout as discussed with client	RW	AG
A	08.05.23	Amendments/updates to layout as discussed with client	RW	AG

© Pegasus Planning Group Limited. © Crown copyright and database rights OS 100042093. Promap. Licence number 100020449. EmapSite Licence number 0100031673. Terms & Conditions @ pegasusgroup.co.uk

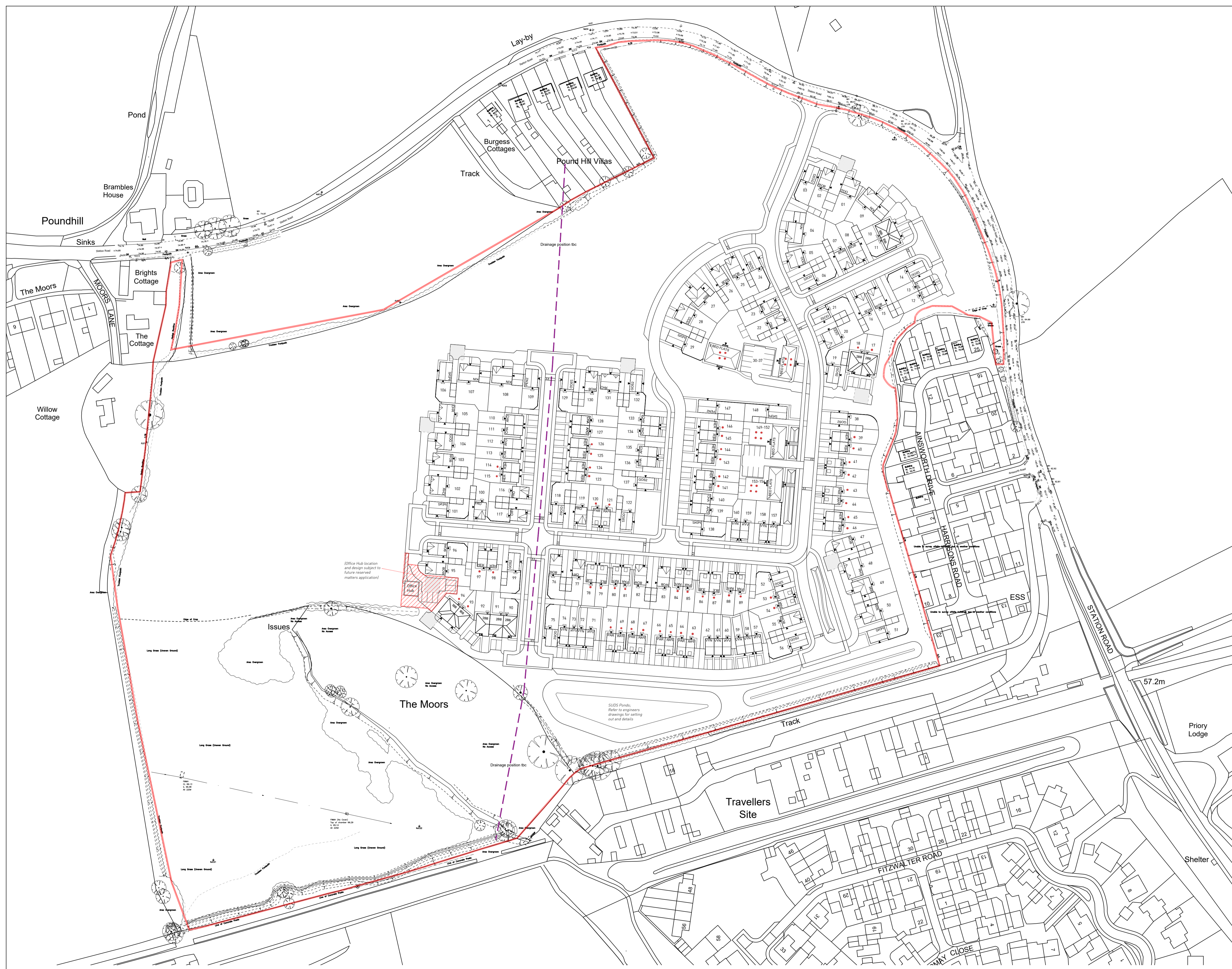

Moors Field, Little Dunmow - Technical Layout

