

Also see inset map 52 SE-B

## Register of

TOWN OR VILLAGE GREENS

Register unit No. VG 117

Edition No. 1

See Overleaf  
for Notes

LAND SECTION—Sheet No. 1

No. and date of entry	Description of the land, reference to the register map, registration particulars etc.
1 20th May 1968	<p>The pieces of land called Smith's Green and Bamber's Green, and the roadside verges connecting them in the Parish of Takeley Essex as marked with green verge lines inside the boundaries on sheet 52 SE of the register map and distinguished by the number of this register unit. Registered pursuant to application No. 255 made 4th May 1968, by Horace Wells Juniper, Lord of the Manor of Takeley or Takeley St. Wallerice, of Warish Hall, Takeley, Bishops Stortford, <del>Essex</del> Herts.</p> <p>(Registration provisional)</p>
2 22nd Jan 1971	<p>The registration at entry No. 1 above, being undisputed, became final on 1st October 1970</p>
3 25 <sup>th</sup> FEBRUARY 2015	<p>UNDER SECTION 19(1)(a) OF THE ACQUISITION OF LAND ACT 1981 PART OF THE LAND WAS DE-REGISTERED, AS SHOWN ON INSET MAP 52 SE-B, AND SUBSTITUTED FOR LAND REGISTERED UNDER VG 259. THE S. 19(1)(a) CERTIFICATE REFERENCE IS DOE 0881. A COPY OF THE CERTIFICATE IS SAVED TO CAVG/100.</p>

No. and date of note	Notes	No. and date of note	Notes
<p>1 21st September 1977.</p>	<p>William Richard and Penelope Anne Dudgeon the owners and occupiers of "Old Thatch" Bambers Green Tabeley and their successors in title claim a right of way with or without vehicles or animals from "Old Thatch" aforesaid over the land comprised in this register unit to the public road as more fully specified in a deed dated 25th August 1977 between the said William Richard and Penelope Anne Dudgeon and Archibald Stewart Kennedy.</p>		

# Register of TOWN OR VILLAGE GREENS

respect of land of which the freehold is registered under the Land Registration Acts 1925 and 1936, but the absence from this section of a registration in respect of any land described in the land section does not necessarily indicate that the freehold of that land is registered under those Acts.

Register unit No. VG117

Edition No. 1

See Overleaf  
for Notes

OWNERSHIP SECTION—Sheet No. 1

1 No. and date of entry	2 No. and date of application	3 Name and Address of person registered as owner	4 Particulars of the land to which the registration applies
1 28 June 1968	256 6 May 1968	<del>Horace Wells Juniper, Warish Hall, Takeley, Bishops Stortford, Herts. (Registration provisional)</del>	<del>The whole of the land comprised in this register unit.</del>
		<i>See entry No. 3 below.</i>	
2 4 December 1969	698 10 November 1969	Archibald Stewart Kennedy Warish Hall Takeley Essex (Registration provisional)	The whole of the land comprised in this register unit.
		<i>(See entry No. 4 below.)</i>	
3 8 <sup>th</sup> December 1970		Registration cancellation: in exercise of their powers under Regulation 12(7) of the Commons Registration (General) Regulations 1966, the Commons Registration Authority hereby cancel registration entry No. 1 above	
4 28 February		The registration at entry No. 2 above, being undisputed, became	

No. and date  
of note

Notes

No. and date  
of note

Notes

~~1~~

~~December~~

~~1969~~

The registration at entry No. 2 above is in conflict with the registration at entry No. 1 above/in the section of the Register of register unit No. and each of those registrations is accordingly to be treated as an objection to the other to the extent of the conflict.

SE/2





(29th January 1997)

**ACQUISITION OF LAND ACT 1981**

**SECTION 19(1)(a)**

**Essex County Council (Puckeridge to Parkestone Quay Classified Road A120)  
(Stansted to Braintree) Compulsory Purchase Order 1995**

**Smiths Green, Bambers Green and Connecting Roadside Verges**

The Secretary of State for the Environment, in exercise of his powers under section 19(1)(a) of the Acquisition of Land Act 1981, hereby certifies that he is satisfied that there will be given in exchange for the land described in the First Schedule hereto, being part of an open space within the meaning of the said Act, the land described in the Second Schedule hereto, which is not less in area and is equally advantageous to the persons, if any, entitled to rights of common or other rights, and to the public, and that the land given in exchange has been or will be vested in the persons in whom the said open space was vested, and subject to the like rights, trusts and incidents as attached to the said open space.

**FIRST SCHEDULE**

10,228 sq.metres of land, being parts of land registered as village green, in the Parish of Takeley, in the district of Uttlesford, shown coloured pink on the map referred to in the above mentioned Compulsory Purchase Order, and comprising:

- (a) 2,068 sq.metres, part of village green west of and adjacent to Warish Hall Road and south of an unmarked track north Warish Hall Farm, numbered Plot 23;
- (b) 1,307 sq.metres, part of village green east of and adjacent to Warish Hall Road, north of Warish Hall Farm, numbered Plot 30;
- (c) 332 sq.metres, part of village green east of and adjacent to Warish Hall Road, east of Warish Hall Farm, numbered Plot 32;
- (d) 66 sq.metres, part of village green west of and adjacent to Warish Hall Road and north of farm track, numbered Plot 180;
- (e) 332 sq. metres part of village green east of and adjacent to Warish Hall Road and northwest of "Fanns", numbered Plot 181;
- (f) 1,940 sq.metres, part of village green east of and adjacent to Warish Hall Road and part of access track to "Fanns", numbered Plot 183;



(g) 1,476 sq.metres part of village green west of and adjacent to Warish Hall Road, north of and adjacent to numbers 1 & 2 Warish Cottages and north east of Warish Hall Farm, numbered Plot 184;

(h) 2,040 sq. metres part of village green east of and adjacent to Warish Hall Road, north and east of numbers 1 & 2 Warish Cottages and north of Parkers Farm, numbered Plot 185;

(i) 30 sq.metres, part of village green west of and adjacent to Warish Hall Road, to the east of Warish Hall Farm, numbered Plot 187;

(j) 637 sq.metres, part of village green west of and adjacent to Warish Hall Road, and part of Public Footpath No.21 (Takeley) to the south west of "Fanns", numbered Plot 189.

#### SECOND SCHEDULE

14,564 sq.metres of arable land, in the Parish of Takeley in the district of Uttlesford, to the east of Warish Hall Road west of Fanns Wood and south of the access track to "Fanns" (part of OS Parcel No.1138), shown coloured green on the map referred to in the above mentioned Compulsory Purchase Order and numbered Plot 201.

Signed by authority of  
the Secretary of State  
for the Environment

29th January 1997

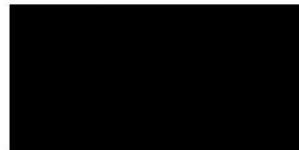

A Principal in  
the Department of  
the Environment

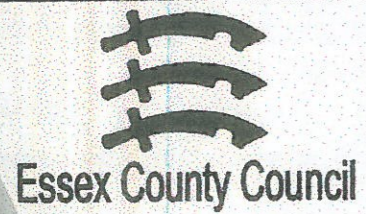
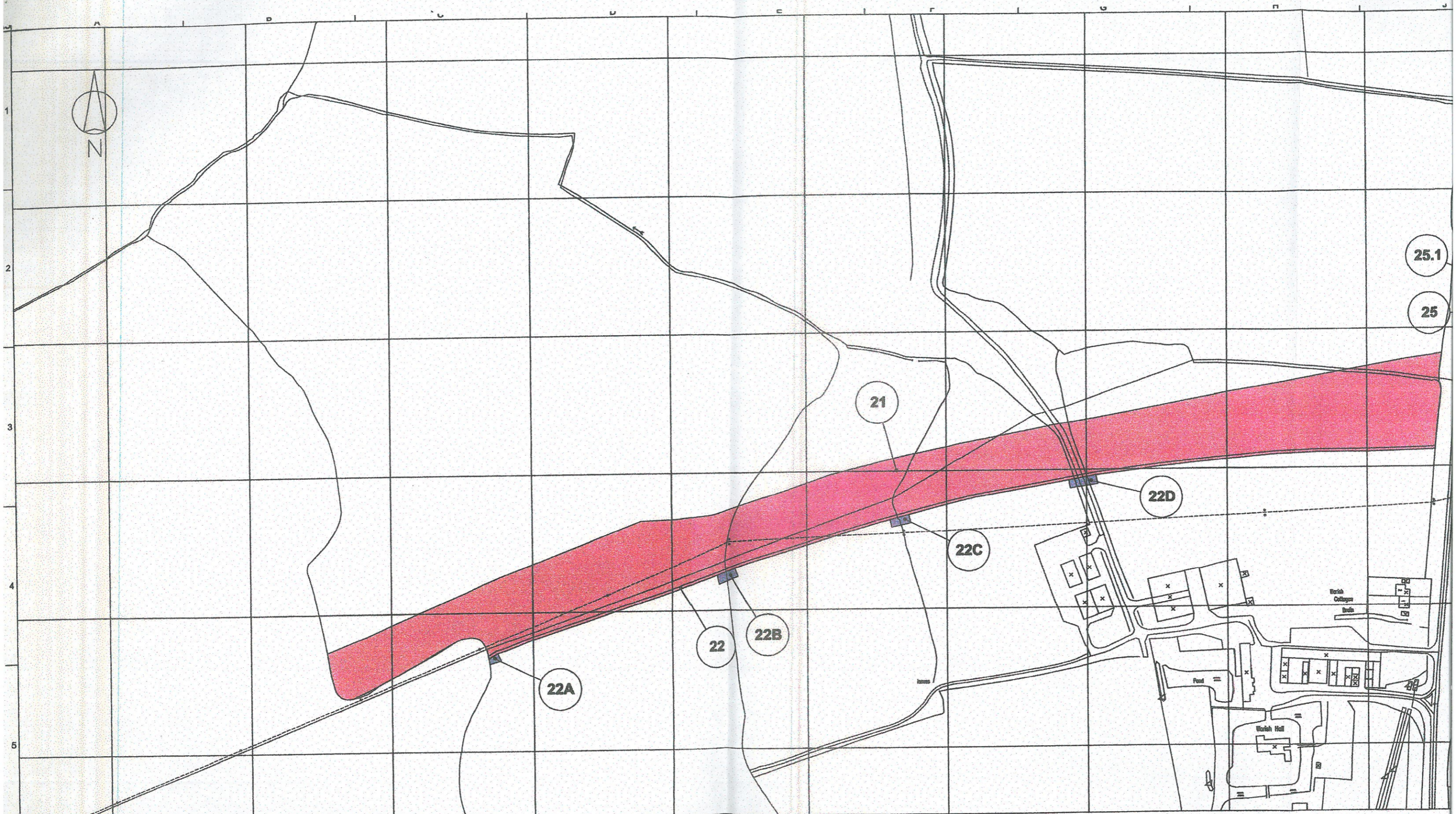

HIGHWAYS AND  
TRANSPORTATION  
COUNTY HALL  
CHELMSFORD CM1 1QH  
Telephone 01245 492211

<u>Plot No.</u>	<u>Area (sq m)</u>	<u>Plot No.</u>	<u>Area (sq m)</u>	<u>Plot No.</u>	<u>Area (sq m)</u>
21	35867	22D	125	33	39518
22	1059	25	798	33A	55
22A	40	25.1	416	1002	13587
22B	75	28	492	201	14564
22C	75	31	1973		

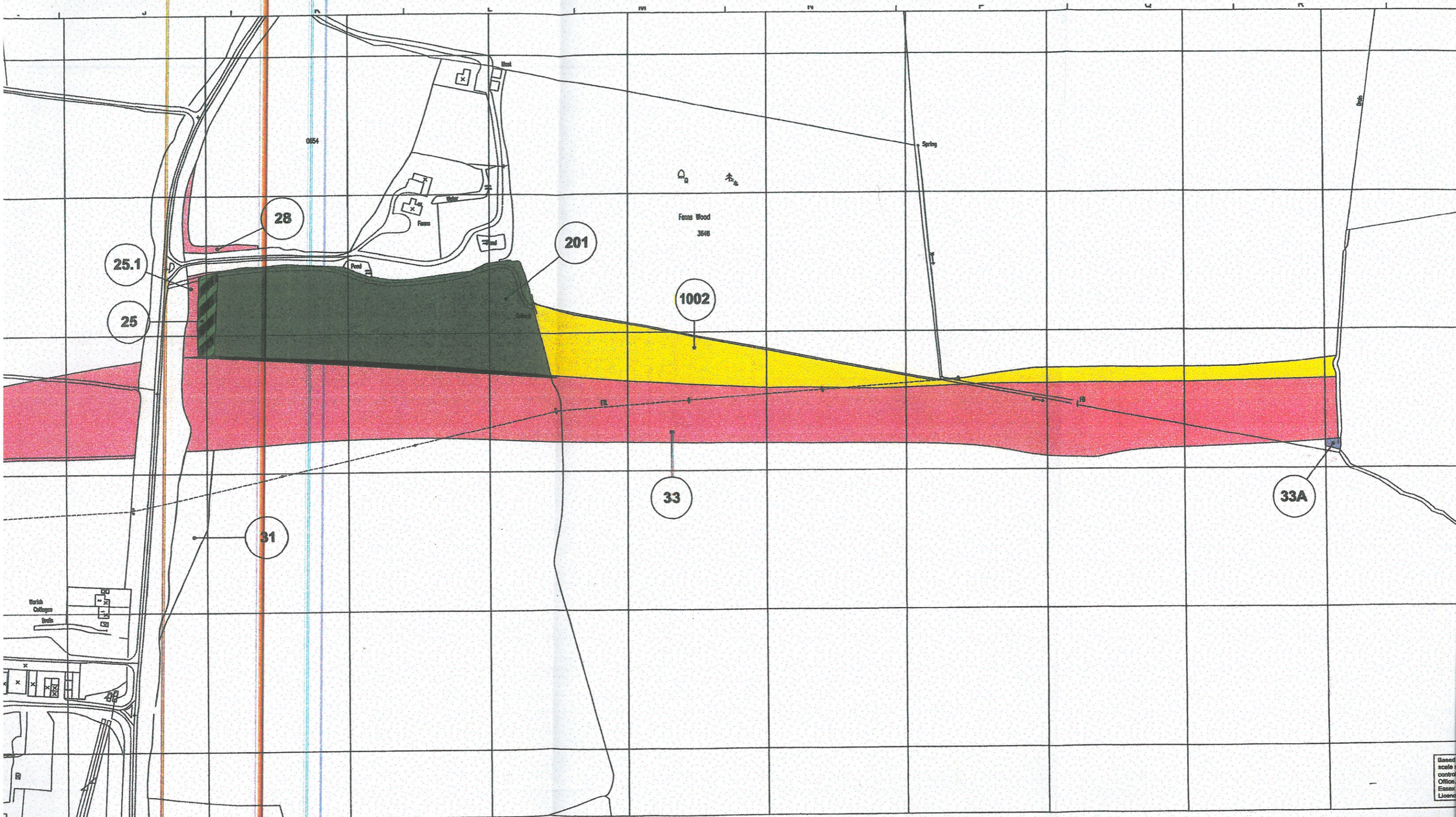

Job Title  
**A120 Stansted to Braintree  
 IN03- Shine Trip  
 Revised Plan**

**ARUP** Arup Co  
 Boston  
 Tel +617  
 www.arup.com

Scale at A3 1:2500

Drawn <b>ADE</b>	Date <b>16/11/04</b>	Check <b>NC</b>
Job No <b>67893-00</b>	Drawing No <b>IP 3</b>	

Based on  
 scale of  
 control  
 Office  
 Estate  
 License

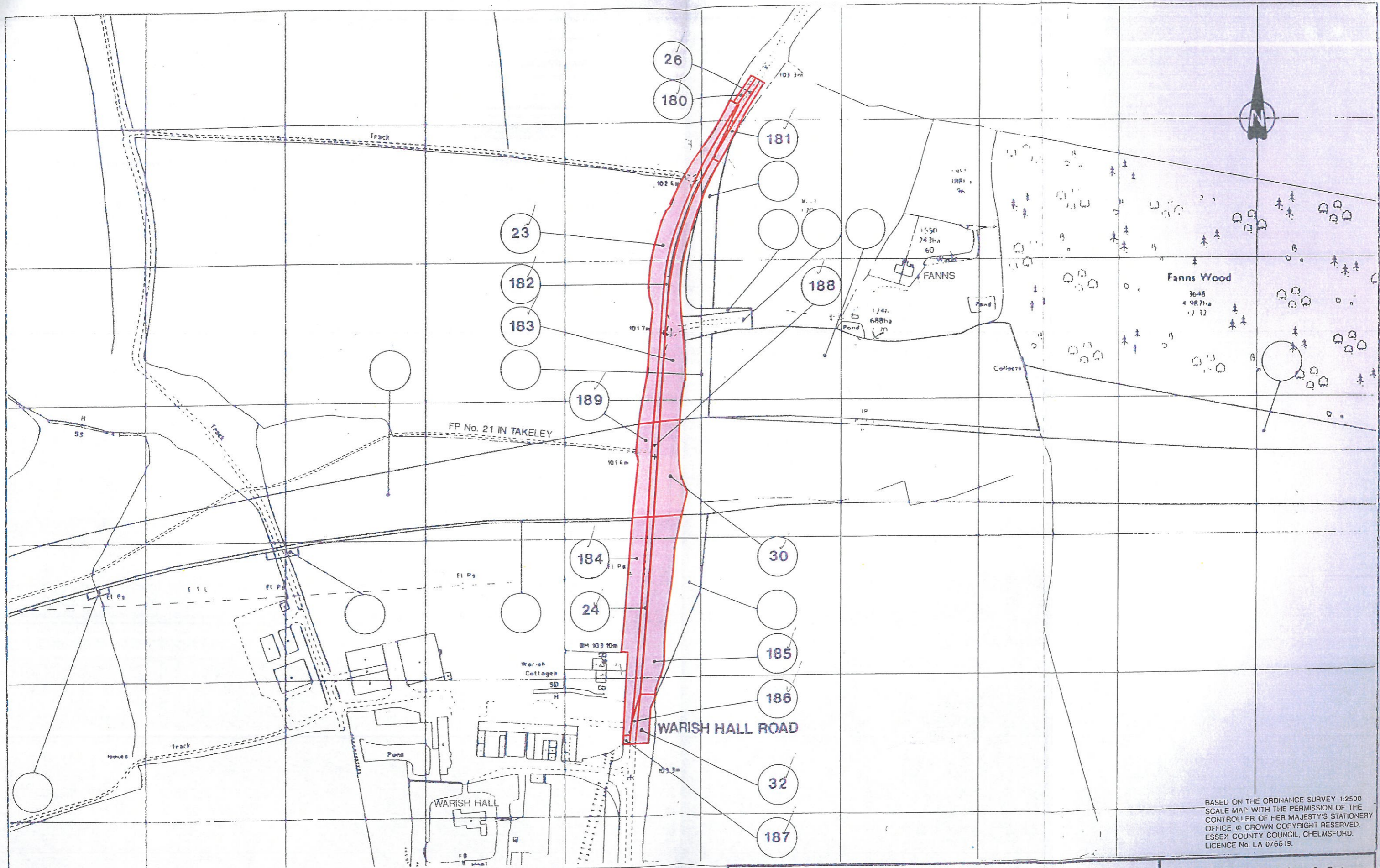

BASED ON THE ORDNANCE SURVEY 1:2500 SCALE MAP WITH THE PERMISSION OF THE CONTROLLER OF HER MAJESTY'S STATIONERY OFFICE © CROWN COPYRIGHT RESERVED. ESSEX COUNTY COUNCIL, CHELMSFORD. LICENCE No. LA 076619.

Plot No.	Area (sq m)	Plot No.	Area (sq m)
23	2068	183	1940
24	548	184	1476
26	112	185	2040
30	1307	186	92

Job Title

**A120 STANSTED TO BRAINTREE**



JOHN SANDERS  
HEAD OF TRANSPORTATION AND  
OPERATIONAL SERVICES  
ENVIRONMENTAL SERVICES DIRECTORATE

**ARUP** Ove Arup & Partners  
The Oaks, Westwood Way, Coventry CV4 8JF  
Tel 01203-474347 Facsimile 01203-466690

Scales 1:2500  
Dn Date 12/99 Checked Approved