

# Notice of variation and consolidation with introductory note

## The Environmental Permitting (England & Wales) Regulations 2016

---

Crown Chicken Limited

Falcons Hall Farm Poultry Unit  
Falcons Hall Farm  
Finningham Road  
Rickingham  
Diss  
Norfolk  
IP22 1LP

### **Variation application number**

EPR/BP3334CB/V006

### **Permit number**

EPR/BP3334CB

# Falcons Hall Farm Poultry Unit

## Permit number EPR/BP3334CB

### Introductory note

#### **This introductory note does not form a part of the notice.**

Under the Environmental Permitting (England & Wales) Regulations 2016 (schedule 5, part 1, paragraph 19) a variation may comprise a consolidated permit reflecting the variations and a notice specifying the variations included in that consolidated permit.

Schedule 1 of the notice specifies the conditions that have been varied and schedule 2 comprises a consolidated permit which reflects the variations being made. All the conditions of the permit have been varied and are subject to the right of appeal.

This variation authorises the following changes:

- Installation of four additional poultry houses, numbered C1 to C4, and associated increase to the permitted boundary.
- Increase in bird numbers from 75,000 to 100,580 broiler breeder pullets.
- Addition of a standby generator, with a thermal rated input of 0.172MWth, serving poultry houses C1 to C4, and associated diesel tank.

We have reviewed the new housing introduced with the permit variation for this installation against the best available techniques (BAT) conclusions as defined in the intensive rearing of poultry or pigs (IRPP) BAT conclusions document, dated 21/02/17. The permit conditions and schedules ensure the compliance of the new housing with this BAT conclusions document. In addition, we have reviewed existing housing, permitted before 21/02/17, to ensure compliance.

The rest of the installation is operated as follows:

Falcons Hall Farm Poultry Unit is situated approximately 9 kilometres south-west of the town of Diss in Norfolk. The installation is approximately centred on National Grid Reference TM 04468 73504.

The installation is operated by Crown Chicken Limited and comprises nine poultry houses, numbered A1, A2, B1 to B3 and C1 to C4, with a capacity for 100,580 broiler breeder pullets (reared to become layers for hatching eggs), operating a fully littered floor system.

The birds are brought on to site at a day old and reared for a period of up to 19 weeks before being transferred to breeder farms elsewhere. The average cycle is 26 weeks, including a 3-week washdown period and 5-week rest period before restocking, resulting in two cycles per year. Prior to the arrival of the birds, the concrete floors in each house are covered with a mixture of dust extracted wood shavings and chopped straw to a suitable depth and houses are pre-warmed using liquid petroleum gas fired heaters.

Houses A1 and A2, and C1 to C4 are ventilated by roof fans with an emission point greater than 3.5 metres high and a fan efflux velocity of 11 metres per second, and houses B1 to B3 are ventilated by roof fans with an emission point greater than 5.5 metres above ground level and an efflux speed of 11 metres per second.

There are two standby generators for emergency use; both have a net thermal rated input <1MWth and are operated for a maximum of 1 hour/week for testing purposes.

The land around the site is predominantly agricultural, with some residential dwellings. Associated food is purchased and delivered from a feed mill and stored on the installation in sealed food bins which are protected from collision damage by careful siting. Water is provided via nipple drinkers which are designed to minimise spillage. Mortalities are collected daily and stored in secure, covered containers, awaiting collection by an approved transporter under the National Fallen Stock Scheme, or incineration in the on-site Animal Health and Veterinary Laboratories Agency (AHVLA) approved incinerator.

At end of the growing period, all the birds are removed from the houses and manure is removed from the site for spreading on third party owned land, in accordance with a manure management plan, or for fuel for local power generation. Houses and equipment are pressure washed, disinfected, and dried, before restocking.

Water from the wash out of poultry houses is channelled to underground collection tanks close to the houses to await export off site for spreading on third party owned land. Roof water, via French drains alongside the poultry houses, and water draining from the yard (excluding during periods of destocking and washing out when water from the yards drains to the underground tanks) from poultry houses C1 to C4 discharges to a ditch to the north-west of the poultry houses, which is a tributary of Little Ouse River, via an unlined attenuation pond. Roof water, via French drains alongside the poultry houses, and water draining from the yard (excluding during periods of destocking and washing out when water from the yards drains to the underground tanks) from poultry houses A1 and A2, and B1 to B3 discharges to ditches to the east and south-east of the poultry houses, which are tributaries of Little Ouse River.

There are no Special Areas of Conservation (SAC), Special Protection Areas (SPA) or Ramsars within 5km of the installation. There are two Sites of Special Scientific Interest (SSSI) within 5km of the installation, and three other nature conservation sites within 2km comprising of one Local Wildlife Site (LWS) and two ancient woodlands. An assessment of the impact of emissions has been carried out and the installation is considered to have no adverse effect on the nature conservation sites.

This permit implements the requirements of the European Union Directive on Industrial Emissions.

The schedules specify the changes made to the permit.

The status log of a permit sets out the permitting history, including any changes to the permit reference number.

<b>Status log of the permit</b>		
<b>Description</b>	<b>Date</b>	<b>Comments</b>
Application EPR/BP3334CB/A001	Duly made 24/09/2012	Application for an intensive farming poultry installation permit.
Additional information received	31/10/2012	Clarification of type of livestock, installation boundary, incinerator, site drainage, chemical storage, ventilation, heat exchangers and generator.
Additional information received	01/11/2012	Revised site drainage plan received showing location of generator.
Permit determined EPR/BP3334CB	27/11/2012	Permit issued to Crown Chicken Limited.
Application EPR/BP3334CB/V002 (variation and consolidation)	Duly made 09/10/2015	Application to increase the number of broiler places from 60,000 to 75,000, add a shed and update the permit to modern conditions.
Variation determined EPR/BP3334CB	05/11/2015	Varied and consolidated permit issued in modern condition format.
Notified change of Registered Office Address	03/10/2016	Request from operator to update the company registered office address from 2 The Norwich Business Park, Whiting Road, Norwich, Norfolk, NR4 6DJ to 74 Helsinki Road, Hull, HU7 0YW.
Variation issued EPR/BP3334CB/V003	06/12/2016	Varied permit issued to Crown Chicken Limited.
Notified change of Registered Office Address	27/02/2019	Registered Office address changed to Crane Court, Hesslewood Office Park, Ferriby Road, Hessle, HU13 0PA.
Variation issued EPR/BP3334CB/V004	13/03/2019	Varied permit issued to Crown Chicken Limited.

<b>Status log of the permit</b>		
<b>Description</b>	<b>Date</b>	<b>Comments</b>
Variation determined EPR/BP3334CB/V005	28/01/2021	Environment Agency initiated variation for Intensive Farming BAT compliance permit review.
Application EPR/BP3334CB/V006 (variation and consolidation)	Duly made 14/12/2022	Application to install four additional poultry houses, increase the number of broiler breeder pullets from 75,000 to 100,580 places and increase the permitted boundary.
Additional information received	16/02/2023, 21/02/2023, 28/02/2023 and 02/03/2023	Revised site drainage plans, clarification with regards to carcass incinerator, details regarding standby generators, revised odour, noise and dust management plans, revised site plan, clarification regarding testing times for the standby generators and revised supporting information document.
Variation determined EPR/BP3334CB (Billing reference: DP3123PT)	07/03/2023	Varied and consolidated permit issued in modern condition format.

End of introductory note

# Notice of variation and consolidation

## The Environmental Permitting (England and Wales) Regulations 2016

The Environment Agency in exercise of its powers under regulation 20 of the Environmental Permitting (England and Wales) Regulations 2016 varies and consolidates

### Permit number

EPR/BP3334CB

### Issued to

**Crown Chicken Limited** (“the operator”)

**Crane Court  
Hesselwood Office Park  
Ferriby Road  
Hessle  
HU13 0PA**

company registration number **04760487**

to operate an installation at

**Falcons Hall Farm Poultry Unit  
Falcons Hall Farm  
Finningham Road  
Rickinghall  
Diss  
Norfolk  
IP22 1LP**

to the extent set out in the schedules.

The notice shall take effect from 07/03/2023.

Name	Date
<b>Rebecca Warren</b>	<b>07/03/2023</b>

Authorised on behalf of the Environment Agency

## **Schedule 1**

All conditions have been varied by the consolidated permit EPR/BP3334CB as a result of the application made by the operator.

## **Schedule 2 – consolidated permit**

Consolidated permit issued as a separate document.

# Permit

## The Environmental Permitting (England and Wales) Regulations 2016

### Permit number

**EPR/BP3334CB**

This is the consolidated permit referred to in the variation and consolidation notice for application EPR/BP3334CB/V006 authorising,

**Crown Chicken Limited** (“the operator”),

whose registered office is

**Crane Court  
Hesselwood Office Park  
Ferriby Road  
Hessle  
HU13 0PA**

company registration number **04760487**

to operate an installation at

**Falcons Hall Farm Poultry Unit  
Falcons Hall Farm  
Finningham Road  
Rickingham  
Diss  
Norfolk  
IP22 1LP**

to the extent authorised by and subject to the conditions of this permit.

Name	Date
<b>Rebecca Warren</b>	<b>07/03/2023</b>

Authorised on behalf of the Environment Agency

# Conditions

## 1 Management

### 1.1 General management

- 1.1.1 The operator shall manage and operate the activities:
- (a) in accordance with a written management system that identifies and minimises risks of pollution, so far as is reasonably practicable, including those risks arising from operations, maintenance, accidents, incidents, non-conformances, closure and those drawn to the attention of the operator as a result of complaints; and
  - (b) using sufficient competent persons and resources.
- 1.1.2 Records demonstrating compliance with condition 1.1.1 shall be maintained.
- 1.1.3 Any person having duties that are or may be affected by the matters set out in this permit shall have convenient access to a copy of the permit.

### 1.2 Energy efficiency

- 1.2.1 The operator shall:
- (a) take appropriate measures to ensure that energy is used efficiently in the activities; and
  - (b) maintain records of fuel and energy consumption used in the activities.

### 1.3 Efficient use of raw materials

- 1.3.1 The operator shall:
- (a) take appropriate measures to ensure that raw materials and water are used efficiently in the activities; and
  - (b) maintain records of raw materials and water used in the activities.

### 1.4 Avoidance, recovery and disposal of wastes produced by the activities

- 1.4.1 The operator shall take appropriate measures to ensure that the waste hierarchy referred to in Article 4 of the Waste Framework Directive is applied to the generation of waste by the activities and that;
- (a) any waste generated by the activities is treated in accordance with the waste hierarchy referred to in Article 4 of the Waste Framework Directive; and
  - (b) where disposal is necessary, this is undertaken in a manner which minimises its impact on the environment.

## 2 Operations

### 2.1 Permitted activities

- 2.1.1 The only activity authorised by the permit is the activity specified in schedule 1 table S1.1 (the “activities”).



## **2.2 The site**

- 2.2.1 The activities shall not extend beyond the site, being the land shown edged in green on the site plan at schedule 7 to this permit.

## **2.3 Operating techniques**

- 2.3.1 The activities shall, subject to the conditions of this permit, be operated using the techniques and in the manner described in the documentation specified in schedule 1, table S1.2, unless otherwise agreed in writing by the Environment Agency.
- 2.3.2 If notified by the Environment Agency that the activities are giving rise to pollution, the operator shall submit to the Environment Agency for approval within the period specified, a revision of any plan or other documentation ("plan") specified in schedule 1, table S1.2 or otherwise required under this permit which identifies and minimises the risks of pollution relevant to that plan, and shall implement the approved revised plan in place of the original from the date of approval, unless otherwise agreed in writing by the Environment Agency.
- 2.3.3 The operator shall maintain and implement a system to record the number of animal places and animal movements.
- 2.3.4 The operator shall ensure that a diet formulation and nutritional strategy is used to reduce the total nitrogen and total phosphorus excreted.
- 2.3.5 The operator shall take appropriate measures in disposal or recovery of solid manure or slurry to prevent, or where this is not practicable, to minimise pollution.
- 2.3.6 Any raw materials or fuels listed in schedule 2 table S2.1 shall conform to the specifications set out in that table.
- 2.3.7 The operator shall ensure that where waste produced by the activities is sent to a relevant waste operation, that operation is provided with the following information, prior to the receipt of the waste:
- (a) the nature of the process producing the waste;
  - (b) the composition of the waste;
  - (c) the handling requirements of the waste;
  - (d) the hazardous property associated with the waste, if applicable; and
  - (e) the waste code of the waste.

## **3 Emissions and monitoring**

### **3.1 Emissions to water, air or land**

- 3.1.1 There shall be no point source emissions to water, air or land except from the sources and emission points specified in tables S3.1 and S3.2.
- 3.1.2 The limits given in schedule 3 shall not be exceeded.
- 3.1.3 Periodic monitoring shall be carried out at least once every 5 years for groundwater and 10 years for soil, unless such monitoring is based on a systematic appraisal of the risk of contamination.

### **3.2 Emissions of substances not controlled by emission limits**

- 3.2.1 Emissions of substances not controlled by emission limits shall not cause pollution. The operator shall not be taken to have breached this condition if appropriate measures, including, but not limited to, those specified in any approved emissions management plan, have been taken to prevent or where that is not practicable, to minimise, those emissions.

3.2.2 The operator shall:

- (a) if notified by the Environment Agency that the activities are giving rise to pollution, submit to the Environment Agency for approval within the period specified, an emissions management plan which identifies and minimises the risks of pollution from emissions of substances not controlled by emission limits; and
- (b) implement the approved emissions management plan, from the date of approval, unless otherwise agreed in writing by the Environment Agency.

3.2.3 All liquids in containers, whose emission to water or land could cause pollution, shall be provided with secondary containment, unless the operator has used other appropriate measures to prevent or where that is not practicable, to minimise, leakage and spillage from the primary container.

### **3.3 Odour**

3.3.1 Emissions from the activities shall be free from odour at levels likely to cause pollution outside the site, as perceived by an authorised officer of the Environment Agency, unless the operator has used appropriate measures, including, but not limited to, those specified in any approved odour management plan, to prevent or where that is not practicable to minimise the odour.

### **3.4 Noise and vibration**

3.4.1 Emissions from the activities shall be free from noise and vibration at levels likely to cause pollution outside the site, as perceived by an authorised officer of the Environment Agency, unless the operator has used appropriate measures, including, but not limited to, those specified in any approved noise and vibration management plan to prevent or where that is not practicable to minimise the noise and vibration.

### **3.5 Monitoring**

3.5.1 The operator shall, unless otherwise agreed in writing by the Environment Agency, undertake the monitoring specified in the following tables in schedule 3 to this permit:

- (a) point source emissions specified in tables S3.1 and S3.2; and
- (b) process monitoring specified in table S3.3.

3.5.2 The operator shall maintain records of all monitoring required by this permit including records of the taking and analysis of samples, instrument measurements (periodic and continual), calibrations, examinations, tests and surveys and any assessment or evaluation made on the basis of such data.

3.5.3 Monitoring equipment, techniques, personnel and organisations employed for the emissions monitoring programme and the environmental or other monitoring specified in condition 3.5.1 shall have either MCERTS certification or MCERTS accreditation (as appropriate), where available, unless otherwise agreed in writing by the Environment Agency.

### **3.6 Pests**

3.6.1 The activities shall not give rise to the presence of pests which are likely to cause pollution, hazard or annoyance outside the boundary of the site. The operator shall not be taken to have breached this condition if appropriate measures, including, but not limited to, those specified in any approved pests management plan, have been taken to prevent or where that is not practicable, to minimise the presence of pests on the site.

3.6.2 The operator shall:

- (a) if notified by the Environment Agency, submit to the Environment Agency for approval within the period specified, a pests management plan which identifies and minimises risks of pollution, hazard or annoyance from pests; and

- (b) implement the pests management plan, from the date of approval, unless otherwise agreed in writing by the Environment Agency.

## **4 Information**

### **4.1 Records**

- 4.1.1 All records required to be made by schedules 3, 4 and 5 to this permit shall:
  - (a) be legible;
  - (b) be made as soon as reasonably practicable;
  - (c) if amended, be amended in such a way that the original and any subsequent amendments remain legible, or are capable of retrieval; and
  - (d) be retained, unless otherwise agreed in writing by the Environment Agency, for at least 6 years from the date when the records were made, or in the case of the following records until permit surrender:
    - (i) off-site environmental effects; and
    - (ii) matters which affect the condition of the land and groundwater.
- 4.1.2 The operator shall maintain convenient access, in either electronic or hard copy, to the records, plans and management system required to be maintained by this permit.

### **4.2 Reporting**

- 4.2.1 The operator shall send all reports and notifications required by the permit to the Environment Agency using the contact details supplied in writing by the Environment Agency.
- 4.2.2 For the following activities referenced in schedule 1, table S1.1 a report or reports on the performance of the activities over the previous year shall be submitted to the Environment Agency by 31 January (or other date agreed in writing by the Environment Agency) each year. The report(s) shall include as a minimum:
  - (a) a review of the results of the monitoring and assessment carried out in accordance with the permit including an interpretive review of that data.
- 4.2.3 Within 28 days of the end of the reporting period the operator shall, unless otherwise agreed in writing by the Environment Agency, submit reports of the monitoring and assessment carried out in accordance with the conditions of this permit, as follows:
  - (a) in respect of the parameters and emission points specified in schedule 4 table S4.1;
  - (b) for the reporting periods specified in schedule 4 table S4.1 and using the forms specified in schedule 4 table S4.2; and
  - (c) giving the information from such results and assessments as may be required by the forms specified in those tables.
- 4.2.4 The operator shall, unless notice under this condition has been served within the preceding four years, submit to the Environment Agency, within six months of receipt of a written notice, a report assessing whether there are other appropriate measures that could be taken to prevent, or where that is not practicable, to minimise pollution.

### **4.3 Notifications**

- 4.3.1 In the event:
  - (a) that the operation of the activities gives rise to an incident or accident which significantly affects or may significantly affect the environment, the operator must immediately :-

- (i) inform the Environment Agency,
  - (ii) take the measures necessary to limit the environmental consequences of such an incident or accident, and
  - (iii) take the measures necessary to prevent further possible incidents or accidents; and
- (b) of a breach of any permit condition the operator must immediately :-
- (i) inform the Environment Agency, and
  - (ii) take the measures necessary to ensure that compliance is restored within the shortest possible time;
- (c) of a breach of permit condition which poses an immediate danger to human health or threatens to cause an immediate significant adverse effect on the environment, the operator must immediately suspend the operation of the activities or the relevant part of it until compliance with the permit conditions has been restored.

4.3.2 Any information provided under condition 4.3.1 shall be confirmed by sending the information listed in schedule 5 to this permit within the time period specified in that schedule.

4.3.3 Where the Environment Agency has requested in writing that it shall be notified when the operator is to undertake monitoring and/or spot sampling, the operator shall inform the Environment Agency when the relevant monitoring and/or spot sampling is to take place. The operator shall provide this information to the Environment Agency at least 14 days before the date the monitoring is to be undertaken.

4.3.4 The Environment Agency shall be notified within 14 days of the occurrence of the following matters, except where such disclosure is prohibited by Stock Exchange rules:

Where the operator is a registered company:

- (a) any change in the operator's trading name, registered name or registered office address; and
- (b) any steps taken with a view to the operator going into administration, entering into a company voluntary arrangement or being wound up.

Where the operator is a corporate body other than a registered company:

- (c) any change in the operator's name or address; and
- (d) any steps taken with a view to the dissolution of the operator.

In any other case:

- (e) the death of any of the named operators (where the operator consists of more than one named individual);
- (f) any change in the operator's name(s) or address(es); and
- (g) any steps taken with a view to the operator, or any one of them, going into bankruptcy, entering into a composition or arrangement with creditors, or, in the case of them being in a partnership, dissolving the partnership.

4.3.5 Where the operator proposes to make a change in the nature or functioning, or an extension of the activities, which may have consequences for the environment and the change is not otherwise the subject of an application for approval under the Regulations or this permit:

- (a) the Environment Agency shall be notified at least 14 days before making the change; and
- (b) the notification shall contain a description of the proposed change in operation.

4.3.6 The Environment Agency shall be given at least 14 days' notice before implementation of any part of the site closure plan.

## **4.4 Interpretation**

- 4.4.1 In this permit the expressions listed in schedule 6 shall have the meaning given in that schedule.
- 4.4.2 In this permit references to reports and notifications mean written reports and notifications, except where reference is made to notification being made “immediately”, in which case it may be provided by telephone.

# Schedule 1 – Operations

<b>Table S1.1 Activities</b>		
<b>Activity listed in Schedule 1 of the EP Regulations</b>	<b>Description of specified activity</b>	<b>Limits of specified activity</b>
Section 6.9 A(1)(a)(i) Rearing of poultry intensively in an installation with more than 40,000 places	The rearing of poultry in a facility with a capacity for 100,580 broiler breeder pullet places.	From receipt of birds, raw materials and fuels onto the site to removal of birds and associated wastes from site.
<b>Directly Associated Activity</b>	<b>Description of specified activity</b>	<b>Limits of specified activity</b>
Carcass incineration	Operation of an Incinerator for carcass disposal Animal and Plant Health Agency (APHA) approved < 50 kg/hr.	From receipt of raw materials, fuels and input of carcasses to release of combustion products to air and associated wastes removed from site.

<b>Table S1.2 Operating techniques</b>		
<b>Description</b>	<b>Parts</b>	<b>Date Received</b>
Application EPR/BP3334CB/A001	Responses to Part B3 section 3 of the application form and referenced supporting documentation.	24/09/12
Additional information requested 31/10/12	Response to Request for Information clarifying type of livestock, use of incinerator, site drainage, chemical storage, use of heat exchangers and generator.	31/10/12 & 01/11/12
Application EPR/BP3334CB/V002	Responses to Part C3.5 of the application form sections 3, 4, 8a, 8d, 8e, 9, 10b and 10c.	04/09/15
Application EPR/BP3334CB/V006 (variation and consolidation)	Responses to Part C3.5 of the application form and referenced supporting documentation and additional information received in response to the not duly made request for information including: <ul style="list-style-type: none"> <li>• Section Q8a 22, 'Technical standards', of the document 'Supporting Information for application to vary environmental permit' dated December 2022, amended 02/03/23, confirming compliance with all relevant best available techniques (BAT) conclusions as defined in the intensive rearing of poultry or pigs (IRPP) BAT conclusions document, dated 21/02/17.</li> <li>• Environmental risk assessment.</li> <li>• Section Q4, 'Summary of Environment Management System', and section Q8a 19-21, 'Technical standards', of the document 'Supporting Information for application to vary environmental permit' dated December 2022, amended 02/03/23.</li> <li>• Detailed ammonia modelling reference 'A Report on the Modelling of the Dispersion and Deposition of Ammonia from the Proposed Pullet Chicken Rearing Houses at Falcons Hall Farm, near Rickingham in Suffolk'.</li> </ul>	14/12/22
Additional information requested 19/01/23	Response to request for information providing revised site drainage plans, clarification with regards to operation of the carcass incinerator, details regarding the standby generators, revised odour, noise and dust management plans, and revised site plan.	16/02/23 and 21/02/23
Additional information requested 22/03/23	Response to request for information providing clarification regarding testing times for the standby generators.	28/02/23
Additional information requested 01/03/23	Response to request for information providing a revised document, reference 'Supporting information for application to vary environmental permit'.	02/03/23

## Schedule 2 – Waste types, raw materials and fuels

Table S2.1 Raw materials and fuels	
Raw materials and fuel description	Specification
---	---



## Schedule 3 – Emissions and monitoring

Table S3.1 Point source emissions to air – emission limits and monitoring requirements						
Emission point ref. & location	Source	Parameter	Limit (including unit)	Reference period	Monitoring frequency	Monitoring standard or method
High velocity roof fan outlets on poultry houses B1 to B3 as shown on site drainage plan 1 in schedule 7	Poultry houses B1 to B3	---	---	---	---	---
Roof fan outlets on poultry houses A1, A2, and C1 to C4 as shown on the site drainage plans in schedule 7	Poultry houses A1, A2 and C1 to C4	---	---	---	---	---
Chimney from carcass incinerator as shown on site drainage plan 1 in schedule 7	Carcass incinerator	---	---	---	---	---
Exhaust from two standby generators as shown on the site drainage plans in schedule 7	Standby Generators	---	---	---	---	---
Vents from two oil tanks as shown on the site drainage plans in schedule 7	Diesel tanks	---	---	---	---	---

Table S3.2 Point Source emissions to water (other than sewer) and land – emission limits and monitoring requirements						
Emission point ref. & location	Source	Parameter	Limit (incl. unit)	Reference Period	Monitoring frequency	Monitoring standard or method
Outlets to ditch (W1 and W2) as indicated on site drainage plan 1 in schedule 7, which ultimately drains to the Little Ouse River	Roof water from poultry houses A1 and A2, intercepted by French drains (acting as soakaways) prior to discharge, and water draining from yard (excluding all times yards are contaminated e.g. catching, mucking out or washing)	---	---	---	---	---

**Table S3.2 Point Source emissions to water (other than sewer) and land – emission limits and monitoring requirements**

<b>Emission point ref. &amp; location</b>	<b>Source</b>	<b>Parameter</b>	<b>Limit (incl. unit)</b>	<b>Reference Period</b>	<b>Monitoring frequency</b>	<b>Monitoring standard or method</b>
Outlet to ditch (W3 and W4) as indicated on site drainage plan 1 in schedule 7, which ultimately drains to the Little Ouse River	Roof water from poultry houses A1 and A2, intercepted by French drains (acting as soakaways) prior to discharge	---	---	---	---	---
Outlet to ditch (W5) as indicated on site drainage plan 1 in schedule 7, which ultimately drains to the Little Ouse River	Water draining from yard (houses B1 to B3) (excluding all times yards are contaminated e.g. catching, mucking out or washing)	---	---	---	---	---
Outlet to ditch (W6) as indicated on site drainage plan 1 in schedule 7, which ultimately drains to the Little Ouse River	Roof water from poultry houses B1 to B3, intercepted by French drains (acting as soakaways) prior to discharge	---	---	---	---	---
Outlet to attenuation pond acting as a soakaway as indicated on site drainage plan 2 in schedule 7	Roof water from poultry houses C1 to C4, intercepted by French drains (acting as soakaways) prior to discharge, and water draining from yard (excluding all times yards are contaminated e.g. catching, mucking out or washing)	---	---	---	---	---
Outlet to ditch (W7) as indicated on site drainage plan 2 in schedule 7, which ultimately drains to the Little Ouse River	Roof water from poultry houses C1 to C4, intercepted by French drains (acting as soakaways) prior to discharge, and water draining	---	---	---	---	---

**Table S3.2 Point Source emissions to water (other than sewer) and land – emission limits and monitoring requirements**

<b>Emission point ref. &amp; location</b>	<b>Source</b>	<b>Parameter</b>	<b>Limit (incl. unit)</b>	<b>Reference Period</b>	<b>Monitoring frequency</b>	<b>Monitoring standard or method</b>
	from yard (excluding all times yards are contaminated e.g. catching, mucking out or washing), via an unlined attenuation pond					

**Table S3.3 Process monitoring requirements**

<b>Emission point reference or source or description of point of measurement</b>	<b>Parameter</b>	<b>Limit (incl. Unit)</b>	<b>Monitoring frequency</b>	<b>Monitoring standard or method</b>
Pullets (all houses)	Dust	n/a	Annually	Estimation using emission factors
Pullets (all houses)	Ammonia	n/a	Annually	Estimation using emission factors

# Schedule 4 – Reporting

Parameters, for which reports shall be made, in accordance with conditions of this permit, are listed below.

<b>Table S4.1 Reporting of monitoring data</b>			
<b>Parameter</b>	<b>Emission or monitoring point/reference</b>	<b>Reporting period</b>	<b>Period begins</b>
Process monitoring Parameters as required by condition 3.5.1	-	Every 12 months	1 January

<b>Table S4.2 Reporting forms</b>		
<b>Media/parameter</b>	<b>Reporting format</b>	<b>Date of form</b>
kg NH <sub>3</sub> /animal place/year	Form Process Monitoring 1 or other form as agreed in writing by the Environment Agency	07/03/2023
Dust atmospheric mass emission	Form Process Monitoring 1 or other form as agreed in writing by the Environment Agency	07/03/2023

# Schedule 5 – Notification

These pages outline the information that the operator must provide.

Units of measurement used in information supplied under Part A and B requirements shall be appropriate to the circumstances of the emission. Where appropriate, a comparison should be made of actual emissions and authorised emission limits.

If any information is considered commercially confidential, it should be separated from non-confidential information, supplied on a separate sheet and accompanied by an application for commercial confidentiality under the provisions of the EP Regulations.

## Part A

Permit number	
Name of operator	
Location of facility	
Time and date of the detection	

<b>(a) Notification requirements for any malfunction, breakdown or failure of equipment or techniques, accident, or emission of a substance not controlled by an emission limit which has caused, is causing or may cause significant pollution</b>	
<b>To be notified within 24 hours of detection</b>	
Date and time of the event	
Reference or description of the location of the event	
Description of where any release into the environment took place	
Substances(s) potentially released	
Best estimate of the quantity or rate of release of substances	
Measures taken, or intended to be taken, to stop any emission	
Description of the failure or accident.	

<b>(b) Notification requirements for the breach of a limit</b>	
<b>To be notified within 24 hours of detection</b>	
Emission point reference/ source	
Parameter(s)	
Limit	
Measured value and uncertainty	
Date and time of monitoring	
Measures taken, or intended to be taken, to stop the emission	

<b>Time periods for notification following detection of a breach of a limit</b>	
<b>Parameter</b>	<b>Notification period</b>

<b>(c) Notification requirements for the breach of permit conditions not related to limits</b>	
To be notified within 24 hours of detection	
Condition breached	
Date, time and duration of breach	
Details of the permit breach i.e. what happened including impacts observed.	
Measures taken, or intended to be taken, to restore permit compliance.	

<b>(d) Notification requirements for the detection of any significant adverse environmental effect</b>	
To be notified within 24 hours of detection	
Description of where the effect on the environment was detected	
Substances(s) detected	
Concentrations of substances detected	
Date of monitoring/sampling	

## **Part B – to be submitted as soon as practicable**

Any more accurate information on the matters for notification under Part A.	
Measures taken, or intended to be taken, to prevent a recurrence of the incident	
Measures taken, or intended to be taken, to rectify, limit or prevent any pollution of the environment which has been or may be caused by the emission	
The dates of any unauthorised emissions from the facility in the preceding 24 months.	
Name*	
Post	
Signature	
Date	

\* authorised to sign on behalf of the operator

## Schedule 6 – Interpretation

“accident” means an accident that may result in pollution.

“Animal and Plant Health Agency (APHA)” is the government agency that licences small on farm incinerators; formerly known as the Animal Health and Veterinary Laboratories Agency.

“application” means the application for this permit, together with any additional information supplied by the operator as part of the application and any response to a notice served under Schedule 5 to the EP Regulations.

“authorised officer” means any person authorised by the Environment Agency under section 108(1) of The Environment Act 1995 to exercise, in accordance with the terms of any such authorisation, any power specified in section 108(4) of that Act.

“building” means a construction that has the objective of providing sheltering cover and minimising emissions of noise, particulate matter, odour and litter.

“emissions to land” includes emissions to groundwater.

“emissions of substances not controlled by emission limits” means emissions of substances to air, water or land from the activities, either from the emission points specified in schedule 3 or from other localised or diffuse sources, which are not controlled by an emission limit.

“EP Regulations” means The Environmental Permitting (England and Wales) Regulations SI 2016 No.1154 and words and expressions used in this permit which are also used in the Regulations have the same meanings as in those Regulations.

“Existing housing” means housing that is not defined as new housing.

“groundwater” means all water, which is below the surface of the ground in the saturation zone and in direct contact with the ground or subsoil.

“Hazardous property” has the meaning in Annex III of the Waste Framework Directive.

“Industrial Emissions Directive” means DIRECTIVE 2010/75/EU OF THE EUROPEAN PARLIAMENT AND OF THE COUNCIL of 24 November 2010 on industrial emissions, as read in accordance with Schedule 1A to the Environmental Permitting (England and Wales) Regulations 2016.

“List of Wastes” means the list of wastes established by Commission Decision 2000/532/EC replacing Decision 94/3/EC establishing a list of wastes pursuant to Article 1(a) of Council Directive 75/442/EEC on waste and Council Decision 94/904/EC establishing a list of hazardous waste pursuant to Article 1(4) of Council Directive 91/689/EEC on hazardous waste, as amended from time to time.

“Manure and slurry” have the following meaning:

- Manures may be either slurries or solid manures.
- Slurries consist of excreta produced by livestock whilst in a yard or building mixed with rainwater and wash water and, in some cases, waste bedding and feed. Slurries can be pumped or discharged by gravity.
- Slurry includes duck effluent, seepage from manure and wash water.
- Solid manures include farmyard manure (FYM) and comprise material from straw-based housing systems, excreta with lots of straw/sawdust/woodchips in it, or solids from mechanical separators.
- Most poultry systems produce solid manure (litter).
- Solid manure can generally be stacked.

“New housing” means housing first permitted at the installation following the publication of the intensive rearing of poultry or pigs (IRPP) best available techniques (BAT) conclusions document dated 21/02/17, or a complete replacement of existing housing after 21/02/17.

“MCERTS” means the Environment Agency’s Monitoring Certification Scheme.

“pests” means Birds, Vermin and Insects.

“Waste code” means the six digit code referable to a type of waste in accordance with the List of Wastes and in relation to hazardous waste, includes the asterisk

“Waste Framework Directive” or “WFD” means Waste Framework Directive 2008/98/EC of the European Parliament and of the Council on waste.

“year” means calendar year ending 31 December.



# Schedule 7 – Site plan

Site plan - showing installation boundary as referred to in condition 2.2.1.

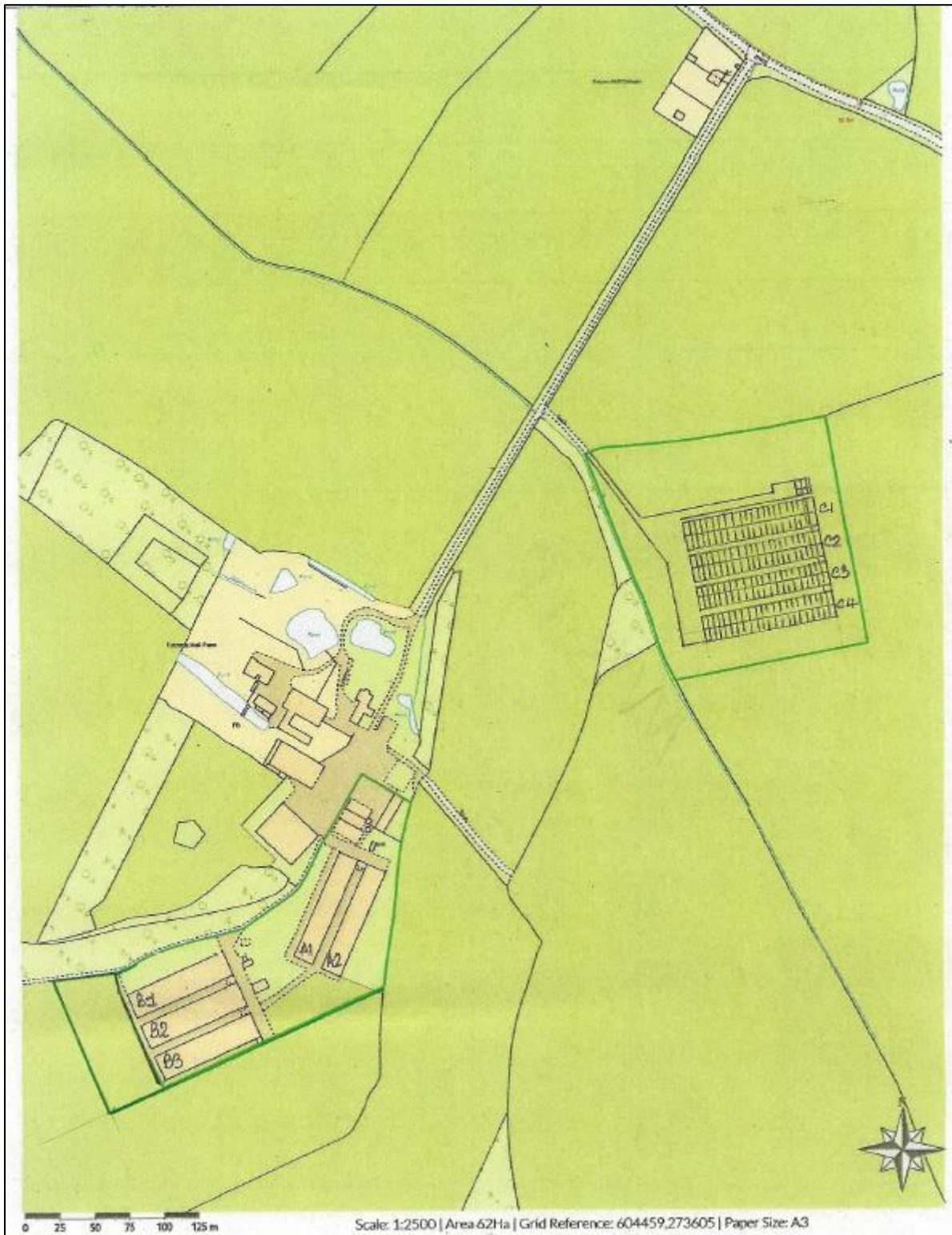

©Crown Copyright. All rights reserved. Environment Agency, 10024198, 2023.

Site drainage plan 1 – poultry houses A1, A2 & B1 to B3

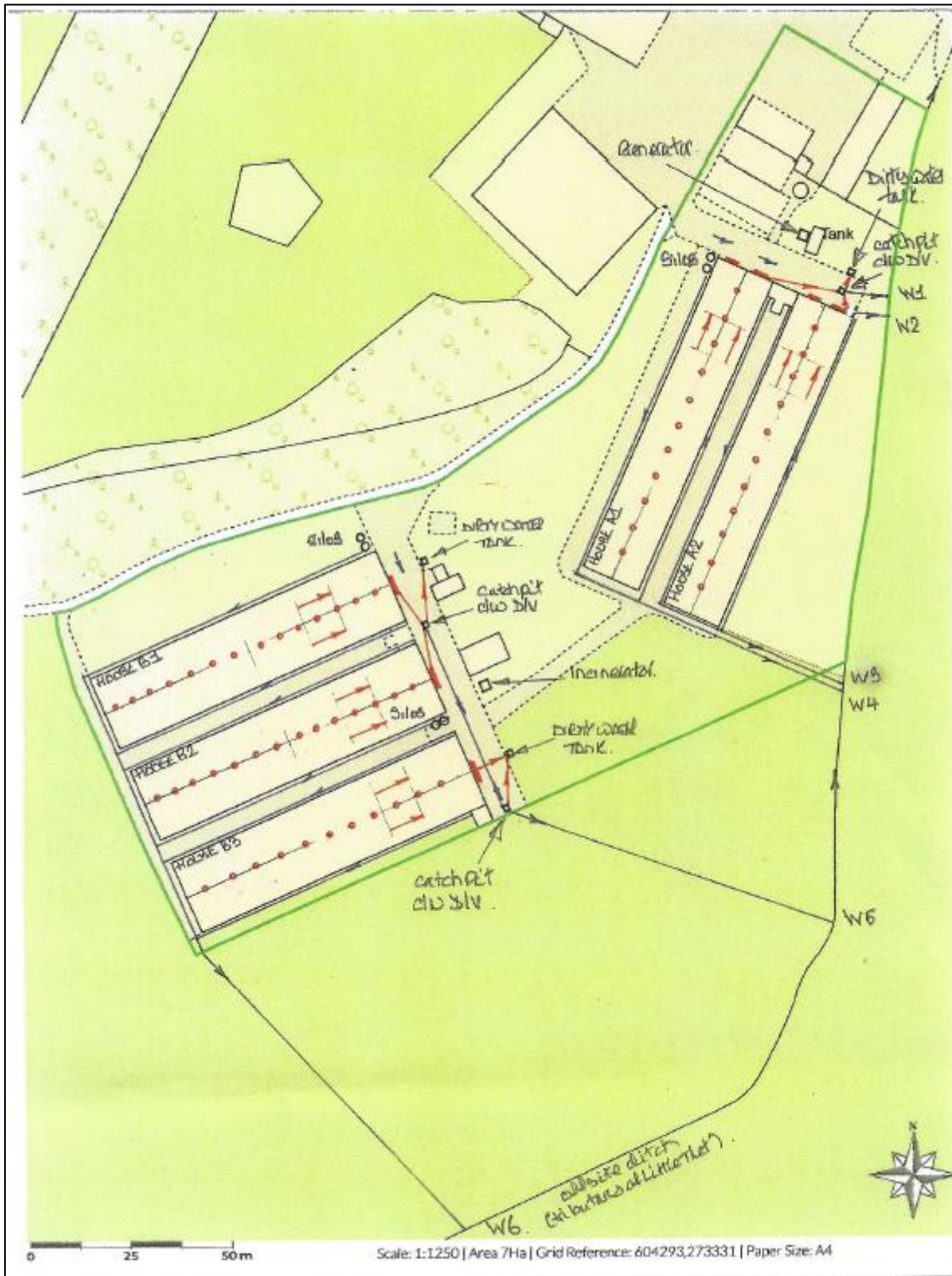

Site drainage plan 2 – poultry houses C1 to C4

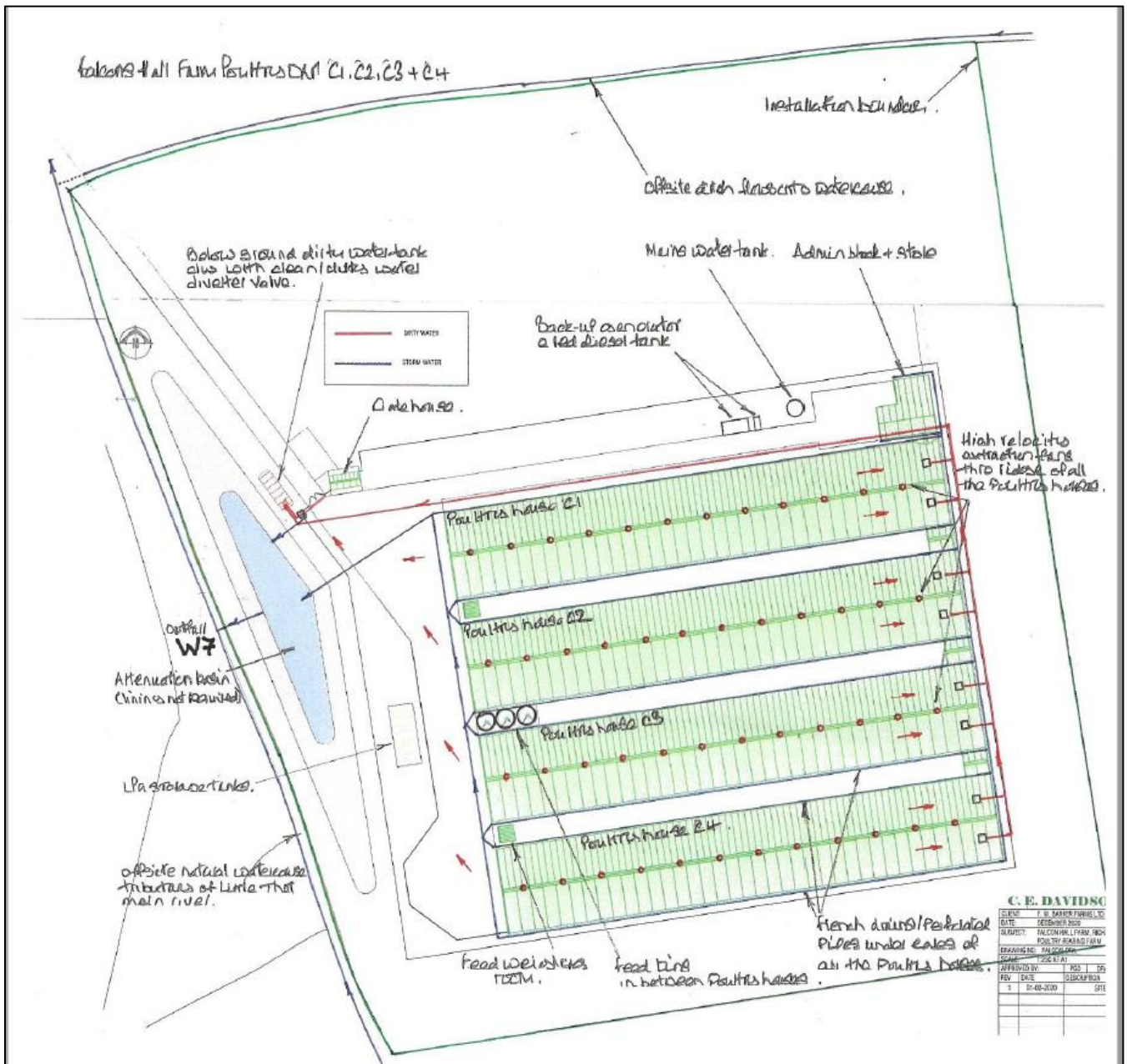

END OF PERMIT