

No dimensions are to be scaled from this drawing. All stated measurements are to be verified on site. Any discrepancies to be brought to the attention of Open Spaces.

|  |   |
|--|---|
|  | Crown spread tree/group                 |
|  | A Category tree<br>Root Protection Area |
|  | B Category tree<br>Root Protection Area |
|  | C Category tree<br>Root Protection Area |
|  | U Category tree<br>Root Protection Area |
|  | Tree to be removed                      |
|  | Tree Protection barrier                 |
|  | Ground Protection                       |
|  | Proposed Buildings / Access Road        |



Towne  
Plantat



| Rev | Date       | Description    |
|-----|------------|----------------|
| A   | 07/12/2022 | Revised Layout |

|               |                        |             |
|---------------|------------------------|-------------|
| Client        |                        |             |
| Project       | Grange Paddock, Eimdon |             |
| Drawing Title | Tree Protection Plan   |             |
| Date:         | 15/11/2022             | Drawn: JS   |
| Scale:        | 1:300 on A1            | Checked: KM |
| Dwg No:       | OS 2369-22-1-1         | Rev: A      |

**Open Spaces**  
Landscape Architects  
LANDSCAPE ARCHITECTURE - TREES - ECOLOGY  
2 Monument Offices, Hall Farm, Maldon Road,  
Woodham Mortimer, Essex CM9 6SN  
Tel: 01277 356511 os@open-spaces.co.uk





No dimensions are to be scaled from this drawing. All stated measurements are to be verified on site. Any discrepancies to be brought to the attention of Open Spaces.

- Crown spread tree/group
- A Category tree  
Root Protection Area
- B Category tree  
Root Protection Area
- C Category tree  
Root Protection Area
- U Category tree  
Root Protection Area
- Tree to be removed
- Tree Protection barrier
- Ground Protection
- Proposed Buildings / Access Road



| Rev | Date       | Description    |
|-----|------------|----------------|
| A   | 07/12/2022 | Revised Layout |

Client: \_\_\_\_\_

Project: Grange Paddock, Eimdon

Drawing Title: Tree Protection Plan

|         |                |             |
|---------|----------------|-------------|
| Date:   | 15/11/2022     | Drawn: JS   |
| Scale:  | 1:300 on A1    | Checked: KM |
| Dwg No: | OS 2369-22.1.2 | Rev: A      |

**Open Spaces**  
 Landscape Architects  
 LANDSCAPE ARCHITECTURE - TREES - ECOLOGY  
 2 Monument Offices, Hall Farm, Maldon Road,  
 Woodham Mortimer, Essex CM9 6SN  
 Tel: 01277 356511 os@open-spaces.co.uk



No dimensions are to be scaled from this drawing. All stated measurements are to be verified on site. Any discrepancies are to be brought to the attention of Open Spaces.

|  |   |
|--|---|
|  | Crown spread tree/group                 |
|  | A Category tree<br>Root Protection Area |
|  | B Category tree<br>Root Protection Area |
|  | C Category tree<br>Root Protection Area |
|  | U Category tree<br>Root Protection Area |
|  | Tree to be removed                      |
|  | Tree Protection barrier                 |
|  | Ground Protection                       |
|  | Existing features                       |
|  | Proposed Buildings / Access Road        |

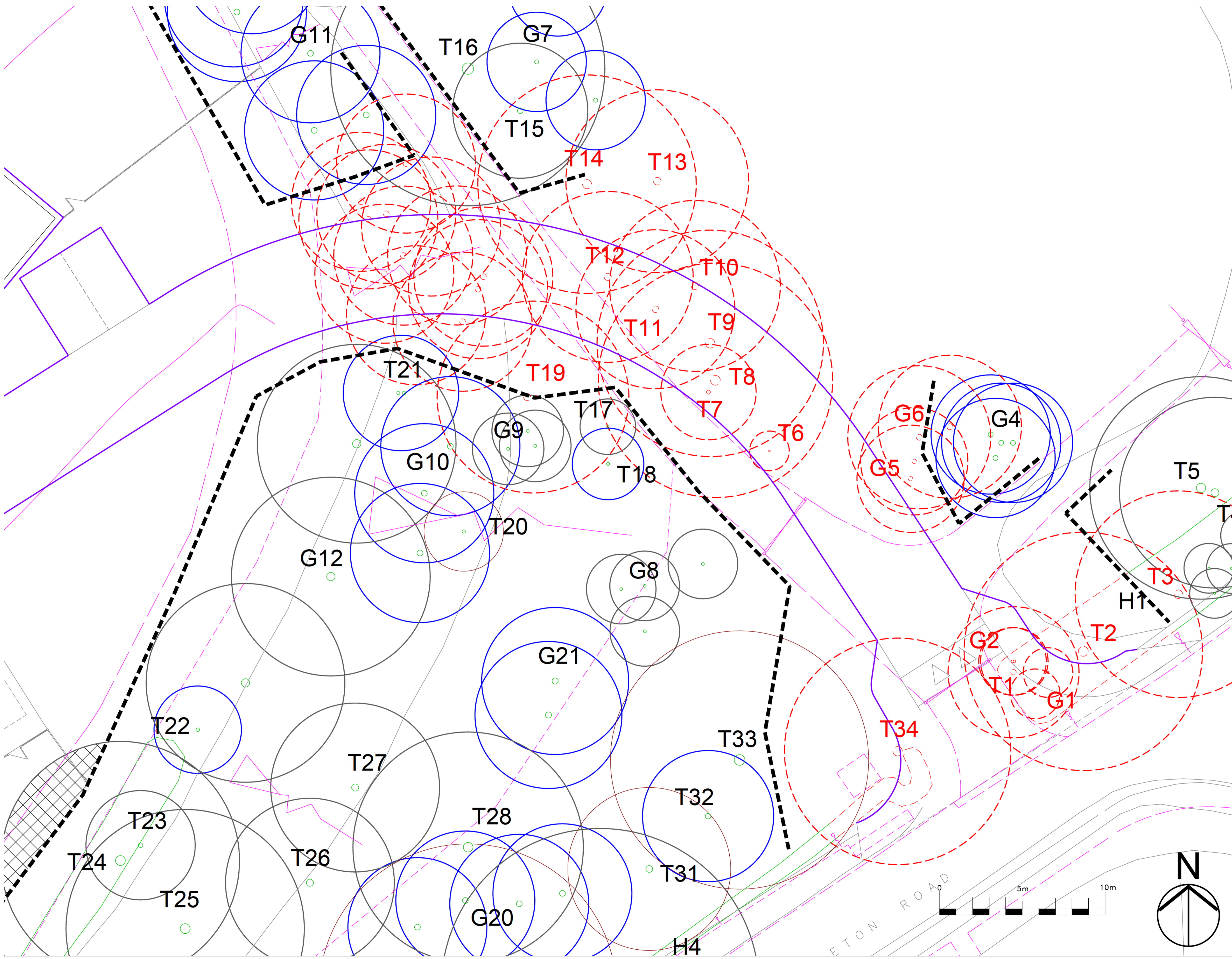

| Rev | Date       | Description    |
|-----|------------|----------------|
| A   | 07/12/2022 | Revised Layout |
|     |            |                |
|     |            |                |

Client: \_\_\_\_\_

Project: Grange Paddock, Eimdon

Drawing Title: Tree Protection Plan

|         |                |             |
|---------|----------------|-------------|
| Date:   | 15/11/2022     | Drawn: JS   |
| Scale:  | 1:100 on A1    | Checked: KM |
| Dwg No: | OS 2369-22-1-3 | Rev: A      |

**Open Spaces**  
 Landscape Architects  
 LANDSCAPE ARCHITECTURE - TREES - ECOLOGY  
 2 Monument Offices, Hall Farm, Maldon Road,  
 Woodham Mortimer, Essex CM9 6SN  
 Tel: 01277 356511 os@open-spaces.co.uk