

**PELHAM SPRING SOLAR FARM
ENVIRONMENTAL STATEMENT
TECHNICAL APPENDICES**

**APPENDIX 2.8 – SITE LOCATION PLAN & LAYOUT
FOR PLANNING APPLICATION 3/21/0969/FUL**

On behalf of Low Carbon Solar Park 6 Limited

Date: December 2022

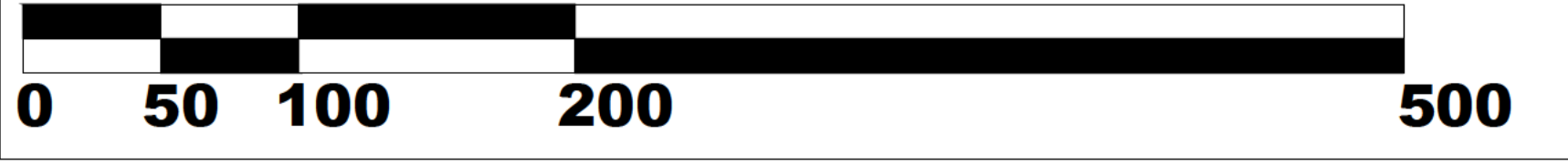
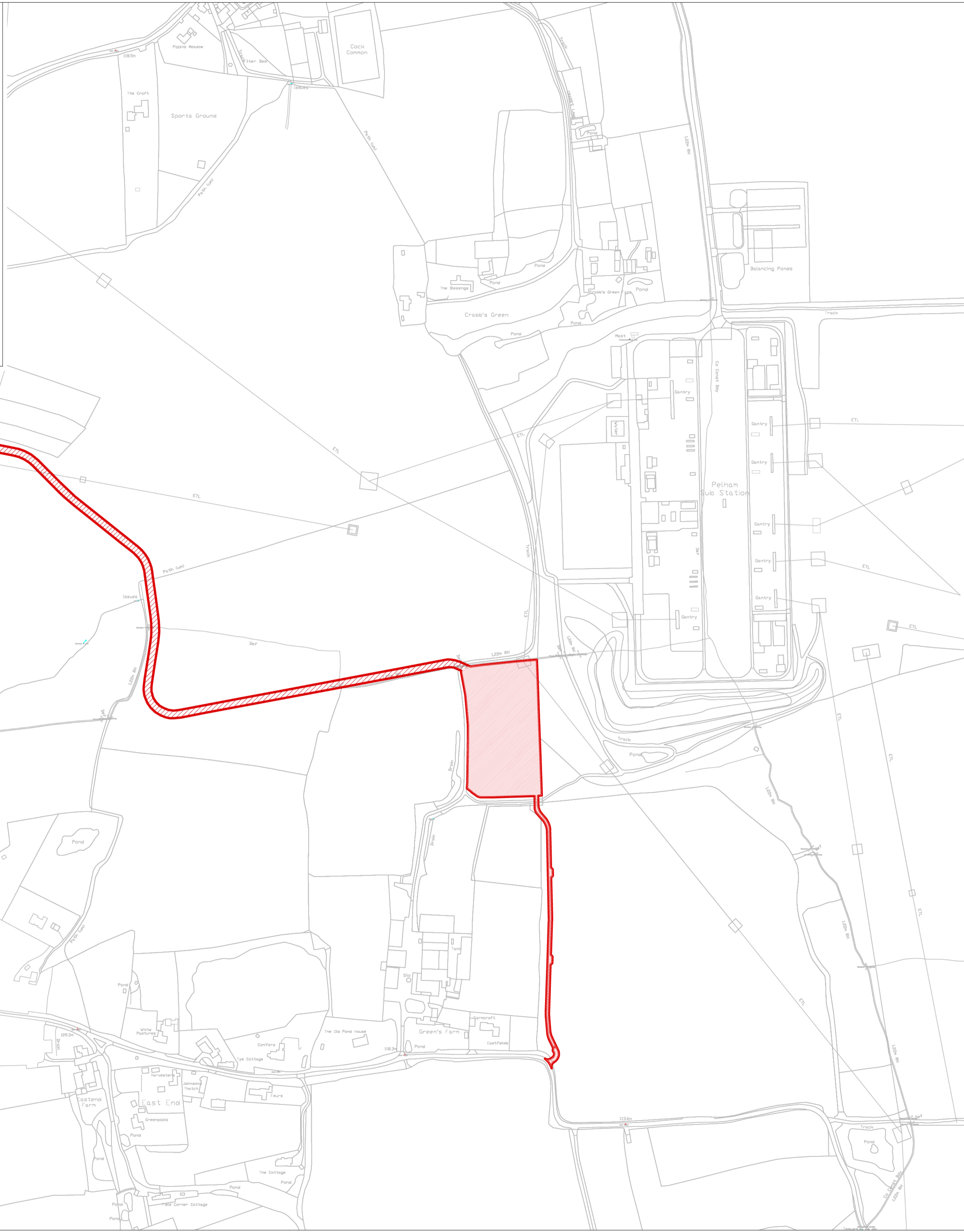
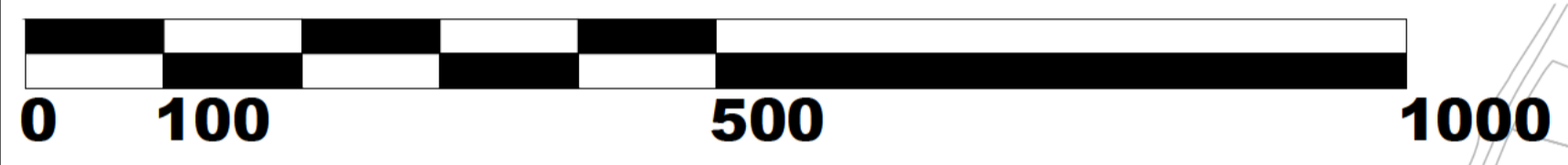
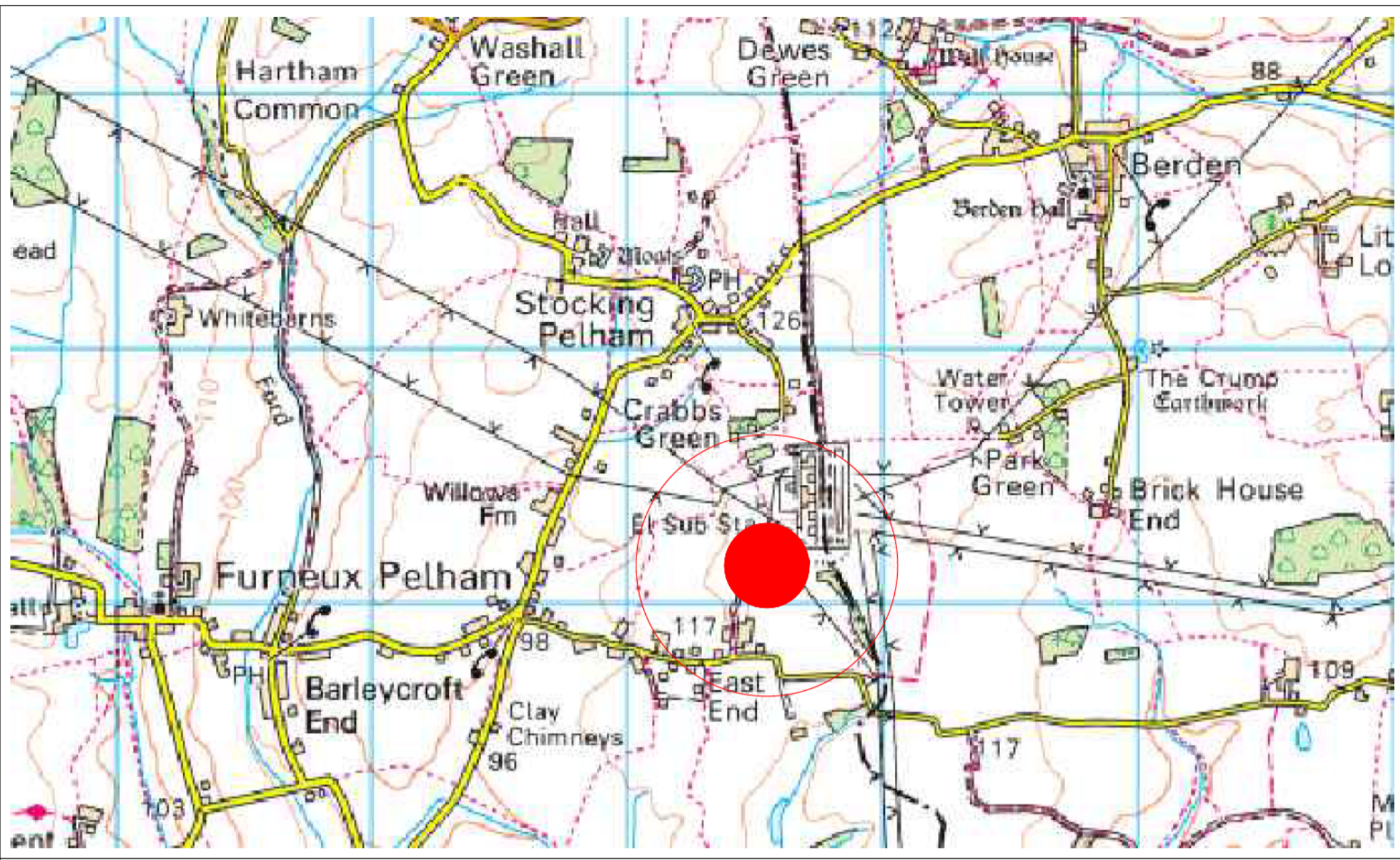

File Information
 Tuesday May 17 2022, 12:5 PM
 F:\Engineering\Grid Scale Energy AutoCAD\E000206315 - CPL Stocking Pelham\Cad\BESS-STP-TP-XX-XX-PL-06-DR-030 - Site Location Plan.dwg

THIS IS A CONTROLLED CAD DRAWING - MANUAL CHANGES MUST NOT BE MADE

Rev	Date	By	Description
P00	17/03/21	SW	Initial Issue
P01	25/03/21	SW	Drawing updated to suit client comments
P02	04/05/21	SW	Scale bars added
P03	14/04/22	SW	Site Boundary amended

Legend

- Application Site Boundary
- Site Location

This drawing may not show all existing underground/overhead or abandoned/redundant services.

The exact position of apparatus should be verified on site using approved location/avoidance techniques prior to excavation.



Draft for Planning

THIS DRAWING IS NOT TO BE USED FOR CONSTRUCTION

Client:
 SMS Energy Services & Pelham Power Ltd

Job Title:
 Stocking Pelham BESS

Drawing Title:
 Site Location Plan

Drawn: SW 04/05/21	Checked: PN 04/05/21
Approved: PN 04/05/21	Scale: 1:5000 & 1:2500 @ A1

© SMS PLC own the copyright of this drawing which is supplied in confidence and must not be used for any purpose other than that for which it is supplied and must not be reproduced without written permission from the owners.



SMS PLC, Prennau House, Cope Walk, Cardiff Gate Business Park, Cardiff CF23 8XH
 Tel: 029 2073 9500 Fax: 029 2073 9501 info@sms-plc.com

Project Number: E000206315	Drawing Number: BESS-STP-TP-XX-XX-PL-06-DR-030	Revision: P03
-------------------------------	---	------------------

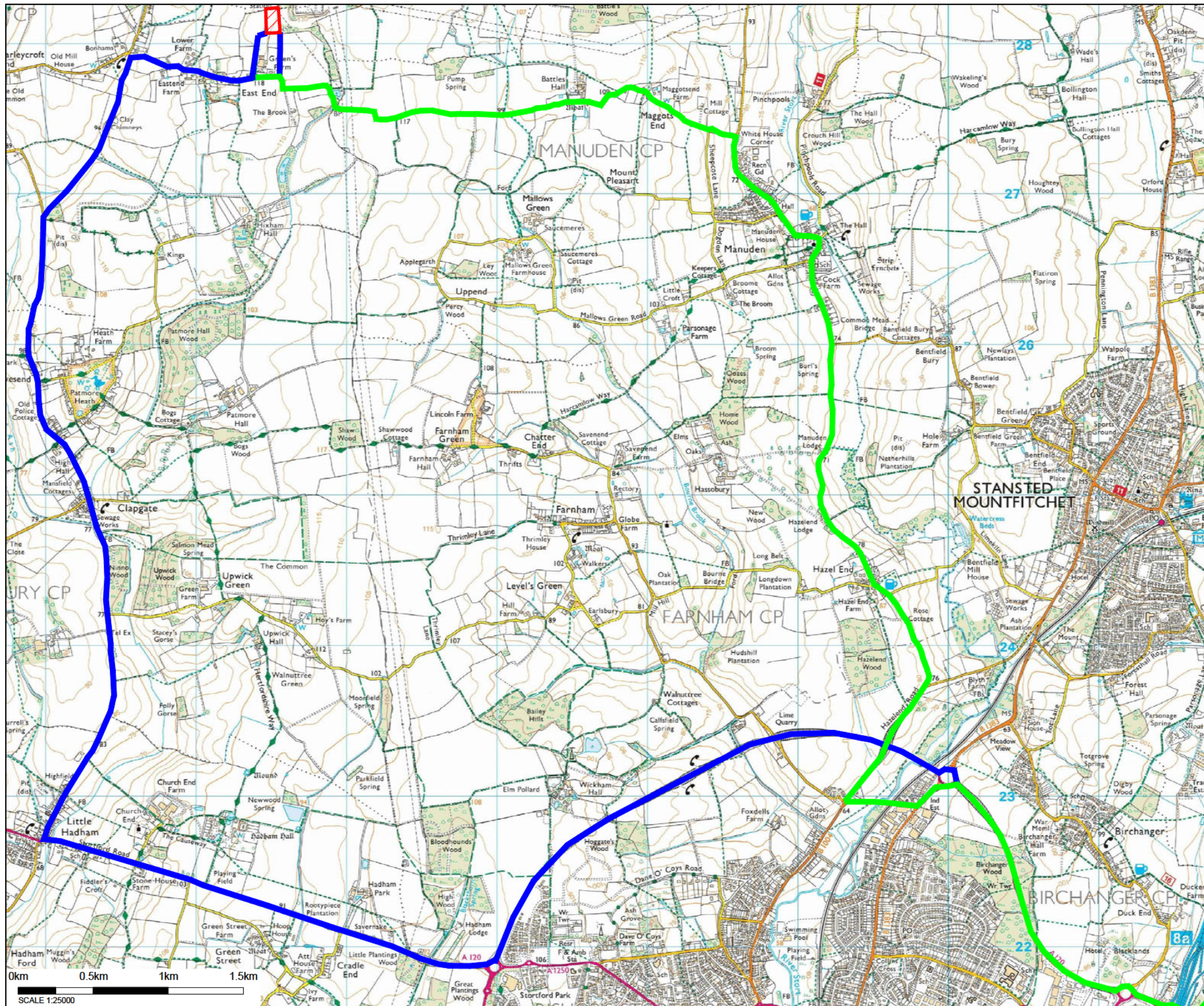

KEY

- SITE LOCATION
- CONSTRUCTION TRAFFIC ROUTE 1
- CONSTRUCTION TRAFFIC ROUTE 2

PRELIMINARY DRAWING:
 THIS DRAWING IS FOR PRELIMINARY PURPOSES ONLY
 AND MUST NOT BE READ AS A CONSTRUCTION ISSUE.
 IT INDICATES DESIGN INTENT ONLY AND IS SUBJECT TO
 AMENDMENT DURING FINAL DESIGN DEVELOPMENT.

REV	DESCRIPTION	DATE	BY	AUTH
P04	CHANGED DRAWING TO SCALE 1:25000	30.04.21	OT	LF
P03	PRELIMINARY ISSUE.	19.03.21	OT	LF
P02	PRELIMINARY ISSUE.	11.03.21	OT	LF
P01	PRELIMINARY ISSUE.	01.02.21	OT	LF

Rossi Long Consulting
 16 Meridian Way, Norwich, Norfolk, NR7 0TA
 T: 01603 706 420 www.rossilong.co.uk

CLIENT
PELHAM POWER Ltd

PROJECT
PROPOSED BATTERY STORAGE SITES (BBS) STOCKING PELHAM

TITLE
SITE LOCATION AND TRAFFIC ROUTING PLAN

DRAWN	AUTHORISED	DATE	SCALE AT A3
OT	LF	01/02/21	1:25000

SUITABILITY
PRELIMINARY

PROJECT NO.	DRAWING FIELDS	DRAWING NO.	REV
201279		SK-01	P4

SCALE 1:25000

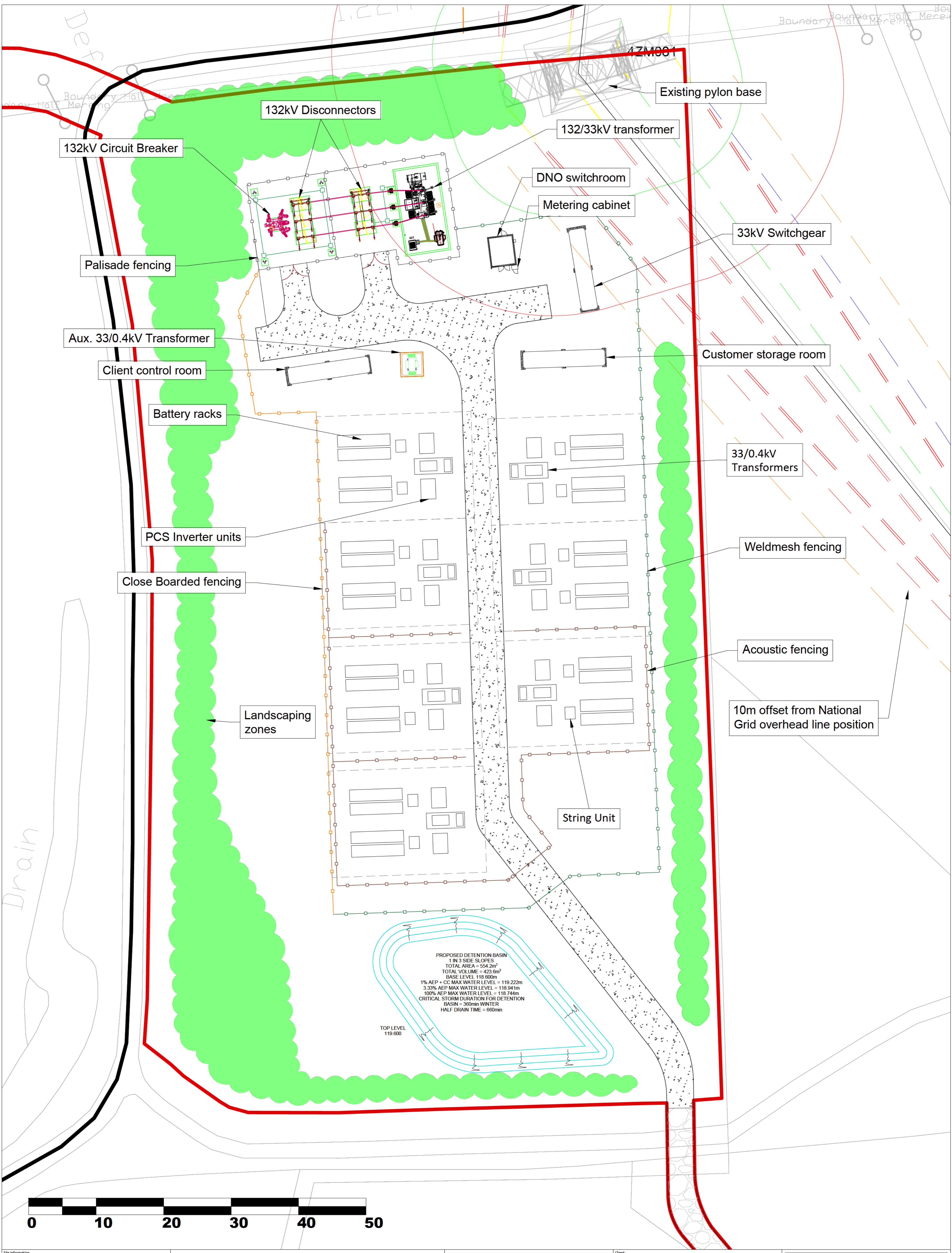

PROPOSED DETENTION BASIN
 1 IN 3 SIDE SLOPES
 TOTAL AREA = 554.2m²
 TOTAL VOLUME = 423.6m³
 BASE LEVEL = 118.600m
 1% AEP + CC MAX WATER LEVEL = 119.222m
 3.33% AEP MAX WATER LEVEL = 118.941m
 100% AEP MAX WATER LEVEL = 118.744m
 CRITICAL STORM DURATION FOR DETENTION BASIN = 360min WINTER
 HALF DRAIN TIME = 660min
 TOP LEVEL 119.600

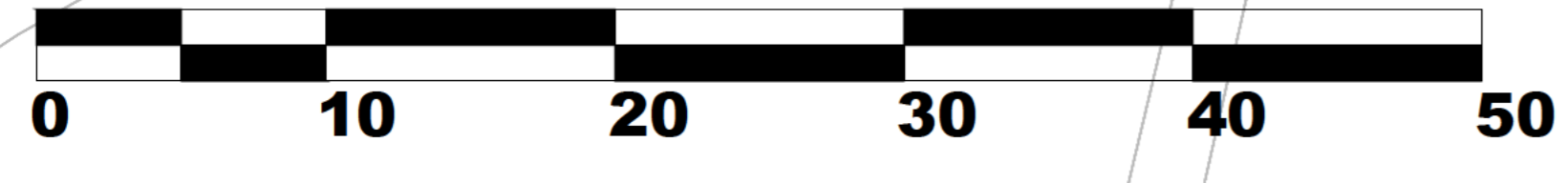

File Information
 Thursday April 14 2022, 4:6 PM
 \\upoffice\up\Engineering\Major Projects\01-ARCHIVED
 PROJECTS\RENEWABLES\SMS Projects\E000206315 - CPL Stocking
 Pelham\Cad\BESS-STP-TP-XX-XX-PL-06-DR-031, 032 & 047 - Proposed
 Layout-Plans.dwg
 THIS IS A CONTROLLED CAD DRAWING - MANUAL CHANGES MUST NOT BE MADE

Rev.	Date:	By:	Description:
P00	21/06/21	SW	Initial issue
P01	02/08/21	SW	Overhead line updated from National Grid records
P02	23/11/21	SW	Close boarded fencing added
P03	14/04/22	SW	Layout updated

Legend
 Application Site Boundary

This drawing may not show all existing underground/overhead or abandoned/redundant services.
 The exact position of apparatus should be verified on site using approved location/avoidance techniques prior to excavation.

Draft for Planning
 THIS DRAWING IS NOT TO BE USED FOR CONSTRUCTION

Client: SMS Energy Services & Pelham Power Ltd
 Job Title: Stocking Pelham BESS
 Drawing Title: Proposed Layout Plan with National Grid Overhead Line
 Drawn: SW 23/11/21
 Checked: PN 23/11/21
 Approved: PN 23/11/21
 Scale: 1:250 @ A1

SMS PLC own the copyright of this drawing which is supplied in confidence and must not be used for any purpose other than that for which it is supplied and must not be reproduced without written permission from the owners.

SMS PLC, Prennau House, Copse Walk, Cardiff Gate Business Park, Cardiff CF23 8XH
 Tel: 029 2073 9500 Fax: 029 2073 9501 info@sms-plc.com

Project Number: E000206315
 Drawing Number: BESS-STP-TP-XX-XX-PL-06-DR-047
 Revision: P03

Town & Country Planning Act 1990 (as amended)
Planning and Compulsory Purchase Act 2004

Expertly Done.

DESIGN | ECONOMICS | ENVIRONMENT | HERITAGE | LAND & PROPERTY | PLANNING | TRANSPORT & INFRASTRUCTURE

Pegasus Group is a trading name of Pegasus Planning Group Limited (07277000) registered in England and Wales.

Registered office: Querns Business Centre, Whitworth Road, Cirencester, Gloucestershire, GL7 1RT
We are ISO certified 9001, 14001, 45001



[Pegasus_Group](#)



[pegasusgroup](#)



[Pegasus_Group](#)

[PEGASUSGROUP.CO.UK](https://www.pegasusgroup.co.uk)