

# Notice of partial surrender, variation and consolidation with introductory note

The Environmental Permitting (England & Wales) Regulations 2016

---

G. E. Porter & Sons Limited

Barn Farm Chicken Unit (comprised of Poplar Farm and Barn Farm)

Barn Farm

Lowfields

Navenby

Lincoln

LN5 0LN

## Partial surrender and variation application number

EPR/FP3739UW/S005

## Permit number

EPR/FP3739UW

# Barn Farm Chicken Unit (comprised of Poplar Farm and Barn Farm)

## Permit number EPR/FP3739UW

### Introductory note

#### **This introductory note does not form a part of the notice.**

Under the Environmental Permitting (England & Wales) Regulations 2016 (schedule 5, part 1, paragraph 19) a variation may comprise a consolidated permit reflecting the variations and a notice specifying the variations included in that consolidated permit.

Schedule 1 of the notice specifies the conditions that have been varied and schedule 2 comprises a consolidated permit which reflects the variations being made. All the conditions of the permit have been varied and are subject to the right of appeal.

Barn Farm Chicken and Pig Unit encompasses two farms operated by GE Porter & Sons Limited. The installation consists of Barn Farm and Poplar Farm. Barn Farm is approximately centred on NGR SK 94709 57910 and Poplar Farm is approximately centred on NGR SK 94298 85334. The installation is approximately three kilometres west of the village of Navenby, Lincoln.

#### This variation and part surrender authorises the following changes:

- *The surrender of all the pig activities, houses and associated land at Barn farm.*
- *An additional poultry house at Barn farm (now 6 poultry houses)*
- *An increase in broiler places at Barn Farm from 232,500 to 289,000.*
- *The installation of a 1.7MWth Biomass boiler at Barn Farm retaining the LPG heating as a backup.*
- *The installation of a 1.7MWth Biomass boiler at Poplar Farm retaining the LPG heating as a backup.*

We have reviewed the new housing introduced with the permit variation for this installation against the best available techniques (BAT) conclusions as defined in the intensive rearing of poultry or pigs (IRPP) BAT conclusions document, dated 21/02/17. The permit conditions and schedules ensure the compliance of the new housing with this BAT conclusions document. We have previously reviewed the existing housing, permitted before 21/02/17, to ensure compliance.

#### The rest of the installation is unchanged and is operated as follows:

The broilers kept at both Barn Farm and Poplar Farm with 262,000 broiler places (6 houses) are brought in as day old chicks. All poultry houses are ventilated by high velocity roof fans with an emission point higher than 5.5 metres above ground level and an efflux speed greater than 9.3 metres per second.

The birds are grown to approximately 35 days of age and throughout the growing cycle water, feed and temperatures are all automatically monitored and recorded. The birds are stocked on concrete floors covered with wood shavings. At the end of the growing period, the buildings are cleaned and wash water is channelled and stored in underground tanks at Poplar Farm and in a lagoon at Barn Farm, and later spread to operator controlled land under the Manure Management Plan.

The areas immediately surrounding the poultry houses at the installation are concreted. Roof water and uncontaminated yard run off from all poultry (excluding periods of washout when water from the yard drains to the lagoon) from both farms flows via drains to dykes in the surrounding fields, and ultimately meets the River Brant.

Feed for both Farms is purchased from the adjacent feed mill and is under common ownership with the farms. On the farm feed is stored in fibreglass bins.

Any fallen stock from either farm are kept in vermin proof containers and are incinerated on site at their respective farms in a (<50 kg/hour) incinerator which has been approved by the State Veterinary Service.

Litter from the poultry houses on both Farms are either spread via the use of a Manure Management Plan on operator owned land farmed by G. E Porter & Sons Limited, or spread on land owned by third parties.

There are no Special Areas of Conservation (SAC), Special Protection Areas (SPA) or Ramsars within 10km of the installation. In addition there are no Sites of Special Scientific Interest (SSSI) within 5km of the installation, and no other nature conservation sites within 2km comprising of Local Wildlife Sites (LWS) or ancient woodlands. An assessment of the impact of emissions has been carried out and the installation is considered to have no adverse effect on the nature conservation sites.

This permit implements the requirements of the European Union Directive on Industrial Emissions.

The schedules specify the changes made to the permit.

The status log of a permit sets out the permitting history, including any changes to the permit reference number.

Status log of the permit		
Description	Date	Comments
Application received EPR/FP3739UW/A001	12/03/07	
Permit determined	27/09/07	
Application received EPR/FP3739UW/V002	20/04/10	
Variation determined	29/04/10	
Application received	Duly made 26/07/17	Application to increase pig and poultry numbers.
Additional information	19/09/17	Confirming that operator has entered into a Climate Change Agreement, confirmation that there will be no changes to existing animal housing and no new houses to accommodate changes in pig, and confirmation that there are no French drains in the routing of roof water from the poultry houses to surface water. The drains are enclosed through to the discharge points.
Additional information received	20/09/17	Confirmation that there is an incinerator at Poplar Farm, confirmation that birds are grown to approximately 35 days, and confirmation that poultry litter is sometimes exported to third parties and it is not incinerated.
Additional information received	04/10/17	Confirmation that an incinerator is present at both Barn Farm and Poplar Farm and updated site plans showing the location of both incinerators.
Additional information received	13/10/17	Confirmation that each incinerator has a capacity of 50kg/hour, and confirmation that the fans in the poultry houses are high velocity.
Variation determined EPR/FP3739UW/V003 (Billing reference: FP3930RP)	23/10/17	Varied and consolidated permit issued in modern condition format.
Variation determined EPR/FP3739UW/V004 (Billing Reference CP3504LC)	21/05/21	Environment Agency initiated variation for Intensive Farming BAT compliance permit review
Application EPR/FP3739UW/S005 (variation and consolidation)	Duly made 10/10/22	Application for Barn farm to surrender pig activities and associated land, increase broiler numbers to 289,000, an additional shed, the

Status log of the permit		
Description	Date	Comments
		installation of a 1.7MWth Biomass boiler and update the permit to modern conditions.
Additional information received	17/11/22	In response to 15/11/22 additional information request confirming that operator has entered into a Climate Change Agreement, LPG heating is being retained as a backup, receptors within 100 meters of the site are associated with the farm
Additional information received	28/11/22	In response to 28/11/22 additional information request revised documents H1 Risk Assessment and Technical Standards.
Additional information received	21/12/22	Application updated to include an additional 1.7MWth Biomass boiler at Poplar Farm. Revised Non-Technical summary, additional C2.5 for Poplar Farm, updated Dust and Bio-aerosol Management Plan, site layout plan for Poplar Farm, revised site boundary plan.
Additional information received	03/01/22	Confirmation all existing and new roof fans are high velocity.
Variation determined EPR/FP3739UW (Billing reference: BP3743QJ)	11/01/23	Partial surrender accepted and varied and consolidated permit issued in modern condition format.

End of introductory note

# Notice of partial surrender, variation and consolidation

## The Environmental Permitting (England and Wales) Regulations 2016

The Environment Agency in exercise of its powers under regulation 20 of the Environmental Permitting (England and Wales) Regulations 2016 varies and consolidates

### Permit number

**EPR/FP3739UW**

### Issued to

**G. E. Porter & Sons Limited** ("the operator")

whose registered office is

**Barn Farm**

**Lowfields**

**Navenby**

**Lincoln**

**LN5 0LN**

company registration number **03256399**

to operate an installation at

**Barn Farm**

**and**

**Poplar Farm**

**Lowfields**

**Lowfields**

**Navenby**

**Navenby**

**Lincoln**

**Lincoln**

**LN5 0LN**

**LN5 0LN**

to the extent set out in the schedules.

The notice shall take effect from 11/01/2023

Name	Date
<b>Daniel Timney</b>	<b>11/01/2023</b>

Authorised on behalf of the Environment Agency

## **Schedule 1**

All conditions have been varied by the consolidated permit EPR/FP3739UW as a result of the application made by the operator.

## **Schedule 2 – consolidated permit**

Consolidated permit issued as a separate document.

# Permit

## The Environmental Permitting (England and Wales) Regulations 2016

### Permit number

**EPR/FP3739UW**

This is the consolidated permit referred to in the partial surrender, variation and consolidation notice for application EPR/FP3739UW/S005 authorising,

**G. E. Porter & Sons Limited** ("the operator"),

whose registered office is

**Barn Farm**

**Lowfields**

**Navenby**

**Lincoln**

**LN5 0LN**

company registration number **03256399**

to operate an installation at

**Barn Farm**

**and**

**Poplar Farm**

**Lowfields**

**Lowfields**

**Navenby**

**Navenby**

**Lincoln**

**Lincoln**

**LN5 0LN**

**LN5 0LN**

to the extent authorised by and subject to the conditions of this permit.

Name	Date
<b>Daniel Timney</b>	<b>11/01/2023</b>

Authorised on behalf of the Environment Agency

# Conditions

## 1 Management

### 1.1 General management

- 1.1.1 The operator shall manage and operate the activities:
- (a) in accordance with a written management system that identifies and minimises risks of pollution, so far as is reasonably practicable, including those risks arising from operations, maintenance, accidents, incidents, non-conformances, closure and those drawn to the attention of the operator as a result of complaints; and
  - (b) using sufficient competent persons and resources.
- 1.1.2 Records demonstrating compliance with condition 1.1.1 shall be maintained.
- 1.1.3 Any person having duties that are or may be affected by the matters set out in this permit shall have convenient access to a copy of the permit.

### 1.2 Energy efficiency

- 1.2.1 The operator shall:
- (a) take appropriate measures to ensure that energy is used efficiently in the activities; and
  - (b) maintain records of fuel and energy consumption used in the activities;

### 1.3 Efficient use of raw materials

- 1.3.1 The operator shall:
- (a) take appropriate measures to ensure that raw materials and water are used efficiently in the activities; and
  - (b) maintain records of raw materials and water used in the activities;

### 1.4 Avoidance, recovery and disposal of wastes produced by the activities

- 1.4.1 The operator shall take appropriate measures to ensure that the waste hierarchy referred to in Article 4 of the Waste Framework Directive is applied to the generation of waste by the activities and that;
- (a) any waste generated by the activities is treated in accordance with the waste hierarchy referred to in Article 4 of the Waste Framework Directive; and
  - (b) where disposal is necessary, this is undertaken in a manner which minimises its impact on the environment.

## 2 Operations

### 2.1 Permitted activities

- 2.1.1 The only activities authorised by the permit are the activities specified in schedule 1 table S1.1 (the “activities”).



## **2.2 The site**

- 2.2.1 The activities shall not extend beyond the site, being the land shown edged in green on the site plan at schedule 7 to this permit.

## **2.3 Operating techniques**

- 2.3.1 The activities shall, subject to the conditions of this permit, be operated using the techniques and in the manner described in the documentation specified in schedule 1, table S1.2, unless otherwise agreed in writing by the Environment Agency.
- 2.3.2 If notified by the Environment Agency that the activities are giving rise to pollution, the operator shall submit to the Environment Agency for approval within the period specified, a revision of any plan or other documentation ("plan") specified in schedule 1, table S1.2 or otherwise required under this permit which identifies and minimises the risks of pollution relevant to that plan, and shall implement the approved revised plan in place of the original from the date of approval, unless otherwise agreed in writing by the Environment Agency.
- 2.3.3 The operator shall maintain and implement a system to record the number of animal places and animal movements.
- 2.3.4 The operator shall ensure that a diet formulation and nutritional strategy is used to reduce the total nitrogen and total phosphorus excreted.
- 2.3.5 The operator shall take appropriate measures in disposal or recovery of solid manure or slurry to prevent, or where this is not practicable, to minimise pollution.
- 2.3.6 Any raw materials or fuels listed in schedule 2 table S2.1 shall conform to the specifications set out in that table.
- 2.3.7 The operator shall ensure that where waste produced by the activities is sent to a relevant waste operation, that operation is provided with the following information, prior to the receipt of the waste:
- (a) the nature of the process producing the waste;
  - (b) the composition of the waste;
  - (c) the handling requirements of the waste;
  - (d) the hazardous property associated with the waste, if applicable; and
  - (e) the waste code of the waste.

## **2.4 Improvement programme**

- 2.4.1 The operator shall complete the improvements specified in schedule 1 table S1.3 by the date specified in that table unless otherwise agreed in writing by the Environment Agency.
- 2.4.2 Except in the case of an improvement which consists only of a submission to the Environment Agency, the operator shall notify the Environment Agency within 14 days of completion of each improvement.

## **3 Emissions and monitoring**

### **3.1 Emissions to water, air or land**

- 3.1.1 There shall be no point source emissions to water, air or land except from the sources and emission points specified in table S3.1 and S3.2.
- 3.1.2 The limits given in schedule 3 shall not be exceeded.
- 3.1.3 Periodic monitoring shall be carried out at least once every 5 years for groundwater and 10 years for soil, unless such monitoring is based on a systematic appraisal of the risk of contamination.

## **3.2 Emissions of substances not controlled by emission limits**

- 3.2.1 Emissions of substances not controlled by emission limits shall not cause pollution. The operator shall not be taken to have breached this condition if appropriate measures, including, but not limited to, those specified in any approved emissions management plan, have been taken to prevent or where that is not practicable, to minimise, those emissions.
- 3.2.2 The operator shall:
- (a) if notified by the Environment Agency that the activities are giving rise to pollution, submit to the Environment Agency for approval within the period specified, an emissions management plan which identifies and minimises the risks of pollution from emissions of substances not controlled by emission limits; and
  - (b) implement the approved emissions management plan, from the date of approval, unless otherwise agreed in writing by the Environment Agency.
- 3.2.3 All liquids in containers, whose emission to water or land could cause pollution, shall be provided with secondary containment, unless the operator has used other appropriate measures to prevent or where that is not practicable, to minimise, leakage and spillage from the primary container.

## **3.3 Odour**

- 3.3.1 Emissions from the activities shall be free from odour at levels likely to cause pollution outside the site, as perceived by an authorised officer of the Environment Agency, unless the operator has used appropriate measures, including, but not limited to, those specified in any approved odour management plan, to prevent or where that is not practicable to minimise the odour.

## **3.4 Noise and vibration**

- 3.4.1 Emissions from the activities shall be free from noise and vibration at levels likely to cause pollution outside the site, as perceived by an authorised officer of the Environment Agency, unless the operator has used appropriate measures, including, but not limited to, those specified in any approved noise and vibration management plan to prevent or where that is not practicable to minimise the noise and vibration.

## **3.5 Monitoring**

- 3.5.1 The operator shall, unless otherwise agreed in writing by the Environment Agency, undertake the monitoring specified in the following tables in schedule 3 to this permit:
- (a) point source emissions specified in tables S3.1 and S3.2; and
  - (b) process monitoring specified in table S3.3
- 3.5.2 The operator shall maintain records of all monitoring required by this permit including records of the taking and analysis of samples, instrument measurements (periodic and continual), calibrations, examinations, tests and surveys and any assessment or evaluation made on the basis of such data.
- 3.5.3 Monitoring equipment, techniques, personnel and organisations employed for the emissions monitoring programme and the environmental or other monitoring specified in condition 3.5.1 shall have either MCERTS certification or MCERTS accreditation (as appropriate), where available, unless otherwise agreed in writing by the Environment Agency.

## **3.6 Pests**

- 3.6.1 The activities shall not give rise to the presence of pests which are likely to cause pollution, hazard or annoyance outside the boundary of the site. The operator shall not be taken to have breached this condition if appropriate measures, including, but not limited to, those specified in any approved pests management plan, have been taken to prevent or where that is not practicable, to minimise the presence of pests on the site.

3.6.2 The operator shall:

- (a) if notified by the Environment Agency, submit to the Environment Agency for approval within the period specified, a pests management plan which identifies and minimises risks of pollution, hazard or annoyance from pests; and
- (b) implement the pests management plan, from the date of approval, unless otherwise agreed in writing by the Environment Agency.

## 4 Information

### 4.1 Records

4.1.1 All records required to be made by schedules 3, 4 and 5 to this permit shall:

- (a) be legible;
- (b) be made as soon as reasonably practicable;
- (c) if amended, be amended in such a way that the original and any subsequent amendments remain legible, or are capable of retrieval; and
- (d) be retained, unless otherwise agreed in writing by the Environment Agency, for at least 6 years from the date when the records were made, or in the case of the following records until permit surrender:
  - (i) off-site environmental effects; and
  - (ii) matters which affect the condition of the land and groundwater.

4.1.2 The operator shall maintain convenient access, in either electronic or hard copy, to the records, plans and management system required to be maintained by this permit.

### 4.2 Reporting

4.2.1 The operator shall send all reports and notifications required by the permit to the Environment Agency using the contact details supplied in writing by the Environment Agency.

4.2.2 For the following activities referenced in schedule 1, table S1.1 a report or reports on the performance of the activities over the previous year shall be submitted to the Environment Agency by 31 January (or other date agreed in writing by the Environment Agency) each year. The report(s) shall include as a minimum:

- (a) a review of the results of the monitoring and assessment carried out in accordance with the permit including an interpretive review of that data.

4.2.3 Within 28 days of the end of the reporting period the operator shall, unless otherwise agreed in writing by the Environment Agency, submit reports of the monitoring and assessment carried out in accordance with the conditions of this permit, as follows:

- (a) in respect of the parameters and emission points specified in schedule 4 table S4.1;
- (b) for the reporting periods specified in schedule 4 table S4.1 and using the forms specified in schedule 4 table S4.2; and
- (c) giving the information from such results and assessments as may be required by the forms specified in those tables.

4.2.4 The operator shall, unless notice under this condition has been served within the preceding four years, submit to the Environment Agency, within six months of receipt of a written notice, a report assessing whether there are other appropriate measures that could be taken to prevent, or where that is not practicable, to minimise pollution.

## 4.3 Notifications

### 4.3.1 In the event:

- (a) that the operation of the activities gives rise to an incident or accident which significantly affects or may significantly affect the environment, the operator must immediately :-
  - (i) inform the Environment Agency,
  - (ii) take the measures necessary to limit the environmental consequences of such an incident or accident, and
  - (iii) take the measures necessary to prevent further possible incidents or accidents; and
- (b) of a breach of any permit condition the operator must immediately :-
  - (i) inform the Environment Agency, and
  - (ii) take the measures necessary to ensure that compliance is restored within the shortest possible time;
- (c) of a breach of permit condition which poses an immediate danger to human health or threatens to cause an immediate significant adverse effect on the environment, the operator must immediately suspend the operation of the activities or the relevant part of it until compliance with the permit conditions has been restored.

4.3.2 Any information provided under condition 4.3.1 shall be confirmed by sending the information listed in schedule 5 to this permit within the time period specified in that schedule.

4.3.3 Where the Environment Agency has requested in writing that it shall be notified when the operator is to undertake monitoring and/or spot sampling, the operator shall inform the Environment Agency when the relevant monitoring and/or spot sampling is to take place. The operator shall provide this information to the Environment Agency at least 14 days before the date the monitoring is to be undertaken.

4.3.4 The Environment Agency shall be notified within 14 days of the occurrence of the following matters, except where such disclosure is prohibited by Stock Exchange rules:

Where the operator is a registered company:

- (a) any change in the operator's trading name, registered name or registered office address; and
- (b) any steps taken with a view to the operator going into administration, entering into a company voluntary arrangement or being wound up.

Where the operator is a corporate body other than a registered company:

- any change in the operator's name or address; and
- (b) any steps taken with a view to the dissolution of the operator.

In any other case:

- the death of any of the named operators (where the operator consists of more than one named individual);
- (b) any change in the operator's name(s) or address(es); and
- (c) any steps taken with a view to the operator, or any one of them, going into bankruptcy, entering into a composition or arrangement with creditors, or, in the case of them being in a partnership, dissolving the partnership.

4.3.5 Where the operator proposes to make a change in the nature or functioning, or an extension of the activities, which may have consequences for the environment and the change is not otherwise the subject of an application for approval under the Regulations or this permit:

- (a) the Environment Agency shall be notified at least 14 days before making the change; and
- (b) the notification shall contain a description of the proposed change in operation.

- 4.3.6 The Environment Agency shall be given at least 14 days' notice before implementation of any part of the site closure plan.
- 4.3.7 Where the operator has entered into a climate change agreement with the Government, the Environment Agency shall be notified within one month of:
- (a) a decision by the Secretary of State not to re-certify the agreement;
  - (b) a decision by either the operator or the Secretary of State to terminate the agreement; and
  - (c) any subsequent decision by the Secretary of State to re-certify such an agreement.

## **4.4 Interpretation**

- 4.4.1 In this permit the expressions listed in schedule 6 shall have the meaning given in that schedule.
- 4.4.2 In this permit references to reports and notifications mean written reports and notifications, except where reference is made to notification being made "immediately", in which case it may be provided by telephone.

# Schedule 1 – Operations

Table S1.1 Activities		
Activity listed in Schedule 1 of the EP Regulations	Description of specified activity	Limits of specified activity
Section 6.9 A(1)(a)(i) Rearing of poultry intensively in an installation with more than 40,000 places	The rearing of poultry in a facility with a capacity for 551,000 broiler places.  Barn Farm: 289,000 Poplar Farm: 262,000	From receipt of birds, raw materials and fuels onto the site to removal of birds and associated wastes from site.
Section 5.1 B (a) (vi) Carcass incineration	Operation of two Incinerators for carcass disposal Animal and Plant Health Agency (APHA) approved < 50 kg/hr one at Barn Farm and one at Poplar Farm.	From receipt of raw materials, fuels and input of carcasses to release of combustion products to air and associated wastes removed from site.  1 incinerator at each farm, each with a capacity of 50kg/hr and a combined capacity of 100kg/hr
Directly Associated Activity	Description of specified activity	Limits of specified activity
Medium Combustion Plant	Operation of 2 biomass boilers with an aggregated thermal rated input not exceeding 3.4 megawatts. Individual unit for site heating requirements, burning biomass fuel not comprising waste or animal carcasses. One at Barn Farm and one at Poplar Farm.	From receipt of raw materials and fuels, to release of combustion products to air and associated wastes removed from site.

Table S1.2 Operating techniques		
Description	Parts	Date Received
Application EPR/FP3739UW/A001	The responses to sections B2.3.1, B2.3.2, B2.3.3, B2.5.1, B2.5.2, B2.5.3, B2.6.1, B2.6.2, B2.6.3, B2.7.1 and B2.7.2 in the application	12/03/07
Application EPR/FP3739UW/V003	Responses to Parts C3.5 of the application form and referenced supporting documentation.	26/07/17
Additional information requested 07/09/17	Response to RFI confirming that operator has entered into a Climate Change Agreement, confirmation that there will be no changes to existing animal housing and no new houses to accommodate changes in pig numbers and confirmation that there are no French drains in the routing of roof water from the poultry houses to surface water. The drains are enclosed through to the discharge points.	19/09/17
Additional information requested 21/09/17	Confirmation that an incinerator is present at both Barn Farm and Poplar Farm and updated site plans showing the location of both incinerators.	04/10/17

Table S1.2 Operating techniques		
Description	Parts	Date Received
Additional information requested 05/10/17	Confirmation that each incinerator has a capacity of 50kg/hour, and confirmation that the fans in the poultry houses are high velocity.	13/10/17
Application EPR/FP3739UW/S005 (part surrender, variation and consolidation)	<p>Responses to Part C3.5 of the application form and referenced supporting documentation.</p> <p>Additional information received in response to not duly made request for information including confirmation of compliance with all relevant best available techniques (BAT) conclusions as defined in the intensive rearing of poultry or pigs (IRPP) BAT conclusions document, dated 21/02/17, and receipt of the following documents:</p> <p>(Revised) Dust and bioaerosol management plan– reference G E Porter and Sons – Barn and Poplar Farms (EA/EPR/FP3739UW/V004)</p> <p>(Revised) Odour management plan- reference G E Porter and Sons – Barn and Poplar Farms (EA/EPR/FP3739UW/V004)</p> <p>(Revised) Noise management plan- reference G E Porter and Sons – Barn and Poplar Farms (EA/EPR/FP3739UW/V004)</p>	10/10/22
Additional information requested 15/11/22	Response to Request for Information confirming all sensitive receptors within 100m are associated with the farm and the retention of LPG heating as backup.	17/11/22
Additional information requested 28/11/22	Revised technical standards document provided in response to section 8a – technical standards of the application form C3.5.	28/11/22
Additional information 21/12/22	<p>Revised and additional documents for a 1.7MWth Biomass boiler biomass boiler at Poplar Farm being added to the application.</p> <p>(Revised) Non-Technical summary, Reference- Submitted as part of the application to vary the permit for Barn Farm (comprised of Poplar Farm and Barn Farm) EPR/FP3739UW – revised December 2022</p> <p>(Additional) C2.5 for Poplar Farm</p> <p>(Revised) Dust and Bio-aerosol Management Plan - reference G E Porter and Sons – Barn and Poplar Farms (EA/EPR/FP3739UW/V004) December 2022</p>	21/12/22
Additional information 03/01/22	Confirmation all existing and new roof fans are high velocity.	03/01/23

Table S1.3 Improvement programme requirements		
Reference	Requirement: Barn Farm	Date
IC1	<p>A written plan shall be submitted to the Agency for approval detailing proposals for replacing or covering existing uncovered slurry stores and lagoons to comply with the requirements of section 5.3.1 and 6.3.1 of TGN How to Comply, Version 1. The proposals shall include a timetable for the replacement and refurbishment work. The notification requirements of condition 2.5.2 shall be deemed to have been complied with on submission of the plan.</p> <p>The plan shall be implemented by the operator subject to such amendments or additions as notified by the Agency in writing.</p>	completed

<b>Table S1.3 Improvement programme requirements</b>		
IC2	The Operator shall ensure that methods are implemented to prevent, or where that is not practicable minimise, the potential for diffuse pollution from the foodstuff storage vessels by protecting them from collision damage.	completed 16/09/08
IC3	A written plan shall be submitted to the Agency for approval following a review of all site drainage at the installation. The review should take into account the appropriate measures in S3.3 of TGN How to Comply, Version 1, and include a timetable for any improvements to the drainage system. The notification requirements of condition 2.5.2 shall be deemed to have been complied with on submission of the plan.  The plan shall be implemented subject to such amendments or additions as notified by the Agency in writing.	completed 10/10/08
IC4	A written plan shall be submitted to the Agency for approval following a review of existing pig and poultry housing and management practices at the installation. The review should take into account the appropriate measures in S5.2.1 & S5.2.2 and 6.2.1 & S6.2.2 of TGN How to Comply, Version 1. The review shall identify measures to reduce emissions to all media, the likely cost of such measures and a proposed timetable for their implementation. The notification requirements of condition 2.5.2 shall be deemed to have been complied with on submission of the plan.  The plan shall be implemented subject to such amendments or additions as notified by the Agency in writing.	completed 10/10/08
<b>Reference</b>	<b>Requirement: Poplar Farm</b>	<b>Date</b>
IC5	The operator shall bund the Agricultural fuel oil storage facilities to comply with the requirements of S3.3 of TGN How to Comply, Version 1.	completed 09/09/08
IC6	The Operator shall ensure that methods are implemented to prevent, or where that is not practicable minimise, the potential for diffuse pollution from the foodstuff storage vessels by protecting them from collision damage.	completed 16/09/08
IC7	A written plan shall be submitted to the Agency for approval following a review of all site drainage at the installation. The review should take into account the appropriate measures in S3.3 of TGN How to Comply, Version 1, and include a timetable for any improvements to the drainage system. The notification requirements of condition 2.5.2 shall be deemed to have been complied with on submission of the plan.  The plan shall be implemented subject to such amendments or additions as notified by the Agency in writing.	completed 10/10/08
IC8	A written plan shall be submitted to the Agency for approval following a review of existing poultry housing and management practices at the installation. The review should take into account the appropriate measures in S5.2.1& S5.2.2 and 6.2.1 & S6.2.2 of TGN How to Comply, Version 1. The review shall identify measures to reduce emissions to all media, the likely cost of such measures and a proposed timetable for their implementation. The notification requirements of condition 2.5.2 shall be deemed to have been complied with on submission of the plan. The plan shall be implemented subject to such amendments or additions as notified by the Agency in writing.	completed 10/10/08



## Schedule 2 – Waste types, raw materials and fuels

Table S2.1 Raw materials and fuels	
Raw materials and fuel description	Specification
Fuel for biomass boiler units	Biomass chips or pellets comprising virgin timber, straw, miscanthus; grade A waste wood or a combination of these.

## Schedule 3 – Emissions and monitoring

Table S3.1 Point source emissions to air – emission limits and monitoring requirements						
Emission point ref. & location	Source	Parameter	Limit (including unit)	Reference period	Monitoring frequency	Monitoring standard or method
Barn Farm						
High velocity roof fan outlets on poultry houses shown on the site plan in schedule 7	Poultry houses1-6	---	---	---	---	---
Chimney from carcass incinerator as shown on the site plan in schedule 7	Carcass incinerator	---	---	---	---	---
Exhaust from standby generator as shown on the site plan in schedule 7	Standby Generator	---	---	---	---	---
Vent from oil tank as shown on the site plan in schedule 7	Diesel tank	---	---	---	---	---
Emissions from 1 biomass boiler subject to MCPD as shown on the site layout plan in schedule 7	1.7 MWth biomass boiler	Oxides of Nitrogen (NO and NO <sub>2</sub> expressed as NO <sub>2</sub> )	500 mg/m <sup>3</sup> (2)(1)	Hourly Average	Once every 3 years	As agreed in writing by the Environment Agency
		Carbon monoxide	No limit			
		Dust	50 mg/m <sup>3</sup> (2)			
Poplar Farm						
High velocity roof fan outlets on poultry houses 1-6 as shown on the site plans in schedule 7	Poultry houses 1-6	---	---	---	---	---
Chimney from carcass incinerator as shown on the site plan reference “Poplar Farm FP3739UW Reviewed October 2017 Appendix 3d” submitted 04/10/17 in support of application EPR/FP3739UW/V003	Carcass incinerator	---	---	---	---	---
Vent from oil tank as shown on the site plan reference “Poplar Farm FP3739UW Reviewed October 2017 Appendix 3d” submitted 04/10/17in	Diesel tank	---	---	---	---	---

Table S3.1 Point source emissions to air – emission limits and monitoring requirements						
Emission point ref. & location	Source	Parameter	Limit (including unit)	Reference period	Monitoring frequency	Monitoring standard or method
support of application EPR/FP3739UW/V003						
Emissions from 1 biomass boiler subject to MCPD as shown on the site layout plan in schedule 7	1.7 MWth biomass boiler	Oxides of Nitrogen (NO and NO <sub>2</sub> expressed as NO <sub>2</sub> )	500 mg/m <sup>3</sup> (2)(1)	Hourly Average	Once every 3 years	As agreed in writing by the Environment Agency
		Carbon monoxide	No limit			
		Dust	50 mg/m <sup>3</sup> (2)			

#### Notes

(1) All limits are defined at a temperature of 273.15 K, a pressure of 101.3 kPa and after correction for the water vapour content of the waste gases at a standardised O<sub>2</sub> content of 6%.

(2) The above emission limits are for biomass fuel combustion units with aggregated thermal input capacity > 1 MW and < 5MW.

Table S3.2 Point Source emissions to water (other than sewer) and land – emission limits and monitoring requirements						
Emission point ref. & location	Source	Parameter	Limit (incl. unit)	Reference Period	Monitoring frequency	Monitoring standard or method
<b>Barn Farm</b>						
Barn Farm Outlet to 'Cardinal Dike' south of Barn Farm installation boundary as indicated on the drainage plan reference "Barn Farm Drainage Plan EPR/FP3739UW" submitted 07/10/17 in support of application EPR/FP3739UW/S005	Roof water from poultry houses 1-6	---	---	---	---	---
Barn Farm Outlet to 'Cardinal Dike' south of Barn Farm installation boundary as indicated on the drainage plan reference "Barn Farm Drainage Plan EPR/FP3739UW" submitted 07/10/17 in support of application EPR/FP3739UW/S005	Water draining from yard (excluding poultry house wash out periods)	---	---	---	---	---
<b>Poplar Farm</b>						
Poplar Farm Outlet to unnamed drain southeast of Poplar Farm installation	Roof water from poultry houses 1-6					

**Table S3.2 Point Source emissions to water (other than sewer) and land – emission limits and monitoring requirements**

Emission point ref. & location	Source	Parameter	Limit (incl. unit)	Reference Period	Monitoring frequency	Monitoring standard or method
boundary as indicated on the drainage plan reference "Poplar Farm FP3739UK Reviewed October 2017Appendix 3c" submitted 04/10/17 in support of application EPR/FP3739UW/V003						
Poplar Farm Outlet to unnamed drain southeast of Poplar Farm installation boundary as indicated on the drainage plan reference "Poplar Farm FP3739UK Reviewed October 2017Appendix 3c" submitted 04/10/17 in support of application EPR/FP3739UW/V003	Water draining from yard (excluding poultry house wash out periods).					

**Table S3.3 Process monitoring requirements**

Emission point reference or source or description of point of measurement	Parameter	Limit (incl. Unit)	Monitoring frequency (1)	Monitoring standard or method
All broiler houses	kg N excreted/animal place/year	0.6 kg N/animal place/year	Annually	Using a mass balance of nitrogen based on the feed intake, dietary content of crude protein, and animal performance or Estimation by using manure analysis for total nitrogen content
	kg P <sub>2</sub> O <sub>5</sub> excreted/animal place/year	0.25 kg P <sub>2</sub> O <sub>5</sub> animal place/year	Annually	Using a mass balance of phosphorus based on the feed intake, dietary content of crude protein, total phosphorus and animal performance or Estimation by using manure analysis for total phosphorus content
	kg NH <sub>3</sub> /animal place/year	0.08 kg NH <sub>3</sub> /animal place/year	Annually	Estimation using emission factors
	Dust	n/a	Annually	Estimation using emission factors

## Schedule 4 – Reporting

Table S4.1 Reporting of monitoring data			
Parameter	Emission or monitoring point/reference	Reporting period	Period begins
Emissions to air - Parameters as required by condition 3.5.1	Biomass boilers subject to MCPD	Every 12 months	1 January
Process monitoring Parameters as required by condition 3.5.1	-	Every 12 months	1 January

Table S4.2 Reporting forms		
Media/parameter	Reporting format	Date of form
kg NH <sub>3</sub> /animal place/year	Form Process Monitoring 1 or other form as agreed in writing by the Environment Agency	21/05/2021
kg N excreted/animal place/year kg P <sub>2</sub> O <sub>5</sub> excreted/animal place/year	Form Process Monitoring 1 or other form as agreed in writing by the Environment Agency	21/05/2021
Dust atmospheric mass emission	Form Process Monitoring 1 or other form as agreed in writing by the Environment Agency	21/05/2021
Air	Form air 1 or other form as agreed in writing by the Environment Agency	11/01/2023

# Schedule 5 – Notification

These pages outline the information that the operator must provide.

Units of measurement used in information supplied under Part A and B requirements shall be appropriate to the circumstances of the emission. Where appropriate, a comparison should be made of actual emissions and authorised emission limits.

If any information is considered commercially confidential, it should be separated from non-confidential information, supplied on a separate sheet and accompanied by an application for commercial confidentiality under the provisions of the EP Regulations.

## Part A

Permit number	
Name of operator	
Location of facility	
Time and date of the detection	

<b>(a) Notification requirements for any malfunction, breakdown or failure of equipment or techniques, accident, or emission of a substance not controlled by an emission limit which has caused, is causing or may cause significant pollution</b>	
<b>To be notified within 24 hours of detection</b>	
Date and time of the event	
Reference or description of the location of the event	
Description of where any release into the environment took place	
Substances(s) potentially released	
Best estimate of the quantity or rate of release of substances	
Measures taken, or intended to be taken, to stop any emission	
Description of the failure or accident.	

<b>(b) Notification requirements for the breach of a limit</b>	
<b>To be notified within 24 hours of detection</b>	
Emission point reference/ source	
Parameter(s)	
Limit	
Measured value and uncertainty	
Date and time of monitoring	
Measures taken, or intended to be taken, to stop the emission	

Time periods for notification following detection of a breach of a limit	
Parameter	Notification period

(c) Notification requirements for the breach of permit conditions not related to limits	
To be notified within 24 hours of detection	
Condition breached	
Date, time and duration of breach	
Details of the permit breach i.e. what happened including impacts observed.	
Measures taken, or intended to be taken, to restore permit compliance.	

(d) Notification requirements for the detection of any significant adverse environmental effect	
To be notified within 24 hours of detection	
Description of where the effect on the environment was detected	
Substances(s) detected	
Concentrations of substances detected	
Date of monitoring/sampling	

## Part B – to be submitted as soon as practicable

Any more accurate information on the matters for notification under Part A.	
Measures taken, or intended to be taken, to prevent a recurrence of the incident	
Measures taken, or intended to be taken, to rectify, limit or prevent any pollution of the environment which has been or may be caused by the emission	
The dates of any unauthorised emissions from the facility in the preceding 24 months.	
Name*	
Post	
Signature	
Date	

\* authorised to sign on behalf of the operator

## Schedule 6 – Interpretation

“accident” means an accident that may result in pollution.

“Animal and Plant Health Agency (APHA)” is the government agency that licences small on farm incinerators; formerly known as the Animal Health and Veterinary Laboratories Agency.

“application” means the application for this permit, together with any additional information supplied by the operator as part of the application and any response to a notice served under Schedule 5 to the EP Regulations.

“authorised officer” means any person authorised by the Environment Agency under section 108(1) of The Environment Act 1995 to exercise, in accordance with the terms of any such authorisation, any power specified in section 108(4) of that Act.

“building” means a construction that has the objective of providing sheltering cover and minimising emissions of noise, particulate matter, odour and litter.

“emissions to land” includes emissions to groundwater.

“emissions of substances not controlled by emission limits” means emissions of substances to air, water or land from the activities, either from the emission points specified in schedule 3 or from other localised or diffuse sources, which are not controlled by an emission limit.

“EP Regulations” means The Environmental Permitting (England and Wales) Regulations SI 2016 No.1154 and words and expressions used in this permit which are also used in the Regulations have the same meanings as in those Regulations.

“Existing housing” means housing that is not defined as new housing.

“groundwater” means all water, which is below the surface of the ground in the saturation zone and in direct contact with the ground or subsoil.

“Hazardous property” has the meaning in Annex III of the Waste Framework Directive.

“Industrial Emissions Directive” means DIRECTIVE 2010/75/EU OF THE EUROPEAN PARLIAMENT AND OF THE COUNCIL of 24 November 2010 on industrial emissions, as read in accordance with Schedule 1A to the Environmental Permitting (England and Wales) Regulations 2016.

“List of Wastes” means the list of wastes established by Commission Decision 2000/532/EC replacing Decision 94/3/EC establishing a list of wastes pursuant to Article 1(a) of Council Directive 75/442/EEC on waste and Council Decision 94/904/EC establishing a list of hazardous waste pursuant to Article 1(4) of Council Directive 91/689/EEC on hazardous waste, as amended from time to time.

“Manure and slurry” have the following meaning:

- Manures may be either slurries or solid manures.
- Slurries consist of excreta produced by livestock whilst in a yard or building mixed with rainwater and wash water and, in some cases, waste bedding and feed. Slurries can be pumped or discharged by gravity.
- Slurry includes duck effluent, seepage from manure and wash water.
- Solid manures include farmyard manure (FYM) and comprise material from straw-based housing systems, excreta with lots of straw/sawdust/woodchips in it, or solids from mechanical separators.
- Most poultry systems produce solid manure (litter).
- Solid manure can generally be stacked.

“Medium Combustion Plant” or “MCP” means a combustion plant with a rated thermal input equal or greater than 1 megawatt (MW) but less than 50 megawatts (MW).

“Medium Combustion Plant Directive” or “MCPD” means medium combustion plant directive 2015/2193/EU of the European Parliament and of the Council on the limitation of emissions of certain pollutants into the air from medium combustion plants.



“New housing” means housing first permitted at the installation following the publication of the intensive rearing of poultry or pigs (IRPP) best available techniques (BAT) conclusions document dated 21/02/17, or a complete replacement of existing housing after 21/02/17.

“MCERTS” means the Environment Agency’s Monitoring Certification Scheme.

“pests” means Birds, Vermin and Insects.

“virgin timber” means timber from

- Whole trees and the woody parts of trees including branches and bark derived from forestry works, woodland management, tree surgery and other similar operations (it does not include clippings or trimmings that consist primarily of foliage);
- Virgin wood processing (e.g. wood offcuts, shavings or sawdust from sawmills) or timber product manufacture dealing in virgin timber.
- If virgin timber is mixed with waste timber or any other waste, the mixed load is classed as waste.

“Waste code” means the six digit code referable to a type of waste in accordance with the List of Wastes and in relation to hazardous waste, includes the asterisk

“Waste Framework Directive” or “WFD” means Waste Framework Directive 2008/98/EC of the European Parliament and of the Council on waste.

“year” means calendar year ending 31 December.

## Schedule 7 – Site plan

Site plan - showing installation boundary as referred to in condition 2.2.1.

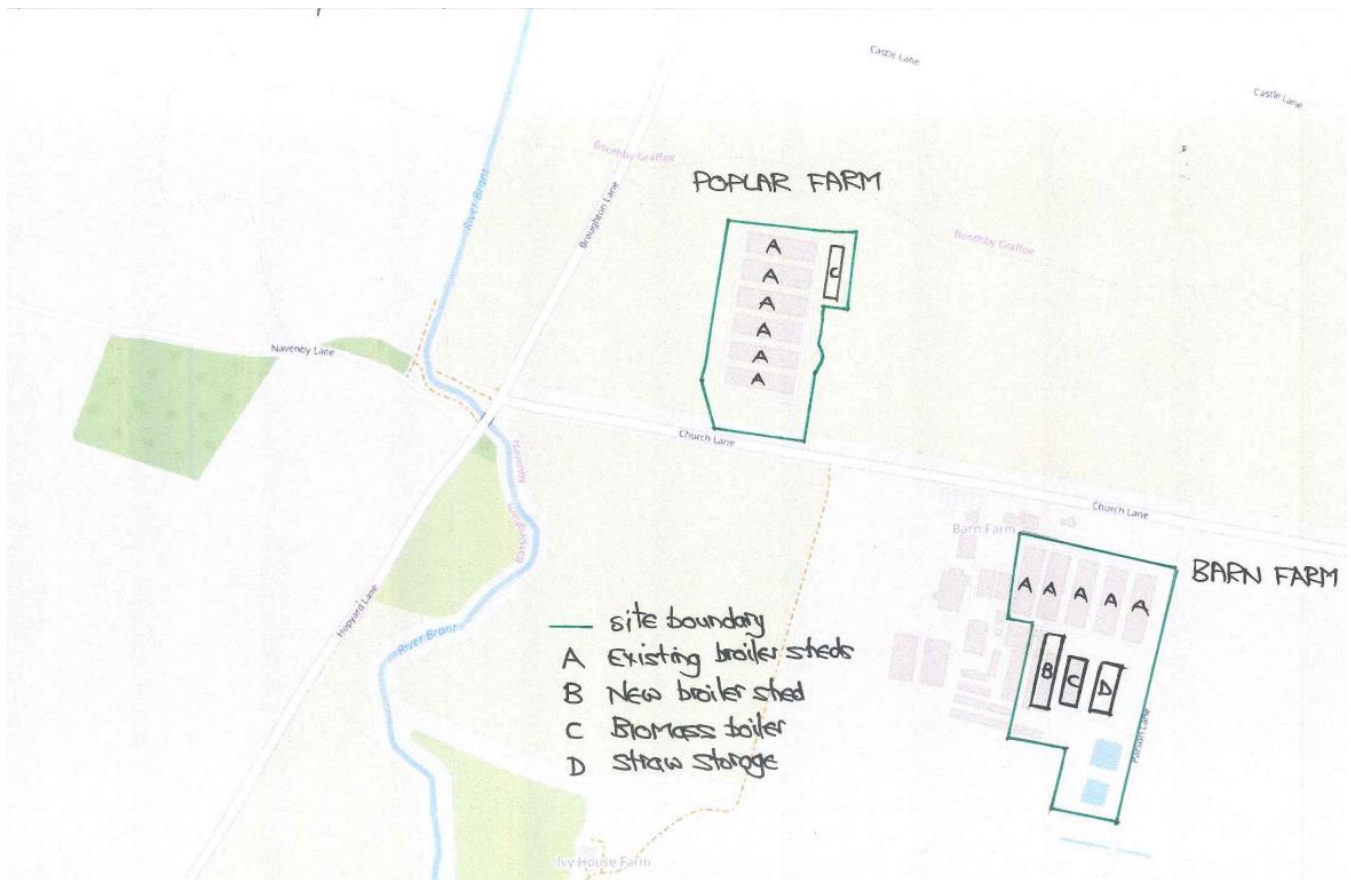

“©Crown Copyright. All rights reserved. Environment Agency, 100024198, 2023.”

Site layout plan Poplar Farm

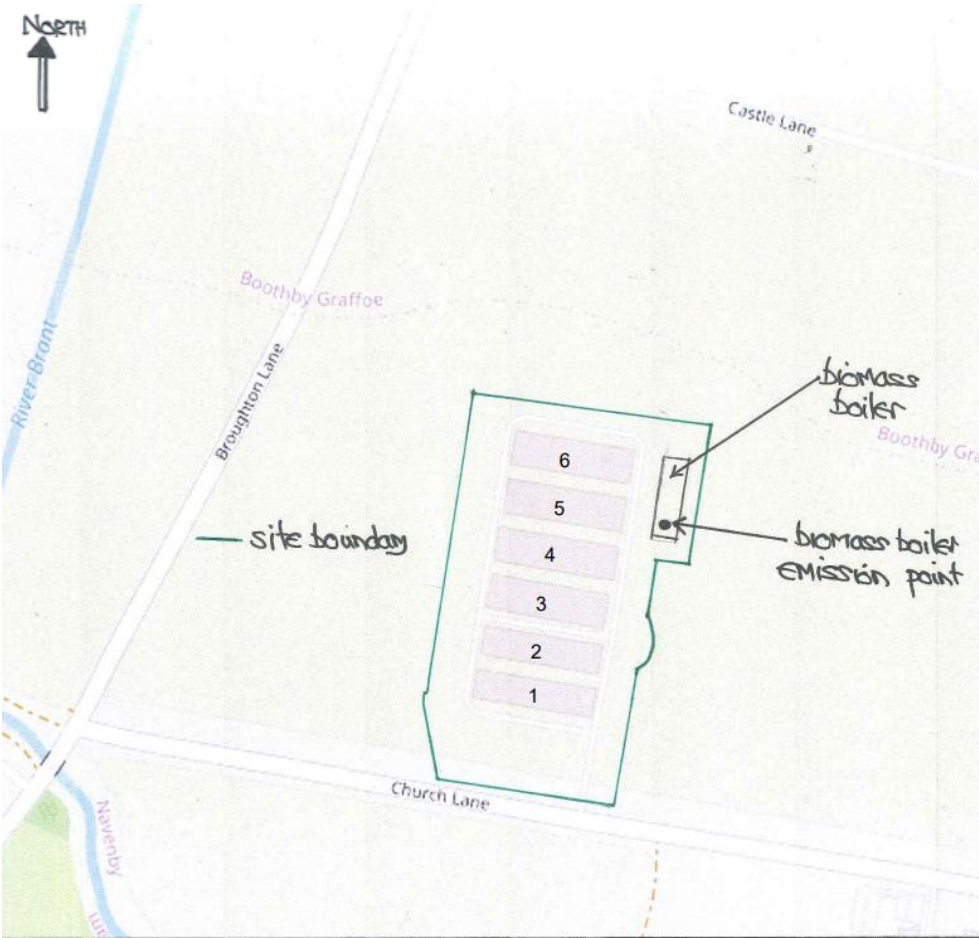

Site layout plan Barn Farm

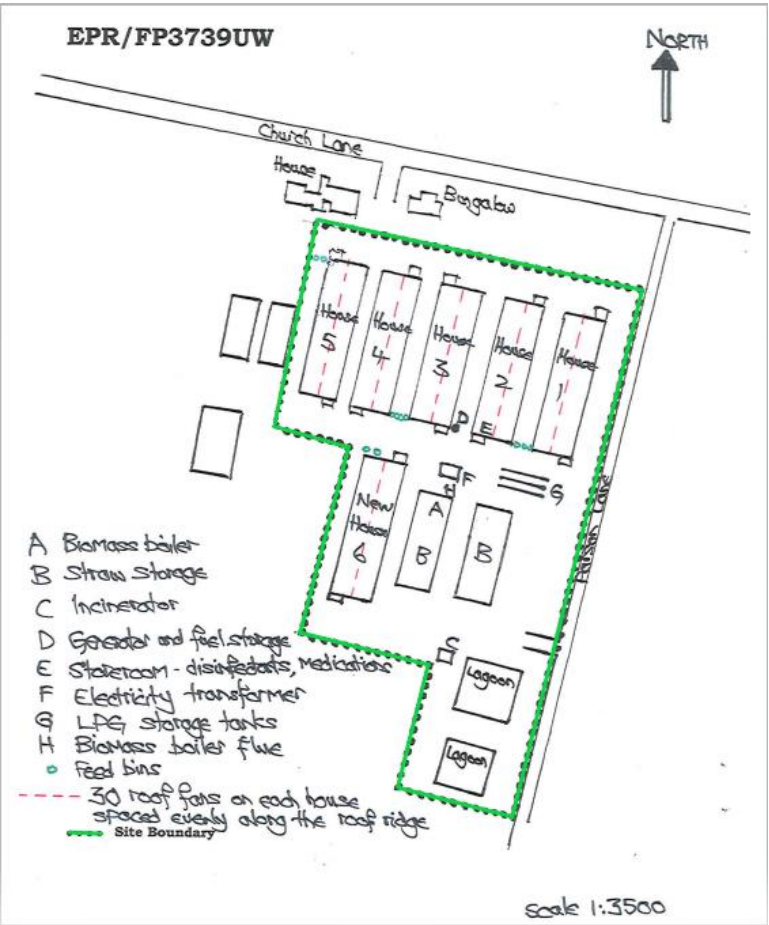

END OF PERMIT

Permit number  
EPR/FP3739UW