

# Notice of variation and consolidation with introductory note

**The Environmental Permitting (England & Wales) Regulations 2016**

---

SUEZ Recycling and Recovery UK Limited

Rugby Solid Recovered Fuel Facility  
Malpass Farm  
Parkfield Road  
Rugby  
Warwickshire  
CV21 1AT

**Variation application number**

EPR/EP3033EJ/V003

**Permit number**

EPR/EP3033EJ

# Rugby Solid Recovered Fuel Facility

## Permit number EPR/EP3033EJ

### Introductory note

#### **This introductory note does not form a part of the permit**

Under the Environmental Permitting (England & Wales) Regulations 2016 (schedule 5, part 1, paragraph 19) a variation may comprise a consolidated permit reflecting the variations and a notice specifying the variations included in that consolidated permit.

Schedule 1 of the notice specifies the conditions that have been varied and schedule 2 comprises a consolidated permit which reflects the variations being made. Only the variations specified in schedule 1 are subject to a right of appeal.

#### **Changes introduced by this variation notice**

This permit variation has been issued to implement the following guidance “Non-hazardous and inert waste: appropriate measures for permitted facilities” and the relevant requirements of the Best Available Techniques (BAT) Conclusions set out in implementing decision (EU) 2018/1147 of 10 August 2018.

The Industrial Emissions Directive (IED) came into force on 7 January 2014 with the requirement to implement all relevant Best Available Techniques (BAT) Conclusions as described in the Commission Implementing Decision.

Article 21(3) of the IED requires the Environment Agency to review conditions in permits that it has issued and to ensure that the permit delivers compliance with relevant standards, within four years of the publication of updated decisions on Best Available Techniques (BAT) Conclusions. The BAT Conclusions for Waste Treatment (the BREF) was published on 17 August 2018 following a European Union wide review of BAT, implementing decision (EU) 2018/1147 of 10 August 2018.

The non-hazardous and inert waste: appropriate measures for permitted facilities guidance was published on the gov.uk website on 12 July 2021. This guidance sets out the standards that are relevant to regulated facilities with a permit to store, treat or transfer (or both) non-hazardous and inert wastes.

This variation has consolidated the original permit and subsequent variations where appropriate.

#### **Brief summary of the process**

The Rugby Solid Recovered Fuel Facility is located at Malpass Farm, Parkfield Road, Rugby, Warwickshire (NGR 49044 76045). The site is located approximately 1.6km northwest of Rugby Town Centre.

The waste treatment facility processes industrial, commercial and residual household wastes to generate a Solid Recovered Fuel (SRF). The maximum annual tonnage of waste accepted at the site is 300,000 tonnes. The facility is set up to handle 220,000 tonnes per annum of mainly industrial and commercial wastes from businesses and some residual municipal wastes and an additional 80,000 tonnes per annum of part processed waste from other waste treatment facilities which are blended together.

The physical waste treatment process includes manual sorting, screening, baling, shredding, crushing, compaction or blending and the use of various magnets and mechanical separators to remove Polyvinylchloride (PVC) products, ferrous and non-ferrous metals, paper and card.

There are three channelled/point source emissions to air from the odour extraction systems. Air collected from the extraction systems is released to the atmosphere through one of three stacks that are located south of the building.

The only point source emission to water from the installation is uncontaminated surface water which flows to an attenuation lagoon before being discharged to the River Avon. This discharge will not affect the features of the local wildlife sites, nature reserves and protected species within the local vicinity.

The status log of the permit sets out the permitting history, including any changes to the permit reference number.

| <b>Status log of the permit</b>   |                       |  |
|---|-----------------------|--|
| <b>Description</b>  | <b>Date</b>           | <b>Comments</b>  |
| Application<br>EPR/EP3033EJ/A0001   | Duly made<br>25/11/13 | Application for Solid Recovered Fuel Facility  |
| Additional information received   | 08/01/14              | Information on local receptors and revised habitats assessment   |
| Additional information received   | 18/03/14              | Fire Risk Assessment   |
| Additional information received   | 02/04/14              | Clarification of details in odour assessment   |
| Additional information received   | 22/04/14              | Clarification of EWC codes   |
| Additional information received   | 15/05/14              | Further clarification of EWC codes   |
| Permit determined<br>(Billing reference EP3033EJ)   | 18/07/14              | Permit issued to SITA UK Limited   |
| Notified change of company name and address   | 07/04/16              | Request from operator to update the company name from SITA UK Limited to SUEZ Recycling and Recovery UK Ltd and the first line of their registered office address from SITA House to SUEZ House. |
| Variation issued<br>EPR/EP3033EJ/V002   | 30/06/16              | Varied permit issued to SUEZ Recycling and Recovery UK Ltd.  |
| Environment Agency Non-hazardous waste Sector Review<br>Variation number<br>EPR/EP3033EJ/V003   | 15/09/21              | Non-hazardous waste Sector Review – documents received in response to the Regulation 61 Notice dated 28/04/2021.   |
| Additional information received in response to the Request for Further Information (RFI) dated 01/12/2021   | 09/12/21              | Documents received in response to questions 1 to 6 of the RFI.   |
| Environment Agency Non-hazardous waste Sector Review<br>Variation number<br>EPR/EP3033EJ/V003<br>Permit determined<br>EPR/EP3033EJ<br>Billing ref. AP3904MR | 11/11/2022            | Varied and consolidated permit issued in modern condition format.  |

End of introductory note

# Notice of variation and consolidation

## The Environmental Permitting (England and Wales) Regulations 2016

The Environment Agency in exercise of its powers under regulation 20 of the Environmental Permitting (England and Wales) Regulations 2016 varies

### Permit number

EPR/EP3033EJ

### Issued to

**SUEZ Recycling and Recovery UK Limited** (“the operator”),

whose registered office is

**SUEZ House  
Grenfell Road  
Maidenhead  
Berkshire  
SL6 1ES**

company registration number 02291198

to operate a regulated facility at

**Rugby Solid Recovered Fuel Facility  
Malpass Farm  
Parkfield Road  
Rugby  
Warwickshire  
CV21 1AT**

to the extent set out in the schedules.

The notice shall take effect from 11/11/2022.

| Name           | Date       |
|----------------|------------|
| Claire Roberts | 11/11/2022 |

Authorised on behalf of the Environment Agency

## Schedule 1

The following conditions and tables were varied as a result of Environment Agency Initiated Variation:

- Condition 2.3.1 of the last permit variation is renumbered and split into conditions 2.1.1 and 2.3.2 in this permit. The follow-on conditions have been renumbered in this variation.
- Condition 2.3.3 has been added as it was omitted in error.
- Condition 2.5.1 has been deleted as the pre-operational condition 1 of Table S1.4 has been completed.
- Conditions 3.5.1 - 3.5.4 have been added because they are relevant to implement the monitoring requirements. The follow-on conditions have been renumbered in this variation.
- Condition 3.7.1 have been added because there is an approved Fire Prevention Plan which has been incorporated in Table S1.2 of the permit but there was no condition relating to fire prevention in the permit.
- Conditions 4.2.2 and 4.2.3 have been added because they are relevant reporting requirements were omitted. The follow-on conditions have been renumbered in this variation.
- Condition 4.3.2 has been amended to remove reference to conditions 4.3.1(a)(i) and 4.3.1(b)(ii).
- Table S1.1 as referenced in condition 2.1.1 has been amended to define the limits of specified activities and to add Directly Associated Activities that were omitted.
- Table S1.2 as referenced in conditions 2.3.1 and 2.3.2 has been amended to incorporate operating techniques documents received from the operator in response to the Regulation 61 Notice and additional information received in response to the RFI.
- Table S1.3 as referenced in condition 2.4.1 has been amended to show IC1 and IC2 completed and add 3 new improvement requirements IC3, IC4 and IC5.
- Table S1.4 has been deleted as Pre-operational condition 1 has been complied with.
- Table S2.1 as referenced in condition 2.3.3 has been added as it was omitted in error.
- Table S2.2 as referenced in condition 2.3.4 has been amended to remove and restrict some of the waste types that are not suitable for SRF production.
- Table S3.1 as referenced in conditions 3.5.1 and 3.5.4 has been amended to add limit and monitoring requirements.
- Table S3.2 as referenced in conditions 3.5.1 and 3.5.4 has been amended to refer to the site plan in Schedule 7 and include oil and grease in monitoring parameters.
- Table S3.3 as referenced in condition 3.5.1 has been added to include process monitoring requirements.
- Tables S4.1 to S4.4 as referenced in conditions 4.2.1 and 4.2.3 have been added because there are reporting requirements in the permit.
- Schedule 5 as referenced in conditions 4.3.2 and 4.3.4 has been amended by adding a new paragraph (c) to Part A requiring notification of breach of permit conditions not relating to limits.
- Schedule 6 has been amended to include new interpretations associated with the permit review.

## Schedule 2 – consolidated permit

Consolidated permit issued as a separate document.

# Conditions

## 1 Management

### 1.1 General management

1.1.1 The operator shall manage and operate the activities:

- (a) in accordance with a written management system that identifies and minimises risks of pollution, including those arising from operations, maintenance, accidents, incidents, non-conformances, closure and those drawn to the attention of the operator as a result of complaints; and
- (b) using sufficient competent persons and resources.

1.1.2 Records demonstrating compliance with condition 1.1.1 shall be maintained.

1.1.3 Any person having duties that are or may be affected by the matters set out in this permit shall have convenient access to a copy of it kept at or near the place where those duties are carried out.

1.1.4 The operator shall comply with the requirements of an approved competence scheme.

### 1.2 Energy efficiency

1.2.1 The operator shall:

- (a) take appropriate measures to ensure that energy is used efficiently in the activities;
- (b) review and record at least every four years whether there are suitable opportunities to improve the energy efficiency of the activities; and
- (c) take any further appropriate measures identified by a review.

### 1.3 Efficient use of raw materials

1.3.1 The operator shall:

- (a) take appropriate measures to ensure that raw materials and water are used efficiently in the activities;
- (b) maintain records of raw materials and water used in the activities;
- (c) review and record at least every four years whether there are suitable alternative materials that could reduce environmental impact or opportunities to improve the efficiency of raw material and water use; and
- (d) take any further appropriate measures identified by a review.

### 1.4 Avoidance, recovery and disposal of wastes produced by the activities

1.4.1 The operator shall take appropriate measures to ensure that:

- (a) the waste hierarchy referred to in Article 4 of the Waste Framework Directive is applied to the generation of waste by the activities; and
- (b) any waste generated by the activities is treated in accordance with the waste hierarchy referred to in Article 4 of the Waste Framework Directive; and
- (c) where disposal is necessary, this is undertaken in a manner which minimises its impact on the environment.

- 1.4.2 The operator shall review and record at least every four years whether changes to those measures should be made and take any further appropriate measures identified by a review.

## **2 Operations**

### **2.1 Permitted activities**

- 2.1.1 The operator is only authorised to carry out the activities specified in schedule 1 table S1.1 (the “activities”).
- 2.1.2 Waste authorised by this permit shall be clearly distinguished from any other waste on the site.

### **2.2 The site**

- 2.2.1 The activities shall not extend beyond the site, being the land shown edged in green on the site plan at schedule 7 to this permit.

### **2.3 Operating techniques**

- 2.3.1 The activities shall, subject to the conditions of this permit, be operated using the techniques and in the manner described in the documentation specified in schedule 1, table S1.2, unless otherwise agreed in writing by the Environment Agency.
- 2.3.2 If notified by the Environment Agency that the activities are giving rise to pollution, the operator shall submit to the Environment Agency for approval within the period specified, a revision of any plan or other documentation (“plan”) specified in schedule 1, table S1.2 or otherwise required under this permit which identifies and minimises the risks of pollution relevant to that plan, and shall implement the approved revised plan in place of the original from the date of approval, unless otherwise agreed in writing by the Environment Agency.
- 2.3.3 Any raw materials or fuels listed in schedule 2 table S2.1 shall conform to the specifications set out in that table.
- 2.3.4 Waste shall only be accepted if:
- (a) it is of a type and quantity listed in schedule 2 table S2.2; and
  - (b) it conforms to the description in the documentation supplied by the producer and holder.
- 2.3.5 The operator shall ensure that where waste produced by the activities is sent to a relevant waste operation, that operation is provided with the following information, prior to the receipt of the waste:
- (a) the nature of the process producing the waste;
  - (b) the composition of the waste;
  - (c) the handling requirements of the waste;
  - (d) the hazardous property associated with the waste, if applicable; and
  - (e) the waste code of the waste.
- 2.3.6 The operator shall ensure that where waste produced by the activities is sent to a landfill site, it meets the waste acceptance criteria for that landfill.

### **2.4 Improvement programme**

- 2.4.1 The operator shall complete the improvements specified in schedule 1 table S1.3 by the date specified in that table unless otherwise agreed in writing by the Environment Agency.

- 2.4.2 Except in the case of an improvement which consists only of a submission to the Environment Agency, the operator shall notify the Environment Agency within 14 days of completion of each improvement.

## **3 Emissions and monitoring**

### **3.1 Emissions to water, air or land**

- 3.1.1 There shall be no point source emissions to water, air or land except from the sources and emission points listed in schedule 3 tables S3.1 and S3.2.
- 3.1.2 The limits given in schedule 3 shall not be exceeded.
- 3.1.3 Periodic monitoring shall be carried out at least once every 5 years for groundwater and 10 years for soil, unless such monitoring is based on a systematic appraisal of the risk of contamination.

### **3.2 Emissions of substances not controlled by emission limits**

- 3.2.1 Emissions of substances not controlled by emission limits (excluding odour) shall not cause pollution. The operator shall not be taken to have breached this condition if appropriate measures, including, but not limited to, those specified in any approved emissions management plan, have been taken to prevent or where that is not practicable, to minimise, those emissions.
- 3.2.2 The operator shall:
- (a) if notified by the Environment Agency that the activities are giving rise to pollution, submit to the Environment Agency for approval within the period specified, an emissions management plan which identifies and minimises the risks of pollution from emissions of substances not controlled by emission limits;
  - (b) implement the approved emissions management plan, from the date of approval, unless otherwise agreed in writing by the Environment Agency.
- 3.2.3 All liquids in containers, whose emission to water or land could cause pollution, shall be provided with secondary containment, unless the operator has used other appropriate measures to prevent or where that is not practicable, to minimise, leakage and spillage from the primary container.

### **3.3 Odour**

- 3.3.1 Emissions from the activities shall be free from odour at levels likely to cause pollution outside the site, as perceived by an authorised officer of the Environment Agency, unless the operator has used appropriate measures, including, but not limited to, those specified in any approved odour management plan, to prevent or where that is not practicable to minimise the odour.

### **3.4 Noise and vibration**

- 3.4.1 Emissions from the activities shall be free from noise and vibration at levels likely to cause pollution outside the site, as perceived by an authorised officer of the Environment Agency, unless the operator has used appropriate measures, including, but not limited to, those specified in any approved noise and vibration management plan to prevent or where that is not practicable to minimise the noise and vibration.

### **3.5 Monitoring**

- 3.5.1 The operator shall, unless otherwise agreed in writing by the Environment Agency, undertake the monitoring specified in the following tables in schedule 3 to this permit:



- (a) point source emissions specified in tables S3.1 and S3.2; and
  - (b) process monitoring requirements specified in table S3.3.
- 3.5.2 The operator shall maintain records of all monitoring required by this permit including records of the taking and analysis of samples, instrument measurements (periodic and continual), calibrations, examinations, tests and surveys and any assessment or evaluation made on the basis of such data.
- 3.5.3 Monitoring equipment, techniques, personnel and organisations employed for the emissions monitoring programme and the environmental or other monitoring specified in condition 3.5.1 shall have either MCERTS certification or MCERTS accreditation (as appropriate), where available, unless otherwise agreed in writing by the Environment Agency.
- 3.5.4 Permanent means of access shall be provided to enable sampling/monitoring to be carried out in relation to the emission points specified in schedule 3 tables S3.1 and S3.2 unless otherwise agreed in writing by the Environment Agency.

### **3.6 Pests**

- 3.6.1 The activities shall not give rise to the presence of pests which are likely to cause pollution, hazard or annoyance outside the boundary of the site. The operator shall not be taken to have breached this condition if appropriate measures, including, but not limited to, those specified in any approved pests management plan, have been taken to prevent or where that is not practicable, to minimise the presence of pests on the site.
- 3.6.2 The operator shall:
- (a) if notified by the Environment Agency, submit to the Environment Agency for approval within the period specified, a pests management plan which identifies and minimises risks of pollution from pests;
  - (b) implement the pests management plan, from the date of approval, unless otherwise agreed in writing by the Environment Agency.

### **3.7 Fire prevention**

- 3.7.1 The operator shall take all appropriate measures to prevent fires on site and minimise the risk of pollution from them including, but not limited to, those specified in any approved fire prevention plan.

## **4 Information**

### **4.1 Records**

- 4.1.1 All records required to be made by this permit shall:
- (a) be legible;
  - (b) be made as soon as reasonably practicable;
  - (c) if amended, be amended in such a way that the original and any subsequent amendments remain legible, or are capable of retrieval; and
  - (d) be retained, unless otherwise agreed in writing by the Environment Agency, for at least 6 years from the date when the records were made, or in the case of the following records until permit surrender:
    - (i) off-site environmental effects; and
    - (ii) matters which affect the condition of the land and groundwater.

4.1.2 The operator shall keep on site all records, plans and the management system required to be maintained by this permit, unless otherwise agreed in writing by the Environment Agency.

## 4.2 Reporting

4.2.1 The operator shall send all reports and notifications required by the permit to the Environment Agency using the contact details supplied in writing by the Environment Agency.

4.2.2 A report or reports on the performance of the activities over the previous year shall be submitted to the Environment Agency by 31 January (or other date agreed in writing by the Environment Agency) each year. The report(s) shall include as a minimum:

- (a) a review of the results of the monitoring and assessment carried out in accordance with the permit including an interpretive review of that data;
- (b) the annual production/treatment data set out in schedule 4 table S4.2; and
- (c) the performance parameters set out in schedule 4 table S4.3 using the forms specified in table S4.4 of that schedule.

4.2.3 Within 28 days of the end of the reporting period the operator shall, unless otherwise agreed in writing by the Environment Agency, submit reports of the monitoring and assessment carried out in accordance with the conditions of this permit, as follows:

- (a) in respect of the parameters and emission points specified in schedule 4 table S4.1;
- (b) for the reporting periods specified in schedule 4 table S4.1 and using the forms specified in schedule 4 table S4.4; and
- (c) giving the information from such results and assessments as may be required by the forms specified in those tables.

4.2.4 The operator shall, unless notice under this condition has been served within the preceding four years, submit to the Environment Agency, within six months of receipt of a written notice, a report assessing whether there are other appropriate measures that could be taken to prevent, or where that is not practicable, to minimise pollution.

4.2.5 Within 1 month of the end of each quarter, the operator shall submit to the Environment Agency using the form made available for the purpose, the information specified on the form relating to the site and the waste accepted and removed from it during the previous quarter.

## 4.3 Notifications

4.3.1 In the event:

- (a) that the operation of the activities gives rise to an incident or accident which significantly affects or may significantly affect the environment, the operator must immediately—
  - (i) inform the Environment Agency,
  - (ii) take the measures necessary to limit the environmental consequences of such an incident or accident, and
  - (iii) take the measures necessary to prevent further possible incidents or accidents;
- (b) of a breach of any permit condition the operator must immediately—
  - (i) inform the Environment Agency, and
  - (ii) take the measures necessary to ensure that compliance is restored within the shortest possible time;
- (c) of a breach of permit condition which poses an immediate danger to human health or threatens to cause an immediate significant adverse effect on the environment, the operator must

immediately suspend the operation of the activities or the relevant part of it until compliance with the permit conditions has been restored.

- 4.3.2 Any information provided under condition 4.3.1 shall be confirmed by sending the information listed in schedule 5 to this permit within the time period specified in that schedule.
- 4.3.3 Where the Environment Agency has requested in writing that it shall be notified when the operator is to undertake monitoring and/or spot sampling, the operator shall inform the Environment Agency when the relevant monitoring and/or spot sampling is to take place. The operator shall provide this information to the Environment Agency at least 14 days before the date the monitoring is to be undertaken.
- 4.3.4 The Environment Agency shall be notified within 14 days of the occurrence of the following matters, except where such disclosure is prohibited by Stock Exchange rules:
- Where the operator is a registered company:
- (a) any change in the operator's trading name, registered name or registered office address; and
  - (b) any steps taken with a view to the operator going into administration, entering into a company voluntary arrangement or being wound up.
- Where the operator is a corporate body other than a registered company:
- (a) any change in the operator's name or address; and
  - (b) any steps taken with a view to the dissolution of the operator.
- In any other case:
- (a) the death of any of the named operators (where the operator consists of more than one named individual);
  - (b) any change in the operator's name(s) or address(es); and
  - (c) any steps taken with a view to the operator, or any one of them, going into bankruptcy, entering into a composition or arrangement with creditors, or, in the case of them being in a partnership, dissolving the partnership.
- 4.3.5 Where the operator proposes to make a change in the nature or functioning, or an extension of the activities, which may have consequences for the environment and the change is not otherwise the subject of an application for approval under the Regulations or this permit:
- (a) the Environment Agency shall be notified at least 14 days before making the change; and
  - (b) the notification shall contain a description of the proposed change in operation.
- 4.3.6 The Environment Agency shall be given at least 14 days' notice before implementation of any part of the site closure plan.

## **4.4 Interpretation**

- 4.4.1 In this permit the expressions listed in schedule 6 shall have the meaning given in that schedule.
- 4.4.2 In this permit references to reports and notifications mean written reports and notifications, except where reference is made to notification being made "immediately" in which case it may be provided by telephone.

# Schedule 1 – Operations

| <b>Table S1.1 activities</b>        |  |  |  |
|-------------------------------------|--|--|--|
| <b>Activity reference</b>           | <b>Activity listed in Schedule 1 of the EP Regulations</b>   | <b>Description of specified activity and WFD Annex I and II operations</b>   | <b>Limits of specified activity and waste types</b>  |
| AR1                                 | S5.4 A(1) (b) (ii)<br>Recovery or a mix of recovery and disposal of non-hazardous waste with a capacity exceeding 75 tonnes per day involving pre-treatment of waste for incineration or co-incineration | R3: Recycling/reclamation of organic substances which are not used as solvents   | Physical treatment of solid non-hazardous waste to produce Solid Recovered Fuel (SRF).<br>Treatment operations shall be limited to physical treatment including manual sorting, separation, screening, baling, shredding, crushing, compaction or blending for the purpose of producing SRF for recovery.<br>Waste treatment shall take place within an enclosed building and on an impermeable surface with sealed drainage system.<br>Waste types as specified in Table S2.2 |
| <b>Directly Associated Activity</b> |  |  |  |
| AR2                                 | N/A  | R13 – Storage of waste pending any of the operations numbered R1 to R12 (excluding temporary storage, pending collection, on the site where it is produced)  | Receipt and storage of non-hazardous waste pending its use in the production of SRF.<br>All waste storage shall take place within an enclosed building and on an impermeable surface with sealed drainage.<br>Waste types as specified in Table S2.2   |
| AR3                                 | N/A  | Bulking of recyclable wastes recovered as an incidental part of the SRF production process<br>R3 – Recycling/ reclamation of organic substances which are not used as solvents<br>R4 - Recycling/ reclamation of metals and metal compounds<br>R5 - Recycling/ reclamation of other inorganic substances | Bulking of recyclables and residual waste generated from SRF production.<br>All bulking activities shall take place within an enclosed building and on an impermeable surface with sealed drainage system.   |
| AR4                                 | N/A  | Storage of recovered SRF recyclables and residual wastes pending removal from the site   | Storage of recovered SRF and recyclables and residual wastes shall take place in an enclosed building and on an  |

| <b>Table S1.1 activities</b> |  |  |  |
|------------------------------|--|--|--|
| <b>Activity reference</b>    | <b>Activity listed in Schedule 1 of the EP Regulations</b> | <b>Description of specified activity and WFD Annex I and II operations</b> | <b>Limits of specified activity and waste types</b>  |
|                              |  |  | impermeable surface with sealed drainage system.   |
| AR5                          | N/A  | Storage of raw materials, including lubrication oil and diesel             | From the receipt of raw materials to despatch for use within the facility.   |
| AR6                          | N/A  | Collection and storage of uncontaminated roof and site surface water       | From the collection of uncontaminated roof and site surface water from non-operational areas only to storage in the attenuation lagoon and discharge off site. |

| <b>Table S1.2 Operating techniques</b>                                   |   |                      |
|--|---|----------------------|
| <b>Description</b>   | <b>Parts</b>  | <b>Date Received</b> |
| Application  | <p>Site Management Plan, August 2013 in response to section 3a – technical standards and section 3d – information for specific sectors, Part B3 of the application form</p> <p>Best Available Techniques (BAT) Assessment Report, Report number 1826/R/004/1 (dated August 2013) in response to section 3a – technical standards and section 3d – information for specific sectors, Part B3 of the application form</p> <p>Layout plan which details the treatment plant and capacity of waste storage areas and structures within the building, submitted in response to request for information under Regulation 60 of Environmental Permitting Regulations</p> | 25/11/13             |
| Application  | Odour management plan (Report number /R1826/R/005/AppendixA/1) in response to section 3, Table 3b – General Requirements, Part B3 of the application form   | 25/11/13             |
| Application  | Noise and Vibration management plan (Report number /R1826/R/005/AppendixB/1) in response to section 3, Table 3b – General Requirements, Part B3 of the application form   | 25/11/13             |
| Response to Schedule 5 Notice dated 11/02/14                             | Response to questions 8 and 9 detailing Fire Risk Assessment  | 18/03/14             |
| Response to Schedule 5 Notice dated 06/03/14                             | Response to questions 1 and 2 confirming odour modelling  | 02/04/14             |
| Response to e-mail referencing Schedule 5 Notice dated 11/02/14          | Justification for acceptance of specific EWC codes relating to glass, metals, and paper and card.   | 22/04/14             |
| Application EPR/EP3033EJ/V003  | Documents received in response to the Regulation 61 Notice including, Annex 1 of the Regulation 61 Notice response but excluding responses to BAT 31.   | 15/09/21             |
| Regulation 61(1) Notice – request for further information dated 01/12/21 | Responses to questions 4, 5 and 6 dated 9 December 2021 submitted in response to the RFI.   | 09/12/21             |

| <b>Table S1.3 Improvement programme requirements</b> |   |             |
|--|---|-------------|
| <b>Reference</b>                                     | <b>Requirement</b>  | <b>Date</b> |
| IC1  | The Operator shall submit a written report to the Environment Agency on the implementation of its Environmental Management System and the progress made in the certification of the system by an external body or if appropriate submit a schedule by which the EMS will be certified.  | Completed   |
| IC2  | The Operator shall submit a written report to the Environment Agency on the commissioning of the installation. The report shall summarise the environmental performance of the plant as installed against the design parameters set out in the Application. The report shall also include a review of the performance of the facility against the conditions of this permit and details of procedures developed during commissioning for achieving and demonstrating compliance with permit conditions.   | Completed   |
| IC3  | <p>The operator shall carry out an assessment and characterisation of the waste gases released from the odour ventilation stacks A1, A2 and A3 specified in Table S3.1 and shown on the site plan in Schedule 7. Following the assessment, the operator shall submit a written report to the Environment Agency for approval that:</p> <ul style="list-style-type: none"> <li>- Details results of at least three monitoring rounds for all odorous compounds (odour profile) emitted during full operation of the SRF production process.</li> <li>- Compares the emissions against the BAT-AEL for TVOCs specified in Table S3.1;</li> <li>- Assesses the suitability of the existing odour abatement systems to meet the requirements set out in BATs 14d and 31 of the Waste treatment BAT Conclusion; and</li> </ul> <p>Where the emission level for TVOCs is higher than the specified limit in Table S3.1, the operator shall include in the report, recommendations for emission/odour control and improvement together with timescales for implementation.</p> | 11/08/2023  |
| IC4  | <p>Upon completion of the IC3, the operator shall review the current Odour Management Plan and submit a revised version of it to the Environment Agency for written approval. The plan shall take into account findings of the IC3 and the appropriate measures for odour control specified in our web guide 'The non-hazardous and inert waste: appropriate measures for permitted facilities' and H4 - Odour Management.</p> <p>Once the updated odour management plan has been approved by the Environment Agency, the installation must be operated in accordance with this management plan.</p>  | 11/10/2023  |
| IC5  | <p>The operator shall review their litter management plan and submit it to the Environment Agency for written agreement. The plan shall take into account and be updated to include the appropriate measures for litter control specified in our web guide 'Non-hazardous and inert waste: appropriate measures for permitted facilities'.</p> <p>Once the updated litter management plan has been agreed with the Environment Agency, the operator shall operate the installation in accordance with this management plan.</p>   | 11/02/2023  |

## Schedule 2 – Waste types, raw materials and fuels

| Table S2.1 Raw materials and fuels |               |
|------------------------------------|---------------|
| Raw materials and fuel description | Specification |
| Oils and fuels                     | -             |

| Table S2.2 Permitted waste types and quantities for production and storage of Solid Recovered Fuel |   |
|--|---|
| Maximum quantity   | 1 700 tonnes total storage and 300 000 tonnes annual throughput   |
| Waste code   | Description   |
| <b>02</b>  | <b>WASTES FROM AGRICULTURE, HORTICULTURE, AQUACULTURE, FORESTRY, HUNTING AND FISHING, FOOD PREPARATION AND PROCESSING</b>   |
| <b>02 01</b>   | <b>Wastes from agriculture, horticulture, aquaculture, forestry, hunting and fishing</b>  |
| 02 01 03   | Plant-tissue waste (solid combustible waste only)   |
| 02 01 04   | Waste plastics (except packaging)   |
| 02 01 07   | Wastes from forestry (solid combustible waste only)   |
| <b>02 03</b>   | <b>Wastes from fruit, vegetables, cereals, edible oils, cocoa, coffee, tea and tobacco preparation and processing; conserve production; yeast and yeast extract production, molasses preparation and fermentation</b> |
| 02 03 02   | wastes from preserving agents (solid combustible waste only)  |
| 02 03 03   | wastes from solvent extraction (solid combustible waste only)   |
| 02 03 04   | Materials unsuitable for consumption or processing (solid combustible waste only)   |
| <b>02 05</b>   | <b>Wastes from the dairy products industry</b>  |
| 02 05 01   | Materials unsuitable for consumption or processing (solid combustible waste only)   |
| <b>02 07</b>   | <b>Wastes from the production of alcoholic and non-alcoholic beverages (except coffee, tea and cocoa)</b>   |
| 02 07 01   | Wastes from washing, cleaning and mechanical reduction of raw materials (solid combustible waste only)  |
| 02 07 04   | Materials unsuitable for consumption or processing (solid combustible waste only)   |
| <b>03</b>  | <b>WASTES FROM WOOD PROCESSING AND THE PRODUCTION OF PANELS AND FURNITURE, PULP, PAPER AND CARDBOARD</b>  |
| 03 01  | Wastes from wood processing and the production of panels and furniture  |
| 03 01 01   | Waste bark and cork   |
| 03 01 05   | Sawdust, shavings, cuttings, wood, particle board and veneer other than those mentioned in 03 01 04   |
| 03 03  | Wastes from pulp, paper and cardboard production and processing   |
| 03 03 01   | Waste bark and wood   |
| 03 03 07   | Mechanically separated rejects from pulping of waste paper and cardboard  |
| 03 03 08   | Wastes from sorting of paper and cardboard destined for recycling   |
| <b>04</b>  | <b>WASTES FROM THE LEATHER, FUR AND TEXTILE INDUSTRIES</b>  |
| 04 01  | Wastes from the leather and fur industry  |
| 04 01 08   | Waste tanned leather (blue sheetings, shavings, cuttings, buffing dust) containing chromium (solid combustible waste only)  |
| 04 01 09   | Wastes from dressing and finishing (solid combustible waste only)   |
| 04 02  | Wastes from the textile industry  |

|          |  |
|----------|--|
| 04 02 09 | Waste from composite materials (impregnated textile, elastomer, plastomer)   |
| 04 02 15 | Waste from finishing other than those mentioned in 04 02 14  |
| 04 02 21 | Wastes from unprocessed textile fibres   |
| 04 02 22 | Wastes from processed textile fibres   |
| 07       | WASTES FROM ORGANIC CHEMICAL PROCESSES   |
| 07 02    | Wastes from the MFSU of plastics, synthetic rubber and man-made fibres   |
| 07 02 13 | Waste plastic  |
| 09       | WASTES FROM THE PHOTOGRAPHIC INDUSTRY  |
| 09 01    | Wastes from the photographic industry  |
| 09 01 07 | Photographic film and paper containing silver or silver compounds  |
| 09 01 08 | Photographic film and paper free of silver or silver compounds   |
| 10       | WASTES FROM THERMAL PROCESSES  |
| 10 11    | Wastes from manufacture of glass and glass products  |
| 15       | WASTE PACKAGING; ABSORBENTS, WIPING CLOTHS, FILTER MATERIALS AND PROTECTIVE CLOTHING NOT OTHERWISE SPECIFIED   |
| 15 01    | Packaging (including separately collected municipal packaging waste)   |
| 15 01 01 | Paper and cardboard packaging  |
| 15 01 02 | Plastic packaging  |
| 15 01 03 | Wooden packaging   |
| 15 01 05 | Composite packaging  |
| 15 01 06 | Mixed packaging  |
| 15 01 09 | Textile packaging  |
| 15 02    | Absorbents, filter materials, wiping cloths and protective clothing  |
| 15 02 03 | Absorbents, filter materials, wiping cloths and protective clothing other than those mentioned in 15 02 02   |
| 16       | WASTES NOT OTHERWISE SPECIFIED IN THE LIST   |
| 16 01    | End-of-life vehicles from different means of transport [including off-road machinery] and wastes from dismantling of end-of-life vehicles and vehicle maintenance (except 13, 14, 16 06 and 16 08) |
| 16 01 19 | Plastic  |
| 16 01 22 | Discarded components not otherwise specified   |
| 17       | CONSTRUCTION AND DEMOLITION WASTES (INCLUDING EXCAVATED SOIL FROM CONTAMINATED SITES)  |
| 17 02    | Wood, glass and plastic  |
| 17 02 01 | Wood   |
| 17 02 03 | Plastic  |
| 19       | WASTES FROM WASTE MANAGEMENT FACILITIES, OFF-SITE WASTE WATER TREATMENT PLANTS AND PREPARATION OF WATER INTENDED FOR HUMAN CONSUMPTION/INDUSTRIAL USE  |
| 19 02    | Wastes from physico/chemical treatments of waste (including dechromatation, decyanidation, neutralisation)   |
| 19 02 03 | Premixed wastes composed only of non-hazardous wastes  |
| 19 02 10 | Combustible wastes other than those mentioned in 19 02 08 and 19 02 09   |
| 19 04    | Vitrified waste and wastes from vitrification  |
| 19 05    | Wastes from aerobic treatment of solid wastes  |
| 19 05 01 | Non-composted fraction of municipal and similar wastes   |



|          |   |
|----------|---|
| 19 05 03 | Off-specification compost (solid combustible waste only)  |
| 19 10    | Wastes from shredding of metal-containing wastes  |
| 19 10 04 | Fluff-light fraction and dust other than those mentioned in 19 10 03 (solid combustible waste only)                                     |
| 19 10 06 | Other fractions other than those mentioned in 19 10 05 (solid combustible waste only)   |
| 19 12    | Wastes from the mechanical treatment of waste (for example sorting, crushing, compacting, pelletising) not otherwise specified          |
| 19 12 01 | Paper and cardboard   |
| 19 12 04 | Plastic and rubber  |
| 19 12 07 | Wood other than that mentioned in 19 12 06  |
| 19 12 08 | Textiles  |
| 19 12 10 | Combustible waste (refuse derived fuel)   |
| 19 12 12 | Other wastes (including mixtures of materials) from mechanical treatment of wastes other than those mentioned in 19 12 11               |
| 19 13    | Wastes from soil and groundwater remediation  |
| 19 13 02 | Solid wastes from soil remediation other than those mentioned in 19 13 01 (solid combustible waste only)                                |
| 20       | MUNICIPAL WASTES (HOUSEHOLD WASTE AND SIMILAR COMMERCIAL, INDUSTRIAL AND INSTITUTIONAL WASTES) INCLUDING SEPARATELY COLLECTED FRACTIONS |
| 20 01    | Separately collected fractions (except 15 01)   |
| 20 01 01 | Paper and cardboard   |
| 20 01 10 | Clothes   |
| 20 01 11 | Textiles  |
| 20 01 38 | Wood other than that mentioned in 20 01 37  |
| 20 01 39 | Plastics  |
| 20 02    | Garden and park wastes (including cemetery waste)   |
| 20 02 03 | Other non-biodegradable wastes (solid combustible waste only)   |
| 20 03    | Other municipal wastes  |
| 20 03 01 | Mixed municipal waste   |
| 20 03 02 | Waste from markets  |
| 20 03 07 | Bulky waste   |

## Schedule 3 – Emissions and monitoring

| <b>Emission point ref. &amp; location</b>   | <b>Source</b>           | <b>Parameter</b> | <b>Limit (including unit) <sup>1)</sup></b> | <b>Reference period</b>    | <b>Monitoring frequency</b>  | <b>Monitoring standard or method</b> |
|---|-------------------------|------------------|---|----------------------------|--|--------------------------------------|
| A1 [Point A1 on site plan in Schedule 7]  | Odour ventilation stack | TVOC             | 30 mg/m <sup>3</sup>                        | Average over sample period | Once every six months or as otherwise agreed with the Environment Agency <sup>2)</sup> | EN 12619                             |
| A2 [Point A2 on site plan in Schedule 7]  |                         |                  |   |                            |  |                                      |
| A3 [Point A3 on site plan in Schedule 7]  |                         |                  |   |                            |  |                                      |
| <sup>1)</sup> Subject to completion of Improvement condition IC3.<br><sup>2)</sup> Monitoring frequencies may be reduced if the emission levels are proven to be sufficiently stable. |                         |                  |   |                            |  |                                      |

| <b>Emission point ref. &amp; location</b>              | <b>Source</b>  | <b>Parameter</b> | <b>Limit (incl. unit)</b> | <b>Reference Period</b> | <b>Monitoring frequency</b> | <b>Monitoring standard or method</b> |
|--|--|------------------|---------------------------|-------------------------|-----------------------------|--------------------------------------|
| W1 on site plan in Schedule 7 - emission to River Avon | Uncontaminated surface runoff (via an oil interceptor) | Oil and grease   | No visible oil or grease  | -                       | Monthly                     | Visual assessment                    |

| <b>Emission point reference or source or description of point of measurement</b> | <b>Parameter</b>    | <b>Monitoring frequency</b> | <b>Monitoring standard or method</b> | <b>Other specifications</b>   |
|--|---------------------|-----------------------------|--------------------------------------|---|
| At the bag plants serving the SRF production process (trommels and shredders)    | Pressure difference | None specified              | None specified                       | Filters in the bag plants shall be designed, operated and managed in accordance with the manufacturers recommendations to ensure particulate release will not exceed 5mg/m <sup>3</sup> . |

## Schedule 4 – Reporting

Parameters, for which reports shall be made, in accordance with conditions of this permit, are listed below.

| Parameter  | Emission or monitoring point/reference  | Reporting period | Period begins |
|--|---|------------------|---------------|
| Point source emissions to air<br>Parameters as required by condition 3.5.1   | A1, A2, A3  | Every 12 months  | 1 January     |
| Point source emissions to water<br>Parameters as required by condition 3.5.1 | W1  | Every 12 months  | 1 January     |
| Process monitoring<br>Parameters as required by condition 3.5.1              | At the bag plants serving the SRF production process (trommels and shredders) | Every 12 months  | 1 January     |

| Parameter                                  | Units  |
|--|--------|
| SRF produced                               | tonnes |
| Other fractions recovered from SRF process | tonnes |

| Parameter                    | Frequency of assessment | Units                      |
|------------------------------|-------------------------|----------------------------|
| Water usage                  | Annually                | m <sup>3</sup>             |
| Energy usage                 | Annually                | MWh                        |
| Other performance parameters | Annually                | tonnes per production unit |

| Parameter                     | Reporting form  | Form version number and date |
|-------------------------------|---|------------------------------|
| Point source emissions to air | Emissions to Air Reporting Form, or other form as agreed in writing by the Environment Agency             | Version 1, 08/03/2021        |
| Water usage                   | Water Usage Reporting Form, or other form as agreed in writing by the Environment Agency                  | Version 1, 08/03/2021        |
| Energy usage                  | Energy Usage Reporting Form, or other form as agreed in writing by the Environment Agency                 | Version 1, 08/03/2021        |
| Other performance parameters  | Other Performance Parameters Reporting Form, or other form as agreed in writing by the Environment Agency | Version 1, 08/03/2021        |
| Waste returns                 | E-waste returns   | -                            |

# Schedule 5 – Notification

These pages outline the information that the operator must provide.

Units of measurement used in information supplied under Part A and B requirements shall be appropriate to the circumstances of the emission. Where appropriate, a comparison should be made of actual emissions and authorised emission limits.

If any information is considered commercially confidential, it should be separated from non-confidential information, supplied on a separate sheet and accompanied by an application for commercial confidentiality under the provisions of the EP Regulations.

## Part A

|                                |  |
|--------------------------------|--|
| Permit Number                  |  |
| Name of operator               |  |
| Location of Facility           |  |
| Time and date of the detection |  |

|   |  |
|---|--|
| <b>(a) Notification requirements for any malfunction, breakdown or failure of equipment or techniques, accident, or emission of a substance not controlled by an emission limit which has caused, is causing or may cause significant pollution</b> |  |
| <b>To be notified within 24 hours of detection</b>  |  |
| Date and time of the event  |  |
| Reference or description of the location of the event   |  |
| Description of where any release into the environment took place  |  |
| Substances(s) potentially released  |  |
| Best estimate of the quantity or rate of release of substances  |  |
| Measures taken, or intended to be taken, to stop any emission   |  |
| Description of the failure or accident.   |  |

|   |  |
|---|--|
| <b>(b) Notification requirements for the breach of a limit</b>                      |  |
| <b>To be notified within 24 hours of detection unless otherwise specified below</b> |  |
| Emission point reference/ source  |  |
| Parameter(s)  |  |
| Limit   |  |
| Measured value and uncertainty  |  |
| Date and time of monitoring   |  |

|   |  |
|---|--|
| <b>(b) Notification requirements for the breach of a limit</b>                      |  |
| <b>To be notified within 24 hours of detection unless otherwise specified below</b> |  |
| Measures taken, or intended to be taken, to stop the emission                       |  |

|   |                            |
|---|----------------------------|
| <b>Time periods for notification following detection of a breach of a limit</b> |                            |
| <b>Parameter</b>  | <b>Notification period</b> |
|   |                            |
|   |                            |
|   |                            |

|  |  |
|--|--|
| <b>(c) Notification requirements for the breach of permit conditions not related to limits</b> |  |
| <b>To be notified within 24 hours of detection</b>   |  |
| Condition breached   |  |
| Date, time and duration of breach  |  |
| Details of the permit breach i.e. what happened including impacts observed.                    |  |
| Measures taken, or intended to be taken, to restore permit compliance.                         |  |

|  |  |
|--|--|
| <b>(d) Notification requirements for the detection of any significant adverse environmental effect</b> |  |
| <b>To be notified within 24 hours of detection</b>   |  |
| Description of where the effect on the environment was detected  |  |
| Substances(s) detected   |  |
| Concentrations of substances detected  |  |
| Date of monitoring/sampling  |  |

## **Part B – to be submitted as soon as practicable**

|  |  |
|--|--|
| Any more accurate information on the matters for notification under Part A.      |  |
| Measures taken, or intended to be taken, to prevent a recurrence of the incident |  |

|  |  |
|--|--|
| Measures taken, or intended to be taken, to rectify, limit or prevent any pollution of the environment which has been or may be caused by the emission |  |
| The dates of any unauthorised emissions from the facility in the preceding 24 months.  |  |

|           |  |
|-----------|--|
| Name*     |  |
| Post      |  |
| Signature |  |
| Date      |  |

\* authorised to sign on behalf of the operator

## Schedule 6 – Interpretation

“accident” means an accident that may result in pollution.

“application” means the application for this permit, together with any additional information supplied by the operator as part of the application and any response to a notice served under Schedule 5 to the EP Regulations.

“appropriate measures” are set out in the “Non-hazardous and inert waste: appropriate measures for permitted facilities” guidance

“authorised officer” means any person authorised by the Environment Agency under section 108(1) of The Environment Act 1995 to exercise, in accordance with the terms of any such authorisation, any power specified in section 108(4) of that Act.

“disposal” means any of the operations provided for in Annex I to the Waste Framework Directive.

“emissions to land” includes emissions to groundwater.

“EP Regulations” means The Environmental Permitting (England and Wales) Regulations SI 2016 No.1154 and words and expressions used in this permit which are also used in the Regulations have the same meanings as in those Regulations.

“emissions of substances not controlled by emission limits” means emissions of substances to air, water or land from the activities, either from the emission points specified in schedule 3 or from other localised or diffuse sources, which are not controlled by an emission or background concentration limit.

“groundwater” means all water, which is below the surface of the ground in the saturation zone and in direct contact with the ground or subsoil.

“Hazardous property” has the meaning in Annex III of the Waste Framework Directive.

“Industrial Emissions Directive” means DIRECTIVE 2010/75/EU OF THE EUROPEAN PARLIAMENT AND OF THE COUNCIL of 24 November 2010 on industrial emissions, as read in accordance with Schedule 1A to the Environmental Permitting (England and Wales) Regulations 2016.

“List of Wastes” means the list of wastes established by Commission Decision 2000/532/EC replacing Decision 94/3/EC establishing a list of wastes pursuant to Article 1(a) of Council Directive 75/442/EEC on waste and Council Decision 94/904/EC establishing a list of hazardous waste pursuant to Article 1(4) of Council Directive 91/689/EEC on hazardous waste, as amended from time to time.

“MCERTS” means the Environment Agency’s Monitoring Certification Scheme.

“Pests” means Birds, Vermin and Insects.

“quarter” means a calendar year quarter commencing on 1 January, 1 April, 1 July or 1 October.

“recovery” means any of the operations provided for in Annex II to the Waste Framework Directive.

“sealed drainage system” in relation to an impermeable surface, means a drainage system with impermeable components which does not leak and which will ensure that:

- no liquids will run off the surface otherwise than via the system
- all liquids entering the system are collected in a sealed sump, except where liquids may be lawfully discharged to foul sewer.

“separation” means separating wastes into different material types, components and grades.

“sorting” means sorting that may be undertaken by hand or machinery. Sorting enables materials to be processed and recycled appropriately. It may involve separation of different waste types or the separation of different metal types including different ferrous metals, non-ferrous metals and non-metallic materials (e.g. paper and plastic). The sorted metals are graded by visual inspection, supplemented by chemical and other laboratory tests. The physical sorting may be assisted by conveyors and electromagnets.

“Waste code” means the six digit code referable to a type of waste in accordance with the List of Wastes and in relation to hazardous waste, includes the asterisk.

“Waste Framework Directive” or “WFD” means Waste Framework Directive 2008/98/EC of the European Parliament and of the Council on waste, as read in accordance with Schedule 1A to the Environmental Permitting (England and Wales) Regulations 2016.

“year” means calendar year ending 31 December.



# Schedule 7 – Site plan

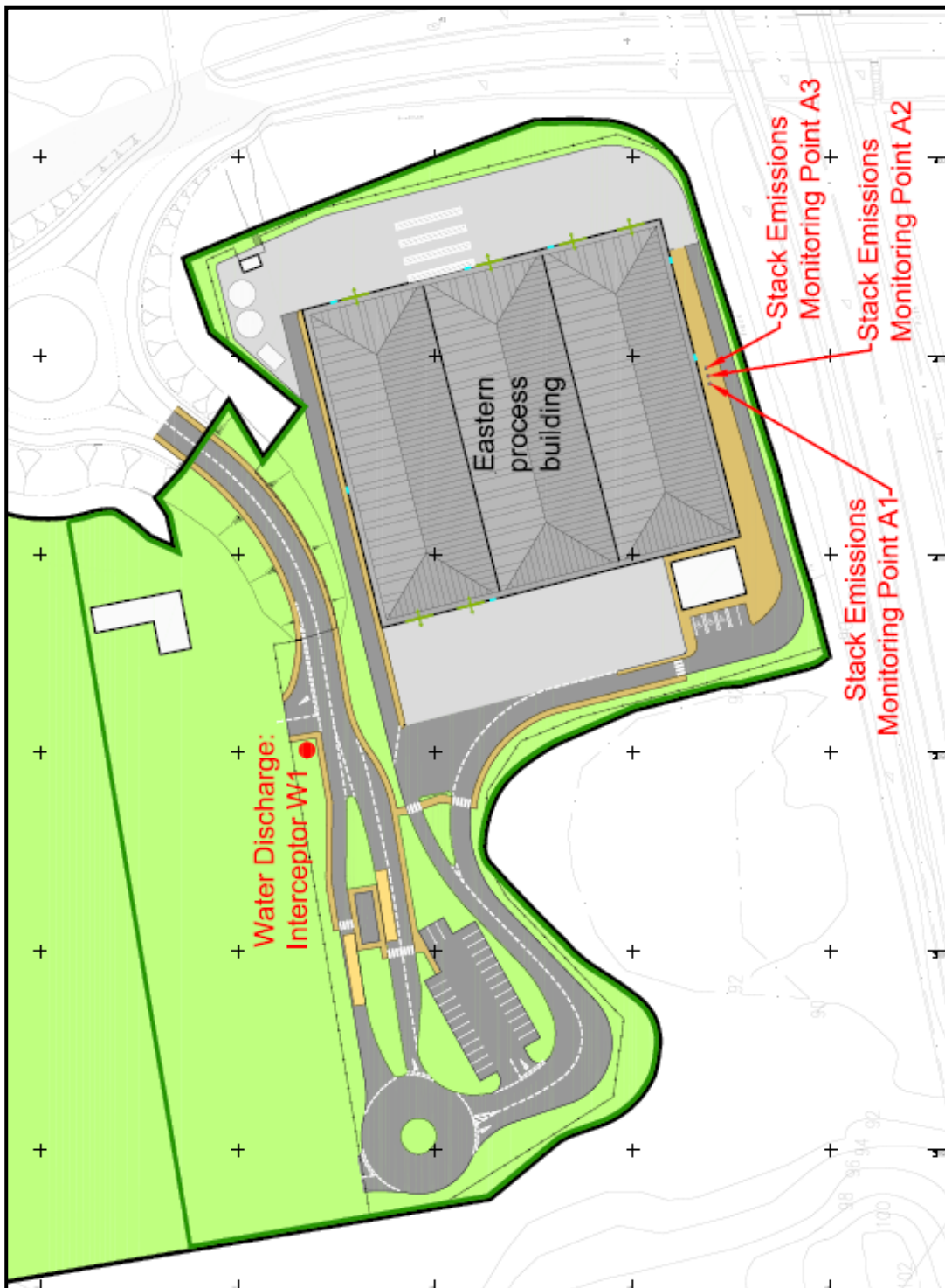

END OF PERMIT

## Emissions to Air Reporting Form

**Permit number:** EPR/EP3033EJ

**Operator:** SUEZ Recycling and Recovery UK Limited

**Facility name:** Rugby Solid Recovered Fuel Facility

**Emissions to Air Reporting Form: version 1, 08/03/2021**

Reporting of emissions to air for the period from *[DD/MM/YY]* to *[DD/MM/YY]*

| Emission point | Substance / parameter | Emission Limit Value | Reference period | Test method <sup>1</sup> | Result <sup>2</sup> | Sample dates and times <sup>3</sup> | Uncertainty <sup>4</sup> |
|----------------|-----------------------|----------------------|------------------|--------------------------|---------------------|-------------------------------------|--------------------------|
| A1             |                       |                      |                  |                          |                     |                                     |                          |
| A2             |                       |                      |                  |                          |                     |                                     |                          |
| A3             |                       |                      |                  |                          |                     |                                     |                          |
|                |                       |                      |                  |                          |                     |                                     |                          |
|                |                       |                      |                  |                          |                     |                                     |                          |
|                |                       |                      |                  |                          |                     |                                     |                          |
|                |                       |                      |                  |                          |                     |                                     |                          |
|                |                       |                      |                  |                          |                     |                                     |                          |
|                |                       |                      |                  |                          |                     |                                     |                          |
|                |                       |                      |                  |                          |                     |                                     |                          |

**Signed:** *[Name]*

**Date:** *[DD/MM/YY]*

(Authorised to sign as representative of the operator)

---

**Guidance for use:** Use this form to report your monitoring results.

Example text is shown in bracketed grey italics. Replace the example text by entering your own site specific information. Complete columns 1 to 5 using the information from schedule 3 of your permit. Complete columns 6 to 8 with your monitoring data. Add additional rows as necessary.

- <sup>1</sup> Where an internationally recognised standard test method is used, give the reference number. Where another method that has been formally agreed with the Environment Agency, give the appropriate identifier. In other cases state the principal technique, for example gas chromatography.
- <sup>2</sup> Give the result as the maximum value (or the minimum value in the case of a limit that is expressed as a minimum) obtained during the reporting period, expressed in the same terms as the emission limit value. Where the emission limit value is expressed as a range, give the result as the 'minimum to maximum' of the measured values.
- <sup>3</sup> For non-continuous measurements give the date and time of the sample that produced the result. For continuous measurements give the percentage of the process operating time covered by the result.
- <sup>4</sup> Complete if the uncertainty associated with the result is not a 95% confidence interval. Leave blank for 95% confidence intervals.

# Water Usage Reporting Form

**Permit number:** EPR/EP3033EJ

**Operator:** SUEZ Recycling and Recovery UK Limited

**Facility name:** Rugby Solid Recovered Fuel Facility

**Water Usage Reporting Form: version 1, 08/03/2021**

Reporting of water usage for the year [YYYY]

| Water source      | Water usage (m <sup>3</sup> )   | Specific water usage (m <sup>3</sup> /unit) <sup>2</sup>                     |
|-------------------|---|--|
| Mains water       | <i>[insert annual usage in m<sup>3</sup> where mains water is used]</i> | <i>[insert annual usage in m<sup>3</sup>/unit where mains water is used]</i> |
| Total water usage | <i>[insert total annual water usage in m<sup>3</sup>]</i>               | <i>[insert total annual water usage in m<sup>3</sup>/unit]</i>               |

|  |
|--|
| <b>Operator's comments</b>               |
| <br><br><br><br><br><br><br><br><br><br> |

**Signed:** [Name]

**Date:** [DD/MM/YY]

(Authorised to sign as representative of the operator)

---

**Guidance for use:** Use this form to report your annual water usage.

Example text is shown in bracketed grey italics. Replace the example text by entering your own site specific information. Add additional rows as necessary.

## Energy Usage Reporting Form

**Permit number:** EPR/EP3033EJ

**Operator:** SUEZ Recycling and Recovery UK Limited

**Facility name:** Rugby Solid Recovered Fuel Facility

**Energy Usage Reporting Form: version 1, 08/03/2021**

Reporting of energy usage for the year [YYYY]

| Energy source   | Energy consumption / production (MWh)                                   | Specific energy consumption (MWh/unit) <sup>2</sup>                          |
|---|---|--|
| Electricity imported as delivered - source [specify source, e.g. supplied from the national grid]   | <i>[insert annual consumption in MWh where electricity is imported]</i> | <i>[insert annual consumption in MWh/unit where electricity is imported]</i> |
| Electricity imported as primary energy 1 – conversion factor of [specify conversion factor used to convert electricity delivered to primary energy] | <i>[insert annual consumption in MWh where electricity is imported]</i> | <i>[insert annual consumption in MWh/unit where electricity is imported]</i> |
| Natural gas   | <i>[insert annual consumption in MWh where natural gas is used]</i>     | <i>[insert annual consumption in MWh/unit where natural gas is used]</i>     |
| Gas oil – conversion factor of [specify conversion factor used to convert tonnes to MWh]  | <i>[insert annual consumption in MWh where gas oil is used]</i>         | <i>[insert annual consumption in MWh/unit where gas oil is used]</i>         |
| Imported heat   | <i>[insert annual consumption in MWh where heat is imported]</i>        | <i>[insert annual consumption in MWh/unit where heat is imported]</i>        |
| Other – <i>[specify other energy source and conversion factors where applicable, e.g. renewable fuel. Add extra rows where needed]</i>              | <i>[insert annual consumption in MWh where applicable]</i>              | <i>[insert annual consumption in MWh/unit where applicable]</i>              |
| Electricity exported  | <i>[insert annual production in MWh where electricity is exported]</i>  | Not applicable   |
| Heat exported   | <i>[insert annual production in MWh where heat is exported]</i>         | Not applicable   |

|                            |
|----------------------------|
| <b>Operator's comments</b> |
|                            |

**Signed:**     *[Name]*

**Date:**       *[DD/MM/YY]*

(Authorised to sign as representative of the operator)

---

**Guidance for use:** Use this form to report your annual energy usage.

Example text is shown in bracketed grey italics. Replace the example text by entering your own site specific information. Add additional rows as necessary.

<sup>1</sup> Multiply delivered electricity by 2.4 to convert to primary energy where the electricity is supplied from the national grid. If the electricity is supplied from another source, specify the conversion factor used. Add additional rows as needed if electricity is imported from multiple sources.

<sup>2</sup> Divide energy consumption by an appropriate unit of raw material processed or product output.

# Other Performance Parameters Reporting Form

**Permit number:** EPR/EP3033EJ

**Operator:** SUEZ Recycling and Recovery UK Limited

**Facility name:** Rugby Solid Recovered Fuel Facility  
**08/03/2021**

**Other Performance Parameters Reporting Form: version 1,**

Reporting of other performance parameters for the period from [DD/MM/YY] to [DD/MM/YY]

| Parameter                      | Units  |
|--------------------------------|--------|
| Total raw material used        | Tonnes |
| Bag filter pressure difference |        |
|                                |        |
|                                |        |
|                                |        |
|                                |        |
|                                |        |

|                            |
|----------------------------|
| <b>Operator's comments</b> |
|                            |



**Signed:** *[Name]*

**Date:** *[DD/MM/YY]*

(Authorised to sign as representative of the operator)

---

**Guidance for use:** Use this form to report the performance parameters (other than water and energy) required by your permit. Example text is shown in bracketed grey italics. Replace the example text by entering your own site specific information. The parameters to report and units to be used can be found in the 'Performance parameters' table in schedule 4 of your permit. Add additional rows as necessary.