

# Notice of variation and consolidation with introductory note

## The Environmental Permitting (England & Wales) Regulations 2016

---

R. G. Boyce Limited

Leys Poultry Farm  
Leys Farm  
Lidgate  
Newmarket  
Suffolk  
CB8 9PS

### **Variation application number**

EPR/QP3231MA/V005

### **Permit number**

EPR/QP3231MA

# Leys Poultry Farm

## Permit number EPR/QP3231MA

### Introductory note

#### **This introductory note does not form a part of the notice.**

Under the Environmental Permitting (England & Wales) Regulations 2016 (schedule 5, part 1, paragraph 19) a variation may comprise a consolidated permit reflecting the variations and a notice specifying the variations included in that consolidated permit.

Schedule 1 of the notice specifies the conditions that have been varied and schedule 2 comprises a consolidated permit which reflects the variations being made. Only the variations specified in schedule 1 are subject to a right of appeal.

This variation authorises the following changes:

This variation increases the rearing capacity of the Installation from 514,640 to 588,784 broilers. There will be two new poultry houses, numbered 14 and 15, and poultry house 8 has been decommissioned. This variation also includes changes to ancillary structures, including a new dirty water tank and LPG tank. Hatching eggs can also be brought on site from a hatchery, and any unhatched eggs are collected and disposed of via a mobile macerator. Improvement condition (IC3) has been completed.

We have reviewed the new housing introduced with the permit variation for this installation against the best available techniques (BAT) conclusions as defined in the intensive rearing of poultry or pigs (IRPP) BAT conclusions document, dated 21/02/2017. The permit conditions and schedules ensure the compliance of the new housing with this BAT conclusions document.

The rest of the installation is unchanged and is operated as follows:

Leys Poultry Farm is located approximately one kilometre south of Lidgate and is centred on National Grid Reference TL 72988 56512. The land around the site is predominantly agricultural.

There are a total of fourteen poultry houses on site. The houses have concrete floors covered with woodchips or shavings. Water is delivered through nipple drinkers with cups and feed is stored in silos on site. Roof and yard water (other than during periods of house washout) drains to either soakaways, a lagoon or a pond.

Houses 3, 4, 6, 7, 9, 10, 11 and 12 have side ventilation. Houses 1, 2, 5, 7A, 14 & 15 have high velocity roof ventilation, at a height at or greater than 3.5m and with an efflux velocity at or greater than 9.7 metres per second. All houses also have gable fans to occasionally supplement the ventilation during hot weather. Liquefied petroleum gas (LPG) is available for site heating.

Chicks or hatching eggs are brought onto site from the hatchery and are reared for 6 to 8 weeks prior to export for processing. Unhatched eggs are collected and disposed of via a mobile macerator. Fallen stock are collected from the houses daily and stored in a chilled container prior to removal from site. Litter is collected in covered trailers following each crop cycle and exported off site for use as a fuel in a power station. The houses are then washed and disinfected. Wash water is channelled to one of two dirty water tanks and then exported from site to be spread on third party land.

There are two other nature conservation sites within 2 km of the installation, comprising of one Local Wildlife Site (LWS) and one Ancient Woodland (AW). An assessment of the impact of emissions has been carried out and the installation is considered to have no adverse effect on the nature conservation sites.

The schedules specify the changes made to the permit.

The status log of a permit sets out the permitting history, including any changes to the permit reference number.

<b>Status log of the permit</b>		
<b>Description</b>	<b>Date</b>	<b>Comments</b>
Application received EPR/QP3231MA	Duly made 01/02/2007	Application for intensive farming permit (>40,000 poultry).
Permit determined EPR/QP3231MA	27/07/2007	Original permit issued to R G Boyce Limited.
Application EPR/QP3231MA/V002	Duly made 24/02/2012	Application to add two poultry houses and increase broiler places from 340,000 to 438,000.
Additional information received	30/03/2012	Balancing pond information, drainage details for house 8 and location plan showing generators and diesel tanks.
	19/04/2012	Financial information.
	24/04/2012	Ventilation system for house 8 and septic tank details.
	30/04/2012	Drainage details for house 8.
	01/05/2012	Ventilation confirmation for houses 1 to 5 and 8 to 12.
Variation determined EPR/QP3231MA/V002	09/05/2012	Varied permit issued to R G Boyce Limited.
Application EPR/QP3231MA/V005	Duly made 22/03/2018	Application to increase capacity from 438,000 to 514,640 broilers, add two new houses (1 and 7A) and vary the site layout and infrastructure.
Response to Schedule 5 Notice dated 02/05/2018	27/06/2018	Provision of revised Odour Management Plan, Noise Management Plan and details regarding site drainage.
Additional information received	04/07/2018	Revised site layout plan.
Variation determined EPR/QP3231MA/V003	06/08/2018	Varied and consolidated permit issued in modern condition format. Registered company address of the operator is also updated.
Notified of change of registered office	05/10/2021	Registered office address changed to Ruffles Barn Brookside, Dalham, Newmarket, Suffolk, CB8 8TG.
Variation issued EPR/QP3231MA/V004	14/01/2022	Varied permit issued to R. G. Boyce Limited.
Application EPR/QP3231MA/V005 (variation and consolidation)	Duly made 06/09/2022	Application to increase capacity from 514,640 to 588,784 broilers, add two new poultry houses (numbered 14 & 15), remove a poultry house (numbered 8) and vary the site layout and infrastructure.
Additional information received	29/09/2022	Details on mobile macerator, generator operation and revised odour management plan received.
Variation determined EPR/QP3231MA (billing reference: YP3304MG)	03/11/2022	Varied and consolidated permit issued in modern condition format.

End of introductory note

# Notice of variation and consolidation

## The Environmental Permitting (England and Wales) Regulations 2016

The Environment Agency in exercise of its powers under regulation 20 of the Environmental Permitting (England and Wales) Regulations 2016 varies and consolidates

### Permit number

EPR/QP3231MA

### Issued to

**R. G. Boyce Limited** (“the operator”)

whose registered office is

**Ruffles Barn Brookside**

**Dalham**

**Newmarket**

**Suffolk**

**CB8 8TG**

company registration number **01151171**

to operate an installation at

**Leys Poultry Farm**

**Leys Farm**

**Lidgate**

**Newmarket**

**Suffolk**

**CB8 9PS**

to the extent set out in the schedules.

The notice shall take effect from 03/11/2022.

Name	Date
<b>Philip Lamb</b>	<b>03/11/2022</b>

Authorised on behalf of the Environment Agency

## **Schedule 1**

All conditions have been varied by the consolidated permit EPR/QP3231MA/V005 as a result of the application made by the operator.

## **Schedule 2 – consolidated permit**

Consolidated permit issued as a separate document.

# Permit

## The Environmental Permitting (England and Wales) Regulations 2016

### Permit number

**EPR/QP3231MA**

This is the consolidated permit referred to in the variation and consolidation notice for application EPR/QP3231MA/V005 authorising,

**R. G. Boyce Limited** (“the operator”),

whose registered office is

**Ruffles Barn Brookside**

**Dalham**

**Newmarket**

**Suffolk**

**CB8 8TG**

company registration number **01151171**

to operate an installation at

**Leys Poultry Farm**

**Leys Farm**

**Lidgate**

**Newmarket**

**Suffolk**

**CB8 9PS**

to the extent authorised by and subject to the conditions of this permit.

Name	Date
<b>Philip Lamb</b>	<b>03/11/2022</b>

Authorised on behalf of the Environment Agency

# Conditions

## 1 Management

### 1.1 General management

1.1.1 The operator shall manage and operate the activities:

- (a) in accordance with a written management system that identifies and minimises risks of pollution, so far as is reasonably practicable, including those risks arising from operations, maintenance, accidents, incidents, non-conformances, closure and those drawn to the attention of the operator as a result of complaints; and
- (b) using sufficient competent persons and resources.

1.1.2 Records demonstrating compliance with condition 1.1.1 shall be maintained.

1.1.3 Any person having duties that are or may be affected by the matters set out in this permit shall have convenient access to a copy of the permit.

### 1.2 Energy efficiency

1.2.1 The operator shall:

- (a) take appropriate measures to ensure that energy is used efficiently in the activities; and
- (b) maintain records of fuel and energy consumption used in the activities.

### 1.3 Efficient use of raw materials

1.3.1 The operator shall:

- (a) take appropriate measures to ensure that raw materials and water are used efficiently in the activities; and
- (b) maintain records of raw materials and water used in the activities.

### 1.4 Avoidance, recovery and disposal of wastes produced by the activities

1.4.1 The operator shall take appropriate measures to ensure that the waste hierarchy referred to in Article 4 of the Waste Framework Directive is applied to the generation of waste by the activities and that;

- (a) any waste generated by the activities is treated in accordance with the waste hierarchy referred to in Article 4 of the Waste Framework Directive; and
- (b) where disposal is necessary, this is undertaken in a manner which minimises its impact on the environment.

## 2 Operations

### 2.1 Permitted activities

2.1.1 The only activities authorised by the permit are the activities specified in schedule 1 table S1.1 (the "activities").

## **2.2 The site**

- 2.2.1 The activities shall not extend beyond the site, being the land shown edged in green on the site plan at schedule 7 to this permit.

## **2.3 Operating techniques**

- 2.3.1 The activities shall, subject to the conditions of this permit, be operated using the techniques and in the manner described in the documentation specified in schedule 1, table S1.2, unless otherwise agreed in writing by the Environment Agency.
- 2.3.2 If notified by the Environment Agency that the activities are giving rise to pollution, the operator shall submit to the Environment Agency for approval within the period specified, a revision of any plan or other documentation ("plan") specified in schedule 1, table S1.2 or otherwise required under this permit which identifies and minimises the risks of pollution relevant to that plan, and shall implement the approved revised plan in place of the original from the date of approval, unless otherwise agreed in writing by the Environment Agency.
- 2.3.3 The operator shall maintain and implement a system to record the number of animal places and animal movements.
- 2.3.4 The operator shall ensure that a diet formulation and nutritional strategy is used to reduce the total nitrogen and total phosphorus excreted.
- 2.3.5 The operator shall take appropriate measures in disposal or recovery of solid manure or slurry to prevent, or where this is not practicable, to minimise pollution.
- 2.3.6 Any raw materials or fuels listed in schedule 2 table S2.1 shall conform to the specifications set out in that table.
- 2.3.7 The operator shall ensure that where waste produced by the activities is sent to a relevant waste operation, that operation is provided with the following information, prior to the receipt of the waste:
- (a) the nature of the process producing the waste;
  - (b) the composition of the waste;
  - (c) the handling requirements of the waste;
  - (d) the hazardous property associated with the waste, if applicable; and
  - (e) the waste code of the waste.

## **2.4 Improvement programme**

- 2.4.1 The operator shall complete the improvements specified in schedule 1 table S1.3 by the date specified in that table unless otherwise agreed in writing by the Environment Agency.
- 2.4.2 Except in the case of an improvement which consists only of a submission to the Environment Agency, the operator shall notify the Environment Agency within 14 days of completion of each improvement.

# **3 Emissions and monitoring**

## **3.1 Emissions to water, air or land**

- 3.1.1 There shall be no point source emissions to water, air or land except from the sources and emission points specified in table S3.1, S3.2 and S3.3.
- 3.1.2 The limits given in schedule 3 shall not be exceeded.
- 3.1.3 Periodic monitoring shall be carried out at least once every 5 years for groundwater and 10 years for soil, unless such monitoring is based on a systematic appraisal of the risk of contamination.



## **3.2 Emissions of substances not controlled by emission limits**

- 3.2.1 Emissions of substances not controlled by emission limits shall not cause pollution. The operator shall not be taken to have breached this condition if appropriate measures, including, but not limited to, those specified in any approved emissions management plan, have been taken to prevent or where that is not practicable, to minimise, those emissions.
- 3.2.2 The operator shall:
- (a) if notified by the Environment Agency that the activities are giving rise to pollution, submit to the Environment Agency for approval within the period specified, an emissions management plan which identifies and minimises the risks of pollution from emissions of substances not controlled by emission limits; and
  - (b) implement the approved emissions management plan, from the date of approval, unless otherwise agreed in writing by the Environment Agency.
- 3.2.3 All liquids in containers, whose emission to water or land could cause pollution, shall be provided with secondary containment, unless the operator has used other appropriate measures to prevent or where that is not practicable, to minimise, leakage and spillage from the primary container.

## **3.3 Odour**

- 3.3.1 Emissions from the activities shall be free from odour at levels likely to cause pollution outside the site, as perceived by an authorised officer of the Environment Agency, unless the operator has used appropriate measures, including, but not limited to, those specified in any approved odour management plan, to prevent or where that is not practicable to minimise the odour.

## **3.4 Noise and vibration**

- 3.4.1 Emissions from the activities shall be free from noise and vibration at levels likely to cause pollution outside the site, as perceived by an authorised officer of the Environment Agency, unless the operator has used appropriate measures, including, but not limited to, those specified in any approved noise and vibration management plan to prevent or where that is not practicable to minimise the noise and vibration.

## **3.5 Monitoring**

- 3.5.1 The operator shall, unless otherwise agreed in writing by the Environment Agency, undertake the monitoring specified in the following tables in schedule 3 to this permit:
- (a) point source emissions specified in tables S3.1, S3.2; and
  - (b) process monitoring specified in table S3.3.
- 3.5.2 The operator shall maintain records of all monitoring required by this permit including records of the taking and analysis of samples, instrument measurements (periodic and continual), calibrations, examinations, tests and surveys and any assessment or evaluation made on the basis of such data.
- 3.5.3 Monitoring equipment, techniques, personnel and organisations employed for the emissions monitoring programme and the environmental or other monitoring specified in condition 3.5.1 shall have either MCERTS certification or MCERTS accreditation (as appropriate), where available, unless otherwise agreed in writing by the Environment Agency.

## **3.6 Pests**

- 3.6.1 The activities shall not give rise to the presence of pests which are likely to cause pollution, hazard or annoyance outside the boundary of the site. The operator shall not be taken to have breached this condition if appropriate measures, including, but not limited to, those specified in any approved pests management plan, have been taken to prevent or where that is not practicable, to minimise the presence of pests on the site.

3.6.2 The operator shall:

- (a) if notified by the Environment Agency, submit to the Environment Agency for approval within the period specified, a pests management plan which identifies and minimises risks of pollution, hazard or annoyance from pests; and
- (b) implement the pests management plan, from the date of approval, unless otherwise agreed in writing by the Environment Agency.

## 4 Information

### 4.1 Records

4.1.1 All records required to be made by schedules 3, 4 and 5 to this permit shall:

- (a) be legible;
- (b) be made as soon as reasonably practicable;
- (c) if amended, be amended in such a way that the original and any subsequent amendments remain legible, or are capable of retrieval; and
- (d) be retained, unless otherwise agreed in writing by the Environment Agency, for at least 6 years from the date when the records were made, or in the case of the following records until permit surrender:
  - (i) off-site environmental effects; and
  - (ii) matters which affect the condition of the land and groundwater.

4.1.2 The operator shall maintain convenient access, in either electronic or hard copy, to the records, plans and management system required to be maintained by this permit.

### 4.2 Reporting

4.2.1 The operator shall send all reports and notifications required by the permit to the Environment Agency using the contact details supplied in writing by the Environment Agency.

4.2.2 For the following activities referenced in schedule 1, table S1.1 a report or reports on the performance of the activities over the previous year shall be submitted to the Environment Agency by 31 January (or other date agreed in writing by the Environment Agency) each year. The report(s) shall include as a minimum:

- (a) a review of the results of the monitoring and assessment carried out in accordance with the permit including an interpretive review of that data.

4.2.3 Within 28 days of the end of the reporting period the operator shall, unless otherwise agreed in writing by the Environment Agency, submit reports of the monitoring and assessment carried out in accordance with the conditions of this permit, as follows:

- (a) in respect of the parameters and emission points specified in schedule 4 table S4.1;
- (b) for the reporting periods specified in schedule 4 table S4.1 and using the forms specified in schedule 4 table S4.2; and
- (c) giving the information from such results and assessments as may be required by the forms specified in those tables.

4.2.4 The operator shall, unless notice under this condition has been served within the preceding four years, submit to the Environment Agency, within six months of receipt of a written notice, a report assessing whether there are other appropriate measures that could be taken to prevent, or where that is not practicable, to minimise pollution.

## 4.3 Notifications

### 4.3.1 In the event:

- (a) that the operation of the activities gives rise to an incident or accident which significantly affects or may significantly affect the environment, the operator must immediately:-
  - (i) inform the Environment Agency,
  - (ii) take the measures necessary to limit the environmental consequences of such an incident or accident, and
  - (iii) take the measures necessary to prevent further possible incidents or accidents; and
- (b) of a breach of any permit condition the operator must immediately :-
  - (i) inform the Environment Agency, and
  - (ii) take the measures necessary to ensure that compliance is restored within the shortest possible time;
- (c) of a breach of permit condition which poses an immediate danger to human health or threatens to cause an immediate significant adverse effect on the environment, the operator must immediately suspend the operation of the activities or the relevant part of it until compliance with the permit conditions has been restored.

4.3.2 Any information provided under condition 4.3.1 shall be confirmed by sending the information listed in schedule 5 to this permit within the time period specified in that schedule.

4.3.3 Where the Environment Agency has requested in writing that it shall be notified when the operator is to undertake monitoring and/or spot sampling, the operator shall inform the Environment Agency when the relevant monitoring and/or spot sampling is to take place. The operator shall provide this information to the Environment Agency at least 14 days before the date the monitoring is to be undertaken.

4.3.4 The Environment Agency shall be notified within 14 days of the occurrence of the following matters, except where such disclosure is prohibited by Stock Exchange rules:

Where the operator is a registered company:

- (a) any change in the operator's trading name, registered name or registered office address; and
- (b) any steps taken with a view to the operator going into administration, entering into a company voluntary arrangement or being wound up.

Where the operator is a corporate body other than a registered company:

- (c) any change in the operator's name or address; and
- (d) any steps taken with a view to the dissolution of the operator.

In any other case:

- (e) the death of any of the named operators (where the operator consists of more than one named individual);
- (f) any change in the operator's name(s) or address(es); and
- (g) any steps taken with a view to the operator, or any one of them, going into bankruptcy, entering into a composition or arrangement with creditors, or, in the case of them being in a partnership, dissolving the partnership.

4.3.5 Where the operator proposes to make a change in the nature or functioning, or an extension of the activities, which may have consequences for the environment and the change is not otherwise the subject of an application for approval under the Regulations or this permit:

- (a) the Environment Agency shall be notified at least 14 days before making the change; and
- (b) the notification shall contain a description of the proposed change in operation.

- 4.3.6 The Environment Agency shall be given at least 14 days' notice before implementation of any part of the site closure plan.
- 4.3.7 Where the operator has entered into a climate change agreement with the Government, the Environment Agency shall be notified within one month of:
- (a) a decision by the Secretary of State not to re-certify the agreement;
  - (b) a decision by either the operator or the Secretary of State to terminate the agreement; and
  - (c) any subsequent decision by the Secretary of State to re-certify such an agreement.

## **4.4 Interpretation**

- 4.4.1 In this permit the expressions listed in schedule 6 shall have the meaning given in that schedule.
- 4.4.2 In this permit references to reports and notifications mean written reports and notifications, except where reference is made to notification being made "immediately", in which case it may be provided by telephone.

# Schedule 1 – Operations

Table S1.1 Activities		
Activity listed in Schedule 1 of the EP Regulations	Description of specified activity	Limits of specified activity
Section 6.9 A(1)(a)(i) Rearing of poultry intensively in an installation with more than 40,000 places	The rearing of poultry in a facility with a capacity for 588,784 broiler places.	From receipt of eggs or birds, raw materials and fuels onto the site to removal of birds and associated wastes from site.

Table S1.2 Operating techniques		
Description	Parts	Date Received
Application EPR/QP3231MA/A001	Responses to sections B2.3.1, B2.3.2, B2.3.3, B2.6.1, B2.6.2, B2.6.3, B2.7.1 and B2.7.2 in the Application.	23/01/2007
Variation application EPR/QP3231MA/V002	Response to Part C3 section 3 of the application form and referenced supporting documentation.	13/02/2012
Request for information dated 26/03/2012	Response to request for information confirming balancing pond details and drainage details for house 8.	30/03/2012
	Response to request for information confirming ventilation details for house 8 and septic tank details.	24/04/2012
Variation application EPR/QP3231MA/V003	Response to question 8a of the Part C3.5 form regarding technical standards, section 4, entitled 'Operating Techniques', of the document reference 3799-1312-A, section 3, entitled 'Site Operations', of the document reference 3799-1312-B, document entitled 'Dealing with an Incident', Dust Management Plan (version 1.1 – 04 January 2018).	09/01/2018
	Response to question 3 of the request for information dated 20/02/18 confirming compliance of the livestock housing with the Conclusions on Best Available Techniques.	28/02/2018
Response to Schedule 5 Notice dated 02/05/2018	Odour Management Plan (version 1.4, dated 22/06/18), Noise Management Plan (document number 3799-1312-C) and information contained in email regarding site drainage.	27/06/2018
Further information provided	Site layout plan 'MFC084 A 02 02 revision G'.	04/07/2018
Application EPR/QP3231MA/V005 (variation and consolidation)	Responses to Part C3.5 of the application form and referenced supporting documentation.  Additional information received in response to not duly made request for information including confirmation of use of a mobile macerator for the unhatched eggs, and receipt of the following documents:  Site and drainage plan (revised) Odour management plan (revised) Noise management plan (revised).	06/09/2022
Additional information requested 07/09/2022, 20/09/2022 & 22/09/2022	Response confirming details on mobile macerator and standby generator operation, and receipt of the following document:  Odour management plan (revised).	29/09/2022

**Table S1.3 Improvement programme requirements**

Reference	Requirement	Date
IC1	<p>A written plan shall be submitted to the Agency for approval, following a review of all site drainage at the installation. The plan should take into account the appropriate measures for the management of drainage systems and run-off in S3.3 of TGN How to Comply, Version 1, including specific reference to drainage from roofs (with roof ridge extraction outlets) contaminated by slurry and include a timetable for any improvements to the drainage system. The notification requirements of condition 2.5.2 shall be deemed to have been complied with on submission of the plan.</p>	Complete
IC2	<p>A written plan shall be submitted to the Agency for approval following a review of existing poultry housing and management practices at the installation. The plan shall take into account the appropriate measures in S6.2.1 &amp; S6.2.2 of TGN How to Comply, Version 1. The plan shall identify measures to reduce emissions to all media, the likely cost of such measures and a proposed timetable for their implementation. The notification requirements of condition 2.5.2 shall be deemed to have been complied with on submission of the plan.</p> <p>The plan shall be implemented by the operator from the date of approval in writing by the Agency subject to such amendments or additions as notified by the Agency.</p>	Complete
IC3	<p>The Operator shall provide a written report to the Environment Agency for approval. The report shall contain proposals to modify or replace the wash water tank new to the permit through variation application EPR/QP3231MA/V003 to demonstrate compliance with our Sector Guidance Note EPR 6.09 'How to comply with your environmental permit for intensive farming' (version 2, January 2010). The Operator shall have regard of, but not limited to, the specific sections on slurry storage (including wash water) as detailed on pages 35 and 36 of the above defined Sector Guidance Note. The proposals contained in the report shall be implemented as agreed by the Environment Agency.</p>	Complete

## Schedule 2 – Waste types, raw materials and fuels

Table S2.1 Raw materials and fuels	
Raw materials and fuel description	Specification
---	---

## Schedule 3 – Emissions and monitoring

Table S3.1 Point source emissions to air – emission limits and monitoring requirements						
Emission point ref. & location	Source	Parameter	Limit (including unit)	Reference period	Monitoring frequency	Monitoring standard or method
High velocity roof fan outlets on poultry houses 1, 2, 5, 7A, 14 and 15 shown on the site plan in schedule 7	Poultry houses 1, 2, 5, 7A, 14 and 15	---	---	---	---	---
Side fan outlets on poultry houses 3, 4, 6, 7, 9, 10, 11 and 12 as shown on the site plan in schedule 7	Poultry houses 3, 4, 6, 7, 9, 10, 11 and 12	---	---	---	---	---
Gable end fan outlets on poultry houses 1 to 7A, and 9 to 15 as shown on the site plan in schedule 7	Poultry houses 1, 2, 3, 4, 5, 6, 7, 7A, 9, 10, 11, 12, 14 and 15	---	---	---	---	---
Exhaust from three standby generators as shown on the site plan reference 'revised permit plan ref MFC168 A 03 01' in application EPR/QP3231MA/V005 received 06/09/2022	Standby generators	---	---	---	---	---
Vent from fuel tank as shown on the site plan reference 'revised permit plan ref MFC168 A 03 01' in application EPR/QP3231MA/V005 received 06/09/2022	Diesel tank	---	---	---	---	---



**Table S3.2 Point Source emissions to water (other than sewer) and land – emission limits and monitoring requirements**

Emission point ref. & location	Source	Parameter	Limit (incl. unit)	Reference Period	Monitoring frequency	Monitoring standard or method
Soakaways beside poultry houses 3, 4, 6, 7, 9, 10, 11, 12, 14 and 15 as shown on the site plan in schedule 7	Roof and yard water from poultry houses 3, 4, 6, 7, 9, 10, 11, 12, 14 and 15 (excluding poultry house wash out periods)	---	---	---	---	---
Attenuation pond named 'lagoon' as shown on the site plan reference 'revised permit plan ref MFC168 A 03 01' in application EPR/QP3231MA/V005 received 06/09/2022	Roof and yard water from poultry houses 1, 2, 5 and 7A (excluding poultry house wash out periods) and overflow from the soakaways serving houses 3, 4, 6, 7, 14 and 15 via sediment traps	---	---	---	---	---
Outlet from attenuation pond named 'lagoon' via pond to a ditch tributary of the River Kennett at NGR TL 73152 56732 as shown on the site plan reference 'revised permit plan ref MFC168 A 03 01' in application EPR/QP3231MA/V005 received 06/09/2022	Overflow from the attenuation pond and pond	---	---	---	---	---

**Table S3.3 Process monitoring requirements**

<b>Emission point reference or source or description of point of measurement</b>	<b>Parameter</b>	<b>Limit (incl. Unit)</b>	<b>Monitoring frequency</b>	<b>Monitoring standard or method</b>
Broilers in poultry houses 1 to 7A, and 9 to 15	kg N excreted/animal place/year	0.6 kg N/animal place/year	Annually	Estimation by using manure analysis for total nitrogen content
	kg P <sub>2</sub> O <sub>5</sub> excreted/animal place/year	0.25 kg P <sub>2</sub> O <sub>5</sub> animal place/year	Annually	Estimation by using manure analysis for total phosphorus content
	kg NH <sub>3</sub> /animal place/year	0.08 kg NH <sub>3</sub> /animal place/year	Annually	Estimation using emission factors
	Dust	N/A	Annually	Estimation using emission factors

# Schedule 4 – Reporting

Parameters, for which reports shall be made, in accordance with conditions of this permit, are listed below.

<b>Table S4.1 Reporting of monitoring data</b>			
<b>Parameter</b>	<b>Emission or monitoring point/reference</b>	<b>Reporting period</b>	<b>Period begins</b>
Process monitoring parameters as required by condition 3.5.1	-	Every 12 months	1 January

<b>Table S4.2 Reporting forms</b>		
<b>Media/parameter</b>	<b>Reporting format</b>	<b>Date of form</b>
kg NH <sub>3</sub> /animal place/year	Form Process Monitoring 1 or other form as agreed in writing by the Environment Agency	03/11/2022
kg N excreted/animal place/year	Form Process Monitoring 1 or other form as agreed in writing by the Environment Agency	03/11/2022
kg P <sub>2</sub> O <sub>5</sub> excreted/animal place/year	Form Process Monitoring 1 or other form as agreed in writing by the Environment Agency	03/11/2022
Dust atmospheric mass emission	Form Process Monitoring 1 or other form as agreed in writing by the Environment Agency	03/11/2022

# Schedule 5 – Notification

These pages outline the information that the operator must provide.

Units of measurement used in information supplied under Part A and B requirements shall be appropriate to the circumstances of the emission. Where appropriate, a comparison should be made of actual emissions and authorised emission limits.

If any information is considered commercially confidential, it should be separated from non-confidential information, supplied on a separate sheet and accompanied by an application for commercial confidentiality under the provisions of the EP Regulations.

## Part A

Permit number	
Name of operator	
Location of facility	
Time and date of the detection	

<b>(a) Notification requirements for any malfunction, breakdown or failure of equipment or techniques, accident, or emission of a substance not controlled by an emission limit which has caused, is causing or may cause significant pollution</b>	
<b>To be notified within 24 hours of detection</b>	
Date and time of the event	
Reference or description of the location of the event	
Description of where any release into the environment took place	
Substances(s) potentially released	
Best estimate of the quantity or rate of release of substances	
Measures taken, or intended to be taken, to stop any emission	
Description of the failure or accident.	

<b>(b) Notification requirements for the breach of a limit</b>	
<b>To be notified within 24 hours of detection</b>	
Emission point reference/ source	
Parameter(s)	
Limit	
Measured value and uncertainty	
Date and time of monitoring	
Measures taken, or intended to be taken, to stop the emission	

<b>Time periods for notification following detection of a breach of a limit</b>	
<b>Parameter</b>	<b>Notification period</b>

<b>(c) Notification requirements for the detection of any significant adverse environmental effect</b>	
<b>To be notified within 24 hours of detection</b>	
Description of where the effect on the environment was detected	
Substances(s) detected	
Concentrations of substances detected	
Date of monitoring/sampling	

## **Part B – to be submitted as soon as practicable**

Any more accurate information on the matters for notification under Part A.	
Measures taken, or intended to be taken, to prevent a recurrence of the incident	
Measures taken, or intended to be taken, to rectify, limit or prevent any pollution of the environment which has been or may be caused by the emission	
The dates of any unauthorised emissions from the facility in the preceding 24 months.	
Name*	
Post	
Signature	
Date	

\* authorised to sign on behalf of the operator

## Schedule 6 – Interpretation

“accident” means an accident that may result in pollution.

“application” means the application for this permit, together with any additional information supplied by the operator as part of the application and any response to a notice served under Schedule 5 to the EP Regulations.

“authorised officer” means any person authorised by the Environment Agency under section 108(1) of The Environment Act 1995 to exercise, in accordance with the terms of any such authorisation, any power specified in section 108(4) of that Act.

“building” means a construction that has the objective of providing sheltering cover and minimising emissions of noise, particulate matter, odour and litter.

“emissions to land” includes emissions to groundwater.

“emissions of substances not controlled by emission limits” means emissions of substances to air, water or land from the activities, either from the emission points specified in schedule 3 or from other localised or diffuse sources, which are not controlled by an emission limit.

“EP Regulations” means The Environmental Permitting (England and Wales) Regulations SI 2016 No.1154 and words and expressions used in this permit which are also used in the Regulations have the same meanings as in those Regulations.

“Existing housing” means housing that is not defined as new housing.

“groundwater” means all water, which is below the surface of the ground in the saturation zone and in direct contact with the ground or subsoil.

“Hazardous property” has the meaning in Annex III of the Waste Framework Directive.

“Industrial Emissions Directive” means DIRECTIVE 2010/75/EU OF THE EUROPEAN PARLIAMENT AND OF THE COUNCIL of 24 November 2010 on industrial emissions, as read in accordance with Schedule 1A to the Environmental Permitting (England and Wales) Regulations 2016.

“List of Wastes” means the list of wastes established by Commission Decision 2000/532/EC replacing Decision 94/3/EC establishing a list of wastes pursuant to Article 1(a) of Council Directive 75/442/EEC on waste and Council Decision 94/904/EC establishing a list of hazardous waste pursuant to Article 1(4) of Council Directive 91/689/EEC on hazardous waste, as amended from time to time.

“Manure and slurry” have the following meaning:

- Manures may be either slurries or solid manures.
- Slurries consist of excreta produced by livestock whilst in a yard or building mixed with rainwater and wash water and, in some cases, waste bedding and feed. Slurries can be pumped or discharged by gravity.
- Slurry includes duck effluent, seepage from manure and wash water.
- Solid manures include farmyard manure (FYM) and comprise material from straw-based housing systems, excreta with lots of straw/sawdust/woodchips in it, or solids from mechanical separators.
- Most poultry systems produce solid manure (litter).
- Solid manure can generally be stacked.

“New housing” means housing first permitted at the installation following the publication of the intensive rearing of poultry or pigs (IRPP) best available techniques (BAT) conclusions document dated 21/02/17, or a complete replacement of existing housing after 21/02/17.

“MCERTS” means the Environment Agency’s Monitoring Certification Scheme.

“pests” means Birds, Vermin and Insects.

“Waste code” means the six digit code referable to a type of waste in accordance with the List of Wastes and in relation to hazardous waste, includes the asterisk

“Waste Framework Directive” or “WFD” means Waste Framework Directive 2008/98/EC of the European Parliament and of the Council on waste.

“year” means calendar year ending 31 December.

# Schedule 7 – Site plan

Site plan - showing installation boundary as referred to in condition 2.2.1.

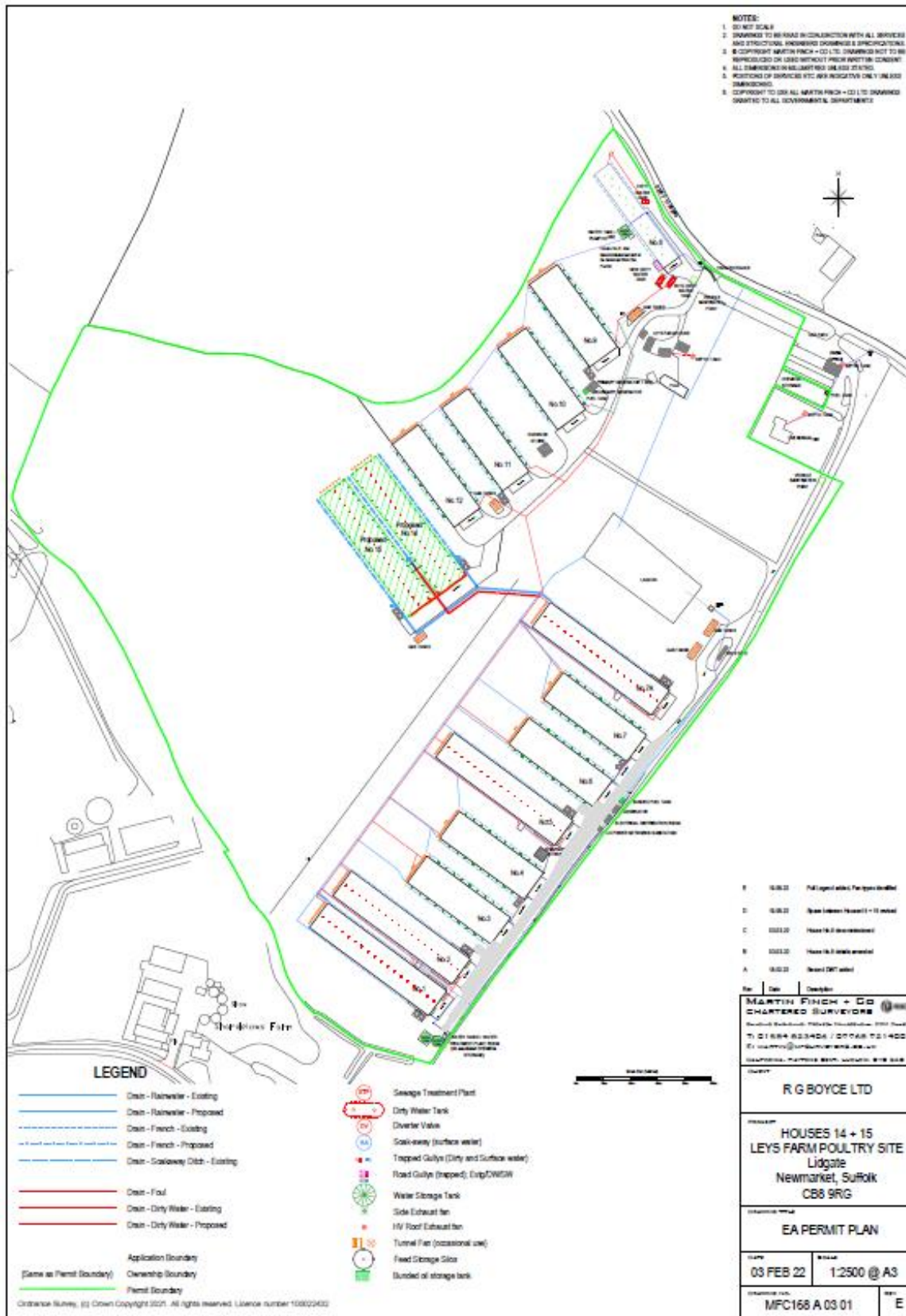

©Crown Copyright. All rights reserved. Environment Agency, 100024198, 2022.

END OF PERMIT

Permit number  
EPR/QP3231MA