

Notice of variation and consolidation with introductory note

The Environmental Permitting (England & Wales) Regulations 2016

Transwaste Recycling and Aggregates Limited

Melton Waste Park
Gibson Lane
Melton
East Yorkshire
HU14 3HH

Variation application number

EPR/BP3792LD/V009

Permit number

EPR/BP3792LD

Melton Waste Park

Permit number EPR/BP3792LD

Introductory note

This introductory note does not form a part of the notice

Under the Environmental Permitting (England & Wales) Regulations 2016 (schedule 5, part 1, paragraph 19) a variation may comprise a consolidated permit reflecting the variations and a notice specifying the variations included in that consolidated permit.

Schedule 1 of the notice specifies the conditions that have been varied and schedule 2 comprises a consolidated permit which reflects the variations being made. Only the variations specified in schedule 1 are subject to a right of appeal.

Changes introduced by this variation notice:

This permit variation has been issued to implement the following guidance “Non-hazardous and inert waste: appropriate measures for permitted facilities” and to implement the relevant requirements of the Best Available Techniques (BAT) Conclusions set out in implementing decision (EU) 2018/1147 of 10 August 2018.

The Industrial Emissions Directive (IED) came into force on 7 January 2014 with the requirement to implement all relevant Best Available Techniques (BAT) Conclusions as described in the Commission Implementing Decision.

Article 21(3) of the IED requires the Environment Agency to review conditions in permits that it has issued and to ensure that the permit delivers compliance with relevant standards, within four years of the publication of updated decisions on Best Available Techniques (BAT) Conclusions. The BAT Conclusions for Waste Treatment (the BREF) was published on 17 August 2018 following a European Union wide review of BAT, implementing decision (EU) 2018/1147 of 10 August 2018.

The non-hazardous and inert waste: appropriate measures for permitted facilities guidance was published on the gov.uk website on 12 July 2021. This guidance sets out the standards that are relevant to regulated facilities with a permit to store, treat or transfer (or both) non-hazardous and inert wastes.

This variation has consolidated the original permit and subsequent variations where appropriate.

Brief summary of the process

Melton Waste Park site is an installation and waste operations facility. The environmental permit allows Transwaste Recycling and Aggregates Limited to operate the following installation and directly associated activities (DAA):

- Section 5.4 Part A1(b)(ii) - recovery or a mix of recovery and disposal of non-hazardous waste with a capacity exceeding 75 tonnes per day involving pre-treatment of waste for incineration or co-incineration for the production of refuse derived fuels (RDF) and solid recovered fuels (SRF);
- Storage of waste prior to treatment;
- Bulking of recyclable wastes;
- Storage of SRF and RDF pending removal from the site;
- Storage of raw materials, including lubrication oil and diesel; and
- Surface water collection, storage and discharge.

In addition to the installation activities, the site is also permitted to carry out the following waste operation activities:

- Inert crushing and screening;

- Materials recycling facility and transfer station;
- Green waste pre-treatment and storage;
- Waste wood shredding and chipping; and
- Hazardous and non-hazardous wastes storage and transfer station – bulking up and storage only.

The RDF and SRF processes involve material sorting via trommels, wind sifting, and the use of magnets to remove inert materials, ferrous and non-ferrous metals prior to shredding. The SRF production is derived mainly from source segregated material including commercial wastes, mixed plastics and packaging wastes and is undertaken within sheds 2 and 3 while the RDF production process is undertaken within Shed 4 and involves the use of mixed municipal waste or black bagged wastes obtained from kerbside collections.

Both RDF and SRF materials when produced are exported offsite for recovery at R1 certified Energy from Waste facilities. Each batch is produced to meet a particular contractual standard of varying calorific values and moisture content. RDF production is undertaken in a sealed building with an air abatement system (air ionisation technology). SRF is processed in covered buildings with two openings which are partially closed with plastic sheeting and a misting system. Odorous waste is not permitted in the SRF process. Any excessively odorous waste is removed from site or moved to the RDF building which is fully enclosed.

There are no channelled (point source) emissions to air at the site but there are channelled emissions to surface water.

Except where allowed in Table S1.1 of this permit, treatment and storage of wastes at the site is authorised to take place on an impermeable surface with a sealed drainage system. Process waters that are generated within the treatment and storage area and areas that are served by sealed drainage are diverted through two full-retention separators working in parallel, then discharged via a settlement lagoon to an unnamed stream flowing to the Humber Estuary.

Transwaste Recycling and Aggregates Limited operate an ISO14001 Management System at the site.

The schedules specify the changes made to the permit.

The status log of a permit sets out the permitting history, including any changes to the permit reference number.

Status log of the permit		
Description	Date	Comments
Waste management licence 65528 determined.	30/03/2007	Application for a household, commercial and industrial waste transfer station with asbestos storage.
Variation EPR/BP3792LD/V002 determined.	28/04/09	Variation application to add WEEE activities and wastes.
Variation EPR/BP3792LD/V003 determined.	10/10/11	Variation application to include exempt activities and increase total annual tonnage.
Partial surrender EPR/BP3792LD/S004 determined.	22/01/13	Partial surrender application to remove part of the site area.
Variation EPR/BP3792LD/V005 determined.	21/10/13	Variation application to increase annual throughput to 500,000 tonnes.
Application EPR/BP3792LD/V006 (variation and consolidation)	Duly made 29/09/14	Variation application for the permitted activities to meet the requirements of the IED and to increase the total throughput to 750,250 tonnes.
Additional information received	21/10/16	Schedule 5 response confirming site operations and submission of updated odour and dust management plans.
Variation determined EPR/BP3792LD	19/01/17	Varied and consolidated permit issued in modern condition format.

Status log of the permit		
Description	Date	Comments
Billing ref: HP3932WF		
Variation EPR/BP3792LD/V007		Documents not found.
Variation EPR/BP3792LD/V008	25/10/21	Variation application withdrawn by the operator.
Environment Agency Non-hazardous Waste Sector Review Variation number EPR/BP3792LD/V009	17/09/21	Non-hazardous waste Sector Review – documents received in response to the Regulation 61 Notice dated 28/04/2021.
Additional information received in response to the Request for Further Information (RFI) dated 27/01/2022	16/02/22	Document received in response to questions 1 to 10 of the RFI, including the amended BAT assessment document titled 'Transwaste BAT Conclusions Feb. 2022'.
	12/05/22	Email containing the document titled 'EWC code justification May 22'.
	17/05/22	Email containing the document titled 'Transwaste Lagoon Sample Results Exp 17.05.2022'.
	08/08/22	Email and documents titled 'Transwaste surfaces and drainage', 'general site layout including developments', 'Waste Storage Locations', 'Transwaste Schedule 1 Operations final' and 'Transwaste EWC Code Removal'.
	08/09/22	Email and documents titled 'Impermeable Surfaces and Drainage' and 'EWC Codes to be moved from AR7 to AR8'.
Additional Information	23/09/22	Email requesting the removal of waste EWC code 08 04 14 and documents titled 'Biodegradable Kitchen and Canteen Waste 20 01 08', containing details of procedure for managing the biodegradable kitchen and canteen waste.
	11/10/22	Email agreeing to the draft permit, including the removal of waste code 09 01 10 from Table S2.2 and 10 13 14 from Table S2.4.
	14/10/22	Email agreeing to the draft permit, including the removal of waste code 03 03 10 and 10 01 07 from Table S2.4.
Environment Agency Non-hazardous Waste Sector Review Variation number EPR/BP3792LD/V009 Permit determined EPR/BP3792LD PAS Billing Ref. AP3104ML, EAWML 65528).	14/10/22	Varied and consolidated permit issued in modern condition format.

End of introductory note

Notice of variation and consolidation

The Environmental Permitting (England and Wales) Regulations 2016

The Environment Agency in exercise of its powers under regulations 19 and 20 of the Environmental Permitting (England and Wales) Regulations 2016 varies

Permit number

EPR/BP3792LD

Issued to

Transwaste Recycling and Aggregates Limited (“the operator”)

whose registered office is

Melton Waste Park

Gibson Lane

Melton

East Yorkshire

HU14 3HH

company registration number **03863280**

to operate regulated facilities at

Melton Waste Park

Gibson Lane

Melton

East Yorkshire

HU14 3HH

to the extent set out in the schedules.

The notice shall take effect from 14/10/2022.

Name	Date
Peter Maksymiw	14/10/2022

Authorised on behalf of the Environment Agency

Schedule 1

The following conditions and tables have been varied as a result of the Environment Agency Initiated Variation:

- Conditions 2.5.3 – 2.5.8 have been deleted because the operator is not treating WEEE at the site.
- Condition 2.7.1 has been deleted because the pre-operational condition is no longer relevant.
- Condition 3.5.1 (b) has been amended by renumbering the referenced process monitoring table from S3.4 to S3.2.
- Condition 3.5.1 (c) has been amended by renumbering the referenced bioaerosols monitoring table from S3.5 to S3.3.
- Condition 3.5.4 has been amended to refer to Table S3.1 instead of S3.2.
- Condition 4.3.2 has been added because it is relevant to the waste operation activities. The follow-on conditions have been renumbered accordingly.
- Condition 4.3.3 (previously condition 4.3.2) has been amended to refer to conditions 4.3.1 and 4.3.2. The follow-on conditions have been renumbered accordingly.
- Table S1.1 as referenced in Condition 2.1.1 has been amended to clearly define the activities that are undertaken at the site and to apply relevant limits to them. The activity references were changed to match with the modern permit template.
- Table S1.2 as referenced in Conditions 2.3.1 and 2.3.2 has been amended to incorporate operating techniques documents submitted in response to the Regulation 61 Notice and additional information received in response to the RFI.
- Tables S1.3 and S1.4 as referenced in the last variation have been deleted. The follow-on tables have been renumbered.
- Table S1.3 (previously S1.5) as referenced in Condition 2.6.1 has been amended to incorporate following changes:
 - IC1 and IC2 have been amended and with new deadlines for compliance.
 - IC3a (previously IC3) has been updated with a new deadline for compliance.
 - IC3b (previously PO2) has been updated with a new deadline for compliance.
 - IC4 is no longer required because it has been replaced with IC7 and IC8.
 - IC5 and IC6 have been added; these require the operator to carry out a detailed review of the existing buildings and treatment equipment at the site, including the treatment operations that are undertaken outside of the buildings and to implement the identified improvements.
 - IC7 and IC8 have been added; these require the operator to submit a proposal to cover to cover areas where activities AR7, AR9 and AR10 are undertaken with impermeable surfacing and sealed drainage systems and to implement the identified improvements.
 - IC9 has been added; this requires the operator to submit updated EMS.
- Table S1.6 has been deleted because pre-operation condition PO1 is now completed and PO2 has been moved into Table S1.3 as improvement condition IC3b.
- Tables S2.2 – S2.4 and S2.7 as referenced in Condition 2.3.4 have been amended by removing waste types that are not appropriate to the permitted activities.
- Tables S2.2 – S2.7 as referenced in Condition 2.3.4 have been amended by changing the annual throughput of the site from 500,000 tonnes to 750,250 tonnes as agreed in the approved Fire prevention Plan.
- Table S3.1 as referenced in Condition 3.5.1 (a) has been amended by including parameters, BAT AELs and monitoring standards that are relevant for direct emissions of site effluent to surface water.
- Tables S3.2 and S3.3 as referenced in the last variation have been deleted. The follow-on tables have been renumbered.
- Table S4.1 as referenced in condition 4.2.3 has been amended by adding reporting requirements for point source emission, process and bioaerosols monitoring to the table.

- Table S4.4 as referenced in conditions 4.2.2 (c) and 4.2.3 (b) has been amended by adding reporting form for emissions to water and ambient/bioaerosol monitoring.
- Schedule 5 as referenced in condition 4.3.3 has been amended by adding a new paragraph (c) to Part A requiring notification of breach of permit conditions not relating to limits.
- Schedule 6 as referenced in condition 4.4.1 has been amended to add additional interpretations that are relevant to the changes made to the permit.

Schedule 2 – consolidated permit

Consolidated permit issued as a separate document.

Permit

The Environmental Permitting (England and Wales) Regulations 2016

Permit number

EPR/BP3792LD

This is the consolidated permit referred to in the variation and consolidation notice for application EPR/BP3792LD/V009 authorising,

Transwaste Recycling and Aggregates Limited (“the operator”),

whose registered office is

Melton Waste Park

Gibson Lane

Melton

East Yorkshire

HU14 3HH

company registration number 03863280

to operate an installation and waste operations at

Melton Waste Park

Gibson Lane

Melton

East Yorkshire

HU14 3HH

to the extent authorised by and subject to the conditions of this permit.

Name	Date
Peter Maksymiw	14/10/2022

Authorised on behalf of the Environment Agency

Management

1.1 General management

- 1.1.1 The operator shall manage and operate the activities:
- (a) in accordance with a written management system that identifies and minimises risks of pollution, including those arising from operations, maintenance, accidents, incidents, non-conformances, closure and those drawn to the attention of the operator as a result of complaints; and
 - (b) using sufficient competent persons and resources.
- 1.1.2 Records demonstrating compliance with condition 1.1.1 shall be maintained.
- 1.1.3 Any person having duties that are or may be affected by the matters set out in this permit shall have convenient access to a copy of it kept at or near the place where those duties are carried out.
- 1.1.4 The operator shall comply with the requirements of an approved competence scheme.

1.2 Energy efficiency

- 1.2.1 For the following activities referenced in schedule 1, table S1.1 (AR1 to AR6) the operator shall:
- (a) take appropriate measures to ensure that energy is used efficiently in the activities;
 - (b) review and record at least every four years whether there are suitable opportunities to improve the energy efficiency of the activities; and
 - (c) take any further appropriate measures identified by a review.

1.3 Efficient use of raw materials

- 1.3.1 For the following activities referenced in schedule 1, table S1.1 (AR1 to AR6) the operator shall:
- (a) take appropriate measures to ensure that raw materials and water are used efficiently in the activities;
 - (b) maintain records of raw materials and water used in the activities;
 - (c) review and record at least every four years whether there are suitable alternative materials that could reduce environmental impact or opportunities to improve the efficiency of raw material and water use; and
 - (d) take any further appropriate measures identified by a review.

1.4 Avoidance, recovery and disposal of wastes produced by the activities

- 1.4.1 The operator shall take appropriate measures to ensure that:
- (a) the waste hierarchy referred to in Article 4 of the Waste Framework Directive is applied to the generation of waste by the activities; and
 - (b) any waste generated by the activities is treated in accordance with the waste hierarchy referred to in Article 4 of the Waste Framework Directive; and
 - (c) where disposal is necessary, this is undertaken in a manner which minimises its impact on the environment.
- 1.4.2 The operator shall review and record at least every four years whether changes to those measures should be made and take any further appropriate measures identified by a review.

2 Operations

2.1 Permitted activities

- 2.1.1 The operator is only authorised to carry out the activities specified in schedule 1 table S1.1 (the “activities”).
- 2.1.2 Waste authorised by this permit shall be clearly distinguished from any other waste on the site.

2.2 The site

- 2.2.1 The activities shall not extend beyond the site, being the land shown edged in green on the site plan at schedule 7 to this permit.

2.3 Operating techniques

- 2.3.1 The activities shall, subject to the conditions of this permit, be operated using the techniques and in the manner described in the documentation specified in schedule 1, tables S1.2, unless otherwise agreed in writing by the Environment Agency.
- 2.3.2 If notified by the Environment Agency that the activities are giving rise to pollution, the operator shall submit to the Environment Agency for approval within the period specified, a revision of any plan or other documentation (“plan”) specified in schedule 1, tables S1.2 or otherwise required under this permit which identifies and minimises the risks of pollution relevant to that plan, and shall implement the approved revised plan in place of the original from the date of approval, unless otherwise agreed in writing by the Environment Agency.
- 2.3.3 Any raw materials or fuels listed in schedule 2 table S2.1 shall conform to the specifications set out in that table.
- 2.3.4 Waste shall only be accepted if:
 - (a) it is of a type and quantity listed in schedule 2, tables S2.2, S2.3, S2.4, S2.5, S2.6 and S2.7; and
 - (b) it conforms to the description in the documentation supplied by the producer and holder.
- 2.3.5 The operator shall ensure that where waste produced by the activities is sent to a relevant waste operation, that operation is provided with the following information, prior to the receipt of the waste:
 - (a) the nature of the process producing the waste;
 - (b) the composition of the waste;
 - (c) the handling requirements of the waste;
 - (d) the hazardous property associated with the waste, if applicable; and
 - (e) the waste code of the waste.
- 2.3.6 The operator shall ensure that where waste produced by the activities is sent to a landfill site, it meets the waste acceptance criteria for that landfill.

2.4 Hazardous waste storage and treatment

- 2.4.1 Hazardous waste shall not be mixed, either with a different category of hazardous waste or with other waste, substances or materials, unless it is authorised by schedule 1 table S1.1 and appropriate measures are taken.

2.5 WEEE storage and treatment

- 2.5.1 Spillage collection facilities and, where appropriate, decanters and cleanser-degreasers shall be provided and used as necessary.
- 2.5.2 WEEE (disassembled spare parts, components and residues) shall be stored in areas provided with a weatherproof covering where appropriate or in containers providing a weatherproof covering where appropriate.

2.6 Improvement programme

- 2.6.1 The operator shall complete the improvements specified in schedule 1 table S1.3 by the date specified in that table unless otherwise agreed in writing by the Environment Agency.
- 2.6.2 Except in the case of an improvement which consists only of a submission to the Environment Agency, the operator shall notify the Environment Agency within 14 days of completion of each improvement.

3 Emissions and monitoring

3.1 Emissions to water, air or land

- 3.1.1 There shall be no point source emissions to water, air or land except from the sources and emission points listed in schedule 3 table S3.1.
- 3.1.2 The limits given in schedule 3 shall not be exceeded.
- 3.1.3 For the following activities referenced in schedule 1, table S1.1 (AR1 to AR6), periodic monitoring shall be carried out at least once every 5 years for groundwater and 10 years for soil, unless such monitoring is based on a systematic appraisal of the risk of contamination.

3.2 Emissions of substances not controlled by emission limits

- 3.2.1 Emissions of substances not controlled by emission limits (excluding odour) shall not cause pollution. The operator shall not be taken to have breached this condition if appropriate measures, including, but not limited to, those specified in any approved emissions management plan, have been taken to prevent or where that is not practicable, to minimise, those emissions.
- 3.2.2 The operator shall:
 - (a) if notified by the Environment Agency that the activities are giving rise to pollution, submit to the Environment Agency for approval within the period specified, an emissions management plan which identifies and minimises the risks of pollution from emissions of substances not controlled by emission limits;
 - (b) implement the approved emissions management plan, from the date of approval, unless otherwise agreed in writing by the Environment Agency.
- 3.2.3 All liquids in containers, whose emission to water or land could cause pollution, shall be provided with secondary containment, unless the operator has used other appropriate measures to prevent or where that is not practicable, to minimise, leakage and spillage from the primary container.

3.3 Odour

- 3.3.1 Emissions from the activities shall be free from odour at levels likely to cause pollution outside the site, as perceived by an authorised officer of the Environment Agency, unless the operator has used appropriate measures, including, but not limited to, those specified in any approved odour management plan, to prevent or where that is not practicable to minimise the odour.

3.3.2 The operator shall:

- (a) if notified by the Environment Agency that the activities are giving rise to pollution outside the site due to odour, submit to the Environment Agency for approval within the period specified, an odour management plan which identifies and minimises the risks of pollution from odour;
- (b) implement the approved odour management plan, from the date of approval, unless otherwise agreed in writing by the Environment Agency.

3.4 Noise and vibration

3.4.1 Emissions from the activities shall be free from noise and vibration at levels likely to cause pollution outside the site, as perceived by an authorised officer of the Environment Agency, unless the operator has used appropriate measures, including, but not limited to, those specified in any approved noise and vibration management plan to prevent or where that is not practicable to minimise the noise and vibration.

3.4.2 The operator shall:

- (a) if notified by the Environment Agency that the activities are giving rise to pollution outside the site due to noise and vibration, submit to the Environment Agency for approval within the period specified, a noise and vibration management plan which identifies and minimises the risks of pollution from noise and vibration;
- (b) implement the approved noise and vibration management plan, from the date of approval, unless otherwise agreed in writing by the Environment Agency.

3.5 Monitoring

3.5.1 The operator shall, unless otherwise agreed in writing by the Environment Agency, undertake the monitoring specified in the following tables in schedule 3 to this permit:

- (a) point source emissions specified in tables S3.1;
- (b) process monitoring specified in table S3.2;
- (c) bioaerosols monitoring specified in table S3.3.

3.5.2 The operator shall maintain records of all monitoring required by this permit including records of the taking and analysis of samples, instrument measurements (periodic and continual), calibrations, examinations, tests and surveys and any assessment or evaluation made on the basis of such data.

3.5.3 Monitoring equipment, techniques, personnel and organisations employed for the emissions monitoring programme and the environmental or other monitoring specified in condition 3.5.1 shall have either MCERTS certification or MCERTS accreditation (as appropriate), where available, unless otherwise agreed in writing by the Environment Agency.

3.5.4 Permanent means of access shall be provided to enable sampling/monitoring to be carried out in relation to the emission points specified in schedule 3 table S3.1 unless otherwise agreed in writing by the Environment Agency.

3.6 Pests

3.6.1 The activities shall not give rise to the presence of pests which are likely to cause pollution, hazard or annoyance outside the boundary of the site. The operator shall not be taken to have breached this condition if appropriate measures, including, but not limited to, those specified in any approved pests management plan, have been taken to prevent or where that is not practicable, to minimise the presence of pests on the site.

3.6.2 The operator shall:

- (a) if notified by the Environment Agency, submit to the Environment Agency for approval within the period specified, a pests management plan which identifies and minimises risks of pollution from pests;
- (b) implement the pests management plan, from the date of approval, unless otherwise agreed in writing by the Environment Agency.

3.7 Fire prevention

3.7.1 The operator shall take all appropriate measures to prevent fires on site and minimise the risk of pollution from them including, but not limited to, those specified in any approved fire prevention plan.

3.7.2 The operator shall:

- (a) if notified by the Environment Agency that the activities are giving rise to a risk of fire, submit to the Environment Agency for approval within the period specified, a fire prevention plan which prevents fires and minimises the risk of pollution from fires;
- (b) implement the fire prevention plan, from the date of approval, unless otherwise agreed in writing by the Environment Agency.

4 Information

4.1 Records

4.1.1 All records required to be made by this permit shall:

- (a) be legible;
- (b) be made as soon as reasonably practicable;
- (c) if amended, be amended in such a way that the original and any subsequent amendments remain legible, or are capable of retrieval; and
- (d) be retained, unless otherwise agreed in writing by the Environment Agency, for at least 6 years from the date when the records were made, or in the case of the following records until permit surrender:
 - (i) off-site environmental effects; and
 - (ii) matters which affect the condition of the land and groundwater.

4.1.2 The operator shall keep on site all records, plans and the management system required to be maintained by this permit, unless otherwise agreed in writing by the Environment Agency.

4.2 Reporting

4.2.1 The operator shall send all reports and notifications required by the permit to the Environment Agency using the contact details supplied in writing by the Environment Agency.

4.2.2 For the following activities referenced in schedule 1, table S1.1 (AR1 to AR6), a report or reports on the performance of the activities over the previous year shall be submitted to the Environment Agency by 31 January (or other date agreed in writing by the Environment Agency) each year. The report(s) shall include as a minimum:

- (a) a review of the results of the monitoring and assessment carried out in accordance with the permit including an interpretive review of that data;
- (b) the annual production /treatment data set out in schedule 4 table S4.2; and
- (c) the performance parameters set out in schedule 4 table S4.3 using the forms specified in table S4.4 of that schedule.

- 4.2.3 Within 28 days of the end of the reporting period the operator shall, unless otherwise agreed in writing by the Environment Agency, submit reports of the monitoring and assessment carried out in accordance with the conditions of this permit, as follows:
- (a) in respect of the parameters and emission points specified in schedule 4 table S4.1;
 - (b) for the reporting periods specified in schedule 4 table S4.1 and using the forms specified in schedule 4 table S4.4; and
 - (c) giving the information from such results and assessments as may be required by the forms specified in those tables.
- 4.2.4 The operator shall, unless notice under this condition has been served within the preceding four years, submit to the Environment Agency, within six months of receipt of a written notice, a report assessing whether there are other appropriate measures that could be taken to prevent, or where that is not practicable, to minimise pollution.
- 4.2.5 Within 1 month of the end of each quarter, the operator shall submit to the Environment Agency using the form made available for the purpose, the information specified on the form relating to the site and the waste accepted and removed from it during the previous quarter.

4.3 Notifications

- 4.3.1 For the following activities referenced in schedule 1, table S1.1 (AR1 to AR6), in the event:
- (a) that the operation of the activities gives rise to an incident or accident which significantly affects or may significantly affect the environment, the operator must immediately—
 - (i) inform the Environment Agency,
 - (ii) take the measures necessary to limit the environmental consequences of such an incident or accident, and
 - (iii) take the measures necessary to prevent further possible incidents or accidents;
 - (b) of a breach of any permit condition the operator must immediately—
 - (i) inform the Environment Agency, and
 - (ii) take the measures necessary to ensure that compliance is restored within the shortest possible time;
 - (c) of a breach of permit condition which poses an immediate danger to human health or threatens to cause an immediate significant adverse effect on the environment, the operator must immediately suspend the operation of the activities or the relevant part of it until compliance with the permit conditions has been restored.
- 4.3.2 For the following activities referenced in schedule 1, table S1.1, AR7 to AR11, the Environment Agency shall be notified without delay following the detection of:
- (a) any malfunction, breakdown or failure of equipment or techniques, accident, or emission of a substance not controlled by an emission limit which has caused, is causing or may cause significant pollution;
 - (b) the breach of a limit specified in the permit; or
 - (c) any significant adverse environmental effects.
- 4.3.3 Any information provided under conditions 4.3.1 and 4.3.2 shall be confirmed by sending the information listed in schedule 5 to this permit within the time period specified in that schedule.
- 4.3.4 Where the Environment Agency has requested in writing that it shall be notified when the operator is to undertake monitoring and/or spot sampling, the operator shall inform the Environment Agency when the relevant monitoring and/or spot sampling is to take place. The operator shall provide this

information to the Environment Agency at least 14 days before the date the monitoring is to be undertaken.

4.3.5 The Environment Agency shall be notified within 14 days of the occurrence of the following matters, except where such disclosure is prohibited by Stock Exchange rules:

Where the operator is a registered company:

- (a) any change in the operator's trading name, registered name or registered office address; and
- (b) any steps taken with a view to the operator going into administration, entering into a company voluntary arrangement or being wound up.

Where the operator is a corporate body other than a registered company:

- (a) any change in the operator's name or address; and
- (b) any steps taken with a view to the dissolution of the operator.

In any other case:

- (a) the death of any of the named operators (where the operator consists of more than one named individual);
- (b) any change in the operator's name(s) or address(es); and
- (c) any steps taken with a view to the operator, or any one of them, going into bankruptcy, entering into a composition or arrangement with creditors, or, in the case of them being in a partnership, dissolving the partnership.

4.3.6 Where the operator proposes to make a change in the nature or functioning, or an extension of the activities, which may have consequences for the environment and the change is not otherwise the subject of an application for approval under the Regulations or this permit:

- (a) the Environment Agency shall be notified at least 14 days before making the change; and
- (b) the notification shall contain a description of the proposed change in operation.

4.3.7 The Environment Agency shall be given at least 14 days' notice before implementation of any part of the site closure plan.

4.4 Interpretation

4.4.1 In this permit the expressions listed in schedule 6 shall have the meaning given in that schedule.

4.4.2 In this permit references to reports and notifications mean written reports and notifications, except where reference is made to notification being made "immediately", in which case it may be provided by telephone.

Schedule 1 – Operations

Table S1.1 activities			
Activity reference	Activity listed in Schedule 1 of the EP Regulations	Description of specified activity and WFD Annex I and II operations	Limits of specified activity and waste types
AR1	S5.4 A1(b)(ii) Recovery or a mix of recovery and disposal of non-hazardous waste with a capacity exceeding 75 tonnes per day involving pre-treatment of waste for incineration or co-incineration	R3: Recycling/ reclamation of organic substances which are not used as solvents R4: Recycling/ reclamation of metals and metal compounds R5: Recycling/ reclamation of other inorganic substances	Physical treatment of solid non-hazardous waste to produce solid recovered fuel (SRF) and refuse derived fuel (RDF) Treatment operations shall be limited to physical treatment including sorting, separation, screening, baling, shredding, crushing, compaction and blending for the purpose of producing SRF and RDF for recovery. RDF production and treatment activities shall be carried out in an enclosed building with air abatement systems. SRF production shall take place in a covered building. Treatment shall be carried out on an impermeable surface with sealed drainage. Waste types suitable for acceptance are limited to the non-hazardous wastes specified in table S2.2.
Directly Associated Activity			
AR2	N/A	Storage of waste prior to treatment R13: Storage of waste pending any of the operations numbered R1 to R12 (excluding temporary storage, pending collection, on the site where it is produced)	Receipt and storage of non-hazardous waste pending pre-treatment of waste for incineration or co-incineration. Waste storage shall be in an enclosed and/or covered building and on an impermeable surface with sealed drainage system. Subject to any other requirements of this permit, wastes shall be stored for no longer than 1 year prior to disposal and 3 years prior to recovery. Waste types suitable for acceptance are limited to the non-hazardous wastes specified in table S2.2.

Table S1.1 activities			
Activity reference	Activity listed in Schedule 1 of the EP Regulations	Description of specified activity and WFD Annex I and II operations	Limits of specified activity and waste types
AR3	N/A	Bulking of recyclable wastes R3: Recycling/reclamation of organic substances which are not used as solvents R4: Recycling/reclamation of metals and metal compounds R5: Recycling/reclamation of other inorganic substances	Bulking of recyclable wastes recovered as an incidental part of the production of SRF and RDF. All bulking activities shall be carried out within an enclosed and/or covered building and on an impermeable surface with sealed drainage system.
AR4	N/A	Storage of SRF and RDF, pending removal from the site, including recyclables and residual waste resulting from SRF and RDF production activity R13: Storage of waste pending any of the operations numbered R1 to R12 (excluding temporary storage, pending collection, on the site where it is produced)	Wrapped and baled SRF and RDF, inert waste, uncontaminated ferrous and non-ferrous metal wastes, uncontaminated wood and residual wastes shall be stored on an impermeable surface with a sealed drainage system or on hardstanding pending removal from the site. Subject to any other requirements of this permit, wastes shall be stored for no longer than 1 year prior to disposal and 3 years prior to recovery.
AR5	N/A	Raw materials storage - storage of raw materials, including lubrication oil and diesel	From the receipt of raw materials to despatch for use within the facility.
AR6	N/A	Surface water collection, storage, treatment and discharge. Collection storage, and treatment of uncontaminated roof and contaminated site surface water in the settlement pond prior to discharge to surface water.	From the collection of uncontaminated roof water and contaminated site surface water from external site areas to discharge offsite into controlled waters. Treatment of the contaminated surface water within the lagoon is limited to aeration/physical agitation of the water only. Uncontaminated roof water and contaminated site surface water shall not be mixed prior to discharge.
Activity reference	Description of activities for waste operations		Limits of activities
AR7	R3: Recycling/reclamation of organic substances which are not used as solvents.		Treatment consisting of sorting, separation, screening, crushing and

Table S1.1 activities			
Activity reference	Activity listed in Schedule 1 of the EP Regulations	Description of specified activity and WFD Annex I and II operations	Limits of specified activity and waste types
Inert crushing and screening	R5: Recycling/reclamation of other inorganic materials. R13: Storage of waste pending any of the operations numbered R1 to R12 (excluding temporary storage, pending collection, on the site where it is produced).		blending inert wastes for recovery as a soil or aggregate. Inert wastes shall be stored and treated on an impermeable surface with sealed drainage or on a hardstanding. Storage and treatment of waste may be undertaken on an impermeable surface or on a hardstanding pending the completion of the Improvement Conditions IC7 and IC8 of Table S1.5. Subject to any other requirements of this permit, wastes shall be stored for no longer than 1 year prior to disposal and 3 years prior to recovery. Waste types suitable for acceptance are limited to those wastes specified in table S2.3.
AR8 Materials recycling facility and transfer station	R3: Recycling/reclamation of organic substances which are not used as solvents. R4: Recycling/reclamation of metals and metal compounds R5: Recycling/reclamation of other inorganic materials. R13: Storage of waste pending any of the operations numbered R1 to R12 (excluding temporary storage, pending collection, on the site where it is produced). D9: Physico-chemical treatment not specified elsewhere in Annex IIA which results in final compounds or mixtures which are discarded by means of any of the operations numbered D1 to D12. D14: Repackaging prior to submission to any of the operations numbered D1 to D13. D15: Storage pending any of the operations numbered D1 to D14 (excluding temporary storage, pending collection, on the site where it is produced).		Treatment consisting of manual and physical sorting, baling, separation, screening, shredding, crushing, compacting or mixing of waste into different components for disposal (no more than 50 tonnes per day), or recovery. Storage and treatment of waste shall be carried out within an enclosed building and on an impermeable surface and sealed drainage system. Waste tyres may be stored outside on an impermeable surface with sealed drainage. No more than 50 tonnes of intact and shredded waste vehicle tyres (waste codes 16 01 03 and 19 12 04) shall be stored on site at any one time. Treatment of ash and slags (in aggregate at the site) shall not exceed 75 tonnes per day for recovery. Biodegradable waste received under this activity shall be stored no longer than 7 days prior to dispatch off-site. The treatment of waste shall not result in: <ul style="list-style-type: none"> ▪ deliberate dilution of hazardous substances ▪ dilution of Persistent Organic Pollutants (POPs). Subject to any other requirements of this permit, wastes shall be stored for no longer than 1 year prior to disposal and 3 years prior to recovery. Waste types suitable for acceptance are limited to those specified in table S2.4.

Table S1.1 activities			
Activity reference	Activity listed in Schedule 1 of the EP Regulations	Description of specified activity and WFD Annex I and II operations	Limits of specified activity and waste types
AR9 Green waste pre-treatment and storage	R3: Recycling/reclamation of organic substances which are not used as solvents. R13: Storage of waste pending any of the operations numbered R1 to R12 (excluding temporary storage, pending collection, on the site where it is produced).		Physical treatment of source segregated green wastes consisting of shredding and blending only. Wastes shall not be composted prior to dispatch offsite. Shredded biodegradable green waste received under this activity shall be stored for no longer than 7 days prior to dispatch off-site. Storage and treatment of waste may be undertaken on an impermeable surface or on a hardstanding pending the completion of the Improvement Conditions IC7 and IC8 of Table S1.5. Waste types suitable for acceptance are limited to those specified in table S2.5.
AR10 Waste wood shredding and chipping	R3: Recycling/reclamation of organic substances which are not used as solvents. R13: Storage of waste pending any of the operations numbered R1 to R12 (excluding temporary storage, pending collection, on the site where it is produced).		Physical treatment of uncontaminated wood wastes consisting of chipping, shredding and blending only. Storage and treatment of waste may be undertaken on an impermeable surface or on a hardstanding pending the completion of the Improvement Conditions IC7 and IC8 of Table S1.5. Waste wood must not be stored for more than 3 months. Waste types suitable for acceptance are limited to those specified in table S2.6.
AR11 Hazardous and non-hazardous wastes storage and transfer station – bulking up and storage only	R4: Recycling/reclamation of metals and metal compounds R5: Recycling/reclamation of other inorganic materials. R13: Storage of waste pending any of the operations numbered R1 to R12 (excluding temporary storage, pending collection, on the site where it is produced). D14: Repackaging prior to submission to any of the operations numbered D1 to D13. D15: Storage pending any of the operations numbered D1 to D14 (excluding temporary storage, pending collection, on the site where it is produced).		Treatment limited to repackaging of waste only. Hazardous waste shall be stored and treated in a building or within a sealed container and on an impermeable surface with a sealed drainage system. Except for WEEE awaiting manual sorting, manual dismantling, repair or refurbishment only, the maximum quantity of hazardous waste (in aggregate) that can be stored at the site shall not exceed 50 tonnes at any one time. Hazardous wastes shall be stored for no longer than 6 months. Treatment of hazardous waste (in aggregate) shall not exceed 10 tonnes per day. Subject to any other requirements of this permit, wastes shall be stored for no longer than 1 year prior to disposal and 3 years prior to recovery.

Table S1.1 activities			
Activity reference	Activity listed in Schedule 1 of the EP Regulations	Description of specified activity and WFD Annex I and II operations	Limits of specified activity and waste types
			<p>Waste types suitable for acceptance are limited to those specified in table S2.7.</p> <p><u>For asbestos</u></p> <p>Asbestos waste must be double bagged and kept within clearly identified, segregated, sealed, secure, lockable bulk containers (for example skips).</p> <p>Asbestos waste shall not be transferred between different bulk containers. Bulk containers shall be locked when not being loaded and shall not be stacked.</p> <p>Asbestos must not be stored loose or in bays.</p> <p><u>For WEEE waste</u></p> <p>Other than WEEE awaiting manual sorting, manual dismantling, repair or refurbishment only, there shall be no treatment of WEEE.</p> <p>Buildings, covered areas or containers shall meet the following requirements:</p> <ul style="list-style-type: none"> • buildings, covered areas, or containers shall be designed, constructed and maintained to prevent ingress of rain and surface water; • rain and uncontaminated surface water shall be kept separate from contaminated water and other liquids; • containers containing waste (excluding uncontaminated metal waste) shall be stored on an impermeable surface with sealed drainage system. <p><u>WEEE</u></p> <p>(a) shall be clearly identified and segregated.</p> <p>(b) shall be stored on an impermeable surface with a sealed drainage system.</p> <p>(c) items that may be reused as whole appliances, or that may have components recovered from them for reuse, must be stored under weatherproof covering to prevent the ingress of water.</p> <p>(d) small mixed WEEE shall not be compacted or compressed during</p>

Table S1.1 activities			
Activity reference	Activity listed in Schedule 1 of the EP Regulations	Description of specified activity and WFD Annex I and II operations	Limits of specified activity and waste types
			<p>storage and preparation for transport.</p> <p>(e) lamps shall be stored in lidded, rigid, leakproof and weatherproof containers. The containers must be designed and constructed so they do not distort or flex when being moved. Container lids must close fully without exerting pressure on the contents.</p> <p>(f) lamps shall be packed to minimise movement and the risk of breakage. Linear fluorescent tubes must be stored separately from other format bulbs.</p> <p>(g) Flat Panel Display equipment must be stored:</p> <ul style="list-style-type: none"> ▪ under weatherproof covering; and ▪ in a way to minimise movement and prevent breakage such as in cages or stillages. <p>(h) Cathode ray tube equipment must be stored in such a way to minimise movement and prevent breakage.</p> <p>(i) Any other WEEE containing hazardous material or fluids shall be stored under weatherproof covering where this is necessary to prevent pollution of water.</p> <p><u>For batteries</u></p> <p>Batteries shall:</p> <p>(a) be clearly identified and segregated from other wastes;</p> <p>(b) be stored in secure containers that are leak-proof;</p> <p>Lead acid batteries shall be stored in containers with an impermeable, acid resistant base.</p>

Table S1.2 Operating techniques		
Description	Parts	Date Received
Application EPR/BP3792LD/V003	Part C4, Section 3 and Appendix 2 of the application form.	04/05/11
Additional information	Summary of treatment activities (T007)	05/08/11
Additional information	Email from applicant addressing information request questions including but not limited to; site infrastructure, waste codes and annual throughputs.	05/08/11
Additional information	Email from applicant outlining discharge operation	05/09/11
Management plans	Updated dust management plan, ' <i>Dust/Litter Emission Management Plan</i> '. Reference Rev 5 03/09/20136.	18/09/13
Management plans	Updated odour management plan, ' <i>Odour Management Plan</i> '. Reference Rev 8 10/06/2014.	12/06/14
Application EPR/BP3792LD/V006	Supporting documentation as referenced within the application.	29/09/14
Response to Schedule 5 Notice dated 01/05/2015	Amended application documents, Part C2 and Part C3. Responses to Part C2 and Part C3 of the application form and referenced supporting documents.	04/09/15
Response to Schedule 5 Notice dated 27/09/2016	Responses clarifying the relevant listed installation activities and remaining waste operations.	21/10/16
Additional information requested 25/10/2016	Email response including an updated site layout plan, mass balance form for different operations and clarification of tonnages and waste codes.	02/11/16, 03/11/16 and 04/11/16
Regulation 61 Notice Response EPR/BP3792LD/V009	Documents received in response to the Regulation 61 Notice - Transwaste Recycling and Aggregates Ltd.: Non-Technical Summary.	17/09/21
Additional information received in response to the Request for Further Information (RFI) dated 27/01/2022	Document received in response to questions 1 to 3 and 5 to 10 of the RFI, including the amended BAT assessment document titled ' <i>Transwaste BAT Conclusions Feb. 2022</i> '.	16/02/22
	Document titled ' <i>EWC code justification May 22</i> '.	12/05/22
	Email and documents titled ' <i>Transwaste surfaces and drainage</i> ', ' <i>general site layout including developments</i> ', ' <i>Waste Storage Locations</i> ', ' <i>Transwaste Schedule 1 Operations final</i> ' and ' <i>Transwaste EWC Code Removal</i> '.	08/08/22
	Email and documents titled ' <i>Impermeable Surfaces and Drainage</i> ' and ' <i>EWC Codes to be moved from AR7 to AR8</i> '.	08/09/22
Additional information	Email requesting the removal of waste EWC code 08 04 14, and documents titled ' <i>Biodegradable Kitchen and Canteen Waste 20 01 08</i> ', containing details of procedure for managing the biodegradable kitchen and canteen waste.	23/09/22
	Email agreeing to the removal of waste code 09 01 10 from Table S2.2 and 10 13 14 from Table S2.4.	11/10/22
	Email agreeing to the removal of waste code 03 03 10 and 10 01 07 from Table S2.4.	14/10/22

Table S1.3 Improvement programme requirements		
Reference	Requirement	Date
IC1	<p>The operator shall submit an updated Odour Management Plan (OMP) to the Environment Agency for written approval.</p> <p>The revised OMP shall include:</p> <ul style="list-style-type: none"> • An assessment of the increased risk of odour pollution as a result of the increase in permitted waste quantities by 250,000 tonnes per year. • An assessment of the existing odour abatement system in Shed 4. The assessment must demonstrate with evidence that the abatement system can remain effective with the increase in throughput. <p>The plan shall take into account the appropriate measures for odour control specified in the <u>Non-hazardous and inert waste: appropriate measures for permitted facilities</u> guidance and <u>H4 - Odour Management</u>.</p> <p>Once the OMP is approved by the Environment Agency, the operator shall carry out site operations in accordance with the approved Odour Management Plan.</p>	31/03/23
IC2	<p>The operator shall submit a revised Dust Management Plan (DMP) to the Environment Agency for approval.</p> <p>The revised plan shall include:</p> <ul style="list-style-type: none"> • An assessment of the increased risk of dust pollution as a result of the increase in permitted waste quantities by 250,000 tonnes per year. <p>The plan shall take into account the appropriate measures for odour control specified in the <u>Non-hazardous and inert waste: appropriate measures for permitted facilities</u> guidance and <u>Control and monitor emissions for your environmental permit</u>.</p> <p>Once the DMP is approved by the Environment Agency, the operator shall carry out site operations in accordance with the approved DMP.</p>	31/03/23
IC3a	<p>Conduct a monitoring assessment of current levels of bioaerosols generated from activity AR9 'Green waste pre-treatment and storage'. The assessment must be undertaken in line with the guidance, 'A standardised protocol for the monitoring of bioaerosols at open composting facilities'. A report must be submitted to the Environment Agency outlining the monitoring results. The report shall demonstrate that monitored bioaerosols do not exceed the standard limits set out in the Environment Agency's guidance, 'How to comply with your environmental permit. Additional technical guidance for: composting and aerobic treatment sector'.</p>	31/03/23
IC3b	<p>Upon completion of IC3, the operator shall submit a site specific bioaerosol risk assessment (SSBRA) (in relation to activity AR9 'Green waste pre-treatment and storage') to the Environment Agency for approval. The SSBRA shall be completed in line with Cranfield University's 'Guidance on the evaluation of bioaerosol risk assessments for composting facilities'. Prior to accepting an increase in green waste for pre-treatment, the SSBRA must be approved by the Environment Agency.</p>	31/06/23
IC4	<p>The operator shall submit to the Environment Agency for approval, a plan detailing how the green waste pre-treatment and storage area (AR9) and waste wood shredding and chipping area (AR10) will be provided with an impermeable surface with a sealed drainage system. The plan shall compare the proposed impermeable surface and sealed drainage system against the requirements of Section 2.2.5 of the Sector Guidance Note IPPC S5.06 – Guidance for the Recovery and Disposal of Hazardous and Non-Hazardous Waste and any relevant British Construction Standard.</p>	Superseded and replaced with IC7 and IC8

Table S1.3 Improvement programme requirements		
Reference	Requirement	Date
	The plan shall identify any measures necessary to meet the requirements stated in the above guidance and standard, a timescale for implementation and a maintenance and inspection regime during site operations to ensure it is fit for purpose. The plan shall be implemented in accordance with written approval from the Environment Agency.	
IC5	<p>The operator shall carry out a detailed review of the existing buildings and treatment equipment at the site, including the treatment operations that are undertaken outside of the buildings to ensure that they are in accordance with the requirements specified in the <u>Non-hazardous and inert waste: appropriate measures for permitted facilities</u> guidance and BAT 14 of the <u>Waste Treatment BAT Conclusions</u>.</p> <p>Following the review, the operator shall submit a written report to the Environment Agency for approval outlining the results of the review and measures and procedures that are in place in the buildings and outside of the buildings to prevent and/or reduce fugitive emissions of dust, odour and noise. The report shall include recommendations for improvements and timescales for implementation of the identified improvements.</p>	31/03/23
IC6	Following the completion of IC5, the operator shall implement any improvements by the deadline specified in this improvement condition unless otherwise agreed in writing with the Environment Agency. The improvements may include, but are not limited to, the installation of new infrastructure to prevent and/or reduce fugitive emissions of dust, odour and noise from the installation and waste operation activities.	30/09/23
IC7	The operator shall submit to the Environment Agency for approval, a proposal to cover areas where activities AR7, AR9 and AR10 are undertaken with impermeable surfacing, sealed drainage and containment systems together with timescales for implementation of the identified improvements. The design and layout of the drainage and containment infrastructure shall be in accordance with <u>Non-hazardous and inert waste: appropriate measures for permitted facilities</u> guidance and CIRIA Report C736 and shall be certified by a suitably qualified engineer.	31/03/23
IC8	Following the completion IC7, the operator shall implement any improvements by the deadline specified in this improvement condition unless otherwise agreed in writing with the Environment Agency. The improvements may include, but are not limited to, the installation of new drainage and containment infrastructure.	30/09/23
IC9	<p>The Operator shall update the site's existing Environment Management System (EMS) and send a copy to the Environment Agency.</p> <p>The Operator shall make available for inspection all documents and procedures which form part of the EMS. The EMS shall be developed in line with the requirements set out in Environment Agency web guide on developing a management system for environmental permits <u>developing a management system for environmental permits</u> and Section 2 of the <u>Non-hazardous and inert waste: appropriate measures for permitted facilities</u> guidance. The documents and procedures set out in the EMS shall form the written management system referenced in condition 1.1.1 (a) of the permit.</p>	31/03/23

Schedule 2 – Waste types, raw materials and fuels

Raw materials and fuel description	Specification
-	-

Table S2.2 Permitted waste types and quantities under Activities AR1 – AR2 of Table S1.1 – storage and treatment of waste to produce SRF and RDF (pre-treatment of waste for incineration or co-incineration).

Maximum quantities	The total aggregated quantity of hazardous and non-hazardous waste accepted at the site shall not exceed 750,250 tonnes per year. The total quantity of waste accepted at the site for activities AR1 and AR2 shall not exceed 200,000 tonnes per year.
Waste code	Description
02	Wastes from agriculture, horticulture, aquaculture, forestry, hunting and fishing, food preparation and processing
02 01	wastes from agriculture, horticulture, aquaculture, forestry, hunting and fishing
02 01 04	waste plastics (except packaging)
07	Wastes from organic chemical processes
07 02	wastes from the MFSU of plastics, synthetic rubber and man-made fibres
07 02 13	waste plastic
09	Wastes from the photographic industry
09 01	wastes from the photographic industry
09 01 07	photographic film and paper containing silver or silver compounds
09 01 08	photographic film and paper free of silver or silver compounds
12	Wastes from shaping and physical and mechanical surface treatment of metals and plastics
12 01	wastes from shaping and physical and mechanical surface treatment of metals and plastics
12 01 05	plastics shavings and turnings
15	Waste packaging, absorbents, wiping cloths, filter materials and protective clothing not otherwise specified
15 01	packaging (including separately collected municipal packaging waste)
15 01 02	plastic packaging
15 01 05	composite packaging
15 01 06	mixed packaging
15 01 09	textile packaging
17	Construction and demolition wastes (including excavated soil from contaminated sites)
17 02	wood, glass and plastic
17 02 03	plastic

Table S2.2 Permitted waste types and quantities under Activities AR1 – AR2 of Table S1.1 – storage and treatment of waste to produce SRF and RDF (pre-treatment of waste for incineration or co-incineration).

Maximum quantities	The total aggregated quantity of hazardous and non-hazardous waste accepted at the site shall not exceed 750,250 tonnes per year. The total quantity of waste accepted at the site for activities AR1 and AR2 shall not exceed 200,000 tonnes per year.
Waste code	Description
19	Wastes from waste management facilities, off-site waste water treatment plants and the preparation of water intended for human consumption and water for industrial use
19 02	wastes from physico/chemical treatments of waste (including dechromatation, decyanidation, neutralisation)
19 02 10	combustible wastes other than those mentioned in 19 02 08 and 19 02 09
19 12	wastes from the mechanical treatment of waste (for example sorting, crushing, compacting, pelletising) not otherwise specified
19 12 04	plastic and rubber
19 12 08	textiles
19 12 10	combustible waste (refuse derived fuel)
19 12 12	other wastes (including mixtures of materials) from mechanical treatment of wastes other than those mentioned in 19 12 11 (combustible waste only)
20	Municipal wastes (household waste and similar commercial, industrial and institutional wastes) including separately collected fractions
20 01	separately collected fractions (except 15 01)
20 01 10	clothes
20 01 11	textiles
20 01 39	plastics
20 03	other municipal wastes
20 03 01	mixed municipal waste
20 03 02	waste from markets

Table S2.3 Permitted waste types and quantities under Activity AR7 of Table S1.1 – storage and treatment of inert waste to produce aggregates.

Maximum quantity	The total aggregated quantity of hazardous and non-hazardous waste accepted at the site shall not exceed 750,250 tonnes per year. The total quantity of waste accepted at the site for activity AR7 shall not exceed 331,600 tonnes per year.
Exclusions	Wastes shall not be accepted at the site which have any of the following characteristics: <ul style="list-style-type: none"> ▪ Wastes consisting solely or mainly of silica, dusts and powders. ▪ Wastes that are in a form which is either sludge or liquid.
Waste code	Description
01	Wastes resulting from exploration, mining, quarrying, and physical and chemical treatment of minerals
01 01	wastes from mineral excavation
01 01 01	wastes from mineral metalliferous excavation

Table S2.3 Permitted waste types and quantities under Activity AR7 of Table S1.1 – storage and treatment of inert waste to produce aggregates.	
Maximum quantity	The total aggregated quantity of hazardous and non-hazardous waste accepted at the site shall not exceed 750,250 tonnes per year. The total quantity of waste accepted at the site for activity AR7 shall not exceed 331,600 tonnes per year.
Exclusions	Wastes shall not be accepted at the site which have any of the following characteristics: <ul style="list-style-type: none"> ▪ Wastes consisting solely or mainly of silica, dusts and powders. ▪ Wastes that are in a form which is either sludge or liquid.
Waste code	Description
01 01 02	wastes from mineral non-metalliferous excavation
01 03	wastes from physical and chemical processing of metalliferous minerals
01 03 06	tailings other than those mentioned in 01 03 04 and 01 03 05
01 03 09	red mud from alumina production other than the wastes mentioned in 01 03 10
01 04	wastes from physical and chemical processing of non-metalliferous minerals
01 04 08	waste gravel and crushed rocks other than those mentioned in 01 04 07
01 04 09	waste sand and clays
01 04 11	wastes from potash and rock salt processing other than those mentioned in 01 04 07
02	Wastes from agriculture, horticulture, aquaculture, forestry, hunting and fishing, food preparation and processing
02 04	wastes from sugar processing
02 04 01	soil from cleaning and washing beet
02 04 02	off-specification calcium carbonate
02 07	wastes from the production of alcoholic and non-alcoholic beverages (except coffee, tea and cocoa)
02 07 01	wastes from washing, cleaning and mechanical reduction of raw materials
10	Wastes from thermal processes
10 01	wastes from power stations and other combustion plants (except 19)
10 01 24	sands from fluidised beds
10 10	wastes from casting of non-ferrous pieces
10 10 06	casting cores and moulds which have not undergone pouring, other than those mentioned in 10 10 05
10 10 08	casting cores and moulds which have undergone pouring, other than those mentioned in 10 10 07
10 10 16	waste crack-indicating agent other than those mentioned in 10 10 15
10 11	wastes from manufacture of glass and glass products
10 11 03	waste glass-based fibrous materials
10 11 10	waste preparation mixture before thermal processing, other than those mentioned in 10 11 09
10 11 12	waste glass other than those mentioned in 10 11 11
10 12	wastes from manufacture of ceramic goods, bricks, tiles and construction products
10 12 08	waste ceramics, bricks, tiles and construction products (after thermal processing)

Table S2.3 Permitted waste types and quantities under Activity AR7 of Table S1.1 – storage and treatment of inert waste to produce aggregates.	
Maximum quantity	The total aggregated quantity of hazardous and non-hazardous waste accepted at the site shall not exceed 750,250 tonnes per year. The total quantity of waste accepted at the site for activity AR7 shall not exceed 331,600 tonnes per year.
Exclusions	Wastes shall not be accepted at the site which have any of the following characteristics: <ul style="list-style-type: none"> ▪ Wastes consisting solely or mainly of silica, dusts and powders. ▪ Wastes that are in a form which is either sludge or liquid.
Waste code	Description
10 12 10	solid wastes from gas treatment other than those mentioned in 10 12 09
10 13	wastes from manufacture of cement, lime and plaster and articles and products made from them
10 13 01	waste preparation mixture before thermal processing
10 13 04	wastes from calcination and hydration of lime
17	Construction and demolition wastes (including excavated soil from contaminated sites)
17 01	concrete, bricks, tiles and ceramics
17 01 01	concrete
17 01 02	bricks
17 01 03	tiles and ceramics
17 01 07	mixtures of concrete, bricks, tiles and ceramics other than those mentioned in 17 01 06
17 05	soil (including excavated soil from contaminated sites), stones and dredging spoil
17 05 04	soil and stones other than those mentioned in 17 05 03
17 05 08	track ballast other than those mentioned in 17 05 07
17 09	other construction and demolition wastes
17 09 04	mixed construction and demolition wastes other than those mentioned in 17 09 01, 17 09 02 and 17 09 03
19	Wastes from waste management facilities, off-site waste water treatment plants and the preparation of water intended for human consumption and water for industrial use
19 01	wastes from incineration or pyrolysis of waste
19 01 19	sands from fluidised beds
19 04	vitrified waste and wastes from vitrification
19 04 01	vitrified waste
19 12	wastes from the mechanical treatment of waste (for example sorting, crushing, compacting, pelletising) not otherwise specified
19 12 09	minerals (for example sand, stones)
20	Municipal wastes (household waste and similar commercial, industrial and institutional wastes) including separately collected fractions
20 02	garden and park wastes (including cemetery waste)
20 02 02	soil and stones

Table S2.4 Permitted waste types and quantities under Activity AR8 of Table S1.1 - material recycling facility and transfer station.	
Maximum quantities	The total aggregated quantity of hazardous and non-hazardous waste accepted at the site shall not exceed 750,250 tonnes per year. The total quantity of waste accepted at the site for activities AR8 shall not exceed 75,000 tonnes per year.
Exclusions	Wastes shall not be accepted at the site which have any of the following characteristics: <ul style="list-style-type: none"> ▪ Wastes consisting solely or mainly of silica dusts and powders. ▪ Wastes that are in a form which is either sludge or liquid.
Waste code	Description
01	Wastes resulting from exploration, mining, quarrying, and physical and chemical treatment of minerals
01 01	wastes from mineral excavation
01 01 01	wastes from mineral metalliferous excavation
01 01 02	wastes from mineral non-metalliferous excavation
01 03	wastes from physical and chemical processing of metalliferous minerals
01 03 06	tailings other than those mentioned in 01 03 04 and 01 03 05
01 03 09	red mud from alumina production other than the wastes mentioned in 01 03 10
01 04	wastes from physical and chemical processing of non-metalliferous minerals
01 04 08	waste gravel and crushed rocks other than those mentioned in 01 04 07
01 04 09	waste sand and clays
01 04 11	wastes from potash and rock salt processing other than those mentioned in 01 04 07
01 04 12	tailings and other wastes from washing and cleaning of minerals other than those mentioned in 01 04 07 and 01 04 11
01 04 13	wastes from stone cutting and sawing other than those mentioned in 01 04 07
02	Wastes from agriculture, horticulture, aquaculture, forestry, hunting and fishing, food preparation and processing
02 01	wastes from agriculture, horticulture, aquaculture, forestry, hunting and fishing
02 01 03	plant-tissue waste
02 01 04	waste plastics (except packaging)
02 01 07	wastes from forestry
02 01 10	waste metal
02 02	wastes from the preparation and processing of meat, fish and other foods of animal origin
02 02 03	materials unsuitable for consumption or processing
02 03	wastes from fruit, vegetables, cereals, edible oils, cocoa, coffee, tea and tobacco preparation and processing; conserve production; yeast and yeast extract production, molasses preparation and fermentation
02 03 02	wastes from preserving agents
02 03 04	materials unsuitable for consumption or processing
02 04	wastes from sugar processing

Table S2.4 Permitted waste types and quantities under Activity AR8 of Table S1.1 - material recycling facility and transfer station.	
Maximum quantities	The total aggregated quantity of hazardous and non-hazardous waste accepted at the site shall not exceed 750,250 tonnes per year. The total quantity of waste accepted at the site for activities AR8 shall not exceed 75,000 tonnes per year.
Exclusions	Wastes shall not be accepted at the site which have any of the following characteristics: <ul style="list-style-type: none"> ▪ Wastes consisting solely or mainly of silica dusts and powders. ▪ Wastes that are in a form which is either sludge or liquid.
Waste code	Description
02 04 01	soil from cleaning and washing beet
02 04 02	off-specification calcium carbonate
02 05	wastes from the dairy products industry
02 05 01	materials unsuitable for consumption or processing
02 06	wastes from the baking and confectionery industry
02 06 01	materials unsuitable for consumption or processing
02 06 02	wastes from preserving agents
02 07	wastes from the production of alcoholic and non-alcoholic beverages (except coffee, tea and cocoa)
02 07 01	wastes from washing, cleaning and mechanical reduction of raw materials
02 07 02	wastes from spirits distillation
02 07 04	materials unsuitable for consumption or processing
03	Wastes from wood processing and the production of panels and furniture, pulp, paper and cardboard
03 01	wastes from wood processing and the production of panels and furniture
03 01 01	waste bark and cork
03 01 05	sawdust, shavings, cuttings, wood, particle board and veneer other than those mentioned in 03 01 04
03 03	wastes from pulp, paper and cardboard production and processing
03 03 01	waste bark and wood
03 03 07	mechanically separated rejects from pulping of waste paper and cardboard
03 03 08	wastes from sorting of paper and cardboard destined for recycling
04	Wastes from the leather, fur and textile industries
04 01	wastes from the leather and fur industry
04 01 08	waste tanned leather (blue sheetings, shavings, cuttings, buffing dust) containing chromium
04 01 09	wastes from dressing and finishing
04 02	wastes from the textile industry
04 02 21	wastes from unprocessed textile fibres
04 02 22	wastes from processed textile fibres
06	Wastes from inorganic chemical processes
06 09	wastes from the MSFU of phosphorous chemicals and phosphorous chemical processes

Table S2.4 Permitted waste types and quantities under Activity AR8 of Table S1.1 - material recycling facility and transfer station.	
Maximum quantities	The total aggregated quantity of hazardous and non-hazardous waste accepted at the site shall not exceed 750,250 tonnes per year. The total quantity of waste accepted at the site for activities AR8 shall not exceed 75,000 tonnes per year.
Exclusions	Wastes shall not be accepted at the site which have any of the following characteristics: <ul style="list-style-type: none"> ▪ Wastes consisting solely or mainly of silica dusts and powders. ▪ Wastes that are in a form which is either sludge or liquid.
Waste code	Description
06 09 02	phosphorous slag
06 09 04	calcium-based reaction wastes other than those mentioned in 06 09 03
06 11	wastes from the manufacture of inorganic pigments and opacifiers
06 11 01	calcium-based reaction wastes from titanium dioxide production
07	Wastes from organic chemical processes
07 02	wastes from the MFSU of plastics, synthetic rubber and man-made fibres
07 02 13	waste plastic
08	Wastes from the manufacture, formulation, supply and use (MFSU) of coatings (paints, varnishes and vitreous enamels), adhesives, sealants and printing inks
08 01	wastes from MFSU and removal of paint and varnish
08 01 12	waste paint and varnish other than those mentioned in 08 01 11
08 03	wastes from MFSU of printing inks
08 03 18	waste printing toner other than those mentioned in 08 03 17
08 04	wastes from MFSU of adhesives and sealants (including water proofing products)
08 04 10	waste adhesives and sealants other than those mentioned in 08 04 09
09	Wastes from the photographic industry
09 01	wastes from the photographic industry
09 01 07	photographic film and paper containing silver or silver compounds
09 01 08	photographic film and paper free of silver or silver compounds
09 01 10	single-use cameras without batteries
10	Wastes from thermal processes
10 01	wastes from power stations and other combustion plants (except 19)
10 01 01	bottom ash, slag and boiler dust (excluding boiler dust mentioned in 10 01 04)
10 01 05	calcium-based reaction wastes from flue-gas desulphurisation in solid form
10 01 15	bottom ash, slag and boiler dust from co-incineration other than those mentioned in 10 01 14
10 01 19	wastes from gas cleaning other than those mentioned in 10 01 05, 10 01 07 and 10 01 18
10 01 24	sands from fluidised beds
10 01 26	wastes from cooling-water treatment
10 02	wastes from the iron and steel industry

Table S2.4 Permitted waste types and quantities under Activity AR8 of Table S1.1 - material recycling facility and transfer station.	
Maximum quantities	The total aggregated quantity of hazardous and non-hazardous waste accepted at the site shall not exceed 750,250 tonnes per year. The total quantity of waste accepted at the site for activities AR8 shall not exceed 75,000 tonnes per year.
Exclusions	Wastes shall not be accepted at the site which have any of the following characteristics: <ul style="list-style-type: none"> ▪ Wastes consisting solely or mainly of silica dusts and powders. ▪ Wastes that are in a form which is either sludge or liquid.
Waste code	Description
10 02 01	wastes from the processing of slag
10 02 02	unprocessed slag
10 02 08	solid wastes from gas treatment other than those mentioned in 10 02 07
10 02 10	mill scales
10 02 12	wastes from cooling-water treatment other than those mentioned in 10 02 11
10 03	wastes from aluminium thermal metallurgy
10 03 02	anode scraps
10 03 05	waste alumina
10 03 16	skimmings other than those mentioned in 10 03 15
10 03 18	carbon-containing wastes from anode manufacture other than those mentioned in 10 03 17
10 03 24	solid wastes from gas treatment other than those mentioned in 10 03 23
10 03 28	wastes from cooling-water treatment other than those mentioned in 10 03 27
10 03 30	wastes from treatment of salt slags and black drosses other than those mentioned in 10 03 29
10 04	wastes from lead thermal metallurgy
10 04 10	wastes from cooling-water treatment other than those mentioned in 10 04 09
10 05	wastes from zinc thermal metallurgy
10 05 01	slags from primary and secondary production
10 05 09	wastes from cooling-water treatment other than those mentioned in 10 05 08
10 05 11	dross and skimmings other than those mentioned in 10 05 10
10 06	wastes from copper thermal metallurgy
10 06 01	slags from primary and secondary production
10 06 02	dross and skimmings from primary and secondary production
10 06 10	wastes from cooling-water treatment other than those mentioned in 10 06 09
10 07	wastes from silver, gold and platinum thermal metallurgy
10 07 01	slags from primary and secondary production
10 07 02	dross and skimmings from primary and secondary production
10 07 03	solid wastes from gas treatment
10 07 08	wastes from cooling-water treatment other than those mentioned in 10 07 07
10 08	wastes from other non-ferrous thermal metallurgy
10 08 09	other slags

Table S2.4 Permitted waste types and quantities under Activity AR8 of Table S1.1 - material recycling facility and transfer station.	
Maximum quantities	The total aggregated quantity of hazardous and non-hazardous waste accepted at the site shall not exceed 750,250 tonnes per year. The total quantity of waste accepted at the site for activities AR8 shall not exceed 75,000 tonnes per year.
Exclusions	Wastes shall not be accepted at the site which have any of the following characteristics: <ul style="list-style-type: none"> ▪ Wastes consisting solely or mainly of silica dusts and powders. ▪ Wastes that are in a form which is either sludge or liquid.
Waste code	Description
10 08 11	dross and skimmings other than those mentioned in 10 08 10
10 08 13	carbon-containing wastes from anode manufacture other than those mentioned in 10 08 12
10 08 14	anode scrap
10 08 20	wastes from cooling-water treatment other than those mentioned in 10 08 19
10 09	wastes from casting of ferrous pieces
10 09 03	furnace slag
10 09 06	casting cores and moulds which have not undergone pouring other than those mentioned in 10 09 05
10 09 08	casting cores and moulds which have undergone pouring other than those mentioned in 10 09 07
10 09 14	waste binders other than those mentioned in 10 09 13
10 09 16	waste crack-indicating agent other than those mentioned in 10 09 15
10 10	wastes from casting of non-ferrous pieces
10 10 03	furnace slag
10 10 06	casting cores and moulds which have not undergone pouring, other than those mentioned in 10 10 05
10 10 08	casting cores and moulds which have undergone pouring, other than those mentioned in 10 10 07
10 10 14	waste binders other than those mentioned in 10 10 13
10 10 16	waste crack-indicating agent other than those mentioned in 10 10 15
10 11	wastes from manufacture of glass and glass products
10 11 03	waste glass-based fibrous materials
10 11 10	waste preparation mixture before thermal processing, other than those mentioned in 10 11 09
10 11 12	waste glass other than those mentioned in 10 11 11
10 11 16	solid wastes from flue-gas treatment other than those mentioned in 10 11 15
10 12	wastes from manufacture of ceramic goods, bricks, tiles and construction products
10 12 01	waste preparation mixture before thermal processing
10 12 06	discarded moulds
10 12 08	waste ceramics, bricks, tiles and construction products (after thermal processing)
10 12 10	solid wastes from gas treatment other than those mentioned in 10 12 09
10 12 12	wastes from glazing other than those mentioned in 10 12 11

Table S2.4 Permitted waste types and quantities under Activity AR8 of Table S1.1 - material recycling facility and transfer station.	
Maximum quantities	The total aggregated quantity of hazardous and non-hazardous waste accepted at the site shall not exceed 750,250 tonnes per year. The total quantity of waste accepted at the site for activities AR8 shall not exceed 75,000 tonnes per year.
Exclusions	Wastes shall not be accepted at the site which have any of the following characteristics: <ul style="list-style-type: none"> ▪ Wastes consisting solely or mainly of silica dusts and powders. ▪ Wastes that are in a form which is either sludge or liquid.
Waste code	Description
10 13	wastes from manufacture of cement, lime and plaster and articles and products made from them
10 13 01	waste preparation mixture before thermal processing
10 13 04	wastes from calcination and hydration of lime
10 13 11	wastes from cement-based composite materials other than those mentioned in 10 13 09 and 10 13 10
10 13 13	solid wastes from gas treatment other than those mentioned in 10 13 12
11	Wastes from chemical surface treatment and coating of metals and other materials; non-ferrous hydro-metallurgy
11 01	wastes from chemical surface treatment and coating of metals and other materials (for example galvanic processes, zinc coating processes, pickling processes, etching, phosphating, alkaline degreasing, anodising)
11 02	wastes from non-ferrous hydrometallurgical processes
11 02 03	wastes from the production of anodes for aqueous electrolytical processes
11 02 06	wastes from copper hydrometallurgical processes other than those mentioned in 11 02 05
11 05	wastes from hot galvanising processes
11 05 01	hard zinc
11 05 02	zinc ash
12	Wastes from shaping and physical and mechanical surface treatment of metals and plastics
12 01	wastes from shaping and physical and mechanical surface treatment of metals and plastics
12 01 01	ferrous metal filings and turnings
12 01 03	non-ferrous metal filings and turnings
12 01 13	welding wastes
12 01 17	waste blasting material other than those mentioned in 12 01 16
12 01 21	spent grinding bodies and grinding materials other than those mentioned in 12 01 20
15	Waste packaging, absorbents, wiping cloths, filter materials and protective clothing not otherwise specified
15 01	packaging (including separately collected municipal packaging waste)
15 01 01	paper and cardboard packaging
15 01 02	plastic packaging
15 01 03	wooden packaging

Table S2.4 Permitted waste types and quantities under Activity AR8 of Table S1.1 - material recycling facility and transfer station.	
Maximum quantities	The total aggregated quantity of hazardous and non-hazardous waste accepted at the site shall not exceed 750,250 tonnes per year. The total quantity of waste accepted at the site for activities AR8 shall not exceed 75,000 tonnes per year.
Exclusions	Wastes shall not be accepted at the site which have any of the following characteristics: <ul style="list-style-type: none"> ▪ Wastes consisting solely or mainly of silica dusts and powders. ▪ Wastes that are in a form which is either sludge or liquid.
Waste code	Description
15 01 04	metallic packaging
15 01 05	composite packaging
15 01 06	mixed packaging
15 01 07	glass packaging
15 01 09	textile packaging
15 02	absorbents, filter materials, wiping cloths and protective clothing
15 02 03	absorbents, filter materials, wiping cloths and protective clothing other than those mentioned in 15 02 02
16	Wastes not otherwise specified in the list
16 01	end-of-life vehicles from different means of transport (including off-road machinery) and wastes from dismantling of end-of-life vehicles and vehicle maintenance (except 13, 14, 16 06 and 16 08)
16 01 03	end-of-life tyres
16 03	off-specification batches and unused products
16 03 04	inorganic wastes other than those mentioned in 16 03 03
16 03 06	organic wastes other than those mentioned in 16 03 05
16 11	waste linings and refractories
16 11 02	carbon-based linings and refractories from metallurgical processes others than those mentioned in 16 11 01
16 11 04	other linings and refractories from metallurgical processes other than those mentioned in 16 11 03
16 11 06	linings and refractories from non-metallurgical processes others than those mentioned in 16 11 05
17	Construction and demolition wastes (including excavated soil from contaminated sites)
17 01	concrete, bricks, tiles and ceramics
17 01 01	concrete
17 01 02	bricks
17 01 03	tiles and ceramics
17 01 07	mixtures of concrete, bricks, tiles and ceramics other than those mentioned in 17 01 06
17 02	wood, glass and plastic
17 02 01	wood
17 02 02	glass

Table S2.4 Permitted waste types and quantities under Activity AR8 of Table S1.1 - material recycling facility and transfer station.	
Maximum quantities	The total aggregated quantity of hazardous and non-hazardous waste accepted at the site shall not exceed 750,250 tonnes per year. The total quantity of waste accepted at the site for activities AR8 shall not exceed 75,000 tonnes per year.
Exclusions	Wastes shall not be accepted at the site which have any of the following characteristics: <ul style="list-style-type: none"> ▪ Wastes consisting solely or mainly of silica dusts and powders. ▪ Wastes that are in a form which is either sludge or liquid.
Waste code	Description
17 02 03	plastic
17 03	bituminous mixtures, coal tar and tarred products
17 03 02	bituminous mixtures other than those mentioned in 17 03 01
17 04	metals (including their alloys)
17 04 01	copper, bronze, brass
17 04 02	aluminium
17 04 03	lead
17 04 04	zinc
17 04 05	iron and steel
17 04 06	tin
17 04 07	mixed metals
17 04 11	cables other than those mentioned in 17 04 10
17 05	soil (including excavated soil from contaminated sites), stones and dredging spoil
17 05 04	soil and stones other than those mentioned in 17 05 03
17 05 08	track ballast other than those mentioned in 17 05 07
17 06	insulation materials and asbestos-containing construction materials
17 06 04	insulation materials other than those mentioned in 17 06 01 and 17 06 03
17 08	gypsum-based construction material
17 08 02	gypsum-based construction materials other than those mentioned in 17 08 01
17 09	other construction and demolition wastes
17 09 04	mixed construction and demolition wastes other than those mentioned in 17 09 01, 17 09 02 and 17 09 03
19	Wastes from waste management facilities, off-site waste water treatment plants and the preparation of water intended for human consumption and water for industrial use
19 01	wastes from incineration or pyrolysis of waste
19 01 02	ferrous materials removed from bottom ash
19 01 12	bottom ash and slag other than those mentioned in 19 01 11
19 01 18	pyrolysis wastes other than those mentioned in 19 01 17
19 01 19	sands from fluidised beds
19 02	wastes from physico/chemical treatments of waste (including dechromatation, decyanidation, neutralisation)

Table S2.4 Permitted waste types and quantities under Activity AR8 of Table S1.1 - material recycling facility and transfer station.	
Maximum quantities	The total aggregated quantity of hazardous and non-hazardous waste accepted at the site shall not exceed 750,250 tonnes per year. The total quantity of waste accepted at the site for activities AR8 shall not exceed 75,000 tonnes per year.
Exclusions	Wastes shall not be accepted at the site which have any of the following characteristics: <ul style="list-style-type: none"> ▪ Wastes consisting solely or mainly of silica dusts and powders. ▪ Wastes that are in a form which is either sludge or liquid.
Waste code	Description
19 02 03	premixed wastes composed only of non-hazardous wastes
19 02 10	combustible wastes other than those mentioned in 19 02 08 and 19 02 09
19 04	vitrified waste and wastes from vitrification
19 04 01	vitrified waste
19 05	wastes from aerobic treatment of solid wastes
19 05 01	non-composted fraction of municipal and similar wastes
19 05 03	off-specification compost
19 12	wastes from the mechanical treatment of waste (for example sorting, crushing, compacting, pelletising) not otherwise specified
19 12 01	paper and cardboard
19 12 02	ferrous metal
19 12 03	non-ferrous metal
19 12 04	plastic and rubber
19 12 05	glass
19 12 07	wood other than that mentioned in 19 12 06
19 12 08	textiles
19 12 09	minerals (for example sand, stones)
19 12 10	combustible waste (refuse derived fuel)
19 12 12	other wastes (including mixtures of materials) from mechanical treatment of wastes other than those mentioned in 19 12 11
19 13	wastes from soil and groundwater remediation
19 13 02	solid wastes from soil remediation other than those mentioned in 19 13 01
20	Municipal wastes (household waste and similar commercial, industrial and institutional wastes) including separately collected fractions
20 01	separately collected fractions (except 15 01)
20 01 01	paper and cardboard
20 01 02	glass
20 01 08	biodegradable kitchen and canteen waste
20 01 10	clothes
20 01 11	textiles
20 01 38	wood other than that mentioned in 20 01 37
20 01 39	plastics

Table S2.4 Permitted waste types and quantities under Activity AR8 of Table S1.1 - material recycling facility and transfer station.	
Maximum quantities	The total aggregated quantity of hazardous and non-hazardous waste accepted at the site shall not exceed 750,250 tonnes per year. The total quantity of waste accepted at the site for activities AR8 shall not exceed 75,000 tonnes per year.
Exclusions	Wastes shall not be accepted at the site which have any of the following characteristics: <ul style="list-style-type: none"> ▪ Wastes consisting solely or mainly of silica dusts and powders. ▪ Wastes that are in a form which is either sludge or liquid.
Waste code	Description
20 01 40	metals
20 02	garden and park wastes (including cemetery waste)
20 02 02	soil and stones
20 03	other municipal wastes
20 03 01	mixed municipal waste
20 03 02	waste from markets
20 03 03	street-cleaning residues
20 03 07	bulky waste

Table S2.5 Permitted waste types and quantities under Activity AR9 of Table S1.1 - green waste pre-treatment and storage.	
Maximum quantities	The total aggregated quantity of hazardous and non-hazardous waste accepted at the site shall not exceed 750,250 tonnes per year. The total quantity of waste accepted at the site for activities AR9 shall not exceed 10,000 tonnes per year.
Waste code	Description
02	Wastes from agriculture, horticulture, aquaculture, forestry, hunting and fishing, food preparation and processing
02 01	wastes from agriculture, horticulture, aquaculture, forestry, hunting and fishing
02 01 03	plant-tissue waste
02 01 07	wastes from forestry
03	Wastes from wood processing and the production of panels and furniture, pulp, paper and cardboard
03 01	wastes from wood processing and the production of panels and furniture
03 01 01	waste bark and cork
20	Municipal wastes (household waste and similar commercial, industrial and institutional wastes) including separately collected fractions
20 02	garden and park wastes (including cemetery waste)
20 02 01	biodegradable waste

Table S2.6 Permitted waste types and quantities under Activity AR10 of Table S1.1 - wood waste shredding and chipping with storage.	
Maximum quantities	The total aggregated quantity of hazardous and non-hazardous waste accepted at the site shall not exceed 750,250 tonnes per year. The total quantity of waste accepted at the site for activities AR10 shall not exceed 130,000 tonnes per year.
Waste code	Description
03	Wastes from wood processing and the production of panels and furniture, pulp, paper and cardboard
03 01	wastes from wood processing and the production of panels and furniture
03 01 01	waste bark and cork
15	Waste packaging, absorbents, wiping cloths, filter materials and protective clothing not otherwise specified
15 01	packaging (including separately collected municipal packaging waste)
15 01 03	wooden packaging
17	Construction and demolition wastes (including excavated soil from contaminated sites)
17 02	wood, glass and plastic
17 02 01	wood
19	Wastes from waste management facilities, off-site waste water treatment plants and the preparation of water intended for human consumption and water for industrial use
19 12	wastes from the mechanical treatment of waste (for example sorting, crushing, compacting, pelletising) not otherwise specified
19 12 07	wood other than that mentioned in 19 12 06
20	Municipal wastes (household waste and similar commercial, industrial and institutional wastes) including separately collected fractions
20 01	separately collected fractions (except 15 01)
20 01 38	wood other than that mentioned in 20 01 37

Table S2.7 Permitted waste types and quantities under Activity AR11 of Table S1.1 - hazardous and non-hazardous storage and transfer station – storage and bulking up only	
Maximum quantities	The total aggregated quantity of hazardous and non-hazardous waste accepted at the site shall not exceed 750,250 tonnes per year. The total quantity of waste accepted at the site for activities AR11 shall not exceed 3,650 tonnes per year.
Waste code	Description
03	Wastes from wood processing and the production of panels and furniture, pulp, paper and cardboard
03 02	wastes from wood preservation
03 02 01*	non-halogenated organic wood preservatives
03 02 02*	organochlorinated wood preservatives
03 02 03*	organometallic wood preservatives
03 02 04*	inorganic wood preservatives
03 02 05*	other wood preservatives containing hazardous substances

Table S2.7 Permitted waste types and quantities under Activity AR11 of Table S1.1 - hazardous and non-hazardous storage and transfer station – storage and bulking up only

Maximum quantities	The total aggregated quantity of hazardous and non-hazardous waste accepted at the site shall not exceed 750,250 tonnes per year. The total quantity of waste accepted at the site for activities AR11 shall not exceed 3,650 tonnes per year.
Waste code	Description
08	Wastes from the manufacture, formulation, supply and use (MFSU) of coatings (paints, varnishes and vitreous enamels), adhesives, sealants and printing inks
08 01	wastes from MFSU and removal of paint and varnish
08 01 11*	waste paint and varnish containing organic solvents or other hazardous substances
08 01 13*	sludges from paint or varnish containing organic solvents or other hazardous substances
08 01 17*	wastes from paint or varnish removal containing organic solvents or other hazardous substances
08 01 21*	waste paint or varnish remover
08 03	wastes from MFSU of printing inks
08 03 16*	waste etching solutions
08 03 19*	disperse oil
08 04	wastes from MFSU of adhesives and sealants (including water proofing products)
08 04 09*	waste adhesives and sealants containing organic solvents or other hazardous substances
08 04 11*	adhesive and sealant sludges containing organic solvents or other hazardous substances
08 04 13*	aqueous sludges containing adhesives or sealants containing organic solvents or other hazardous substances
08 04 15*	aqueous liquid waste containing adhesives or sealants containing organic solvents or other hazardous substances
08 04 17*	rosin oil
10 13	wastes from manufacture of cement, lime and plaster and articles and products made from them
10 13 10	wastes from asbestos-cement manufacture other than those mentioned in 10 13 09
15	Waste packaging, absorbents, wiping cloths, filter materials and protective clothing not otherwise specified
15 01	packaging (including separately collected municipal packaging waste)
15 01 06	mixed packaging
15 02	absorbents, filter materials, wiping cloths and protective clothing
15 02 02*	absorbents, filter materials (including oil filters not otherwise specified), wiping cloths, protective clothing contaminated by hazardous substances
16	Wastes not otherwise specified in the list
16 02	wastes from electrical and electronic equipment
16 02 09*	transformers and capacitors containing PCBs
16 02 10*	discarded equipment containing or contaminated by PCBs other than those mentioned in 16 02 09

Table S2.7 Permitted waste types and quantities under Activity AR11 of Table S1.1 - hazardous and non-hazardous storage and transfer station – storage and bulking up only

Maximum quantities	The total aggregated quantity of hazardous and non-hazardous waste accepted at the site shall not exceed 750,250 tonnes per year. The total quantity of waste accepted at the site for activities AR11 shall not exceed 3,650 tonnes per year.
Waste code	Description
16 02 11*	discarded equipment containing chlorofluorocarbons, HCFC, HFC
16 02 12*	discarded equipment containing free asbestos
16 02 13*	discarded equipment containing hazardous components other than those mentioned in 16 02 09 to 16 02 12
16 02 14	discarded equipment other than those mentioned in 16 02 09 to 16 02 13
16 02 15*	hazardous components removed from discarded equipment
16 02 16	components removed from discarded equipment other than those mentioned in 16 02 15
16 06	batteries and accumulators
16 06 01*	lead batteries
16 06 02*	Ni-Cd batteries
16 06 03*	mercury-containing batteries
16 06 04	alkaline batteries (except 16 06 03)
16 06 05	other batteries and accumulators
17	Construction and demolition wastes (including excavated soil from contaminated sites)
17 06	insulation materials and asbestos-containing construction materials
17 06 01*	insulation materials containing asbestos
17 06 05*	construction materials containing asbestos
20	Municipal wastes (household waste and similar commercial, industrial and institutional wastes) including separately collected fractions
20 01	separately collected fractions (except 15 01)
20 01 21*	fluorescent tubes and other mercury-containing waste
20 01 23*	discarded equipment containing chlorofluorocarbons
20 01 34	batteries and accumulators other than those mentioned in 20 01 33
20 01 35*	discarded electrical and electronic equipment other than those mentioned in 20 01 21 and 20 01 23 containing hazardous components
20 01 36	discarded electrical and electronic equipment other than those mentioned in 20 01 21, 20 01 23 and 20 01 35
20 01 37*	wood containing hazardous substances

Schedule 3 – Emissions and monitoring

Table S3.1 Point Source emissions to water (other than sewer) and land – emission limits and monitoring requirements						
Emission point ref. & location	Source	Parameter	Limit (incl. unit) ⁽¹⁾	Reference Period	Monitoring frequency	Monitoring standard or method
W1 Discharge to surface water as detailed on the site layout plan in Schedule 7	Site lagoon	Maximum daily discharge volume	43 m ³ /day	Total daily volume	NA	Maximum
		Maximum rate of discharge	17.7 l/s	Instantaneous (spot sample)	NA	Maximum
		Total organic carbon (TOC)	100 mg/l	Instantaneous (spot sample)	Once per batch	EN 1484
		Total suspended solids (TSS)	60 mg/l			EN 872
		Hydrocarbon oil index (HOI)	10 mg/l			EN ISO 9377-2
		Total phosphorus (Total P)	3 mg/l			Various EN standards available (i.e., EN ISO 15681-1 and -2, EN ISO 6878, EN ISO 11885)
		Phenol index	0.3 mg/l			EN ISO 14402
		Free cyanide (CN-) ⁽¹⁾	0.1 mg/l			Various EN standards available (i.e., EN ISO 14403-1 and -2)
		Adsorbable organically bound halogens (AOX) ⁽¹⁾	1 mg/l			EN ISO 9562
		Arsenic (expressed as As) ⁽¹⁾	0.05 mg/l			Various EN standards available (e.g., EN ISO 11885, EN ISO 17294-2, EN ISO 15586)
		Cadmium (expressed as Cd) ⁽¹⁾	0.05 mg/l			
		Chromium (expressed as Cr) ⁽¹⁾	0.15 mg/l			

Table S3.1 Point Source emissions to water (other than sewer) and land – emission limits and monitoring requirements						
Emission point ref. & location	Source	Parameter	Limit (incl. unit)⁽¹⁾	Reference Period	Monitoring frequency	Monitoring standard or method
		Copper (expressed as Cu) ⁽¹⁾	0.5 mg/l			
		Lead (expressed as Pb) ⁽¹⁾	0.1 mg/l			
		Nickel (expressed as Ni) ⁽¹⁾	0.5 mg/l			
		Zinc (expressed as Zn) ⁽¹⁾	1 mg/l			
		Mercury (expressed as Hg) ⁽¹⁾	5 µg/l			Various EN standards available (i.e., EN ISO 17852, EN ISO 12846)
		Hexavalent chromium (expressed as Cr (VI)) ⁽¹⁾	0.1 mg/l			Various EN standards available (i.e., EN ISO 10304-3, EN ISO 23913)
(1) The monitoring and BAT-AELs only applies when the substance concerned is identified as relevant in the wastewater inventory mentioned in BAT 3.						

Table S3.2 Process monitoring requirements				
Emission point reference or source or description of point of measurement	Parameter	Monitoring frequency	Monitoring standard or method	Other specifications
Odour abatement system (Air ionisation system)	No parameter set	In accordance with manufacturer's recommendations	None specified	Abatement system shall be regularly checked and maintained to ensure appropriate operating parameters in line with the manufactures recommendations.

Table S3.3 Bioaerosol monitoring requirements					
Location or description of point of measurement	Parameter	Bioaerosol threshold limits (CFU m-3)	Monitoring frequency	Monitoring standard or method	Other specifications
At a minimum of three separate locations, as described in the Industry Standard Protocol	Total bacteria	1000	Quarterly	In accordance with the Industry Standard Protocol, and, for gram-negative bacteria, together with the Environment Agency's "Guidance on the evaluation of bioaerosol risk assessments for composting facilities".	As described in the Industry Standard Protocol, including all the additional data requirements specified therein.
	Aspergillus Fumigatus	500			

Schedule 4 – Reporting

Parameters, for which reports shall be made, in accordance with conditions of this permit, are listed below.

Parameter	Emission or monitoring point/reference	Reporting period	Period begins
Point source emissions to water (other than sewer) Parameters as required by condition 3.5.1	W1	Every 6 months	1 January, 1 July
Process monitoring Parameters as required by condition 3.5.1	Odour abatement system	Every 6 months	1 January, 1 July
Ambient air monitoring Parameters as required by condition 3.5.1	Bioaerosol (at the agreed locations)	Every 6 months	1 January, 1 July

Parameter	Units
Processed SRF and RDF	tonnes

Parameter	Frequency of assessment	Units
Water usage	Annually	tonnes
Energy usage	Annually	MWh
Total raw material used	Annually	tonnes

Media/parameter	Reporting format	Date of form
Water usage	Form water usage 1 or other form as agreed in writing by the Environment Agency	19/01/2017
Energy usage	Form energy 1 or other form as agreed in writing by the Environment Agency	19/01/2017
Other performance indicators	Form performance 1 or other form as agreed in writing by the Environment Agency	19/01/2017

Schedule 5 – Notification

These pages outline the information that the operator must provide.

Units of measurement used in information supplied under Part A and B requirements shall be appropriate to the circumstances of the emission. Where appropriate, a comparison should be made of actual emissions and authorised emission limits.

If any information is considered commercially confidential, it should be separated from non-confidential information, supplied on a separate sheet and accompanied by an application for commercial confidentiality under the provisions of the EP Regulations.

Part A

Permit Number	
Name of operator	
Location of Facility	
Time and date of the detection	

(a) Notification requirements for any malfunction, breakdown or failure of equipment or techniques, accident, or emission of a substance not controlled by an emission limit which has caused, is causing or may cause significant pollution	
To be notified within 24 hours of detection	
Date and time of the event	
Reference or description of the location of the event	
Description of where any release into the environment took place	
Substances(s) potentially released	
Best estimate of the quantity or rate of release of substances	
Measures taken, or intended to be taken, to stop any emission	
Description of the failure or accident.	

(b) Notification requirements for the breach of a limit	
To be notified within 24 hours of detection unless otherwise specified below	
Emission point reference/ source	
Parameter(s)	
Limit	
Measured value and uncertainty	
Date and time of monitoring	

(b) Notification requirements for the breach of a limit	
To be notified within 24 hours of detection unless otherwise specified below	
Measures taken, or intended to be taken, to stop the emission	

Time periods for notification following detection of a breach of a limit	
Parameter	Notification period

(c) Notification requirements for the breach of permit conditions not related to limits	
To be notified within 24 hours of detection	
Condition breached	
Date, time and duration of breach	
Details of the permit breach i.e. what happened including impacts observed.	
Measures taken, or intended to be taken, to restore permit compliance.	

(d) Notification requirements for the detection of any significant adverse environmental effect	
To be notified within 24 hours of detection	
Description of where the effect on the environment was detected	
Substances(s) detected	
Concentrations of substances detected	
Date of monitoring/sampling	

Part B – to be submitted as soon as practicable

Any more accurate information on the matters for notification under Part A.	
Measures taken, or intended to be taken, to prevent a recurrence of the incident	

Measures taken, or intended to be taken, to rectify, limit or prevent any pollution of the environment which has been or may be caused by the emission	
The dates of any unauthorised emissions from the facility in the preceding 24 months.	

Name*	
Post	
Signature	
Date	

* authorised to sign on behalf of the operator

Schedule 6 – Interpretation

“accident” means an accident that may result in pollution.

“application” means the application for this permit, together with any additional information supplied by the operator as part of the application and any response to a notice served under Schedule 5 to the EP Regulations.

“appropriate measures” are set out in the “Non-hazardous and inert waste: appropriate measures for permitted facilities” guidance published 12 July 2021

“authorised officer” means any person authorised by the Environment Agency under section 108(1) of The Environment Act 1995 to exercise, in accordance with the terms of any such authorisation, any power specified in section 108(4) of that Act.

specified in section 108(4) of that Act.

“baling” means baling that utilises a hydraulic machine that using compressive forces compacts various materials into regular-shaped dense bales (typically a cube). Bales may be belted with straps or steel wire to keep the bale in its compacted state; although for most metal bales this is not necessary. Baled scrap metal may be easier to handle, store and transport than loose scrap.

“best available treatment, recovery and recycling techniques” shall have the meaning given to it in the document published jointly by the Department for Environment, Food and Rural Affairs, the Welsh Assembly Government and the Scottish Executive on 27th November 2006, entitled ‘Guidance on Best Available Treatment, Recovery and Recycling Techniques (BATRRT) and Treatment of Waste Electrical and Electronic Equipment (WEEE)’; and any revision to or replacement of it.

“bioaerosol threshold limits” means the maximum acceptable bioaerosol concentrations at the nearest sensitive receptor, or at an equivalent distance downwind of the composting operations, which are attributable to the composting operations. The maximum acceptable concentrations are respectively, 1000 and 500 CFU m⁻³ for total bacteria and *Aspergillus fumigatus*.

“building” means a construction that has the objective of providing sheltering cover and minimising emissions of noise, particulate matter, odour and litter.

“container” is a receptacle for waste for example bags, bins, boxes, drums, IBCs and blister packs. Wastes may be packaged in more than one receptacle for example a bag in a box.

“disposal” Means any of the operations provided for in Annex I to Directive 2008/98/EC of the European Parliament and of the Council on waste.

“emissions of substances not controlled by emission limits” means emissions of substances to air, water or land from the activities, either from the emission points specified in schedule 3 or from other localised or diffuse sources, which are not controlled by an emission or background concentration limit.

“emissions to land” includes emissions to groundwater.

“EP Regulations” means The Environmental Permitting (England and Wales) Regulations SI 2016 No.1154 and words and expressions used in this permit which are also used in the Regulations have the same meanings as in those Regulations.

“groundwater” means all water, which is below the surface of the ground in the saturation zone and in direct contact with the ground or subsoil.

“Hazardous property” has the meaning in Annex III of the Waste Framework Directive.

“Hazardous waste” has the meaning given in the Hazardous Waste (England and Wales) Regulations 2005 (as amended).

“impermeable surface” means a surface or pavement constructed and maintained to a standard sufficient to prevent the transmission of liquids beyond the pavement surface.

“Industrial Emissions Directive” means DIRECTIVE 2010/75/EU OF THE EUROPEAN PARLIAMENT AND OF THE COUNCIL of 24 November 2010 on industrial emissions, as read in accordance with Schedule 1A to the Environmental Permitting (England and Wales) Regulations 2016.

“Industry Standard Protocol” means “A standardised protocol for the monitoring of bioaerosols at open composting facilities” published by the Association for Organics Recycling and developed in conjunction with the Environment Agency.

“List of Wastes” means the list of wastes established by Commission Decision 2000/532/EC replacing Decision 94/3/EC establishing a list of wastes pursuant to Article 1(a) of Council Directive 75/442/EEC on waste and Council Decision 94/904/EC establishing a list of hazardous waste pursuant to Article 1(4) of Council Directive 91/689/EEC on hazardous waste, as amended from time to time.

“MCERTS” means the Environment Agency’s Monitoring Certification Scheme.

“pests” means Birds, Vermin and Insects.

“pollution” includes pollution of the environment, harm to human health and serious detriment to the amenities of the locality, resulting from the permitted activities.

“quarter” means a calendar year quarter commencing on 1 January, 1 April, 1 July or 1 October.

“recovery” means any of the operations provided for in Annex II to the Waste Framework Directive.

“repackaging” is the removal of waste from one container to another. Examples of repackaging include:

(a) taking a waste package (for example a bag, drum or box) out of one cart or bulk container (for example a skip) and placing it into another cart or bulk container for example, skip

(b) taking a waste package from a cart or bulk container for example, skip and placing it onto a pallet or vehicle

(c) taking a waste package from a pallet and placing it into a cart or bulk container for example, skip

(d) transferring, removing or separating waste from its primary packaging into another container

The removal of waste from a vehicle is not ‘repackaging’.

“sealed drainage system” in relation to an impermeable surface, means a drainage system with impermeable components which does not leak and which will ensure that:

- no liquids will run off the surface otherwise than via the system
- all liquids entering the system are collected in a sealed sump, except where liquids may be lawfully discharged to foul sewer.

“Waste code” means the six-digit code referable to a type of waste in accordance with the List of Wastes and in relation to hazardous waste, includes the asterisk.

“Waste Framework Directive” or “WFD” means Waste Framework Directive 2008/98/EC of the European Parliament and of the Council on waste, as read in accordance with Schedule 1A to the Environmental Permitting (England and Wales) Regulations 2016.

“WEEE” means waste electrical and electronic equipment.

“WEEE Directive” means Directive 2012/19/EU of the European Parliament and of the Council of 4th July 2012 on waste electrical and electronic equipment (WEEE), as read in accordance with Schedule 1A to the Environmental Permitting (England and Wales) Regulations 2016.

“year” means calendar year ending 31 December.

Where a minimum limit is set for any emission parameter, for example pH, reference to exceeding the limit shall mean that the parameter shall not be less than that limit.

Unless otherwise stated, any references in this permit to concentrations of substances in emissions into air means:

- in relation to emissions from combustion processes, the concentration in dry air at a temperature of 273K, at a pressure of 101.3 kPa and with an oxygen content of 3% dry for liquid and gaseous fuels, 6% dry for solid fuels; and/or
- in relation to emissions from non-combustion sources, the concentration at a temperature of 273K and at a pressure of 101.3 kPa, with no correction for water vapour content.

Schedule 7 – Site plan

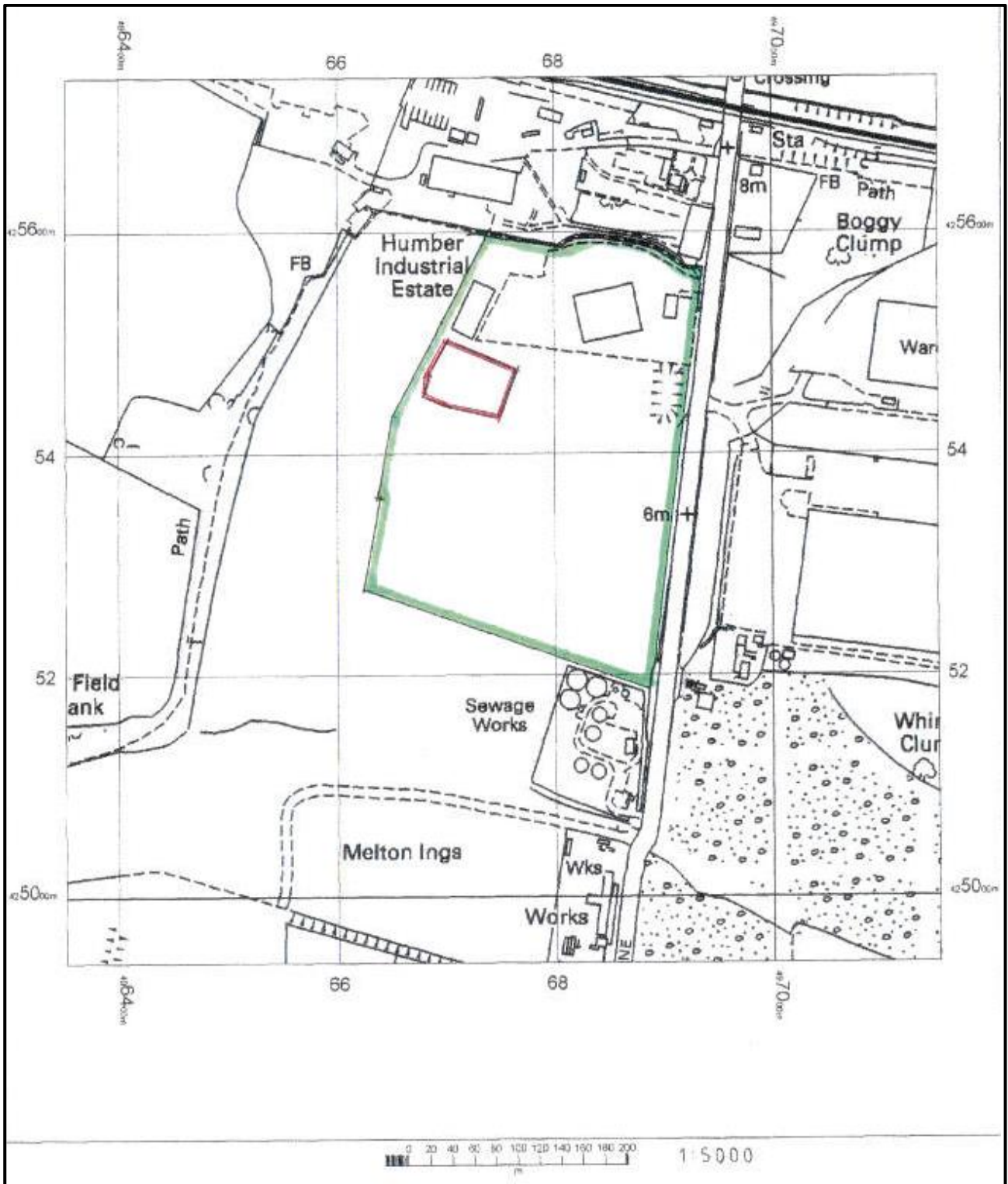

Site layout plan

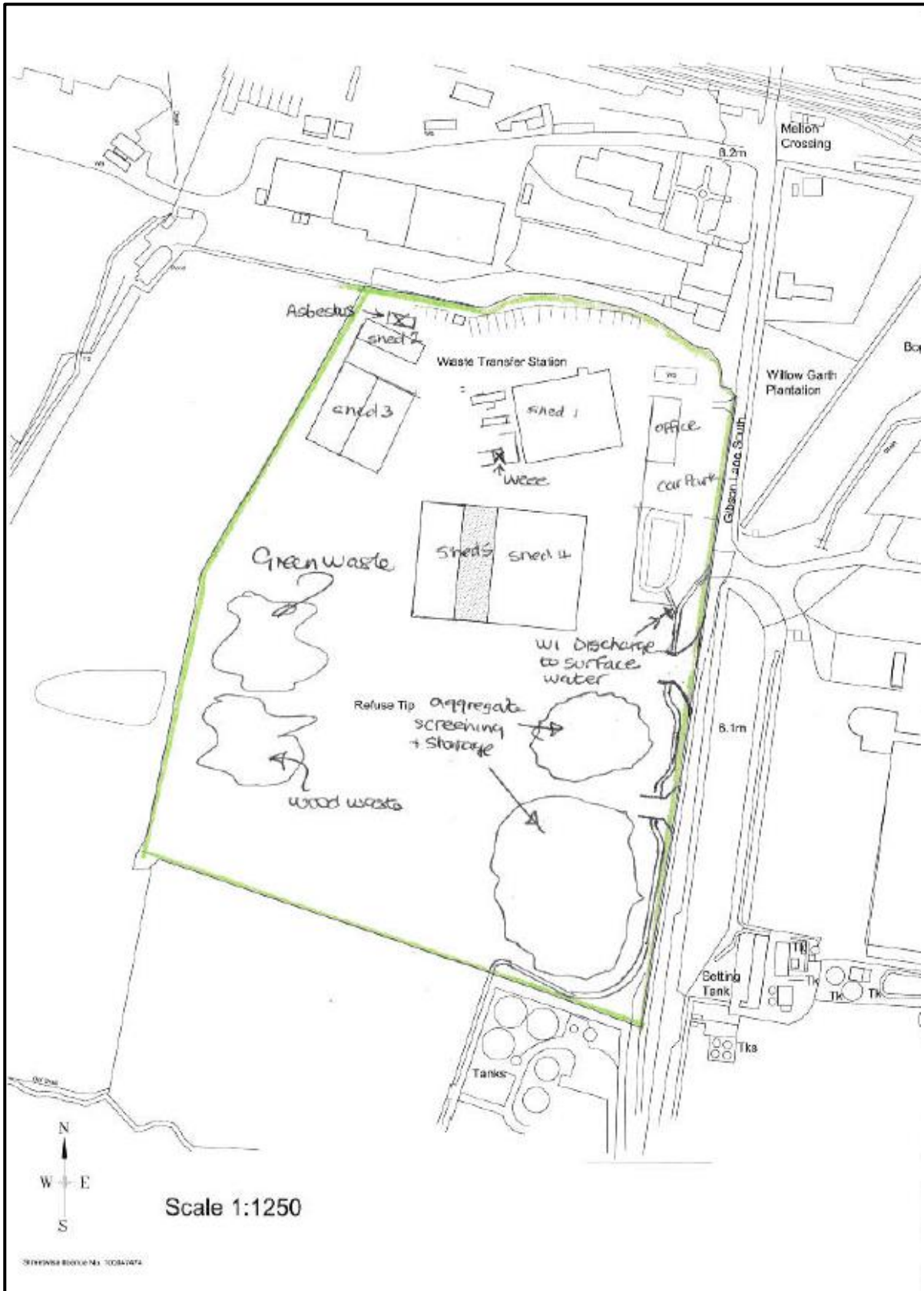

©Crown Copyright. All rights reserved. Environment Agency, 100024198, 2016.

END OF PERMIT

Permit Number: BP3792LD

Operator:

**Transwaste Recycling and
Aggregates Limited**

Facility: Melton Waste Park

**Form
Number:**

WaterUsage1 / 19/01/2017

Reporting of Water Usage for the year 2017

Water Source	Usage (m³/year)	Specific Usage (m³/unit output)
Mains water		
Site borehole		
River abstraction		
TOTAL WATER USAGE		

Operator's comments:

Signed

Date.....

(authorised to sign as representative of Operator)

Permit Number: BP3792LD

Operator:

**Transwaste Recycling and
Aggregates Limited**

Facility: Melton Waste Park

**Form
Number:**

Energy1 / 19/01/2017

Reporting of Energy Usage for the year 2017

Energy Source	Energy Usage		Specific Usage (MWh/unit output)
	Quantity	Primary Energy (MWh)	
Electricity *	MWh		
Natural Gas	MWh		
Gas Oil	tonnes		
Recovered Fuel Oil	tonnes		
TOTAL	-		

* Conversion factor for delivered electricity to primary energy = 2.4

Operator's comments:

Signed

Date.....

(Authorised to sign as representative of Operator)

Permit Number: BP3792LD

**Operator: Transwaste Recycling and
Aggregates Limited**

Facility: Melton Waste Park

**Form
Number: Performance1 / 19/01/2017**

Reporting of other performance indicators for the period DD/MM/YYYY to DD/MM/YYYY

Parameter	Units
Total raw material used	tonnes

Operator's comments:

Signed

Date.....

(Authorised to sign as representative of Operator)