

Drawings

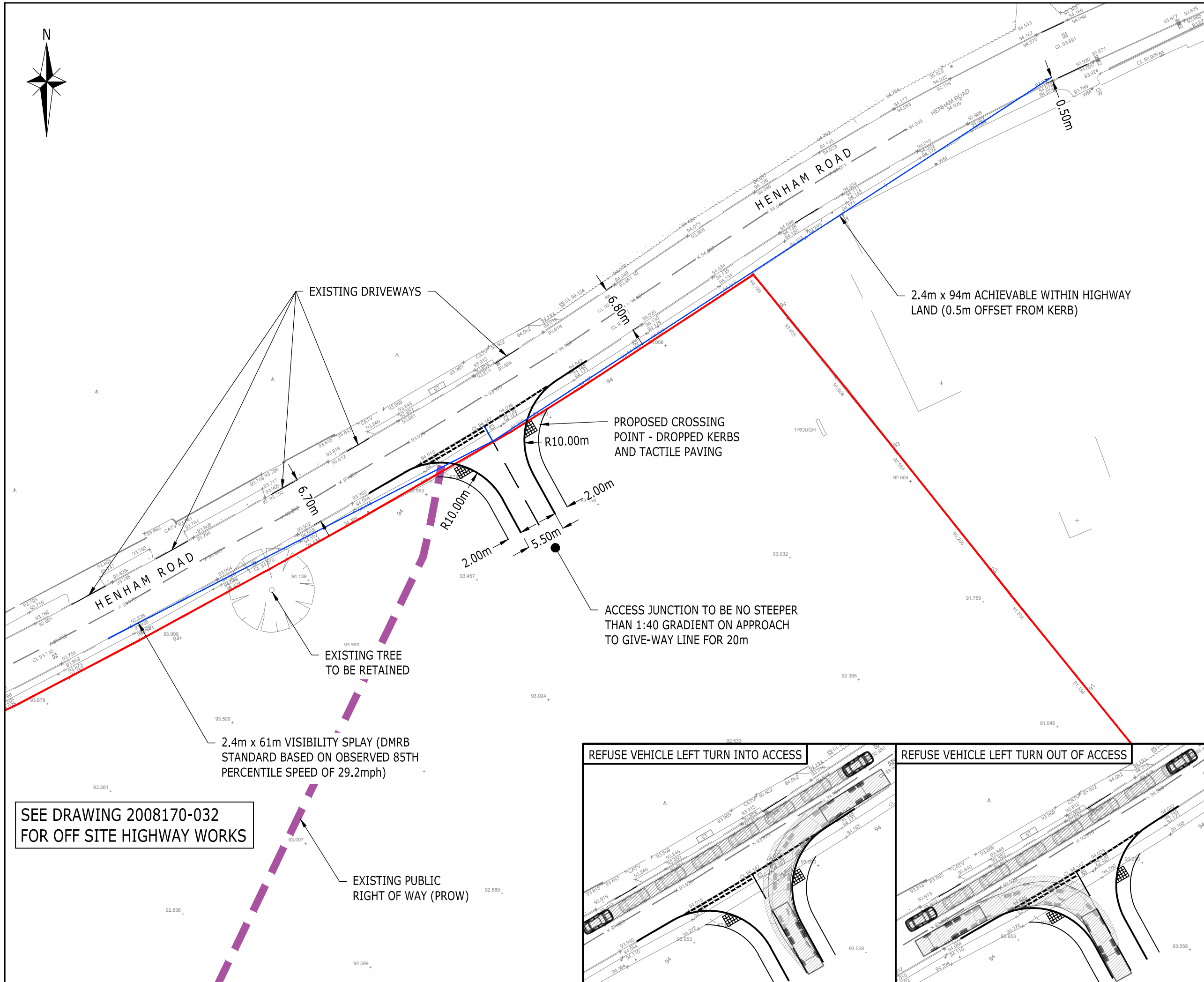

SEE DRAWING 2008170-032 FOR OFF SITE HIGHWAY WORKS

REFUSE VEHICLE LEFT TURN INTO ACCESS

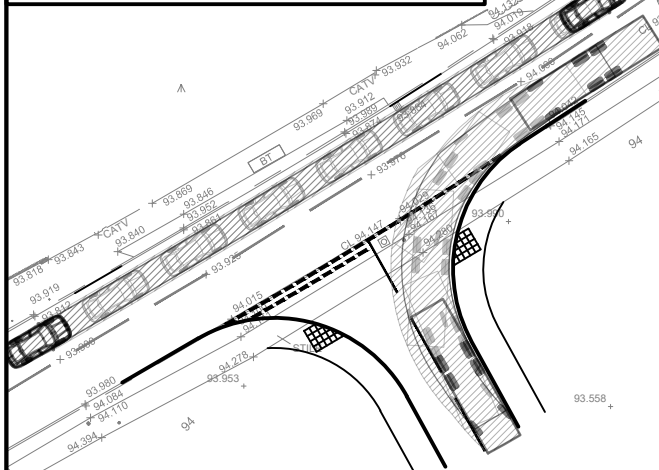

REFUSE VEHICLE LEFT TURN OUT OF ACCESS

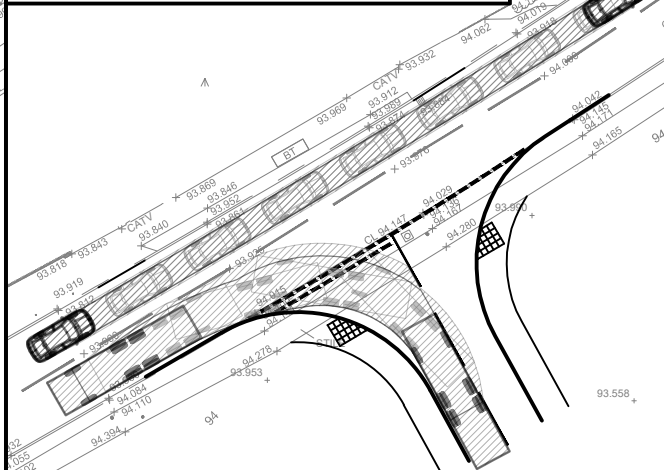

NOTES:

DESIGN SUBJECT TO HIGHWAYS APPROVAL DETAILED DESIGN.

VEHICLE USED:

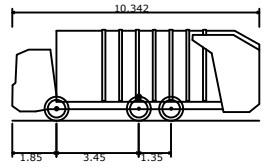

Essex Large Refuse Vehicle (3 axle)

Overall Length	10.342m
Overall Width	2.450m
Overall Body Height	3.814m
Min Body Ground Clearance	0.366m
Track Width	2.450m
Lock to lock time	4.00s
Kerb to Kerb Turning Radius	9.500m

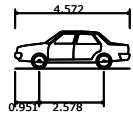

Car

Overall Length	4.572m
Overall Width	1.769m
Overall Body Height	1.488m
Min Body Ground Clearance	0.249m
Max Track Width	1.713m
Lock to lock time	4.00s
Kerb to Kerb Turning Radius	5.100m

KEY:

- TRANSCRIBED REDLINE BOUNDARY
- HIGHWAY BOUNDARY TRANSCRIBED FROM ECC RECORDS
- ASSUMED HIGHWAY LAND TRANSCRIBED FROM OS MAPPING
- EXISTING PROW

A	VISIBILITY SPLAYS UPDATED	DV	DV	IW	10.03.22
Rev	Description	Drn	Chk	App	Date

ARDENT CONSULTING ENGINEERS

Third Floor
The Hallmark Building
52-56 Leadenhall Street
London
EC3M 5JE

Tel: 020 7680 4088
E-mail: enquiries@ardent-ce.co.uk

Client
COUNTRYSIDE PROPERTIES LTD

Project Title:
LAND SOUTH OF HENHAM ROAD, ELSHAM

Drawing Title:
HENHAM ROAD PROPOSED SITE ACCESS

A3 Scale	Date	Designed by
1:500	15.04.21	BT
Drawn by	Checked by	Approved by
BT	DV	IW

Drawing Number **2008170-008** Rev **A**

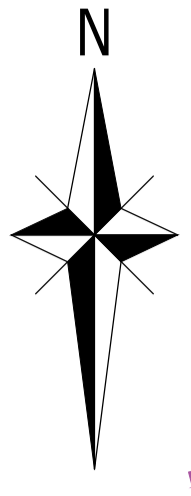

SEE DRAWING 2008170-008A FOR PROPOSED ACCESS

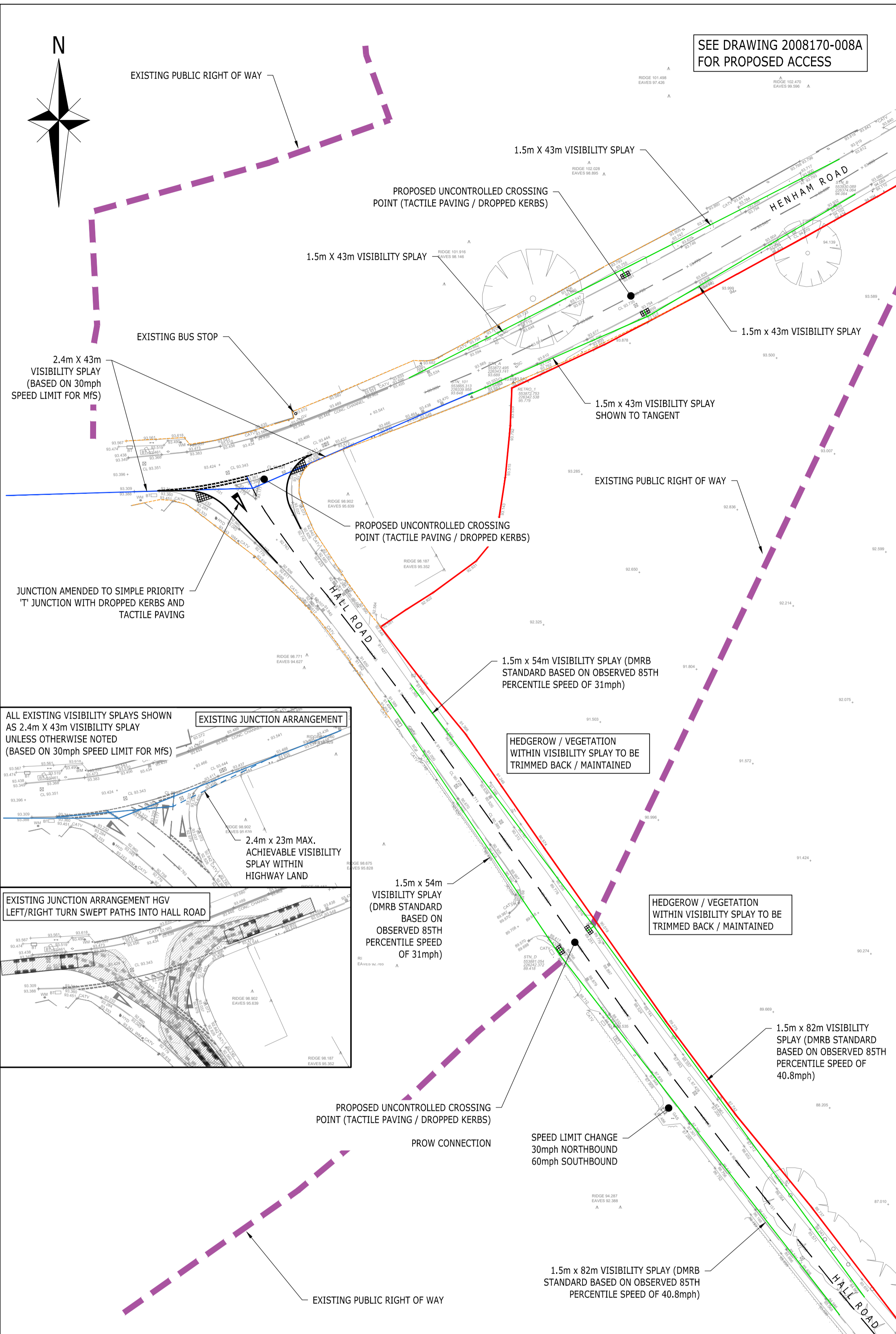

NOTES:
 UNCONTROLLED CROSSING POINT CONSISTS OF DROPPED KERB AND TACTILE PAVING
 FOR FOOTWAY CONNECTIONS ON HALL ROAD THE GRADIENT SHOULD NOT EXCEED 1 IN 12, WHERE A 1 IN 20 GRADIENT IS PREFERRED
 DESIGN BASED ON TOPOGRAPHICAL SURVEY AND SUBJECT TO DETAIL DESIGN

- KEY:**
- TRANSCRIBED REDLINE BOUNDARY
 - HIGHWAY BOUNDARY TRANSCRIBED FROM ECC RECORDS
 - ASSUMED HIGHWAY LAND TRANSCRIBED FROM OS MAPPING
 - ASSUMED BACK OF HIGHWAY BASED ON TOPO SURVEY
 - EXISTING PROW

VEHICLES USED:

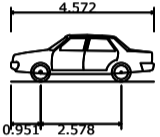
	Car	Overall Length	4.572m
		Overall Width	1.769m
		Overall Body Height	1.488m
		Min Body Ground Clearance	0.249m
		Max Track Width	1.713m
		Lock to lock time	4.00s
		Kerb to Kerb Turning Radius	5.100m

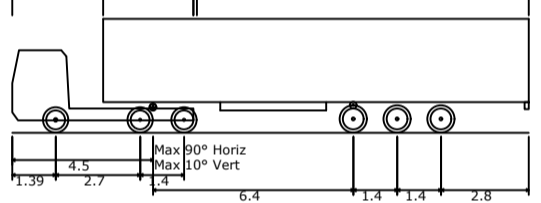
	Max Legal Articulated Vehicle (16.5m)	Overall Length	16.500m
		Overall Width	2.500m
		Overall Body Height	3.632m
		Min Body Ground Clearance	0.396m
		Max Track Width	2.500m
		Lock to lock time	6.00s
		Kerb to Kerb Turning Radius	6.870m

ALL EXISTING VISIBILITY SPLAYS SHOWN AS 2.4m X 43m VISIBILITY SPLAY UNLESS OTHERWISE NOTED (BASED ON 30mph SPEED LIMIT FOR MFS)

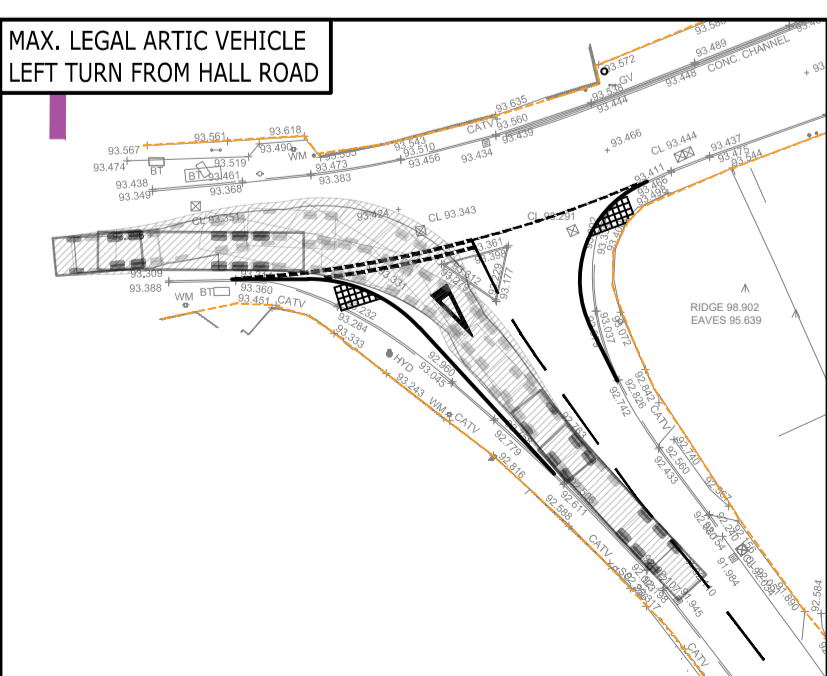
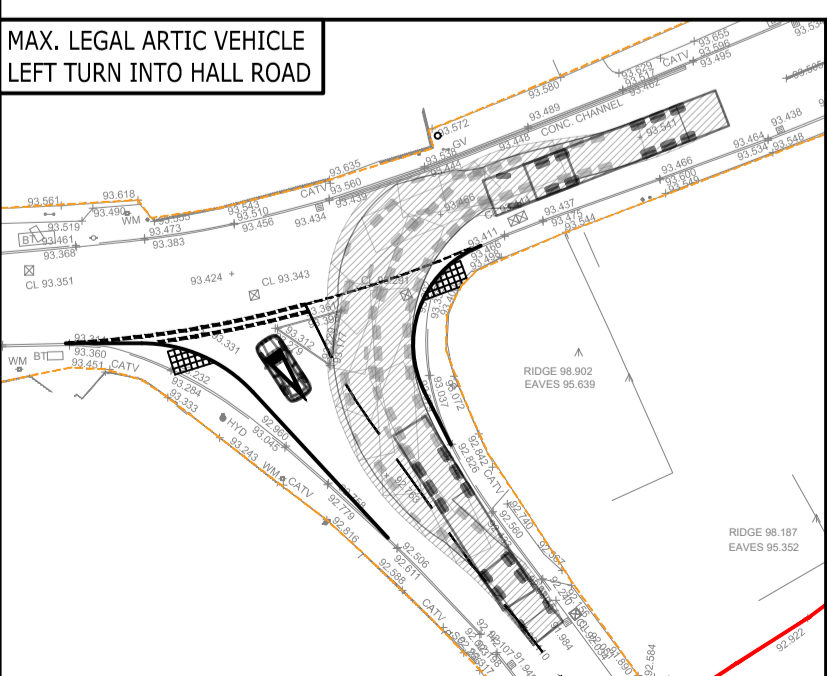
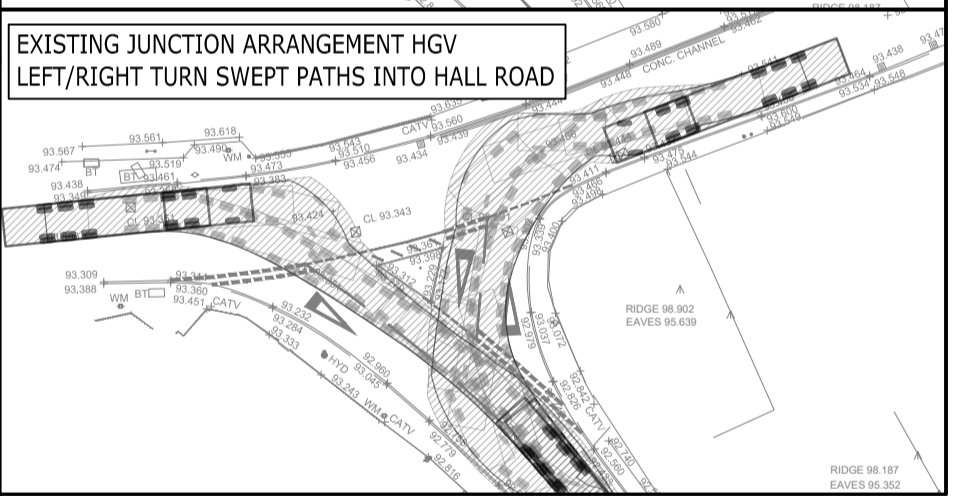
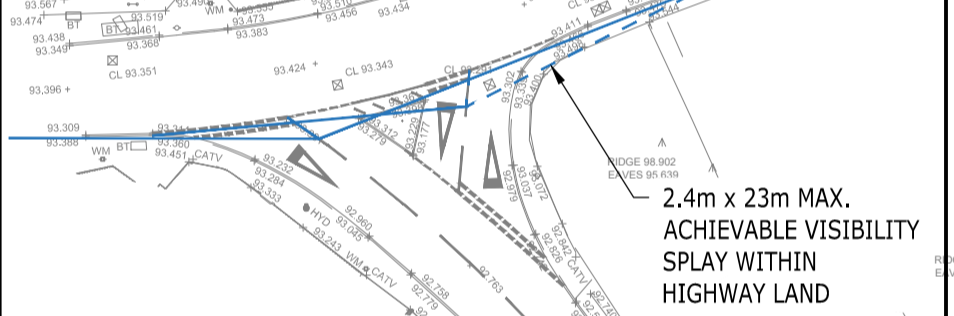

Rev	Description	Dm	Chk	App	Date

ARDENT CONSULTING ENGINEERS

Third Floor
The Hallmark Building
52-56 Leadenhall Street
London
EC3M 5JE
Tel: 020 7680 4088
E-mail: enquiries@ardent-ce.co.uk

worksafe
consultant

SSIP
SAFETY
SCHEDULED
BY
REGISTRATION

Client
COUNTRYSIDE PROPERTIES LTD

Project Title:
LAND SOUTH OF HENHAM ROAD, ELSENHAM

Drawing Title:
PROPOSED OFF SITE HIGHWAY WORKS

A2 Scale	Date	Designed by
1:500	23.06.22	DV
Drawn by	Checked by	Approved by
DV	FM	IW

Drawing Number 2008170-032 **Rev** -

Reproduced from/based upon Ordnance Survey material with the permission of the Controller of Her Majesty's Stationary Office. Crown Copyright Reserved. License No. 100044561



COOPERS END
ROUNDAABOUT

5.43m

4.08m

EXISTING SCENARIO

NOTES:

DESIGN SUBJECT TO LAND BOUNDARIES, HIGHWAY BOUNDARY, TOPOGRAPHICAL SURVEY, DETAIL DESIGN AND HIGHWAY APPROVAL.

KERB ALIGNMENTS SUBJECT TO LEVELS AND TREE SURVEY - STREET FURNITURE TO BE RELOCATED WHERE APPLICABLE.

KEY:

— PROPOSED KERB / ROAD MARKINGS

PROPOSED IMPROVEMENTS

DRAFT

COOPERS END
ROUNDAABOUT

6.50m

4.50m

35m RADIUS DEFLECTION

PROPOSED WIDENING TO ALLOW FOR 7m ENTRY WIDTH AND INCREASED FLARE LENGTH

PROPOSED WIDENING TO ALLOW FOR 7m ENTRY WIDTH AND INCREASED FLARE LENGTH

Rev	Description	Drn	Chk	App	Date
-----	-------------	-----	-----	-----	------

ARDENT CONSULTING ENGINEERS

Third Floor
The Hallmark Building
52-56 Leadenhall Street
London
EC3M 5JE

Tel: 020 7680 4088
E-mail: enquiries@ardent-ce.co.uk



Client
COUNTRYSIDE PROPERTIES LTD

Project Title:
LAND SOUTH OF HENHAM ROAD, ELSHAM

Drawing Title:
COOPERS END ROUNDAABOUT IMPROVEMENTS

A3 Scale	Date	Designed by
1:250	15.07.22	DV
Drawn by	Checked by	Approved by
DV	DV	IW

Drawing Number
2008170-033

Reproduced from/based upon Ordnance Survey material with the permission of the Controller of Her Majesty's Stationary Office. Crown Copyright Reserved. License No. 10004561

Appendix A

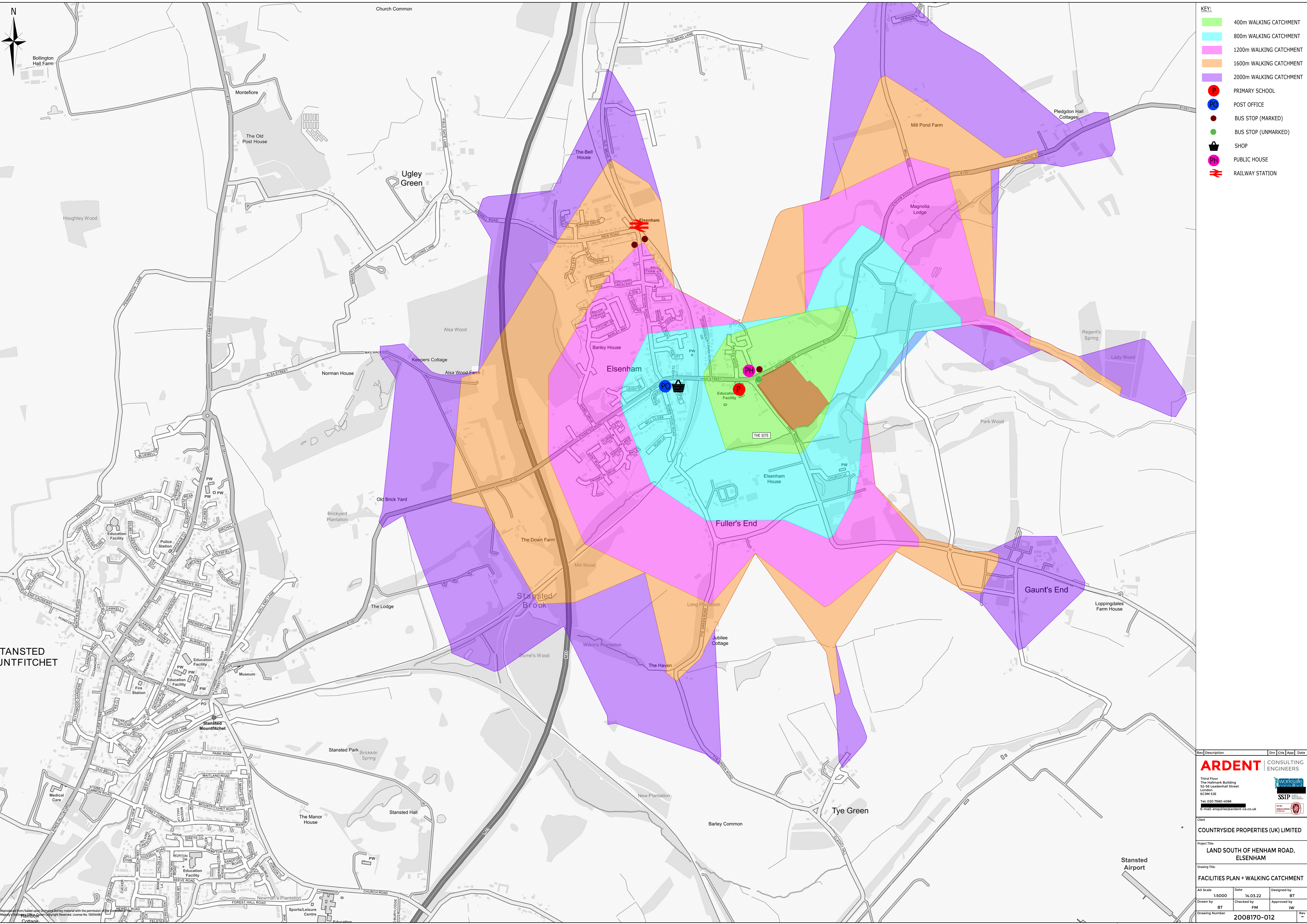

- KEY:**
- 400m WALKING CATCHMENT
 - 800m WALKING CATCHMENT
 - 1200m WALKING CATCHMENT
 - 1600m WALKING CATCHMENT
 - 2000m WALKING CATCHMENT
 - PRIMARY SCHOOL
 - POST OFFICE
 - BUS STOP (MARKED)
 - BUS STOP (UNMARKED)
 - SHOP
 - PUBLIC HOUSE
 - RAILWAY STATION

Rev	Description	Dim	Chk	App	Date

ARDENT CONSULTING ENGINEERS
 Third Floor
 The Holmark Building
 52-56 Leadenhall Street
 London
 EC3M 5JE
 Tel: 020 7680 4088
 E-mail: enquiries@ardent-ce.co.uk

Client:
COUNTRYSIDE PROPERTIES (UK) LIMITED

Project Title:
LAND SOUTH OF HENHAM ROAD, ELSENHAM

Drawing Title:
FACILITIES PLAN + WALKING CATCHMENT

AD Scale	Date	Designed by
1:5000	14.03.22	BT
Drawn by	Checked by	Approved by
BT	FM	IW
Drawing Number	Rev	
2008170-012		

Reproduced from/based upon Ordnance Survey material with the permission of the Controller of Her Majesty's Stationery Office. Copyright Reserved. License No. 10004488

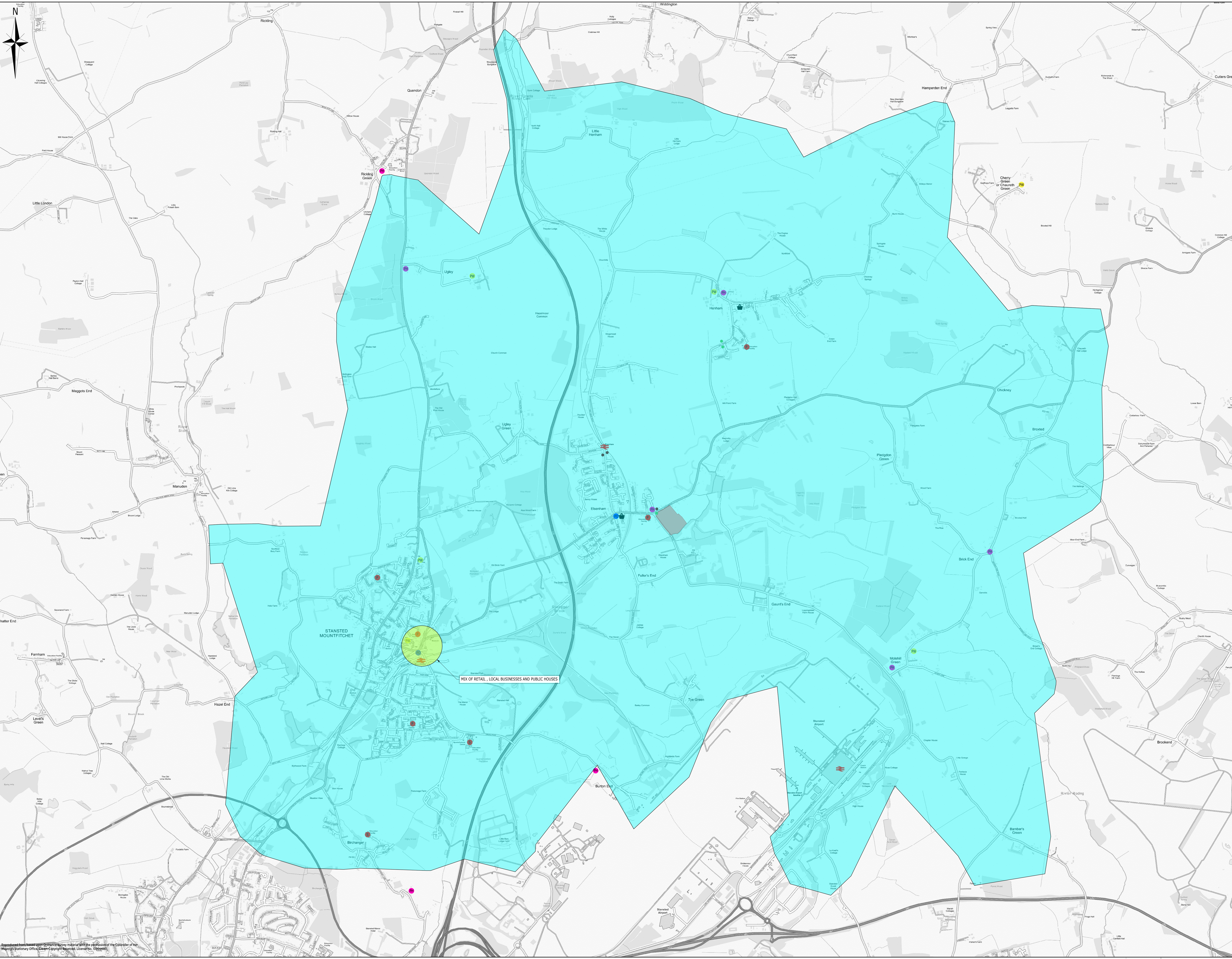
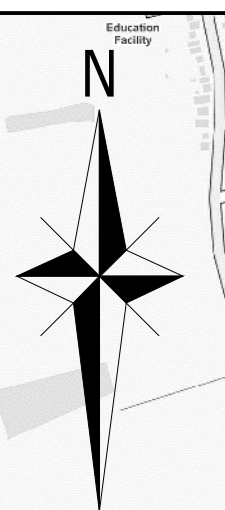

- KEY:**
- P PRIMARY SCHOOL
 - S SECONDARY SCHOOL
 - PW PLACE OF WORSHIP
 - PO POST OFFICE
 - BUS STOP (MARKED)
 - BUS STOP (UNMARKED)
 - SHOP
 - + MEDICAL CENTRE
 - PH PUBLIC HOUSE
 - RAILWAY STATION
 - 20 MINUTE CYCLE CATCHMENT

Rev	Description	Dim	Chk	App	Date
ARDENT CONSULTING ENGINEERS					
Third Floor The Helix Building 52-56 Leadenhall Street London EC3M 5JE Tel: 020 7680 4088 www.ardent-engineers.co.uk					
Client: COUNTRYSIDE PROPERTIES (UK) LIMITED					
Project Title: LAND SOUTH OF HENHAM ROAD, ELSENHAM					
Drawing Title: FACILITIES PLAN + CYCLE CATCHMENT					
A0 Scale	Date	Designed by	Designed by		
1:12000	14.03.22	BT	BT		
Drawn by	Checked by	Approved by	Approved by		
BT	FM	IW	IW		
Drawing Number	2008170-013				

Reproduced from Ordnance Survey data with the permission of the Controller of Her Majesty's Stationary Office. Crown Copyright Reserved. License No. 100049501