

Plan

Scale 1:10,000 @ A1

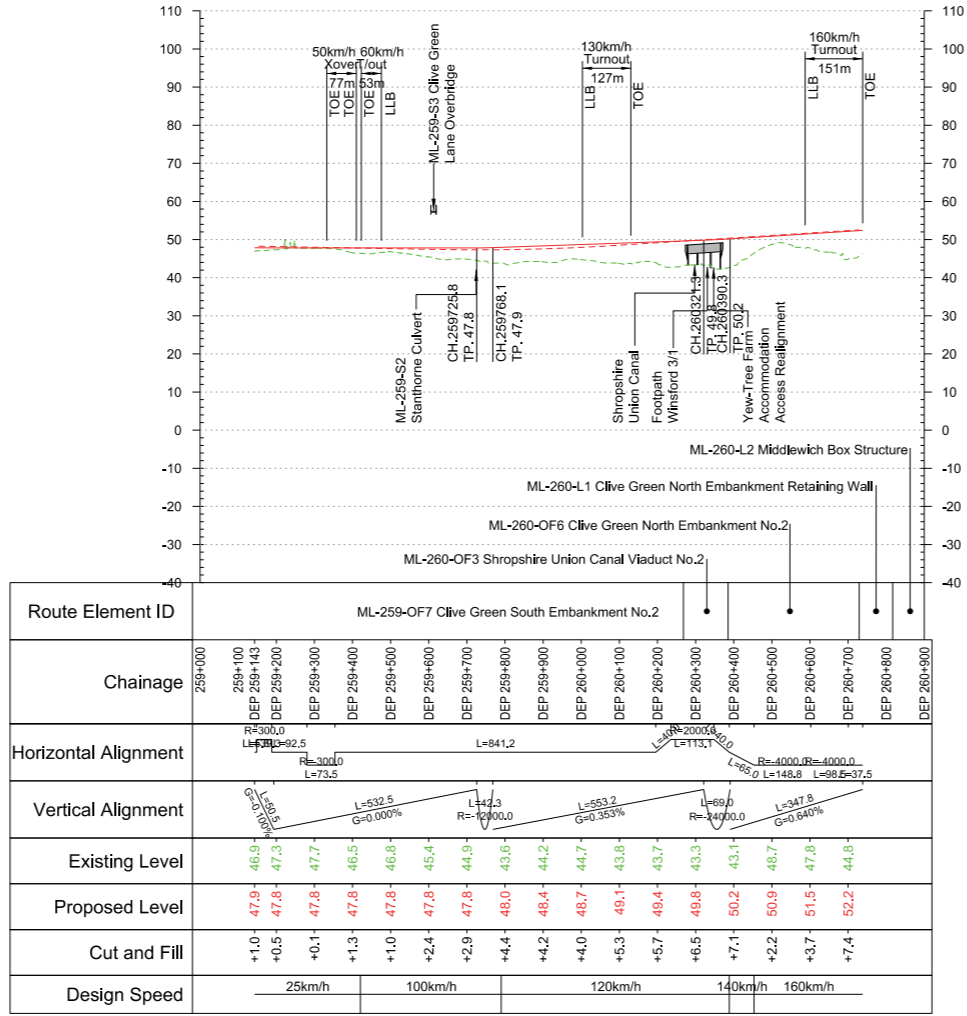

Route Element ID	ML-259-OF7 Clive Green South Embankment No.2																				
Chainage	259+000	259+100	259+143	259+200	259+300	259+400	259+500	259+600	259+700	259+800	259+900	260+000	260+100	260+200	260+300	260+400	260+500	260+600	260+700	260+800	260+900
Horizontal Alignment	$R=300.0$ $L=73.5$ $L=84.2$ $L=113.1$ $R=4000.0$ $L=4000.0$ $L=148.8$ $L=98.6$ $L=37.5$																				
Vertical Alignment	$L=307.0$ $G=0.000\%$ $L=532.5$ $G=0.000\%$ $L=47.3$ $R=1400.0$ $L=553.2$ $G=0.353\%$ $L=69.0$ $R=1400.0$ $L=247.8$ $G=0.040\%$																				
Existing Level	46.9	47.3	47.7	47.7	46.5	46.8	45.4	44.9	43.6	44.2	44.7	43.8	43.7	43.3	43.1	46.7	47.8	47.8	44.8	44.8	44.8
Proposed Level	47.9	47.8	47.8	47.8	47.8	47.8	47.8	47.8	48.0	48.4	48.7	48.1	48.4	48.8	50.2	50.9	51.5	51.5	52.2	52.2	52.2
Cut and Fill	+1.0	+0.5	+0.1	+1.3	+1.0	+2.4	+2.9	+4.4	+4.2	+4.0	+5.3	+5.7	+6.5	+7.1	+2.2	+3.7	+3.7	+7.4	+7.4	+7.4	+7.4
Design Speed	25km/h			100km/h			120km/h			140km/h			160km/h								

Profile

Scale H:1:10,000 V:1:1000 @ A1

This document is issued for the party which commissioned it and for specific purposes connected with the captioned project only. It should not be relied upon by any other party or used for any other purpose. We accept no responsibility for the consequences of this document being relied upon by any other party, or being used for any other purpose, or containing any error or omission which is due to an error or omission in data supplied to us by other parties.

P02	AP1 Second Issue	CMC	JSA	GHU	06/12/2021	06/12/2021	06/12/2021
P01	AP1 First Issue	MW	EMO	GHU	27/08/2021	27/08/2021	27/08/2021

HS2 accepts no responsibility for any circumstances which arise from the reproduction of this document after alteration, amendment or abbreviation or if it is issued in part or issued incompletely in any way.

© Crown Copyright and database right 2021. All rights reserved. Ordnance Survey Licence number: 100049190

© Crown Copyright material is reproduced with the permission of Land Registry under delegated authority from the Controller of HMSO.

This material was last updated on 2021 and may not be copied, distributed, sold or published without the formal permission of Land Registry. Only an official copy of a title plan or register obtained from the Land Registry may be used for legal or other official purposes.

Scale with caution as distortion can occur.

**Legends/Notes:**

- Depot, station, headhouse, shaft or portal building
- Tunnel portal
- Railway system site
- Ecological mitigation pond
- Balancing pond
- Pumping station
- Replacement floodplain storage area
- Woodland habitat creation
- Wetland habitat creation
- Grassland habitat creation
- Landscape mitigation planting (scrub / woodland)
- Grassed areas
- Local placement
- Public realm
- Engineering earthworks
- Landscape earthworks
- Rail alignment formation
- Returned to suitable development use
- County boundary
- Borough / District boundary
- Major contour
- Community area boundary
- Existing watercourse
- Watercourse diversions
- New Ditches
- Hedge row
- Major utility works
- Noise fence barrier
- Car Park
- Existing public right of way
- New, diverted or realigned public right of way
- Public right of way closure
- Tunnels external extent
- HS2 access
- Realigned highway
- Light Rail Transit
- Rail alignment
- Chainage (e.g. 10+000)

Registered in England  
 Registration No. 06791686  
 Registered office:  
 2 Snow Hill, Queensway,  
 Birmingham, B4 6GA

Creator/Originator  
 MW JV (Mott MacDonald and WSP Joint Venture)

Zone	M2 Wide – Hough to Bamfurlong	Project/Contract	2DE01 Hybrid Bill Additional Provision 1 AP1		
Design Stage	Hybrid Bill - Interim Preliminary Design AP1	Discipline/Function	Civil		
Drawing Title	M2 Crewe North Rolling Stock Depot	Drawn	CCL	Checked	EMO
	Depot Down (Departures) Alignment Plan & Profile	Date	27/08/2021	Scale	AS SHOWN
	Chainage 259+300 to 260+900	Drawing No.	2PT24-MWJ-CV-DPP-M002-220532		Rev.
					P02

**Fit for Acceptance**