

Electricity Act 1989  
Town and Country Planning Act 1990

Certified to be Drawing Number: UKP/STC/0107/C referred to in the consent dated 23 June 2022 given by the Secretary of State for Business, Energy and Industrial Strategy to RWE Generation Plc for the continued operation of a combined cycle gas turbine generating station at Staythorpe, Nottinghamshire.

Signed: 

Department of Business, Energy and Industrial Strategy

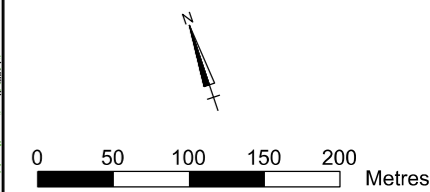

Key:  
 SECTION 36 BOUNDARY

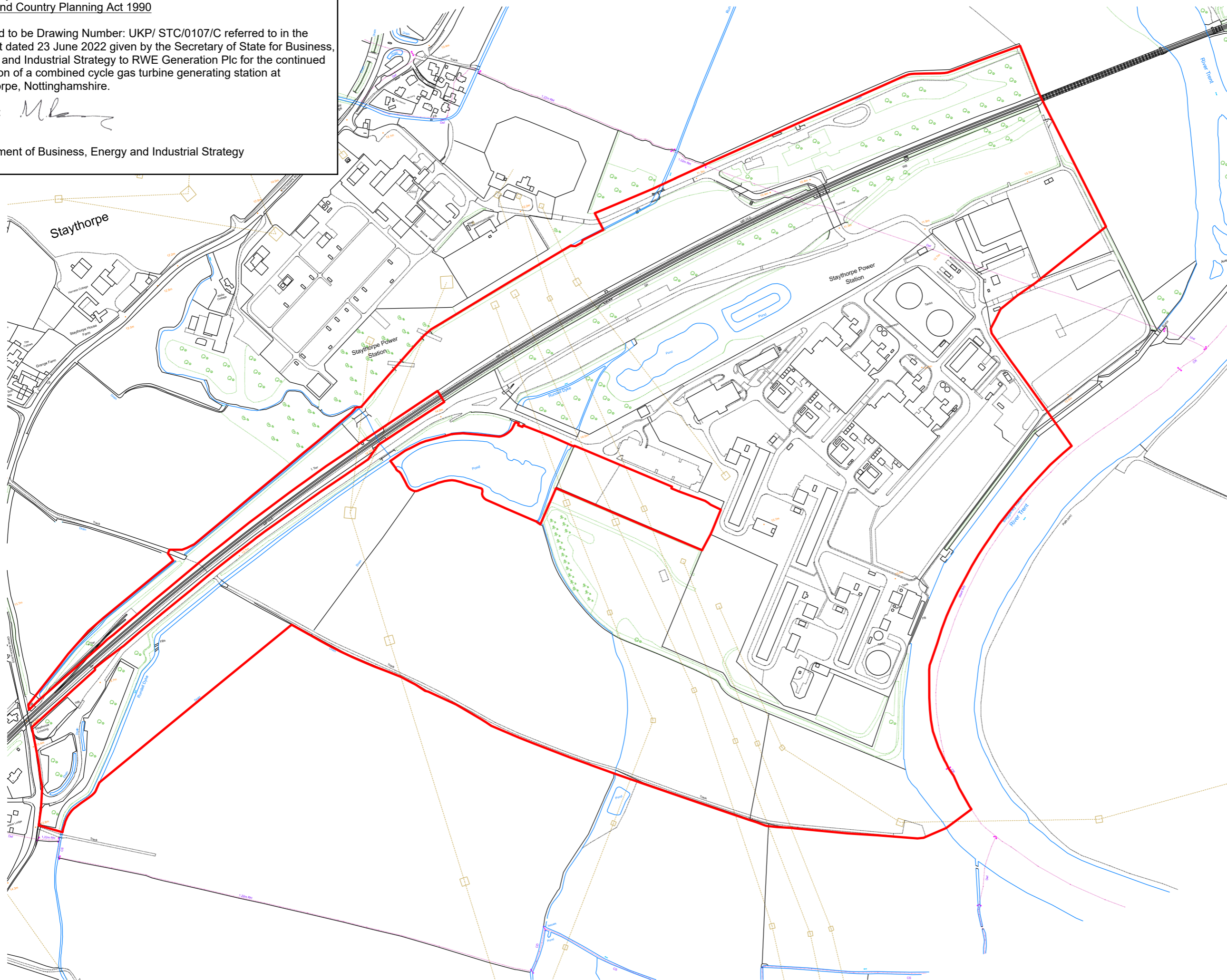

JGB	CM	03.02.21	CM	C
Drawn	Checked	Date	Approved	Rev.

THE PERSON NAMED IN THE 'APPROVED BY' BOX HOLDS RESPONSIBILITY FOR THE TECHNICAL CONTENT OF THIS DRAWING AND SHOULD BE CONSULTED PRIOR TO REQUESTING MODIFICATION.

O.S. Data reproduced by permission of Ordnance Survey on behalf of HMSO © Crown copyright and database right 2021 All rights reserved. Ordnance Survey Licence no. 0100031673

**RWE**  
Geospatial Graphics E: james.bean@rwe.com  
RWE Generation UK plc  
Electron - E12  
Windmill Hill Business Park  
Swindon  
SN5 6PB

Size of original	Scale of original
A3	1:5000

Site  
**STAYTHORPE POWER STATION**

Title  
**SECTION 36 BOUNDARY**

Status  
**APPROVED**

Drawing number  
**UKP/STC/0107/C**