

# Notice of variation and consolidation with introductory note

The Environmental Permitting (England & Wales) Regulations 2016

---

ForFarmers UK Limited  
Radstock Animal Feed Mill  
Mill Road  
Radstock  
Bath  
Somerset  
BA3 5TT

**Variation application number**

EPR/QP3338SV/V005

**Permit number**

EPR/QP3338SV

# Radstock Animal Feed Mill

## Permit number EPR/QP3338SV

### Introductory note

#### **This introductory note does not form a part of the notice**

Under the Environmental Permitting (England & Wales) Regulations 2016 (schedule 5, part 1, paragraph 19) a variation may comprise a consolidated permit reflecting the variations and a notice specifying the variations included in that consolidated permit.

Schedule 1 of the notice specifies the conditions that have been varied and schedule 2 comprises a consolidated permit which reflects the variations being made. All the conditions of the permit have been varied and are subject to the right of appeal.

This consolidated permit has been issued following a full review against the best available techniques (BAT) conclusions for the Food, Drink and Milk Industries published on 4<sup>th</sup> December 2019 in the official journal of the European Union.

We have implemented the requirements of the Medium Combustion Plant directive, and incorporated post-dated requirements for 2030.

The schedules specify the changes made to the permit.

Radstock Feed Mill manufactures compound animal and poultry feeds, which are suitable for consumption without further processing. The products manufactured are based upon a core recipe of cereals (such as wheat and barley) and other natural ingredients (such as soya, rapeseed and sugar beet), plus specific additives, such as mineral supplements and a small proportion of medicants before being coated with fats to produce the final product.

The key stages of the processing are raw material intake, weighing, grinding, mixing, conditioning, pressing, cooling and coating. The required feed materials, additives and minerals are weighed prior to grinding to a uniform grist size. The ground material is then transferred to the mixing stage of the process. Following this, the mix is conditioned through addition of steam and molasses. After conditioning, the hot mix is extruded through dies to produce pellets, nuts and rolls. The hot products are passed through a cooler causing them to harden. At this stage approximately 5% of the product is crumbed to produce feed for chickens. The remaining pellets are subsequently coated in fat to complete the finished product.

The majority of the finished product is stored in bulk in bins or tote bins, located within the main process building, prior to dispatch. The bins are filled with high level alarms to prevent over filling. The remaining product is stored in 20/25Kg bags, bags are stored on pallets in the warehouse prior to dispatch.

The Environmental Permit is for the main listed activity falling under Section 6.8 Part A(1)(d)(iii)(bb) of the Environmental Permitting Regulations: Treatment and processing, other than exclusively packaging, of the following raw materials, whether previously processed or unprocessed, intended for the production of food or feed (where the weight of the finished product excludes packaging)—

(iii) animal and vegetable raw materials (other than milk only), both in combined and separate products, with a finished product production capacity in tonnes per day greater than—

(bb) 300-(22.5 x A) in any other case,

where 'A' is the portion of animal material in percent of weight of the finished product production capacity

The main emissions to air arise from the three pellet coolers (A1 - A3) and two grinders (A4 and A5). The site also has two boilers to produce steam used in the process a 1.5 MWth natural gas fired boiler and a 1.5 MWth kerosene fired boiler. Both boilers are considered existing medium combustion plant and the associated limits for oxides of nitrogen (NOx) have been added to the permit and will come into effect from 01/01/2030 unless

the boilers are replaced. Additional emission points also serve the installation; mainly to enable safe operations, such as tank breathing and dust relief vents.

The main emissions to water arise from the discharge of uncontaminated site drainage arising from roof run-off and yard surfaces to the Wellow Brook. Discharges via W1 and W4 are via a three-stage interceptor as the discharges from these areas cover the raw material intake area and the warehouse respectively. The run-off from the vehicle wash is discharged to foul sewer (S1) via a two-stage interceptor and discharges of boiler blow down and compressor oil/water separator effluent is discharged to foul sewer via S2.

The installation is located on the Mill Road Industrial Estate outside the town of Radstock, Bath and is centred at National Grid Reference ST 69807 55132. The immediate surrounding area comprises mainly of commercial and industrial premises.

Mells Valley, Bath & Bradford-on-Avon Bats and Mendip Woodlands are all designated Special Areas of Conservation are located within 10Km of the installation. The following Sites of Special Scientific Interest are located within 2Km of the installation, Kilmersdon Road Quarry, Huish Colliery Quarry, Writhlington and Fox Hills.

The installation operates under a documented Environmental Management System, which is certified as conforming to ISO 14001, and includes an Energy Management System which is ISO 50001 certified.

The status log of a permit sets out the permitting history, including any changes to the permit reference number.

<b>Status log of the permit</b>		
<b>Description</b>	<b>Date</b>	<b>Comments</b>
Application received EPR/QP3338SV/A001	Duly made 15/04/2005	Application for a new Feed Mill.
Request to extend determination	27/07/2005	Request accepted 01/08/2005.
Request for further information	26/09/2005	Response received 21/10/2005.
Request to extend determination	29/09/2005	Request accepted 30/09/2005.
Permit determined EPR/QP3338SV/A001	05/12/2005	Permit issued to BOCM Pauls Limited.
Notified of change of company name	08/12/2014	Name changed to ForFarmers UK Limited – change effective from 03/03/2015.
Variation issued EPR/QP3338SV/V002	26/03/2015	Varied permit issued to ForFarmers UK Limited.
Notified of change of registered office address	Duly made 28/04/2017	Registered office address changed to Horizon House, Fred Castle Way, Rougham Industrial Estate, Rougham, Bury St. Edmunds, IP30 9ND.
Variation issued EPR/QP3338SV/V003	09/05/2017	Varied permit issued to ForFarmers UK Limited.
Application variation EPR/QP3338SV/V004	Duly made 21/07/2017	Application to update emission points on site plan and amend emission limit for emission point A2.
Response to Schedule 5 dated 14/09/2017	10/11/2017	Provision of additional information for emission point S1 and amended site plan.
Variation issued EPR/QP3338SV/V004	11/01/2018	Varied permit issued to ForFarmers UK Limited
Application EPR/QP3338SV/V005 (variation and consolidation)	Regulation 61 Notice response received 14/07/2021	Environment Agency initiated variation and consolidation following the Food, Drink & Milk Industries sector permit review.

<b>Status log of the permit</b>		
<b>Description</b>	<b>Date</b>	<b>Comments</b>
Request for further information dated 02/02/2021	09/02/2022	Confirmation of the proportion of animal derived raw material used in the production of the animal feed.
	18/02/2022	Baseline Assessment Tool
Variation determined and consolidation issued EPR/QP3338SV (Billing ref. BP3208MN).	06/04/2022	Varied and consolidated permit issued in modern format

End of introductory note.

# Notice of variation and consolidation

## The Environmental Permitting (England and Wales) Regulations 2016

The Environment Agency in exercise of its powers under regulation 20 of the Environmental Permitting (England and Wales) Regulations 2016 varies

### Permit number

EPR/QP3338SV

### Issued to

**ForFarmers UK Limited** (“the operator”)

whose registered office is

**Horizon House  
Fred Castle Way  
Rougham Industrial Estate  
Rougham  
Bury St. Edmunds  
IP30 9ND**

company registration number 00062904

to operate a regulated facility at

**Radstock Animal Feed Mill  
Mill Road  
Radstock  
Bath  
Somerset  
BA3 5TT**

to the extent set out in the schedules.

The notice shall take effect from 06/04/2022.

Name	Date
<b>Samantha Haddock</b>	<b>06/04/2022</b>

Authorised on behalf of the Environment Agency

## **Schedule 1**

All conditions have been varied by the consolidated permit as a result of an Environment Agency initiated variation.

## **Schedule 2 – consolidated permit**

Consolidated permit issued as a separate document.

# Permit

## The Environmental Permitting (England and Wales) Regulations 2016

### Permit number

**EPR/QP3338SV**

This is the consolidated permit referred to in the variation and consolidation notice for application EPR/QP3338SV/V005 authorising,

**ForFarmers UK Limited** (“the operator”),

whose registered office is

**Horizon House  
Fred Castle Way  
Rougham Industrial Estate  
Rougham  
Bury St. Edmunds  
IP30 9ND**

company registration number **00062904**

to operate an installation at

**Radstock Animal Feed Mill  
Mill Road  
Radstock  
Bath  
Somerset  
BA3 5TT**

to the extent authorised by and subject to the conditions of this permit.

Name	Date
<b>Samantha Haddock</b>	<b>06/04/2022</b>

Authorised on behalf of the Environment Agency

# Conditions

## 1 Management

### 1.1 General management

1.1.1 The operator shall manage and operate the activities:

- (a) in accordance with a written management system that identifies and minimises risks of pollution, including those arising from operations, maintenance, accidents, incidents, non-conformances, closure and those drawn to the attention of the operator as a result of complaints; and
- (b) using sufficient competent persons and resources.

1.1.2 Records demonstrating compliance with condition 1.1.1 shall be maintained.

1.1.3 Any person having duties that are or may be affected by the matters set out in this permit shall have convenient access to a copy of it kept at or near the place where those duties are carried out.

### 1.2 Energy efficiency

1.2.1 The operator shall:

- (a) take appropriate measures to ensure that energy is used efficiently in the activities;
- (b) review and record at least every four years whether there are suitable opportunities to improve the energy efficiency of the activities; and
- (c) take any further appropriate measures identified by a review.

### 1.3 Efficient use of raw materials

1.3.1 The operator shall:

- (a) take appropriate measures to ensure that raw materials and water are used efficiently in the activities;
- (b) maintain records of raw materials and water used in the activities;
- (c) review and record at least every four years whether there are suitable alternative materials that could reduce environmental impact or opportunities to improve the efficiency of raw material and water use; and
- (d) take any further appropriate measures identified by a review.

### 1.4 Avoidance, recovery and disposal of wastes produced by the activities

1.4.1 The operator shall take appropriate measures to ensure that:

- (a) the waste hierarchy referred to in Article 4 of the Waste Framework Directive is applied to the generation of waste by the activities; and
- (b) any waste generated by the activities is treated in accordance with the waste hierarchy referred to in Article 4 of the Waste Framework Directive; and
- (c) where disposal is necessary, this is undertaken in a manner which minimises its impact on the environment.

1.4.2 The operator shall review and record at least every four years whether changes to those measures should be made and take any further appropriate measures identified by a review.



## **2 Operations**

### **2.1 Permitted activities**

2.1.1 The operator is only authorised to carry out the activities specified in schedule 1 table S1.1 (the “activities”).

### **2.2 The site**

2.2.1 The activities shall not extend beyond the site, being the land shown edged in green on the site plan at schedule 7 to this permit.

### **2.3 Operating techniques**

2.3.1 The activities shall, subject to the conditions of this permit, be operated using the techniques and in the manner described in the documentation specified in schedule 1, table S1.2, unless otherwise agreed in writing by the Environment Agency.

2.3.2 If notified by the Environment Agency that the activities are giving rise to pollution, the operator shall submit to the Environment Agency for approval within the period specified, a revision of any plan or other documentation (“plan”) specified in schedule 1, table S1.2 or otherwise required under this permit which identifies and minimises the risks of pollution relevant to that plan, and shall implement the approved revised plan in place of the original from the date of approval, unless otherwise agreed in writing by the Environment Agency.

2.3.3 Any raw materials or fuels listed in schedule 2 table S2.1 shall conform to the specifications set out in that table.

2.3.4 The operator shall ensure that where waste produced by the activities is sent to a relevant waste operation, that operation is provided with the following information, prior to the receipt of the waste:

- (a) the nature of the process producing the waste;
- (b) the composition of the waste;
- (c) the handling requirements of the waste;
- (d) the hazardous property associated with the waste, if applicable; and
- (e) the waste code of the waste.

2.3.5 The operator shall ensure that where waste produced by the activities is sent to a landfill site, it meets the waste acceptance criteria for that landfill.

### **2.4 Improvement programme**

2.4.1 The operator shall complete the improvements specified in schedule 1 table S1.3 by the date specified in that table unless otherwise agreed in writing by the Environment Agency.

2.4.2 Except in the case of an improvement which consists only of a submission to the Environment Agency, the operator shall notify the Environment Agency within 14 days of completion of each improvement.

## **3 Emissions and monitoring**

### **3.1 Emissions to water, air or land**

3.1.1 There shall be no point source emissions to water, air or land except from the sources and emission points listed in schedule 3 tables S3.1, S3.2 and S3.3.

- 3.1.2 The limits given in schedule 3 shall not be exceeded.
- 3.1.3 Periodic monitoring shall be carried out at least once every 5 years for groundwater and 10 years for soil, unless such monitoring is based on a systematic appraisal of the risk of contamination.
- 3.1.4 For the following activities referenced in schedule 1, table S1.1 (AR2); the first monitoring measurements shall be carried out within four months of 01/01/2030 or of the date when the MCP is first put into operation, whichever is later.

## **3.2 Emissions of substances not controlled by emission limits**

- 3.2.1 Emissions of substances not controlled by emission limits (excluding odour) shall not cause pollution. The operator shall not be taken to have breached this condition if appropriate measures, including, but not limited to, those specified in any approved emissions management plan, have been taken to prevent or where that is not practicable, to minimise, those emissions.
- 3.2.2 The operator shall:
- (a) if notified by the Environment Agency that the activities are giving rise to pollution, submit to the Environment Agency for approval within the period specified, an emissions management plan which identifies and minimises the risks of pollution from emissions of substances not controlled by emission limits;
  - (b) implement the approved emissions management plan, from the date of approval, unless otherwise agreed in writing by the Environment Agency.
- 3.2.3 All liquids in containers, whose emission to water or land could cause pollution, shall be provided with secondary containment, unless the operator has used other appropriate measures to prevent or where that is not practicable, to minimise, leakage and spillage from the primary container.

## **3.3 Odour**

- 3.3.1 Emissions from the activities shall be free from odour at levels likely to cause pollution outside the site, as perceived by an authorised officer of the Environment Agency, unless the operator has used appropriate measures, including, but not limited to, those specified in any approved odour management plan, to prevent or where that is not practicable to minimise the odour.
- 3.3.2 The operator shall:
- (a) if notified by the Environment Agency that the activities are giving rise to pollution outside the site due to odour, submit to the Environment Agency for approval within the period specified, an odour management plan which identifies and minimises the risks of pollution from odour;
  - (b) implement the approved odour management plan, from the date of approval, unless otherwise agreed in writing by the Environment Agency.

## **3.4 Noise and vibration**

- 3.4.1 Emissions from the activities shall be free from noise and vibration at levels likely to cause pollution outside the site, as perceived by an authorised officer of the Environment Agency, unless the operator has used appropriate measures, including, but not limited to, those specified in any approved noise and vibration management plan to prevent or where that is not practicable to minimise the noise and vibration.

## **3.5 Monitoring**

- 3.5.1 The operator shall, unless otherwise agreed in writing by the Environment Agency, undertake the monitoring specified in the following tables in schedule 3 to this permit:
- (a) point source emissions specified in tables S3.1, S3.2 and S3.3.

- 3.5.2 The operator shall maintain records of all monitoring required by this permit including records of the taking and analysis of samples, instrument measurements (periodic and continual), calibrations, examinations, tests and surveys and any assessment or evaluation made on the basis of such data.
- 3.5.3 Monitoring equipment, techniques, personnel and organisations employed for the emissions monitoring programme and the environmental or other monitoring specified in condition 3.5.1 shall have either MCERTS certification or MCERTS accreditation (as appropriate), where available, unless otherwise agreed in writing by the Environment Agency.
- 3.5.4 Permanent means of access shall be provided to enable sampling/monitoring to be carried out in relation to the emission points specified in schedule 3 tables S3.1, S3.2 and S3.3 unless otherwise agreed in writing by the Environment Agency.

## **3.6 Pests**

- 3.6.1 The activities shall not give rise to the presence of pests which are likely to cause pollution, hazard or annoyance outside the boundary of the site. The operator shall not be taken to have breached this condition if appropriate measures, including, but not limited to, those specified in any approved pests management plan, have been taken to prevent or where that is not practicable, to minimise the presence of pests on the site.
- 3.6.2 The operator shall:
- (a) if notified by the Environment Agency, submit to the Environment Agency for approval within the period specified, a pests management plan which identifies and minimises risks of pollution from pests;
  - (b) implement the pests management plan, from the date of approval, unless otherwise agreed in writing by the Environment Agency.

# **4 Information**

## **4.1 Records**

- 4.1.1 All records required to be made by this permit shall:
- (a) be legible;
  - (b) be made as soon as reasonably practicable;
  - (c) if amended, be amended in such a way that the original and any subsequent amendments remain legible, or are capable of retrieval; and
  - (d) be retained, unless otherwise agreed in writing by the Environment Agency, for at least 6 years from the date when the records were made, or in the case of the following records until permit surrender:
    - (i) off-site environmental effects; and
    - (ii) matters which affect the condition of the land and groundwater.
- 4.1.2 The operator shall keep on site all records, plans and the management system required to be maintained by this permit, unless otherwise agreed in writing by the Environment Agency.

## **4.2 Reporting**

- 4.2.1 The operator shall send all reports and notifications required by the permit to the Environment Agency using the contact details supplied in writing by the Environment Agency.

- 4.2.2 A report or reports on the performance of the activities over the previous year shall be submitted to the Environment Agency by 31 January (or other date agreed in writing by the Environment Agency) each year. The report(s) shall include as a minimum:
- (a) a review of the results of the monitoring and assessment carried out in accordance with the permit including an interpretive review of that data;
  - (b) the annual production/treatment data set out in schedule 4 table S4.2; and
  - (c) the performance parameters set out in schedule 4 table S4.3 using the forms specified in table S4.4 of that schedule.
- 4.2.3 Within 28 days of the end of the reporting period the operator shall, unless otherwise agreed in writing by the Environment Agency, submit reports of the monitoring and assessment carried out in accordance with the conditions of this permit, as follows:
- (a) in respect of the parameters and emission points specified in schedule 4 table S4.1;
  - (b) for the reporting periods specified in schedule 4 table S4.1 and using the forms specified in schedule 4 table S4.4; and
  - (c) giving the information from such results and assessments as may be required by the forms specified in those tables.
- 4.2.4 The operator shall, unless notice under this condition has been served within the preceding four years, submit to the Environment Agency, within six months of receipt of a written notice, a report assessing whether there are other appropriate measures that could be taken to prevent, or where that is not practicable, to minimise pollution.

## 4.3 Notifications

- 4.3.1 In the event:
- (a) that the operation of the activities gives rise to an incident or accident which significantly affects or may significantly affect the environment, the operator must immediately—
    - (i) inform the Environment Agency,
    - (ii) take the measures necessary to limit the environmental consequences of such an incident or accident, and
    - (iii) take the measures necessary to prevent further possible incidents or accidents;
  - (b) of a breach of any permit condition the operator must immediately—
    - (i) inform the Environment Agency, and
    - (ii) take the measures necessary to ensure that compliance is restored within the shortest possible time;
  - (c) of a breach of permit condition which poses an immediate danger to human health or threatens to cause an immediate significant adverse effect on the environment, the operator must immediately suspend the operation of the activities or the relevant part of it until compliance with the permit conditions has been restored.
- 4.3.2 Any information provided under condition 4.3.1 shall be confirmed by sending the information listed in schedule 5 to this permit within the time period specified in that schedule.
- 4.3.3 Where the Environment Agency has requested in writing that it shall be notified when the operator is to undertake monitoring and/or spot sampling, the operator shall inform the Environment Agency when the relevant monitoring and/or spot sampling is to take place. The operator shall provide this information to the Environment Agency at least 14 days before the date the monitoring is to be undertaken.

4.3.4 The Environment Agency shall be notified within 14 days of the occurrence of the following matters, except where such disclosure is prohibited by Stock Exchange rules:

Where the operator is a registered company:

- (a) any change in the operator's trading name, registered name or registered office address; and
- (b) any steps taken with a view to the operator going into administration, entering into a company voluntary arrangement or being wound up.

Where the operator is a corporate body other than a registered company:

- (a) any change in the operator's name or address; and
- (b) any steps taken with a view to the dissolution of the operator.

4.3.5 Where the operator proposes to make a change in the nature or functioning, or an extension of the activities, which may have consequences for the environment and the change is not otherwise the subject of an application for approval under the Regulations or this permit:

- (a) the Environment Agency shall be notified at least 14 days before making the change; and
- (b) the notification shall contain a description of the proposed change in operation.

4.3.6 The Environment Agency shall be given at least 14 days' notice before implementation of any part of the site closure plan.

4.3.7 Where the operator has entered into a climate change agreement with the Government, the Environment Agency shall be notified within one month of:

- (a) a decision by the Secretary of State not to re-certify the agreement;
- (b) a decision by either the operator or the Secretary of State to terminate the agreement; and
- (c) any subsequent decision by the Secretary of State to re-certify such an agreement.

## **4.4 Interpretation**

4.4.1 In this permit the expressions listed in schedule 6 shall have the meaning given in that schedule.

4.4.2 In this permit references to reports and notifications mean written reports and notifications, except where reference is made to notification being made "immediately", in which case it may be provided by telephone.

# Schedule 1 – Operations

<b>Table S1.1 activities</b>			
<b>Activity reference</b>	<b>Activity listed in Schedule 1 of the EP Regulations</b>	<b>Description of specified activity</b>	<b>Limits of specified activity</b>
AR1	S6.8 A1(d)(iii)(bb)	Treatment and processing, of animal and vegetable raw materials (other than milk only) with a finished product production capacity in tonnes per day greater than 297.8 tonnes per day.	From receipt of raw materials through to dispatch of final product. Production capacity is limited to 792 tonnes per day.
<b>Directly Associated Activity</b>			
AR2	Steam supply	Medium Combustion plants: 1.5 MWth natural gas-fired boiler and 1.5 MWth kerosene fired boiler.	From receipt of fuel to release of products of combustion to air.
AR3	Storage and use of chemicals and oils	Storage and use of chemicals and oils at the installation.	From receipt of chemicals and oils to disposal of wastes arising.
AR4	Waste storage and handling	Storage and handling of waste materials	From generation of waste to storage pending removal for disposal or recovery.
AR5	Vehicle washing	Provision of vehicle washing facilities	From operation of vehicle wash facilities to discharge of wash waters to sewer
AR6	Surface water drainage	Collection of uncontaminated site surface waters	Handling and storage of site drainage until discharge to Wellow Brook

<b>Table S1.2 Operating techniques</b>		
<b>Description</b>	<b>Parts</b>	<b>Date Received</b>
Original permit application	The response to questions 2.1 and 2.2 given in pages 19 to 67 of the application	15/04/2005
Response to Request for Further Information	The response dated 21/10/2005 to the Request for Further Information email of 26/09/2005	24/10/2005
Additional Information	Noise Management Plan	August 2016
Regulation 61 Notice responses and supporting information	All parts	Received 14/07/2021
Regulation 61(1) Notice – request for further information dated 02/02/2022	Further Information regarding <ul style="list-style-type: none"> <li>The percentage of animal derived product used in the production of animal feed</li> </ul>	Received 09/02/2022
Regulation 61(1) Notice – request for further information dated 07/02/2022	Further Information regarding <ul style="list-style-type: none"> <li>Baseline Assessment</li> </ul>	Received 18/02/2022

<b>Table S1.3 Improvement programme requirements</b>		
<b>Reference</b>	<b>Requirement</b>	<b>Date</b>
IC9	<p>The operator shall submit, for approval by the Environment Agency, a report setting out progress to achieving the Best Available Techniques Conclusion Associated Emission Levels (BAT-AELs) where BAT is currently not achieved but will be achieved before 4 December 2023. The report shall include, but not be limited to, the following:</p> <ol style="list-style-type: none"> <li>1) Current performance against the BAT-AELs.</li> <li>2) Methodology for reaching the BAT-AELs.</li> <li>3) Associated targets /timelines for reaching compliance by 4 December 2023.</li> <li>4) Any alterations to the initial plan (in progress reports).</li> </ol> <p>The report shall address the BAT Conclusions for Food, Drink and Milk industries with respect to the following:</p> <ul style="list-style-type: none"> <li>• BAT 17 Table 4 (compliance with BAT-AELs for channelled dust emissions to air from grinding and pellet cooling in compound feed manufacture)</li> </ul> <p>Refer to BAT Conclusions for a full description of the BAT requirement.</p>	<p>Progress reports at 12 monthly intervals from date of permit issue: 31/03/2023</p>
IC10	<p>The operator shall submit, for approval by the Environment Agency, a report demonstrating compliance against BAT17 Table 4 for channelled dust emissions to air from grinding for emission points A4 &amp; A5.</p>	<p>04/12/2023 or other date as agreed in writing with the Environment Agency</p>
IC11	<p>The Operator shall submit a report, for approval in writing by the Environment Agency, demonstrating the ability to comply with BAT 5 for monitoring of particulates from the grinder emissions points A4 &amp; A5 in accordance with the MCERTS standard.</p> <p>The report shall include, but not be limited to, the installation of the sampling ports and platforms to enable particulate monitoring in accordance with table S3.1.</p>	<p>04/06/2023 or other date as agreed in writing with the Environment Agency</p>
IC12	<p>The Operator shall submit a written report to the Environment Agency of monitoring carried out to determine the size distribution of particulate matter in the exhaust gas emissions to air from emission points A1, A2, A3, A4, &amp; A5, identifying the fractions within the PM10 and PM2.5 ranges. The monitoring shall be carried out under representative operating conditions and shall be in accordance with EN ISO 23210 unless otherwise agreed with the Environment Agency.</p>	<p>04/12/2023 or other date as agreed in writing with the Environment Agency</p>
IC13	<p>The operator shall review and update the H1 risk assessment for particulate emissions to air at the capacity levels stated within table S1.1 of this permit. The H1 shall be submitted to the Environment Agency for review.</p>	<p>31/03/2023 or other date as agreed in writing with the Environment Agency</p>

## Schedule 2 – Waste types, raw materials and fuels

Table S2.1 Raw materials and fuels	
Raw materials and fuel description	Specification
-	-



## Schedule 3 – Emissions and monitoring

Table S3.1 Point source emissions to air – emission limits and monitoring requirements						
Emission point ref. & location	Source	Parameter	Limit (including unit)	Reference period	Monitoring frequency	Monitoring standard or method
A1 [Point A1 on site plan in Schedule 7]	Cooler 1	Particulate matter	20 mg/m <sup>3</sup>	Average over sampling period	Annual	BS EN 13284-1
A2 [Point A2 on site plan in Schedule 7]	Cooler 2	Particulate matter	20 mg/m <sup>3</sup>	Average over sampling period	Annual	BS EN 13284-1
A3 [Point A3 on site plan in Schedule 7]	Cooler 3	Particulate matter	20 mg/m <sup>3</sup>	Average over sampling period	Annual	BS EN 13284-1
A4 [Point A4 on-site plan in schedule 7]	Grinder Exhaust (Tietjen)	Particulate matter	10 mg/m <sup>3</sup> [Note 3]	Average over sampling period	Annual [Note 4]	BS EN 13284-1
A5 [Point A5 on site plan in schedule 7]	Grinder Exhaust (Wynveen)	Particulate matter	10 mg/m <sup>3</sup> [Note 3]	Average over sampling period	Annual [Note 4]	BS EN 13284-1
A6 [Point A6 on-site plan in schedule 7]	Grinder Explosion Vent (Wynveen)	No parameters set	No limits set	--	--	--
A7 [Point A7 on-site plan in Schedule 7]	Grinder Explosion Vent (Tietjen)	No parameters set	No limits set	--	--	--
A8 [Point A8 on-site plan in Schedule 7]	Grain Silo Bin 16	No parameters set	No limits set	--	--	--
A9 [Point A9 on-site plan in Schedule 7]	Grain Silo Bin 17	No parameters set	No limits set	--	--	--
A10 [Point A10 on-site plan in Schedule 7]	Grain Silo Bin 18	No parameters set	No limits set	--	--	--
A11 [Point A11 on-site plan in Schedule 7]	Grain Silo Bin 19	No parameters set	No limits set	--	--	--
A12 [Point A12 on-site plan in Schedule 7]	Grain Silo Bin 20	No parameters set	No limits set	--	--	--

<b>Table S3.1 Point source emissions to air – emission limits and monitoring requirements</b>						
<b>Emission point ref. &amp; location</b>	<b>Source</b>	<b>Parameter</b>	<b>Limit (including unit)</b>	<b>Reference period</b>	<b>Monitoring frequency</b>	<b>Monitoring standard or method</b>
A13 [Point A7 on-site plan in Schedule 7]	Grain Silo Bin 21	No parameters set	No limits set	--	--	--
A14 [Point A14 on-site plan in Schedule 7]	Grain Silo Bin 22	No parameters set	No limits set	--	--	--
A15 [Point A15 on-site plan in Schedule 7]	Grain Silo Bin 23	No parameters set	No limits set	--	--	--
A16 [Point A16 on-site plan in Schedule 7]	Soya Tank 1	No parameters set	No limits set	--	--	--
A17 [Point A17 on-site plan in Schedule 7]	Fat Tank 1	No parameters set	No limits set	--	--	--
A18 [Point A18 on-site plan in Schedule 7]	Soya Tank 2	No parameters set	No limits set	--	--	--
A19 [Point A19 on-site plan in Schedule 7]	Molasses Tank	No parameters set	No limits set	--	--	--
A20 [Point A20 on-site plan in Schedule 7]	Fats Tank 2	No parameters set	No limits set	--	--	--
A21 [Point A21 on-site plan in Schedule 7]	Kerosene Tank	No parameters set	No limits set	--	--	--
A22 [Point A22 on-site plan in Schedule 7]	Fuelling Station (Diesel & Adblue)	No parameters set	No limits set	--	--	--
A23 [Point A23 on-site plan in Schedule 7]	Oil Storage tank (Space Heating Boiler)	No parameters set	No limits set	--	--	--
A24 [Point A24 on-site plan in Schedule 7]	1.5 MWth Natural gas fired boiler	Oxides of Nitrogen (NO and NO <sub>2</sub> expressed as NO <sub>2</sub> )	250 mg/m <sup>3</sup> [Note 1]	Periodic	Every three years [Note 2]	EN 14792
		Carbon monoxide	No limit set	Periodic	Every three years [Note 2]	EN 15058
A25 [Point A25 on-site plan in Schedule 7]		Oxides of Nitrogen	200 mg/m <sup>3</sup> [Note 1]	Periodic	Every three years [Note 2]	EN 14792

<b>Table S3.1 Point source emissions to air – emission limits and monitoring requirements</b>						
<b>Emission point ref. &amp; location</b>	<b>Source</b>	<b>Parameter</b>	<b>Limit (including unit)</b>	<b>Reference period</b>	<b>Monitoring frequency</b>	<b>Monitoring standard or method</b>
	1.5 MWth Kerosene fired boiler	(NO and NO <sub>2</sub> expressed as NO <sub>2</sub> )				
		Carbon monoxide	No limit set	Periodic	Every three years <sup>[Note 2]</sup>	EN 15058
A26 [Point A26 on-site plan in Schedule 7]	Space Heating Boiler Exhaust	No parameters set	No limits set	--	--	--
A27 [Point A27 on-site plan in Schedule 7]	Power Washer	No parameters set	No limits set	--	--	--
A28 [Point A28 on-site plan in Schedule 7]	E12 Explosion Vents	No parameters set	No limits set	--	--	--
A29 [Point A29 on-site plan in Schedule 7]	E13 Explosion Vents	No parameters set	No limits set	--	--	--
A30 [Point A30 on-site plan in Schedule 7]	Waste Oil Drum	No parameters set	No limits set	--	--	--
A31 [Point A31 on-site plan in Schedule 7]	Finished Product Returns Bin	No parameters set	No limits set	--	--	--
A32 [Point A32 on-site plan in Schedule 7]	Grinder Under Hopper Explosion Vent (Wynveen)	No parameters set	No limits set	--	--	--
<p>Note 1: The limits shall only apply from 01/01/2030 (unless the boiler is replaced).</p> <p>Note 2: The monitoring requirements shall only apply from 01/01/2030 (unless the boiler is replaced).</p> <p>Note 3: The limits shall only apply upon completion of IC9 and IC10, and at the latest by 04/12/2023.</p> <p>Note 4: The monitoring requirements shall only apply upon completion of IC11, and at the latest by 04/12/2023.</p>						

<b>Table S3.2 Point Source emissions to water (other than sewer) and land – emission limits and monitoring requirements</b>						
<b>Emission point ref. &amp; location</b>	<b>Source</b>	<b>Parameter</b>	<b>Limit (incl. unit)</b>	<b>Reference Period</b>	<b>Monitoring frequency</b>	<b>Monitoring standard or method</b>
W1 [Point W1 on site plan in schedule 7] emission to Wellow Brook	Clean & uncontaminated surface water via 3 stage interceptor	No parameters set	No limit set	--	--	--
W2 [Point W2 on site plan in schedule 7] emission to Wellow Brook	Clean & uncontaminated surface water	No parameters set	No limit set	--	--	--
W3 [Point W3 on site plan in schedule 7] emission to Wellow Brook	Clean & uncontaminated surface water	No parameters set	No limit set	--	--	--
W4 [Point W4 on site plan in schedule 7] emission to Wellow Brook via public storm water sewer.	Clean & uncontaminated surface water via 3 stage interceptor	No parameters set	No limit set	--	--	--

<b>Table S3.3 Point source emissions to sewer, effluent treatment plant or other transfers off-site – emission limits and monitoring requirements</b>						
<b>Emission point ref. &amp; location</b>	<b>Source</b>	<b>Parameter</b>	<b>Limit (incl. Unit)</b>	<b>Reference period</b>	<b>Monitoring frequency</b>	<b>Monitoring standard or method</b>
S1 [Point S1 on site plan in schedule 7] emission to Wessex Water foul sewer	Vehicle wash	No parameters set	No limit set	--	--	--
S2 [Point S2 on site plan in schedule 7] emission to Wessex Water foul sewer	Boiler blow-down and condensate	No parameters set	No limit set	--	--	--

## Schedule 4 – Reporting

Parameters, for which reports shall be made, in accordance with conditions of this permit, are listed below.

Parameter	Emission or monitoring point/reference	Reporting period	Period begins
Point source emissions to air	A1, A2, A3, A4 and A5	Every 12 months	1 January
Parameters as required by condition 3.5.1	A24 & A25	First monitoring undertaken in accordance with Condition 3.1.4 to be reported within 3 months, and then every 3 years thereafter.	From first monitoring requirements in accordance with Condition 3.1.4

Parameter	Units
Compound feed	tonnes

Parameter	Frequency of assessment	Units
Water usage	Annually	m <sup>3</sup>
Specific waste water discharge (yearly average)	Annually	m <sup>3</sup> /tonne of products
Energy usage	Annually	MWh
Specific energy consumption (yearly average)	Annually	MWh/ tonne of products
Waste	Annually	tonnes

Parameter	Reporting form	Form version number and date
Point source emissions to air	Emissions to Air Reporting Form, or other form as agreed in writing by the Environment Agency	Version 1, 08/03/2021
Water usage	Water Usage Reporting Form, or other form as agreed in writing by the Environment Agency	Version 1, 08/03/2021
Energy usage	Energy Usage Reporting Form, or other form as agreed in writing by the Environment Agency	Version 1, 08/03/2021
Other performance parameters	Other Performance Parameters Reporting Form, or other form as agreed in writing by the Environment Agency	Version 1, 08/03/2021

# Schedule 5 – Notification

These pages outline the information that the operator must provide.

Units of measurement used in information supplied under Part A and B requirements shall be appropriate to the circumstances of the emission. Where appropriate, a comparison should be made of actual emissions and authorised emission limits.

If any information is considered commercially confidential, it should be separated from non-confidential information, supplied on a separate sheet and accompanied by an application for commercial confidentiality under the provisions of the EP Regulations.

## Part A

Permit Number	
Name of operator	
Location of Facility	
Time and date of the detection	

<b>(a) Notification requirements for any malfunction, breakdown or failure of equipment or techniques, accident, or emission of a substance not controlled by an emission limit which has caused, is causing or may cause significant pollution</b>	
<b>To be notified within 24 hours of detection</b>	
Date and time of the event	
Reference or description of the location of the event	
Description of where any release into the environment took place	
Substances(s) potentially released	
Best estimate of the quantity or rate of release of substances	
Measures taken, or intended to be taken, to stop any emission	
Description of the failure or accident.	

<b>(b) Notification requirements for the breach of a limit</b>	
<b>To be notified within 24 hours of detection unless otherwise specified below</b>	
Emission point reference/ source	
Parameter(s)	
Limit	
Measured value and uncertainty	
Date and time of monitoring	

<b>(b) Notification requirements for the breach of a limit</b>	
<b>To be notified within 24 hours of detection unless otherwise specified below</b>	
Measures taken, or intended to be taken, to stop the emission	

<b>Time periods for notification following detection of a breach of a limit</b>	
<b>Parameter</b>	<b>Notification period</b>

<b>(c) Notification requirements for the breach of permit conditions not related to limits</b>	
<b>To be notified within 24 hours of detection</b>	
Condition breached	
Date, time and duration of breach	
Details of the permit breach i.e. what happened including impacts observed.	
Measures taken, or intended to be taken, to restore permit compliance.	

<b>(d) Notification requirements for the detection of any significant adverse environmental effect</b>	
<b>To be notified within 24 hours of detection</b>	
Description of where the effect on the environment was detected	
Substances(s) detected	
Concentrations of substances detected	
Date of monitoring/sampling	

## Part B – to be submitted as soon as practicable

Any more accurate information on the matters for notification under Part A.	
Measures taken, or intended to be taken, to prevent a recurrence of the incident	
Measures taken, or intended to be taken, to rectify, limit or prevent any pollution of the environment which has been or may be caused by the emission	
The dates of any unauthorised emissions from the facility in the preceding 24 months.	

Name*	
Post	
Signature	
Date	

\* authorised to sign on behalf of the operator



## Schedule 6 – Interpretation

“accident” means an accident that may result in pollution.

“application” means the application for this permit, together with any additional information supplied by the operator as part of the application and any response to a notice served under Schedule 5 to the EP Regulations.

“authorised officer” means any person authorised by the Environment Agency under section 108(1) of The Environment Act 1995 to exercise, in accordance with the terms of any such authorisation, any power specified in section 108(4) of that Act.

“emissions to land” includes emissions to groundwater.

“EP Regulations” means The Environmental Permitting (England and Wales) Regulations SI 2016 No.1154 and words and expressions used in this permit which are also used in the Regulations have the same meanings as in those Regulations.

“emissions of substances not controlled by emission limits” means emissions of substances to air, water or land from the activities, either from the emission points specified in schedule 3 or from other localised or diffuse sources, which are not controlled by an emission limit.

“groundwater” means all water, which is below the surface of the ground in the saturation zone and in direct contact with the ground or subsoil.

“Industrial Emissions Directive” means DIRECTIVE 2010/75/EU OF THE EUROPEAN PARLIAMENT AND OF THE COUNCIL of 24 November 2010 on industrial emissions, as read in accordance with Schedule 1A to the Environmental Permitting (England and Wales) Regulations 2016.

“MCERTS” means the Environment Agency’s Monitoring Certification Scheme.

“Medium Combustion Plant” or “MCP” means a combustion plant with a rated thermal input equal to or greater than 1 MW but less than 50 MW. An “existing medium combustion plant” is combustion plant operating before 20 December 2018.

“Medium Combustion Plant Directive” or “MCPD” means Directive 2015/2193/EU of the European Parliament and of the Council on the limitation of emissions of certain pollutants into the air from medium combustion plants, as read in accordance with Schedule 1A to the Environmental Permitting (England and Wales) Regulations 2016.

“Pests” means Birds, Vermin and Insects.

Where a minimum limit is set for any emission parameter, for example pH, reference to exceeding the limit shall mean that the parameter shall not be less than that limit.

Unless otherwise stated, any references in this permit to concentrations of substances in emissions into air means:

- in relation to emissions from combustion processes, the concentration in dry air at a temperature of 273K, at a pressure of 101.3 kPa and with an oxygen content of 3% dry for liquid and gaseous fuels other than gas engines or gas turbines, 6% dry for solid fuels; and/or
- in relation to emissions from gas engines or gas turbines, the concentration in dry air at a temperature of 273K, at a pressure of 101.3 kPa and with an oxygen content of 15% dry for liquid and gaseous fuels; and/or
- in relation to emissions from non-combustion sources, the concentration at a temperature of 273K and at a pressure of 101.3 kPa, with no correction for water vapour content

“year” means calendar year ending 31 December.

# Schedule 7 – Site plan

Created By: Grant Johnson Version: V2 Date Updated: 06/04/2022

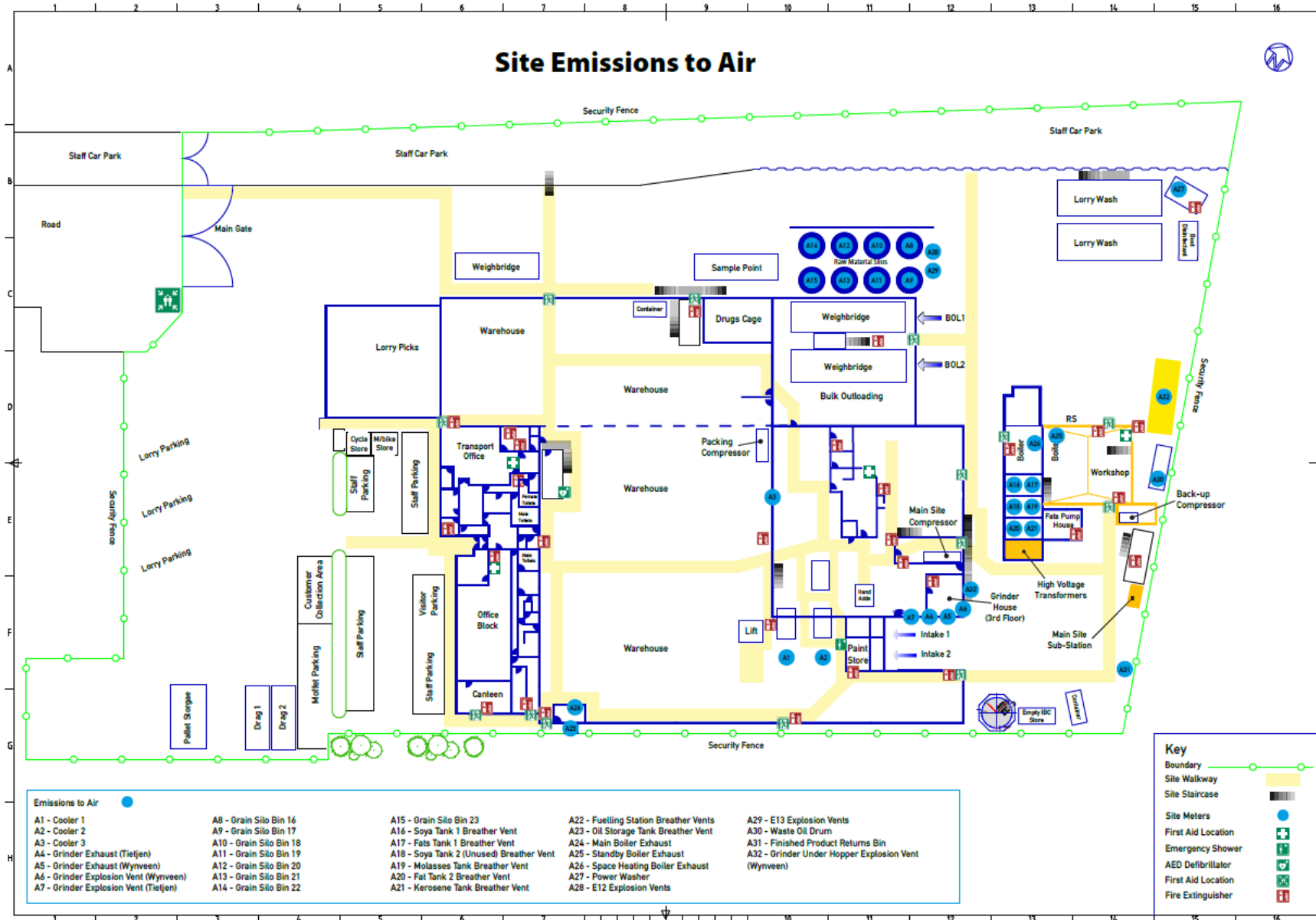

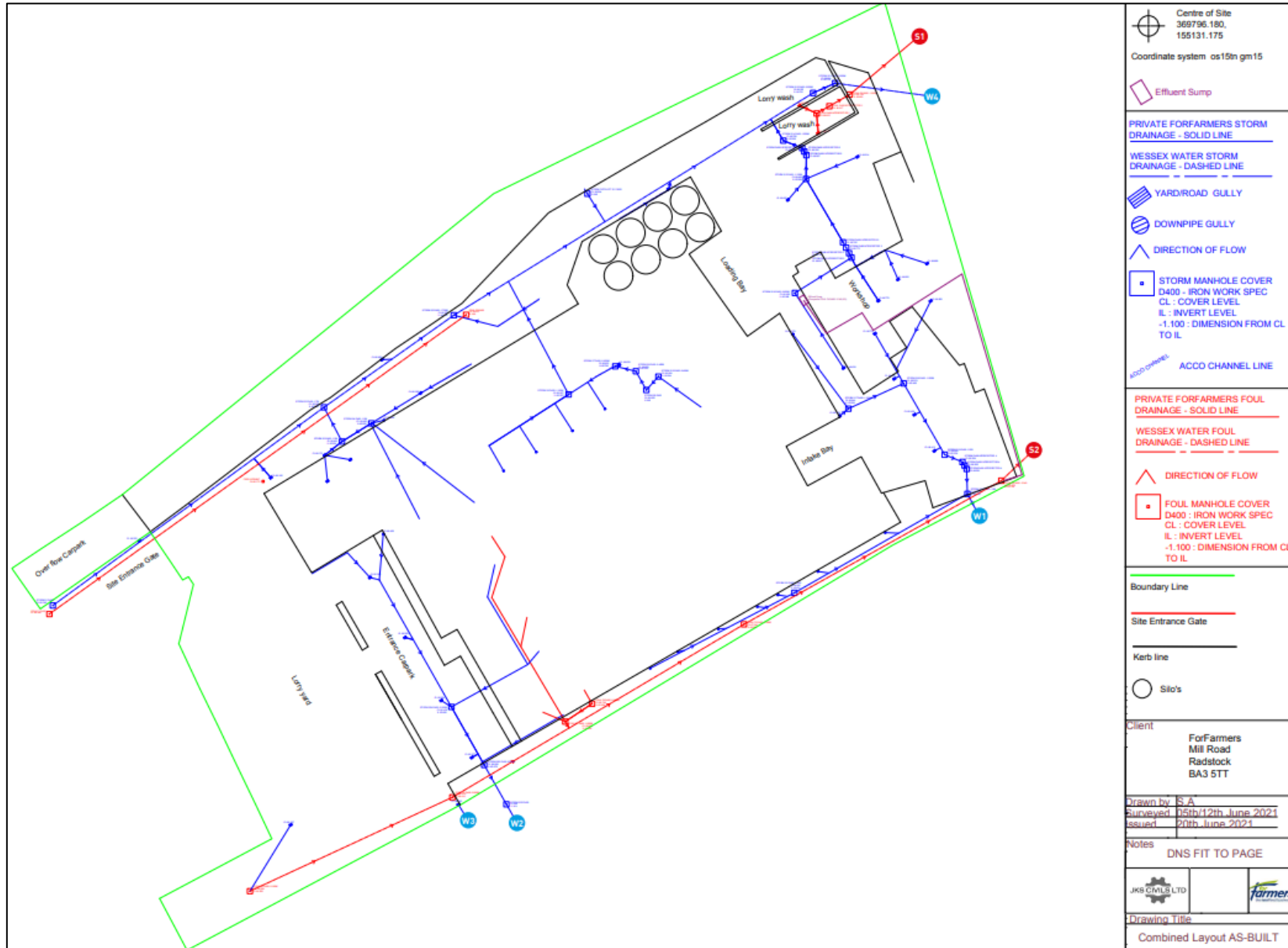

END OF PERMIT