

HIGH SPEED RAIL (LONDON – WEST MIDLANDS) ACT 2017

HIGH SPEED RAIL (LONDON – WEST MIDLANDS) GENERAL VESTING DECLARATION No. 805

This **GENERAL VESTING DECLARATION** is executed on 13 DECEMBER 2021 by the Secretary of State for Transport ("the Authority").

WHEREAS:

- (1) On 23 February 2017 the High Speed Rail (London – West Midlands) Act 2017 ("the High Speed Rail Act") received Royal Assent authorising the Authority to acquire the land specified in the Schedule hereto.
- (2) Section 4(1) of the High Speed Rail Act authorises the Authority to acquire compulsorily so much of the land within the limits of the High Speed Rail Act as may be required for Phase One purposes¹.
- (3) Section 4(4) of the High Speed Rail Act provides that the Compulsory Purchase (Vesting Declarations) Act 1981 ("the 1981 Act") applies as if the High Speed Rail Act were a compulsory purchase order and paragraph 3² of Schedule 6 to the High Speed Rail Act provides that the 1981 Act shall have effect subject to the modifications specified in that paragraph.
- (4) Notice pursuant to section 3A³ of the 1981 Act was first published on 26 November 2021. That notice included the particulars specified in section 3A(3) of the 1981 Act.

NOW THIS DEED WITNESSETH that, in exercise of the powers conferred on it by section 4 of the 1981 Act, the Authority hereby declares:-

1. The land described in the Schedule hereto (being part of the land authorised to be acquired by the High Speed Rail Act) and more particularly delineated and shown coloured pink on the plan annexed hereto, together with the right to enter upon and take possession of the land, shall vest in the Authority as from the end of the period of 4 months from the date on which the service of notices required by section 6⁴ of the 1981 Act is completed.

For the purposes of Section 2(2) of the 1981 Act, the specified period in relation to the land comprised in this declaration is one year and one day.

1 Phase One Purposes has meaning given by section 67 of the High Speed Rail Act

2 Paragraph 3 as substituted by section 11 of, and paragraph 6 of Schedule 14 to, the High Speed Rail Act.

3 Section 3A of the 1981 Act as inserted by paragraph 3(a) of Schedule 6 to the High Speed Rail Act as substituted by section 11 of, and paragraphs 6 and 7 of Schedule 14 to, that Act.

4 Section 6 as modified by paragraph 3(c) of Schedule 6 to the High Speed Rail Act, as substituted by section 11 of, and paragraph 6 of Schedule 14 to, that Act

SCHEDULE

Buckinghamshire

(1) Plot No.	(2) Description
65818	All interests in 3904.1 square metres, or thereabouts, of public road, verges, access splays and drain (Quainton Road)
65825	All interests in 51422.3 square metres, or thereabouts, of agricultural land, ponds, hedgerows and woodland (Upper South Farm)
65827	All interests in 44.1 square metres, or thereabouts, of agricultural land (Upper South Farm)
65828	All interests in 12.7 square metres, or thereabouts, of verge and hedgerow (Fidlers Field Road)
65830	All interests in 1551.8 square metres, or thereabouts, of railway, works and land and hedgerow (Great Central Railway)
65831	All interests in 1564.0 square metres, or thereabouts, of woodland, grassland and drain (Fidlers Field Road)
65832	All interests in 1696.3 square metres, or thereabouts, of public road, verges, access splay and woodland (Fidlers Field Road)
65833	All interests in 2202.9 square metres, or thereabouts, of agricultural land, hedgerow and building (Station Road)
65834	All interests in 10379.2 square metres, or thereabouts, of agricultural land (Quainton Hatchery)
65835	All interests in 4760.4 square metres, or thereabouts, of agricultural land and hedgerow (Station Road)
65836	All interests in 1146.7 square metres, or thereabouts, of woodland, agricultural land and pond (Upper South Farm)
65837	All interests in 1078.2 square metres, or thereabouts, of agricultural land and hedgerow (Melling Farm)
65838	All interests in 1703.3 square metres, or thereabouts, of public road, verges and footways (Station Road)
65839	All interests in 34.8 square metres, or thereabouts, of verge (Upper South Farm)
65840	All interests in 162.9 square metres, or thereabouts, of bridge carrying public road and verges over railway, works and land (Great Central Main Line) (Fidlers Field Road)
65841	All interests in 571.9 square metres, or thereabouts, of agricultural land and hedgerow (Station Road)
65842	All interests in 27.9 square metres, or thereabouts, of access road and verge (Upper South Farm)
65843	All interests in 1137.4 square metres, or thereabouts, of railway, works and land (Great Central Main Line), woodland, access track, access splay and verge (Fidlers Field road)
65844	All interests in 647.0 square metres, or thereabouts, of access road and verges (Upper South Farm)
65845	All interests in 21795.5 square metres, or thereabouts, of agricultural land, hedgerows and drain (Fieldside Farm)
65846	All interests in 932.3 square metres, or thereabouts, of public road, verges and hedgerow (Fidlers Field Road)
65847	All interests in 5930.6 square metres, or thereabouts, of agricultural land and woodland (Upper South Farm)

65848	All interests in 3456.5 square metres, or thereabouts, of railway, works and land, woodland and public footpath (QUA/31/4) (Great Central Main Line)
65849	All interests in 2009.4 square metres, or thereabouts, of access road, verges and hedgerow (Upper South Farm)
65850	All interests in 62.2 square metres, or thereabouts, of access road (Upper South Farm)
65852	All interests in 1018.3 square metres, or thereabouts, of public road and verges (Fidlers Field Road)
65856	All interests in 25533.0 square metres, or thereabouts, of agricultural land, drain and public footpath (QUA/31/4) (Upper South Farm)
65860	All interests in 23370.0 square metres, or thereabouts, of agricultural land, dismantled railway, hedgerows, embankment, woodland and drain (Upper South Farm)
65875	All interests in 13422.0 square metres, or thereabouts, of railway, works and land, woodland and hedgerow, public footpaths (QUA/24A/1 and QUA/31/4) and public bridleway (QUA/28A/2) (Great Central Main Line)
65877	All interests in 25874.2 square metres, or thereabouts, of agricultural land, public brideways (QUA/28A/2 and QUA/28/1) and public footpaths (QUA/24/1 and QUA/24A/1) (Doddershall)
65881	All interests in 19.0 square metres, or thereabouts, of hedgerow (Railway Cottage)
65883	136.4 interests in 136.4 square metres, or thereabouts, of agricultural land, woodland and public bridleway (QUA/28/1) (Doddershall)
65886	All interests in 96958.0 square metres, or thereabouts, of agricultural land, drains, access tracks, hedgerows, public bridleway (QUA/28A/1) and public footpath (QUA/24A/1) (Doddershall)
65896	All interests in 26230.3 square metres, or thereabouts, of agricultural land, drains, hedgerows and woodland (Hill Farm)
65898	All interests in 116.0 square metres, or thereabouts, of railway, works and land and agricultural underpass (Great Central Main Line)
65907	All interests in 14895.2 square metres, or thereabouts, of railway, works and land, woodland, drain and public footpath (QUA/26/1) (Great Central Main Line)
65908	All interests in 7197.4 square metres, or thereabouts, of agricultural land and public footpath (QUA/26/1) (Middle Farm)
65909	All interests in 18567.0 square metres, or thereabouts, of agricultural land, access track and public footpath (QUA/26/1) (Hill Farm)
65914	All interests in 3120.8 square metres, or thereabouts, of public road, verges, access splays, hedgerows and woodland (Shipton Lee Road)
65915	All interests in 393.1 square metres, or thereabouts, of bridge carrying public road over verges and railway, works and land (Great Central Railway) (Shipton Lee Road)
65917	All interests in 4261.0 square metres, or thereabouts, of public road, verges, woodland and access splay (Shipton Lee Road)
65926	All interests in 2794.1 square metres, or thereabouts, of access track carrying public footpath (QUA/35A/1), and verges (Finemere Wood)
65933	All interests in 90391.6 square metres, or thereabouts, of agricultural land, public footpath (QUA/35/2), pylons and overhead electricity cables, hedgerows and pond (Middle Farm)
65935	All interests in 86269.2 square metres, or thereabouts, of agricultural land, river, bed and banks thereof (River Ray), hedgerows, hardstanding, public footpath (QUA/35/1), pylon and overhead electricity cables (Hill Farm)
65944	All interests in 19152.6 square metres, or thereabouts, of agricultural land, hedgerows, woodland and river, bed and banks thereof (River Ray) (Middle Farm)
70123	All interests in 1850.8 square metres, or thereabouts, of agricultural land

	and hedgerow (Upper South Farm)
70177	All interests in 6825.2 square metres, or thereabouts, of agricultural land (Doddershall)
70493	All interests in 158.6 square metres, or thereabouts, of access track and access splay (Melling Farm)
70498	All interests in 2463.2 square metres, or thereabouts, of access track, drain and woodland (Doddershall)
70609	All interests in 353.6 square metres, or thereabouts, of access splay, hedgerow and verge (Fidlers Field Road)
71148	All interests in 2120.8 square metres, or thereabouts, of grassland, access track, access splay, hedgerow and public footpath (QUA/31/4) (Upper South Farm)
71653	All interests in 114.3 square metres, or thereabouts, of drain and hedgerow (Doddershall Park)
71656	All interests in 5393.6 square metres, or thereabouts, of agricultural land and hedgerow (Upper South Farm)
71715	All interests in 31005.7 square metres, or thereabouts, of agricultural land, hedgerows and public footpath (QUA/26/1) (Doddershall)

IN WITNESS WHEREOF the Secretary of State for Transport has hereunto set its corporate seal on the day in the year first written above.

The **CORPORATE SEAL** of the SECRETARY OF STATE FOR TRANSPORT hereunto affixed to this deed is authenticated by

.....

Authorised Signatory

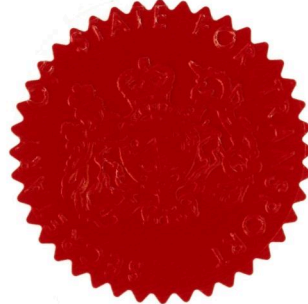

SEAL REF
DFT GP / 0959

Dated: 13 DECEMBER 2021

HIGH SPEED RAIL (LONDON – WEST MIDLANDS) ACT 2017 GENERAL VESTING DECLARATION No. 805 SHEET 1 of 8

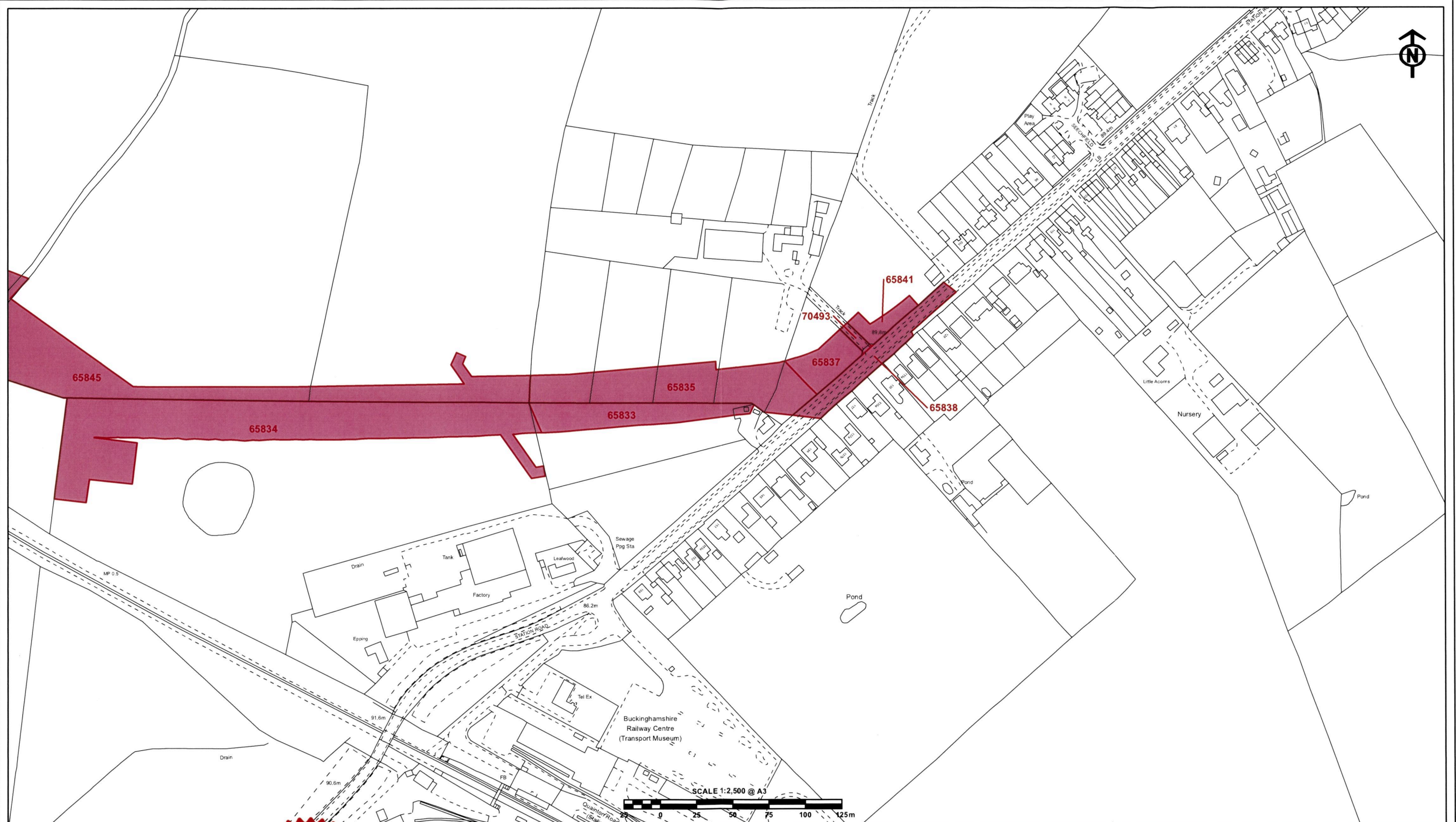

The CORPORATE SEAL of the
SECRETARY OF STATE
hereunto affixed to this deed
is authenticated by

Authorised by the Secretary of State for Transport

Dated 13 DECEMBER 2021



0959

CENTRE POINT: 473,984, 219,239

© Crown copyright and database rights 2021. Ordnance Survey Licence Number 100049190.
© Crown copyright material is reproduced with the permission of Land Registry under
delegated authority from the Controller of HMSO and © Crown Copyright Ordnance Survey.

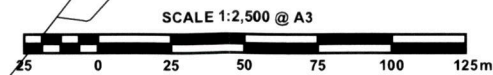
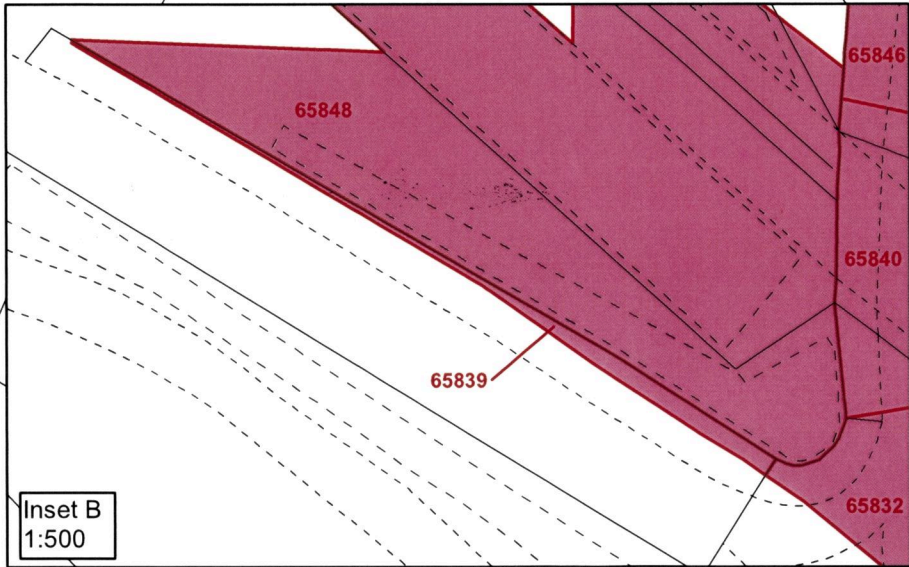
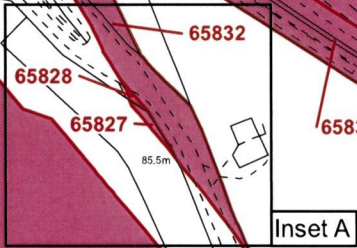
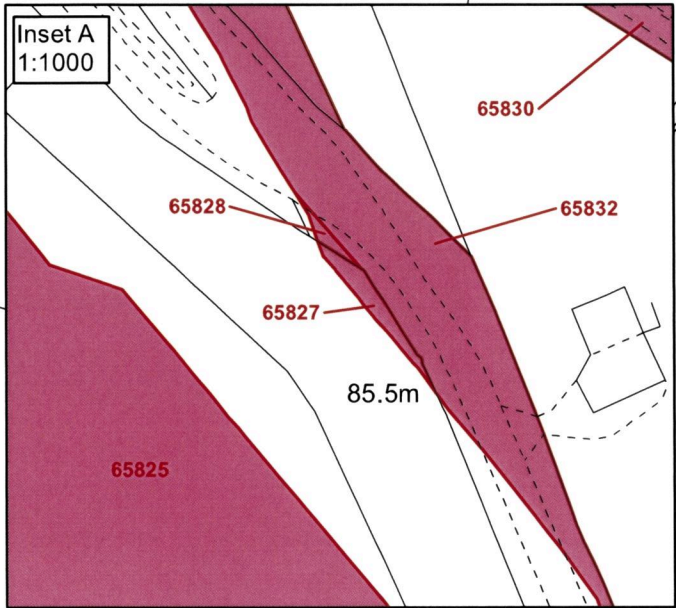
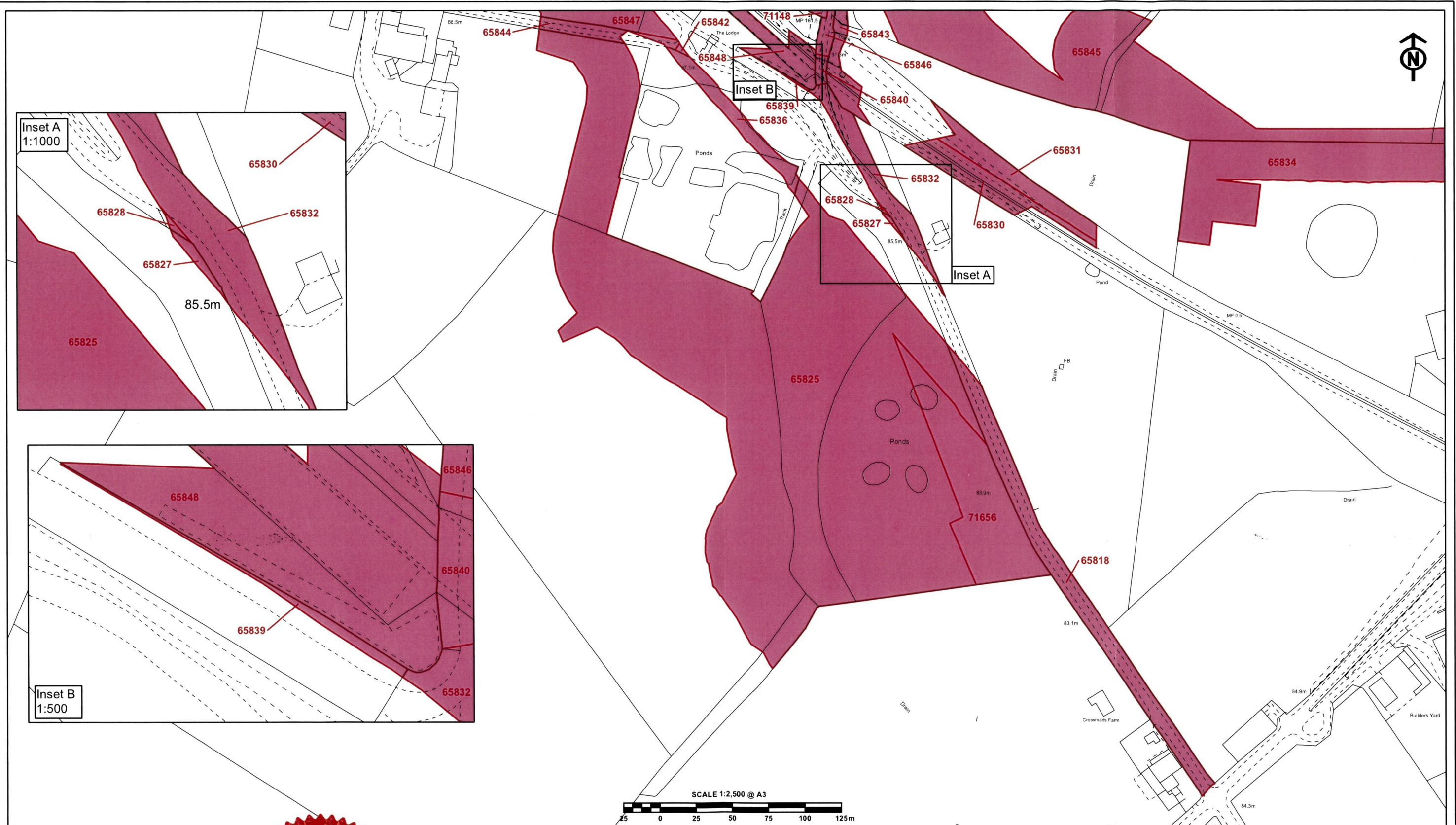

The CORPORATE SEAL of the
SECRETARY OF STATE
hereunto affixed to this deed
is authenticated by

Authorised by the Secretary of State for Transport

Dated 13 DECEMBER 2021

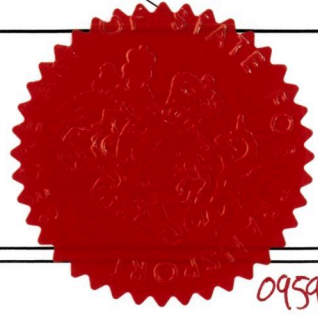

0959

CENTRE POINT: 473,211, 219,060

© Crown copyright and database rights 2021. Ordnance Survey Licence Number 100049190.
© Crown copyright material is reproduced with the permission of Land Registry under
delegated authority from the Controller of HMSO and © Crown Copyright Ordnance Survey.

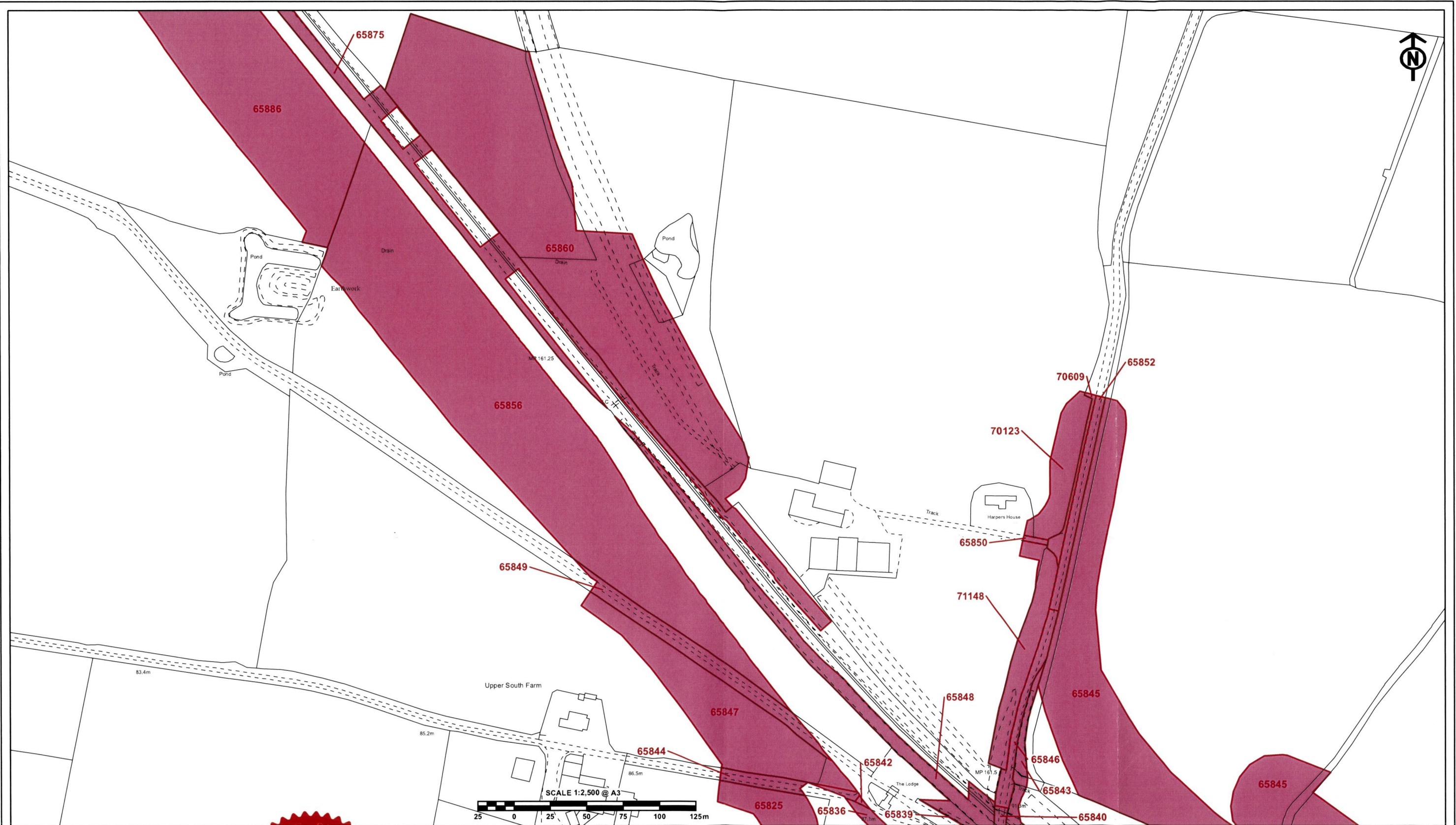

The CORPORATE SEAL of the
SECRETARY OF STATE
hereunto affixed to this deed
is authenticated by

Authorised by the Secretary of State for Transport

Dated 13 DECEMBER 2011



0959

CENTRE POINT: 473,089, 219,578

© Crown copyright and database rights 2021. Ordnance Survey Licence Number 100049190.
© Crown copyright material is reproduced with the permission of Land Registry under
delegated authority from the Controller of HMSO and © Crown Copyright Ordnance Survey.

HIGH SPEED RAIL (LONDON – WEST MIDLANDS) ACT 2017 GENERAL VESTING DECLARATION No. 805 SHEET 5 of 8

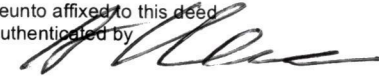

The CORPORATE SEAL of the
SECRETARY OF STATE
hereunto affixed to this deed
is authenticated by

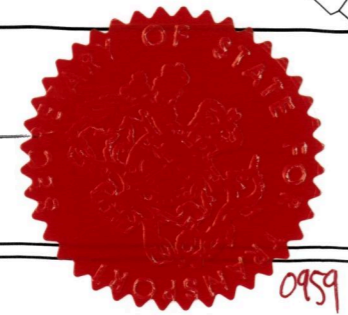
Authorised by the Secretary of State for Transport
Dated 13 DECEMBER 2021



CENTRE POINT: 472,066, 220,607

© Crown copyright and database rights 2021. Ordnance Survey Licence Number 100049190.
© Crown copyright material is reproduced with the permission of Land Registry under
delegated authority from the Controller of HMSO and © Crown Copyright Ordnance Survey.

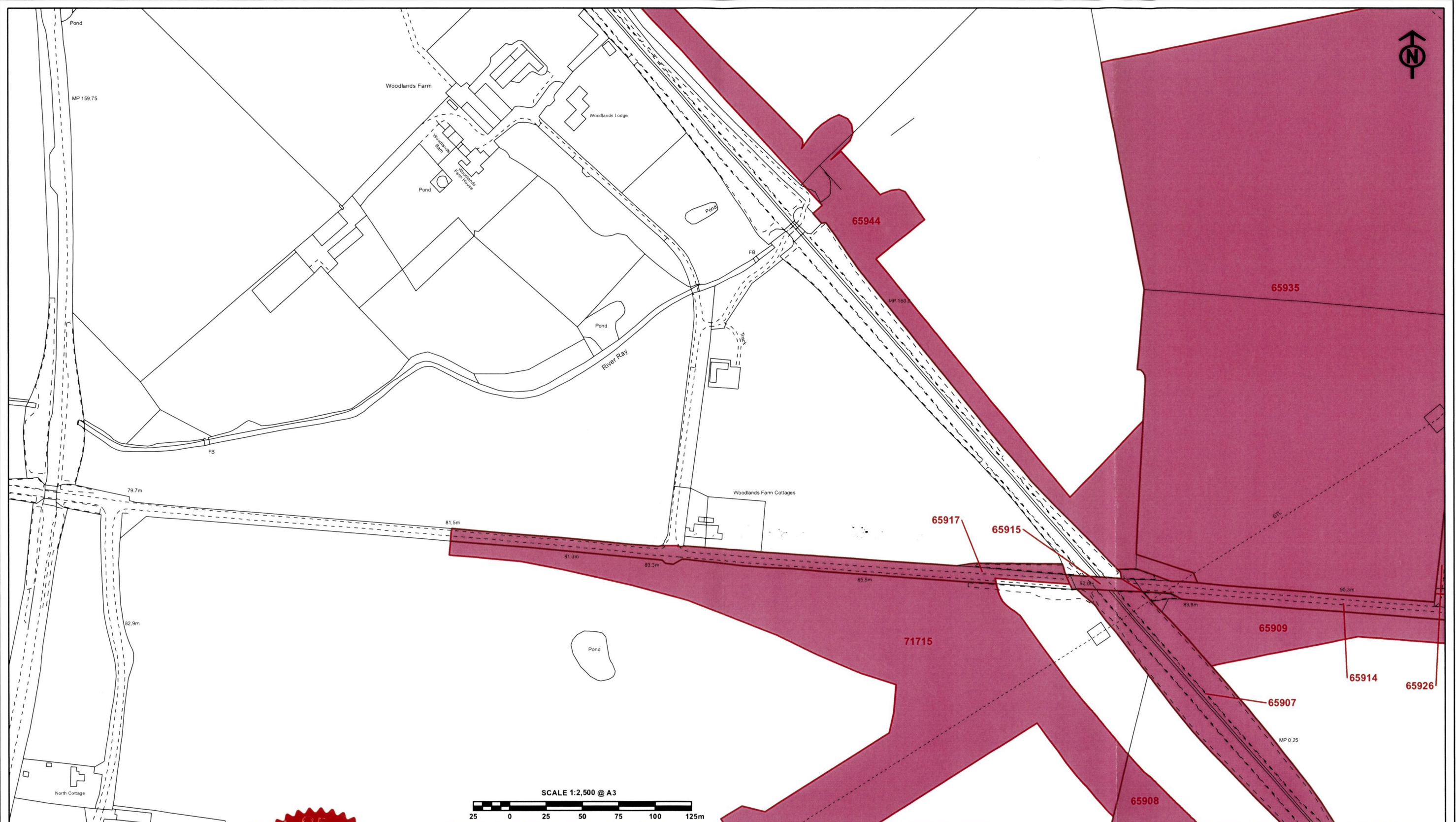
0459

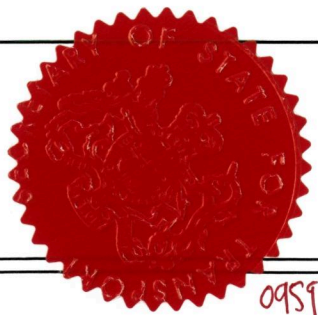

The CORPORATE SEAL of the
SECRETARY OF STATE
hereunto affixed to this deed
is authenticated by

Authorised by the Secretary of State for Transport
Dated 13 DECEMBER 2021



0959

CENTRE POINT: 471,599, 221,084

HIGH SPEED RAIL (LONDON – WEST MIDLANDS) ACT 2017 GENERAL VESTING DECLARATION No. 805 SHEET 7 of 8



The CORPORATE SEAL of the
SECRETARY OF STATE
hereunto affixed to this deed
is authenticated by

Authorised by the Secretary of State for Transport

Dated 13 DECEMBER 2021



0459

HIGH SPEED RAIL (LONDON – WEST MIDLANDS) ACT 2017 GENERAL VESTING DECLARATION No. 805 SHEET 8 of 8

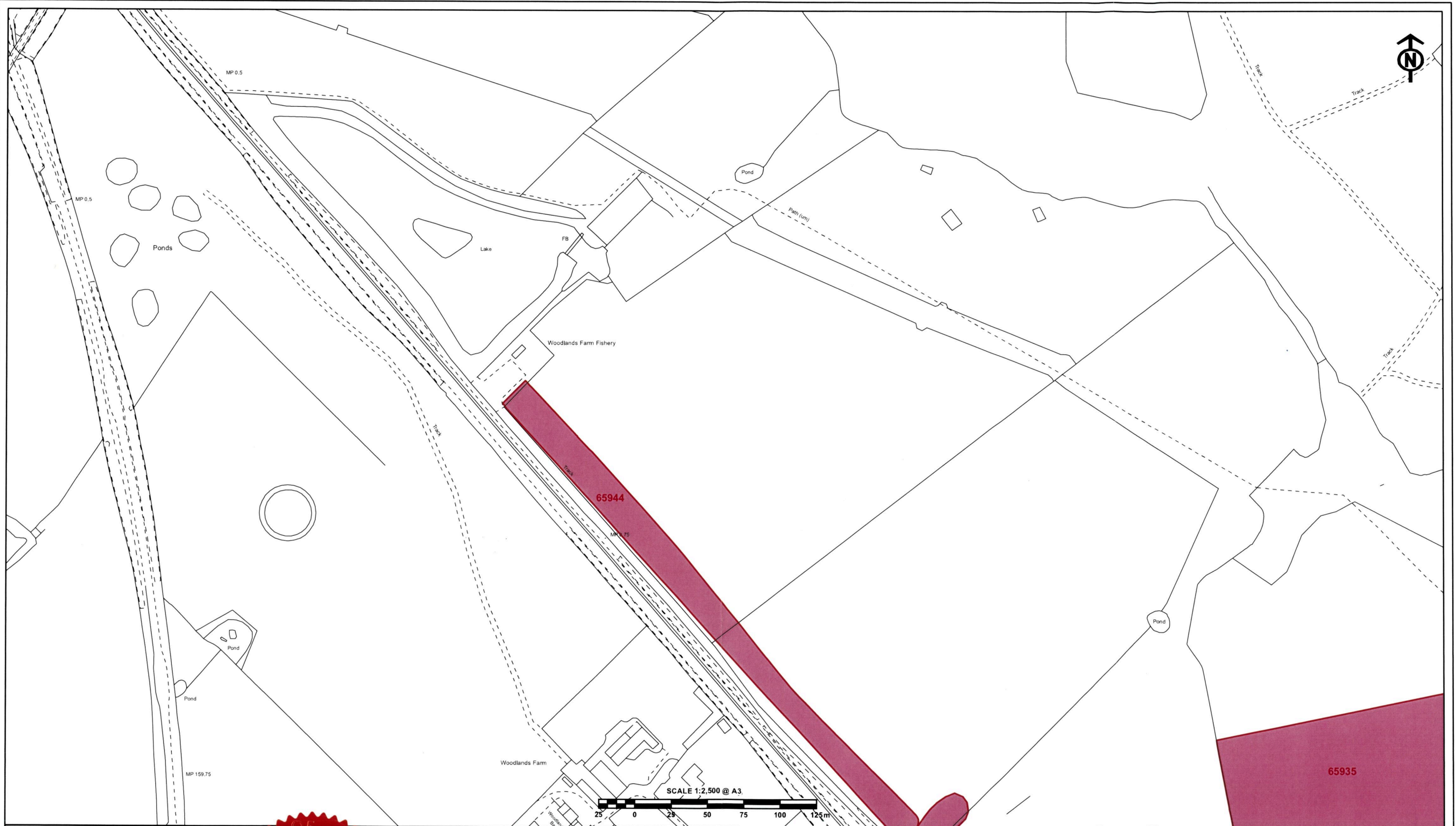

The CORPORATE SEAL of the
SECRETARY OF STATE
hereunto affixed to this deed
is authenticated by

Authorised by the Secretary of State for Transport

Dated 13 DECEMBER 2011

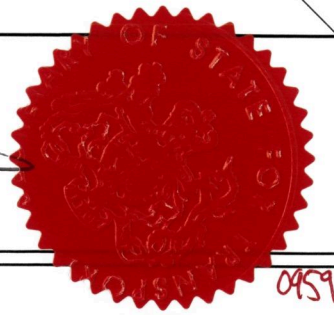

0959

CENTRE POINT: 471,520, 221,548

© Crown copyright and database rights 2021. Ordnance Survey Licence Number 100049190.
© Crown copyright material is reproduced with the permission of Land Registry under
delegated authority from the Controller of HMSO and © Crown Copyright Ordnance Survey.

