

## HIGH SPEED RAIL (LONDON – WEST MIDLANDS) ACT 2017

### HIGH SPEED RAIL (LONDON – WEST MIDLANDS) GENERAL VESTING DECLARATION No. 745

This **GENERAL VESTING DECLARATION** is executed on 26 November 2021 by the Secretary of State for Transport ("the Authority").

#### WHEREAS:

- (1) On 23 February 2017 the High Speed Rail (London – West Midlands) Act 2017 ("the High Speed Rail Act") received Royal Assent authorising the Authority to acquire the land specified in the Schedule hereto.
- (2) Section 4(1) of the High Speed Rail Act authorises the Authority to acquire compulsorily so much of the land within the limits of the High Speed Rail Act as may be required for Phase One purposes<sup>1</sup>.
- (3) Section 4(4) of the High Speed Rail Act provides that the Compulsory Purchase (Vesting Declarations) Act 1981 ("the 1981 Act") applies as if the High Speed Rail Act were a compulsory purchase order and paragraph 3<sup>2</sup> of Schedule 6 to the High Speed Rail Act provides that the 1981 Act shall have effect subject to the modifications specified in that paragraph.
- (4) Notice pursuant to section 3A<sup>3</sup> of the 1981 Act was first published on 11 November 2021. That notice included the particulars specified in section 3A(3) of the 1981 Act.

**NOW THIS DEED WITNESSETH** that, in exercise of the powers conferred on it by section 4 of the 1981 Act, the Authority hereby declares:-

1. The land described in the Schedule hereto (being part of the land authorised to be acquired by the High Speed Rail Act) and more particularly delineated and shown coloured pink on the plan annexed hereto, together with the right to enter upon and take possession of the land, shall vest in the Authority as from the end of the period of 4 months from the date on which the service of notices required by section 6<sup>4</sup> of the 1981 Act is completed.

For the purposes of Section 2(2) of the 1981 Act, the specified period in relation to the land comprised in this declaration is one year and one day.

---

1 Phase One Purposes has meaning given by section 67 of the High Speed Rail Act

2 Paragraph 3 as substituted by section 11 of, and paragraph 6 of Schedule 14 to, the High Speed Rail Act.

3 Section 3A of the 1981 Act as inserted by paragraph 3(a) of Schedule 6 to the High Speed Rail Act as substituted by section 11 of, and paragraphs 6 and 7 of Schedule 14 to, that Act.

4 Section 6 as modified by paragraph 3(c) of Schedule 6 to the High Speed Rail Act, as substituted by section 11 of, and paragraph 6 of Schedule 14 to, that Act

## SCHEDULE

Buckinghamshire

(1) Plot No.	(2) Description
66409	All interests in 1737.7 square metres, or thereabouts, of public road and verges (Brackley Road)
66411	All interests in 1469.9 square metres, or thereabouts, of agricultural land and hedgerow (Grove Farm)
66412	All interests in 2723.9 square metres, or thereabouts, of agricultural land and hedgerow (Grovehill Farm)
66418	All interests in 2525.8 square metres, or thereabouts, of agricultural land and hedgerow (Grovehill Farm)
66422	All interests in 497.7 square metres, or thereabouts, of agricultural land, hedgerow, hardstanding and access splay (Glebe Farm)
66423	All interests in 2447.1 square metres, or thereabouts, of agricultural land and woodland (Oatleys Farm)
66426	All interests in 12834.5 square metres, or thereabouts, of agricultural land and hedgerow (Oatleys Farm)
66428	All interests in 8390.1 square metres, or thereabouts, of agricultural land, woodland and public footpath (TUW/3/2) (Glebe Farm)
66448	All interests in 1661.6 square metres, or thereabouts, of playing fields and hedgerow (Turweston Playing Fields)
70684	All interests in 2987.0 square metres, or thereabouts, of agricultural land and hedgerow (Oatleys Farm)
70685	All interests in 238.4 square metres, or thereabouts, of agricultural land (Oatleys Farm)
70686	All interests in 99.1 square metres, or thereabouts, of agricultural land (Oatleys Farm)
70687	All interests in 95.5 square metres, or thereabouts, of access track (Oatleys Farm)
70688	All interests in 263.2 square metres, or thereabouts, of agricultural land (Oatleys Farm)
70689	All interests in 251.7 square metres, or thereabouts, of access track (Oatleys Farm)
70904	All interests in 392.4 square metres, or thereabouts, of public road and verges (Brackley Road)
70905	All interests in 814.9 square metres, or thereabouts, of public road and verges (Brackley Road)

**IN WITNESS WHEREOF** the Secretary of State for Transport has hereunto set its corporate seal on the day in the year first written above.

The **CORPORATE SEAL** of the SECRETARY OF STATE FOR TRANSPORT hereunto affixed to this deed is authenticated by

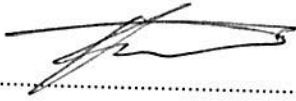

.....  
Authorised Signatory

Dated : 26 NOVEMBER 2021 .



SEAL REF.  
DFT GP / 0898

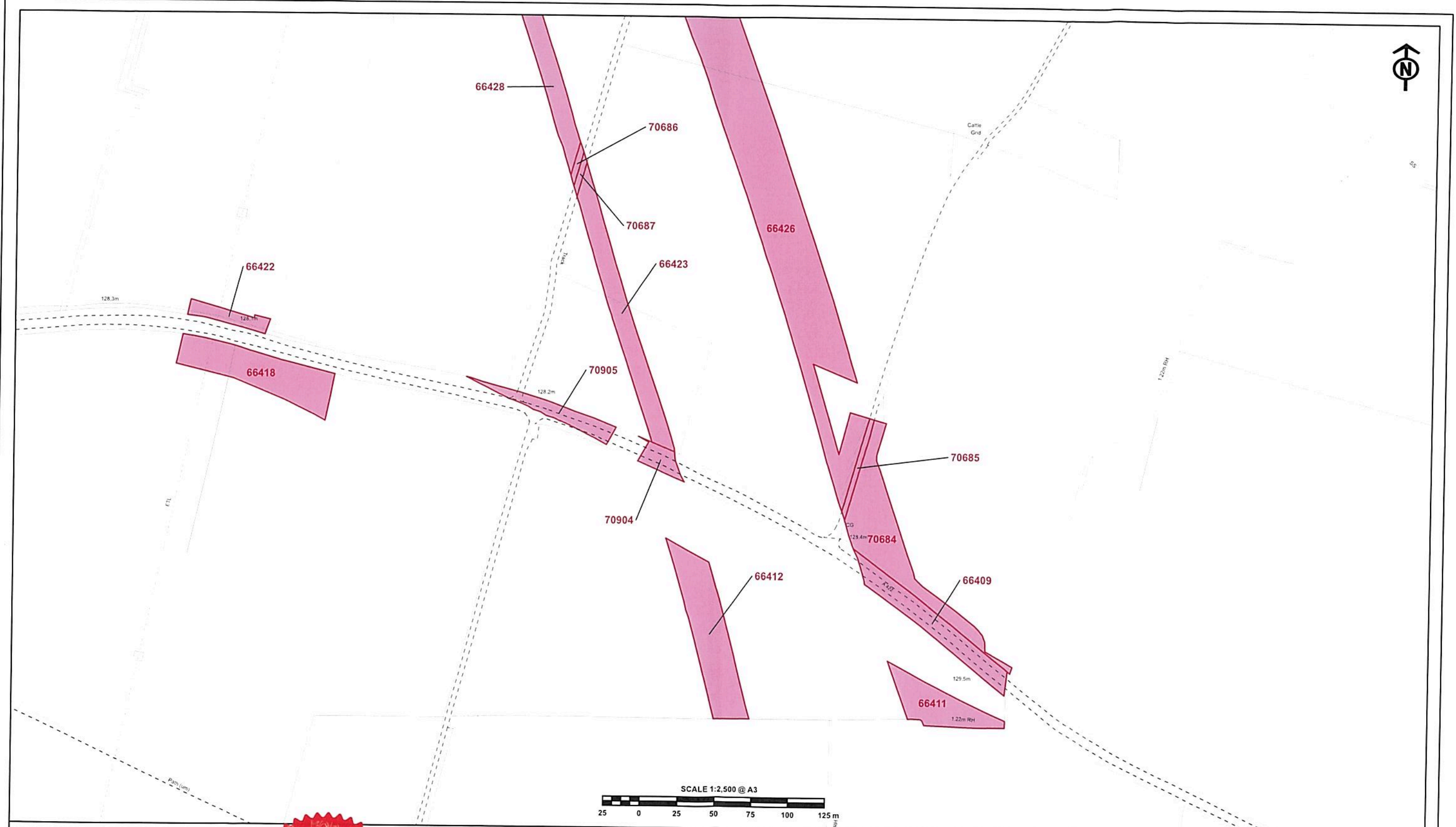

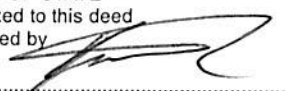
The CORPORATE SEAL of the  
SECRETARY OF STATE  
hereunto affixed to this deed  
is authenticated by   
.....  
Authorised by the Secretary of State for Transport  
Dated 26 NOVEMBER 2021.



0898

CENTRE POINT: 460,895, 236,643

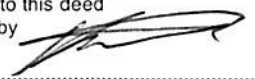

The CORPORATE SEAL of the  
SECRETARY OF STATE  
hereunto affixed to this deed  
is authenticated by   
.....  
Authorised by the Secretary of State for Transport  
Dated 26 NOVEMBER 2021.



0898

CENTRE POINT: 460,662, 237,118

© Crown copyright and database rights 2021. Ordnance Survey Licence Number: 100049190.  
© Crown copyright material is reproduced with the permission of Land Registry under  
delegated authority from the Controller of HMSO and © Crown Copyright Ordnance Survey.

