

HIGH SPEED RAIL (LONDON – WEST MIDLANDS) ACT 2017

HIGH SPEED RAIL (LONDON – WEST MIDLANDS) GENERAL VESTING DECLARATION No. 781

This **GENERAL VESTING DECLARATION** is executed on 13 DECEMBER 2021 by the Secretary of State for Transport (“the Authority”).

WHEREAS:

- (1) On 23 February 2017 the High Speed Rail (London – West Midlands) Act 2017 (“the High Speed Rail Act”) received Royal Assent authorising the Authority to acquire the land specified in the Schedule hereto.
- (2) Section 4(1) of the High Speed Rail Act authorises the Authority to acquire compulsorily so much of the land within the limits of the High Speed Rail Act as may be required for Phase One purposes¹.
- (3) Section 4(4) of the High Speed Rail Act provides that the Compulsory Purchase (Vesting Declarations) Act 1981 (“the 1981 Act”) applies as if the High Speed Rail Act were a compulsory purchase order and paragraph 3² of Schedule 6 to the High Speed Rail Act provides that the 1981 Act shall have effect subject to the modifications specified in that paragraph.
- (4) Notice pursuant to section 3A³ of the 1981 Act was first published on 19 November 2021. That notice included the particulars specified in section 3A(3) of the 1981 Act.

NOW THIS DEED WITNESSETH that, in exercise of the powers conferred on it by section 4 of the 1981 Act, the Authority hereby declares:-

1. The land described in the Schedule hereto (being part of the land authorised to be acquired by the High Speed Rail Act) and more particularly delineated and shown coloured pink on the plan annexed hereto, together with the right to enter upon and take possession of the land, shall vest in the Authority as from the end of the period of 4 months from the date on which the service of notices required by section 6⁴ of the 1981 Act is completed.

For the purposes of Section 2(2) of the 1981 Act, the specified period in relation to the land comprised in this declaration is one year and one day.

1 Phase One Purposes has meaning given by section 67 of the High Speed Rail Act

2 Paragraph 3 as substituted by section 11 of, and paragraph 6 of Schedule 14 to, the High Speed Rail Act.

3 Section 3A of the 1981 Act as inserted by paragraph 3(a) of Schedule 6 to the High Speed Rail Act as substituted by section 11 of, and paragraphs 6 and 7 of Schedule 14 to, that Act.

4 Section 6 as modified by paragraph 3(c) of Schedule 6 to the High Speed Rail Act, as substituted by section 11 of, and paragraph 6 of Schedule 14 to, that Act

SCHEDULE

District of Cherwell

(1) Plot No.	(2) Description
66294	All interests in 1921.6 square metres, or thereabouts, of agricultural land (Warren Farm)
66304	All interests in 3096.8 square metres, or thereabouts, of access road and verges (A421)
66306	All interests in 406.0 square metres, or thereabouts, of access road and verges (A421)
66309	All interests in 404.6 square metres, or thereabouts, of access track and hedgerows (A421)
66313	All interests in 56.4 square metres, or thereabouts, of access road (A421)
66323	All interests in 4247.5 square metres, or thereabouts, of agricultural land (Oaks Farm)
66326	All interests in 13444.5 square metres, or thereabouts, of agricultural land, hedgerows and public footpath (303/7/10) (Warren Farm)
66327	All interests in 6466.0 square metres, or thereabouts, of agricultural land and public bridleway (303/8/10) (Fulwell Lane)
66328	All interests in 947.7 square metres, or thereabouts, of agricultural land (Church Lane)
66329	All interests in 3782.0 square metres, or thereabouts, of dismantled railway (Verney Junction to Banbury)
66330	All interests in 1710.3 square metres, or thereabouts, of public road and verges (Church Lane)
66331	All interests in 287.8 square metres, or thereabouts, of agricultural land and public footpath (303/7/10) (Warren Farm)
66334	All interests in 797.5 square metres, or thereabouts, of public road and verges (Fulwell Lane)
66337	All interests in 74.2 square metres, or thereabouts, of access splay and verges (Mixbury Road)
66338	All interests in 78563.0 square metres, or thereabouts, of agricultural land, woodland, hedgerows, drains, access track and public bridleway (303/4/20) (Tibbetts Farm)
66339	All interests in 54640.8 square metres, or thereabouts, of agricultural land, woodland, access tracks, outbuildings, hardstanding, drains, dismantled railway and public bridleways (303/4/30 and 303/22/20) (Tibbetts Farm)
66344	All interests in 2074.0 square metres, or thereabouts, of dismantled railway (Verney Junction to Banbury)
66345	All interests in 2643.9 square metres, or thereabouts, of dismantled railway (Verney Junction to Banbury)
66353	All interests in 59.2 square metres, or thereabouts, of river, bed and banks thereof and bridge over same (River Great Ouse)
66356	All interests in 27.4 square metres, or thereabouts, of river, bed and banks thereof (River Great Ouse)
66362	All interests in 456.1 square metres, or thereabouts, of river, bed and banks thereof (River Great Ouse)
70706	All interests in 24022.6 square metres, or thereabouts, of agricultural land (Tibbetts Farm)
70707	All interests in 2657.8 square metres, or thereabouts, of agricultural land,

	woodland and public footpath (303/6/10) (Tibbetts Farm)
70708	All interests in 832.5 square metres, or thereabouts, of agricultural land (Tibbetts Farm)
70709	All interests in 21285.2 square metres, or thereabouts, of agricultural land (Tibbetts Farm)
70710	All interests in 3097.6 square metres, or thereabouts, of agricultural land, woodland, dismantled railway and public bridleway (303/22/20) (Tibbetts Farm)
70711	All interests in 94.1 square metres, or thereabouts, of woodland (Tibbetts Farm)
70713	All interests in 354.3 square metres, or thereabouts, of agricultural land, access track and woodland (Tibbetts Farm)
70714	All interests in 122.1 square metres, or thereabouts, of access track and public bridleway (303/22/10) (Tibbetts Farm)
70715	All interests in 724.5 square metres, or thereabouts, of access track and public bridleway (303/22/20) (Tibbetts Farm)
70716	All interests in 1464.0 square metres, or thereabouts, of access track, public footpath (303/6/10) and public bridleway (303/22/10) (Tibbetts Farm)
71258	All interests in 454.8 square metres, or thereabouts, of agricultural land (Warren Farm)
71259	All interests in 27338.7 square metres, or thereabouts, of agricultural land, hardstanding and public footpath (213/1/10) (Warren Farm)
71461	All interests in 7361.7 square metres, or thereabouts, of agricultural land (Warren Farm)
71706	All interests in 514.4 square metres, or thereabouts, of woodland and grassland (Town Farm and Fulwell Farm)
71707	All interests in 40.7 square metres, or thereabouts, of agricultural land and public footpath (303/6/10) (Tibbetts Farm)
71708	All interests in 39.2 square metres, or thereabouts, of access track (Tibbetts Farm)

Buckinghamshire

(1) Plot No.	(2) Description
66349	All interests in 9198.8 square metres, or thereabouts, of agricultural land and woodland (Manor Cottage)
66354	All interests in 478.6 square metres, or thereabouts, of river, bed and banks thereof and bridge over same (River Great Ouse)
66363	All interests in 437.5 square metres, or thereabouts, of river, bed and banks thereof (River Great Ouse)
66367	All interests in 27164.0 square metres, or thereabouts, of agricultural land (Mill Farm)
66378	All interests in 23900.9 square metres, or thereabouts, of agricultural land (Mill Farm)
66381	All interests in 2332.1 square metres, or thereabouts, of agricultural land (Mill Farm)
66382	All interests in 839.1 square metres, or thereabouts, of agricultural land and hedgerow (Grovehill Farm)
66392	All interests in 812.0 square metres, or thereabouts, of agricultural land, access track and public footpath (WBB/17/1) (Manor Cottage)
66393	All interests in 2985.1 square metres, or thereabouts, of agricultural land and hedgerow (Grovehill Farm)

66394	All interests in 249.9 square metres, or thereabouts, of hedgerow and copse (Mill Farm)
66397	All interests in 44876.7 square metres, or thereabouts, of agricultural land, hedgerows and public footpath (WBB/17/1) (Mill Farm)
66401	All interests in 1569.1 square metres, or thereabouts, of agricultural land, hedgerow and public footpath (TUW/11/2) (Grovehill Barn)
66404	All interests in 33438.7 square metres, or thereabouts, of agricultural land, hedgerow and public footpath (WBB/17/1) (Mill Farm)
69139	All interests in 7404.5 square metres, or thereabouts, of agricultural land (Manor Cottage)
70712	All interests in 0.4 square metres, or thereabouts, of hedgerow (Mill Farm)
70766	All interests in 9139.1 square metres, or thereabouts, of agricultural land (Mill Farm)
70767	All interests in 35529.6 square metres, or thereabouts, of agricultural land and hedgerow (Mill Farm)
70768	All interests in 8871.0 square metres, or thereabouts, of agricultural land (Mill Farm)

IN WITNESS WHEREOF the Secretary of State for Transport has hereunto set its corporate seal on the day in the year first written above.

The **CORPORATE SEAL** of the SECRETARY OF STATE FOR TRANSPORT hereunto affixed to this deed is authenticated by



.....

Authorised Signatory

Dated: 13 DECEMBER 2021



SEAL REF
DFT GP / 0948

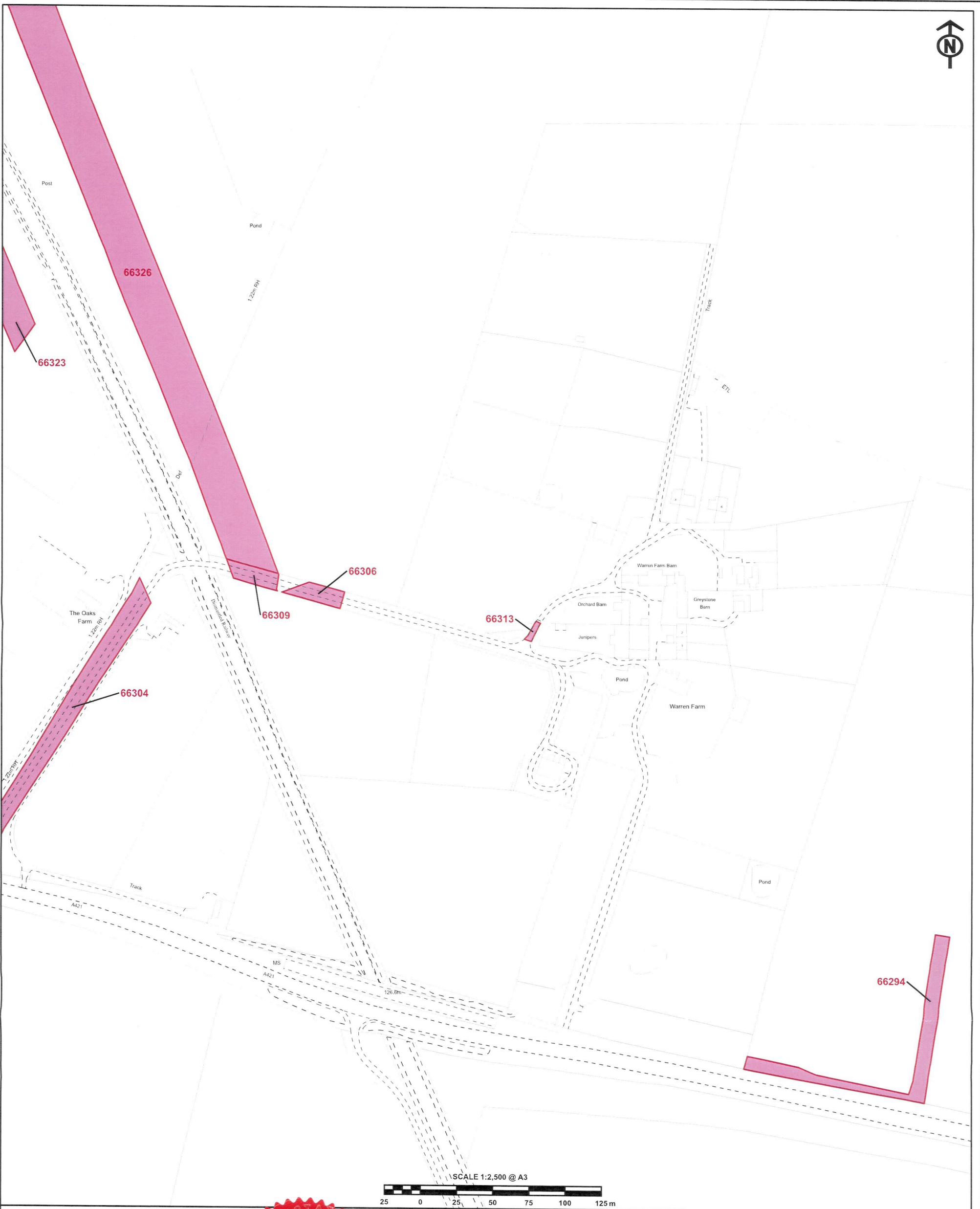

SCALE 1:2,500 @ A3

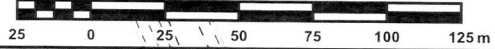

The CORPORATE SEAL of the
SECRETARY OF STATE
hereunto affixed to this deed
is authenticated by

Authorised by the Secretary of State for Transport

Dated 13 DECEMBER 2021



CENTRE POINT: 462,290, 233,261

0918

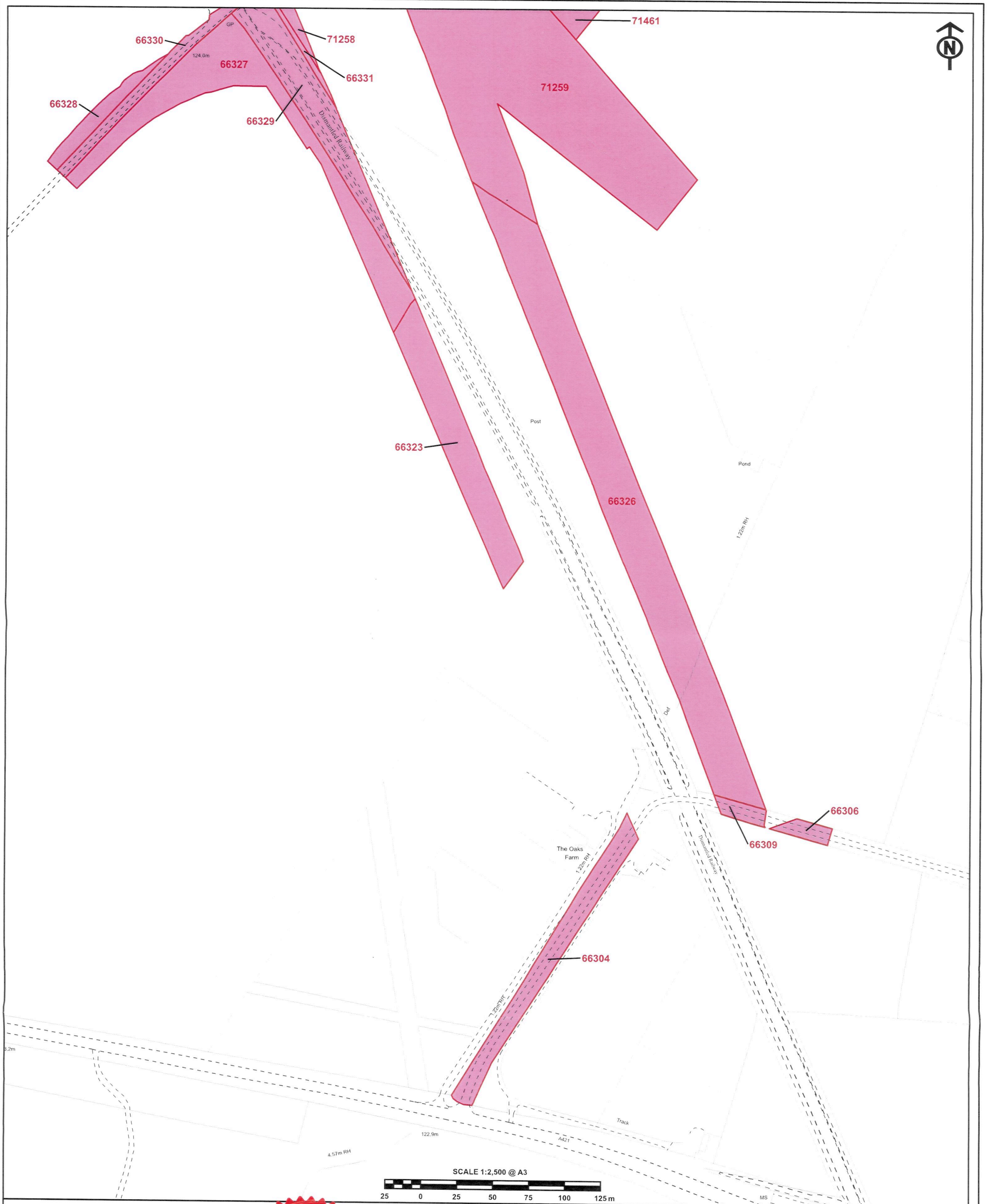

The CORPORATE SEAL of the
SECRETARY OF STATE
hereunto affixed to this deed
is authenticated by

[Signature]

Authorised by the Secretary of State for Transport

Dated 13 DECEMBER 2021

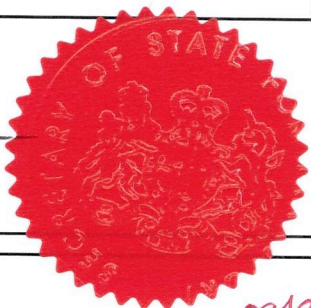

0948

CENTRE POINT: 461,952, 233,424



The CORPORATE SEAL of the
SECRETARY OF STATE
hereunto affixed to this deed
is authenticated by

Authorised by the Secretary of State for Transport

Dated 13 DECEMBER 2021



0948

CENTRE POINT: 461,755, 234,138

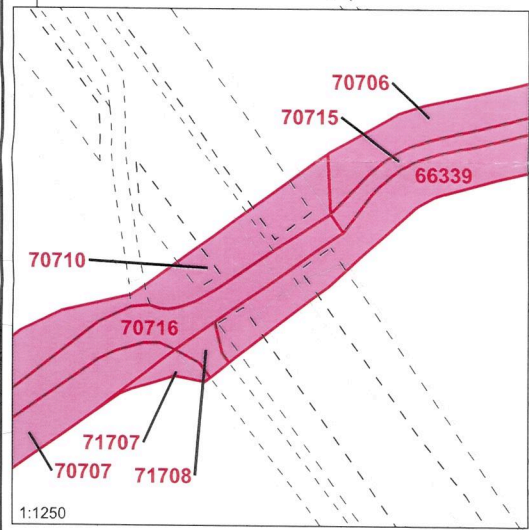
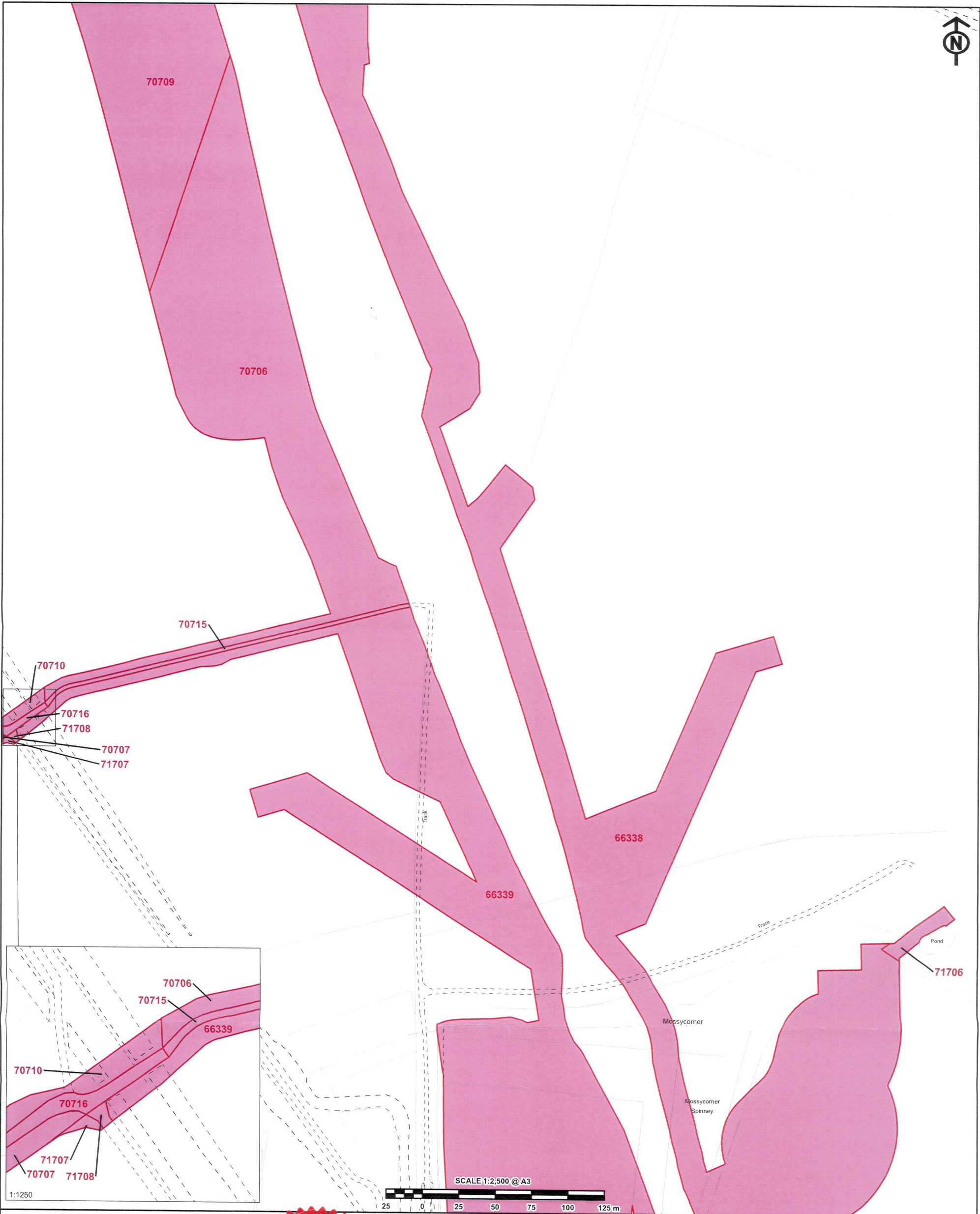

The CORPORATE SEAL of the
SECRETARY OF STATE
hereunto affixed to this deed
is authenticated by

Authorised by the Secretary of State for Transport

Dated 13 DECEMBER 2021



0948

CENTRE POINT: 461,531, 234,729

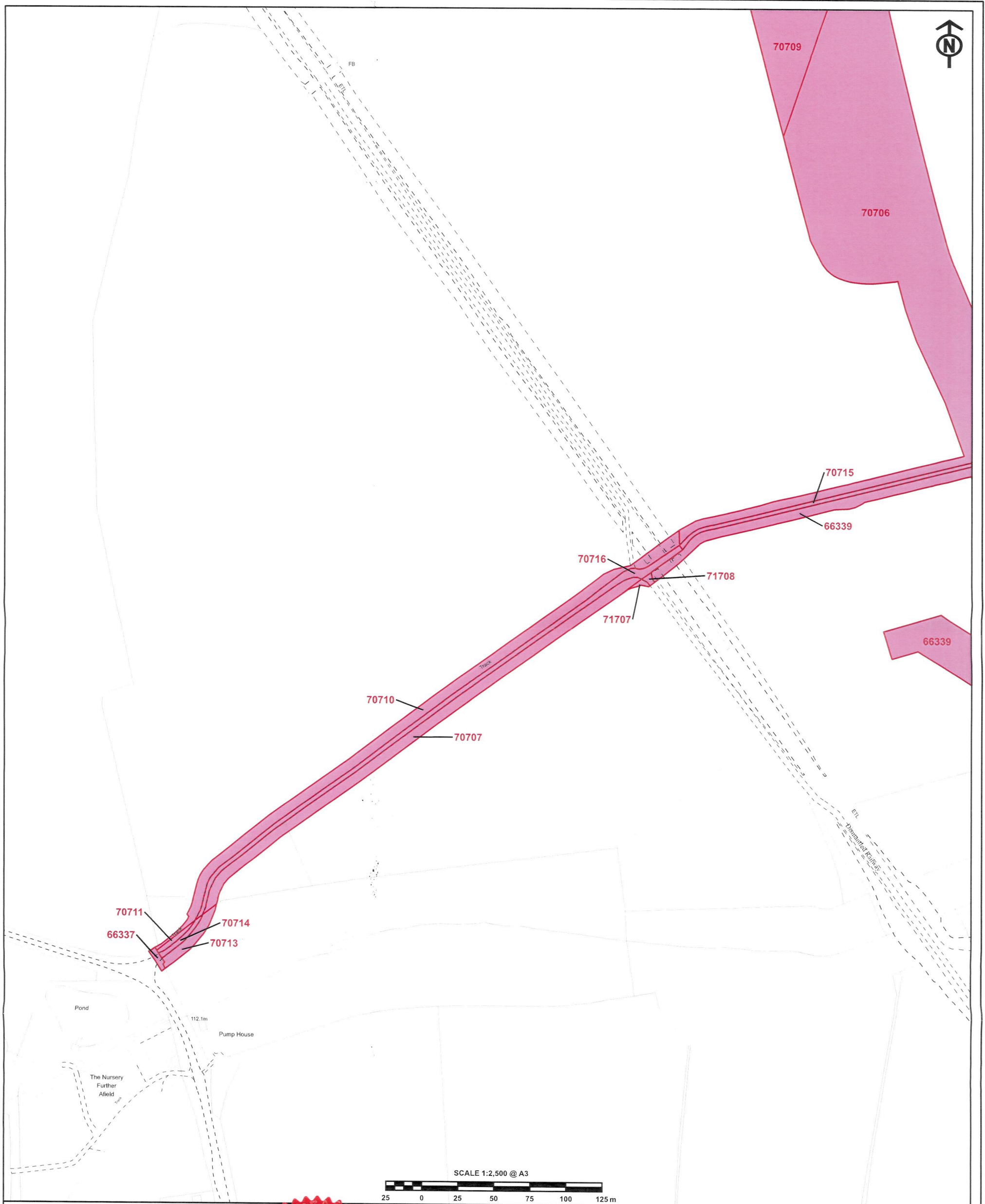

The CORPORATE SEAL of the
SECRETARY OF STATE
hereunto affixed to this deed
is authenticated by

Authorised by the Secretary of State for Transport

Dated 13 DECEMBER 2021

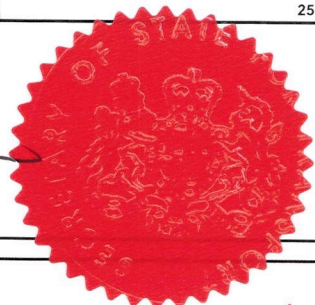

0948

CENTRE POINT: 461,091, 234,618



The CORPORATE SEAL of the
SECRETARY OF STATE
hereunto affixed to this deed
is authenticated by

Authorised by the Secretary of State for Transport

Dated 13 DECEMBER 2021



CENTRE POINT: 461,281, 235,172

0948



The CORPORATE SEAL of the
SECRETARY OF STATE
hereunto affixed to this deed
is authenticated by

Authorised by the Secretary of State for Transport

Dated 13 DECEMBER 2021

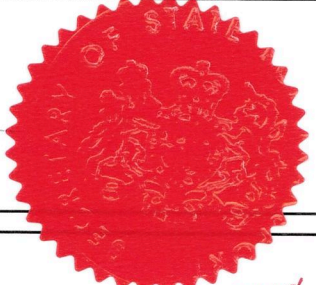

CENTRE POINT: 461,221, 235,736

0948



The CORPORATE SEAL of the
SECRETARY OF STATE
hereunto affixed to this deed
is authenticated by

Authorised by the Secretary of State for Transport

Dated 13 DECEMBER 2021

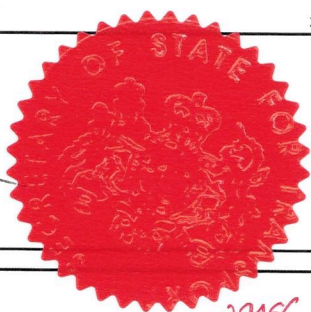

0948

CENTRE POINT: 460,678, 235,749

