

HIGH SPEED RAIL (LONDON – WEST MIDLANDS) ACT 2017

HIGH SPEED RAIL (LONDON – WEST MIDLANDS) GENERAL VESTING DECLARATION No. 775

This **GENERAL VESTING DECLARATION** is executed on 07th FEBRUARY 2022
by the Secretary of State for Transport (“the Authority”).

WHEREAS:

- (1) On 23 February 2017 the High Speed Rail (London – West Midlands) Act 2017 (“the High Speed Rail Act”) received Royal Assent authorising the Authority to acquire the land specified in the Schedule hereto.
- (2) Section 4(1) of the High Speed Rail Act authorises the Authority to acquire compulsorily so much of the land within the limits of the High Speed Rail Act as may be required for Phase One purposes¹.
- (3) Section 8 of the High Speed Rail Act provides that the power under section 4(1) in relation to land may be exercised in relation to the subsoil or under-surface of the land only.
- (4) Section 4(4) of the High Speed Rail Act provides that the Compulsory Purchase (Vesting Declarations) Act 1981 (“the 1981 Act”) applies as if the High Speed Rail Act were a compulsory purchase order and paragraph 3² of Schedule 6 to the High Speed Rail Act provides that the 1981 Act shall have effect subject to the modifications specified in that paragraph.
- (5) Notice pursuant to section 3A³ of the 1981 Act was first published on 01 December 2021. That notice included the particulars specified in section 3A(3) of the 1981 Act.

NOW THIS DEED WITNESSETH that, in exercise of the powers conferred on it by section 4 of the 1981 Act, the Authority hereby declares:-

1. The land described in the Schedule hereto (being part of the land authorised to be acquired by the High Speed Rail Act) and more particularly delineated and shown coloured yellow on the plan annexed hereto, together with the right to enter upon and take possession of the land, shall vest in the Authority as from the end of the period of 3 months from the date on which the service of notices required by section 6⁴ of the 1981 Act is completed.
2. For the purposes of Section 2(2) of the 1981 Act, the specified period in relation to the land comprised in this declaration is one year and one day.

1 Phase One Purposes has meaning given by section 67 of the High Speed Rail Act

2 Paragraph 3 as substituted by section 11 of, and paragraph 6 of Schedule 14 to, the High Speed Rail Act.

3 Section 3A of the 1981 Act as inserted by paragraph 3(a) of Schedule 6 to the High Speed Rail Act as substituted by section 11 of, and paragraphs 6 and 7 of Schedule 14 to, that Act.

4 Section 6 as modified by paragraph 3(c) of Schedule 6 to the High Speed Rail Act, as substituted by section 11 of, and paragraph 6 of Schedule 14 to, that Act

SCHEDULE

London Borough of Camden

(1) Plot No.	(2) Description
08371	All that stratum of subsoil that lies beneath 4887.21 square metres, or thereabouts, of railway (West Coast Main Line), works, land, electricity substations, hardstanding (north of Gloucester Avenue) and tunnels below, the upper extremity of which is 16.0 metres above Ordnance Survey Datum and the lower extremity of which is 4.6 metres below Ordnance Survey Datum.
08375	All that stratum of subsoil that lies beneath 945.41 square metres, or thereabouts, of public road and footways (Gloucester Avenue), the upper extremity of which is 15.2 metres above Ordnance Survey Datum and the lower extremity of which is 3.3 metres below Ordnance Survey Datum, excluding any interest held by the Secretary of State for Transport.
08376	All that stratum of subsoil that lies beneath 782.63 square metres, or thereabouts, of offices, flats, premises, hardstanding and land (36 Gloucester Avenue), the upper extremity of which is 15.4 metres above Ordnance Survey Datum and the lower extremity of which is 3.2 metres below Ordnance Survey Datum, excluding any interest held by the Secretary of State for Transport.
08377	All that stratum of subsoil that lies beneath 17.89 square metres, or thereabouts, of electricity substation and premises (south of 36 Gloucester Avenue), the upper extremity of which is 15.2 metres above Ordnance Survey Datum and the lower extremity of which is 3.1 metres below Ordnance Survey Datum, excluding any interest held by the Secretary of State for Transport.
08378	All that stratum of subsoil that lies beneath 1302.62 square metres, or thereabouts, of land and woodland (off Gloucester Avenue), the upper extremity of which is 15.8 metres above Ordnance Survey Datum and the lower extremity of which is 3.8 metres below Ordnance Survey Datum, excluding any interest held by the Secretary of State for Transport.
08379	All that stratum of subsoil that lies beneath 3717.97 square metres, or thereabouts, of flats, premises, access, hardstanding and land (Darwin Court, Gloucester Avenue), the upper extremity of which is 16.2 metres above Ordnance Survey Datum and the lower extremity of which is 3.1 metres below Ordnance Survey Datum, excluding any interest held by the Secretary of State for Transport.
08381	All that stratum of subsoil that lies beneath 215.90 square metres, or thereabouts, of land and woodland (off Gloucester Avenue), the upper extremity of which is 16.2 metres above Ordnance Survey Datum and the lower extremity of which is 3.2 metres below Ordnance Survey Datum, excluding any interest held by the Secretary of State for Transport.
08385	All that stratum of subsoil that lies beneath 2815.04 square metres, or thereabouts, of public road, footways (Gloucester Avenue and Parkway, A4201) and tunnels carrying railway (West Coast Main Line), works and land below, the upper extremity of which is 19.4 metres above Ordnance Survey Datum and the lower extremity of which is 5.2 metres below Ordnance Survey Datum, excluding any interest held by the Secretary of State for Transport.
08852	All that stratum of subsoil that lies beneath 6.53 square metres, or thereabouts, of shrubland (off Gloucester Avenue), the upper extremity of which is 15.8 metres above Ordnance Survey Datum and the lower extremity of which is 3.1 metres below Ordnance Survey Datum, excluding

	any interest held by the Secretary of State for Transport.
08855	All that stratum of subsoil that lies beneath 178.26 square metres, or thereabouts, of railway works (West Coast Main line) and land, the upper extremity of which is 15.2 metres above Ordnance Survey Datum and the lower extremity of which is 3.5 metres below Ordnance Survey Datum, excluding any interest held by the Secretary of State for Transport.
08856	All that stratum of subsoil that lies beneath 47.95 square metres, or thereabouts, of land and woodland (off Gloucester Avenue), the upper extremity of which is 15.3 metres above Ordnance Survey Datum and the lower extremity of which is 3.0 metres below Ordnance Survey Datum, excluding any interest held by the Secretary of State for Transport.
08857	All that stratum of subsoil that lies beneath 12.08 square metres, or thereabouts, of mast site (66-89 Gloucester Avenue), the upper extremity of which is 15.4 metres above Ordnance Survey Datum and the lower extremity of which is 3.5 metres below Ordnance Survey Datum, excluding any interest held by the Secretary of State for Transport.
08858	All that stratum of subsoil that lies beneath 1045.01 square metres, or thereabouts, of railway (West Coast Main line), the upper extremity of which is 14.9 metres above Ordnance Survey Datum and the lower extremity of which is 5.6 metres below Ordnance Survey Datum.
08860	All that stratum of subsoil that lies beneath 149.99 square metres, or thereabouts, of public road and footway (Delancey Street) and tunnel carrying railway below (West Coast Main Line), the upper extremity of which is 13.1 metres above Ordnance Survey Datum and the lower extremity of which is 5.4 metres below Ordnance Survey Datum, excluding any interest held by the Secretary of State for Transport.
09605	All that stratum of subsoil that lies beneath 362.38 square metres, or thereabouts, of railway (West Coast Main Line), the upper extremity of which is 15.8 metres above Ordnance Survey Datum and the lower extremity of which is 5.4 metres below Ordnance Survey Datum.
09606	All that stratum of subsoil that lies beneath 32.43 square metres, or thereabouts, of accessway leading to flats and premises (1-7, 117 Parkway), the upper extremity of which is 20.2 metres above Ordnance Survey Datum and the lower extremity of which is 2.1 metres above Ordnance Survey Datum, excluding any interest held by the Secretary of State for Transport.
09608	All that stratum of subsoil that lies beneath 123.49 square metres, or thereabouts, of hardstanding, parking spaces (off Delancey Street) and tunnel carrying railway below (West Coast Main Line), the upper extremity of which is 13.0 metres above Ordnance Survey Datum and the lower extremity of which is 5.6 metres below Ordnance Survey Datum, excluding any interest held by the Secretary of State for Transport.
09609	All that stratum of subsoil that lies beneath 868.52 square metres, or thereabouts, of railway (West Coast Main Line), works and land, the upper extremity of which is 15.7 metres above Ordnance Survey Datum and the lower extremity of which is 3.3 metres below Ordnance Survey Datum, excluding any interest held by the Secretary of State for Transport.
09610	All that stratum of subsoil that lies beneath 156.26 square metres, or thereabouts, of hardstanding, shop and premises (115 Parkway) and tunnel carrying railway and works below (West Coast Main Line), the upper extremity of which is 17.1 metres above Ordnance Survey Datum and the lower extremity of which is 5.2 metres below Ordnance Survey Datum, excluding any interest held by the Secretary of State for Transport.
09611	All that stratum of subsoil that lies beneath 101.63 square metres, or thereabouts, of accessway leading to flats and premises (1-7, 117 Parkway), the upper extremity of which is 18.6 metres above Ordnance Survey Datum and the lower extremity of which is 1.1 metres above Ordnance Survey Datum, excluding any interest held by the Secretary of State for Transport.

IN WITNESS WHEREOF the Secretary of State for Transport has hereunto set its corporate seal on the day in the year first written above.

The **CORPORATE SEAL** of the SECRETARY OF STATE FOR TRANSPORT hereunto affixed to this deed is authenticated by

.....

Authorised Signatory



Dated: 07th FEBRUARY 2022

SEAL REF
DIT GP / 0945

Registered in England. Registration number 06791686.
Registered office: 2 Snowhill, Snow Hill Queensway, Birmingham B4 6GA.

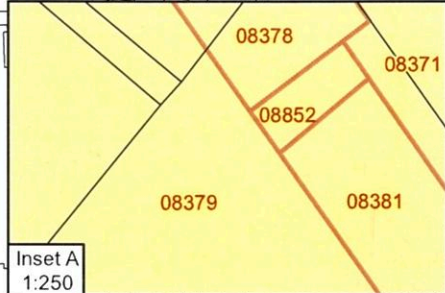

SCALE 1:1,250 @ A3

CENTRE POINT: 528,485, 183,823

The CORPORATE SEAL of the SECRETARY OF STATE hereunto affixed to this deed is authenticated by



Authorised by the Secretary of State for Transport
Dated: 07TH FEBRUARY 2022

© Crown copyright and database rights 2021. Ordnance Survey Licence Number 100049190.
© Crown copyright material is reproduced with the permission of Land Registry under delegated authority from the Controller of HMSO and © Crown Copyright Ordnance Survey.

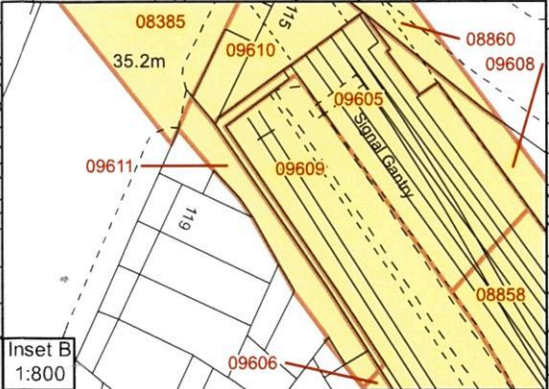
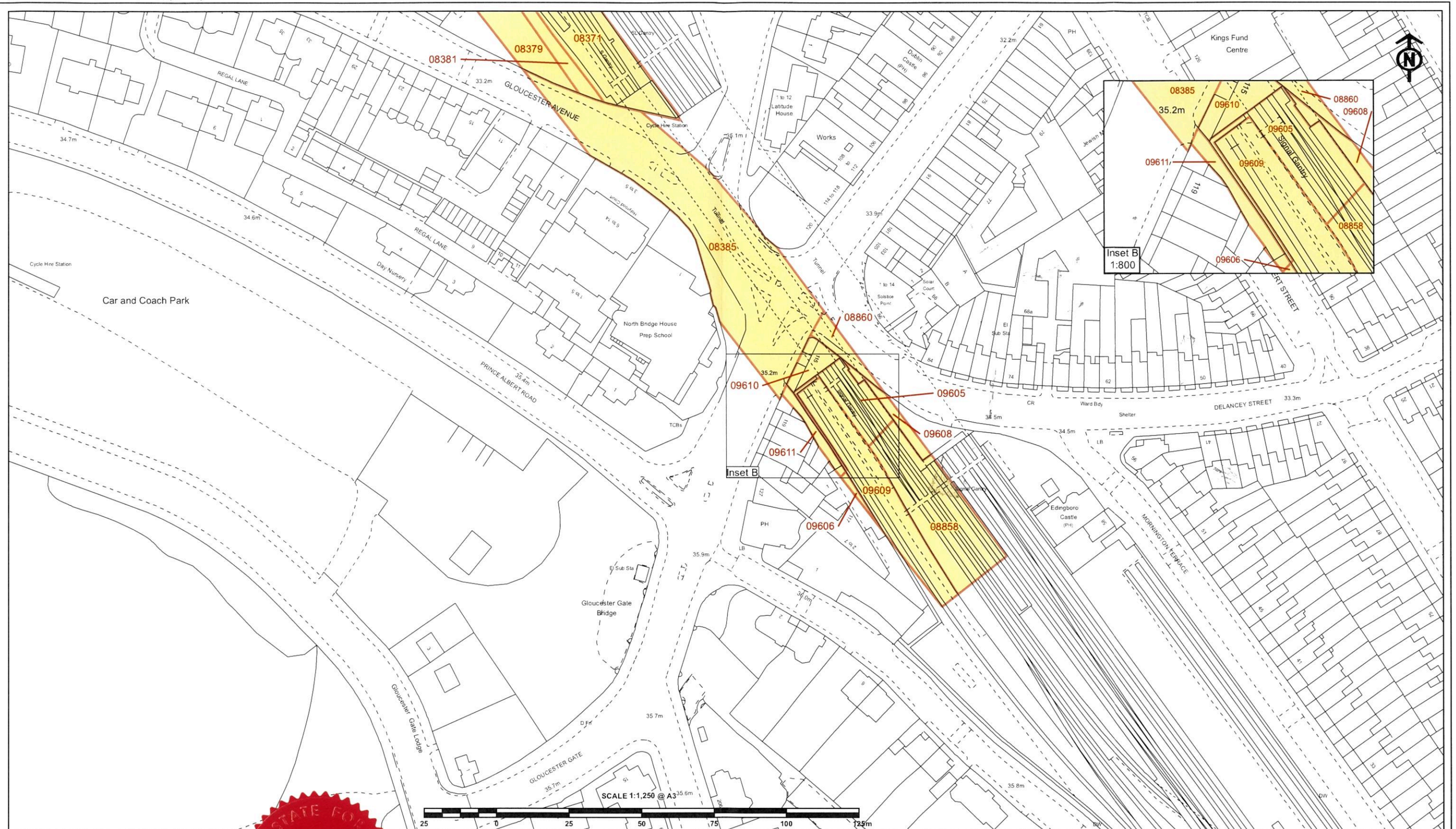

The CORPORATE SEAL of the
SECRETARY OF STATE
hereunto affixed to this deed
is authenticated by

Authorised by the Secretary of State for Transport
Dated: 07TH FEBRUARY 2022.



CENTRE POINT: 528,670, 183,573