

## HIGH SPEED RAIL (LONDON – WEST MIDLANDS) ACT 2017

### HIGH SPEED RAIL (LONDON – WEST MIDLANDS) GENERAL VESTING DECLARATION No. 766

This **GENERAL VESTING DECLARATION** is executed on 02<sup>ND</sup> FEBRUARY 2022 by the Secretary of State for Transport (“the Authority”).

#### WHEREAS:

- (1) On 23 February 2017 the High Speed Rail (London – West Midlands) Act 2017 (“the High Speed Rail Act”) received Royal Assent authorising the Authority to acquire the land specified in the Schedule hereto.
- (2) Section 4(1) of the High Speed Rail Act authorises the Authority to acquire compulsorily so much of the land within the limits of the High Speed Rail Act as may be required for Phase One purposes<sup>1</sup>.
- (3) Section 8 of the High Speed Rail Act provides that the power under section 4(1) in relation to land may be exercised in relation to the subsoil or under-surface of the land only.
- (4) Section 4(4) of the High Speed Rail Act provides that the Compulsory Purchase (Vesting Declarations) Act 1981 (“the 1981 Act”) applies as if the High Speed Rail Act were a compulsory purchase order and paragraph 3<sup>2</sup> of Schedule 6 to the High Speed Rail Act provides that the 1981 Act shall have effect subject to the modifications specified in that paragraph.
- (5) Notice pursuant to section 3A<sup>3</sup> of the 1981 Act was first published on 05 November 2021. That notice included the particulars specified in section 3A(3) of the 1981 Act.

**NOW THIS DEED WITNESSETH** that, in exercise of the powers conferred on it by section 4 of the 1981 Act, the Authority hereby declares:-

1. The land described in the Schedule hereto (being part of the land authorised to be acquired by the High Speed Rail Act) and more particularly delineated and shown coloured yellow on the plan annexed hereto, together with the right to enter upon and take possession of the land, shall vest in the Authority as from the end of the period of 3 months from the date on which the service of notices required by section 6<sup>4</sup> of the 1981 Act is completed.
2. For the purposes of Section 2(2) of the 1981 Act, the specified period in relation to the land comprised in this declaration is one year and one day.

---

1 Phase One Purposes has meaning given by section 67 of the High Speed Rail Act

2 Paragraph 3 as substituted by section 11 of, and paragraph 6 of Schedule 14 to, the High Speed Rail Act.

3 Section 3A of the 1981 Act as inserted by paragraph 3(a) of Schedule 6 to the High Speed Rail Act as substituted by section 11 of, and paragraphs 6 and 7 of Schedule 14 to, that Act.

4 Section 6 as modified by paragraph 3(c) of Schedule 6 to the High Speed Rail Act, as substituted by section 11 of, and paragraph 6 of Schedule 14 to, that Act

## SCHEDULE

London Borough of Camden

(1) Plot No.	(2) Description
08201	All that stratum of subsoil that lies beneath 11663.67 square metres, or thereabouts, of railway (West Coast Main line), works, land, sidings, tow path and bridge carrying railway over, the upper extremity of which is 15.5 metres above Ordnance Survey Datum and the lower extremity of which is 4.7 metres below Ordnance Survey Datum, excluding any interests held by the Secretary of State for Transport.
08204	All that stratum of subsoil that lies beneath 36.68 square metres, or thereabouts, of garden (The Pembroke Castle, 150 Gloucester Avenue), the upper extremity of which is 13.5 metres above Ordnance Survey Datum and the lower extremity of which is 4.7 metres below Ordnance Survey Datum, excluding any interests held by the Secretary of State for Transport.
08212	All that stratum of subsoil that lies beneath 706.49 square metres, or thereabouts, of public road and footways (Gloucester Avenue), the upper extremity of which is 13.6 metres above Ordnance Survey Datum and the lower extremity of which is 4.8 metres below Ordnance Survey Datum, excluding any interests held by the Secretary of State for Transport.
08307	All that stratum of subsoil that lies beneath 12.36 square metres, or thereabouts, of railway works (West Coast Main line), land and garden (The Pembroke Castle, 150 Gloucester Avenue), the upper extremity of which is 13.5 metres above Ordnance Survey Datum and the lower extremity of which is 4.8 metres below Ordnance Survey Datum, excluding any interests held by the Secretary of State for Transport.
08313	All that stratum of subsoil that lies beneath 1069.75 square metres, or thereabouts, of public road and footways (Gloucester Avenue), the upper extremity of which is 15.5 metres above Ordnance Survey Datum and the lower extremity of which is 3.7 metres below Ordnance Survey Datum, excluding any interests held by Canal & River Trust and Secretary of State for Transport.
08315	All that stratum of subsoil that lies beneath 121.11 square metres, or thereabouts, of bridge carrying railway (West Coast Main line), works and land over canal (Grand Union Canal, Regent's Canal), bed, banks thereof and tow path, the upper extremity of which is 15.5 metres above Ordnance Survey Datum and the lower extremity of which is 2.8 metres below Ordnance Survey Datum, excluding any interests held by Canal & River Trust and Secretary of State for Transport.
08316	All that stratum of subsoil that lies beneath 63.64 square metres, or thereabouts, of bridge carrying railway (West Coast Main line), land over canal (Grand Union Canal, Regent's Canal), stairway and canal tow path, the upper extremity of which is 15.5 metres above Ordnance Survey Datum and the lower extremity of which is 2.9 metres below Ordnance Survey Datum, excluding any interests held by Canal & River Trust and Secretary of State for Transport.
08318	All that stratum of subsoil that lies beneath 27.19 square metres, or thereabouts, of railway (West Coast Main line), works, land and footbridge carrying public footway (Regents Park Road), the upper extremity of which is 13.5 metres above Ordnance Survey Datum and the lower extremity of which is 4.8 metres below Ordnance Survey Datum, excluding any interests held by the Secretary of State for Transport.
08319	All that stratum of subsoil that lies beneath 328.17 square metres, or thereabouts, of public road and footways (Regents Park Road), the upper

	extremity of which is 13.5 metres above Ordnance Survey Datum and the lower extremity of which is 4.9 metres below Ordnance Survey Datum, excluding any interests held by the Secretary of State for Transport.
08335	All that stratum of subsoil that lies beneath 4.30 square metres, or thereabouts, of public footway (Gloucester Avenue), the upper extremity of which is 15.5 metres above Ordnance Survey Datum and the lower extremity of which is 2.9 metres below Ordnance Survey Datum, excluding any interests held by the Secretary of State for Transport.

**IN WITNESS WHEREOF** the Secretary of State for Transport has hereunto set its corporate seal on the day in the year first written above.

The **CORPORATE SEAL** of the SECRETARY OF STATE FOR TRANSPORT hereunto affixed to this deed is authenticated by



Authorised Signatory



Dated: 02<sup>ND</sup> FEBRUARY 2022

SEAL REF  
DFT GP / 0941



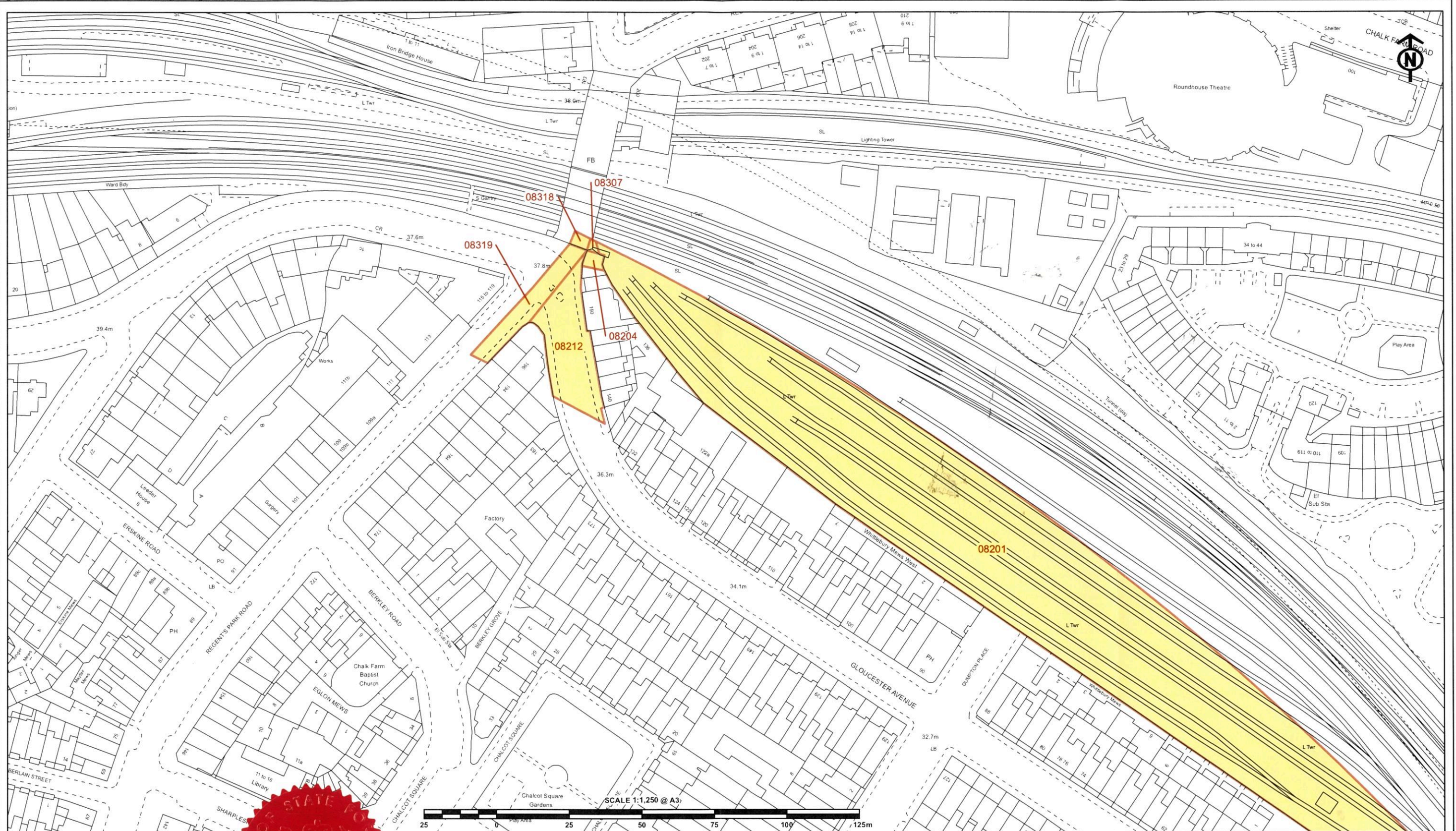

CENTRE POINT: 528,088, 184,203

The CORPORATE SEAL of the  
SECRETARY OF STATE  
hereunto affixed to this deed  
is authenticated by



Authorised by the Secretary of State for Transport

Dated: 02<sup>ND</sup> FEBRUARY 2022

094H







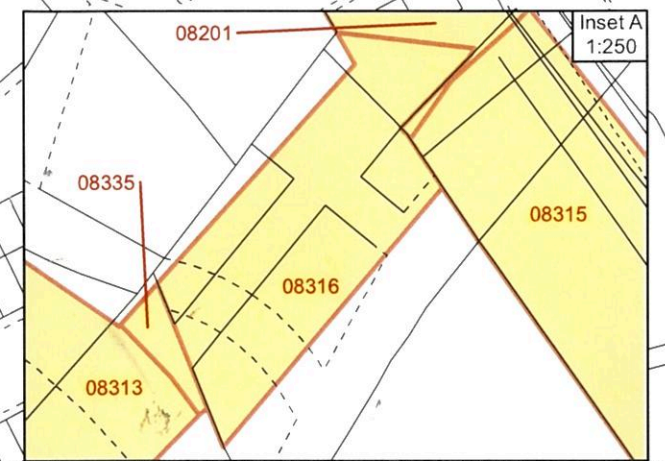
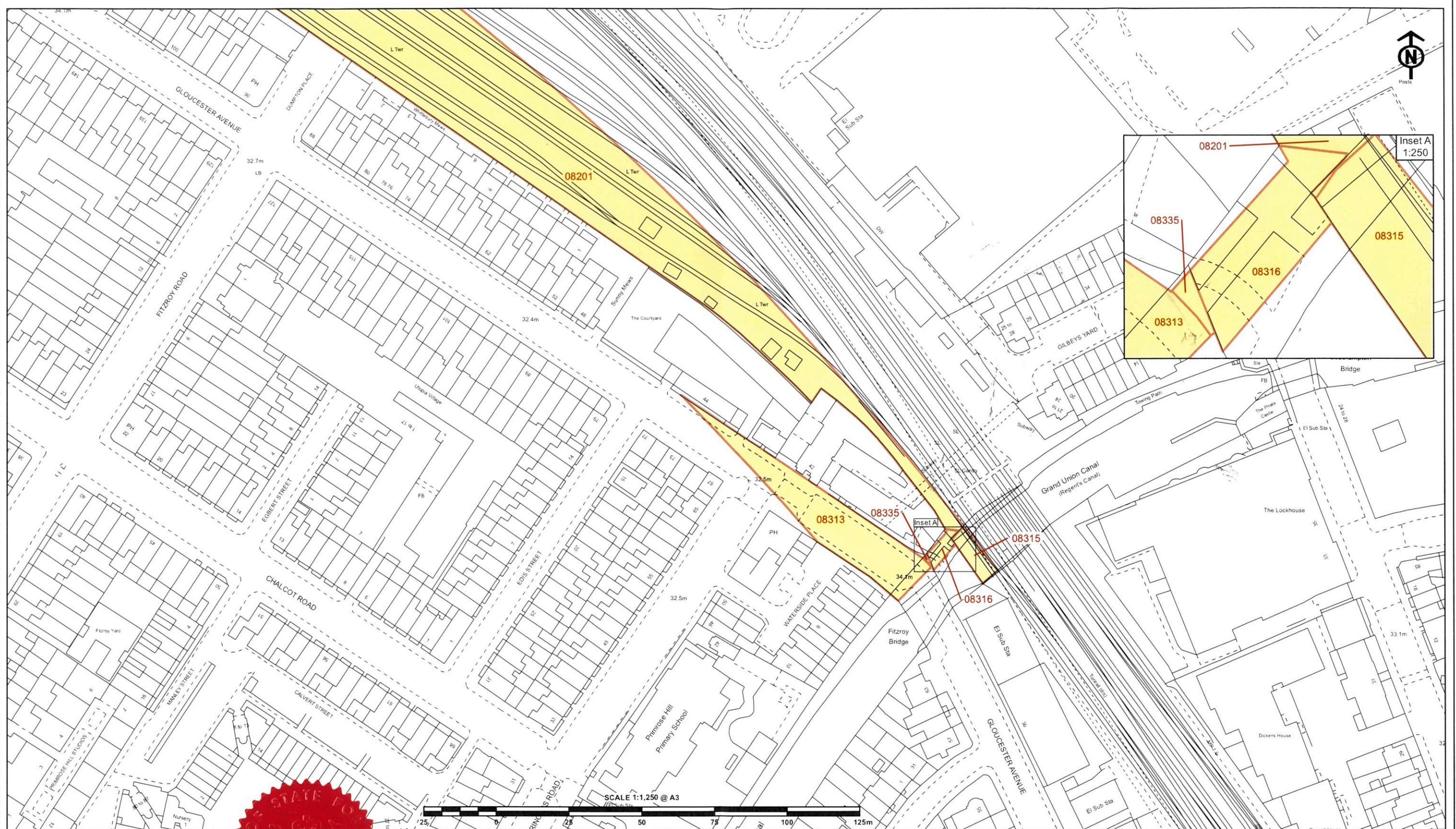

The CORPORATE SEAL of the  
SECRETARY OF STATE  
hereunto affixed to this deed  
is authenticated by



Authorised by the Secretary of State for Transport

Dated: 02<sup>ND</sup> FEBRUARY 2022

0941

CENTRE POINT: 528,320, 184,007