

HIGH SPEED RAIL (LONDON - WEST MIDLANDS) ACT 2017

HIGH SPEED RAIL (LONDON - WEST MIDLANDS) GENERAL VESTING DECLARATION No. 808

This **GENERAL VESTING DECLARATION** is executed on
by the Secretary of State for Transport ("the Authority").

3RD FEBRUARY 2022

WHEREAS:

- (1) On 23 February 2017 the High Speed Rail (London - West Midlands) Act 2017 ("the High Speed Rail Act") received Royal Assent authorising the Authority to acquire the land specified in the Schedule hereto.
- (2) Section 4(1) of the High Speed Rail Act authorises the Authority to acquire compulsorily so much of the land within the limits of the High Speed Rail Act as may be required for Phase One purposes¹.
- (3) Section 8 of the High Speed Rail Act provides that the power under section 4(1) in relation to land may be exercised in relation to the subsoil or under-surface of the land only.
- (4) Section 4(4) of the High Speed Rail Act provides that the Compulsory Purchase (Vesting Declarations) Act 1981 ("the 1981 Act") applies as if the High Speed Rail Act were a compulsory purchase order and paragraph 3² of Schedule 6 to the High Speed Rail Act provides that the 1981 Act shall have effect subject to the modifications specified in that paragraph.
- (5) Notice pursuant to section 3A³ of the 1981 Act was first published on 30 November 2021. That notice included the particulars specified in section 3A(3) of the 1981 Act.

NOW THIS DEED WITNESSETH that, in exercise of the powers conferred on it by section 4 of the 1981 Act, the Authority hereby declares:-

1. The land described in the Schedule hereto (being part of the land authorised to be acquired by the High Speed Rail Act) and more particularly delineated and shown coloured yellow on the plan annexed hereto, together with the right to enter upon and take possession of the land, shall vest in the Authority as from the end of the period of 3 months from the date on which the service of notices required by section 6⁴ of the 1981 Act is completed.
2. For the purposes of Section 2(2) of the 1981 Act, the specified period in relation to the land comprised in this declaration is one year and one day.

1 Phase One Purposes has meaning given by section 67 of the High Speed Rail Act

2 Paragraph 3 as substituted by section 11 of, and paragraph 6 of Schedule 14 to, the High Speed Rail Act.

3 Section 3A of the 1981 Act as inserted by paragraph 3(a) of Schedule 6 to the High Speed Rail Act as substituted by section 11 of, and paragraphs 6 and 7 of Schedule 14 to, that Act.

4 Section 6 as modified by paragraph 3(c) of Schedule 6 to the High Speed Rail Act, as substituted by section 11 of, and paragraph 6 of Schedule 14 to, that Act

SCHEDULE

London Borough of Hammersmith and Fulham

(1) Plot No.	(2) Description
06548	All that stratum of subsoil that lies beneath 3267.43 square metres, or thereabouts, of railway (Great Western Main Line, Elizabeth Line and Engine and Carriage Line), works and land, the upper extremity of which is 16.3 metres above Ordnance Survey Datum and the lower extremity of which is 2.2 metres below Ordnance Survey Datum.
06551	All that stratum of subsoil that lies beneath 342.18 square metres, or thereabouts, of railway (Engine and Carriage Line, Great Western Main Line and Elizabeth Line) and bridge carrying railway (West London Line) over, works and land, the upper extremity of which is 10.3 metres above Ordnance Survey Datum and the lower extremity of which is 8.6 metres below Ordnance Survey Datum.
06552	All that stratum of subsoil that lies beneath 402.58 square metres, or thereabouts, of railway (Engine and Carriage Line, Great Western Main Line and Elizabeth Line) and bridge carrying public road (Mitre Bridge, Scrubs Lane) over, works and land, the upper extremity of which is 9.1 metres above Ordnance Survey Datum and the lower extremity of which is 9.7 metres below Ordnance Survey Datum.
06553	All that stratum of subsoil that lies beneath 616.07 square metres, or thereabouts, of railway (Engine and Carriage Line, Great Western Main Line and Elizabeth Line), works and land, the upper extremity of which is 9.9 metres above Ordnance Survey Datum and the lower extremity of which is 9.2 metres below Ordnance Survey Datum.
06554	All that stratum of subsoil that lies beneath 1151.73 square metres, or thereabouts, of railway (Engine and Carriage Line, Great Western Main Line and Elizabeth Line), works and land, the upper extremity of which is 8.6 metres above Ordnance Survey Datum and the lower extremity of which is 11.3 metres below Ordnance Survey Datum.
09866	All that stratum of subsoil that lies beneath 3288.56 square metres, or thereabouts, of railway (Great Western Main Line, Elizabeth Line and Engine and Carriage Line), works, land and depot, the upper extremity of which is 16.0 metres above Ordnance Survey Datum and the lower extremity of which is 5.0 metres below Ordnance Survey Datum.
09867	All that stratum of subsoil that lies beneath 2996.92 square metres, or thereabouts, of railway (Great Western Main Line, Elizabeth Line and Engine and Carriage Line), works, land and depot, the upper extremity of which is 13.3 metres above Ordnance Survey Datum and the lower extremity of which is 8.3 metres below Ordnance Survey Datum.
09868	All that stratum of subsoil that lies beneath 1169.11 square metres, or thereabouts, of railway (Engine and Carriage Line, Great Western Main Line and Elizabeth Line), works and land, the upper extremity of which is 7.0 metres above Ordnance Survey Datum and the lower extremity of which is 14.3 metres below Ordnance Survey Datum.
09869	All that stratum of subsoil that lies beneath 65.33 square metres, or thereabouts, of railway (Engine and Carriage Line, Great Western Main Line and Elizabeth Line), works and land, the upper extremity of which is 4.0 metres above Ordnance Survey Datum and the lower extremity of which is 15.0 metres below Ordnance Survey Datum.
09946	All that stratum of subsoil that lies beneath 56.78 square metres, or thereabouts, of railway (Elizabeth Line and Engine and Carriage Line), works

	and land, the upper extremity of which is 12.8 metres above Ordnance Survey Datum and the lower extremity of which is 6.8 metres below Ordnance Survey Datum, excluding any interest held by the Secretary of State for Transport.
09947	All that stratum of subsoil that lies beneath 12.70 square metres, or thereabouts, of railway (Elizabeth Line and Engine and Carriage Line), works and land, the upper extremity of which is 11.1 metres above Ordnance Survey Datum and the lower extremity of which is 7.8 metres below Ordnance Survey Datum, excluding any interest held by the Secretary of State for Transport.
09948	All that stratum of subsoil that lies beneath 0.04 square metres, or thereabouts, of railway (Elizabeth Line and Engine and Carriage Line), works and land, the upper extremity of which is 10.30 metres above Ordnance Survey Datum and the lower extremity of which is 7.90 metres below Ordnance Survey Datum, excluding any interest held by the Secretary of State for Transport.
09949	All that stratum of subsoil that lies beneath 7.47 square metres, or thereabouts, of railway (Engine and Carriage Line and Elizabeth Line) and bridge carrying railway (West London Line) over, works and land, the upper extremity of which is 10.3 metres above Ordnance Survey Datum and the lower extremity of which is 8.3 metres below Ordnance Survey Datum, excluding any interest held by the Secretary of State for Transport.
09950	All that stratum of subsoil that lies beneath 81.06 square metres, or thereabouts, of railway (Engine and Carriage Line and Elizabeth Line), works and land, the upper extremity of which is 9.9 metres above Ordnance Survey Datum and the lower extremity of which is 9.2 metres below Ordnance Survey Datum, excluding any interest held by the Secretary of State for Transport.
09951	All that stratum of subsoil that lies beneath 80.02 square metres, or thereabouts, of railway (Engine and Carriage Line and Elizabeth Line) and bridge carrying public road (Mitre Bridge, Scrubs Lane) over, works and land, the upper extremity of which is 9.0 metres above Ordnance Survey Datum and the lower extremity of which is 9.7 metres below Ordnance Survey Datum, excluding any interest held by the Secretary of State for Transport.
09952	All that stratum of subsoil that lies beneath 470.39 square metres, or thereabouts, of railway (Engine and Carriage Line and Elizabeth Line), works and land, the upper extremity of which is 8.5 metres above Ordnance Survey Datum and the lower extremity of which is 11.3 metres below Ordnance Survey Datum, excluding any interest held by the Secretary of State for Transport.
09953	All that stratum of subsoil that lies beneath 1214.73 square metres, or thereabouts, of railway (Engine and Carriage Line and Elizabeth Line), works and land, the upper extremity of which is 7.0 metres above Ordnance Survey Datum and the lower extremity of which is 14.3 metres below Ordnance Survey Datum, excluding any interest held by the Secretary of State for Transport.
09954	All that stratum of subsoil that lies beneath 559.20 square metres, or thereabouts, of railway (Engine and Carriage Line and Elizabeth Line), works and land, the upper extremity of which is 4.0 metres above Ordnance Survey Datum and the lower extremity of which is 15.6 metres below Ordnance Survey Datum, excluding any interest held by the Secretary of State for Transport.
09955	All that stratum of subsoil that lies beneath 426.56 square metres, or thereabouts, of railway (Engine and Carriage Line and Elizabeth Line), works and land, the upper extremity of which is 2.7 metres above Ordnance Survey Datum and the lower extremity of which is 17.4 metres below Ordnance Survey Datum.

IN WITNESS WHEREOF the Secretary of State for Transport has hereunto set its corporate seal on the day in the year first written above.

The **CORPORATE SEAL** of the SECRETARY OF STATE FOR TRANSPORT hereunto affixed to this deed is authenticated by



Authorised Signatory



SEAL REF
DfT GP / 1083

Dated : 3rd FEBRUARY 2022

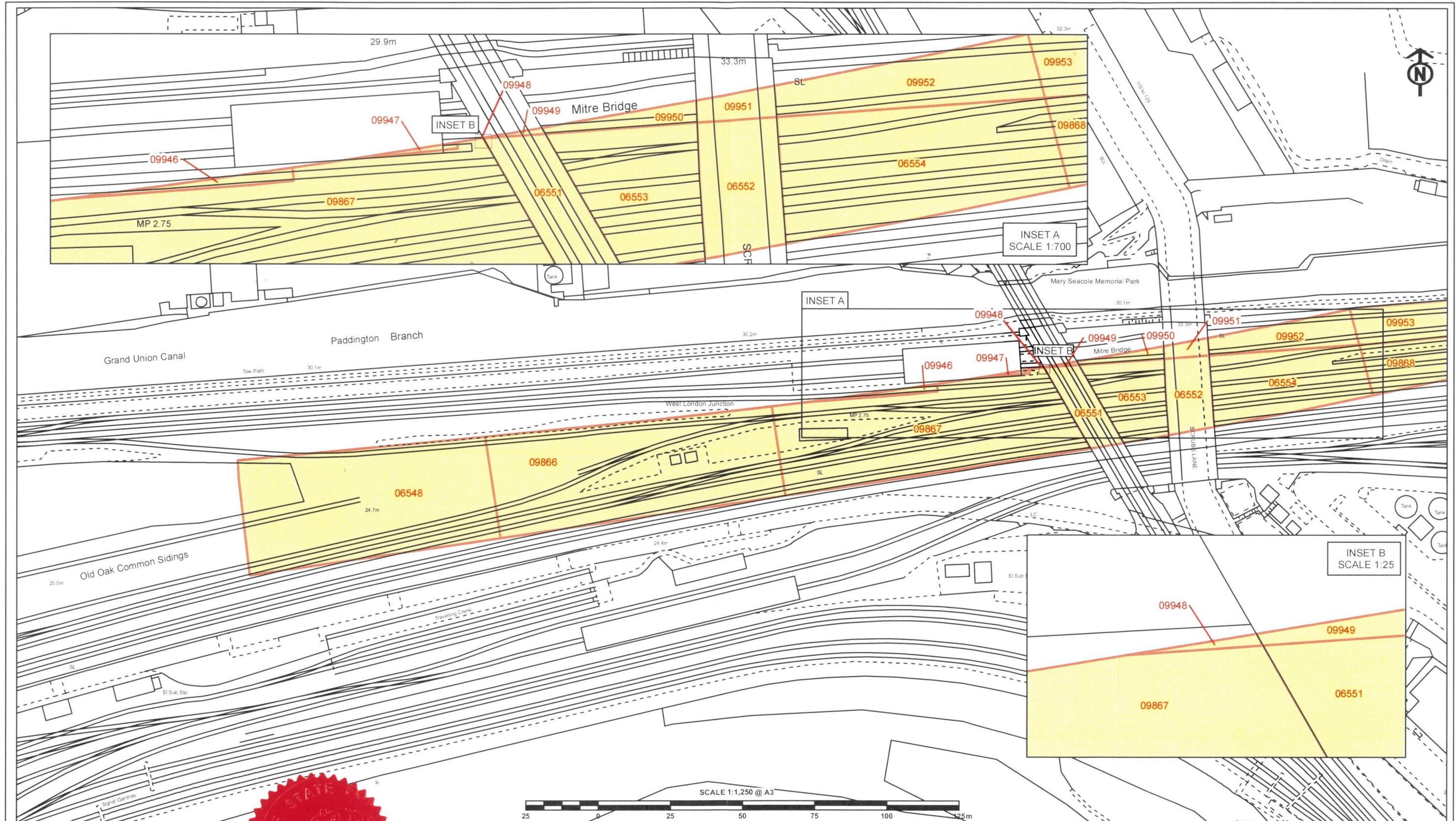

The CORPORATE SEAL of the
SECRETARY OF STATE
hereunto affixed to this deed
is authenticated by

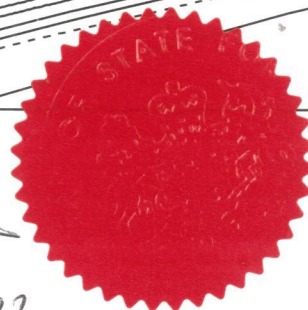

SEAL REF
DFT GP/11083

Authorised by the Secretary of State for Transport

Dated 3rd FEBRUARY 2022

CENTRE POINT: 522,420, 182,227

© Crown copyright and database rights 2021. Ordnance Survey Licence Number 100049190.
© Crown copyright material is reproduced with the permission of Land Registry under
delegated authority from the Controller of HMSO and © Crown Copyright Ordnance Survey.



SCALE 1:1,250 @ A3



CENTRE POINT: 522,819, 182,260

The CORPORATE SEAL of the
SECRETARY OF STATE
hereunto affixed to this deed
is authenticated by

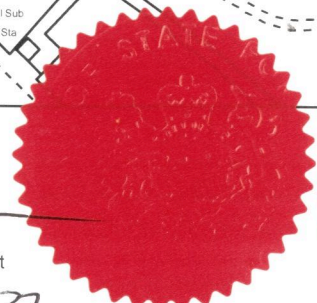

SEAL REF
DFT GP/11083

Authorised by the Secretary of State for Transport

Dated **3rd FEBRUARY 2021**