

## HIGH SPEED RAIL (LONDON - WEST MIDLANDS) ACT 2017

### HIGH SPEED RAIL (LONDON - WEST MIDLANDS) GENERAL VESTING DECLARATION No. 802

This **GENERAL VESTING DECLARATION** is executed on  
by the Secretary of State for Transport ("the Authority").

20 DECEMBER 2021

#### WHEREAS:

- (1) On 23 February 2017 the High Speed Rail (London - West Midlands) Act 2017 ("the High Speed Rail Act") received Royal Assent authorising the Authority to acquire the land specified in the Schedule hereto.
- (2) Section 4(1) of the High Speed Rail Act authorises the Authority to acquire compulsorily so much of the land within the limits of the High Speed Rail Act as may be required for Phase One purposes<sup>1</sup>.
- (3) Section 8 of the High Speed Rail Act provides that the power under section 4(1) in relation to land may be exercised in relation to the subsoil or under-surface of the land only.
- (4) Section 4(4) of the High Speed Rail Act provides that the Compulsory Purchase (Vesting Declarations) Act 1981 ("the 1981 Act") applies as if the High Speed Rail Act were a compulsory purchase order and paragraph 3<sup>2</sup> of Schedule 6 to the High Speed Rail Act provides that the 1981 Act shall have effect subject to the modifications specified in that paragraph.
- (5) Notice pursuant to section 3A<sup>3</sup> of the 1981 Act was first published on 03 December 2021. That notice included the particulars specified in section 3A(3) of the 1981 Act.

**NOW THIS DEED WITNESSETH** that, in exercise of the powers conferred on it by section 4 of the 1981 Act, the Authority hereby declares:-

1. The land described in the Schedule hereto (being part of the land authorised to be acquired by the High Speed Rail Act) and more particularly delineated and shown coloured yellow on the plan annexed hereto, together with the right to enter upon and take possession of the land, shall vest in the Authority as from the end of the period of 3 months from the date on which the service of notices required by section 6<sup>4</sup> of the 1981 Act is completed.
2. For the purposes of Section 2(2) of the 1981 Act, the specified period in relation to the land comprised in this declaration is one year and one day.

---

1 Phase One Purposes has meaning given by section 67 of the High Speed Rail Act

2 Paragraph 3 as substituted by section 11 of, and paragraph 6 of Schedule 14 to, the High Speed Rail Act.

3 Section 3A of the 1981 Act as inserted by paragraph 3(a) of Schedule 6 to the High Speed Rail Act as substituted by section 11 of, and paragraphs 6 and 7 of Schedule 14 to, that Act.

4 Section 6 as modified by paragraph 3(c) of Schedule 6 to the High Speed Rail Act, as substituted by section 11 of, and paragraph 6 of Schedule 14 to, that Act

## SCHEDULE

London Borough of Ealing

(1) Plot No.	(2) Description
04797	All that stratum of subsoil that lies beneath 21448.59 square metres, or thereabouts, of railway (Acton-Northolt Line), works, land, bridge carrying public footway above, outbuilding, mast, electricity substation, hardstanding, access and woodland, the upper extremity of which is 20.4 metres above Ordnance Survey Datum and the lower extremity of which is 5.5 metres below Ordnance Survey Datum.
04798	All that stratum of subsoil that lies beneath 79.34 square metres, or thereabouts, of car park, hardstanding and land (off Mandeville Road), the upper extremity of which is 21.0 metres above Ordnance Survey Datum and the lower extremity of which is 1.0 metres above Ordnance Survey Datum.
04799	All that stratum of subsoil that lies beneath 4203.38 square metres, or thereabouts, of woodland and hardstanding (off Mandeville Road), the upper extremity of which is 21.3 metres above Ordnance Survey Datum and the lower extremity of which is 0.9 metres above Ordnance Survey Datum.
04800	All that stratum of subsoil that lies beneath 48.54 square metres, or thereabouts, of land, hardstanding and access (off Mandeville Road), the upper extremity of which is 20.5 metres above Ordnance Survey Datum and the lower extremity of which is 0.9 metres above Ordnance Survey Datum.
04801	All that stratum of subsoil that lies beneath 9.19 square metres, or thereabouts, of public road and footway (Mandeville Road), the upper extremity of which is 20.4 metres above Ordnance Survey Datum and the lower extremity of which is 0.7 metres above Ordnance Survey Datum.
04802	All that stratum of subsoil that lies beneath 70.48 square metres, or thereabouts, of private accessway (south of Badminton Close), the upper extremity of which is 20.3 metres above Ordnance Survey Datum and the lower extremity of which is 0.6 metres above Ordnance Survey Datum.
04803	All that stratum of subsoil that lies beneath 25.96 square metres, or thereabouts, of gardens (217-221 (odd only) Carr Road), the upper extremity of which is 18.6 metres above Ordnance Survey Datum and the lower extremity of which is 1.1 metres below Ordnance Survey Datum.
04804	All that stratum of subsoil that lies beneath 145.84 square metres, or thereabouts, of gardens (209-211 (odd) Carr Road), the upper extremity of which is 18.5 metres above Ordnance Survey Datum and the lower extremity of which is 1.3 metres below Ordnance Survey Datum.
04805	All that stratum of subsoil that lies beneath 32.67 square metres, or thereabouts, of garden and outbuilding (215 Carr Road), the upper extremity of which is 18.5 metres above Ordnance Survey Datum and the lower extremity of which is 1.1 metres below Ordnance Survey Datum.
04806	All that stratum of subsoil that lies beneath 35.32 square metres, or thereabouts, of garden (213 Carr Road), the upper extremity of which is 18.5 metres above Ordnance Survey Datum and the lower extremity of which is 1.2 metres below Ordnance Survey Datum.
04807	All that stratum of subsoil that lies beneath 91.83 square metres, or thereabouts, of garden and outbuildings (197 Carr Road), the upper extremity of which is 18.1 metres above Ordnance Survey Datum and the lower extremity of which is 1.5 metres below Ordnance Survey Datum.
04808	All that stratum of subsoil that lies beneath 533.56 square metres, or thereabouts, of gardens (199-207 (odd) Carr Road), the upper extremity of which is 18.4 metres above Ordnance Survey Datum and the lower extremity of which is 1.5 metres below Ordnance Survey Datum.

04809	All that stratum of subsoil that lies beneath 83.72 square metres, or thereabouts, of garden (195 Carr Road), the upper extremity of which is 18.1 metres above Ordnance Survey Datum and the lower extremity of which is 1.6 metres below Ordnance Survey Datum.
04810	All that stratum of subsoil that lies beneath 113.00 square metres, or thereabouts, of garden (193 Carr Road), the upper extremity of which is 18.0 metres above Ordnance Survey Datum and the lower extremity of which is 1.6 metres below Ordnance Survey Datum.
04811	All that stratum of subsoil that lies beneath 88.40 square metres, or thereabouts, of garden (191 Carr Road), the upper extremity of which is 18.0 metres above Ordnance Survey Datum and the lower extremity of which is 1.7 metres below Ordnance Survey Datum.
04812	All that stratum of subsoil that lies beneath 127.73 square metres, or thereabouts, of gardens (187 and 189 Carr Road), the upper extremity of which is 17.9 metres above Ordnance Survey Datum and the lower extremity of which is 1.8 metres below Ordnance Survey Datum.
04813	All that stratum of subsoil that lies beneath 66.81 square metres, or thereabouts, of garden (185 Carr Road), the upper extremity of which is 17.8 metres above Ordnance Survey Datum and the lower extremity of which is 1.9 metres below Ordnance Survey Datum.
04814	All that stratum of subsoil that lies beneath 146.41 square metres, or thereabouts, of gardens (179 to 183 (odd only) Carr Road), the upper extremity of which is 17.7 metres above Ordnance Survey Datum and the lower extremity of which is 2.0 metres below Ordnance Survey Datum.
04815	All that stratum of subsoil that lies beneath 49.83 square metres, or thereabouts, of garden (177 Carr Road), the upper extremity of which is 17.6 metres above Ordnance Survey Datum and the lower extremity of which is 2.1 metres below Ordnance Survey Datum.
04816	All that stratum of subsoil that lies beneath 85.90 square metres, or thereabouts, of gardens (173 and 175 Carr Road), the upper extremity of which is 17.5 metres above Ordnance Survey Datum and the lower extremity of which is 2.2 metres below Ordnance Survey Datum.
04817	All that stratum of subsoil that lies beneath 30.10 square metres, or thereabouts, of garden (171 Carr Road), the upper extremity of which is 17.4 metres above Ordnance Survey Datum and the lower extremity of which is 2.3 metres below Ordnance Survey Datum.
04818	All that stratum of subsoil that lies beneath 37.24 square metres, or thereabouts, of garden (169 Carr Road), the upper extremity of which is 17.3 metres above Ordnance Survey Datum and the lower extremity of which is 2.3 metres below Ordnance Survey Datum.
04819	All that stratum of subsoil that lies beneath 155.75 square metres, or thereabouts, of gardens (161 to 167 (odd only) Carr Road), the upper extremity of which is 17.3 metres above Ordnance Survey Datum and the lower extremity of which is 2.7 metres below Ordnance Survey Datum.
04820	All that stratum of subsoil that lies beneath 123.51 square metres, or thereabouts, of garden, bin shelter, hardstanding and land (off Cherry Gardens), the upper extremity of which is 16.9 metres above Ordnance Survey Datum and the lower extremity of which is 3.1 metres below Ordnance Survey Datum.
04821	All that stratum of subsoil that lies beneath 17.92 square metres, or thereabouts, of garden (23 Cherry Gardens), the upper extremity of which is 16.5 metres above Ordnance Survey Datum and the lower extremity of which is 3.2 metres below Ordnance Survey Datum.
04822	All that stratum of subsoil that lies beneath 18.25 square metres, or thereabouts, of garden (22 Cherry Gardens), the upper extremity of which is 16.5 metres above Ordnance Survey Datum and the lower extremity of which is 3.2 metres below Ordnance Survey Datum.
04823	All that stratum of subsoil that lies beneath 18.54 square metres, or thereabouts, of garden (20 Cherry Gardens), the upper extremity of which is



	16.4 metres above Ordnance Survey Datum and the lower extremity of which is 3.3 metres below Ordnance Survey Datum.
04824	All that stratum of subsoil that lies beneath 18.55 square metres, or thereabouts, of garden (21 Cherry Gardens), the upper extremity of which is 16.4 metres above Ordnance Survey Datum and the lower extremity of which is 3.2 metres below Ordnance Survey Datum.
04825	All that stratum of subsoil that lies beneath 19.82 square metres, or thereabouts, of garden and outbuildings (16 Cherry Gardens), the upper extremity of which is 16.2 metres above Ordnance Survey Datum and the lower extremity of which is 3.5 metres below Ordnance Survey Datum.
04826	All that stratum of subsoil that lies beneath 20.69 square metres, or thereabouts, of garden (17 Cherry Gardens), the upper extremity of which is 16.2 metres above Ordnance Survey Datum and the lower extremity of which is 3.4 metres below Ordnance Survey Datum.
04827	All that stratum of subsoil that lies beneath 21.12 square metres, or thereabouts, of garden (18 Cherry Gardens), the upper extremity of which is 16.3 metres above Ordnance Survey Datum and the lower extremity of which is 3.4 metres below Ordnance Survey Datum.
04828	All that stratum of subsoil that lies beneath 21.76 square metres, or thereabouts, of garden (24 Cherry Gardens), the upper extremity of which is 16.6 metres above Ordnance Survey Datum and the lower extremity of which is 3.1 metres below Ordnance Survey Datum.
04829	All that stratum of subsoil that lies beneath 27.45 square metres, or thereabouts, of garden and outbuilding (19 Cherry Gardens), the upper extremity of which is 16.3 metres above Ordnance Survey Datum and the lower extremity of which is 3.3 metres below Ordnance Survey Datum.
04832	All that stratum of subsoil that lies beneath 380.85 square metres, or thereabouts, of land and woodland (off Cherry Gardens), the upper extremity of which is 16.1 metres above Ordnance Survey Datum and the lower extremity of which is 4.1 metres below Ordnance Survey Datum.
04833	All that stratum of subsoil that lies beneath 654.20 square metres, or thereabouts, of car park and hardstanding (off Mandeville Road), the upper extremity of which is 20.7 metres above Ordnance Survey Datum and the lower extremity of which is 0.9 metres above Ordnance Survey Datum.
04834	All that stratum of subsoil that lies beneath 634.65 square metres, or thereabouts, of bridge carrying public road and footways (Mandeville Road) above railway (Acton- Northolt Line), works and land, the upper extremity of which is 20.5 metres above Ordnance Survey Datum and the lower extremity of which is 0.7 metres above Ordnance Survey Datum.
04835	All that stratum of subsoil that lies beneath 233.62 square metres, or thereabouts, of woodland, land, access and hardstanding (off Mandeville Road), the upper extremity of which is 20.5 metres above Ordnance Survey Datum and the lower extremity of which is 0.8 metres above Ordnance Survey Datum.
04836	All that stratum of subsoil that lies beneath 30.66 square metres, or thereabouts, of railway (Acton-Northolt Line), works and land, the upper extremity of which is 22.4 metres above Ordnance Survey Datum and the lower extremity of which is 2.6 metres above Ordnance Survey Datum.
04837	All that stratum of subsoil that lies beneath 182.82 square metres, or thereabouts, of public road, ramp carrying public road (Eastcote Lane) over land, the upper extremity of which is 22.4 metres above Ordnance Survey Datum and the lower extremity of which is 2.7 metres above Ordnance Survey Datum.
04838	All that stratum of subsoil that lies beneath 8921.52 square metres, or thereabouts, of railway (Acton-Northolt Line), works, land, woodland and electricity substation (off Eastcote Lane), the upper extremity of which is 22.4 metres above Ordnance Survey Datum and the lower extremity of which is 1.0 metres above Ordnance Survey Datum.
04839	All that stratum of subsoil that lies beneath 67.65 square metres, or

	thereabouts, of railway (Acton-Northolt Line), works and land and bridge carrying public road (Eastcote Lane) over, the upper extremity of which is 22.4 metres above Ordnance Survey Datum and the lower extremity of which is 2.7 metres above Ordnance Survey Datum.
04840	All that stratum of subsoil that lies beneath 96.65 square metres, or thereabouts, of railway (Acton-Northolt Line) works and land, the upper extremity of which is 20.6 metres above Ordnance Survey Datum and the lower extremity of which is 0.9 metres above Ordnance Survey Datum.
04841	All that stratum of subsoil that lies beneath 156.45 square metres, or thereabouts, of bridge carrying public road and footways (Mandeville Road) above railway (Acton-Northolt Line), works and land, the upper extremity of which is 20.5 metres above Ordnance Survey Datum and the lower extremity of which is 0.8 metres above Ordnance Survey Datum.
30369	All that stratum of subsoil that lies beneath 5978.61 square metres, or thereabouts, of railway works and land (Acton-Northolt Line), the upper extremity of which is 20.4 metres above Ordnance Survey Datum and the lower extremity of which is 5.5 metres below Ordnance Survey Datum.

**IN WITNESS WHEREOF** the Secretary of State for Transport has hereunto set its corporate seal on the day in the year first written above.

The **CORPORATE SEAL** of the SECRETARY OF STATE FOR TRANSPORT hereunto affixed to this deed is authenticated by

  
.....

Authorised Signatory



Dated : 20 DECEMBER 2021

SEAL REF  
DFT GP / 1002



## HIGH SPEED RAIL (LONDON – WEST MIDLANDS) ACT 2017 GENERAL VESTING DECLARATION No. 802 SHEET 1 of 3

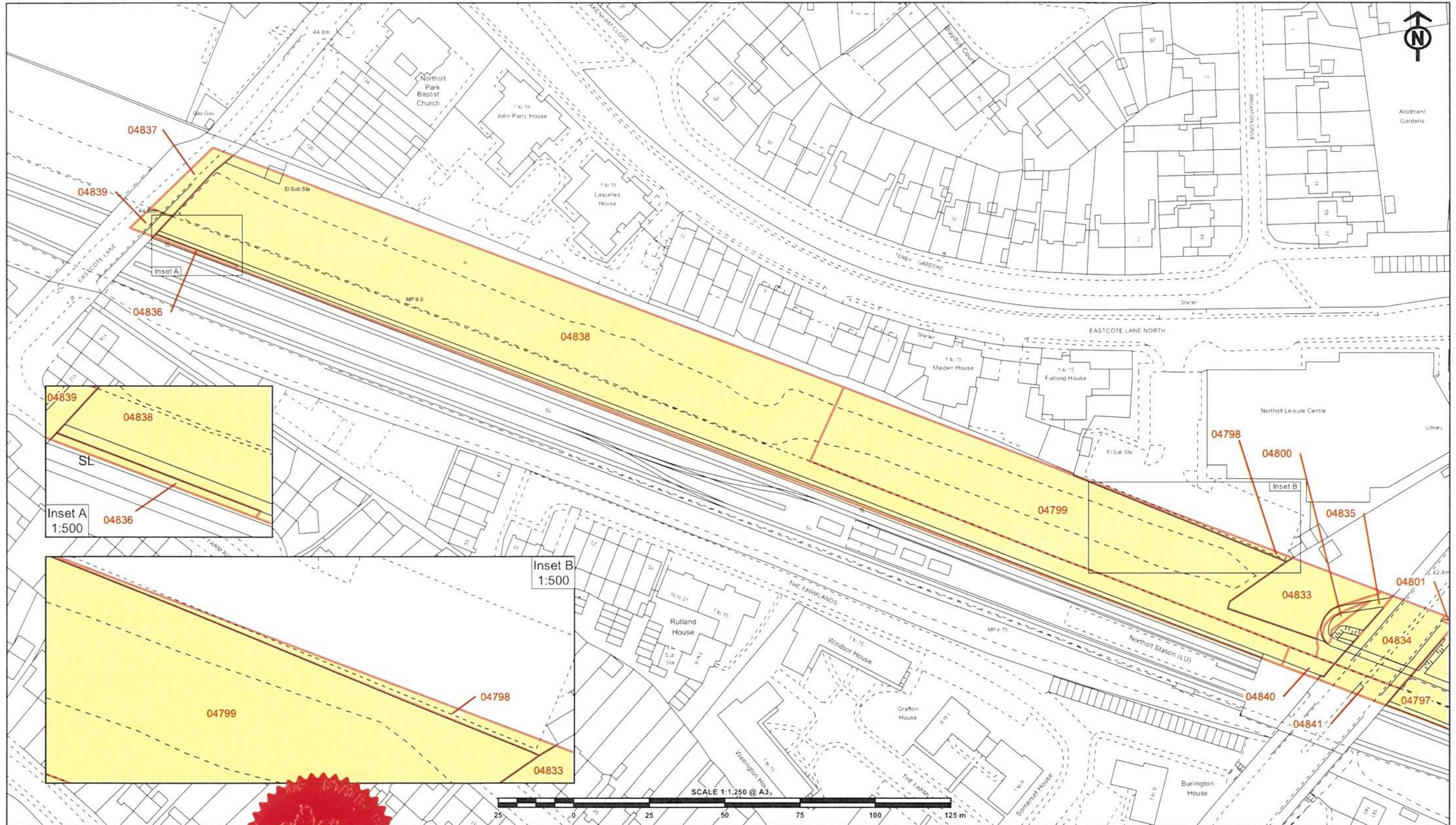

The CORPORATE SEAL of the  
SECRETARY OF STATE  
hereunto affixed to this deed  
is authenticated by

  
Authorised by the Secretary of State for Transport

Dated: 20 DECEMBER 2021

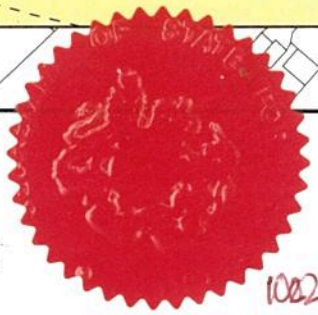

CENTRE POINT: 513,049, 184,604

© Crown copyright and database rights 2021. Ordnance Survey Licence Number 100049190.  
© Crown copyright material is reproduced with the permission of Land Registry under  
delegated authority from the Controller of HMSO and © Crown Copyright Ordnance Survey.







## HIGH SPEED RAIL (LONDON – WEST MIDLANDS) ACT 2017 GENERAL VESTING DECLARATION No. 802 SHEET 2 of 3

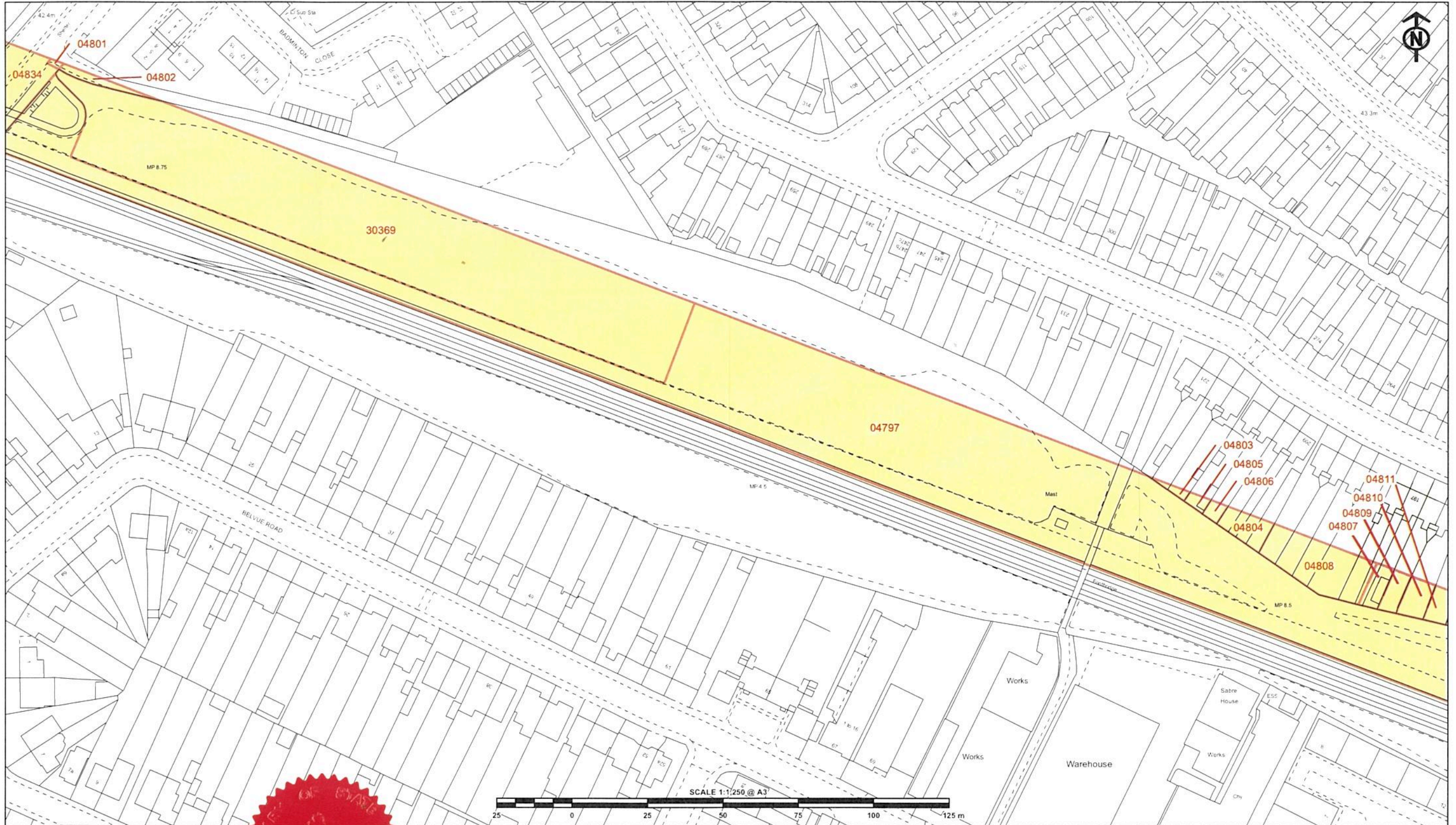

The CORPORATE SEAL of the  
SECRETARY OF STATE  
hereunto affixed to this deed  
is authenticated by

Authorised by the Secretary of State for Transport

Dated: 20 DECEMBER 2021



CENTRE POINT: 513,510, 184,420

SCALE 1:1,250 @ A3

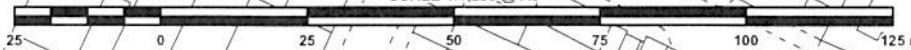







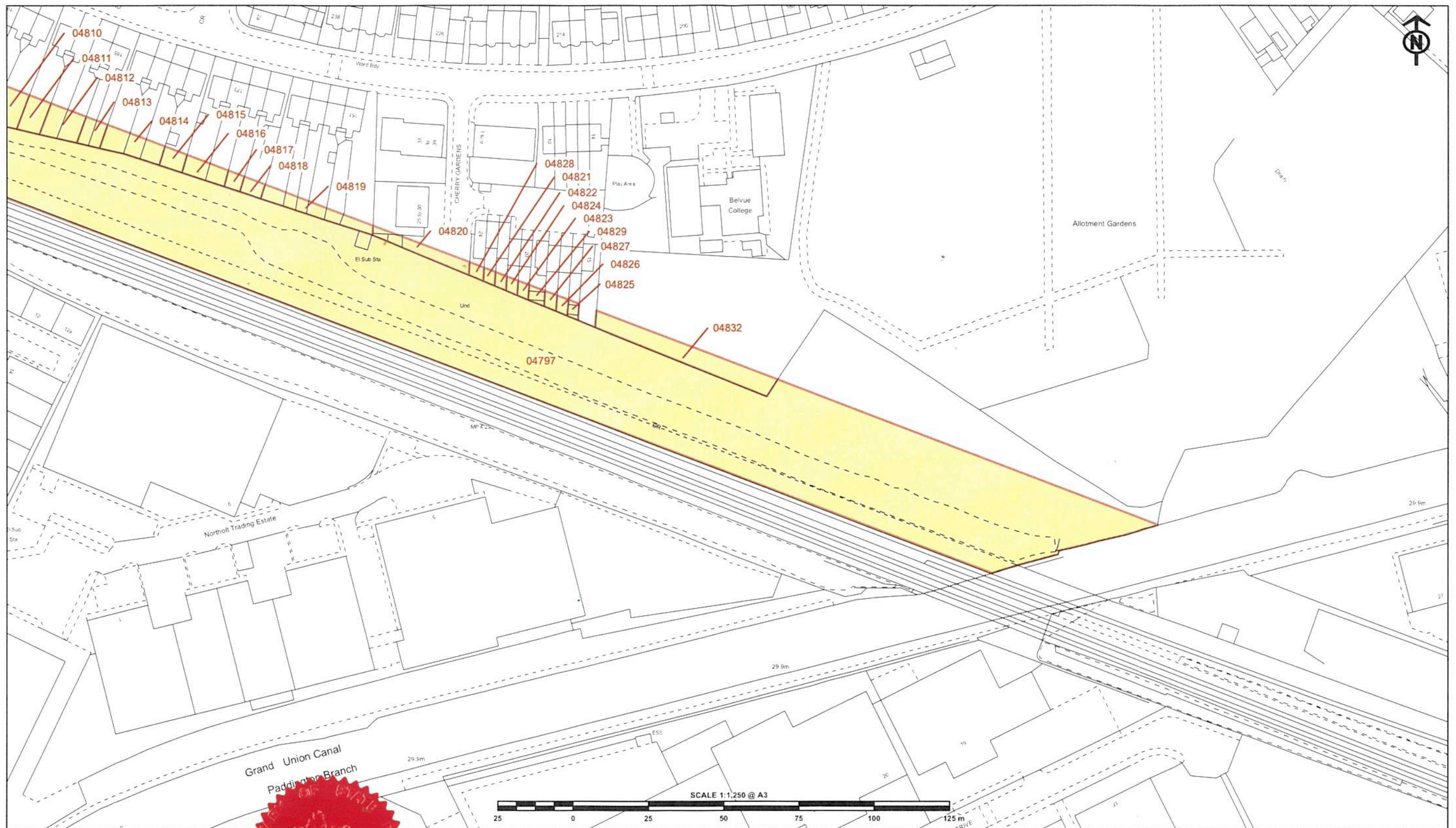

## HIGH SPEED RAIL (LONDON – WEST MIDLANDS) ACT 2017 GENERAL VESTING DECLARATION No. 802 SHEET 3 of 3



The CORPORATE SEAL of the  
SECRETARY OF STATE  
hereunto affixed to this deed  
is authenticated by

  
Authorised by the Secretary of State for Transport

Dated: 20 DECEMBER 2021

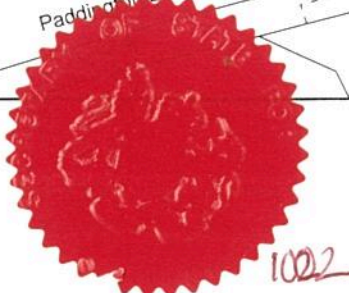

CENTRE POINT: 513,976, 184,257

© Crown copyright and database rights 2021. Ordnance Survey Licence Number 100049190.  
© Crown copyright material is reproduced with the permission of Land Registry under  
delegated authority from the Controller of HMSO and © Crown Copyright Ordnance Survey.