

I hereby certify this to be a true and accurate copy of the original

Name MUSGRAVE

Signed [Signature]

HIGH SPEED RAIL (LONDON - WEST MIDLANDS) ACT 2017

11 FEB 2022

HIGH SPEED RAIL (LONDON - WEST MIDLANDS) GENERAL VESTING DECLARATION No. 613

Occupation CHAIRMAN [Signature]

This GENERAL VESTING DECLARATION is executed on
by the Secretary of State for Transport ("the Authority").

20 OCTOBER 2021

WHEREAS:

- (1) On 23 February 2017 the High Speed Rail (London – West Midlands) Act 2017 ("the High Speed Rail Act") received Royal Assent authorising the Authority to acquire the land specified in the Schedule hereto.
- (2) Section 4(1) of the High Speed Rail Act authorises the Authority to acquire compulsorily so much of the land within the limits of the High Speed Rail Act as may be required for Phase One purposes¹.
- (3) Section 8 of the High Speed Rail Act provides that the power under section 4(1) in relation to land may be exercised in relation to the subsoil or under-surface of the land only.
- (4) Section 4(4) of the High Speed Rail Act provides that the Compulsory Purchase (Vesting Declarations) Act 1981 ("the 1981 Act") applies as if the High Speed Rail Act were a compulsory purchase order and paragraph 3² of Schedule 6 to the High Speed Rail Act provides that the 1981 Act shall have effect subject to the modifications specified in that paragraph.
- (5) Notice pursuant to section 3A³ of the 1981 Act was first published on 23 September 2021. That notice included the particulars specified in section 3A(3) of the 1981 Act.

NOW THIS DEED WITNESSETH that, in exercise of the powers conferred on it by section 4 of the 1981 Act, the Authority hereby declares:-

- 1. The land described in the Schedule hereto (being part of the land authorised to be acquired by the High Speed Rail Act) and more particularly delineated and shown coloured yellow on the plan annexed hereto, together with the right to enter upon and take possession of the land, shall vest in the Authority as from the end of the period of 3 months from the date on which the service of notices required by section 6⁴ of the 1981 Act is completed.
- 2. For the purposes of Section 2(2) of the 1981 Act, the specified period in relation to the land comprised in this declaration is one year and one day.

1 Phase One Purposes has meaning given by section 67 of the High Speed Rail Act

2 Paragraph 3 as substituted by section 11 of, and paragraph 6 of Schedule 14 to, the High Speed Rail Act.

3 Section 3A of the 1981 Act as inserted by paragraph 3(a) of Schedule 6 to the High Speed Rail Act as substituted by section 11 of, and paragraphs 6 and 7 of Schedule 14 to, that Act.

4 Section 6 as modified by paragraph 3(c) of Schedule 6 to the High Speed Rail Act, as substituted by section 11 of, and paragraph 6 of Schedule 14 to, that Act

SCHEDULE

London Borough of Hillingdon

(1) Plot No.	(2) Description
04340	All that stratum of subsoil that lies beneath 22408.51 square metres, or thereabouts, of railways (Chiltern Main Line and Acton-Northolt Line), works, land and woodland, the upper extremity of which is 27.5 metres above Ordnance Survey Datum and the lower extremity of which is 6.8 metres above Ordnance Survey Datum, excluding any interests held by Network Rail Infrastructure Limited.
04341	All that stratum of subsoil that lies beneath 213.37 square metres, or thereabouts, of public road and footway (Long Drive), the upper extremity of which is 28.3 metres above Ordnance Survey Datum and the lower extremity of which is 8.8 metres above Ordnance Survey Datum.
04342	All that stratum of subsoil that lies beneath 740.82 square metres, or thereabouts, of car park, hardstanding, land and access (Long Drive Car Park), the upper extremity of which is 28.3 metres above Ordnance Survey Datum and the lower extremity of which is 8.9 metres above Ordnance Survey Datum.
04343	All that stratum of subsoil that lies beneath 9.29 square metres, or thereabouts, of part of supermarket premises and hardstanding (11 Long Drive), the upper extremity of which is 28.5 metres above Ordnance Survey Datum and the lower extremity of which is 9.2 metres above Ordnance Survey Datum.
04344	All that stratum of subsoil that lies beneath 408.03 square metres, or thereabouts, of car park, hardstanding, part of supermarket premises and land (11 Long Drive), the upper extremity of which is 27.6 metres above Ordnance Survey Datum and the lower extremity of which is 9.1 metres above Ordnance Survey Datum.
04345	All that stratum of subsoil that lies beneath 8581.19 square metres, or thereabouts, of railway (Chiltern Main Line), works, land and hardstanding (West London Waste Authority), the upper extremity of which is 28.4 metres above Ordnance Survey Datum and the lower extremity of which is 7.1 metres above Ordnance Survey Datum.
04346	All that stratum of subsoil that lies beneath 493.21 square metres, or thereabouts, of land and woodland (off Rabournmead Drive), the upper extremity of which is 26.6 metres above Ordnance Survey Datum and the lower extremity of which is 6.8 metres above Ordnance Survey Datum.
04351	All that stratum of subsoil that lies beneath 17.85 square metres, or thereabouts, of public road, footways (Long Drive) and bridge carrying railway (Chiltern Main Line), works and land above, the upper extremity of which is 28.3 metres above Ordnance Survey Datum and the lower extremity of which is 8.8 metres above Ordnance Survey Datum, excluding any interests held by Network Rail Infrastructure Limited.

IN WITNESS WHEREOF the Secretary of State for Transport has hereunto set its corporate seal on the day in the year first written above.

The CORPORATE SEAL of the SECRETARY OF STATE FOR TRANSPORT hereunto affixed to this deed is authenticated by

.....

Authorised Signatory

Dated: 20 OCTOBER 2021

SEAL REF
DfT GP / 0735



I hereby certify this to be a true and accurate copy of the original

Name..... *MUSGRAVE*

Signed..... *[Signature]*

11 FEB 2022

Occupation: *CHAIRMAN* *[Signature]*
High Speed Two (HS2) Limited
Two Snowhill, Birmingham
B4 8GA

HIGH SPEED RAIL (LONDON - WEST MIDLANDS) ACT 2017 GENERAL VESTING DECLARATION No. 613 SHEET 1 of 2

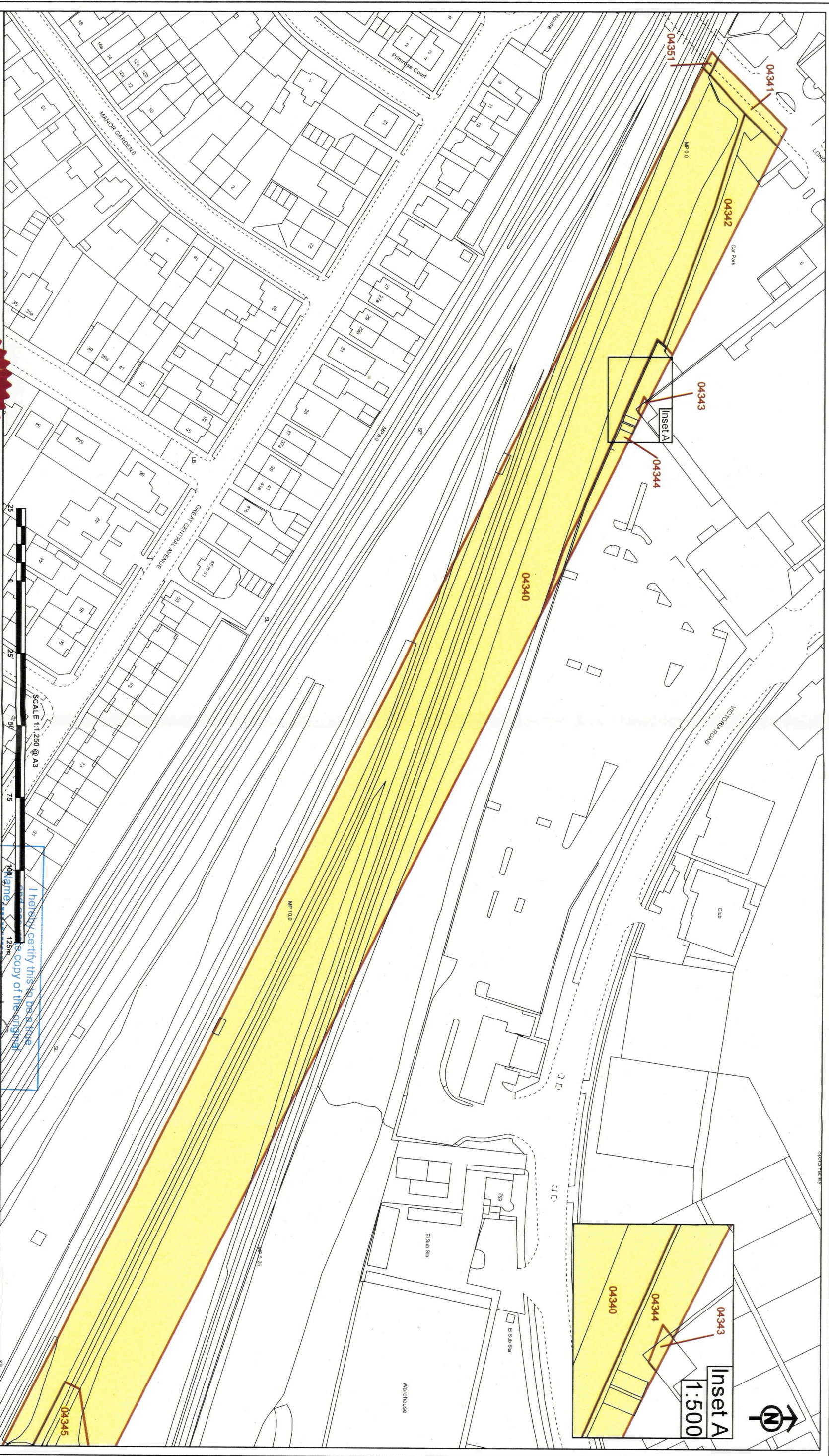

The CORPORATE SEAL of the
SECRETARY OF STATE
hereunto affixed to this deed
is authenticated by my hand.

Authorised by the Secretary of State for Transport
Dated: 20 October 2021



1735

I hereby certify this to be a true
and correct copy of the original

Signed

11 FEB 2022

Occupational
High Speed Two (HS2) Limited
The Signatory, Birmingham

© Crown copyright and database rights 2021. Ordnance Survey Licence Number 100049190
© Crown copyright material is reproduced with the permission of Land Registry, under
delegated authority from the Controller of HMSO and © Crown Copyright Ordnance Survey

HIGH SPEED RAIL (LONDON - WEST MIDLANDS) ACT 2017 GENERAL VESTING DECLARATION NO. 613 SHEET 2 of 2

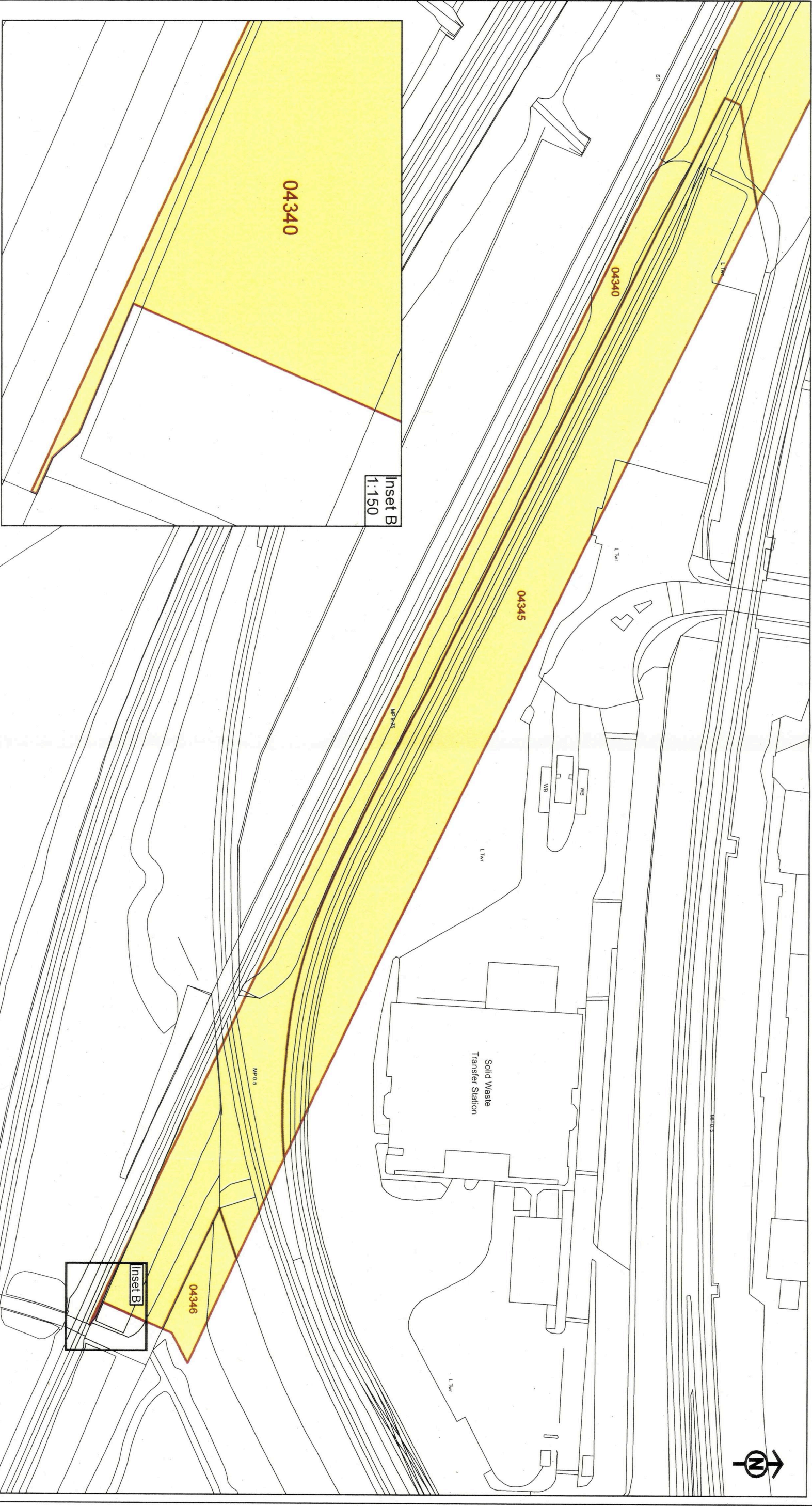

The CORPORATE SEAL of the
SECRETARY OF STATE
hereunto affixed to this deed
is authenticated by

[Signature]

Authorised by the Secretary of State for Transport
Dated: 20 October 2021

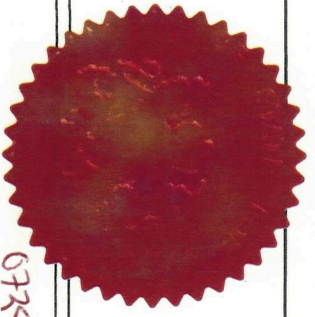

67K5

I hereby certify this to be a true
and accurate copy of the original
Name: *[Signature]*
Signed: *[Signature]*
11 FEB 2022
Occupation: *[Signature]*
High Speed Rail (London - West Midlands) Act 2017
B4 6GA

© Crown copyright and database rights 2021. Ordnance Survey Licence Number 100049190
© Crown copyright material is reproduced with the permission of Land Registry under
delegated authority from the Controller of HMSO and © Crown Copyright Ordnance Survey.