

## HIGH SPEED RAIL (LONDON – WEST MIDLANDS) ACT 2017

### HIGH SPEED RAIL (LONDON – WEST MIDLANDS) GENERAL VESTING DECLARATION No. 912

This **GENERAL VESTING DECLARATION** is executed on 11<sup>th</sup> FEBRUARY 2022 by the Secretary of State for Transport ("the Authority").

#### WHEREAS:

- (1) On 23 February 2017 the High Speed Rail (London – West Midlands) Act 2017 ("the High Speed Rail Act") received Royal Assent authorising the Authority to acquire the land specified in the Schedule hereto.
- (2) Section 4(1) of the High Speed Rail Act authorises the Authority to acquire compulsorily so much of the land within the limits of the High Speed Rail Act as may be required for Phase One purposes<sup>1</sup>.
- (3) Section 4(4) of the High Speed Rail Act provides that the Compulsory Purchase (Vesting Declarations) Act 1981 ("the 1981 Act") applies as if the High Speed Rail Act were a compulsory purchase order and paragraph 3<sup>2</sup> of Schedule 6 to the High Speed Rail Act provides that the 1981 Act shall have effect subject to the modifications specified in that paragraph.
- (4) Notice pursuant to section 3A<sup>3</sup> of the 1981 Act was published on 21 January 2022 and 04 February 2022. The notices included the particulars specified in section 3A(3) of the 1981 Act.

**NOW THIS DEED WITNESSETH** that, in exercise of the powers conferred on it by section 4 of the 1981 Act, the Authority hereby declares:-

1. The land described in the Schedule hereto (being part of the land authorised to be acquired by the High Speed Rail Act) and more particularly delineated and shown coloured pink on the plan annexed hereto, together with the right to enter upon and take possession of the land, shall vest in the Authority as from the end of the period of 2 years from the date on which the service of notices required by section 6<sup>4</sup> of the 1981 Act is completed.

For the purposes of Section 2(2) of the 1981 Act, the specified period in relation to the land comprised in this declaration is one year and one day.

---

<sup>1</sup> Phase One Purposes has meaning given by section 67 of the High Speed Rail Act

<sup>2</sup> Paragraph 3 as substituted by section 11 of, and paragraph 6 of Schedule 14 to, the High Speed Rail Act.

<sup>3</sup> Section 3A of the 1981 Act as inserted by paragraph 3(a) of Schedule 6 to the High Speed Rail Act as substituted by section 11 of, and paragraphs 6 and 7 of Schedule 14 to, that Act.

<sup>4</sup> Section 6 as modified by paragraph 3(c) of Schedule 6 to the High Speed Rail Act, as substituted by section 11 of, and paragraph 6 of Schedule 14 to, that Act

**SCHEDULE**

<b>1 Plot No.</b>	<b>2 Description</b>
53685	All interests in 615.48 square metres, or thereabouts, of private road, footways and verges partly beneath footbridge (Station Link Road)
53686	All interests in 15,330.66 square metres, or thereabouts, of car parks, private road (Birmingham International Railway Station), advertising hoardings, yard, wooded area and railway works and land (Rugby and Birmingham Line) (Station Way)
53693	All interests in 16,632.83 square metres, or thereabouts, of pond, wooded area, car park (NEC West Car Park), public road, verge, footway and public conveniences (Bickenhill Lane, B4438)
53694	All interests in 2,069.96 square metres, or thereabouts, of car park and advertising hoardings (Station Link Road)
53695	All interests in 1,282.7 square metres, or thereabouts, of public road, verge and public footpath (M104) (Bickenhill Lane, B4438), excluding the interests of Solihull Metropolitan Borough Council as highway authority
53699	All interests in 4,900.03 square metres, or thereabouts, of private roads, verges, footways, grassed area and wooded area (Concorde Road, Comet Road, Trident Road and Hermes Road)
56108	All interests in 219.12 square metres, or thereabouts, of scrubland partly under footbridge (Station Link Road)
56110	All interests in 133.2 square metres, or thereabouts, of railway works and land (Perimeter Road)
56111	All interests in 492.94 square metres, or thereabouts, of hardstanding, wooded area and scrubland partly under footbridge (Station Link Road)

56114	All interests in 468.62 square metres, or thereabouts, of private road verge and wooded area (Airport Way and Vanguard Road)
56115	All interests in 65.53 square metres, or thereabouts, of public road verge (Vanguard Road)
56116	All interests in 455.24 square metres, or thereabouts, of grassed area (Vanguard Road)
56117	All interests in 185.21 square metres, or thereabouts, of public road verge (Concorde Road)

**IN WITNESS WHEREOF** the Secretary of State for Transport has hereunto set its corporate seal on the day in the year first written above.

The **CORPORATE SEAL** of the SECRETARY OF STATE FOR TRANSPORT hereunto affixed to this deed is authenticated by

Neil WAT

Authorised Signatory

Dated: 11<sup>TH</sup> FEBRUARY 2022



SEAL REF  
DfT GP / 1163

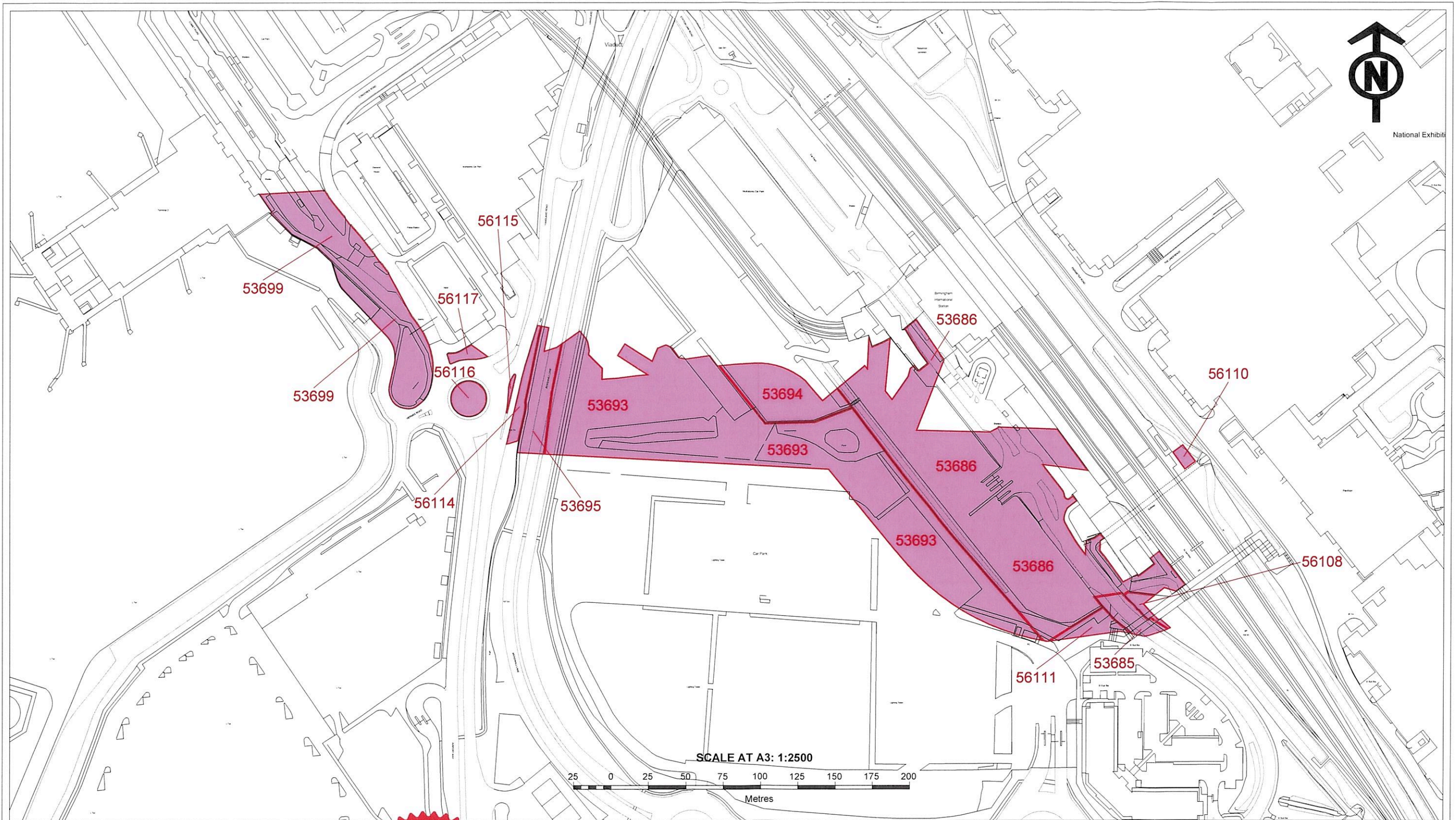

CENTRE POINT: 418.604, 283.584

The CORPORATE SEAL of the  
SECRETARY OF STATE  
hereunto affixed to this deed  
is authenticated by

Authorised by the Secretary of State for Transport

Dated 11<sup>th</sup> FEBRUARY 2022



1163

